

Laredo

2004

when there are no limitations...



A black and white photograph showing the interior of a motorhome. On the left, there is a large sofa with several pillows. In the center, a table is partially visible. On the right, there is a dining area with a table and chairs. Large windows run along the back wall, and a skylight is on the ceiling. The overall atmosphere is bright and spacious.

Laredo

As one of America's most popular brands, you will see why the Laredo appeals to the senses, with classic and timeless styling. From the balanced colors, the open interiors and the rich fresco washed walls, to the customer influenced room layouts...Laredo will satisfy the most discriminating and experienced RVers.

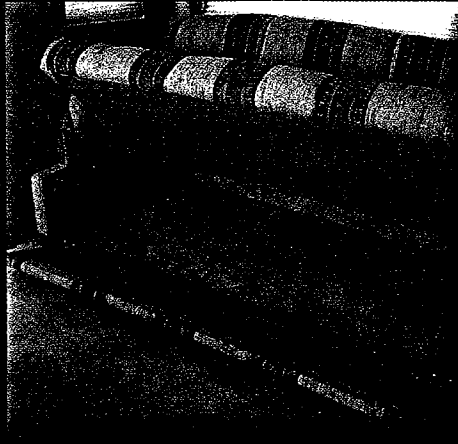
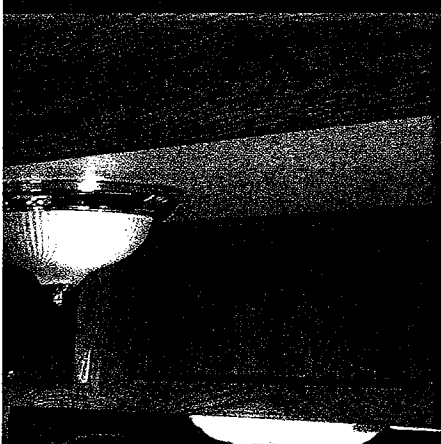

NEW! Laredo's innovative indoor/outdoor rotating entertainment center! Enjoy watching your favorite sporting events, car races or movies while outside with family and friends!!! Available on the 29 GR

A NEW Laredo exclusive; the "easy-store" jack-knife sofa sleeper boasts the most accessible and expansive interior storage of any RV.

Engineers have used today's most advanced technology to design Laredo's exclusive Pentagonal Aluminum Frame™ that creates:

- Lighter Weight
- Straighter Walls
- More aluminum for Strength and Towability

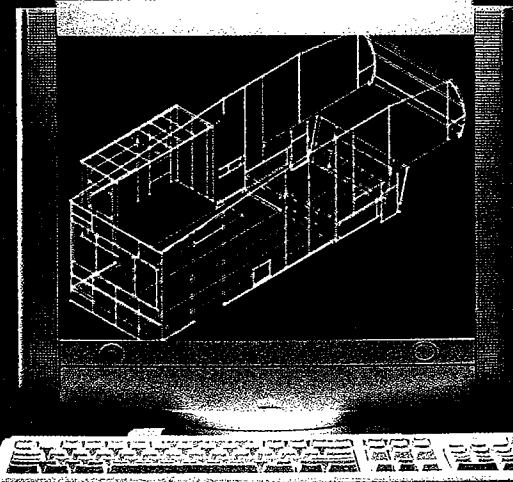

Actual CAD Drawing of Laredo Fifth Wheel

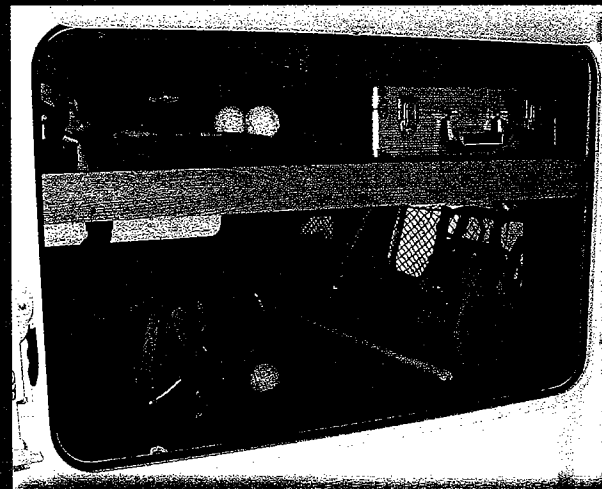

Convenience and function drives every Laredo innovation and feature. Laredo's 4-Way-Entry Basement Storage allows the most camper friendly access ever—including 3 exterior doors and one inside!

Winterizing your Laredo will only take minutes. Turn a valve and press a button... with that ease, your Laredo is ready for winter.

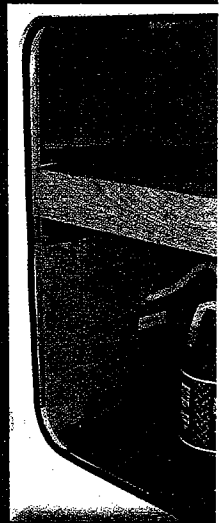

Winter Guard

THERMA SHIELD
TANK ENCLOSURE
-ENCLOSED-INSULATED-HEATED-HOLDING TANKS-

Therma Shield Tank Enclosure is a new advancement to keep your termination valves and holding tanks enclosed, insulated, and heated.

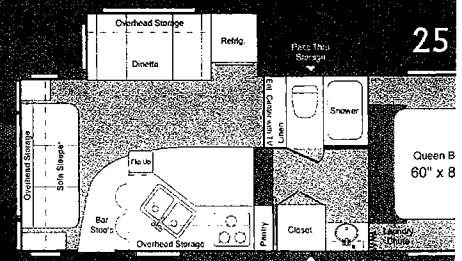

| | | | |
|------------|-------------------|--------------|-------|
| Dry Weight | Carrying Capacity | Hitch Weight | Exter |
| 6543 | 2971 | 1420 | |

Laredo
by Supreme Coach

RESIDENTIAL LIVING PACKAGE:

Surround, 40 Watt CD/Cassette Stereo with Remote, 20" Color TV with Remote, Over the Range Microwave, Shower Door, Countertop Extension, 5 Panel Oak Refrigerator Insert, Day/Night Shades, Clock, Mirror, Sink Cover, 80% tint Windows, *Oak Door Assist Handle, Bathroom Hamper, Kitchen Waste Basket, Deep 30" x 10" Aerosol Kitchen Sink with High Rise Faucet, Sink Cover, Smoke Detector, LP Leak Detector, Raised Ash Mousse and Lamin Cabinet, Doors, Rain Gutters with Down Spouts, Porch Light, Utility Light, 60" x 80" Fine Queen Bed, Satellite Ready, Outside Shower, *Winter Guard™ System

COMFORT PLUS PACKAGE:

Fiberglass Front Cap, Fiberglass Exterior, Full Walk-On Roof with Seamless EPDM Rubber Covering, Aluminum Construction, Stabilizer Jacks, *Front Electric Jack, Security Light, Awning, *Rear Ladder, TV Antenna with Booster, 13.5 BTU A/C, *Padded Folding Entry Handle, Spare Tire with Cover, Double Insulated Cook (R-14), Enclosed and Heated Holding Tanks, E-Z Lube Axles, Triple Entry Steps, Gas/Electric 6 Gallon PSI Water Heater, Water Heater Bypass Kit, *Extended Hitch Pin

*Fifth Wheels Only

(1) Day/Night Shades Standard on

Fifth Wheels Optional on Travel Trailers



2 Rocker/Glider opt.
28RL, 254RL, 29GS only



Table with Chairs

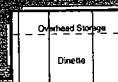

Hide-A-Bed Option

| Models | 25RL | 27RK | 27RL | 28RE | 29GS | 29GR | 29BH |
|-----------------------|-------------|-------------|-------------|-------------|-------------|-------------|-------------|
| Fresh Water System: | 45 Gal | 45 Gal | 45 Gal | 45 Gal | 45 Gal | 45 Gal | 45 Gal |
| Grey Water: | 40 Gal | 72 Gal | 40 Gal | 72 Gal | 72 Gal | 72 Gal | 72 Gal |
| Waste Water: | 40 Gal | 40 Gal | 40 Gal | 40 Gal | 40 Gal | 40 Gal | 40 Gal |
| Brake Size: | 12" | 12" | 12" | 12" | 12" | 12" | 12" |
| Tire Size: | 225/5R15(D) | 225/5R15(D) | 225/5R15(D) | 225/5R15(D) | 225/5R15(D) | 225/5R15(D) | 225/5R15(D) |
| Height Including A/C: | 140" | 140" | 140" | 140" | 140" | 140" | 140" |

See "trailer weight information" placard located in unit for specific weight including options.
Base dry weights exclude all removable options. Carrying capacity includes all popular options, excluding fluids.

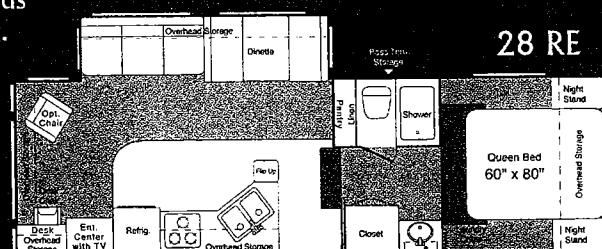

Dry Weight 7153 Carrying Capacity 2596 Hitch Weight 1565 Exterior Length 30.4"

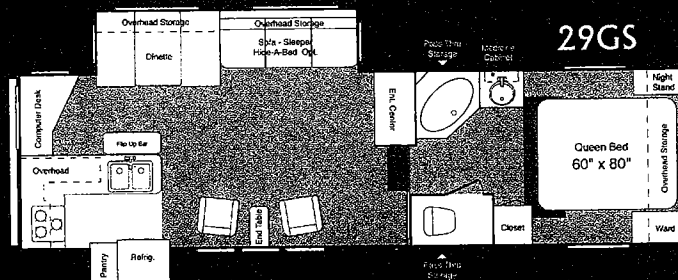

Dry Weight TBA Carrying Capacity TBA Hitch Weight TBA Exterior Length TBA

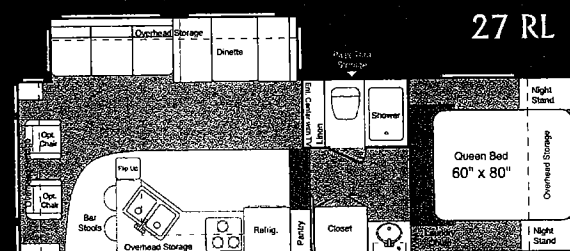

Dry Weight 6925 Carrying Capacity 2471 Hitch Weight 1450 Exterior Length 29.5"

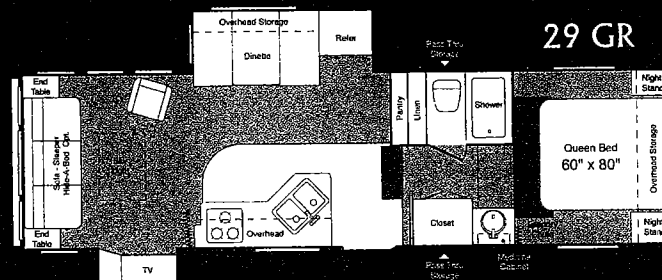

Dry Weight 7450 Carrying Capacity 2450 Hitch Weight 1790 Exterior Length 31.4"

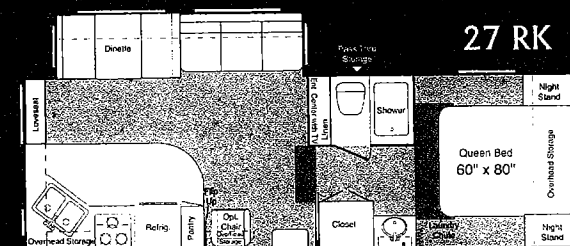

Dry Weight 6798 Carrying Capacity 2666 Hitch Weight 1450 Exterior Length 28.10"

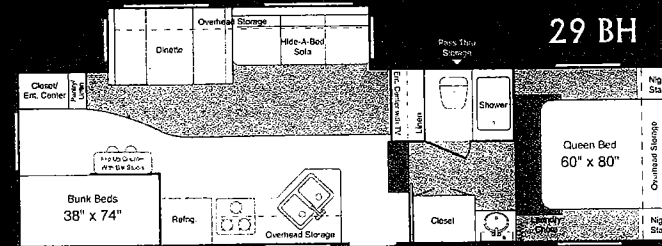

Dry Weight 7218 Carrying Capacity 2701 Hitch Weight 1460 Exterior Length 31.4"

System

length

CEILING FABRIC
WALL BORDER
COUCH FABRIC



CARPET
INTERIOR CHOICES:

Indian Summer

Sunny Sage

Marble Cloud

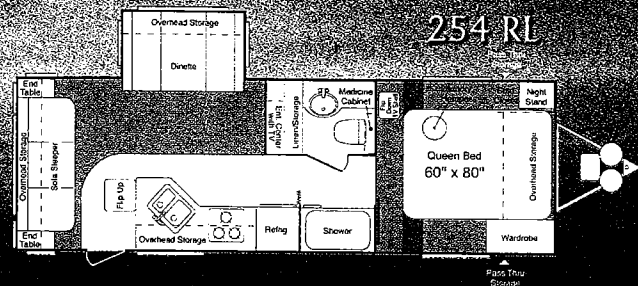

Dry Weight 5524 Carrying Capacity 1431 Hitch Weight 420 Exterior Length 29.1"

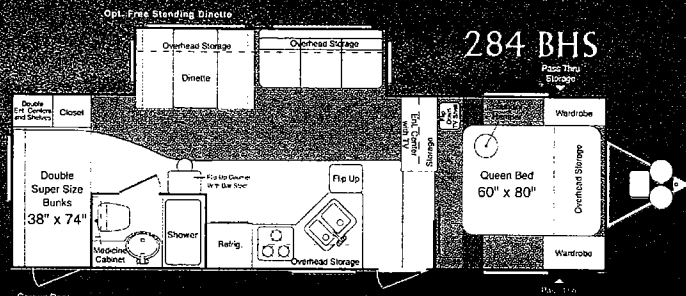

Dry Weight 6474 Carrying Capacity 2981 Hitch Weight 600 Exterior Length 33.3"

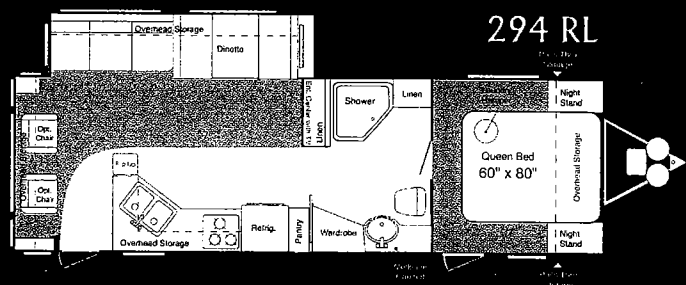

Model Available January 2004

The Laredo TRAVEL TRAILER stands in a class of its own.



...live your dream

Inspired and influenced by actual RV owners, Laredo offers the most popular features of any TRAVEL TRAILER in its class...No other TRAVEL TRAILER will compare with Laredo.

| Models | 254RL | 284BHS | 294RL |
|-----------------------|-------------|-------------|-------------|
| Fresh Water System: | 45 Gal | 45 Gal | 45 Gal |
| Grey Water: | 30 Gal | 30 Gal | 30 Gal |
| Waste Water: | 30 Gal | 30 Gal | 30 Gal |
| Brake Size: | 10" | 12" | 12" |
| Tire Size: | 20575B15(C) | 22575R15(D) | 22575R15(D) |
| Height Including A/C: | 119" | 121" | 121" |

Your Laredo Dealer:

A direct response from customer feedback; Laredo's travel trailer has the MOST expansive pass-thru storage available.

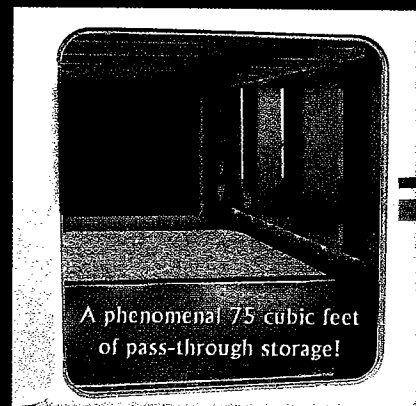

A phenomenal 75 cubic feet of pass-through storage!



Keystone RV Company

17400 Hackberry Drive, Goshen, IN 46520
(574) 535-2100
www.keystone-goshen.com

Product information is as accurate as possible at the time of publication. Features, floorplans, and specifications are subject to change without notice. Some features listed and shown are optional 9/03