



FORM AND FUNCTION AT ITS BEST...



Outback's exterior pass-through storage features a large pull-out drawer for an effortless reach to all your camping items and there's plenty of room for long and narrow cargo as well.

See for yourself how relaxed you'll feel dining or just enjoying family time in the elegantly functional Outback travel trailer.



Outback

by Keystone

Your Favorite Outback Dealer:



Outback's exclusive outdoor cook center is permanently attached and opens with ease. A built-in cutting board/counter and flip-out towel bar along side the stovetop will expand your cooking area.



**Keystone RV
Company**

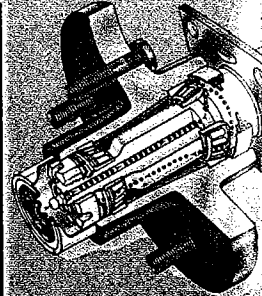
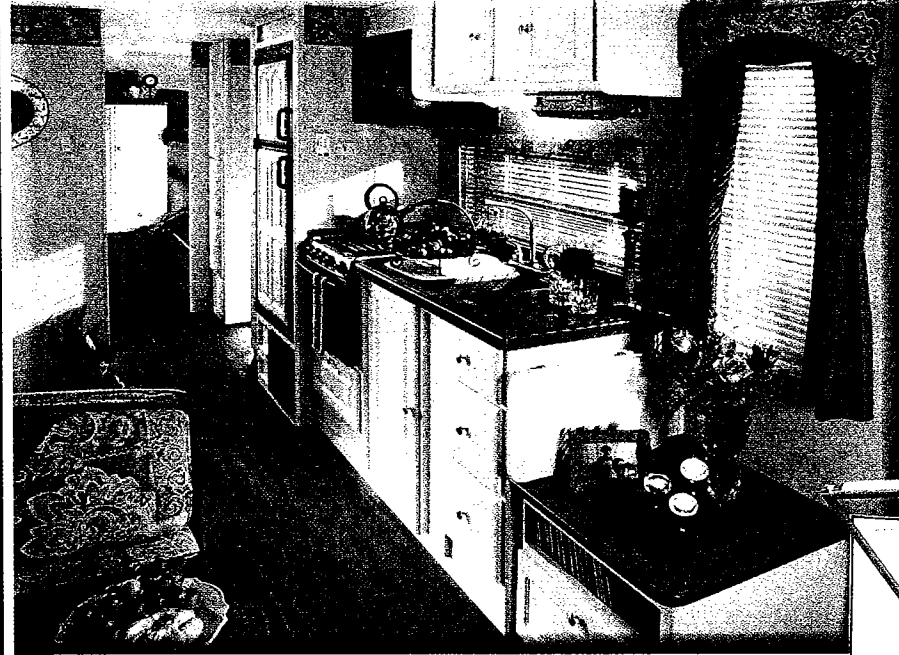
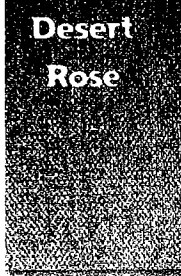
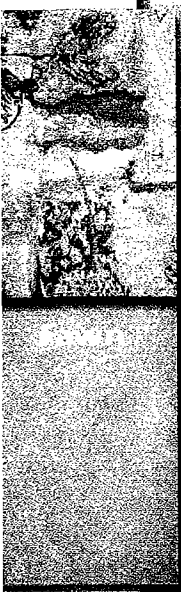

Preparing food will be your pleasure in this beautiful kitchen thanks to plenty of cabinet space and additional storage.
Pictured above: 28RS-S in Desert Rose

21RS

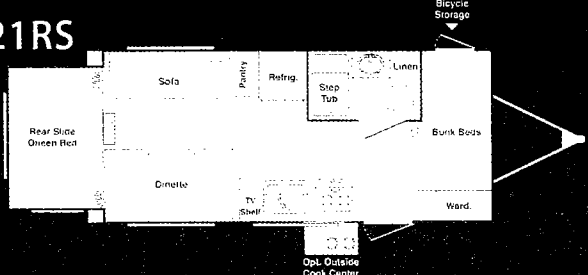

Dry Weight • Carrying Capacity • Hitch • Exterior Length
*3990 1510 360 22'1"

23RS

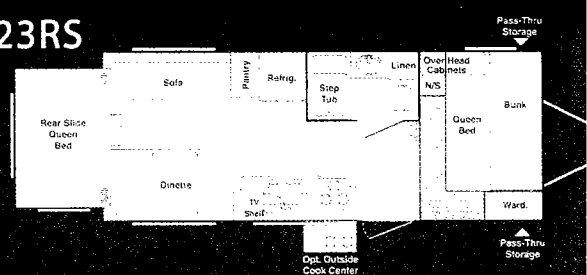

Dry Weight • Carrying Capacity • Hitch • Exterior Length
*4360 1640 420 24'11"

28RS-S

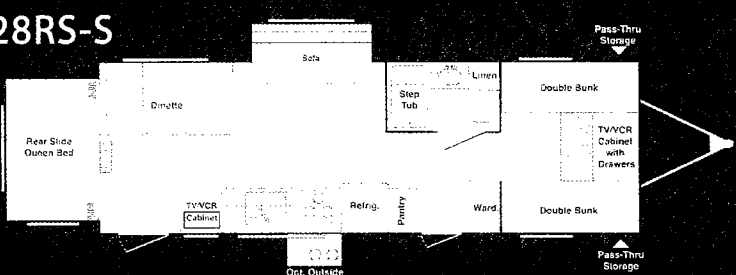

Dry Weight • Carrying Capacity • Hitch • Exterior Length
*5190 1810 460 29'4"

25FB-S

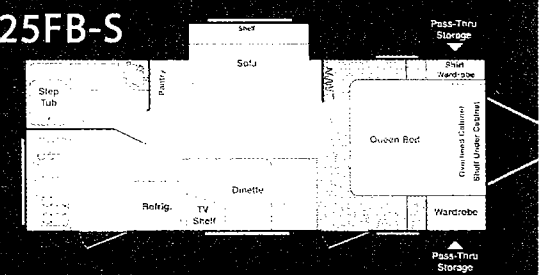

Dry Weight • Carrying Capacity • Hitch • Exterior Length
*4130 1870 440 25'2"

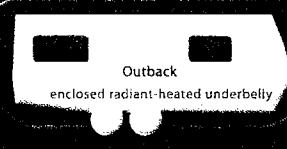
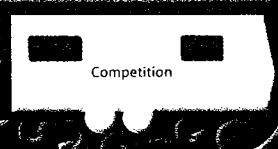

Outback's exterior design with the enclosed underbelly creates less air turbulence for easier towing.
Outback's exclusive below-floor radiant heat ducts will extend your camping season and increase your interior storage space.

Comfort Package: 13,500 ducted A/C, AM/FM Microwave

Designer Package: Oval mirror, Wall border accessories, Brushed nickel coat hooks, Utensil rack, LP/battery cover, Chrome bumper cover, Raised panel board, Paper towel holder, Laundry hamper

Other Popular Options

6 gal. gas/electric DSI water heater, Oven, 4-stabilizer surround, Outside cook center, 14" spare tire kit, Pull

Product information and photography are as accurate as possible at the time of publication. Colors and finishes are photographic representations and may appear differently when viewing actual materials. Some features shown are optional. Features, prices and specifications are subject to change without notice. 11/03

* Options not included in dry weight, check actual trailer for dry weight w/options.

Running Gear

- 205-14 trailer tires (TT only)
- 225-15 trailer tires (FW only)
- White wheels with black dust caps and lugnut covers
- 10" electric brakes (TT only)
- 12" electric brakes (FW only)
- Leaf spring "equalizing" suspension system
- 8" I-beam frame, totally powder-coated

Electrical

- Patio light with amber lens
- Ceiling lights with wall switches
- Outside 120-volt receptacle
- 30-amp. power cord
- 55-amp. (solid state) converter
- Double-battery brackets
- Hitch light
- Trunk light

Capacity

LP Capacity (lb.)= 60
 Water Capacity (Gal.)
 Fresh.....45
 Grey.....30 (29F BH-S.....60)
 Waste.....30

Appliances & Equipment

- 2-door refrigerator
- 3-burner range
- 6-gallon water heater
- 30,000 BTU furnace
- Water heater bypass kit
- 1-piece molded acrylic countertops and sinks (TT)
- Stainless steel stove top
- Flush fit sink cover/cutting board
- Hi-rise faucet in galley
- Monitor panel
- Compression waterline fittings

Exterior

- Filon™ "plus" exterior fiberglass
- PDM rubber roof
- Jalousie windows throughout
- 30-lb. LP bottles
- Drip rails with drip caps
- Radius entrance doors
- Grab handles at entrance doors
- TT=21'-26' : 10' ext. height top of A/C
- TT=28' : 10'2" ext. height top of A/C
- FW=12'3" ext. height top of A/C
- Ladder (FW only)
- Heated and enclosed underbelly and tanks

Interior

- Grab handles inside at entrance doors
- Water, soil and stain-resistant fabrics
- Custom-designed box valances
- Miniblinds on all windows (TT only)
- Pleated shades on all windows (FW)
- Congoleum® flooring
- Carpet in bedrooms (TT and FW) and livingroom (FW)
- Large overhead cabinets
- "Thermofoil" raised panel cabinet doors
- Residential style concealed cabinet door hinges
- Wood side drawers with residential-style drawer guides
- Upholstered headboard
- Portable Acrylic dinette table with folding legs for exterior use (TT)

Bath

- Power roof vent
- 1-piece molded acrylic lavatory sink with sink cover (TT only)
- Skylight over tub (TT only)
- Grab handle at bathtub (TT only)
- Neo angle shower stall (FW only)
- Sky light over shower (FW only)
- Custom built medicine cabinet (FW)

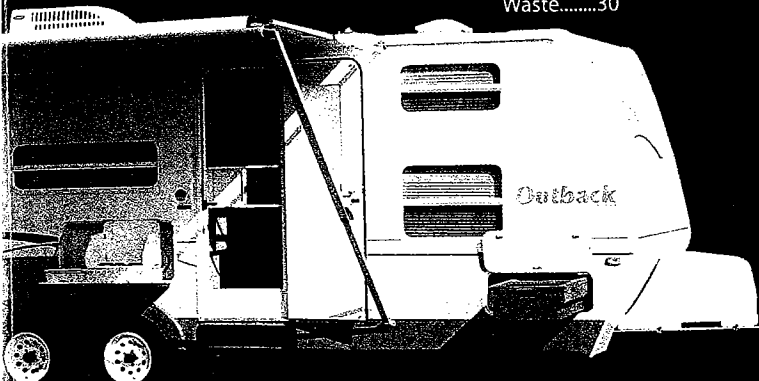

25RS-S

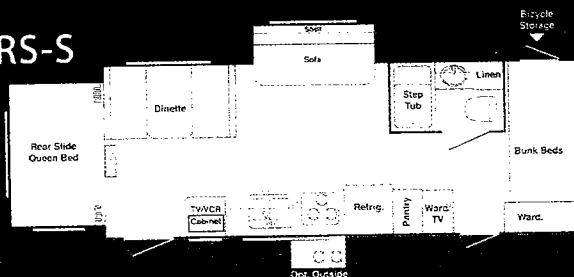

Dry Weight • Carrying Capacity • Hitch • Exterior Length
 *4655 1345 440 25'10"

26RS

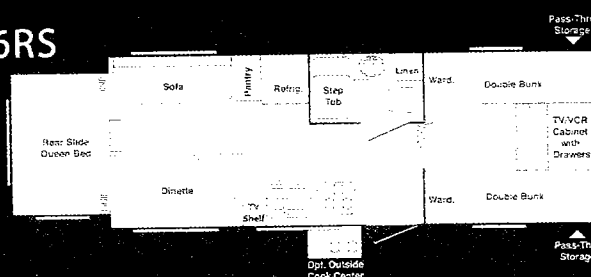

Dry Weight • Carrying Capacity • Hitch • Exterior Length
 *4480 1520 600 26'5"

28BH-S

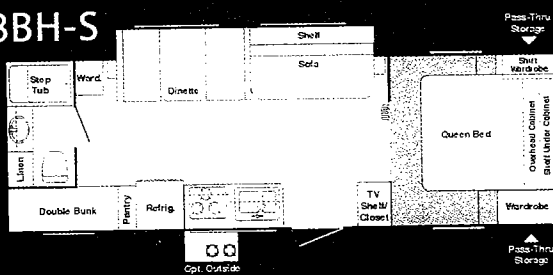

Dry Weight • Carrying Capacity • Hitch • Exterior Length
 *4930 2070 560 29'4"

28RL-S

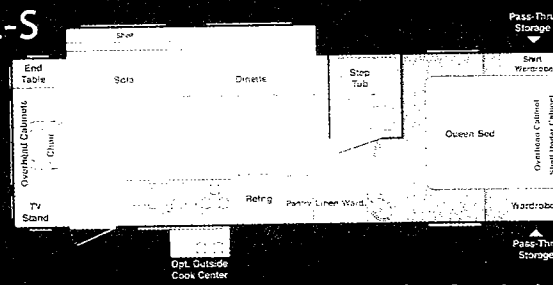

Dry Weight • Carrying Capacity • Hitch • Exterior Length
 *4900 2100 760 29'10"

FM/CD stereo, Awning, TV antenna/cable,

er, Cloth shower curtain, Sofa pillows, Bathroom
 & Posture rest innerspring mattress, Bedspread,
 panel refrigerator, Catch-all tray, Recessed cutting

er jacks, Outside shower, 2 security lights, Tub
 illout pantry, Exterior storage drawer

Another example of Form and function:

Maximum kitchen
 storage from
 floor to ceiling!

