

Outback

2006
by Keystone

EXTRAORDINARY
TRAVEL TRAILERS

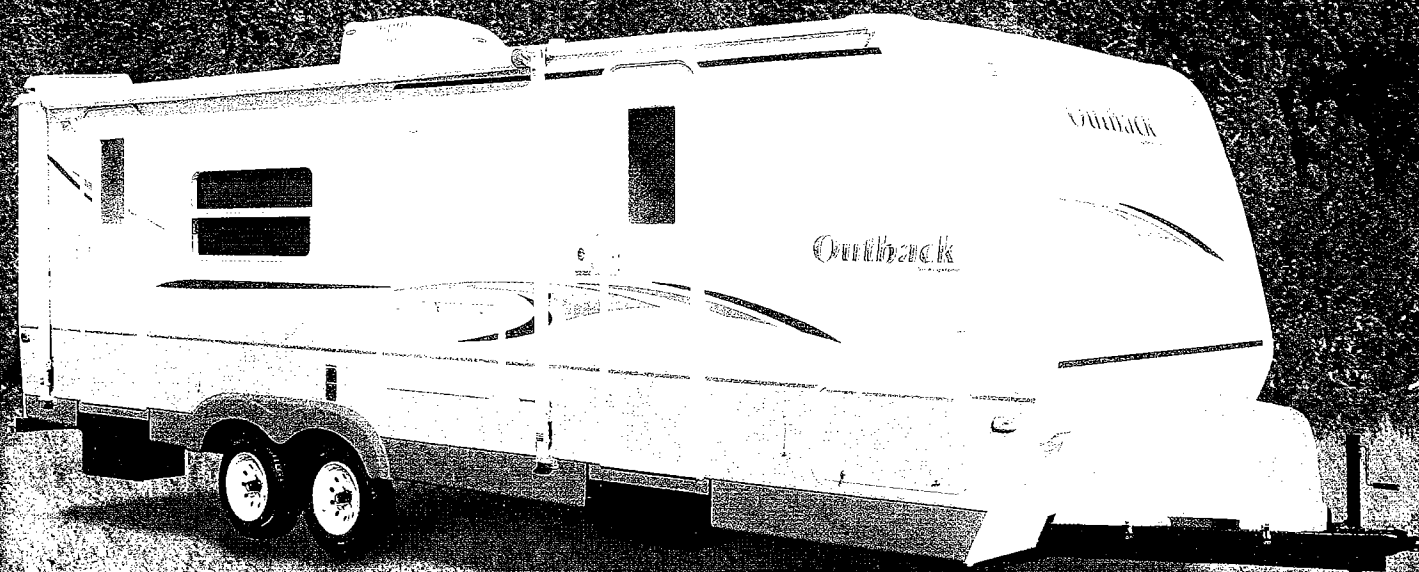

"Built for a Lifetime of RVing"

Outback

UNCOMMON DESIGN



OUTBACK OPTIONS

- Designer package
- Comfort package
- Pullout pantry (n/a on all models)
- Carbon monoxide detector
- Exterior picnic table
- Tub surround
- Outside camp kitchen
- 14" Spare tire kit
- 6-Gal. gas/elec. DSI water heater
- Oven
- Stabilizer jacks (4)
- 2 Security lights at side

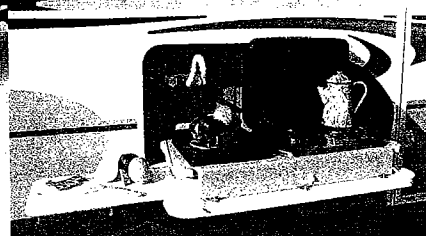

New this year with Outback's fabulous outside camp kitchen is a 20-ft. coil hose you can swap with the sink faucet for outdoor clean-up. The large concealed cutting board slides from side to side, both hot and cold water are accessible, and there's even a towel rack.

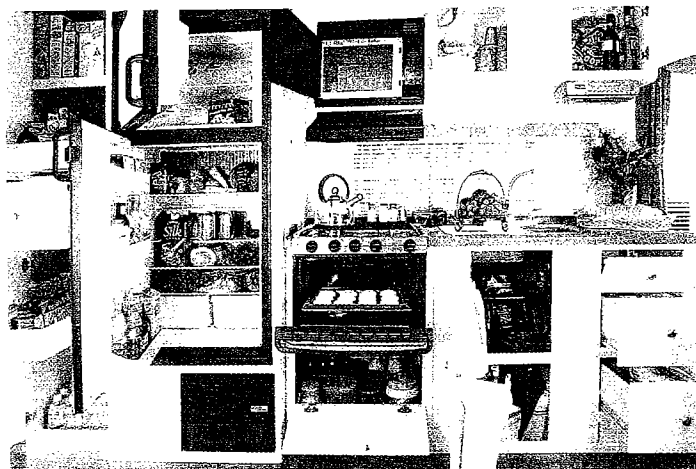
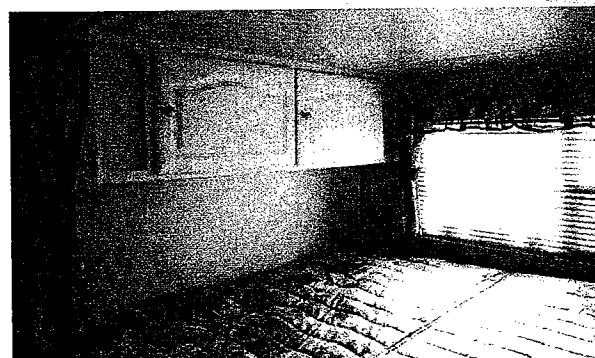
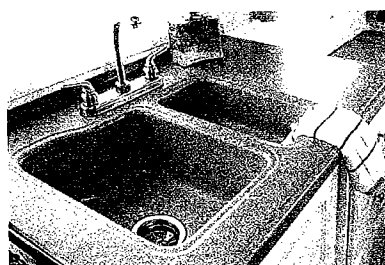

Top left, Outbacks' one-piece, granite-look molded acrylic sink/countertop. Top right, the hardwall rear slide-out bedroom adds living space without length when it's time for Outback to take to the road. New for 2006, a bank of cabinets above the queen-size bed. Bottom photo shows the amazing amount of storage you'll enjoy in your Outback kitchen.

**REMOTE-CONTROLLED HEATING,
AIR-CONDITIONING AND DEHUMIDIFYING
ALLOW YOU TO
MANAGE YOUR ENVIRONMENT**

**LIGHT AND STYLISH,
DURABLE AND AFFORDABLE**

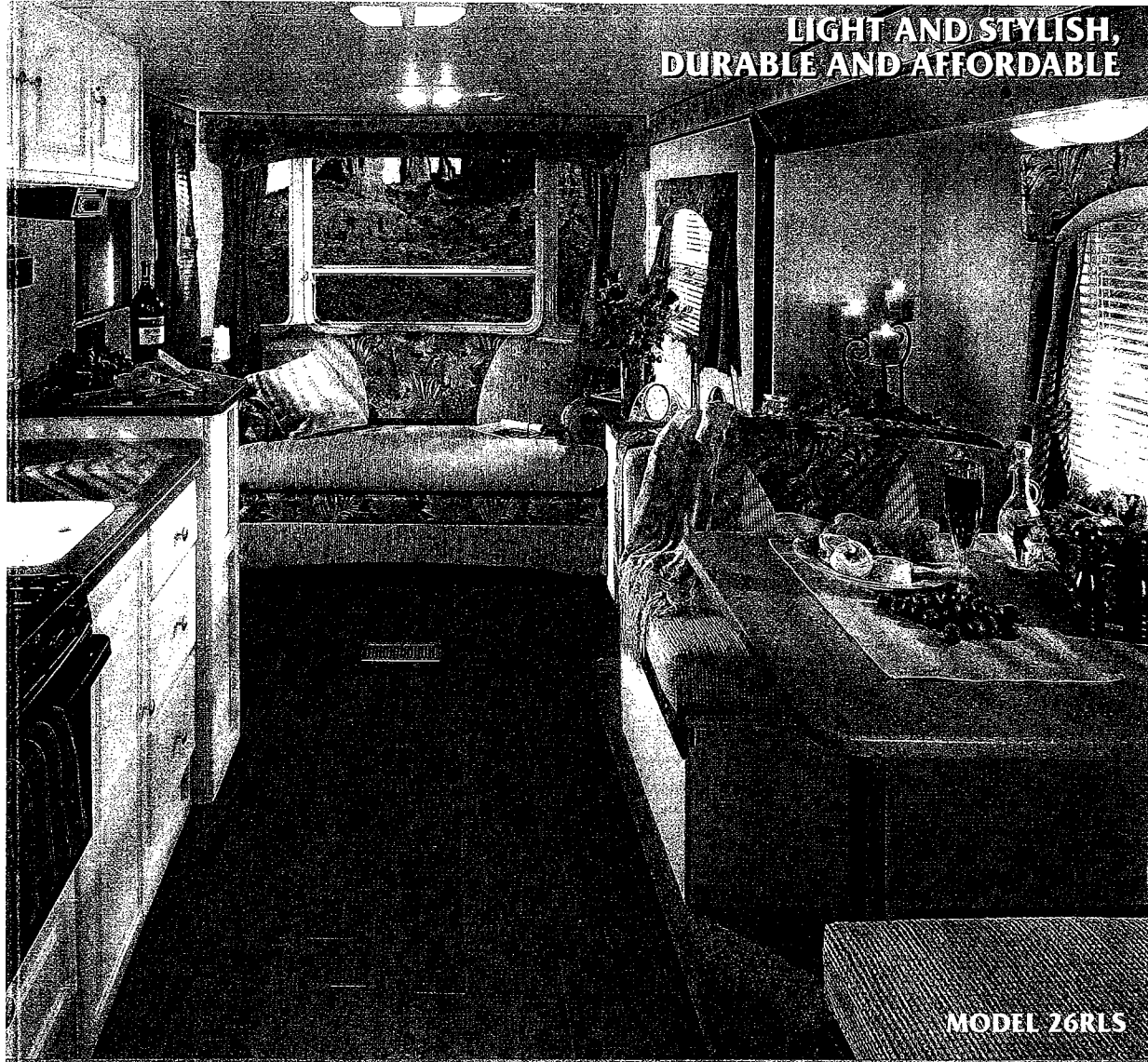

MODEL 26RLS

Left photo, Outback's Havana decor, new for 2006, shown here in Model 26RLS. The appeal of the Outback interior revolves around the unusual white raised panel Thermofoil cabinetry. Specially suited for the RVing environment, it is light but remarkably strong and easy to maintain. Contrasting with the cherry wood-plank look flooring, the cabinetry harmonizes with Outback's light-toned furnishings. The complete look offers the same fresh, upscale style found in today's most trend setting homes. The 26RLS also features a comfortable camel-back sofa in front of a panoramic scenic view window. In the front of the model, there is a spacious, carpeted queen bedroom/bathroom suite.

STANDARD INTERIOR FEATURES

Living Area

- Grab handle at entry*
- Hardwood valance (living room)
- Linoleum floor
- Thermofoil residential raised-panel doors with concealed hinges throughout
- Wood side drawers with steel guides
- Water, soil, and stain resistant fabrics
- Molded acrylic galley counter and dinette
- Aluminum framed dinette seats
- Large overhead cabinets

Kitchen

- 60/40 deep molded acrylic sink with 3" drains
- Pullout pantry drawers* (n/a 26RKS and 26RLS)

- Two-door 6 cu.ft. refrigerator
- High-rise faucet
- Flush fitting cutting board
- Monitor panel
- Utensil tray
- Trash can (most models)
- 3 burner range with oven*

Bedroom

- Deluxe innerspring mattress
- TV hook-up
- Residential bedspread
- Deluxe headboard
- Jalousie windows for maximum ventilation

Bathroom

- Power roof vent
- One-piece molded acrylic lavatory sink
- Skylight over tub
- Grab handle at tub
- Porcelain foot flush toilet
- Laundry hamper

- Tub surround*
- Large linen closet (most models)

Appliances

- Two-door 6 cu.ft. refrigerator
- Three-burner range with oven*
- Six gallon gas/electric DSI water heater*
- 30,000 BTU furnace
- 13,500 BTU Remote-controlled A/C with timer*

OUTBACK DESIGNER PACKAGE

Oval mirror, Wall Border, Cloth Shower Curtain, Laundry Hamper, Bathroom Accessories, Brushed Nickel Coat Hooks, Utensil Rack, Sofa Pillows, Innerspring Mattress, Bedspread, LP/Battery Cover, Chrome Bumper Cover, Catch-All Tray, Raised Panel Refrigerator, Recessed Cutting board, (Approx. Wt. - 300 Lbs.)

OUTBACK COMFORT PACKAGE

TV Antenna/Cable, Microwave, AM/FM/CD Stereo, Awning, 13,500 BTU Ducted A/C with Remote (Approx. Wt. 200 Lbs.)

*Optional

2006 Outback Floorplans

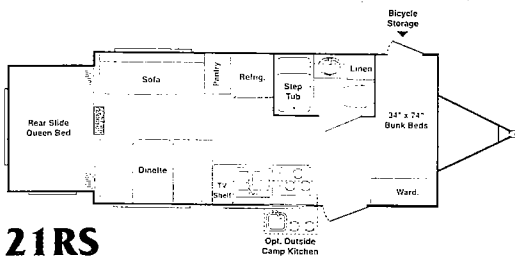

21RS

GVWR Dry Weight Hitch Carrying Cap.
6000 4300 425 1625
Ext. Height w/AC Exterior Length
9' 11" 22' 1"

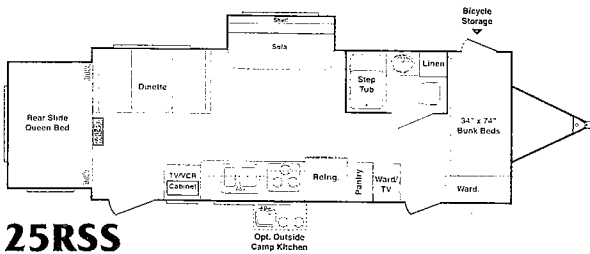

25RSS

GVWR Dry Weight Hitch Carrying Cap.
6000 4695 440 1305
Ext. Height w/AC Exterior Length
9' 11" 25' 10"

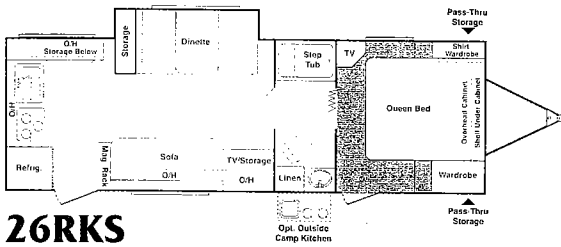

26RKS

GVWR Dry Weight Hitch Carrying Cap.
7000 5155 625 1845
Ext. Height w/AC Exterior Length
9' 11" 28' 9"

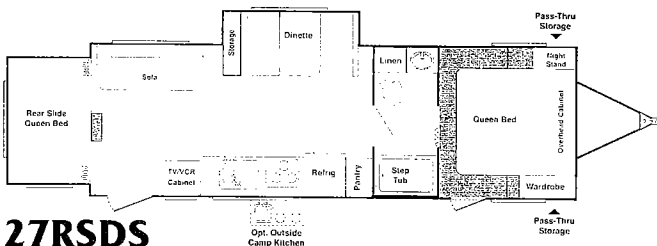

27RSDS

GVWR Dry Weight Hitch Carrying Cap.
7500 5550 570 1950
Ext. Height w/AC Exterior Length
10' 1" 29' 7"

OUTBACK TANK CAPACITIES

LP Capacity: 60 Lbs.

Water Tanks:

Fresh.....50 Gal.
Grey.....40 Gal.
Waste.....40 Gal.

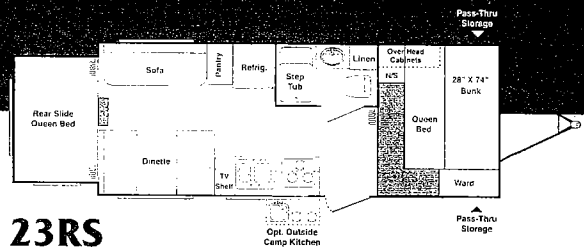

23RS

GVWR Dry Weight Hitch Carrying Cap.
6000 4715 565 1285
Ext. Height w/AC Exterior Length
9' 11" 24' 11"

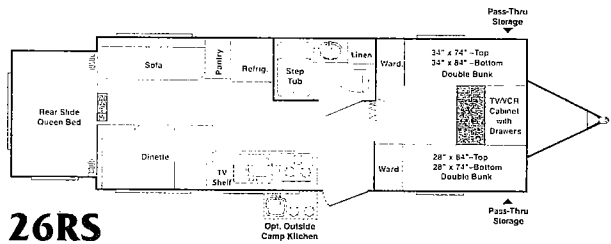

26RS

GVWR Dry Weight Hitch Carrying Cap.
6000 4905 605 1095
Ext. Height w/AC Exterior Length
9' 11" 26' 5"

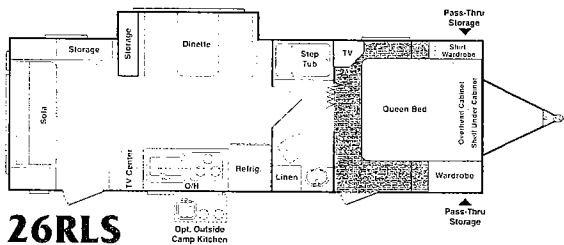

26RLS

GVWR Dry Weight Hitch Carrying Cap.
7000 5025 770 1975
Ext. Height w/AC Exterior Length
10' 1" 28' 10"

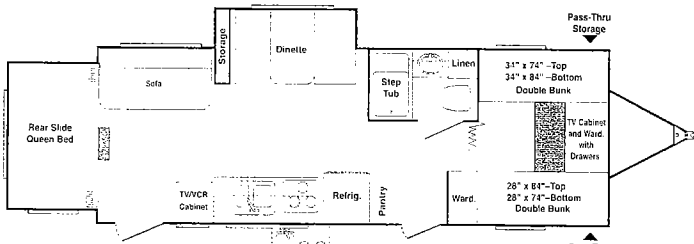

28RSDS

GVWR Dry Weight Hitch Carrying Cap.
7500 5630 700 1870
Ext. Height w/AC Exterior Length
10' 1" 30' 8"

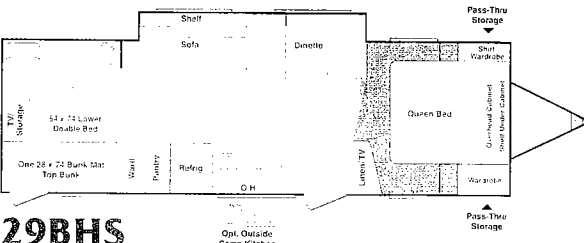

29BHS

GVWR Dry Weight Hitch Carrying Cap.
7500 5250 670 2250
Ext. Height w/AC Exterior Length
10' 1" 30' 8"

*Options not included in dry weight; check actual trailer for dry weight with options.

