

PREMIER

ULTRA LITE BY BULLET



THE PREMIERE ... LUXURY LIGHTWEIGHT



Premier utilizes frameless tinted windows to provide an elegant exterior look and feel.



The vaulted ceiling system provides an unprecedented interior ceiling height in an ultra lite weight product.



Premier's stainless steel appliances provide a contemporary look to our kitchens.



Progressive lighting throughout the Premier brings a residential look and function to the master bedroom.

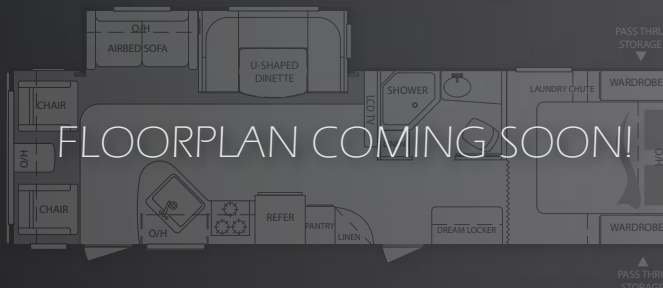
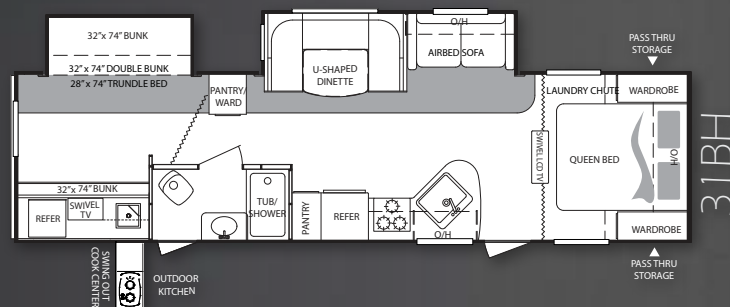
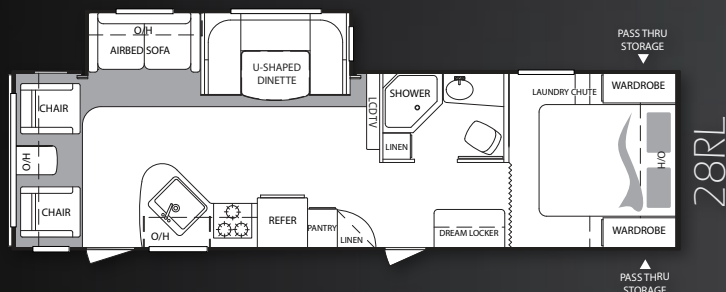
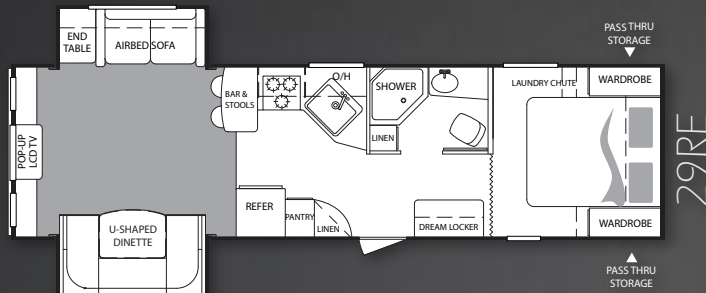

FLOORPLAN COMING SOON!



| | 19FB | 28RL | 29RE | 31BH |
|--------------------------|------|------|------|---------|
| Shipping | TBD | TBD | TBD | 6230 |
| Carrying Capacity | TBD | TBD | TBD | 1370 |
| Hitch | TBD | TBD | TBD | 785 |
| Ext. Length | TBD | TBD | TBD | 35' 4" |
| Ext. Width | TBD | TBD | TBD | 8' |
| Ext. Height | TBD | TBD | TBD | 10' 11" |
| Fresh Water | TBD | TBD | TBD | 41 |
| Waste Water | TBD | TBD | TBD | 30 |
| Grey Water | TBD | TBD | TBD | 30 |
| LPG | TBD | TBD | TBD | TBD |

PREMIER PACKAGE

- Aerodynamic Fiberglass Front Cap
- Stainless Steel Appliances
- Vaulted Ceiling System
- Exterior LED Lights
- Frameless Tinted Windows
- Power Tongue Jack
- Air Bed Sofa Sleeper
- Max Depth Slides
- Progressive Interior Lighting
- Chestnut Glazed Cabinetry
- Upgraded Exterior Graphics Package

Plus Full Body Paint Option!

Product information is as accurate as possible as of the date of publication of this brochure. Features, floor plans, and specifications are subject to change without notice. Please also consult Keystone's web site at keystonerv.com for more current product information and specifications. Tow Vehicle Disclaimer. CAUTION: Owners of Keystone recreational vehicles are solely responsible for the selection and proper use of tow vehicles. All customers should consult with a motor vehicle manufacturer or their dealer concerning the purchase and use of suitable tow vehicles for Keystone products. Keystone disclaims any liability or damages suffered as a result of the selection, operation, use or misuse of a tow vehicle. KEYSTONE'S LIMITED WARRANTY DOES NOT COVER DAMAGE TO THE RECREATIONAL VEHICLE OR THE TOW VEHICLE AS A RESULT OF THE SELECTION, OPERATION, USE OR MISUSE OF THE TOW VEHICLE. 11/2009