

# RESIDENCE

*by Keystone*



**Keystone RV  
Company**

[www.keystone-residence.com](http://www.keystone-residence.com)





## 401FE Specifications

Shipping Weight	10,620
Carrying Capacity	2380
Hitch Weight	1285
Exterior Length	40' 11"
Exterior Width	8' 6"
Exterior Height	12' 9"
Fresh Water Capacity	70
Waste Water Capacity	34
Gray Water Capacity	68
LPG Capacity	60
Water Heater Capacity	16
Tire Size	235 80R16E

◀ The 401FE features a spacious slide room, ideal for family get togethers or entertaining. The extra large front windows add to the beauty of the interior. The Fireplace in the living room is a popular feature.

## 401FE

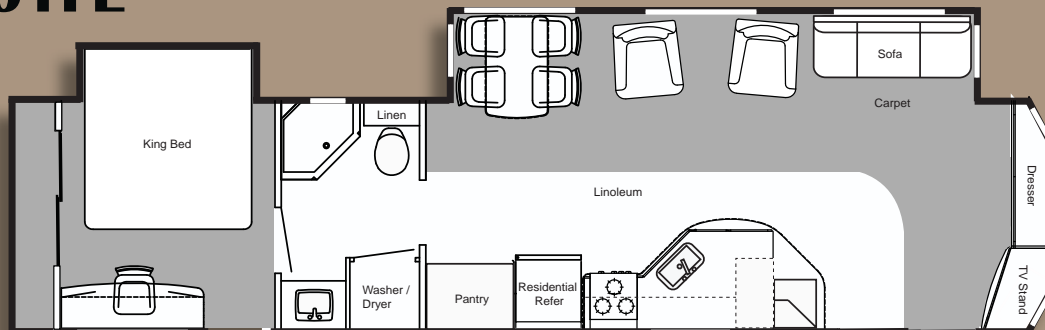

The master bedroom in the 401FE features a 72 x 80 inch king bed with a pillow top mattress. Huge overhead cabinets and a rear double door closet provide plenty of storage.





## 402BH Specifications

Shipping Weight	10,880
Carrying Capacity	2120
Hitch Weight	1185
Exterior Length	40' 11"
Exterior Width	8' 6"
Exterior Height	12' 9"
Fresh Water Capacity	70
Waste Water Capacity	34
Gray Water Capacity	68
LPG Capacity	60
Water Heater Capacity	16
Tire Size	235 80R16E

▶ The spacious living area in the 402BH has a large entertainment center, a full length air hide-a-bed sofa with an overhead storage cabinet, and a free standing dinette arrangement.

The 402 BH 2nd bedroom provides a queen island bed slide as well as an extra bunk above the wardrobe/entertainment center for additional sleeping space.



## 402BH

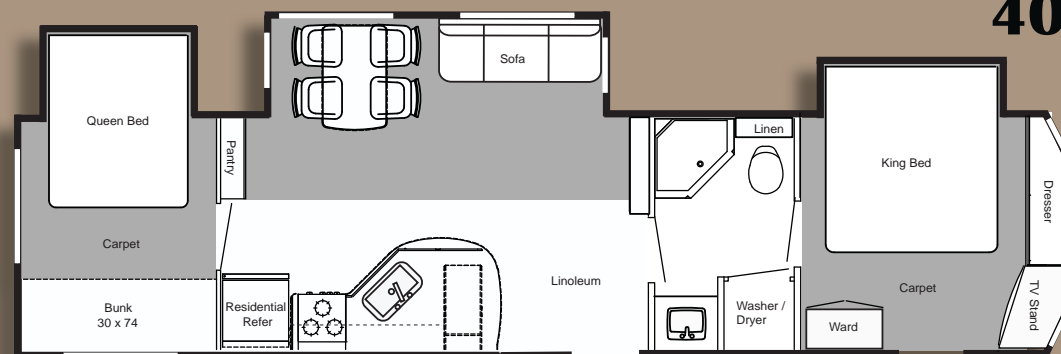



## APPLIANCES / EQUIPMENT

- 18 Cu. Ft. Residential Refrigerator\*\*\*
  - Three Burner, High Output Range with 22" Oven
  - 16 Gallon Gas/Electric Water Heater with DSI\*\*\*
  - 40,000 BTU Forced Air DSI Furnace with Thermostat
  - 100 Amp Power Converter
  - Range Hood with 12 Volt Light and Exhaust Fan
  - In Floor Rigid Heat Ducting
  - Fire Extinguisher
  - Smoke Detector
  - CO2 Detector
  - L.P. Detector
  - Hot Water Heater By-Pass
  - Dual 30 Lbs L.P. Bottles with /Auto Change Over\*\*\*
  - L.P. Bottle Cover
  - 4 Stabilizer Jacks
  - 15,000 BTU Ducted A/C\*\*\*
  - TV Antenna with Booster
  - Cable TV Hook-Up
  - Satellite TV Prep
  - Telephone Jack\*\*\*
  - Water Purifier\*\*\*
  - Space Maker Water System
- ### Bath Room
- Glass Shower Enclosure
  - Shower Surround
  - Power Vent with Remote
  - Skylight
  - Lighted Medicine Cabinet with Mirror
  - Linen Storage
  - Porcelain Stool with Foot Pedal
  - Toilet Paper Holder
  - Washer / Dryer Prep\*\*\*

## KITCHEN

- Raised Panel Upper Cabinets
- Extra Large Residential Sink
- Faucet with Pull Out Sink Sprayer
- Extra Large Overhead Cabinets
- Microwave\*\*\*
- Extra Large Picture Window at dinette
- Spice Rack built in under the kitchen Sink
- Systems Monitor Panel
- Extra Large Pantry
- Water Purifier\*\*\*

## LIVING ROOM

- Free Standing Table with 4 Chairs\*\*\*
- AM/FM/CD/DVD Player with Speakers\*\*\*
- Swivel Rockers (N/A on all Models)
- Residential Curtain Package with Day/Night Shades\*\*\*
- Living Room Ceiling Fan\*\*\*
- Air Hide-a-Bed Sofa\*\*\*
- Cable TV Hook Up
- Satellite Ready
- Extra Large Picture Windows in the Slide
- Extra Large Overhead Cabinets in Slide Room
- 60" Dual Pane Sliding Glass Door
- Residential Style 110 Volt Light Fixtures in the Slide Room
- Carpeting with Padding
- Residential Style Furniture
- Vertical Blinds at the Patio Door
- Wall Paper Border

\*\*\* Feature is Part of the Residential Package  
Floor Plans and specs are subject to change without notice.

## EXTERIOR

- XL Entry Swing Out Handle\*\*\*
- 50 Amp Electrical Service with Detachable Cord\*\*\*
- 16" Radial Tires
- Outside Speakers
- Black Tank Flush\*\*\*
- Rain Gutter
- Tinted Safety Glass Windows
- Radius Clamp Ring Windows
- Hose Carrier Bumper with End Caps
- Detachable Hitch
- Patio Awning\*\*\*
- Outdoor Activity Light\*\*\*

## MASTER BEDROOM

- 72" x 80" King Bed with Pillow Top Mattress\*\*\*
- Desk with Chair (Floor Plan Specific)
- Cable TV Hook Up
- Satellite Ready
- Overhead Cabinets in Bedroom Slide
- Bedroom Entry / Exit Door
- Bedspread
- TV Cabinet with Shelf

## CONSTRUCTION

- 12" Powder Coated I-Beam Frame
- 2" x 2" Sidewall Studs
- 2" x 3" Floor Joists
- 5/8" Floor Decking
- 102" Exterior Width
- 96" Interior Height
- 80" Slide Room Height
- One Piece Crowned Rubber Roof

## POPULAR OPTIONS

- Outside Shower
- Bedroom Ceiling Fan
- 2nd 13,500 BTU Air Conditioner
- Delete Patio Awning
- Spare Tire Kit
- 4 Stabilizer Jacks
- LCD TV (Floor Plan Specific)
- Fireplace
- Canadian Compliance

## RESIDENTIAL PACKAGE

- 18 Cu. Ft. Residential Refrigerator
- 16 Gallon Gas / Electric Water Heater
- Dual 30 Lbs. L.P. Bottles with Automatic Change Over
- 15,000 BTU Ducted Air Conditioner
- Telephone Jack
- Water Purifier
- Microwave
- Free Standing Table with 4 Chairs
- Washer / Dryer Prep
- AM/FM/CD/DVD Player with Speakers
- Residential Curtain Package with Day / Night Shades
- Living Room Ceiling Fan
- Air Hide-a-Bed Sofa
- 72" x 80" King Bed with Pillow Top Mattress
- XL Entry Assist Swing Out Handle
- 50 Amp Electrical Service with Detachable Cord
- Black Tank Flush
- Patio Awning
- Outdoor Activity Light

**RESIDENCE**  
BY APPOINTMENT

2642 Hackberry Dr  
Goshen, In 46526  
574-535-2100  
www.keystonerv.com

Product information is as accurate as possible as of the date of publication of this brochure. Features, floor Plans and specifications are subject to change without notice. Please also consult Keystone's website at [keystonerv.com](http://keystonerv.com) for more current product information. Tow Vehicle Disclaimer Caution: Owners of Keystone Recreational Vehicles are solely responsible for the selection and proper use of tow vehicles. All customers should consult with a motor vehicle manufacturer or their dealer concerning the purchase or proper use of suitable tow vehicles for Keystone products. Keystone disclaims any liability or damages suffered as result of the selection, operation, or misuse of a tow vehicle. KEYSTONE'S LIMITED WARRANTY DOES NOT COVER DAMAGES TO THE RECREATIONAL VEHICLE OR THE TOW VEHICLE AS RESULT OF THE SELECTION, OPERATION, USE OR MISUSE OF THE TOW VEHICLE. May 2009.