

**1790QB**

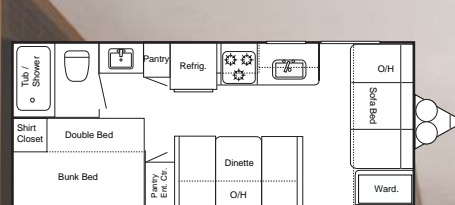

**1890FL**

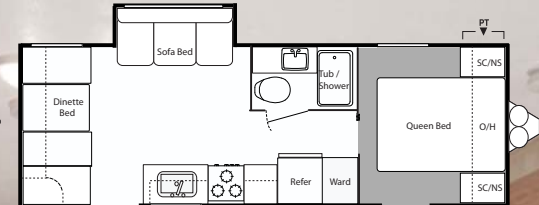

**2520RD**



**2560RL**

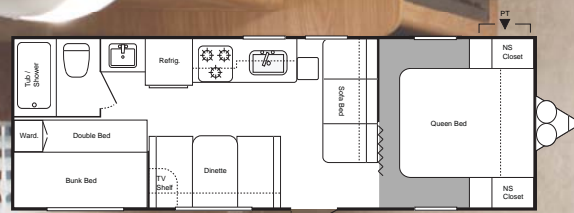

**2600TBL**

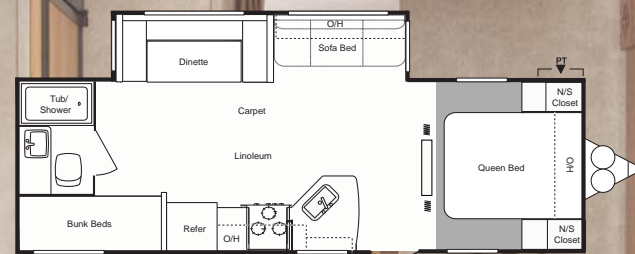

**2670BH-GS**

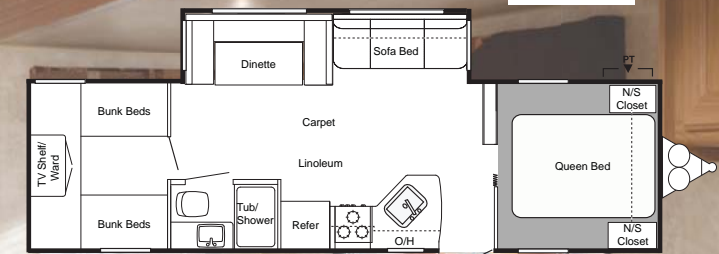

**2980BH-GS**

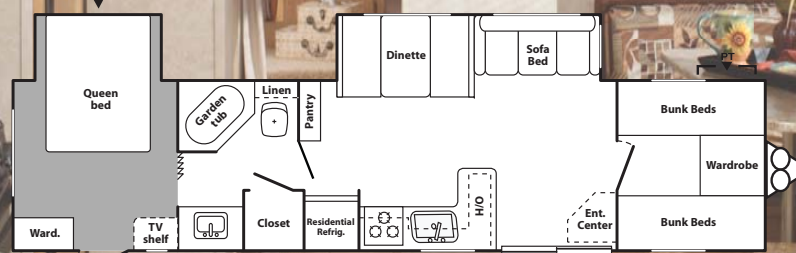

**3720BH**

**SUMMERLAND**  
by SPRINGDALE

**The Floor Plans You Want, The Features You Need, A Price you Won't Believe!**

Item	1790QB	1890FL	2520RD	2560RL	2600TB	2670BH-GS	2980BH-GS	3720BH
Shipping Weight	3940	4137	4835	4751	4778	5740	6375	7711
Carrying Capacity	2041	1873	2750	2864	2767	1905	3130	3279
Hitch Weight	490	410	585	615	545	645	705	830
Exterior Length	20' 10"	23' 7"	26' 11"	27' 11"	28' 10"	28' 11"	32' 7"	38' 6"
Ext Height - Top of AC	10' 6"	10' 6"	10' 6"	10' 6"	10' 6"	10' 11"	10' 11"	11' 3"
Fresh Water Capacity	50	50	50	50	50	50	50	50
Waste Water Capability	30	34	34	34	34	30	30	34
Gray Water Capacity	30	30	34	34	30	34	34	64

## Standards Appliances and Equipment

- Double Door Refrigerator
- 13.5 Btu Non-Ducted A/C (1790, 1890, 2560, 2600)
- 13.5 Btu Ducted A/C
- Three Burner, High Output Range with Oven
- Forced Air DSI Furnace with Thermostat
- 50 Gal. Fresh Water Capacity
- Under Floor Fresh Water System
- Range Hood with 12 Volt Light and Exhaust Fan
- In Floor Rigid Heat Ducting
- Fire Extinguisher
- Carbon Monoxide Detector
- L.P. Leak Detector
- Water Heater Bypass
- TV Antenna with Booster

## Interior

- Innerspring Mattress
- Bedspread
- 45" Wide Dinette Booth in all Slides
- Extra Large Over Head Cabinets
- Large Pedestal Dinette Tables
- Over Head Medicine Cabinet with Mirrored Door
- 12 Volt Power Bath Roof Exhaust Vent
- 2" x 3" Floor Joists with 5/8" Decking
- AM/FM/CD Player

## Kitchen

- Residential Kitchen Sink with Deep Basin
- High Spout Faucet in the Kitchen
- Extra Large Over Head Cabinets
- Spice Rack Storage Under the Sink
- Wall Mounted Systems Monitor Panel
- Microwave

## Exterior

- 8' Exterior Width
- Hose Carrier Bumper with End Caps
- Fiberglass Insulation
- Entry Assist Handle
- Radius Clamp Ring Windows
- Tinted Safety Glass
- Rubber Roof
- E-Z Open Entry Step
- Rain Gutters
- Patio Awning
- Radial Tires



**SUMMERLAND**  
by SPRINGDALE

The Floor Plans You Want,  
The Features You Need,  
A Price you Won't Believe!

## Options

- \* **Summer Package**
  - 6 Gal. Gas Water Heater with Direct Spark Ignition
  - 30# L.P. Bottles with Cover
  - Tub Surround
  - Cable TV Hook-Up
  - Exterior Shower
- \* Four Stabilizer Jacks
- \* Spare Tire
- \* CSA



2642 Hackberry Drive Goshen, Indiana 46526  
(574) 535-2100 [www.keystone-summerland.com](http://www.keystone-summerland.com)

Product information is as accurate as possible as of the date of publication of this brochure. Features, floor plans, and specifications are subject to change without notice. Please also consult Keystone's web site at [www.keystonerv.com](http://www.keystonerv.com) for more current product information and specifications. Tow Vehicle disclaimer. CAUTION: Owners of Keystone recreational vehicles are solely responsible for the selection and proper use of tow vehicles. All customers should consult with a motor vehicle manufacturer or their dealer concerning the purchase and use of suitable tow vehicles for Keystone products. Keystone disclaims any liability or damages suffered as a result of the selection, operation, use or misuse of a tow vehicle. KEYSTONE'S LIMITED WARRANTY DOES NOT COVER DAMAGE TO THE RECREATIONAL VEHICLE OR THE TOW VEHICLE AS A RESULT OF THE SELECTION, OPERATION, USE OR MISUSE OF THE TOW VEHICLE. June 2009.