

# Minnie Winnie®

## WINNEBAGO®

### Standard Minnie Winnie Features

**Driver's compartment:** — Ashtray — Beverage tray — Cigarette lighter — Inside rearview mirror — AM radio with 4-10. oz. speakers — Two sunvisors — Cab decor package (including carpet, door trim pads and carpeted motor cover)

**Chassis:** — Battery — Chrome front bumper — Painted rear bumper with sewer hose storage — V8 engine — RV tires (6) — Tire carrier and wheel

**Appliances:** — Forced air furnace with decorative grill — 4 burner range and "shorty oven" — Three way gas/electric refrigerator — Water heater — Non-power bath vent — Non-power stove vent

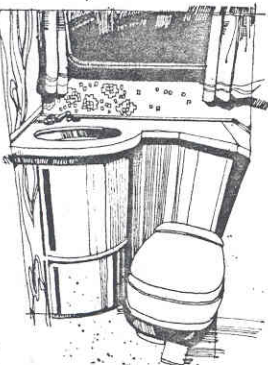

**Bath:** — Color coordinated lavatory, shower/tub, and marine toilet — Shower curtain and track — Flexible head shower — Solid door — Tissue holder — Towel bar — Mirror in bath

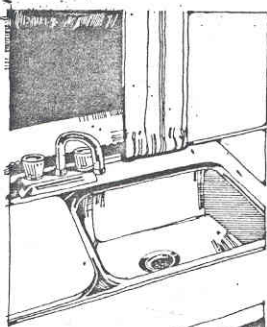

**Galley:** — Drawer to accommodate silverware tray — Double stainless steel sink with cover

**Convenience:** — Screen door — Sprung overhead door hinges and positive cabinet latches

**Exterior:** — Lighted recessed assist handle — Color coordinated stripe — Lockable gas fill and water fill — Painted rearview mirrors with convex — Sewage hose and storage — Retractable entrance step — Two inch sidewall construction with

steel inside lamination — Steel reinforced floor — Tinted windows all around — Awning Rail

**Utility:** — Demand water system — L.P. leak tester — Permanent mount L.P. tank with gauge

**Miscellaneous features:** — Fire extinguisher (2 B.C.) — Jack and tools

(Option for above line with size)

entrance step — 1.68 inch

### Minnie Winnie Options

	WD420RG	WD423RB	WD424RH
Automotive air conditioning	0	0	0
Cruise control	0	0	0
AM/FM MPLX Radio with 8 track	0	0	0
40 Channel CB radio with antenna*	0	0	0
Driver convenience group, battery gauge, high back bucket seats with armrest	0	0	0
California Emissions	0	0	0
440 cu. in. V8 Engine	0	0	0
Spare tire with cover (N/A with radials)	0	0	0
Radial tire (7)	0	0	0
Class I trailer hitch	0	0	0
Forced air furnace with electronic ignition (either 24,000 or 30,000 BTU)	0	0	0
Microwave oven	0	0	0
Refrigerator, 8 cu. ft. (7.0 a.g.a. rated), 3-way	N/A	0	0
Bath carpeting	N/A	S	S
Interior feature group: Monitor panel, power stove vent, power bath vent, medicine cabinet	0	0	0
Front wrap curtain/front bunk curtain	0	0	0
Room divider	N/A	N/A	0
Rear pedestal table	0	N/A	N/A
Galley extension	S	N/A	N/A
Vinyl floor	0	0	0

	WD420RG	WD423RB	WD424RH
Exterior trim group	0	0	0
110 V. exterior outlet*	N/A	S	S
Luggage rack and ladder	0	0	0
TV antenna with jack	0	0	0
Winnebago storage box	N/A	N/A	0
Winterization package	0	N/A	N/A
11,000 BTU roof air conditioner	0	0	0
13,500 BTU roof air conditioner	N/A	N/A	0
Second 105 amp deep cycle battery	0	0	0
Two maintenance free deep cycle batteries	0	0	0
Generator prep kit (includes louvered door, steel floor, insulation, wiring and gas line) (generator mounting tray not included)	0	0	0
3000 watt generator with hourmeter	0	0	N/A
4000 watt generator with hourmeter	N/A	N/A	0
Ground fault interrupter*	N/A	S	S
Heat element for roof air conditioning (13,500 BTU only)	N/A	N/A	0
21 gallon permanent mount L.P. tank with gauge	N/A	0	0
Canadian code	0	0	0
Export electrical conversion	0	0	0
Export prep option	0	0	0

0—Optional this model.

S—Standard this model, no extra cost.

\*N/A in Canada

NA—Not available this model.

# Minnie Winnie

## Optional Floor Plan Arrangements

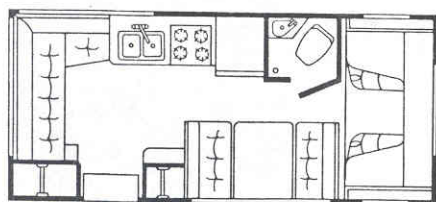

**20RG** 1.

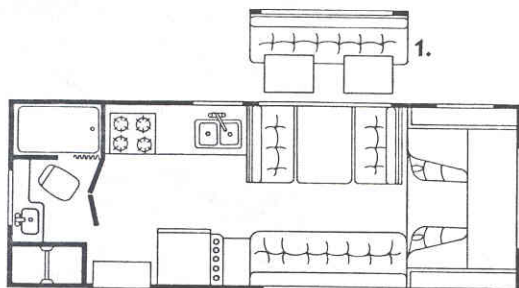

**23RB** 1. 2. 3.

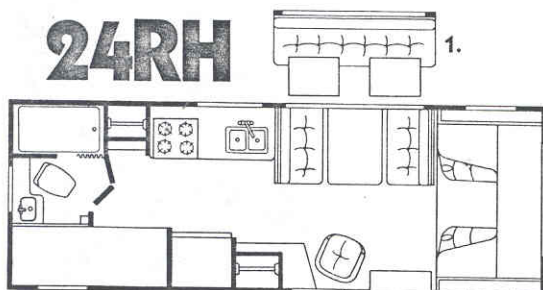

**24RH** 1.

### Minnie Winnie 20RG

Dinette Standard.

1. Convertible couch with tables to replace dinette.

### Minnie Winnie 23RB

Dinette Standard.

1. Convertible couch with tables to replace dinette. (This option must accompany one of the options on the right side to be available.)

Convertible Couch Standard.

2. Swivel chairs and table to replace convertible couch.
3. Lounge chairs and table to replace convertible couch.

### Minnie Winnie 24RH

Dinette Standard.

1. Convertible couch with tables to replace dinette.

You and your whole family can have a say in how the floor plan of your Winnebago is designed! We offer the modular plan with spacious floor plans available and help you select the floor plan right for you.

## SPECIFICATIONS

	WD420RG	WD423RB	WD424RH
Exterior height	111.25"	111.25"	111.25"
Exterior length	20'8"	22'11.5"	24'
Interior height	80"	80"	80"
Interior width	91"	91"	91"
Sleeping capacity (standard)	5	5	5
Sleeping capacity (Max. option)	6	5	6
GVWR	10,500	10,500	11,500
V8 engine (cu. in.)	360	360	360
Battery (amp.)	70	70	70

	WD420RG	WD423RB	WD424RH
Auxiliary battery (amp.)	105	105	105
Fuel capacity (gal.)	50	50	50
Fresh water capacity (gal.)	28	50	50
Holding tank (main)	16	38	38
Holding tank (aux.)	22	24	24
L.P. tank (gal.)	10	10	10
Furnace (BTU)	19,000	19,000	19,000
Refrigerator (cu. ft.)	6	6	6

Certain equipment and specifications may vary on units sold in Canada. Ask your dealer for specific details.

Winnebago's continuing program of product improvement makes specifications, equipment, model availability and prices subject to change without notice. Some items shown may be extra cost options.

**WINNEBAGO®**  
WINNEBAGO INDUSTRIES, INC.  
P.O. BOX 152, FOREST CITY, IOWA 50436