

SPECTRUM.  
To examine it is to explore the future.





# An evolutionary departure in flight engineering.

Times have changed. Today's motor home must be efficient enough to challenge the family car for economy. So trim and sleek that it's magic to drive. Spacious and livable inside. And enhanced with style and luxury throughout.

In the future, perhaps all motor homes will be built this way. But for the present, there is only one. Spectrum™ by Itasca.

---

**36% lighter  
than motor homes  
of the past.**

---

If there is one thing Spectrum lacks, it is unnecessary weight. Spectrum is engineered with the latest technology, the newest materials.

Incredibly, it possesses all the stability of a conventional 22-foot Itasca. Yet Spectrum is 3200 pounds lighter.

Spectrum utilizes specially designed aluminum extrusions. They create a strong, solid structure many times lighter than steel. Walls are a unique, lightweight lamination of wood, foam and aluminum with a high insulation value.

Ultra-light space-age materials have slashed the weight of cabinets, countertops, doors, the dinette and other interior components.

Overall, this remarkable 36% reduction in weight is accomplished without loss of quality, integrity or style.

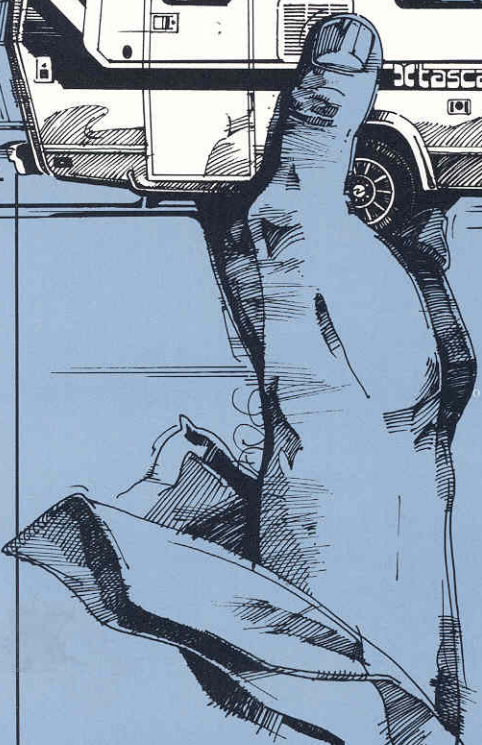

---

**Sleek  
and slippery  
in the wind.**

---

The motor homes of the past waste most of their fuel just pushing air out of the way.

But Spectrum is a breakthrough in air travel. With its low, wedge-shaped front end, Spectrum slips smoothly through the wind. Decreasing drag. Increasing mileage. And presenting an aerodynamic silhouette that performs admirably on the open highway.

---

**Unrivalled mileage.**

---

Consider what you've read above. The new technology. Dramatic weight loss. Advanced engineering.

Aerodynamic breakthrough.

Together they've had one purpose. To make Spectrum the most efficient motor home in America.

That goal has been accomplished. Spectrum squeezes an unexpected number of miles out of every gallon of regular gas.

In fact, dollar for dollar, Spectrum is so close to the economy of the family car, you'll be able to take it wherever you go.

---

**Balanced like a fine car.**

---

Very few of the world's automobiles have a 50-50 weight distribution. Yet Spectrum achieves it. Front to back. Side to side.

This near-perfect balance makes Spectrum the most maneuverable motor home you've ever driven. In handling and agile response, Spectrum far more resembles a car than a motor home.

# SPECT

Itasca®

A clear c



# A revolutionary departure in space technology.

## A new chassis from Chevrolet.

Thanks to its greatly reduced weight, Spectrum rides on a lighter, more efficient chassis. It's still heavy duty. Just not heavyweight.

This new chassis cuts rolling resistance and reduces weight even further by using single rear wheels rather than duals.

Dual rear wheels merely support excessive weight. Spectrum's single rear wheels are just as stable and surefooted, yet achieve

more mpg's, better handling, superior traction.

Rubber mounts isolate Spectrum's body. So inside you're not disturbed by chassis or road noise.

## Leader in the space race.

Nothing so efficient outside has ever been so luxuriously livable inside. Everywhere you look, you'll see the unmistakable mark of style, quality and luxury which separates an Itasca from the rest of the pack.

Stretch out. You'll find full stand-up headroom everywhere. At the side entry door. In the richly

furnished galley. Even in the dry bath, where storage space, towel bars and the medicine chest are molded right into the walls and door.

Spectrum has plenty of sleeping space for a family of 4. The dinette bed is actually wider than the one on Itasca's most expensive motor home.

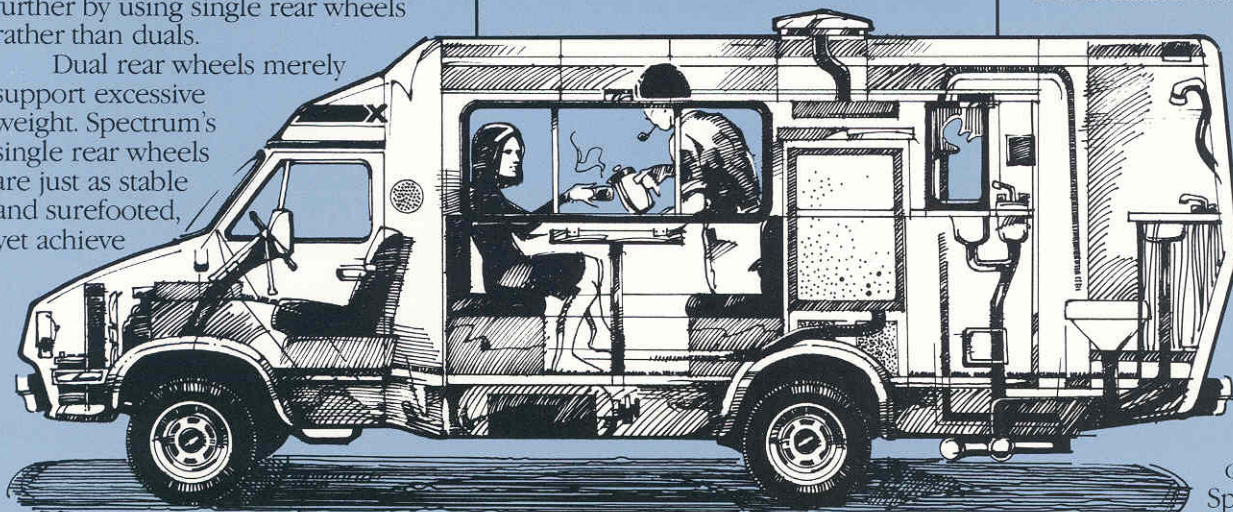

even the inside of the wardrobe closet.

## A visible difference for the driver.

The cab of a Spectrum is distinctly pleasing.

Sliding pedestal seats give the driver added room. As does the tilt steering wheel.

But the real advance is in visibility. Spectrum gives you a wide open view of those wide open spaces.

Impressive, too, is the instrument panel.

## Dropped upside down for safety.

Before it came on the market, Spectrum underwent perhaps the most startling safety test in the industry. Itasca's drop test.

Weighted to simulate fully loaded conditions, Spectrum was hoisted into the air. Then dropped upside down onto a concrete floor.

Inspectors carefully measured the vehicle's condition. Doors remained operable. Windows were unbroken. Potentially dangerous appliances remained in place. The roof, compressing only a few inches, had absorbed the shock.

Spectrum passed.

Spectrum also passed such vital tests as fuel integrity, body integrity and flammability. And, of course, Itasca's durability test for overall performance and dependability of the finished product.

## A clear departure from the past.

Travel in the future. Depart in the motor home that sets new standards of efficiency, engineering, handling and luxurious livability.

Spectrum. Clearly the motor home of the future.

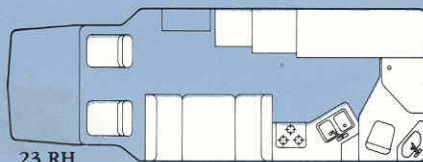

23 RH

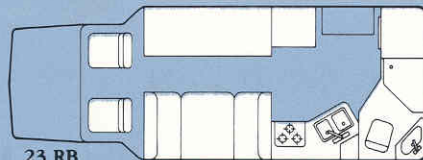

23 RB

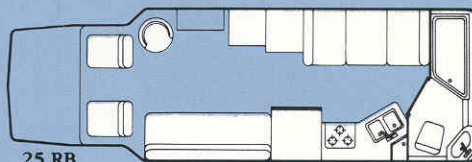

25 RB

Available in Fall of 1981.

An optional pull down bunk and convertible Youth Bed are also available.

## That plush interior is washable.

Spectrum's total efficiency extends to interior maintenance as well. Nearly all interior surfaces are completely washable; including countertops, cabinets, walls, ceilings,

**SPECTRUM**  
departure.



# SPECTRUM.

## A clear departure.

SPECIFICATIONS	23RB/RH	25RB
Curb weight (lbs.-dry)	5835	NA
Exterior length	22' 1"	24' 7"
Exterior height (w/o roof air)	106.6"	106.6"
Interior height	75"	75"
Exterior width	91.3"	91.3"
Interior width	88"	88"
Chevy V-8 engine	350 cu. in.	350 cu. in.
3-Speed automatic transmission	STD	STD
Battery (amp.-hr.)	50	50
Fuel capacity (gal.)	40	40
Fresh water (gal.)	24	24
Holding tank (gal.)	20	20
Sgl. LP tank (lb.)	28	28
Sleeping capacity		
Standard	4	3
Optional	5	5
Wheelbase	133"	157"



EQUIPMENT	23RB/RH	25RB*
Tilt steering wheel	STD	STD
Low-back cab seats w/ slide-swivel pedestal	STD	STD
Full tinted windows	STD	STD
3-Burner range w/shorty oven	STD	STD
4½ Gal. water heater	STD	STD
Furnace	19,000 BTU w/manual ignition	24,000 BTU w/elec. ignition
3-Way refrigerator	4 cu. ft.	6 cu. ft.
3,000 Watt generator w/ 13,500 BTU roof air	OPT	OPT
Roof air heat element	OPT	OPT
Dual Fuel	OPT	OPT
Traveler's Protection Plan	OPT	OPT
AM/FM Radio w/8-track	OPT	OPT
AM/FM Radio w/cassette	OPT	OPT
Cruise control	OPT	OPT
TV Antenna w/jack	OPT	OPT
Youth bed	OPT	OPT
Hi-back reclining cab seats w/slide-swivel pedestal	OPT	OPT

\*Available in Fall of 1981.

Itasca's continuing program of product improvement makes specifications, equipment, model availability and prices subject to change without notice. Some items shown may be extra cost options.

# Itasca

WINNEBAGO INDUSTRIES, INC.

Forest City, Iowa 50436

Printed in U.S.A. Copyright 1981