

The Future Of
Motor Homing Has Never
Looked This Good.



Elandan. The Only Thing It Shares With The Competition Is The Road.

Winnebago® proudly introduces a new breed of motor home. The Elandan®.

Totally new in all respects. Full sized for comfort and liveability. Loaded with the newest advances in technology and the brightest ideas in interior design.

The new Elandan is styled with classic good looks that set it clearly and cleanly apart from everything else



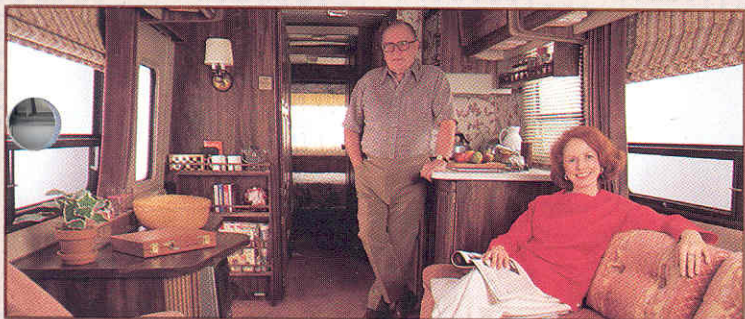

on the road. Its beauty begins with the dramatic sweep of its front end.

Not surprisingly, the bold 40-degree slant of the Elandan windshield is as

much a part of its efficient performance as of its striking good looks.

STRIKING AND EFFICIENT

With its smooth, curved fiberglass sidewalls and crowned roof, the Elandan slices through the air precisely.

Even such minor items as bumpers, rocker panels and side mirrors have been

designed and molded by the dictates of aerodynamic excellence.

As a result, the Elandan is responsive and nimble beyond its size; a pleasure to drive.

Since this is Winnebago's new flagship, you would expect the interior to be plush. And it is. Indeed, the Elandan challenges the world's most expensive motor homes for comfort and style.

A VAST, PANORAMIC VIEW SURROUNDS YOU

The first thing you'll notice inside the Elandan is the light. Huge tinted windows make every living area seem larger than life. And bathe you with fresh air ventilation from all sides.

This vast expanse of windows, and the views they bring you, are unrivaled by anything else on wheels. But when the sun goes down and the lights come up, you'll appreciate a living environment that's both spacious and distinctive.

Rich woods and fabrics add to the Elandan's look and feel of luxury. Cabinets are solid oak. The carpeting has the added touch of a thick, separate pad. Couches and chairs are invitingly soft.

Up front, you'll discover an amazing innovation. Two doors. No other manufacturer offers a Class A motor home with two front doors. Nor can any other manufacturer match our doors' automotive design.

In fact, due to its sophisticated engineering, the Elandan is designed and built beyond the capabilities of all other motor home manufacturers. Only Winnebago, with 25 years of innovation and industry leadership, has the manufacturing technology needed to build a motor home this exceptional, this advanced.



Inside And Out, The Most Exceptional Winnebago Ever Built.

Nothing we can say about the Elandan is as impressive as the vehicle itself.

Everything looks right. Everything feels right. Right down to the smallest detail, everything about the Elandan seems to have been planned and executed by people

who know exactly what you want in a motor home.

THE LURE OF THE ELANDAN.

Step inside. If you were ever to design and build your own motor home, it might look like this. Roomy. Private. Plenty of storage. And

everywhere you look, special touches that make every inch of space work overtime.

Surprisingly, you'll find that even the cab is spacious. We redesigned the motor cover to give you noticeably more room and to make it easier to get in and

out of the front seats.

The dashboard is a new design as well. It's automotive in styling, beautiful in function. Exclusively Elandan. With a thoughtfully considered layout that makes all the information you need easy to find and easy to read.

The instrument panel is designed for serviceability. A portion of the padded dashboard removes for easy access to all instrumentation.

Even the defroster vents are improved. Rather than simply being bolted on as in other motor homes, the Elandan has strategically positioned vents molded into the dashboard and each front door to defrost all cab windows efficiently.

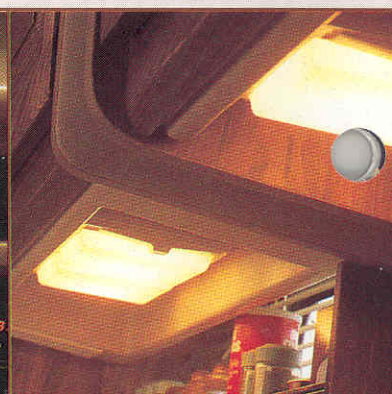

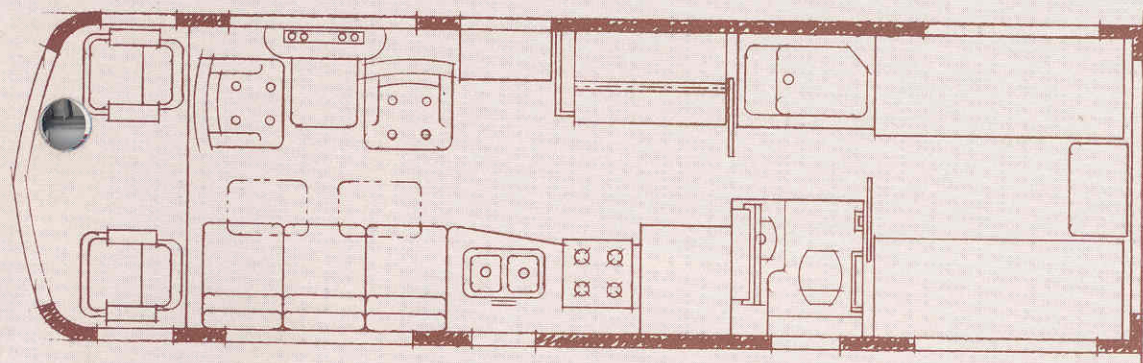

IT'S TIME CO-PILOTS GOT A DOOR OF THEIR OWN.

Lots of motor homes have an optional cab door. But only for the driver. The Elandan offers two front doors — each with a sliding window, courtesy lights, and a steel door well, with built in step and slide-out battery tray.

Typical of the Elandan's superior construction, these are not typical motor home doors. They close easily, seal tight, and have the solid automotive feel of their steel framing.

There are a few other unique features in the cab. The windshield wipers were especially designed and

built for the Elandan.

The result is a solidly constructed pantograph wiper system that cleans more windshield than ordinary wipers.

Other cab conveniences include a secure interior hood release, multi-adjustable sunvisors, an AM/FM/cassette tape player and stereo sound

system, tilt steering wheel and map light.

There's also an ambient temperature gauge — it's a handy little device that tells you the temperature inside and outside. With a digital readout, of course.

As impressive as the cab may be, we think you'll agree that the living areas have been thought out just as carefully.

Lighting is recessed beneath the overhead cabinets for a clean, uncluttered look. Drapes, too, are integrated beneath the cabinetry.

Even the optional pull-down bunk is integrated into the ceiling design so that it practically disappears when not in use.





10 SCREENED WINDOWS, 5 VENTS AND 1 SCREEN DOOR.

All but three of the windows in the Elandan—the windshield, the rear window and the one in the entrance door—open to give you a breath of fresh air. The four large coach windows

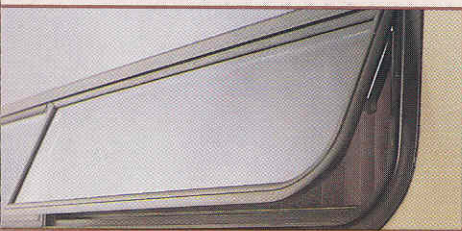

have screened, tilt out sections which you can even leave open in the rain.

In the evenings, handsome drapes and woven wood shades seal in your privacy and enhance that special, cozy feeling which rewards every motor homer at the end of the day.

Each living area also

has a ceiling vent. Except the galley, which has two.

One of those galley vents is a trim, almond range hood. It matches perfectly the almond top on the 4-burner range and is a handsome accent to the entire decor.

The refrigerator has double doors for cooling efficiency and electronic controls for easier 3-way operation.

A roll-out pantry puts supplies at your fingertips while it multiplies your storage space. Its rubber-clad shelves eliminate the shakes and rattles while you're rolling.

The Elandan also has an optional microwave oven, central vacuum cleaner and entertainment center with automatic ice maker.

TRAVEL FIRST CLASS.

As you would expect at the top of the line, the Elandan offers first class comfort. The couch, for instance, is not

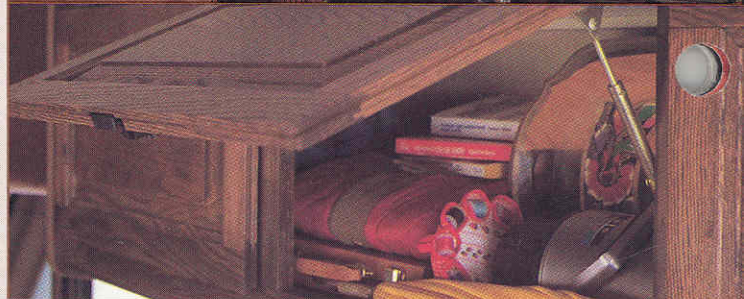
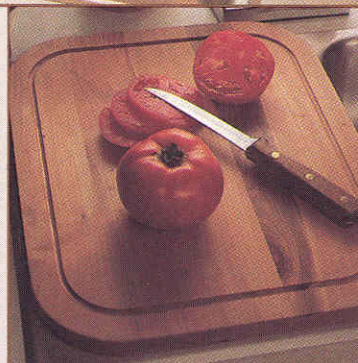



an ordinary couch. It's a Flexsteel® MagicBed. If you've ever slept on a normal sprung couch, this one will surprise you.

Of course, we were just as careful in choosing the bedroom mattress. It's a Sealy Posturepedic®. The very best they make.

But the nicest features of the bedroom are still the three large windows. They turn the room into a sunroom. Curtains, shades and sheers, tucked neatly under a padded valance, offer all the privacy you need.

Bathroom privacy is provided by sliding doors that separate this area from the bedroom and galley.

Wood framed mirrors and brass-tone faucets and towel bars give the bathroom a luxurious look. For extra convenience, we added a removable clothes rod to the

shower for drip drying or for temporary clothes storage.

The tub/shower deserves a special mention. The walls and ceiling are molded from a single piece of plastic. The resulting enclosure is strong, durable and leak free. It comes complete with a skylight.

It's one more example of the creative thinking and sophisticated manufacturing techniques that make the Elandan so innovative inside and out.

OUTSIDE, IT'S WHAT YOU DON'T SEE.

You won't find a corner seam on the front of the Elandan. Or any exposed body rivets or fasteners. Or a bumpy, pebbled surface. For good reason.

The Elandan is designed to slice through the air smoothly, cleanly. The aerodynamics of the vehicle

involve far more than just the dramatic 40-degree rake of its front end.

Rather, it's a combination of reduced frontal area, rounded sidewalls, wrap-around bumpers, sculptured rocker panels and integrated side mirrors. Together they cut wind resistance and give you superior aerodynamic performance.

The sculptured lines of the Elandan flow right into the rear cap. Molded from one piece of fiberglass, it incorporates built-in spare tire and sewer hose compartments.

There are plenty of other exterior storage compartments. All are seamless, tightly sealed and made of tough plastic. With doors that prop open to free your hands. There are lights in all the luggage compartments and a porch light beside the door.



THE MOST ADVANCED MANUFACTURING FACILITY IN THE INDUSTRY.

The Elandan is an exciting improvement in motor home design. And it can't be copied by any other manufacturer. For only Winnebago Industries has the advanced technology needed to build a vehicle of this scope.

Under its 57 acres of

roof, the Winnebago Industries facility is a marvel of ultra-sophisticated manufacturing capabilities and advanced computer technology.

Our 1,000 foot, conveyor-fed assembly lines are miles ahead of the competition.

Specialized computers help us design our motor homes. Still other computers analyze those designs for

strength and balance.

Steel parts for the cab of the Elandan are dipped in a series of 22,000 gallon tanks. They are cleansed with acid, rustproofed with iron phosphate, and primed with paint bonded into every seam and curve by a 400-volt electrical charge.

WHEN IT COMES TO QUALITY AND SAFETY, WE DROP EVERYTHING.

The Elandan has passed countless tests with flying colors.

On the assembly line, professional inspectors check all aspects of craftsmanship, fit, finish, and final results.

But the testing actually began long before the Elandan reached the assembly line.

It began with the most dramatic test of them all — and possibly the most important — the famous Winnebago drop test.

We took a real Elandan, loaded it to 12,800 lbs. (the design wet curb weight of the unit), and dropped it 36" onto solid concrete.

Not a single window broke. Or even cracked. All three doors remained closed — but opened easily for emergency exit. All appliances and cabinets stayed safely in place.

According to Winnebago's Testing Laboratory Supervisor, "It was the most impressive drop test we've ever run."

After the drop test came the accelerated endurance test. A prototype Elandan proved itself in a demanding trial that subjected it to thousands of miles worth of bumps, swerves, stops, screeching turns and assorted wear and tear.

The Winnebago drop test and endurance test show our commitment to

making each of our motor homes as safe and dependable as possible.

And they demonstrate the uncompromising standards of quality and performance which make the Elandan the most exceptional Winnebago ever built.

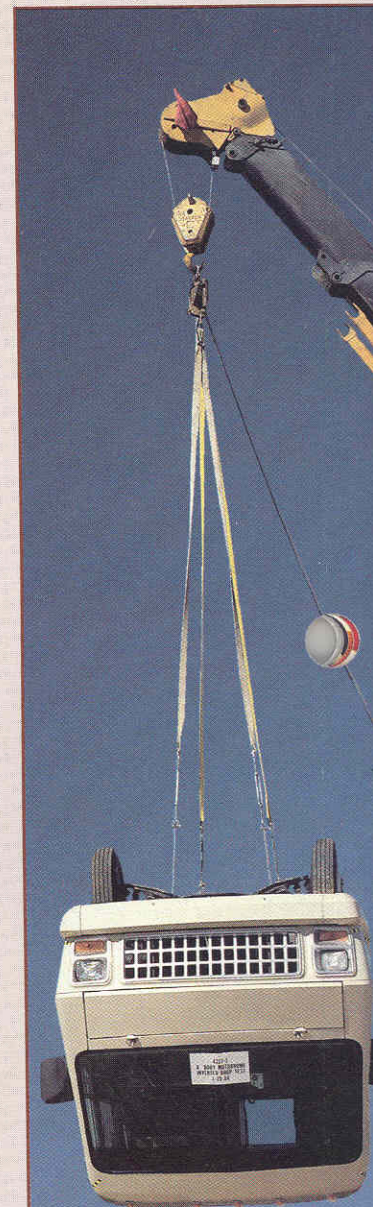

Elandan. Compare It To Other Motor Homes. No Competition.

The best way to fully appreciate the new Elandan is to compare it to other motor homes. Not from a distance, but close up. Side by side.

We've done just that. On the next three pages, we've taken a head-to-head look at some typical motor

home features.

On the left is the Elandan. On the right, an example of other brands. As you'll see for yourself, the differences between the Elandan and other motor homes are quite obvious.

Of course, these nine examples don't tell the whole story. They're just the beginning. But they may convince you to look at motor homes a little differently. A little more closely.

When you do, we know the Elandan will come out on top.

WINNEBAGO ELANDAN CROSSCOUNTRY

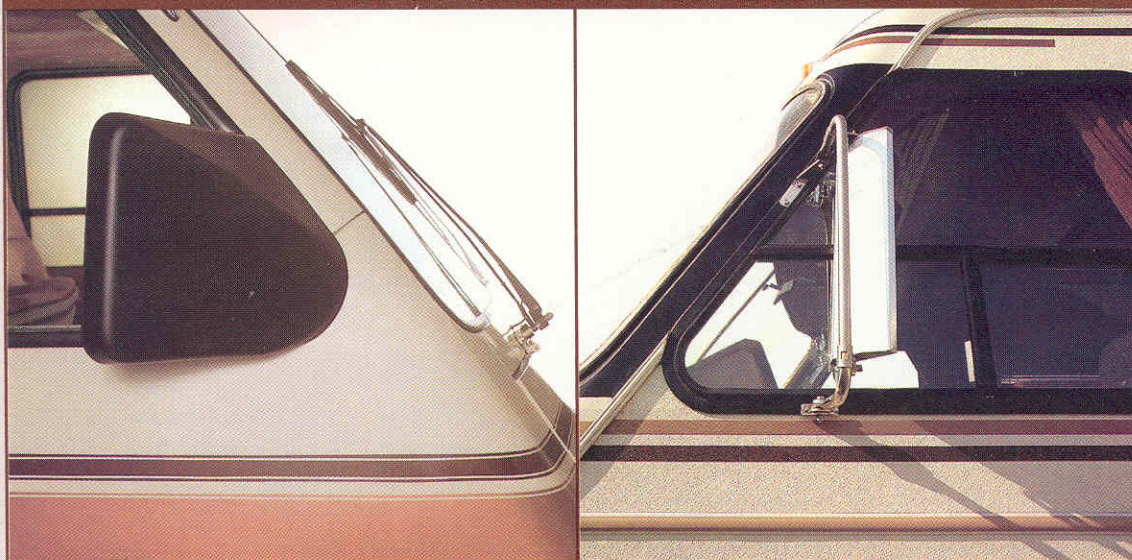

1. The Elandan front end is smooth, rounded, with aerodynamic side mirrors. In vivid contrast, the Cross-Country has protruding corner seams, bolt-on mirrors and a patchwork of both pebbled and smooth fiberglass.

WINNEBAGO ELANDAN PACE ARROW 454SG

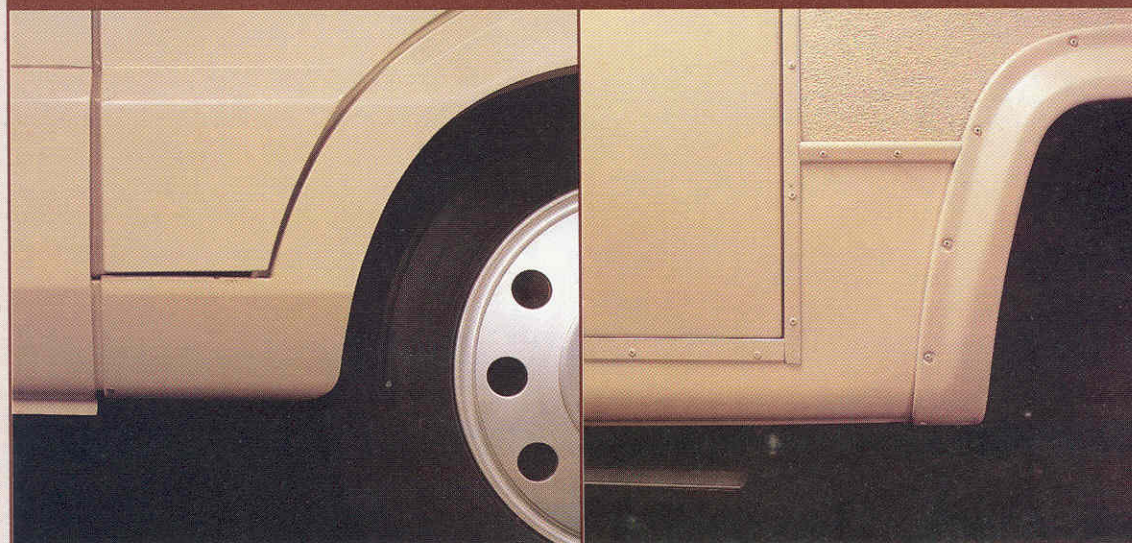

2. The Elandan has a smooth, sculptured fiberglass sidewall. Wheel lips and rocker panels flow together as integrated units. On the Pace Arrow, exposed rivets and fasteners reveal a less modern assembly technique.

Elandan. Compare It To Other Motor Homes. No Competition.

(CONTINUED)

WINNEBAGO ELANDAN

PACE ARROW 454SG



WINNEBAGO ELANDAN

PACE ARROW 454SG

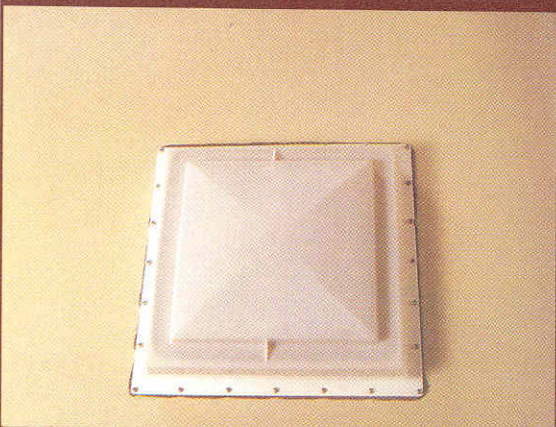

WINNEBAGO ELANDAN

SPORTSCOACH

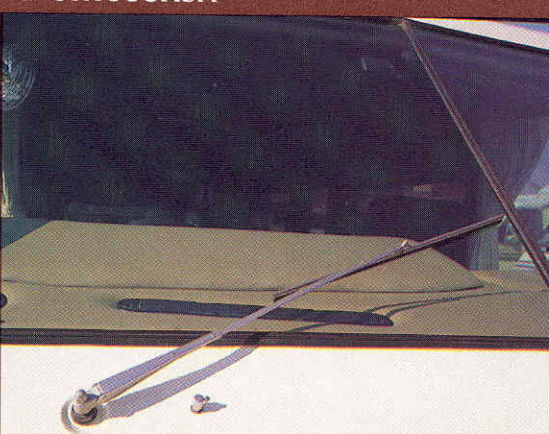
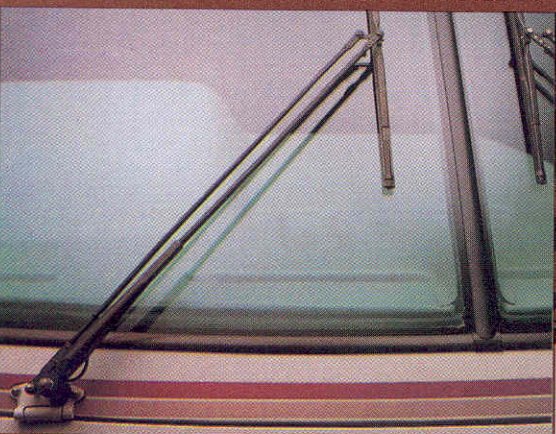

3. The Elandan is full sized. The Pace Arrow has a shorter ceiling, smaller dinette, less floor space and lower counter tops that can be a real pain in the back to use.

4. Some manufacturers think "what you don't know won't hurt you." But we build in quality even where you'll never see it. Like inside the walls, under the floor and on the roof. The Elandan roof is strong, well-sealed and durable. The Pace Arrow. It speaks for itself.

5. The windshield wiper system on the Elandan was specially designed and built for the Elandan. Its articulated, pantograph system is mounted in the steel substructure to minimize the effects of torque and vibration. The more expensive Sportcoach, like many other brands, merely attaches the wipers to the fiberglass front.

6. The Elandan instrument panel is clean and uncluttered. Even a removable beverage tray is integrated into the design. The Elandan driver's compartment matches, and perhaps even surpasses, the far more expensive Sportscoach.

7. No comparison here. The Elandan has two cab doors. No other manufacturer, regardless of price, gives you a Class A with that option. The Pace Arrow doesn't even offer one front door. More importantly, ours are solid, steel-framed, automotive-styled doors — not simply modified sidewall sections.

8. Pull off the molding strips, and you'll discover two ways to install a windshield. The Elandan windshield is framed in steel, and secured by the same adhesives and sealants used by auto makers. Pace Arrow uses a rubber molding to mount the windshield onto the fiberglass.

9. The rear bumper doesn't really affect performance. But the Elandan clearly looks better. And its integrated styling means that signal lights are built in, not bolted on — as on the Pace Arrow.

Photos portray competitive units available during December 1983 and January 1984. Competitive features may have changed subsequent to printing of this brochure.

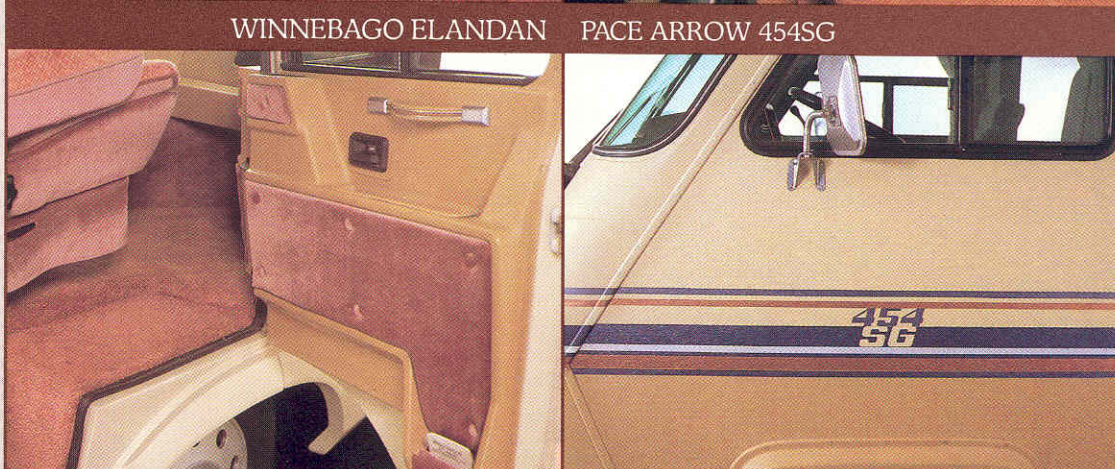

Elandan. Designed And Built Beyond The Capabilities Of Any Other Manufacturer.

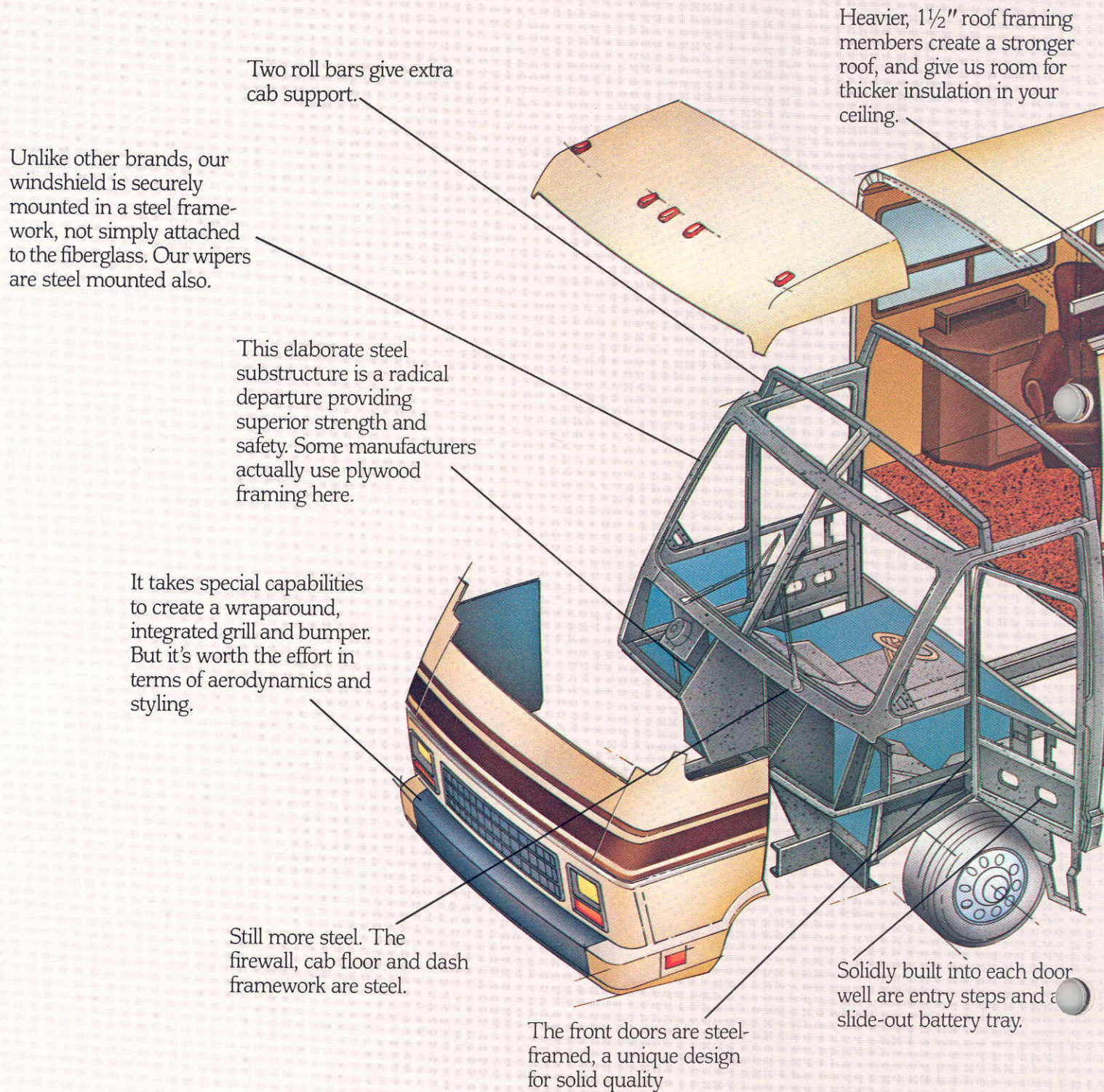

Two roll bars give extra cab support.

Unlike other brands, our windshield is securely mounted in a steel frame-work, not simply attached to the fiberglass. Our wipers are steel mounted also.

This elaborate steel substructure is a radical departure providing superior strength and safety. Some manufacturers actually use plywood framing here.

It takes special capabilities to create a wraparound, integrated grill and bumper. But it's worth the effort in terms of aerodynamics and styling.

Still more steel. The firewall, cab floor and dash framework are steel.

The front doors are steel-framed, a unique design for solid quality

Heavier, 1½" roof framing members create a stronger roof, and give us room for thicker insulation in your ceiling.

Solidly built into each door well are entry steps and a slide-out battery tray.

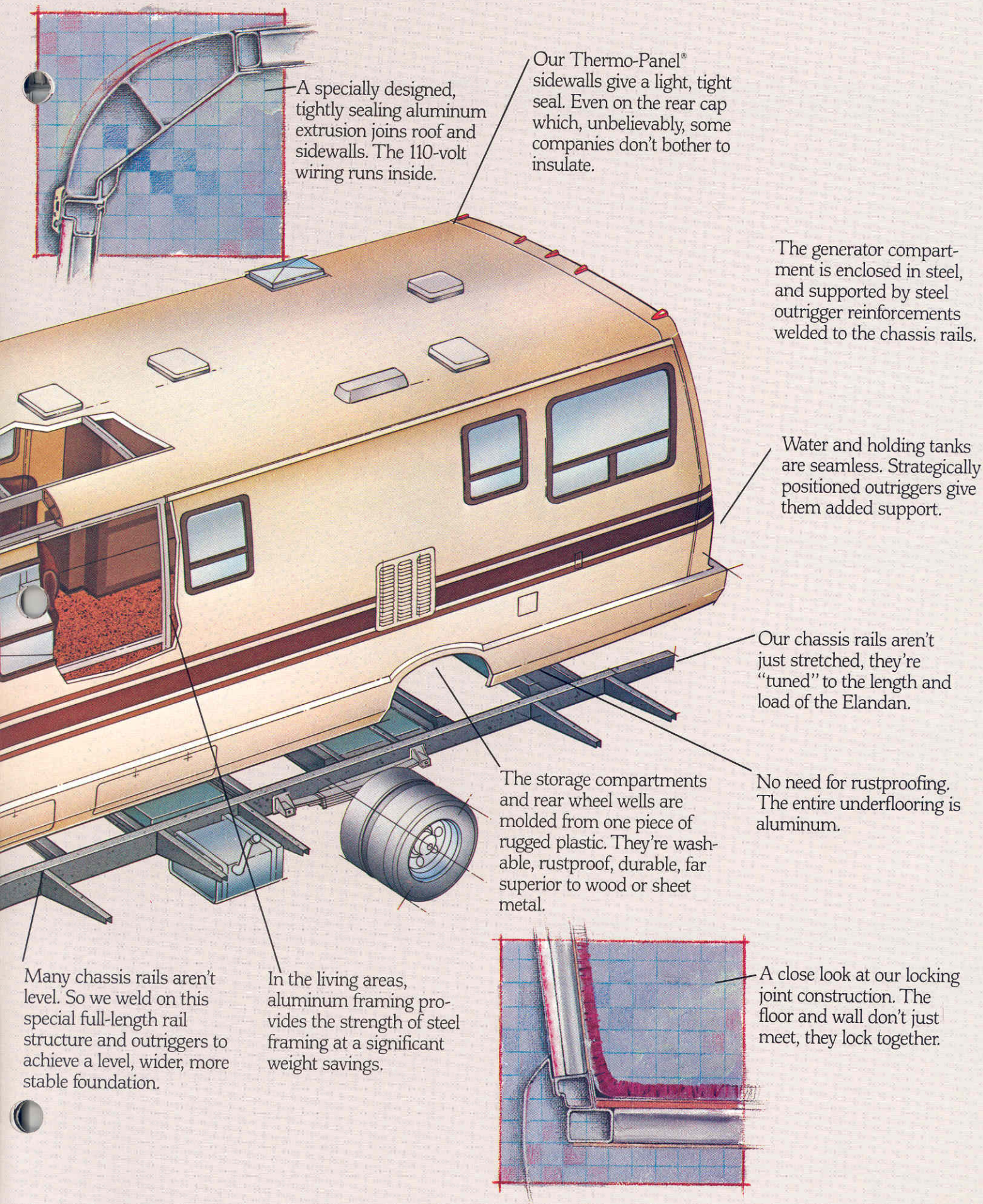

A specially designed, tightly sealing aluminum extrusion joins roof and sidewalls. The 110-volt wiring runs inside.

Our Thermo-Panel® sidewalls give a light, tight seal. Even on the rear cap which, unbelievably, some companies don't bother to insulate.

The generator compartment is enclosed in steel, and supported by steel outrigger reinforcements welded to the chassis rails.

Water and holding tanks are seamless. Strategically positioned outriggers give them added support.

Our chassis rails aren't just stretched, they're "tuned" to the length and load of the Elandan.

The storage compartments and rear wheel wells are molded from one piece of rugged plastic. They're washable, rustproof, durable, far superior to wood or sheet metal.

No need for rustproofing. The entire underflooring is aluminum.

Many chassis rails aren't level. So we weld on this special full-length rail structure and outriggers to achieve a level, wider, more stable foundation.

In the living areas, aluminum framing provides the strength of steel framing at a significant weight savings.

A close look at our locking joint construction. The floor and wall don't just meet, they lock together.

DRIVER CONVENIENCES

Standard Equipment	Optional Equipment
AM/FM Cassette Stereo with 4 speakers	Electronic-Tune AM/FM/ Cassette Stereo with 5-Band Equalizer, 4 Speakers
Power Steering	Sport Steering wheel
Tilt Steering	Automotive Air Conditioning
Interior/Exterior Temperature Gauge	Cruise Control
Emergency Start Solenoid	Chrome Airhorns
Interior Hood Release	
Intermittent Pantograph Wiper System	
Transmission Cooler	
All Windows Tinted	
45 Amp. Converter/ Battery Charger with Exterior Power Cord	

INTERIOR APPOINTMENTS

Standard Equipment	Optional Equipment
Swivel Lounge Chairs with Fold-up Table	Dinette (Replaces Swivel Chairs)
Flexsteel MagicBed/Couch	Front Pull-Down Bunk, Single
Bedspreads & Pillow Sham	Double Bed (Replaces Twin Beds)
Blackout Curtain	Rear Horseshoe Lounge (Replaces Twin Beds)
Full Carpeting	Entertainment Center with Ice Maker**
Floor Courtesy Lights	Automatic Ice Maker/ Cabinet**
Automatic Wardrobe Light	Powered Entrance Door Step
Clothes Hamper with Laundry Bag	Central Vacuum Cleaner
Medicine Cabinet with Framed Mirror	
Magazine Rack	
Smoke Detector	
Screen Door	

**Not available in Canada

SYSTEMS & ACCESSORIES

Standard Equipment	Optional Equipment
Water Heater with Electronic Ignition	Motoraid Water Heater with Rear Automotive Heater
34,000 BTU Forced Air Furnace with Electronic Ignition	13,500 BTU Roof Air Conditioner
5-B.C. Fire Extinguisher	4 kw, 4.5 kw, 6 kw or 7.5 kw Generator
LP Leak Detector	Second 13,500 BTU Roof Air Conditioner (with 6 kw or 7.5 kw Generator only)
Locking Fuel and Water Doors	Luggage Rack and Ladder
	Roof Storage Box
	Stylized Aluminum Wheels
	Radial Tires

GALLEY FURNISHINGS

Standard Equipment	Optional Equipment
4-Burner Range with Large Oven	Electronic Touch Control Microwave Oven
Powered Range Hood	Large Double Door Refrigerator with Electronic Ignition
Double Door 3-Way Refrigerator with Electronic Ignition	
Deluxe Monitor Panel with Digital Clock	
Spice Rack	
Trash Container	
Roll-Out Pantry	

THE ONLY WAY TO IMPROVE YOUR NEW ELANDAN.

Join the club. The Winnebago International Travelers Club. W.I.T. is your ticket to good times and lasting friendships.

You'll enjoy rallies and caravans with other Winnebago owners all across the continent. You'll meet new friends and greet old ones everywhere you go. And you'll have more

fun motor homing than you ever thought possible.

Yet the camaraderie is just the beginning. As a member of W.I.T., you'll also receive a variety of special services

and money-saving discount opportunities.

For the best in motor homing, buy an Elandan and join the club.

Elandan 31RT.

SPECIFICATIONS*

Length (Bumper to Bumper)	31'9½"	Fresh Water Capacity (with Heater)	60 Gal.
Exterior Height — at GVWR without Roof Air:	112"	Holding Tank Capacity	
with Roof Air:	119.5"	Sewage	40 Gal.
Interior Height	77"	Waste Water	44 Gal.
Exterior Width (Wheel Lip to Wheel Lip)	95.75"	LP Gas	80 Lbs.
Interior Width	91"	Sleeping Capacity	4 STD/6 OPT
Tires	8.00 x 19.5	GVWR	14,500 Lbs.
Automotive Battery	80 Amp.	Wheelbase	190"
Two Auxiliary Batteries	90 Amp. Deep Cycle Die-Hard®	Engine	Chevrolet 454 CID V-8
Fuel Capacity	60 Gal. STD/ 90 Gal. OPT	Fiberglass Sidewall	Thermo-Panel® with Smooth Fiberglass Skin
		Crown Roof	Thermo-Panel with Smooth Aluminum Skin

*Some measurements and capacities approximated at time of publication.

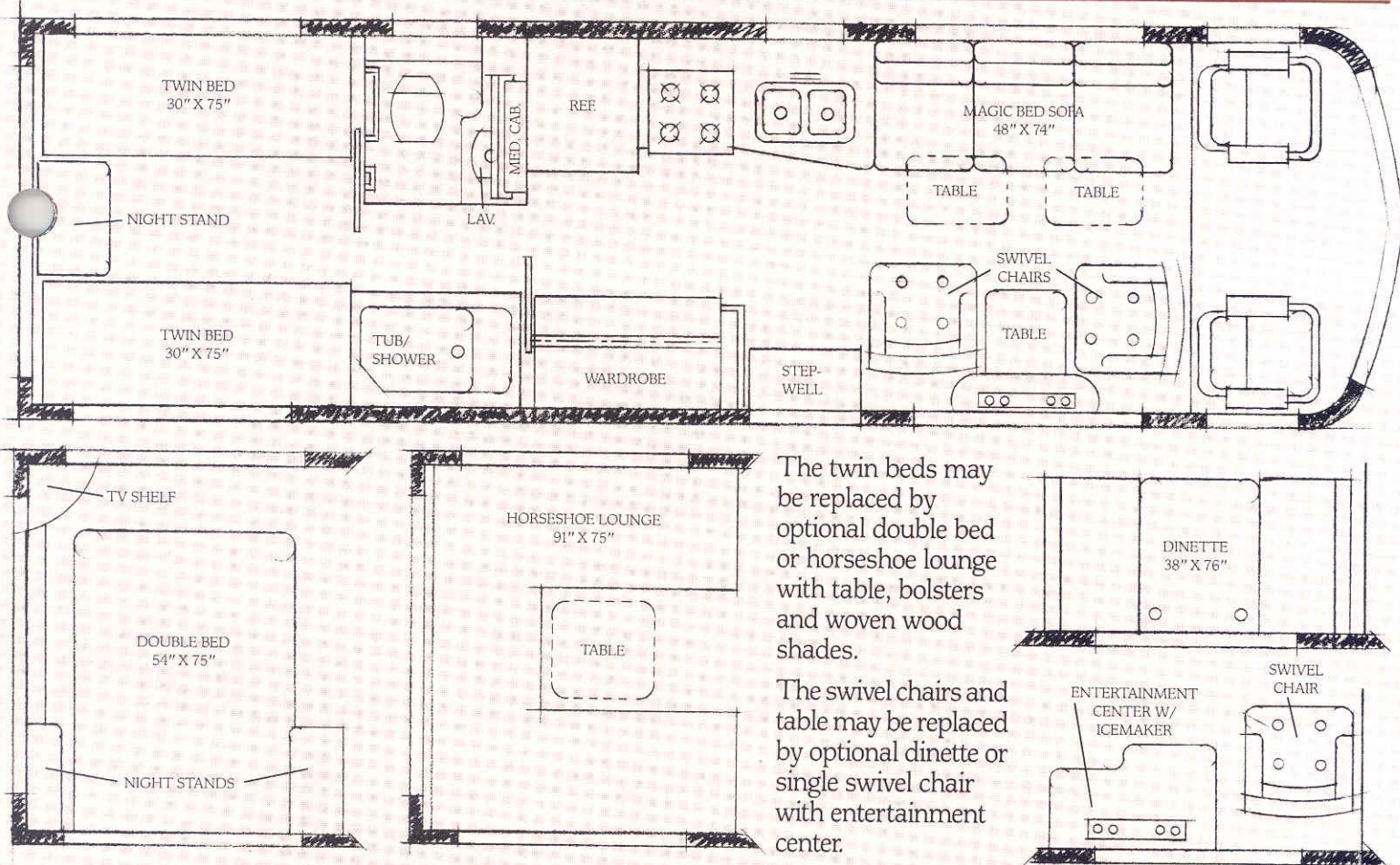

Sales

Winnebago's continuing program of product improvement makes specifications, equipment, model availability and prices subject to change without notice. Some items shown may be extra cost options. ©1984 Winnebago Industries, Inc., Forest City, Iowa 50436. Printed in U.S.A.