

ITASCA SPIRIT



Just because a motor home is inexpensive doesn't mean it has to be cheap.

A case in point: The Itasca® Spirit® line, your chance to buy premium Itasca quality without paying a premium price.

Like all Itascas, the three Spirits (class A, class C, and micro) are built with welded steel construction and the most exhaustive product testing in the business. And Itasca offers the best resale value and dependability available.

All three Spirits have everything you need for comfortable life on the road. They feature a fully-equipped galley, bathroom with shower, and enough sleeping room for up to five. Check out Spirit's quality and value—test drive one at your Itasca dealer soon!

CLASS A SPIRIT.

Early pioneers chose their gear carefully. They made the most of what they had. A rugged wagon with space for their belongings and the equipment they would need along the way.

Today, modern-day explorers find that same philosophy





in the Class A Spirit — with comfort and convenience added.

Class A Spirit is built like Itasca's larger, more expensive motor homes.

Thermo Panel® sidewalls and a laminated roof (with Itasca's unique locking-joint roof/wall construction) cover Spirit's rugged, welded steel structure.

Motor home design like this adds years of life and livability to each Spirit. Yet they still can cost thousands of dollars less than other Class A motor homes.

Spirit's attractive interior is outfitted with comfortable furniture and durable carpeting and fabrics. Lots of headroom in the spacious cab gives easy access to the living area. And its storage space lets you haul gear as if you had a herd of pack horses.

An Itasca through and through, with integrity built in from top to bottom, the Class A Spirit meets the toughest quality standards in the industry.

And best of all, it meets your budget as well.



The Class A Spirit gives you lots of exterior storage. Unlike some motor homes, a driver's door with roll-up window is optional.



The galley has an oven with a four-burner range-top, large refrigerator/freezer, double stainless steel sink, systems monitor panel, and an optional microwave.



Class A Spirit provides plenty of room to relax and loads of overhead storage. The optional front bunk provides extra sleeping space. Between the twin, swiveling side chairs is a convenient pull-out table.



Luxurious furniture built by Winnebago Industries' craftsmen and durable stain-resistant carpet provide the comforts of home. The driver and passenger seats swivel to provide extra lounge seating. The optional vinyl



The 327RT model features outside access to the underbed storage area.



floor covering allows easy clean-ups in the galley.

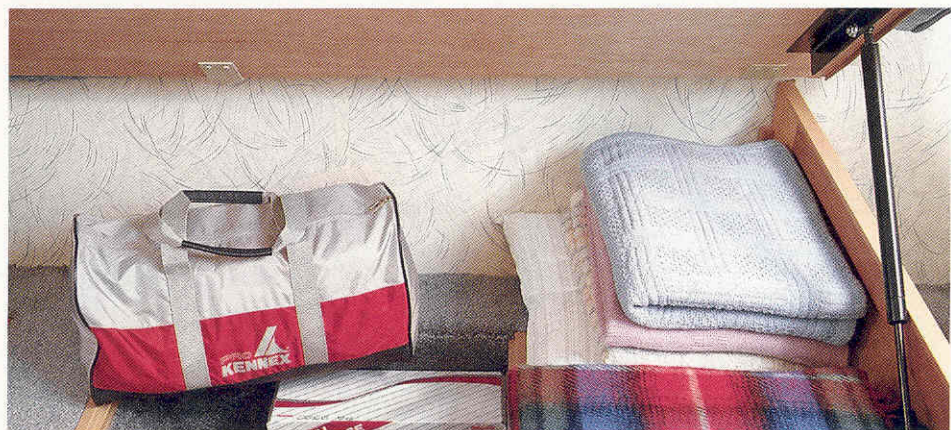

The 27-foot model's unique underbed storage area is easily accessible from both inside and outside the motor home.

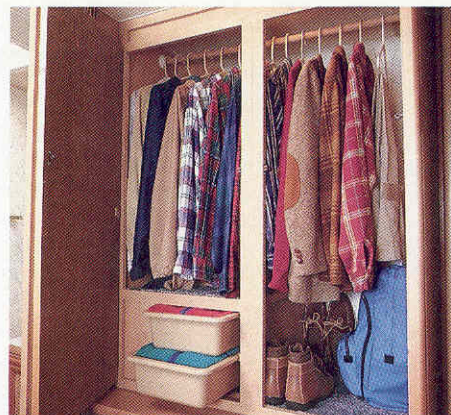

The spacious wardrobe offers plenty of room for full-length items. Handy drawers pack away small items.



The fully equipped Class A Spirit has a bathroom with shower, marine toilet, vanity, and plenty of storage.



The bedroom boasts extensive storage space, a color-coordinated mattress and window coverings, and a handy bedside nightstand.

CLASS C SPIRIT

It's done. You've planned the trip, plotted your course, and pointed yourself toward the horizon. Now let Spirit take you there.

Redesigned for 1990, the Class C Spirit has more storage, yet still offers the extra features and livability you expect to find in an Itasca motor home.

With room to sleep five, a fully-equipped galley and bathroom, and great value for your dollar, the Class C Spirit is a vacationer's dream machine.



The standard Class C Spirit has all the room, style and features you could want in a motor home. Plush carpeting, contemporary furniture and beautiful cabinetry add up to the best value Class C available.



The Class C Spirit: the motor home for dedicated horizon chasers. Sturdy Thermo Panel® walls provide outstanding insulation. New for 1990 is a straight roofline that adds extra head room and a cleaner look.



The fully-equipped cross-aisle bath, with shower, marine toilet, brass-tone fixtures, and vanity with new rectangular sink and color-coordinated faucet, gives you plenty of storage.



In the galley: stainless steel sink, systems monitor panel, four-burner rangetop with porcelain-door oven. A microwave oven and easy-maintenance vinyl flooring are optional.



Class C Spirit's bedroom offers generous storage and lots of windows for cross-ventilation, color-coordinated bed pillows, mattress cover(s) and attractive window coverings.



Spirit will always give you something to look forward to. In the cockpit, swivel/sliding seats, cruise control and in-dash air conditioning. Above, a queen-sized, cab-over bed with a panoramic view.

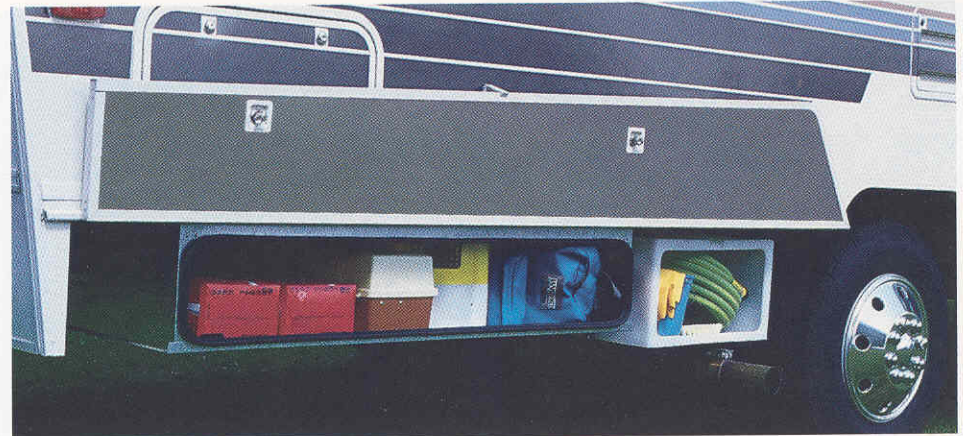

Also available, two optional storage compartments hidden behind a new full-length valance door. The compartment behind the rear wheel is made of seamless plastic for added protection.



The 327RT model features outside access to the underbed storage area.



The generator and a handy storage compartment are located on the driver's side of the 327RT.



The attractively finished rear end includes integrated tail lights, vinyl spare tire cover and optional roof rack and ladder. A bright rear bumper is included in the optional exterior package.

MICRO SPIRIT

The Micro Spirit is the least expensive Itasca. It's the perfect starter motor home for people looking for a weekend escape vehicle.

With a new V6 engine, standard this year, you'll have plenty of power for passing and climbing hills. The Micro Spirit offers the same quality construction, design, features and conveniences found in all Itasca motor homes. Compare prices and you'll agree, Micro Spirit is the best motor home value available.



The Micro Spirit has a roomy, open feel that belies its compact size.



The Micro Spirit's Thermo-Panel® walls provide outstanding insulation.



Note the attractive window coverings, spacious cab-over bunk, and generous overhead storage. The dinette easily converts to a bed.



The bathroom is fully equipped. It has a shower, marine toilet, sink, vanity, wardrobe, and medicine cabinet.

CONSTRUCTION CHART

EXTERIOR

- ☐ Galvanized Steel Storage Compartments
- ☐ Rotocast Plastic Rear Wheel Wells
- ☐ Windshield Mounted In Steel
- ☐ Tinted, Screened Windows
- ☐ Spare Tire w/Carrier and Vinyl Cover
- ☐ U.L. Approved LP Regulator
- ☐ Electrostatically Painted Aluminum Trim
- ☐ Fiberglass Exterior Sidewall
- ☐ Color-Coordinated Graphics

- ☐ Steel Tie-Downs For Galley Appliances
- ☐ Critical Steel Parts Are Primed And Rustproofed
- ☐ Steel Generator Compartment
- ☐ Meets Or Exceeds All Applicable State, RVIA And Federal Safety Standards
- ☐ Computer-Aided Design Helps Ensure Proper Balance And Weight Distribution

INTERIOR

- ☐ 10-B:C Fire Extinguisher, Smoke Detector, LP Leak Tester, Ground Fault Interrupter
- ☐ Stitchcraft Furniture By Winnebago Industries
- ☐ Automotive Air Conditioning
- ☐ Optional Driver Door w/Roll-up Window (Class A)
- ☐ Cruise Control
- ☐ Solid Wood-Framed Cabinet Doors
- ☐ Stain-Resistant Upholstery Fabrics And Carpeting
- ☐ Entrance Door Deadbolt Lock (NA Micro)
- ☐ Straight Roofline For Extra Headroom (NA Micro)
- ☐ Three-Point Retracting Driver And Passenger Seatbelts

STRUCTURAL

- ☐ Thermo Panel® Sidewalls Contain Thick Styrofoam® Insulation
- ☐ Every Spirit Is Subjected To An Extensive Water Leak Test
- ☐ Welded Steel Outriggers And Leveling Rails
- ☐ Locking-Joint Wall And Floor Construction
- ☐ Steel Cab And Dash Sub-structure
- ☐ Sealed Aluminum Underflooring
- ☐ Welded Steel Tube Wall Structure
- ☐ Seamless Water And Holding Tanks

CONSTRUCTION FEATURES

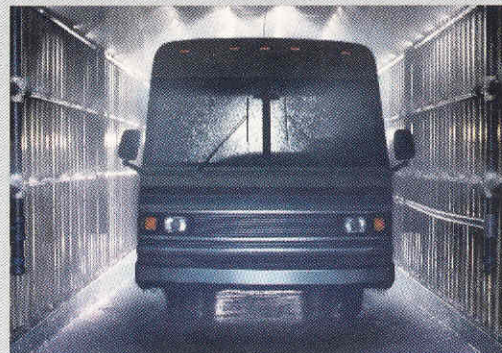

Simulating the ferocity of a thunderstorm, every Itasca motor home is subjected to an exterior water leak test in a tunnel filled with high-pressure spray nozzles.



Winnebago Industries' test track is one of a kind. In a half mile of track, a motor home endures cobblestones, chatter bumps, chuckholes, and a high-crowned intersection. Brakes are also tested on 20 and 30 percent grades.



To really put its motor homes to a test, Winnebago Industries drops them on their tops. Doors must still open and close easily. Appliances and cabinets must stay firmly in place. And the motor home must prove to be structurally sound in order to pass the drop test.

CLASS A SPIRIT

SPECIFICATIONS

	22EC	27EU
Length	22' 11"	27' 11"
Exterior Height w/Roof Air	10' 4"	10' 4"
Exterior Height w/o Roof Air	9' 5"	9' 5"
Exterior Width	8'	8'
Interior Height (Max.)	6' 8"	6' 8"
Fuel Capacity (Gals.)	40	60
Fresh Water Capacity (Gals. w/Heater)	53	51
Holding Tank Capacity (Gals.)		
Toilet, Lav./Galley, Shower	32/25	44/37
Sleeping Capacity—Standard	3	3
Optional	4	5
LP Capacity (lbs.)	60	60
GVWR (lbs.)	11,800	12,300
Wheelbase	137"	158.5"

STANDARD FEATURES*

AUTOMOTIVE FEATURES*

454-CID V-8 Engine
3-Speed Automatic Transmission
 w/Cooler
630-CCA Battery
Coil Spring Front Suspension w/Auxiliary
 Air Bags
Rear Leaf Springs
(6) Tires—7.50 x 16D
Automotive Air Conditioning
105-Amp Alternator
Emergency Start Solenoid (Dual
 Battery Switch)
Interior Hood Release
Radio (Electronic Tune AM/FM/
 Stereo Cassette w/Four Speakers)
Radio Power Switch (Main/Auxiliary)
Bucket Seats (w/Armrests, Three-
 Point Retracting Seatbelts)
Power Steering
Tilt Steering Wheel
Cruise Control
Multi-Function Signal Lever (w/Intermittent
 Wipers, Hi/Low Beam Control, and Turn
 Signal)
Cigarette Lighter
Map Light
Rearview Mirror
Passenger Window Screen
Multi-Adjustable Sunvisors
Front Wraparound Curtain

APPLIANCES/SAFETY FEATURES*

4-Burner Range w/Oven
Powered Range Hood
Wall Mount Monitor Panel

Double Door Refrigerator/Freezer
Double Stainless Steel Sink w/Sink Cover
6-Gallon Electronic Ignition Water
 Heater
Direct Drive Water Pump
24,000 BTU Electronic Ignition Furnace
60 lb. LP Tank w/Gauge
Sewer Hose
10-B.C. Fire Extinguisher
Ground Fault Interrupter
Smoke Detector
LP Leak Tester

INTERIOR FEATURES*

Carpeting
Ceiling Lights
Coach Vent
Wardrobe w/Drawers and Shelf
Flip-up Galley Extension
Folding Bath Door (22EC)
Bath Light
Lavatory with Molded Soap Dishes
Powered Lavatory Vent
Marine Toilet
Medicine Cabinet w/Mirror
3 Bulb Makeup Light (27EU)
Framed Mirror on Bath Wall (27EU)
Shower w/Flexible Shower Head and Curtain
 (22EC)
Shower Door (27EU)
Brass-Tone Tissue Holder
Towel Ring
Towel Bar and Soap Dish in Shower (27EU)
Divider Doors (Bath to Bedroom and Bath to
 Galley—27EU only)
Double Bed w/Fitted Mattress Cover and Bed
 Pillows (Nightstand & Below-Bed Storage on
 27EU only.)

EXTERIOR FEATURES*

Painted Bumpers
Tinted Windows
Side Rearview Mirrors
Two Deep Cycle Marine/RV Batteries
32-Amp Converter
9-Amp Battery Charger
Exterior Outlet
Generator Prep Kit
Entrance Door w/Frosted Window & Screen Door
Retractable Entrance Step
Porch Light w/Switch
Exterior Assist Handle
Locking Storage Compartments w/Hold-ups
Locking Fuel And Water Fill Doors
Rear Rock Guards
Exterior Power Cord—30 Amps
Extensive Warranty (Complete details of
 warranty terms and conditions are available at
 any Itasca dealer.)

OPTIONAL FEATURES*

Microwave Oven
TV Antenna w/Jack
Front Pull-Down Bunk
Convertible Couch (Exchange for Dinette—
 27EU only)
13,500 BTU Roof Air Conditioner
34,000 BTU Furnace
Water Heater w/Motoraid & Auxiliary Rear
 Auto Heater
4,000-Watt Generator
Rear Air Bags and Two Front Stabilizer
 Shocks
Trailer Towing Package (22EC Only)
Spare Tire w/Carrier and Cover
Radial Tires
Clamp-On Wheel Covers
Driver's Door w/Roll-up Window
Reclining Bucket Seats with Swivel and
 Slide Pedestals
Vinyl Galley Flooring
Luggage Rack and Ladder
Undercoating
Interior Color Options: Blue Sky or Desert Sand

*Not all standard features or options are available on all models. See your dealer for the availability of specific options.

CLASS C SPIRIT

SPECIFICATIONS

Length
 Chev.
 Ford
Exterior Height w/Roof Air
 Chev.
 Ford
Exterior Width
Interior Height (Max.)
V-8 Engine (CIDs)
 Chev.
 Ford
Battery CCA
 Chev./Ford
Alternator Amps
 Chev./Ford
Fuel Capacity (Gals.)
 Chev./Ford
Fresh Water Capacity (Gals.)
 w/Heater
Holding Tank Capacity (Gals.)
 Lav., Toilet
 Galley, Shower
LP Capacity (Lbs.)
Sleeping Capacity
 (STD/OPT)
GVWR (lbs.)
 Chev.
 Ford
Wheelbase (Chev./Ford)

VARIABLE FEATURES

2nd Deep Cycle Marine/RV Battery
Refrigerator/Freezer (Large Single
 Door/Double Door)
Shower (Curtain/Door)
Entrance Door Cabinet
Room Divider Curtain
Electronic Ignition Furnace
 BTUs STD
 BTUs OPT

STANDARD FEATURES*

AUTOMOTIVE FEATURES

3-Speed Automatic Transmission w/Cooler
3-Speed Automatic Transmission w/Cooler and
 Overdrive (327RT Ford only)
Coil Spring Front Suspension
Two-Stage Multi-Leaf Rear Suspension
(6) 8.00 x 16.5D Tires (Chev.)
Emergency Start Solenoid

321RG	323RC	327RT
21'3"	22'11"	NA
21'11"	23'7"	27'
10'1"	9'10"	NA
10'3"	10'	10'
8'0"	8'0"	8'0"
6'7"	6'7"	6'7"
350	350 or 454	NA
351 or 460	351 or 460	460
525/635	525/635	NA/635
85/100	85/100	NA/100
33/38	33/38	NA/38
32	40	40
25	35	28
25	35	37
60	60	60
5/5	5/5	5/5
10,200	10,500	NA
10,500	11,000	11,000
125"/138"	146"/158"	NA/176"

321RG	323RC	327RT
OPT	STD	NA
STD/NA	NA/STD	NA/STD
STD/NA	STD/NA	STD/STD
NA	STD	NA
NA	STD	NA
24,000	24,000	30,000
NA	34,000	NA

Electronic Tune Radio with AM/FM/Stereo
Cassette and Speakers
Automotive Air Conditioning
Power Steering
Tilt Steering Wheel
Cruise Control
Intermittent Wipers
Cigarette Lighter
Ashtray
Dome Light

Cab Divider Curtain
Blackout Curtain
Sunvisors
Inside Rearview Mirror
Bucket Seats (Swivel/Slide, Armrests, Three-Point Retracting Seatbelts)
Cab Mat w/Carpeted Floor Mats

APPLIANCES/SAFETY

4-Burner Range w/Porcelain Door Oven
Powered Range Hood
Monitor Panel
Double Stainless Steel Sink w/Dual Control
Faucet and Sink Cover
Direct Drive Water Pump
4-Gallon Water Heater
Generator Prep Kit
10-BC Fire Extinguisher
Smoke Detector
Ground Fault Interrupter
LP Leak Tester

INTERIOR

Coach & Bedroom Vents
Frosted Entrance Door Window
Bone Lavatory and Shower Faucets
Bathroom Light
Marine Toilet
Wood Framed Medicine Cabinet
Shower w/Flexible Shower Head
Brass-Tone Towel Ring & Tissue Holder
Bath Area Pleated Blind w/Padded Valance
(321RG has ABS Valance and Pull Shade)
Powered Lavatory Vent
Carpeting
Carpeted Wardrobe Shelf
Entrance Mat
110 Volt Galley Outlets (2)
Fitted Bed Covers w/Bed Pillows

EXTERIOR

Chrome Front Bumper
Tinted Windows
Locking Valance Panels
Retracting Entrance Door Step
110-Volt Outlet
Lockable Water Door
Painted Rearview Mirrors
Porch Light
Entrance Screen Door
Exterior Assist Handle
Deep Cycle Marine/RV Battery
32-Amp. Converter/9-Amp. Battery Charger
LP Tank
Roof Air Pre-Wiring
Cab Mud Flaps
Tire Tools
30 Amp. Power Cord
Extensive Warranty (Complete details of warranty terms and conditions are available at any Itasca dealer.)

OPTIONAL FEATURES*

454 CID V-8 (Chevrolet)
351 or 460 CID V-8 (Ford)
Microwave Oven
4,000-Watt Generator
13,500-BTU Roof Air
6 Gal. Water Heater or 6 Gal. Water Heater w/Motoraid and Rear Automotive Heater (NA 321RG)
Rear Pedestal Table (321RG only)
TV Antenna w/Jack
Luggage Rack and Ladder
Spare Tire
(7) Radial Tires
Wheel Covers
Aluminum Running Boards
Exterior Trim Package (Includes: Chrome Mirrors, Bright Rear Bumper Cover and Rear Mud Flaps)
Exterior Storage behind Wheel Wells (NA 323RC)
Vinyl Galley Flooring
Trailer Towing Package
Interior Color Options: Blue Sky or Desert Sand

MICRO SPIRIT

SPECIFICATIONS

20'7" Length
9'2" Height w/Roof Air
8'8" Height w/o Roof Air
7'1" Exterior Width
6'2" Interior Height (Max.)
17.2-Gal. Gasoline Capacity
18-Gal. Fresh Water Capacity (w/water heater)
(2) 14-Gal. Capacity Holding Tanks
28-lb. LP Capacity
3-Person Sleeping Capacity
6,000-lb. GVWR (6-Cyl.)
137" Wheelbase

STANDARD FEATURES*

AUTOMOTIVE FEATURES

6 Cylinder Toyota Engine
4-Speed Automatic Transmission
(7) 185R 14LT6PR Radial Tires
Fuel Injection
60-Amp. Alternator
60-Amp. Battery
Tinted Cab Windows
Power Steering
Automotive Air Conditioner
Cruise Control
Door Trim Panels and Map Pockets
Multi-function Signal Lever
Ash Tray
Cigarette Lighter
Remote Hood Release
Map Light
Bucket Seats w/Three-Point Retracting Seatbelts
Floor Mat

Electronic Tune Radio w/AM/FM/Stereo
Cassette and Speakers
Sunvisors
Blackout Curtain

APPLIANCES/SAFETY FEATURES

Direct Drive Water Pump
4-Burner Range Top
Power Range Hood
Systems Monitor Panel
Large Refrigerator
12,000-BTU Forced Air Electronic Ignition Furnace (16,000 BTU—320RC)
Double Stainless Steel Sink
4-Gallon LP Water Heater
LP Leak Tester
Smoke Detector
Ground Fault Interrupter
10-B.C. Fire Extinguisher

INTERIOR FEATURES

Front Overhead Bunk
Lavatory
Shower w/Curtain
Marine Toilet
Medicine Cabinet w/Mirror (319RB)
Power Bath Vent (319RB)
Coach Vent
Carpet
Side Bunk Windows and Lined Draperies
Bath Door
Bone Lavatory and Shower Faucets
Brass-Tone Bath Accessories
Pleated Blinds w/Padded Window Treatments
Frosted Entrance Door Window
Pull Shade (Bath)

EXTERIOR FEATURES

Deep-Cycle Auxiliary Battery
25-Amp. Converter/Battery Charger with Power Cord
Storage Compartments
Sewer Hose Stored in Rear Bumper
Lockable Water/Fuel Fill Doors
Porch Light
110 Volt Outlet
Painted Mirrors
Entrance Screen Door

OPTIONAL FEATURES*

5-Speed Manual Transmission
Right Front Swivel Chair
7,100-BTU Roof Air Conditioner
Cab Mud Flaps
Fabric Covered Bucket Seats
4 Burner Range w/Oven
Generator Prep Kit (319RB only)
2,500 Watt Generator (319RB only)
Interior Color Options: Blue Sky or Desert Sand

CLASS A SPIRIT

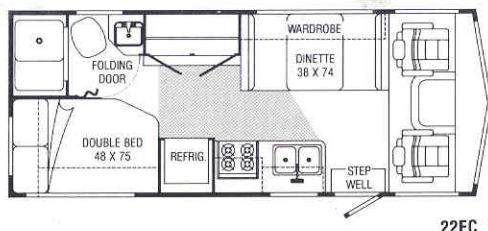

22EC

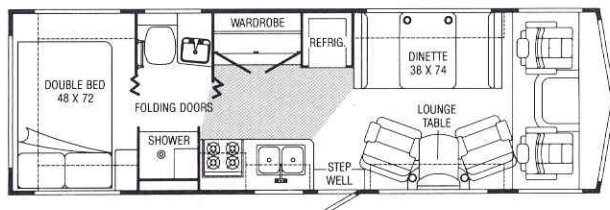
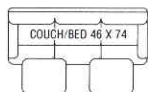

27EU

CLASS C SPIRIT

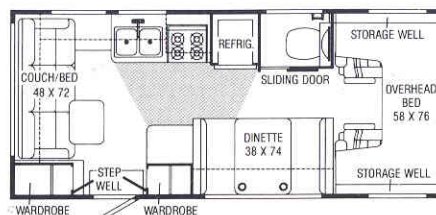

321RG

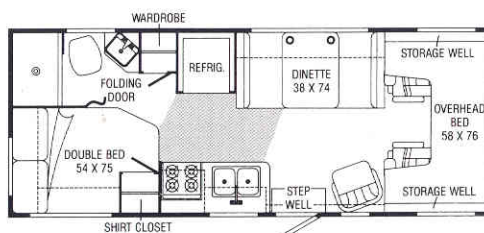

323RC

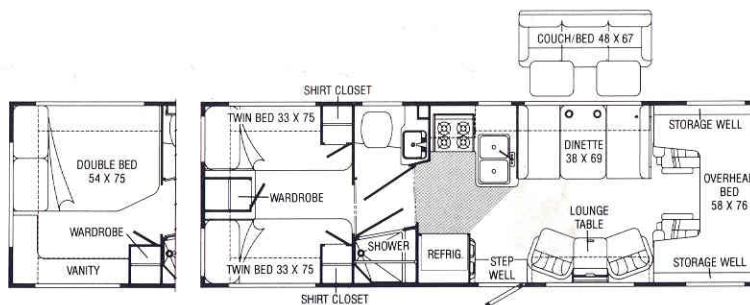

327RT

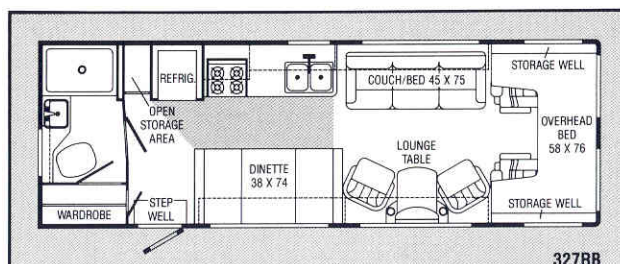

327RB

New Floorplan available spring 1990.

The new 327RB features a layout that's ideal for entertaining and family use and includes all the features and value Spirits are known for.

MICRO SPIRIT

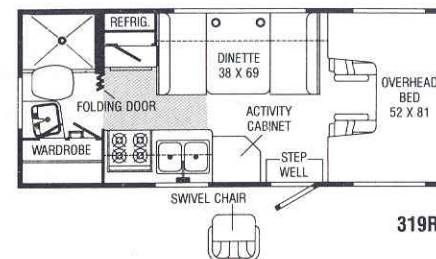

319RB

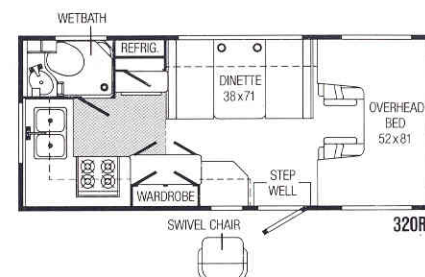

320RC

Itasca's continuing program of product improvement makes specifications, equipment, model availability and prices subject to change without notice. Some items shown may be extra cost options.

Note: Dimensions shown are for sleeping space only and dashed lines denote overhead storage area. Shaded areas indicate optional vinyl galley flooring location.

If you are in the Forest City, Iowa area, be sure to take the free Winnebago Industries factory tour. For more information call 1-515-582-6936.

Every Itasca owner is invited to join the Winnebago-Itasca Travelers (W.I.T.) Club. Members enjoy rallies and caravans, receive special discounts and services, make new friends and renew old acquaintances, and, of course, have the time of their lives. For more information, call W.I.T. at (515) 582-6874.

Printed in the U.S.A.

Part 1890

For Itasca sales and service, contact:

Itasca
Built Proudly By Winnebago Industries.