

# P A S S A G E

By Winnebago Industries





The roomy interior of the Itasca Passage features both a couch and dinette that convert into sleeping areas— and there's also a pull-down front bunk. The Passage has an efficient galley, hand-crafted cabinetry, abundant storage and stain resistant fabric and carpet.

## Just a Little Gives You a Lot

The 22-foot Passage's suggested retail price is less than most luxury automobiles. Low monthly payments make the Passage even more affordable. And the Passage may qualify for second home tax advantages, making all interest tax deductible.

But affordability doesn't mean compromising quality. The Itasca Passage is manufactured by Winnebago Industries— the number one name in motor home excellence. You get solid steel substructure, exclusive Thermo-Panel sidewalls and backwall, extensive product testing and quality control Winnebago Industries is famous for.

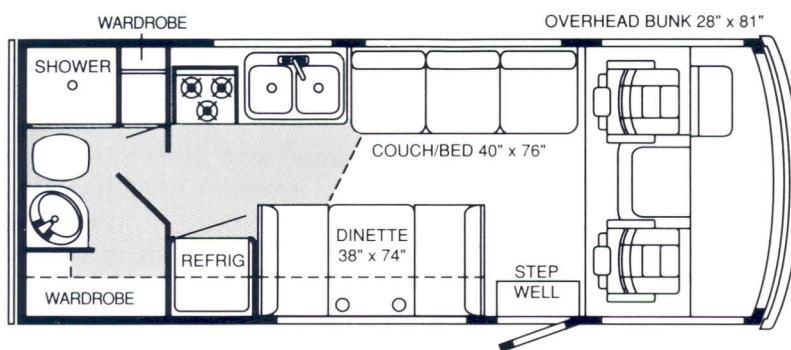

Passage 22RB

There's also a well-planned, spacious, tasteful interior featuring Scotchgard™ protection on all fabrics. The couch/bed, convertible dinette and pull-down overhead bunk provide abundant sleeping capacity.

The Passage also offers excellent towing capabilities— and all sorts of opportunities for just plain traveling fun! Whether it's a weekend outing or an extended vacation, the 22-foot Itasca Passage provides motorhoming excitement that's designed to last many years down the road—at a very affordable price!

| SPECIFICATIONS:               | 22RB        |
|-------------------------------|-------------|
| Length                        | 21' 11"     |
| Exterior Height w/Roof Air    | 10' 4"      |
| Exterior Width                | 8'          |
| Interior Height               | 6' 5.7"     |
| Interior Width                | 7' 7"       |
| Fuel Capacity                 | 40 gals.    |
| Fresh Water Capacity w/Heater | 36 gals.    |
| Holding Tank Capacity         | 38 gals.    |
| LP Capacity                   | 42 lbs.     |
| Furnace                       | 17,000 BTU  |
| GVWR                          | 11,800 lbs. |
| Wheelbase                     | 137"        |





A rear bedroom with full size walk around bed is a primary feature of the Itasca Passage 25RU. There are also an efficient galley, comfortable dinette, side bath and spacious closets.

## Drive a Tough Bargain!

The exciting new 25 foot Itasca Passage gives you world-famous Winnebago Industries quality in a Class A motor home— at a very affordable price.

You get a great floor plan, solid Winnebago Industries construction, excellent towing capability and a bedroom!

You can have your choice of a walk-around double bed or twin beds. Overhead bunks on the twin-bed option give even more sleeping capacity.

But even with all of this, the 25 foot Itasca Passage is one of the lowest priced Class A motor homes on the market today. The suggested retail price is below that of many luxury automobiles!

And do we need to mention the low monthly payments and possible second home tax advantages again?

| SPECIFICATIONS:               | 25RU        |
|-------------------------------|-------------|
| Length                        | 25' 4"      |
| Exterior Height w/Roof Air    | 10' 4"      |
| Exterior Width                | 8'          |
| Interior Height               | 6' 5.7"     |
| Interior Width                | 7' 7"       |
| Fuel Capacity                 | 40 gals.    |
| Fresh Water Capacity w/Heater | 36 gals.    |
| Holding Tank Capacity         | 38 gals.    |
| LP Capacity                   | 42 lbs.     |
| Furnace                       | 19,000 BTU  |
| GVWR                          | 11,800 lbs. |
| Wheelbase                     | 158.5"      |

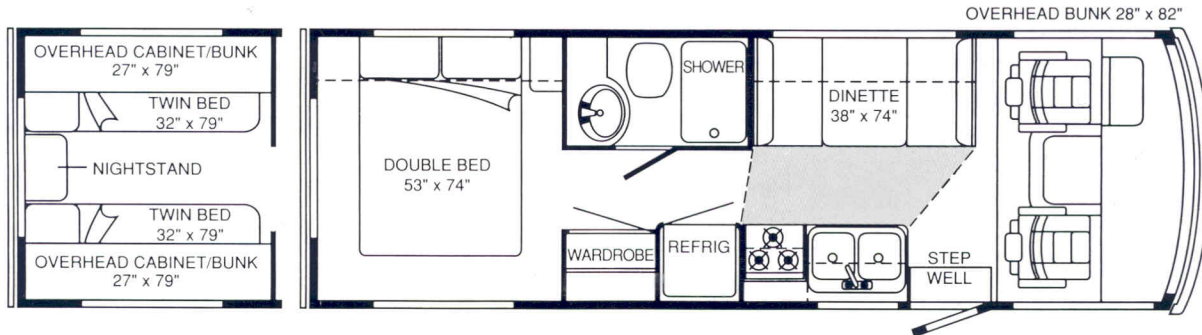

Passage 25RU

# See What Passage Delivers!

## STANDARD FEATURES

### DECOR SELECTIONS:

Blue  
Teal  
Brown  
Eggplant

### AUTOMOTIVE FEATURES:

Chevrolet Chassis: 7.4L  
Gasoline Engine  
Automatic Transmission  
w/Overdrive and Cooler  
105 Amp Alternator  
Deep Cycle Marine/RV 630 CCA  
Battery  
Dual Battery Charge Control

### DRIVER CONVENIENCES:

Automotive Heating/Air Conditioning: Flow Control System  
Cab Windows: Full Sliding  
w/Screen  
Intermittent Windshield Wipers  
Front Wraparound Curtain  
w/Track  
Power Assist Steering w/Tilt  
Wheel  
Seats: All Fabric, Arm Rests,  
Swivel/Slide, Pedestal  
Sunvisors  
Cruise Control  
Analog Cluster Display

### SYSTEMS:

Six Gallon LP Water Heater  
A/C Roof Mount Wire Path  
AC/DC Load Center/Converter  
Unit: DC Automotive-style  
Fuses, AC Circuit Breakers, 9  
Amp Battery Charger, 32 Amp  
Converter  
30 Amp. Power Cord  
Demand Water Pump

### SAFETY FEATURES:

LPG Leak Detector/Alarm  
Smoke Detector/Alarm  
10 BC Fire Extinguisher  
Ground Fault Interrupter

### INTERIOR FEATURES:

Main Entrance Door w/Screen  
Latch and Lock Assembly  
w/Deadbolt  
Stain Resistant Carpet w/Pad  
Assist Strap  
Roof Vent: Bath and Galley  
Ceiling Lights  
Wardrobe w/Wooden Clothes  
Rod

### GALLEY FEATURES:

Dual Control Faucet  
Stainless Steel Double Sink  
w/Countertop Cover  
Single Door Refrigerator/Freezer  
Monitor Panel: Battery Condition  
Gauge, Holding Tank Level  
3-Burner Range Top  
Vented Range Hood w/Light  
Access to Storage Below Dinette  
Seats

### BATHROOM FEATURES:

Dual Control Faucet  
Large, Ledge-back Oval Sink  
Shower, Dual Control w/Flexible  
Head  
Shower Curtain  
Lavatory Cabinet  
Wood Medicine Cabinet  
Marine Toilet  
Tissue Holder  
Towel Bar

### EXTERIOR FEATURES:

Retractable Entrance Step  
Awning Rail  
Front Bumper: Painted Aluminum w/End Caps  
Hinged Single Panel Hood  
Tinted Window  
City Water Hook Up  
Gravity Tank Fill  
Sewer Hose Storage In Rear  
Bumper  
Molded Storage Compartments

### WARRANTY:

The basic warranty period is 12 months or 15,000 miles (24,135 kilometers) on the odometer, whichever occurs first.  
Preferred Care 24-Hour Road Service available. (See dealer for details)

### OPTIONAL EQUIPMENT

Radial Tires (mandatory option)  
13,500 BTU Roof A/C  
4,000 Watt Generator  
Canadian Code  
Undercoating  
**PREFERRED  
EQUIPMENT PACKAGE:**  
Class II Trailer Hitch  
Wheel Covers  
Exterior Ladder  
Single Front Bunk  
AM/FM Stereo w/Cassette  
Microwave Oven  
Vinyl Floor Covering  
Auxiliary Start Circuit  
TV Antenna— Amplified System

See your dealer for availability of special options.

Winnebago Industries' continuing program of product improvement makes specifications, equipment, model availability and prices subject to change without notice.

The logo for Ctasca, featuring the word "Ctasca" in a bold, stylized, blocky font. The "C" is particularly large and has a unique shape.

Built Proudly By Winnebago Industries.

© 1992 Winnebago Industries, Inc. Forest City, Iowa 50436  
Printed in the U.S.A.