

LUXOR™



Much more than just another luxury class widebody motor home, the 1996 Luxor embodies true engineering excellence. Each coach effortlessly blends the most advanced technology, impeccable craftsmanship and uncompromised luxury.

Built Proudly by







LUXOR
BY WINNEBAGO

TURBO DIESEL



Luxor's reputation rests on its firm foundation

Luxor's widebody bus-style design is truly a step ahead of the industry. It's the culmination of over 37 years of RV manufacturing excellence. And it comes from the only company capable of building this high-line coach with superior construction, meticulous attention to detail and exquisite furnishings.

Winnebago Industries designed and built the Luxor on one of the most advanced chassis and power trains available. For 1996, Luxor rests on a unique raised rail Freightliner chassis which offers travelers easily accessible, useable storage. Power is supplied by a rugged, dependable Cummins 8.3 liter turbo-charged/after-cooled 300 horsepower diesel engine and an Allison 6 speed World automatic transmission. Comfort on the road is provided by a full air suspension system. And driving convenience and safety are increased with Luxor's new exhaust brake system.

Additional exterior features include 22.5" stylized aluminum wheels and metric radial tires, electronically controlled and heated mirrors, high-visibility windshield, Sony® rear monitor with one-way audio, whisper-quiet 7,500-watt Onan® diesel generator stowed in an ingenious slideout compartment, available pull-out storage tray which extends from either side of the motor home and an available slideout refrigerator/freezer.

L U X O R
Built Proudly by 



Luxor's high-strength, quick-drying A&E awning is completely fade resistant and 22% cooler than other awnings. Its unique counterbalanced design makes operation easy. When not in use, all hardware (including side supports) disappears into an aerodynamic weathershield.

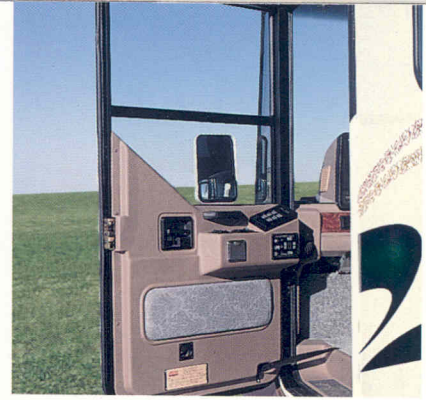

For maximum driver convenience, Luxor includes a driver's entry door with an integrated valance entry step and assist handle. The remote control, keyless entry system automatically locks or unlocks both the driver and main entry doors.



You can easily store up to 1,000 pounds in Luxor's available 42" x 90" slideout storage compartment. The smooth-rolling tray is mounted to 4" side rails that slide out from either side of the coach, making it perfect for loading and unloading large, bulky items like bikes and golf clubs. Spring loaded locking latches and a carpeted tray keep items in place while traveling. Gas struts ease all compartment doors open and hold them in place.

Luxor's available exterior entertainment center includes two folding lawn chairs, power outlets, TV jack, antenna, AM/FM cassette stereo, and two speakers. The available roll-out refrigerator/freezer features 75 lb. capacity, AC/DC operation and an adjustable thermostat.

A slideout compartment houses Luxor's 7,500-watt Onan diesel generator. An available 2,000-watt Heart Interface® inverter allows use of 110-volt appliances while maintaining battery charge.

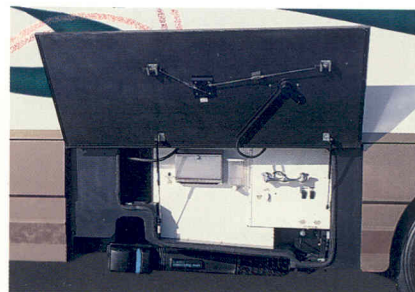

The heated service center was designed for easy access to hook-ups. It includes a paper towel holder, soap dispenser and convenient wash station. The innovative Thetford telescoping drain neatly tucks out of the way when not in use.



New this year, an available digital satellite system offers more than 175 channels with CD-quality sound, clean pictures and remote control convenience. Not available in Canada. Program activation fees not included.

The available 10-watt solar panel trickle charges batteries, extending their life.

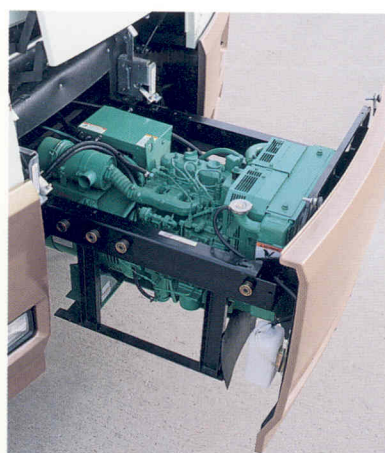
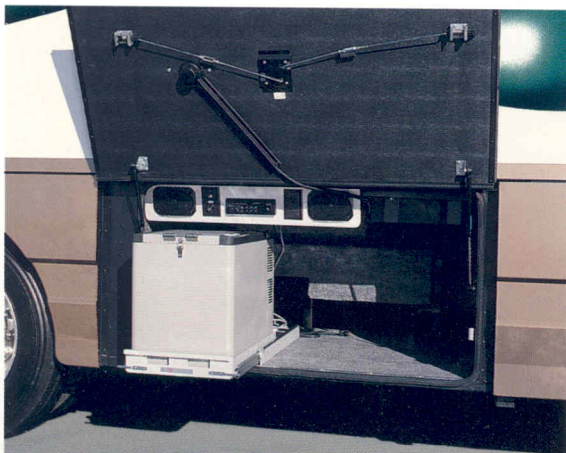







A luxurious approach to practical living

On the one hand, Luxor is remarkably practical — designed for extended living and travel. On the other, it is exceedingly elegant — literally loaded with the finest appointments available.

Thorough customer research and Winnebago Industries' 37-plus years of experience determined the standard features and amenities that a world-class motor home should offer. To start with, the mid-entry door's thoughtful placement in the floorplan conveniently allows passengers to enter and exit the coach without having to walk through the living area. In addition, Luxor offers a selection of four interior decors. Each beautifully coordinates stunning fabrics, rich window treatments, luxurious carpet and the choice of either Pickled Ash or Salem Cherry cabinetry.

The living area greets travelers with a comfortable sofa and ottoman, a fine leather lounge chair and a 19" color TV with VCR. Dual-pane thermo-insulated windows and a custom central air conditioning system (ducted through the coach's nearly four-inch-thick insulated roof) ensure utmost interior comfort. An available Sony/Bose® stereo system with CD changer and below-the-floor sub-woofer speaker system is yet another example of the length to which Winnebago Industries has gone to equip the 1996 Luxor with the finest amenities.

L U X O R
Built Proudly by 



The driver's area includes a custom, leather-wrapped steering wheel and large rocker switches located right at the driver's fingertips. Luxor's unique design and high-visibility windshield provide drivers with an unsurpassed view of the road.



In addition to its good looks and unmatched comfort, the plush sofa quickly converts to a bed. The movable ottoman houses additional storage space.



Passenger comfort is guaranteed with Luxor's oversized companion seat. This custom leather chair reclines, slides and swivels to become part of the lounge area. The footrest raises electronically for ease and comfort.

Corian® countertops, rich wood cabinetry, a full size microwave/convection oven, two-burner recessed residential-style KitchenAid® cook top, coffee maker, available built-in dishwasher and an abundance of workspace are just a few of the kitchen's standard features. The large refrigerator/freezer includes a back-up operating system, door ajar alarm, adjustable shelves and door bins.

The pantry includes upper and lower roll-out racks with adjustable baskets which provide additional storage space.





Luxor's dining area offers the perfect atmosphere for dining and entertaining. It features a large picture window with pleated shades, stunning window treatments, decorative brass light, beautifully upholstered chairs and a wood-trimmed table. For increased comfort, both chairs swivel and slide. Quickly add space for entertaining guests thanks to a self-storing table leaf and folding chairs.

The brass-accented bathroom takes elegance to a new level with its Corian countertops, porcelain toilet, glass-doored shower/garden tub, moisture resistant, easy-care cabinetry and easy-cleaning premium vinyl flooring.





Luxor's bedroom makes a statement with its elegant wainscoting, Corian-topped nightstands, beautifully coordinated fabrics and window treatments, and a four-panel door. It also includes a residential queen bed with Sealy® innerspring mattress or available California King bed with Sealy Posturepedic® innerspring mattress, 13" color TV with remote stereo system and day/night pleated blinds.

A handy linen closet is above a beautiful four-drawer chest that can be exchanged for an available washer/dryer combination (shown in photo). The cedar-lined wardrobe includes sliding, full-length mirrored doors, a large shelf and convoluted hanging rod.

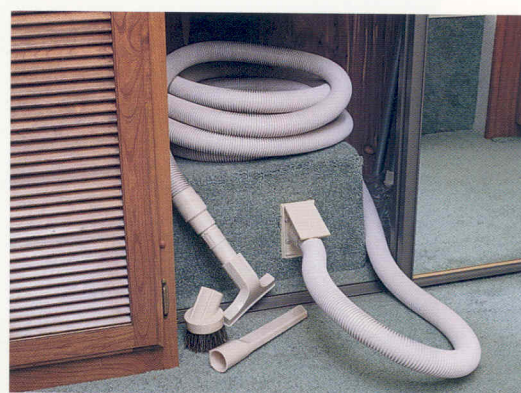

When not in use, the centrally-located, available vacuum cleaner system neatly stows inside the wardrobe.

Luxor's entertainment systems include a 13" color TV with remote in the bedroom and a 19" color TV/VCR with remote in the lounge area. For maximum audio quality, both TV systems are wired into remote speakers. A switching system allows video viewing on either the front or rear TV.



1996 Luxor Interiors

~ Cappuccino*

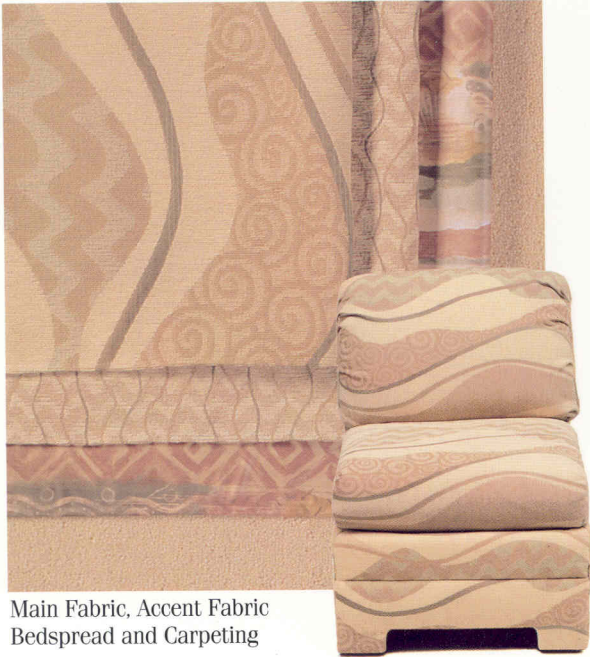

Main Fabric, Accent Fabric
Bedspread and Carpeting

~ Windsor*

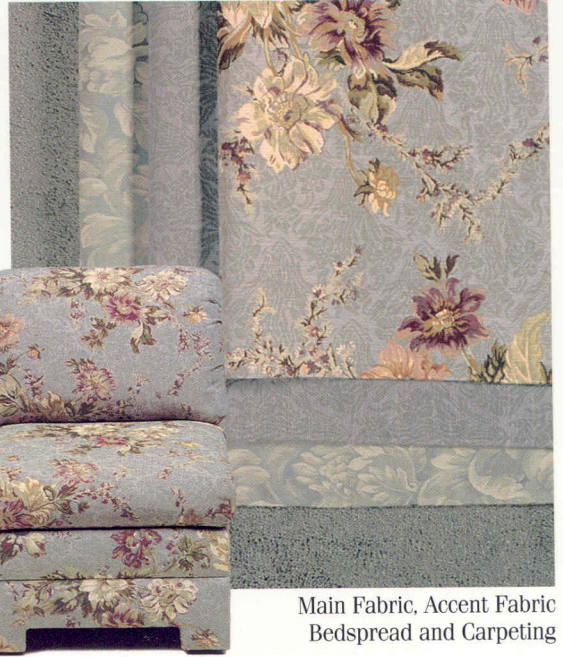

Main Fabric, Accent Fabric
Bedspread and Carpeting

~ Cabernet*



Main Fabric, Accent Fabric
Bedspread and Carpeting

~ Silver Aspen*



Main Fabric, Accent Fabric
Bedspread and Carpeting

~ Salem Cherry Wood



~ Pickled Ash Wood



*The style of chair shown is not available on the motor home you purchase. It is shown to represent fabric color and pattern only.

1996 Luxor Construction & Floorplan

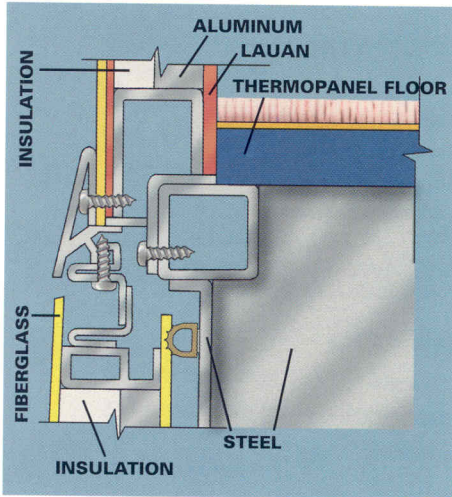

The steel framework of the foundation supports the weight of the roof and sidewalls.

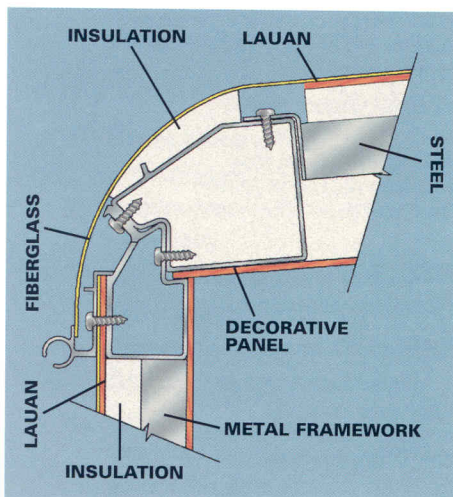

The interlocking roof and sidewall joint utilizes a two-point fastening design to ensure no corner pivoting. It also helps transfer the weight of the roof to the sidewall.

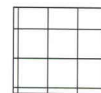
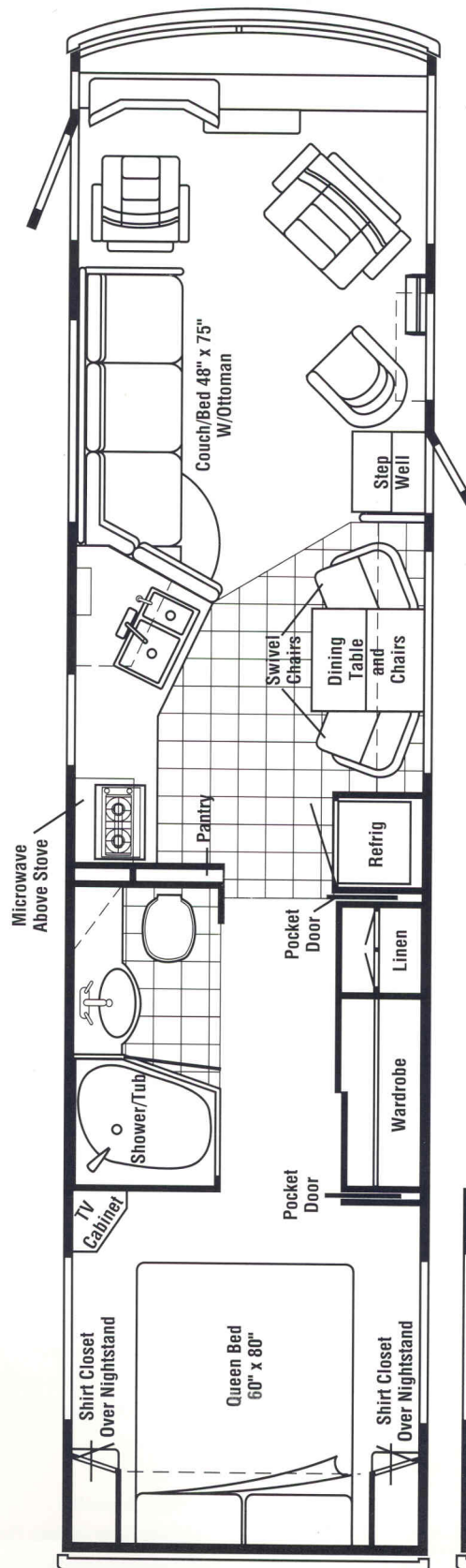

Premium Vinyl Floor

Note: Dimensions shown are for sleeping space only and dashed lines denote overhead storage areas.

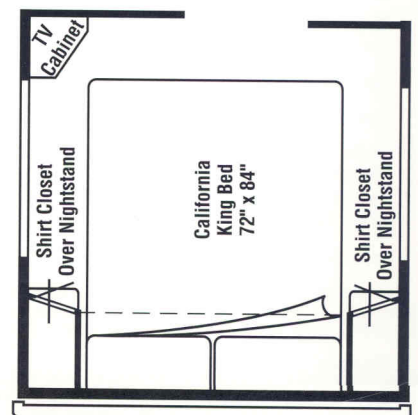

1996 Luxor Specifications

Luxor	37WQ
Length	36'9"
Exterior Height†	11'2"
Exterior Width▼	8'5.5"
Interior Height	6'8"
Interior Width	8'
Fuel Capacity	100 gal.
Fresh Water Capacity w/Heater	100 gal.
Holding Tank Capacity	125 gal.
LP Capacity	109 lbs.
GVWR	26,000 lbs.
Wheelbase	228"
Exterior Storage	136 cu.ft.

Automotive

Chassis (Raised Rail) Freightliner 8.3L 300 H.P. Turbo-Charged After-Cooled Diesel Engine, Automatic Transmission w/Overdrive & Cooler, Air Suspension, 2 - 925-CCA Batteries/100-Amp. Alternator, Air Flow Indicator, Full Air Brakes, Engine Block Heater, Engine Exhaust Brake, Air Suspension, Fuel/Water Separator

Headlamps Halogen

Tires (Radial) w/Spare

Driver Conveniences

12-V Electrical Supply/Lighter & Aux. 12-V Electrical Supply

Battery Charge Control Dual, Automatic

Battery Disconnect

Cabinet Center Console

Cruise Control

Curtain w/Traverse Rod Front Wrap-Around

Defroster Fans (2) Auxiliary, 2-Speed

Door (Driver Entrance)

Door Locks (Power) Remote Controlled, Driver & Main Entry

Floor Mats Driver, Passenger

Fog Lamps

Glove Compartment

Heating/Air Conditioning Automotive Blend Air System

Hood Light

Hood Release Exterior Key Locks

Horns (Air) Roof Mounted

Lamps (2) Auxiliary Side Illumination

Map Light Passenger, 2 Switches

Mirrors (Rear View) Low Mounted, Electronically Controlled, Heated, Turn Light Incorporated into Mirror

Motor Cover Steel Enclosure w/Sound Deadening

Rear View Monitor System Video, 1-Way Audio

Seats Reclining High-Back Design, Armrests, Driver-Side Powered Lumbar Support, Passenger Luxury Lounge Seat w/Power Foot Rest, Swivel/Slide Pedestals, 3-Point Retracting Seat Belts, Driver Seat 6-Way Power Assist

Service Light Driver Side

Squeegee Long Handle, Stored under Hood

Start Circuit Auxiliary

Steering Power Assisted w/Tilt Wheel

Steering Wheel (Custom)

Storage Cabinet (Front Overhead)

Sunvisors

Window (Power) Driver

Window Shades Roller, Light Filtering

Window (Sliding) Passenger, w/Screens, Dual-Glazed, Thermo-Insulated

Windshield Wipers (Intermittent) Pantographic

Entertainment

Antenna (Radio) Roof-Mounted, Flexible Rubber

C.B. Prep Kit Antenna, Coax Wiring, 12-V Power Connection

CD Multi-Disc Changer* w/Radio Exchange

Deluxe Bose Sound System 40-Watt Amplifier, Compact Multi-Disc Changer, 9-Band Equalizer, AM/FM/Cassette Radio w/Wireless CD Changer Remote, Speaker System

Entertainment Center (Patio) AM/FM/Cassette Deck, Speakers (2), DC Receptacle, 110-V Outlet, TV Jack, Radio Antenna, Folding Lawn Chairs (2)

Satellite System Pre-Wiring Roof

Satellite System Digital w/Dish & Crank◆

Satellite System w/Receiver Digital w/Dish & Crank◆

Stereo Power Switch For Main or Auxiliary Battery Use

Stereo System AM/FM/Cassette, Digital Alarm Clock, Rear

Stereo w/Digital Clock (Cab) Deluxe Electronic Tune AM/FM/Cassette Deck w/Auto Reverse, Seek Feature, Speakers (4)

Stereo w/Digital Clock (Cab)* Deluxe Compact Disc Player, AM/FM Radio, Speakers (4)

Telephone Jacks Internal (2)

TV (13" Color) w/Remote Located in Bedroom

TV (19" Color) w/VCR & Remote Switching System, Inverter, Remote Speakers

TV Entertainment Package Amplified Antenna System, Coax Wiring, Cable Input, Interior Antenna Jacks (2), Exterior Antenna Jack, Receptacles, Rear TV Cabinet

Interior

Carpeting w/Pad Stain Resistant w/Scotchgard™ Protector

Ceiling Lights Fluorescent, Recessed

Clock Decorator Style

Color Themes (Interior) Choice of Cabernet (Burgundy), Silver Aspen (Light Teal), Windsor (Blue) or Cappuccino (Taupe), All w/Choice of Pickled Ash or Salem Cherry Woodgrain

Divider Sliding Doors (2) Wood

Lamps Decorator Style, Wall-Mounted in Lounge

Pictures (2) Framed

Vacuum Cleaner (Central)

Washer/Dryer Combination

Window Coverings Day/Nighter Pleated Blinds

Window Coverings 2" Wood Blinds (Standard in Galley Only)

Windows Tinted, Dual-Glazed, Thermo-Insulated

Galley

Coffee Maker

Cutting Board Slideout

Dishwasher* Built-In under Counter

Flooring (Premium Vinyl)

Galley Rail

Icemaker*

Lighting Decorative

Lighting under Cabinet, Fluorescent

Microwave/Convection Oven w/Range Fan Touch Control

Pantry Upper & Lower Roll-Out Racks w/Adjustable Baskets

Paper Towel Holder

Range Cover Solid Countertop Material, Flush w/Counter

- Range Top*** 2 Burners, 1 High Output, Recessed, w/2 Pull-Out Utility Trays ▶
- Refrigerator/Freezer** Large, Double-Door, Flush-Mounted ▶
- Refrigerator/Freezer w/Icemaker** Large, Double-Door, Flush-Mounted ▷
- Silverware Tray** ▶
- Sink** Stainless Steel, Large & Small Compartment, Recessed w/Countertop Covers (2) ▶
- Spice Rack** ▶
- Utility Basket w/Towel Holder** ▶
- Utility Tray** Tip Out ▶
- Vent** Powered ▶
- Wastepaper Basket** w/Pull-Out Tray ▶
- Water Purification System** Everpure® ▶

Bedroom

- Bed Lifts** Gas Springs ▶
- Bedsread, Pillow Shams, Pillows, Throw Pillows (4)** ▶
- Headboard** Fabric ▶
- Lamps (2)** Decorator Style, Wall-Mounted ▶
- Mattress** Sealy Innerspring ▶
- Mirror** Wall-Mounted (Back Wall) ▶
- Wainscoting** ▶
- Wardrobe** Mirrored Doors, Carpeted Floor, Clothes Rod, Wooden Drawers (4), Shelf, Cedar Lining, Light ▶

Bathroom

- Flooring (Premium Vinyl)** ▶
- Lavatory Cabinet** ▶
- Medicine Cabinet** Corner w/Mirrored Door ▶
- Mirror (Wall)** ▶
- Mirrors (2)** Wall-Mounted ▶
- Shower Door (Textured Glass)** ▶
- Shower/Tub** Wall Surround ▶
- Sink** Large Oval, Solid Surface Material ▶
- Skylight** ▶
- Soap Dish** ▶
- Tissue Holder** Recessed ▶
- Toilet w/Sprayer** Porcelain (Elongated Bowl) w/Foot Pedal ▶
- Toothbrush & Tumbler Holder** ▶
- Towel Rings (2)** ▶
- Vent** Powered ▶
- Wainscoting** ▶
- Water Pump Switch** ▶

Exterior

- Awning* (Acrylic)** 21' (NA in Canada) ▶
- Awning Rail** ▶
- Bumpers** Rustproof, Steel Reinforced ▶
- Door Bell** ▶
- Entrance Door Locks (2)** Latch, Deadbolt ▶
- Entrance Door Steps (Electric)** w/Door Jamb Switch ▶
- Entrance Door w/Screen Door** ▶
- Fuel Fill Doors** Lockable ▶
- Generator Access** Pull-Out ▶
- Holding Tanks (Heated Compartment)** ▶
- Ladder** ▷
- Mud Flaps** Rear ▶
- Outlet** 110-V, Curbside ▶

- Porch Light** Interior Switch ▶
- Refrigerator/Freezer** Portable ▷
- Service Center** Wash Station, Paper Towel Dispenser, Soap Dispenser ▶
- Sewer Hose & Storage Compartment** ▶
- Slideout Storage Tray** 42" x 90", Spring Loaded Latches, 1,000 lb. Capacity ▷
- Stepwell Light** Interior Switch ▶
- Storage Compartments** Floor & Side Carpet Lining, Lights, Galvanized Steel Construction, Insulated Doors w/Gas Cylinder Supports, Locking ▶
- Tire Tools** Wrench, Leverage Bar, Tire Hoist Rod ▶
- Trailer Towing Package** w/Class III Hitch ▶
- Trailer Wiring Extension** ▶
- Trailer Wiring Socket** ▶
- Wheels (Stylized)** Aluminum ▶

Systems

- Air Conditioner (Central)** Remote Cooling Unit, Ceiling Distribution ▶
- Batteries (4)** Chassis Batteries Located on Exterior Pull-Out Tray, Coach Batteries in Stepwell Compartment ▶
- Battery Charger (Solar)** 10-Watt ▶
- City Water Hook-Up** ▶
- Drain System** Telescoping, Thetford® ▶
- Electrical Control Center** AC & DC Breaker Panel, 55-Amp. Remote Converter/Charger* ▶
- Furnace** Ducted, Low Profile, Electronic Ignition, 40,000-BTU ▶
- Furnace Ducting System** Rigid, below Floor ▶
- Generator** 7,500-Watt, Diesel ▶
- Generator/Shoreline Changeover Switch** Automatic ▶
- Inverter** AC/DC, 100-Watt ▶
- Inverter/Charger** Heart Interface, AC/DC, 2,000-Watt, Remote Panel, Additional Battery ▷
- Leveling System by HWH®** 4-Point, Automatic Controls ▷
- LP Tank** Permanent Mount w/Gauge ▶
- Monitor Panel** Water, Holding & LP Tank Levels, Battery Condition Gauge, Water Heater Ignition Switch w/Pilot Indicator Light, Water Pump Switch, Located in Galley ▶
- Power Cord** 50-Amp. ▶
- Water Heater** 6-Gal., Electronic Ignition, Motoraid ▶
- Water Heater Winterization By-Pass Valve** ▶
- Water Pump (Demand)** ▶
- Water System Winterization Kit** Automatic, 12-V Control Panel, Anti-Freeze Tank ▷

Safety

- Assist Handle*** Exterior ▶
- Assist Strap** Interior ▶
- Carbon Monoxide Detector/Alarm** ▶
- Fire Extinguisher (10-B.C.)** ▶
- Ground Fault Interrupter** ▶
- LP Leak Detector/Alarm** ▶
- Smoke Detector/Alarm** ▶
- Three-Point Seat Belts** w/Retractors ▶

▶ **Standard** ▷ **Optional**

† The height of each model is based on the curb weight of a typically equipped unit on the standard chassis. The actual height of your vehicle may vary by as much as 2" depending on chassis or equipment variations.

▼ The Luxor features a widebody design - over 96". In making your purchase decision, you should be aware that some states restrict access on some or all state roads to 96" in body width. Before making your purchase decision, you should confirm the road usage laws in the states of interest to you.

* Not all options available in combinations. See dealer for details.

◆TV satellite system options do not include programming activation. Quality reception is only available in the lower 48 States. System not available in Canada.

Winnebago Industries' continuing program of product improvement makes specifications, equipment, model availability and prices subject to change without notice.

The benefits of ownership

When you purchase a 1996 Luxor, you're buying much more than just the vehicle itself. You're also getting a free one-year membership in Winnebago Industries' Preferred Care Program. Membership can be extended through membership in the



WIT Club. This unique program gives you 24-hour referral to any of our

20,000-plus factory authorized dealer locations across North America and Luxor coverage includes free battery jump-start, tire change, fuel delivery and lockout assistance. Plus our warranty program is the most comprehensive in the industry, starting with 12-month or 15,000 mile protection. Our sidewalls and backwall are so strong, they're covered by a limited warranty for 36-months/36,000 miles. And the roof is protected by a 10-year limited parts and labor warranty.

The Winnebago-Itasca Travelers (WIT) Club was designed to help you get the most out of your Luxor. WIT



gives you the opportunity to meet other Winnebago Industries motor home owners and take part in organized rallies, caravans and trips. WIT also provides specialized club services like professional trip routing and mail forwarding.

Your Luxor is also your ticket to life in the fast lane — auto racing. As the Official Motor Homes of NASCAR,



Winnebago Industries has created quite a presence at racetracks all across the country. A growing number of NASCAR and NHRA drivers are joining the Winnebago Motorsports Team. You can join, too. As a member you'll receive a quarterly newsletter and exciting racing merchandise along with once-in-a-lifetime opportunities to participate in special on-track events at selected races.

Finally, we'd like to meet you. Please join us at our headquarters in Forest City, Iowa, for a free factory tour. Call (515) 582-3535 for more information.

For Luxor Sales and Service, Contact:

L U X O R
Built Proudly by 