

ULTIMATE ADVANTAGE™



38K

1 9 9 9

WINNEBAGO
INDUSTRIES

THE ULTIMATE COMFORT

Introducing the 1999 Ultimate Advantage, an all-new luxury widebody diesel pusher motor home from Winnebago Industries — the most recognized name in motor homes. The Ultimate Advantage brings great value to the luxury class of motor homes, offering the most sought after features at a price well below many similarly equipped coaches. However, value pricing is not the only feature setting this new motor home apart. The Ultimate Advantage is designed around a custom chassis developed in conjunction with Freightliner utilizing our innovative and exclusive **ULTI-BAY** construction which provides an incredible amount of exterior storage space.

This is just one of many innovations and advantages built into the Ultimate Advantage — the luxury class motor home that truly lives up to its name.

38K



Finishing touches inside the coach are classic, with solid wood dovetailed cabinet drawers, stile and rail cabinet doors with raised panel inserts, solid surface countertops, premium floorcoverings, and custom furniture richly upholstered in the finest fabrics and leather. Interior comfort is maintained by the sub-floor mounted high-efficiency central air conditioning unit and integrated ceiling distribution system. The driver's area includes a Sony® RearVision monitor system with one-way audio and a 7" in-dash monitor for safety when backing up.

38K



Ultimate Advantage's convenient front entry design includes a powered interior entrance well cover, six-way power assist driver's seat and an available "luxury lounge" leather passenger seat.

38K



Free-standing chairs provide a comfortable dining environment and a self-storing leaf quickly extends from the table for those times when you're entertaining guests. Both are examples of the "home comfort design" built into the Ultimate Advantage.

INTERIOR COLOR THEMES

Colors are displayed with the main fabric on top followed by the accent fabric, maple or cherry wood choices, and carpeting.

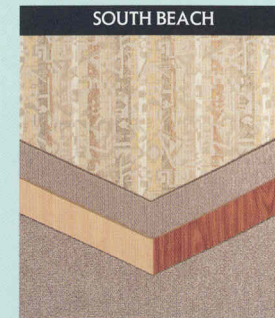
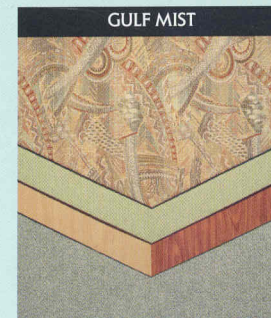
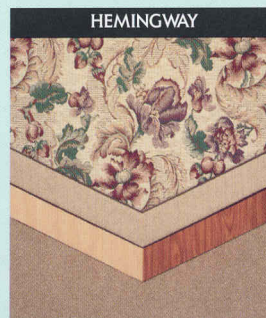



40J



The well equipped galley includes such luxuries as a large double-door refrigerator/freezer with icemaker, roll-out pantry with locking slides, solid surface countertops, coffee maker and an Everpure® water purification system with separate faucet.



40J

The spacious bathroom includes premium vinyl flooring, solid surface countertops, recessed solid surface sinks, a polished brass single lever control faucet, and full sliding pocket doors. An added luxury of the 40J is the second lavatory.



40J

38K

Ultimate Advantage's spacious widebody floorplans offer something for everyone. The innovative **STOREMORE™** Hydraulic Slideout System includes the galley/sofa area. The easy-to-care-for vinyl wood plank flooring used in the galley/dinette area offers both beauty and durability and is the perfect accent to the hand finished woodwork and custom furniture used in the coach.

The bedroom features a 60" x 80" residential queen size bed with an innerspring mattress from Serta® that accepts standard-sized bedding. Gas spring supports provide easy access to the engine enclosure and storage area. For added storage, shirt closets are located above the nightstands.

This large residential style roll-out pantry with locking slides is another example of the user-friendly design built into the all-new Ultimate Advantage.

38K



The available vented combination washer/dryer includes a new larger drum to reduce drying cycle time. When not in use, the washer/dryer resides out of sight behind wooden louvered doors.

40J



38K



Living area features include a 25" color TV with remote (versus the 19"-20" units on competitive models), VCR with remote, deluxe sound system, TV antenna and video selection system. As an added benefit, Ultimate Advantage is satellite system ready.

For easy cleaning, a central vacuum system with a 30' hose and multiple accessories is available.

38K



40J



An enclosed toilet area provides additional privacy.

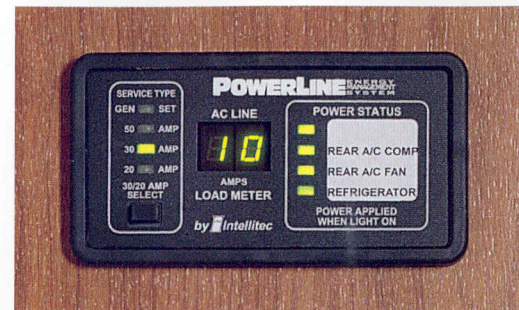

The Ultimate Advantage includes the innovative **POWERLINE** Energy Management System. This fully automated system has the ability to run the air conditioner and numerous electrical loads at the same time when utilizing 30 amp. service by monitoring the usage of 120 volt power and redistributing it as needed.

CONSIDER IT AN ADVANCED EDUCATION IN MOTORHOMES

There's much more to buying a motor home than simply finding one with comfortable furniture and inviting interior fabrics (although those things are important). In fact, we recommend people spend as much time examining the motor home's "unseen" features as they do looking over the interior appointments. For instance, there's a great

deal you can learn about how well a motor home is constructed by simply looking inside the storage compartments.

To help make your buying decision easier, we've put together a user-friendly guide which lists the most important things you should be looking for in a motor home, no matter what make or model it is. "The Guide" also highlights the importance of meeting (and exceeding) industry

standards, explains Winnebago Industries' one-of-a-kind construction process and details our industry-leading warranty and care programs. So ask for "The Guide" the next time you visit your Winnebago Industries dealer. This "advanced education" will definitely pay off down the road.

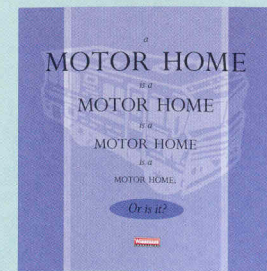

THE ULTIMATE POWER

Ultimate Advantage's power is supplied by a standard 275 hp Caterpillar engine or available 300 hp Caterpillar (300 hp is standard on the 40J).



Additional features setting Ultimate Advantage apart include the Tri/Mark KeyOne™ program, which utilizes one key for the main entrance door, fuel fill doors, and all lower compartment doors, and our ten watt solar panel battery charger (twice as large as the five watt charger found on competitive models).



Exterior paint packages are Teal — recommended with Gulf Mist interior color theme, and Taupe — recommended with Hemingway and South Beach interior color themes. You may order either exterior color, regardless of your interior choice.



40J

The high gloss painted fiberglass exterior, sleek body lines, stylized aluminum wheels and dual glazed windows with gray tint combine to give Ultimate Advantage a look all its own. Available window awnings take the Ultimate Advantage appearance one step further. For easy fueling, Ultimate Advantage includes two fuel fills — one on each side of the coach. The automatic HWH® hydraulic jacks make leveling quick and easy.



40J

Our **ULTI-BAY** exterior storage design is the result of Ultimate Advantage's exclusive innovative chassis. The enormous main storage compartment includes an available smooth rolling storage tray for easy access to stored items.



40J

Slideout storage compartments feature our ingenious **STOREMORE™** Hydraulic Slideout System — the original high storage slide system allowing full-size storage compartments to extend with the slideout room. For long-term reliability, the **STOREMORE™** system features HWH® Spacemaker hydraulics.



40J

The exterior service center combines water and drainage facilities to provide easy access to system controls. This convenient compartment houses a secondary monitor panel for instant access to tank levels.

1999 Ultimate Advantage Specifications

	38K	40J
Length	37'11"	39'11"
Exterior Height†	12'2"	12'1"
Exterior Width*	8'5.5"	8'5.5"
Interior Height	6'8"	6'8"
Interior Width	8'0.5"	8'0.5"
Fuel Capacity	125 gal.	125 gal.
Fresh Water Capacity w/Heater	109 gal.	109 gal.
Holding Tank Capacity - Black/Gray	50/54 gal.	50/54 gal.
LP Capacity◇	39 gal.	39 gal.
GVWR	27,410 lbs.	29,410 lbs.
Wheelbase	243"	267"
Exterior Storage	155.4 cu. ft.	184.5 cu. ft.

AUTOMOTIVE

	38K	40J
Air Suspension (Chassis Supplied)	S	S
Chassis (Freightliner) CAT 275 H.P. Turbo-Diesel, Jacobs Extarder Exhaust Brake, Rear Radiator, Allison MD3060 World Transmission	S	
Chassis (Freightliner) CAT 300 H.P. Turbo-Diesel, Jacobs Extarder Exhaust Brake, Allison MD3060 World Transmission	O	S
Tires (Radial)	S	S

DRIVER CONVENIENCES

	38K	40J
12-V Electrical Supply/Lighter & Aux. 12-V Electrical Supply	S	S
Battery Disconnect Coach	S	S
Cabinet Center Console	S	S
Courtesy Blink Switch	S	S
Cruise Control	S	S
Daytime Running Lamps	S	S
Defroster Fans (2) Auxiliary, 2-Speed	S	S
Door Lock (Power) Remote Controlled, Main Entry	S	S
Dual Battery Charge Control Automatic	S	S
Floor Mat Driver	S	S
Fog Lamps	S	S
Heating/Air Conditioning Automotive Blend Air System, Rotary Controls	S	S
Hood Light	S	S
Hood Release Exterior Key Locks	S	S

	38K	40J
Horns (Air) Roof Mounted	O	O
Lamps (2) Docking	S	S
Leather Driver & "Luxury Lounge" Passenger Seat w/Vinyl Surround	O	O
Map Light (2)	S	S
Mirrors (Rear View) Electronically Controlled, Heated	S	S
Motor Cover Steel Enclosure w/Sound Deadening (Located under Queen Bed)	S	S
Rear View Monitor System Video, 1-Way Audio	S	S
Seats 3-Point Retracting Seat Belts, 6-Way Power Assist (Driver Seat)	S	S
Service Light Driver Side	S	S
Shade Pleated, Front Wrap-Around	S	S
Squeegie Stored under Hood	S	S
Start Circuit Auxiliary	S	S
Steering Power Assisted w/Tilt Wheel	S	S
Steering Wheel (Custom)	O	O
Storage Cabinet (Front Overhead)	S	S
Sunvisors	S	S
Window Shades Light Filtering (Cab Side Windows)	S	S
Window (Sliding) Driver, w/Screen, Dual-Glazed	S	S
Windshield Wipers (Intermittent) Pantographic	S	S

ENTERTAINMENT

	38K	40J
Antenna (Radio) Roof-Mounted, Flexible Rubber	S	S
C.B. Prep Kit Antenna, Coax Wiring, 12-V Power Connection	S	S
CD Multi-Disc Changer (Panasonic®) w/Remote Control	O	O
Deluxe Sound System Amplifier, Cube Speaker System, Equalizer	S	S
Entertainment Center (Patio) AM/FM Cassette Deck, Speakers (2), DC Receptacle, 110-V Outlet, TV Jack, Radio Antenna	S	S
Entertainment Center (Patio) Compact Disc Player (Exchange For Cassette)	O	O
Satellite System Pre-Wiring Roof	S	S
Satellite System♦ Manual, Digital w/Dish & Crank	O	O
Satellite System♦ Power, Digital w/Dish (N/A in Canada)	O	O
Stereo Power Switch For Main or Auxiliary Battery Use	S	S
Stereo System Rear w/2 Speakers, AM/FM Cassette	O	O
Stereo System Rear w/2 Speakers, AM/FM Cassette, Compact Disc Player	O	O
Stereo w/Digital Clock (Cab) Electronic Tune AM/FM Cassette Deck w/Auto Reverse, Seek Feature, Speakers	S	S
Stereo w/Digital Clock (Cab) Electronic Tune AM/FM Compact Disc, Seek Feature, Speakers	O	O
Telephone Jacks Internal (2)	S	S
TV Entertainment Package Amplified Antenna System, Coax Wiring, Cable Input, Interior Antenna Jacks (2), Exterior Antenna Jack, DC Receptacles (2), TV Shelf	S	S
TV (19" Color) w/Remote Located in Bedroom	O	O
TV (25" Color) w/VCR & Remote Video Selection System, Remote Speakers, Located in Front	S	S

SLIDEOUT

	38K	40J
Slideout Room (Driver Side) StoreMore, Galley/Sofa Area	S	S

INTERIOR

	38K	40J
Carpeting w/Pad Stain Resistant	S	S
Ceiling Lights Fluorescent, Recessed	S	S
Color Themes (Interior) Hemingway (Taupe), Gulf Mist (Seagreen), South Beach (Sand), All w/Choice of Maple or Cherry Woodgrain	S	S
Courtesy Lights (2) Along the Floor w/Wall Switches	S	S
Leather Furniture* Sofa (Leather w/Fabric Insert) Banquette* (Leather w/Vinyl Surround) Lounge Chair* (Leather w/Vinyl Surround)	O	O
Vacuum Cleaner (Central)	O	O
Washer/Dryer Combination	O	O
Windows Tinted, Dual-Glazed, Thermo-Insulated	S	S

GALLEY/DINING

	38K	40J
Appliance Storage Cabinet Roll-Up Tambour Door		S
Coffee Maker	S	S
Countertop Solid Surface	S	S
Cutting Board Slideout	S	S
Dishwasher* Built-In under Counter	O	O
Flooring (Premium Vinyl Plank) Woodgrain	S	S
Lighting Decorative	S	S
Lighting under Cabinet, Fluorescent	S	S
Microwave/Convection Oven w/Range Fan Touch Control	S	S
Pantry	S	S
Range Cover	S	S
Range Top (Maytag®) 3 Burners, Recessed	S	S
Range Top (Maytag®) w/Large Oven 3 Burners, Recessed	O	O
Refrigerator/Freezer w/Icemaker Large, Double Door	S	S
Refrigerator/Freezer w/Icemaker Large, Four Door	O	O
Silverware Tray	S	S
Sink Stainless Steel, Large & Small Compartment, Recessed w/Countertop Covers (2), Single Control Faucet	S	S
Table & Chairs (4) w/Removable Leaf	S	S
Towel Rack	S	
Utility Tray Tip-Out	S	

EXTERIOR

	38K	40J
Ventilator Fan Powered w/Thermostatic Wall Controls	S	S
Wastepaper Basket	S	S
Water Purification System (Everpure®)	S	S

BEDROOM

	38K	40J
Bedspread, Pillows, Throw Pillows (2)	S	S
Headboard Fabric	S	S
Lamps (2) Decorative, Wall-Mounted	S	S
Mattress (Serta®) Innerspring, Queen	S	S
Mirror Wall-Mounted (Back Wall)	S	S
Picture	S	S
Queen Bed Cabinet Bed Base w/Bed Lift, Gas Springs	S	S
Wainscoting w/Chair Rail	S	S
Wardrobe Mirrored Doors, Carpeted Floor, Wooden Clothes Rod, Shelf, Cedar Lining, Light	S	S

BATHROOM

	38K	40J
Flooring (Premium Vinyl)	S	S
Lavatory Cabinet	S	S
Linen Cabinet	S	S
Make-Up Lights (4 Bulbs) 2	S	S
Medicine Cabinet Wood w/Mirror	S	S
Mirrors (2) Wall-Mounted		S
Roof Vent Fan, Lift, Remote Switch	S	S
Shower Door (Textured Glass)	S	S
Shower/Tub Wall Surround	S	S
Sink Lg. Oval, Solid Surface Material	S	S
Sink Sm. Oval, Solid Surface Material		S
Skylight	S	S
Tissue Holder Recessed	S	S
Toilet w/Sprayer Porcelain (Elongated Bowl) w/Foot Pedal	S	S
Towel Bar	S	S
Towel Ring (2 on 40J)	S	S
Ventilator Fan Powered	O	O
Water Pump Switch	S	S

	38K	40J
Awning* Patio	O	O
Awning Rail (Passenger Side)	S	S
Awning Slide Room Cover	S	S
Awnings* Window	O	O
Bumpers Steel Reinforced	S	S
Entrance Door Locks (2) Latch, Deadbolt	S	S
Entrance Door Step (Electric)	S	S
Entrance Door w/Screen Door Sliding Step Filler Panel	S	S
Fiberglass Skin Smooth, One-Piece, High Gloss	S	S
Fuel Fill Doors (2) Lockable, L.H., R.H.	S	S
Generator Access Pull-Out	S	S
Graphics Package Choice of Teal (Recom. w/Gulf Mist) or Taupe (Recom. w/Hemingway or South Beach)	S	S
Holding Tanks (Heated Compartment)	S	S
Ladder	O	O
Mud Flaps Rear (2)	S	S
Mud Guard Full Width, Rear	O	O
Outlet 110-V	S	S
Porch Light w/Interior Switch	S	S
Service Center (Electrical) Cable TV Input, Power Cord, Automatic Generator/Shoreline Changeover Switch, Telephone Input	S	S
Service Center (Water) Wash Station w/Water Pump Switch, Paper Towel Dispenser, Soap Dispenser, Glove Holder, Holding Tank Flushing System (Black Tank Only), Monitor Panel, City Water Hook-Up, Tank Diverter Fill, Drainage Valves, Sewer Hose, Fresh Water System Drain	S	S
Slideout Storage Tray	O	O
Spotlight Roof Mounted w/Electric Controls	O	O
Stepwell Light w/Interior Switch	S	S
Storage Compartments Floor & Side Carpet Lining, Lights, Electrodeposition Coated Steel, Insulated Doors w/Gas Cylinder Supports, Locking	S	S
Trailer Towing Package w/Hitch	S	S
Trailer Wiring Fixed Mount Female Socket & Male Trailer Plug Connector	S	S
Wheel Liners Stainless Steel	S	
Wheels (Stylized)* Aluminum	O	S

SYSTEMS

	38K	40J
Air Conditioner - Central Remote Cooling Unit, Ceiling Distribution, Wall Thermostat	S	S
Batteries (3) Deep Cycle	S	S
Battery Charger (Solar) 10-Watt	S	S
City Water Hook-Up	S	S
Electrical Control Center AC & DC Breaker Panels	S	S
Furnace (Auxiliary) Ducted Below Floor, Low Profile, 25,000-BTU	O	O
Furnace Ducted Below Floor, Low Profile, 35,000-BTU	S	S
Generator (Onan® Marquis) 6,500-Watt, LP Fueled	S	S
Generator (Onan Quiet Diesel™) 7,500-Watt	O	O
Hydraulic Leveling Jacks Front & Rear, Automatic Controls	S	S
Inverter/Charger (Heart Interface®) DC/AC, 1,500-Watt, Remote Panel	S	S
LP Tank Permanent Mount w/Gauge	S	S
Monitor Panel Water, Holding & LP Tank Levels, Battery Condition Gauge, Water Heater Ignition Switch w/Pilot Indicator Light, Water Pump Switch, Generator Hourmeter Gauge, Generator Start/Stop Switch, Located in Galley	S	S
Power Cord 50-Amp., Detachable	S	S
PowerLine Energy Management System	S	S
Water Heater (Suburban®) 10-Gal., Electronic Ignition, 120V AC/LP Gas	S	S
Water Heater Winterization By-Pass Valve	S	S
Water Pump (Demand) Accumulator Tank	S	S
Water System Winterization Valve Manual	S	S
Water Winterization System (Fresh) Automatic, 12-V Control Panel, Anti-Freeze Tank	O	O

SAFETY

	38K	40J
Assist Bars (2)	S	S
Assist Handle* Exterior	S	S
Carbon Monoxide Detector/Alarm	S	S
Center High Mount Brake Light	S	S
Escape Window	S	S

	38K	40J
Fire Extinguisher (10-B.C.)	S	S
Ground Fault Interrupter	S	S
Lap Belts in Selected Areas	S	S
LP Leak Detector/Alarm	S	S
Smoke Detector/Alarm	S	S
Three-Point Adjustable Retracting Shoulder & Lap Seat Belts Driver/Passenger Seats	S	S
Windshield Laminated Safety Glass	S	S

† The height of each model to the top of the ladder is based on the curb weight of a typically equipped unit on the standard chassis. The actual height of your vehicle may vary by as much as 2' depending on chassis or equipment variations.

▼ The Ultimate Advantage features a widebody design – over 96". In making your purchase decision, you should be aware that some states restrict access on some or all state roads to 96" in body width. Before making your purchase decision, you should confirm the road usage laws in the states of interest to you.

◇ Capacities shown are tank manufacturer's listed water capacity (W.C.). Actual filled LP capacity is 80% of listing due to safety shut-off required on tank.

S Standard

O Optional

◆ TV satellite system options do not include programming activation or receiver. Quality reception is only available in the lower 48 states.

* Not all options available in combinations. See dealer for details.

Winnebago Industries' continuing program of product improvement makes specifications, equipment, model availability, and prices subject to change without notice.

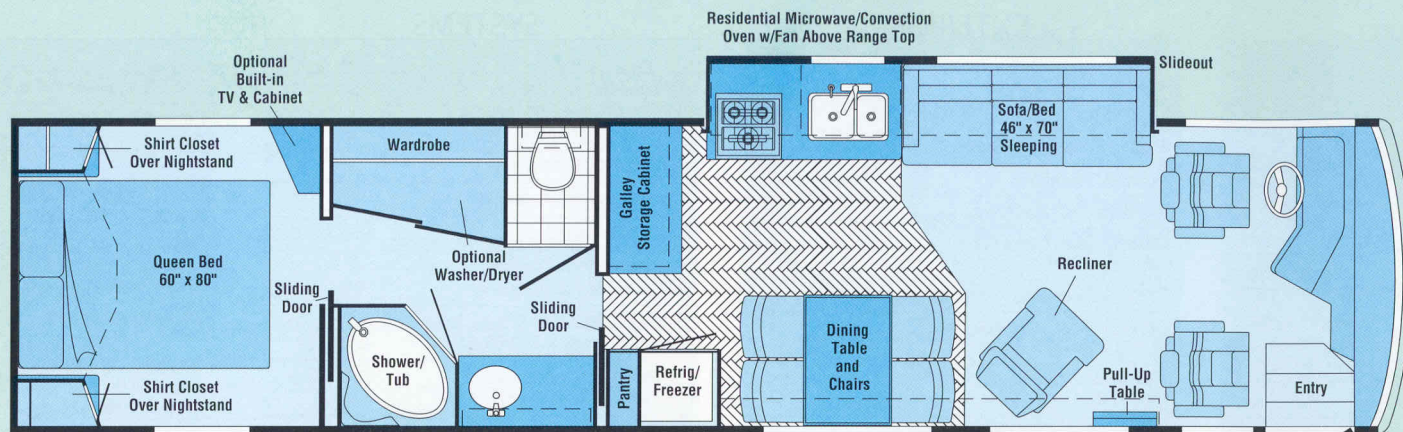

38K

This galley and sofa/bed slideout model offers a tremendous amount of living space. Includes an available 4-door refrigerator/freezer, and a banquette sofa in place of the recliner and pull-up table.

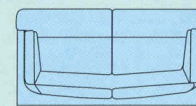

Banquette



Standard Premium Vinyl



Standard Premium Vinyl Plank Woodgrain

Note: Dimensions shown are for sleeping space only and dashed lines denote overhead storage areas.

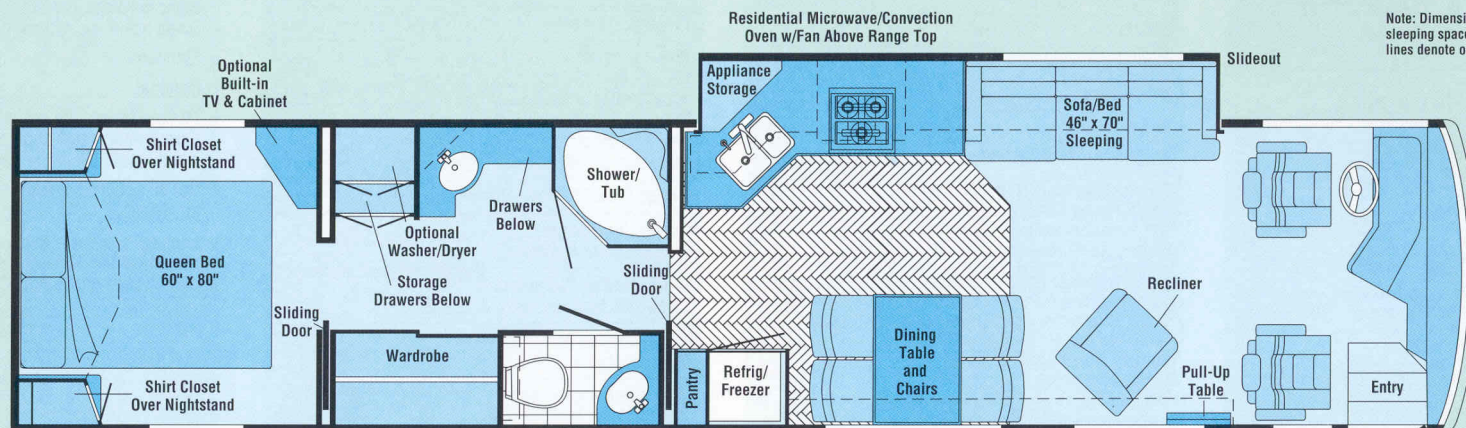

40J

This spacious floorplan features a slideout which includes an angled galley and a sofa/bed. The luxurious bathroom offers an angled shower/tub and two separate sinks. Includes an available 4-door refrigerator/freezer, and a banquette sofa in place of the recliner and pull-up table.

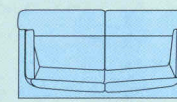

Banquette

For Sales and Service Information Contact:



Seat belts are your most important hookup. Always buckle up.