

Four Winds

Class C Motorhomes

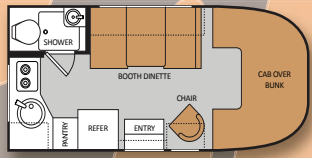

19G

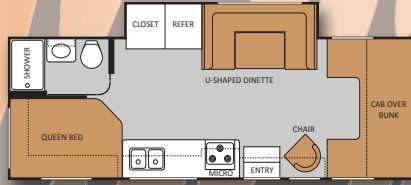

25C

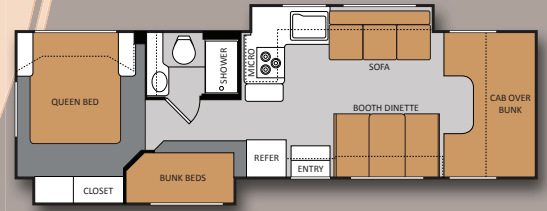

31A

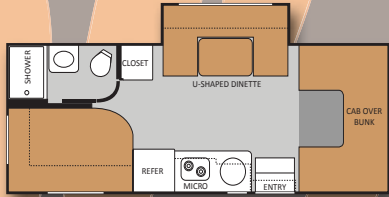

23S

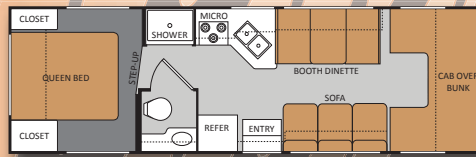

28A MEGA STORAGE

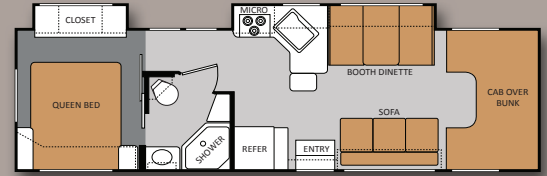

31F NEW FLOOR PLAN

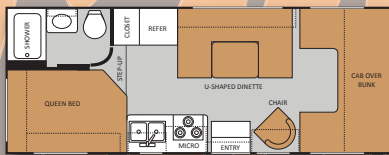

23U MEGA STORAGE

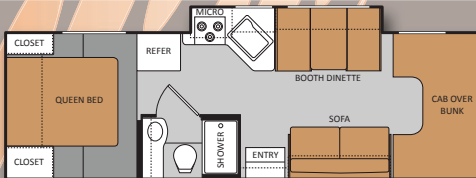

28Z MEGA STORAGE

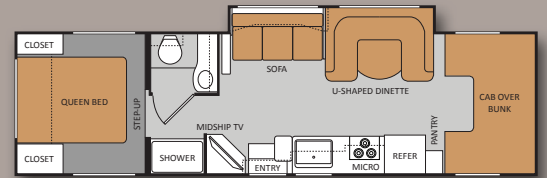

31K

Specifications

Model	19G	23S	23U	25C	28A	28Z	31A	31F	31K
Ford Chassis with Triton engine	5.4L/V-8	N/A	6.8L/V-10	6.8L/V-10	6.8L/V-10	6.8L/V-10	6.8L/V-10	6.8L/V-10	6.8L/V-10
Gross Vehicle (GVWR)	10,050	N/A	12,500	14,500	12,500	14,500	14,500	14,500	14,500
Gross Combined (GCWR)	13,000	N/A	18,500	22,000	18,500	22,000	22,000	22,000	22,000
Chevy Chassis with 6.0L Vortec engine	N/A	N/A	V-8	V-8	V-8	N/A	N/A	N/A	N/A
Gross Vehicle (GVWR)	N/A	N/A	12,300	14,200	12,300	N/A	N/A	N/A	N/A
Gross Combined (GCWR)	N/A	N/A	18,500	20,000	18,500	N/A	N/A	N/A	N/A
Sprinter Chassis with 3.0L diesel engine	N/A	V-6	N/A	N/A	N/A	N/A	N/A	N/A	N/A
Gross Vehicle (GVWR)	N/A	11,030	N/A	N/A	N/A	N/A	N/A	N/A	N/A
Gross Combined (GCWR)	N/A	15,250	N/A	N/A	N/A	N/A	N/A	N/A	N/A
Exterior Length without ladder (Ford)	19'10"	24'9"	24'10"	27'4"	29'9"	29'11"	32'2"	32'2"	32'7"
Exterior Length without ladder (Chevy)	N/A	N/A	25'4"	27'11"	30'3"	N/A	N/A	N/A	N/A
Exterior Height (with air conditioning)	10'3"	11'	10'10"	10'10"	10'10"	10'10"	10'10"	10'10"	10'10"
Exterior Width (without mirrors)	91"	90"	99"	99"	99"	99"	99"	99"	99"
Interior Height	80"	80"	82"	82"	82"	82"	82"	82"	82"
Awning Size (manual/electric)	8'/-	15'/15'	15'/15'	18'/18'	14'/14'	14'/14'	10'6'/-	16'/16'	16'/16'
Fuel - Ford/Chevy (gallons)	40/-	26.4	55/57	55/57	55/57	55/-	55/-	55/-	55/-
LPG (pounds)	40	68.2	40.9	40.9	40.9	40.9	40.9	40.9	40.9
Fresh/Waste (gallons)	20.5/17	40/38	40/24.5	40/24.5	40/25	40/26	40/26	40/28	40/31
Gray Water (gallons)	16.5	34	38.5	38.5	22	22	31	28/23	29/23
Water Heater (gallons)	6	6	6	6	6	6	6	6	6
Furnace (BTUs)	16,000	25,000	25,000	30,000	30,000	30,000	30,000	30,000	30,000
Exterior Storage Capacity (cubic feet)	6	65	69	69	108	108	53	99	99

WEIGHT RATING (LBS.)

MEASUREMENTS

CAPACITIES

Four Winds Class C Standard & Optional Features

BODY CONSTRUCTION/EXTERIOR

Fully welded tubular aluminum roof and sidewall cage construction	S
Vacu-Bond laminated roof, walls and floors with high-density block foam insulation	S
Slick fiberglass exterior	S
Exterior graphics package	S
Exterior graphics/partial paint package	O
Exterior rear Mega Storage compartment (Select Models)	S
Seamless roto-cast storage compartments	S
Flush mount radius luggage doors	S
Premium one-piece TPO roof	S
Manual patio awning	S
Electric patio awning (N/A 19G & 31A)	O
Slide-out room awning	S
Roof ladder	S
Rubber Tread Entry Steps	S
Drop-down stairwell entrance step (N/A 23S)	S
Automatic electric entrance step (23S Only)	S
Outside shower	O

AUTOMOTIVE/COCKPIT

3,500-lb. trailer hitch (19G & 23S only)	S
5,000-lb. trailer hitch (N/A 19G & 23S)	S
AM/FM dash radio with large buttons, CD player and weather band tuner	S
3-point seat belts for driver and passenger	S
Power window and door locks	S
Deluxe exterior mirrors (N/A on 23S)	S
Deluxe heated remote mirrors (N/A 19G)(Std. 23S)	O
Aluminum running boards (N/A 23S)	S
Fiberglass running boards (23S only)	S

Spare tire (N/A 19G)	S
Aluminum wheels (19G only)	S
Wheel liners (N/A 19G)	O
Cockpit Carpet Mat	O
Power driver's seat (Ford Chassis Only)	O
Leatherette driver and passenger captain's chairs	O
Back-up monitor	O

INTERIOR

Residential linoleum (Galley, Bath and Living Area)	S
Residential Linoleum throughout the coach (19G, 23U & 23S only)	S
Metal entry grab handle	S
Windshield privacy curtain	S
13,500 BTU roof air conditioner in front	S
15,000 BTU roof air conditioner in front (N/A on 19G & 23S)	O
Ceiling ducted air conditioning system (N/A on 19G & 23S)	S
Cherry cabinetry	S
Glazed maple cabinetry	O
Raised panel upper cabinet doors	S
Hardware with Brushed Nickel finish	S
Night shades throughout	S
Vinyl ceiling	S
Fabric barrel chair (Select Models)	S
Leatherette euro recliner with ottoman in place of barrel chair (Select Models)	O
Fabric jackknife sofa (28A, 28Z, 31A & 31F Only)	S
Leatherette jackknife sofa (28A, 28Z, 31A & 31F Only)	O
Leatherette hide-a-bed sofa with air mattress (STD 31K)	S
Booth dinette (N/A 23S, 23U, 25C & 31K)	S
Fabric U-shaped dinette (23S, 23U, 25C & 31K only)	S
Leatherette U-shaped dinette (23S, 23U, 25C & 31K only)	O

Fantastic® fan in kitchen area	O
Fantastic® fan in overhead bunk (N/A on 19G & 23S)	O

GALLEY

Single door refrigerator (19G only)	S
Double door refrigerator (N/A on 19G)	S
2-burner cooktop (19G & 23S only)	S
3-burner high-output gas range top	S
3-burner high-output gas range top with oven (N/A on 19G & 23S)	O
Microwave oven	S
Convection microwave	O
Pantry (31F & 31K Only)	S
Laminate countertops	S
Large single bowl sink (19G & 23S only)	S
Large double bowl sink (N/A 19G & 23S)	S
Flip-up countertop extension (23U, 31A, 31F & 31K only)	S
Full extension metal drawer guides	S

ENTERTAINMENT & ACCESSORIES

19" LCD television on swivel in cab-over (N/A 28Z & 31K)	O
22" LCD television (28Z only)	S
26" television in front overhead with electric swivel in cab-over (N/A 19G, 28Z & 31K)	O
Living room entertainment center w/ 32" LCD television (31K only)	S
19" LCD television in bedroom - can be removed and mounted to exterior hook-ups (N/A on 19G, 23U, 25C & 31A)	O
Two 13" LCD televisions with DVD Player in bunk beds (31A only)	O
Coach radio system with DVD Player (23S only)	O
Television antenna and booster	S

BEDROOM/BATHROOM

Queen-size bed with innerspring mattress (N/A 19G)	S
--	---

Bunk beds in hallway slide room (31A)	S
Bedsread and pillow shams (N/A 19G)	S
China bowl toilet (N/A 19G)	S
Skylight in shower	S
Shower with pleated shower curtain (19G only)	S
Shower with glass door (N/A 19G)	O

SAFETY & CONVENIENCE

Entry door with deadbolt lock	S
Smoke, LPG, carbon monoxide detector and fire extinguisher	S
Passenger seat belts in select areas	S
Child safety seat tether anchor	O
Convenience Package: includes keyless entry and valve stem extenders (N/A on 19G & 23S)	O

ELECTRICAL & PLUMBING

Onan® Microquiet™ 4.0 gas generator (4000-watt)(N/A 23S)	S
Onan® 3.6 LP generator (3600-watt) (Std. 23S)	S
Onan® 3.2KW diesel generator (3200-watts)(23S only)	O
30-amp service with shoreline power cord and battery disconnect switch	S
Automatic generator transfer switch	O
Emergency start switch (N/A 23S)	S
Second auxiliary house battery (N/A 19G)	O
6-gallon DSI gas water heater	S
6-gallon DSI gas/electric water heater	O
Water heater bypass system	S
Holding tanks with heat pads	O

Four Winds



VEHICLE LOADING: Every effort has been made to provide the greatest number of options for the recreation vehicle owner. Along with these choices comes the responsibility to manage the loads that are imposed by the choices so that they remain within the manufacturer's specified chassis weight limits. Do not overload the recreation vehicle.

IMPORTANT: Towing capacity may vary by chassis model, floorplan, options and loading of the vehicle. This may result in a towing capacity which is less than the maximum capacity of the hitch. Do not exceed the vehicle's Gross Combined Weight Rating

(GCWR), or the hitch rating. A separate functioning brake system is required for any towed vehicle or trailer weighing more than 1,000 lbs. (450 KG) when fully loaded. Liquid capacities and weights are approximations only.

WARNING: This information is intended as a guide only. Weights of individual vehicles may vary. Consult your owner's manual and weight sticker affixed to each vehicle for complete loading, weighing, and towing instructions.

WARRANTY: The vehicles are provided with a twelve (12) month, 15,000-mile limited warranty. Chassis,

component part and appliance manufacturers may issue limited warranties covering those portions of the vehicle not covered by the limited warranties issued by Thor Motor Coach. To learn what portions of the vehicle are excluded from coverage under the limited warranties issued by Thor Motor Coach, please contact your selling dealership or Thor Motor Coach directly, or review the warranty packet inside the vehicle.

Product information, specifications, and photography in this brochure were as accurate as possible at time of printing. Photographs may contain some

features that are optional on your vehicle. Since we continually strive to improve our products, actual products may differ. The manufacturer reserves the right, at any time, to make changes in product design, materials, component specifications and pricing, without notice. All capacities are approximate and dimensions are nominal. Some features or options may be different or unavailable in Canada.

