

Apex

By Coachmen

ULTRA LITE TRAVEL TRAILERS



Reaching New Heights



Coachmen
Recreational Vehicles
A division of Forest River, Inc.

Lighten up with Apex!

Apex ULTRA LITE

APEX – LIGHT AND EASY...

Perfect for Smaller Tow Vehicles

Pack up, back up, hitch up and go. Apex Ultra Lights are perfect for towing with half ton trucks and SUVs for optimized fuel efficiency. All Apex floor plans are designed with rich, warm interiors, contemporary cabinetry, fabrics and flooring.

Apex travel trailers and hybrid expandables are built incredibly lightweight and durable, with fully laminated, aluminum framed walls, floor and roof.

The spacious **300BHS** has a 24" deep slide for the ultimate in family vacation living. The private full wall master bedroom has a swivel TV. Shown in Antique Denim décor.

Apex Ultra-Light Travel Trailers are designed for towing with today's half-ton trucks and SUVs, with weights ranging from under 3,000 to 6,000 lbs.









Apex

ULTRA LITE

Apex is available in three decor choices
shown throughout this brochure



The family-friendly, **300BHS** is a spacious, dual slide model that features both a private bedroom and separate bunk house with accommodations for up to ten. It's the perfect lightweight trailer for vacation travelers who want more space.



This convenient outside kitchen includes a Coleman grill, refrigerator, sink and additional storage for outdoor grilling at its best! It's standard on **215RBK** and **300BHS** models.



The **239RBS** is the perfect couples travel trailer, with a queen walk around bed, spacious kitchen, ample counter space, plenty of storage and a large stand up shower with glass door. **239RBS** offers the advantages of a larger model, without added size and weight. Shown in Cinnamon Stone décor.

Apex

ULTRA LITE



Our **Apex Expandables** feature dual queen beds, ample, easily accessible storage and a spacious kitchen. Shown in Midnight Bronze decor.



Light on the environment! ~

A cross-sectional diagram of the AZDEL Onboard construction. It shows three main layers: a white 'Fiberglass Exterior' on the left, a thin 'Decor Interior' layer on the right, and a thick 'Insulation' layer in the middle. Arrows point from the text labels to their respective layers. The AZDEL Onboard logo is in the bottom left corner.

7-1/2 ft. Models

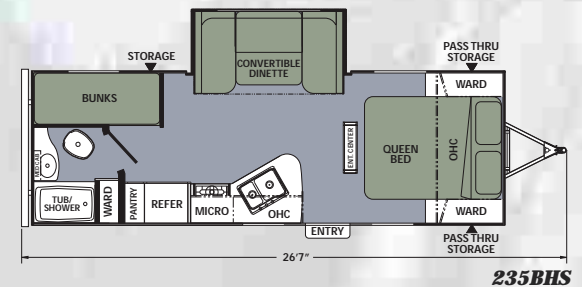
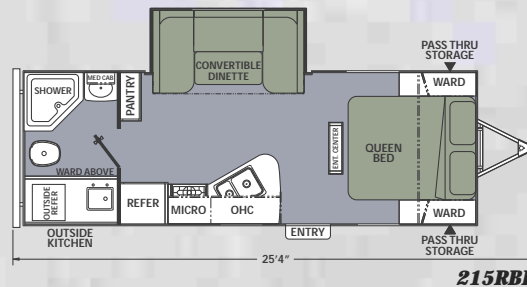
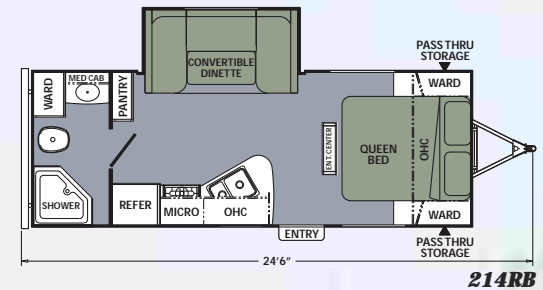
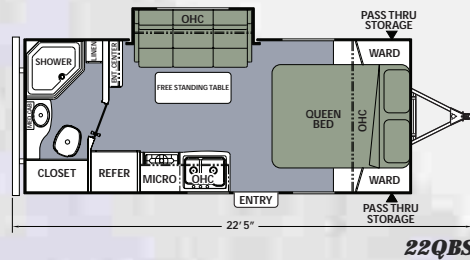

Apex Expandables

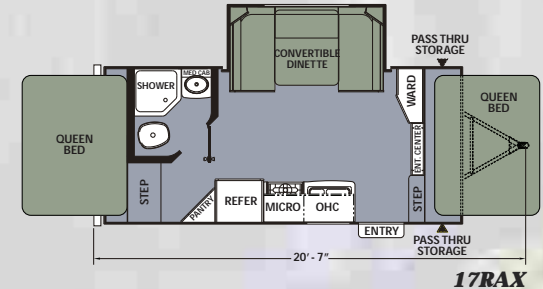
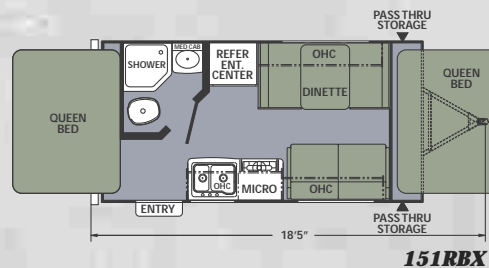
[illegible]

8 ft. Models

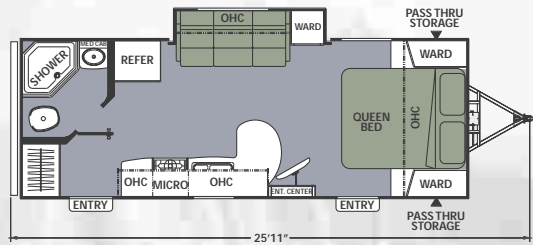
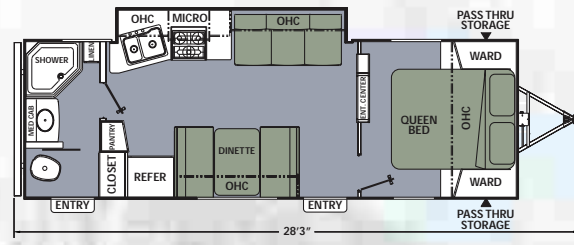
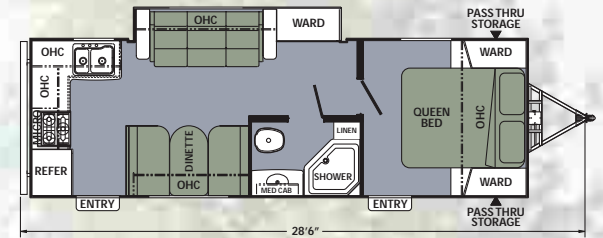
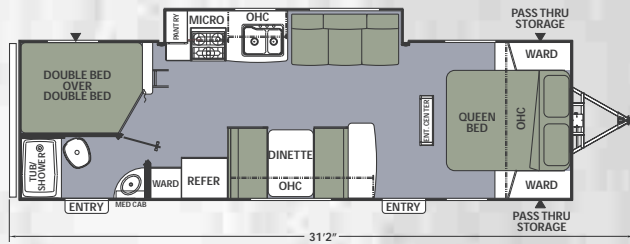
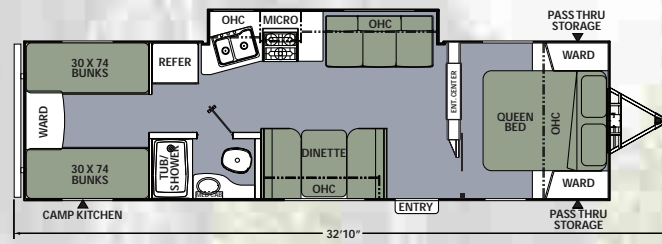
**239RBS****249RBS****258RKS****288BHS**

298BHS

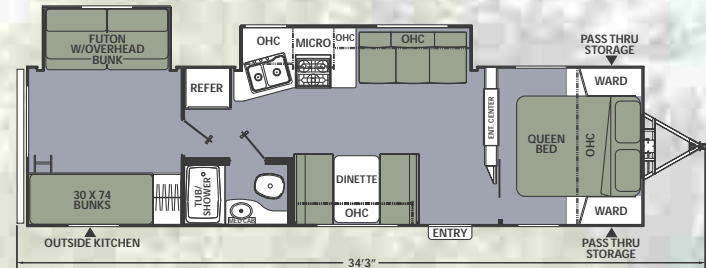

300BHS

8 ft. Deep Slides

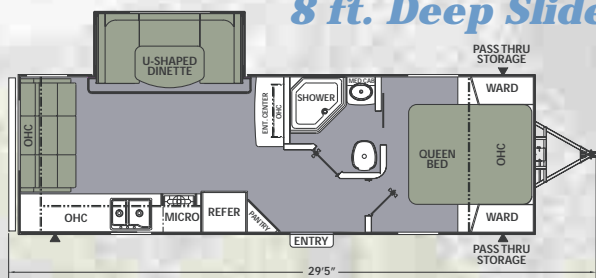
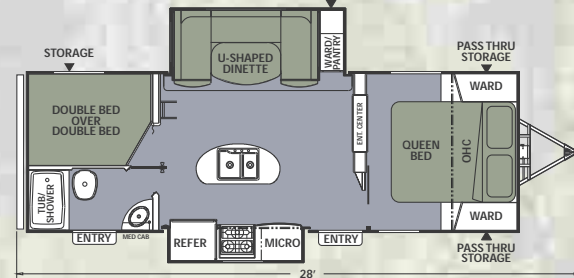
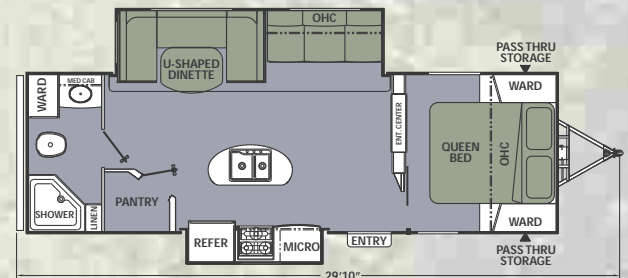
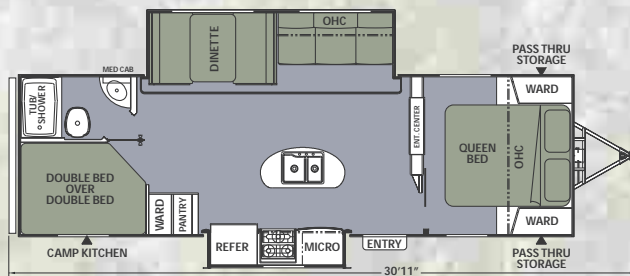
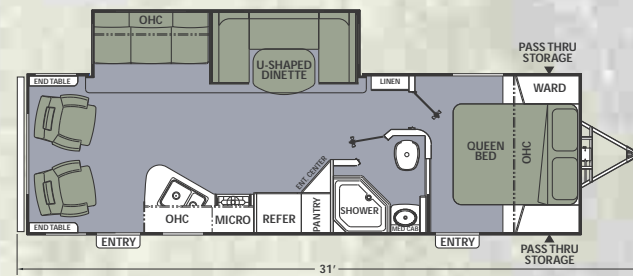
**250RLS****259BHSS****269RBSS****276BHSS****279RLSS**



Standard Features

INTERIOR AND DÉCOR

- ▲ Glazed Grace Cherry cabinetry
- ▲ Overhead bedroom cabinets
- ▲ Sealed edge countertops
- ▲ Congoleum Grand Canyon flooring
- ▲ Mini-blinds – throughout
- ▲ Pedestal dinette table
- ▲ Large oversized booth – U-shaped dinette
- ▲ 68" Residential sofa (Most models)
- ▲ Energy efficient LED interior lighting
- ▲ Hardwood mortise & tenon cabinet door frames
- ▲ Stile & rail cabinet front construction
- ▲ LP leak alarm
- ▲ Fire extinguisher
- ▲ Smoke alarm
- ▲ Carbon monoxide detector

ELECTRICAL/HEATING/AC

- ▲ Furnace – forced air/ducts per floorplan
- ▲ 55 Amp power center (35 Amp on 151RBX)
- ▲ Outside receptacle GFI
- ▲ Patio light
- ▲ TV antenna with cable TV hookups
- ▲ AM/FM/CD player

- ▲ 2 Outside speakers
- ▲ Ducted air conditioner 239RBS & above
- ▲ Detachable power cord

GALLEY

- ▲ Microwave
- ▲ 3-Burner cooktop with oven
- ▲ Double door refrigerator (N/A 151RBX)
- ▲ Power/lighted range hood
- ▲ Brushed nickel hardware
- ▲ Stonecast double bowl sink

BATH AND WATER

- ▲ Power bath vent
- ▲ 6 Gal. Gas/Elec. DSI hot water heater
- ▲ Water heater bypass valve
- ▲ Demand water pump
- ▲ Medicine cabinet
- ▲ Below floor low point drains
- ▲ Foot flush toilet
- ▲ Tub surround
- ▲ Glass shower door – 34" neo-angle showers

SLEEPING

- ▲ Reversible plush comforter (Select models)
- ▲ Evergreen sleep mattress
- ▲ Bunk shelves – double over double

EXTERIOR/CONSTRUCTION

- ▲ 13.5 Roof A/C
- ▲ Power awning (N/A 151RBX)
- ▲ Spare tire kit with spare tire
- ▲ 4 Stabilizer jacks
- ▲ LP port

- ▲ Double 20# LP tanks
- ▲ Rubber roof
- ▲ Fully laminated aluminum framed radius rubber roof – R-11 (7-1/2' Wides)
- ▲ Fully laminated aluminum framed radius rubber roof – R-14 (8' Wides)
- ▲ Vacuum bond Azdel/fiberglass sidewalls (Additional R-2)
- ▲ Laminated aluminum framed fully insulated sidewalls – R-9
- ▲ Laminated aluminum framed floor – R-11
- ▲ Gutter rail
- ▲ Dead bolt lock
- ▲ Tinted safety glass radius windows
- ▲ Radius entrance door
- ▲ Radius thumb latch baggage doors
- ▲ I-beam chassis construction
- ▲ Corrosion resistant powder coated frame
- ▲ Dual battery tray
- ▲ Heated/enclosed holding tanks (8' Wide models only)
- ▲ Break away switch
- ▲ Schwintek slide room system (N/A Deep slides)
- ▲ Lighted pass-thru storage
- ▲ Double entry step
- ▲ EZ lube axles
- ▲ Nitro filled radial tires
- ▲ Gray exterior fiberglass
- ▲ Exterior door side cable hook-up
- ▲ Aluminum rims

Optional Features

▲ APEX ELITE PACKAGE (MANDATORY ON 8' WIDES)

- Hard valances with side curtains
- Night shades
- Dual sink cover
- AM/FM/CD/DVD stereo
- 24" LED TV (7-1/2' Wides)
- 32" LED TV (8' Wides with entertainment center)
- Access doors under dinette
- Ground effects (Metal skirting & ABS fender skirts – N/A 151RBX)
- Slam latch doors at pass thru (Most models)
- Black tank flush
- Magnetic door catches
- Stone guard
- Hot/cold outside shower
- Bottle covers
- Apex fleece blanket – Sofa models

▲ SUMMIT PACKAGE*

- Painted fiberglass front cap with LED lighting
- Blue awning LED rope lighting
- Power tongue jack with light
- Swing-away assist handle at main entry
- Black metal refrigerator panels
- Hi-rise kitchen faucet with pull-out sprayer

****The Apex Elite Package is required with the Summit Package.**

ADDITIONAL OPTIONS

- ▲ Frameless dark tint windows
- ▲ 15,000 BTU roof air conditioner
- ▲ Tri-fold Destination Hide-a-Bed sofa



Standard Features

INTERIOR AND DÉCOR

- ▲ Glazed Grace Cherry cabinetry
- ▲ Overhead bedroom cabinets
- ▲ One-piece sealed edge countertops
- ▲ Congoleum Grand Canyon flooring
- ▲ Mini-blinds throughout
- ▲ Pedestal dinette table
- ▲ Large oversized booth/U-shaped dinette
- ▲ Hardwood mortise & tenon cabinet door frames
- ▲ Reversible plush comforter (Select models)
- ▲ Stile & rail cabinet front construction
- ▲ 2" Thick insulated floor
- ▲ LP leak alarm
- ▲ Fire extinguisher
- ▲ Smoke alarm
- ▲ Carbon monoxide detector

ELECTRICAL/HEATING/AC

- ▲ Outside receptacle GFI
- ▲ Patio light
- ▲ Detachable power cord

GALLEY

- ▲ Microwave
- ▲ Black appliances
- ▲ Brushed nickel hardware

BATH AND WATER

- ▲ Power bath vent
- ▲ Water heater bypass valve
- ▲ Demand water pump
- ▲ Hand-crafted wood medicine cabinet
- ▲ Below floor low point drains
- ▲ Foot flush toilet



Apex Ultra-Lite Travel Trailers are designed for towing by today's half-ton trucks and SUVs, with weights ranging between 3,000 and 6,000 lbs.

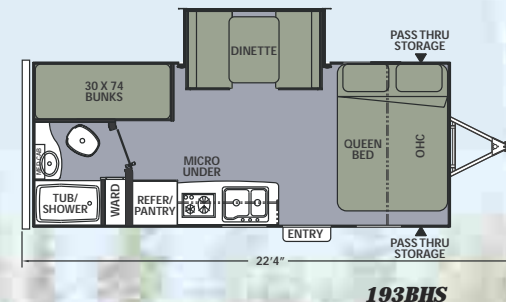
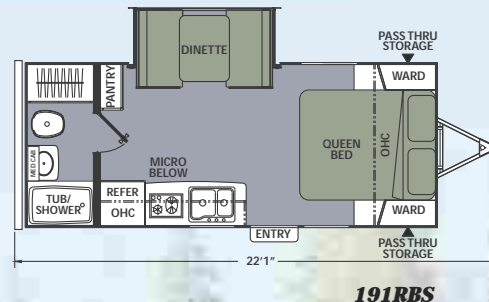
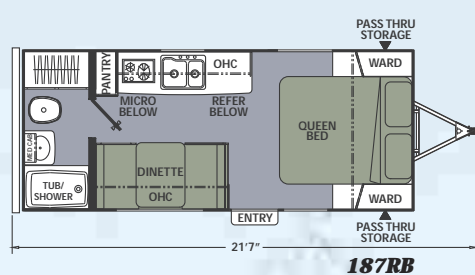
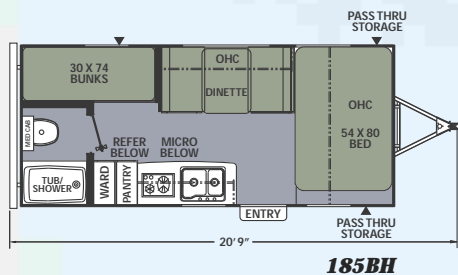

EXTERIOR/CONSTRUCTION

- ▲ 20# LP tank
- ▲ Rubber roof
- ▲ Vacuum bond Azdel/fiberglass sidewalls (Additional R-2)
- ▲ Laminated aluminum framed fully insulated sidewalls – R-9
- ▲ Gutter rail
- ▲ Dead bolt lock
- ▲ Tinted safety glass radius windows
- ▲ Radius entrance door with window
- ▲ Radius thumb latch baggage doors
- ▲ Corrosion resistant powder coated frame
- ▲ Dual battery tray
- ▲ Break away switch
- ▲ Stone guard
- ▲ Pass-thru storage
- ▲ Double entry step
- ▲ EZ lube axles
- ▲ Nitro filled radial tires

Optional Features

▲ NANO PACKAGE (MANDATORY)

- Vacuum bond Azdel fiberglass walls
- Vacuum bond laminated crowned roof/ceiling
- Aluma-cage construction
- Welded aluminum framed floor
- Schwintek slide room system
- Insulated floor with seamless decking
- High efficiency LED interior lighting
- 2 Outside speakers
- Stabilizer jacks (4)
- TV antenna with cable hookups
- DSI water heater
- Microwave
- 4.0 Cu. ft. 2-way refrigerator
- 2 burner cooktop
- AM/FM/CD Stereo
- Skylight in bath
- Evergreen sleep mattress
- Gray exterior fiberglass
- LP port

▲ COMFORT PACKAGE

- 13.5 BTU roof air conditioner
- 20,000 BTU direct vent furnace
- Manual awning

ADDITIONAL OPTION

- ▲ Spare tire and carrier

APEX NANO	185BH	187RB	191RBS	193BHS
Base Model Weight	2604	2788	3089	3124
Hitch Weight	350	316	382	406
Carrying Capacity (base)	1175	875	1164	1229
GVWR	3800	3800	4500	4600
Exterior Length	20'9"	21'7"	22'1"	22'4"
Exterior Width	90"	90"	90"	90"
Exterior Height (with A/C)	9'6"	9'6"	9'6"	9'6"
Fresh Water	30	30	30	30
Gray Water	30	30	30	30
Waste Water	30	30	30	30

This storage friendly super-lightweight Nano **187RB** features a curved ceiling, abundant kitchen counter space, pantry, double bowl sink, walk-around bed, full length wardrobes, plus an additional bathroom wardrobe.





239RBS Apex standard exterior



BIG BENEFITS FOR NEW OWNERS

FREE One Year Membership – Coachmen Owners Association! Coachmen is proud to sponsor the largest manufacturer sponsored camping club in North America... Coachmen Owners' Association (COA). COA provides you a world of ways to enjoy your RV. This is FUN ON OVERDRIVE and provides: Free Trip Routing, Exciting Tours & Rallies, Free Campground Directory, Local/State Club Activities, Easy RVing Magazine Free, Theme Park Discounts, Fuel Discounts, Free onebigplanet® Memberships with discounts at 180,000 merchants and Much More! Every new Coachmen RV buyer is eligible for a 1 Year FREE membership in the Coachmen Owners' Association. It all adds up to an easy ownership experience!



TRAVEL EASY™ ROADSIDE ASSISTANCE

RVing is easier with Coachmen's Travel Easy™ Roadside Assistance provided FREE the first year of ownership to those who purchase a New Coachmen RV. Administered by Coach-Net, this service provides you with 24/7 operational, technical and emergency road service coverage. Also included is towing, fuel delivery, jump starts, lockout service, tire changes, mobile mechanic and unlimited technical assistance. Anywhere. Anytime. Travel Easy™ is the security of knowing that help is an easy phone call away.



423 N. Main Street ■ P.O. Box 30
Middlebury, IN 46540

To learn more about Coachmen RV and our products and see how Coachmen is making the easy life easier, visit www.coachmenrv.com



A division of Forest River, Inc.

All information contained in this brochure is believed to be accurate at the time of publication. However, during the model year, it may be necessary to make revisions and Coachmen reserves the right to make all such changes without notice, including prices, colors, materials, equipment and specifications as well as the addition of new models and the discontinuance of models shown in this brochure. Therefore, please consult with your Coachmen dealer and confirm the existence of any materials, design or specifications that are material to your purchase decision.

©2014 Coachmen RV a Division of Forest River, Inc., A Berkshire Hathaway company. All Rights Reserved. 12/14



Forest River, Inc. encourages our customers to purchase their Forest River products from a local dealership whenever possible for the following reasons:

- 1) Forest River, Inc. dealers are independently owned and operated businesses so priority service and scheduling is at their discretion and is often provided to customers that purchased their unit at that dealership.
- 2) Purchasing locally allows customers to establish meaningful relationships with a dealer, enhancing the RV experience through assistance with product questions, user tips or RV regulations for your state or country, and much more!
- 3) Canadian customers must meet requirements to bring an RV purchased out of the country to their home. These requirements may involve additional inspections and certifications, taxes and fees. Your local Canadian Dealer is a professional at meeting these requirements.
- 4) Scheduling timely warranty repairs and adjustments through a local dealership provides far greater flexibility and convenience to you, the customer!

It is the goal of Forest River, Inc. that all of our RV owners fully enjoy the RV experience and that customer satisfaction meets or exceeds their expectations!



Learn More
Scan this barcode using a QR Reader on your smart phone to learn more about Forest River.



A Berkshire Hathaway company.

Your Apex Dealer