

Since 1947

2007

# KODIAK

by Skamper

## ULTRA-LITE EXPANDABLES AND TRAVEL TRAILERS

*Take Life to the Extreme!*



INDUSTRY LEADING ULTRA-LITE TECHNOLOGY





## ULTRA-LITE EXPANDABLES

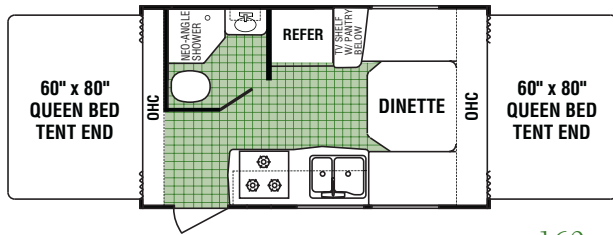

160

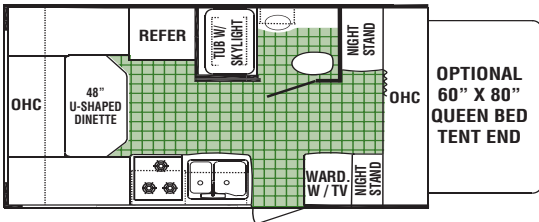

17FL

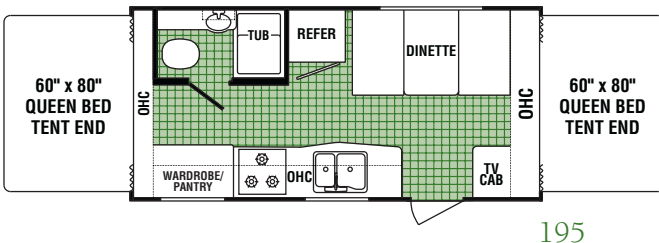

195

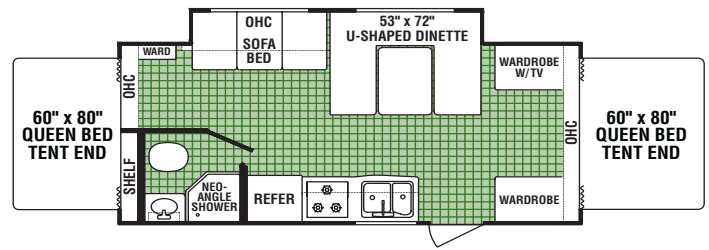

214

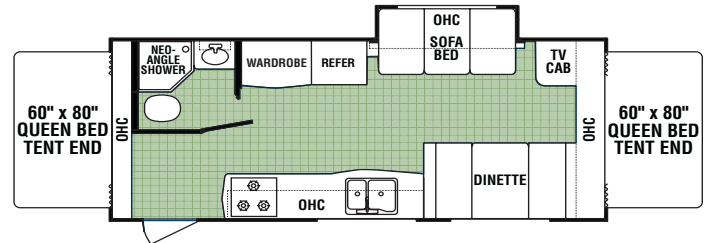

235

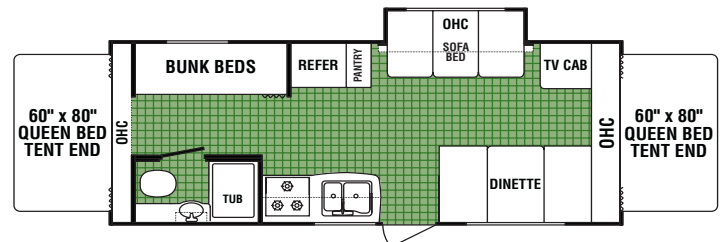

23BH

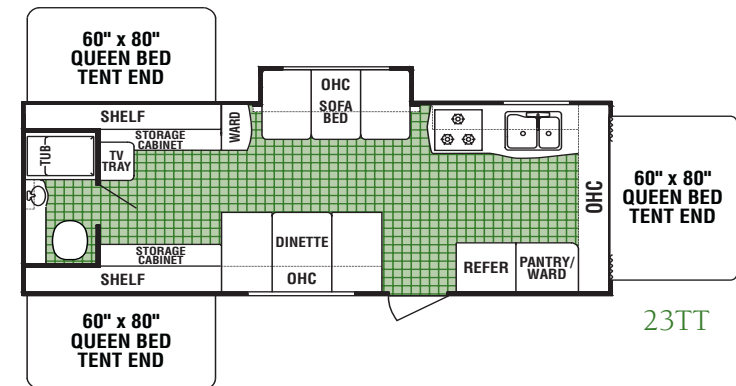

23TT

## ULTRA-LITE EXPANDABLES

KODIAK EXPANDABLES	160	17FL	195	214	235	23BH	23TT
*Axle Weight	2418	2286	2899	3297	3269	3401	3497
*Dry Hitch	305	321	231	351	345	461	513
*Unloaded Vehicle Weight	2704	2608	3130	3648	3614	3862	4110
GVWR	3850	3850	4840	4840	4840	4840	6000
Net Cargo Capacity	1126	1242	1710	1192	1226	978	1890
Exterior Length (closed)	17'2"	17'5"	20'8"	24'4"	24'4"	26'4"	26'4"
Exterior Height with A/C	9'4"	9'4"	9'4"	9'4"	9'4"	9'4"	9'4"
Exterior Width	8'	8'	8'	8'	8'	8'	8'
Fresh Water Capacity	46	46	46	46	46	46	46
Gray Water Capacity	34	34	34	34	34	34	34
Black Water Capacity	22	22	22	22	22	22	22
Furnace Size	19,000	19,000	19,000	19,000	19,000	19,000	19,000

\*Axle weight, dry hitch weight and unloaded vehicle weight (UVW) are base weights of units without options. Each unit includes a weight label which lists specific weight information for that unit. **Vehicle Loading** – Every effort has been made to provide the greatest number of options for the recreation vehicle owner. Along with these choices comes the responsibility to manage the loads that are imposed by the choices so that they remain within the manufacturer's specified chassis weight limits. Do not overload the recreation vehicle. *Net carrying capacity (NCC)* determined by subtracting unloaded vehicle weight (UVW) from gross vehicle weight (GVWR) and includes fluids, options and cargo. Liquid capacities and weights are approximations only.

**Warning:** This information is intended as a guide only. Weights of individual vehicles may vary. Consult your owner's manual for complete loading, weighing and towing instructions. Product information, specifications, and photography in this brochure were as accurate as possible at time of printing. Photographs may contain some features that are optional on your vehicle. Since we continually strive to improve our products, actual products may differ. Prices and specifications are subject to change without notice. All capacities are approximate and dimensions are nominal. Some features shown are optional and may be different or unavailable in Canada. Vehicles are designed for recreational use only and not intended for use as a primary residence.

## ULTRA-LITE TRAVEL TRAILERS

KODIAK TRAVEL TRAILERS	19FL	21QS	24RB-SL	25RGB-SL	25QS	26QS	26QSL	26QSQ	26RG-SL	26RK-SL	27BH	27RB-SL	30BH-SL
*Axle Weight	3326	3680	3469	3738	3954	3857	4030	4092	3779	3841	3999	3745	4051
*Dry Hitch Weight	285	275	433	383	392	397	381	413	409	479	428	605	479
*Unloaded Vehicle Weight	3612	3956	3902	4122	4328	4254	4412	4506	4188	4350	4427	4305	4530
GVWR	6000	6000	6000	6000	6000	6000	6000	6000	6000	6000	6000	6000	6000
Net Cargo Capacity	2388	2004	2098	1878	1672	1746	1588	1494	1812	1650	1574	1650	1470
Exterior Length	24'4"	24'4"	26'4"	28'7"	27'1"	26'9"	26'9"	26'9"	28'7"	26'9"	30'3"	30'3"	30'3"
Exterior Height w/A/C	9'8"	9'8"	9'8"	9'8"	9'8"	9'8"	9'8"	9'8"	9'8"	9'8"	9'8"	9'8"	9'8"
Exterior Width	8'	8'	8'	8'	8'	8'	8'	8'	8'	8'	8'	8'	8'
Fresh Water Capacity	46	46	46	46	46	46	46	46	46	46	46	46	46
Gray Water Capacity	34	34	34	34	34	34	34	34	26	34	34	34	34
Black Water Capacity	22	22	22	22	22	22	22	22	22	22	22	22	22
Furnace Size (BTUs)	19,000	19,000	19,000	19,000	30,000	30,000	30,000	30,000	19,000	30,000	30,000	31,000	30,000

Tire Size (all models): ST205/75D14(C) Interior Height (all Kodiak Expandables and Kodiak Travel Trailers models): 6'4"

# ULTRA-LITE TRAVEL TRAILERS

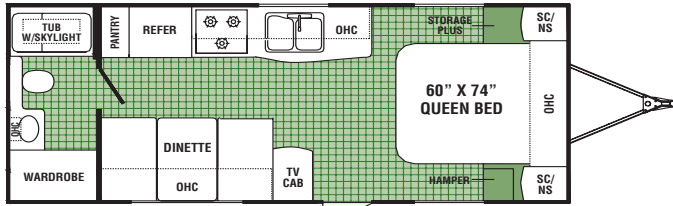

19FL

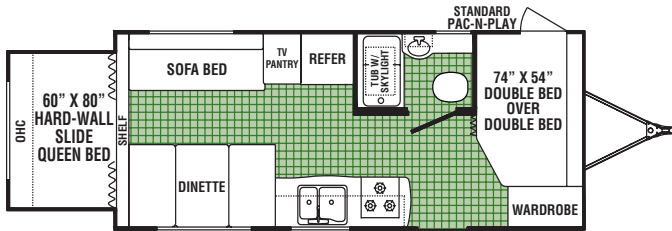

21QS

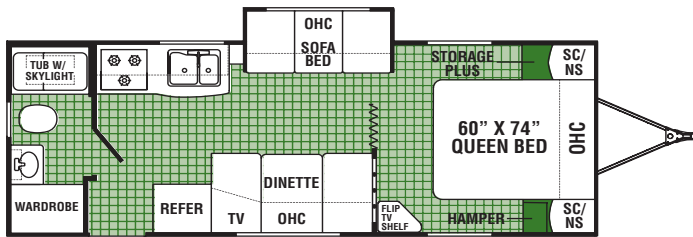

24RB-SL

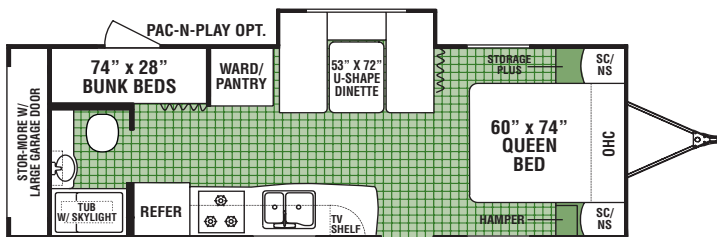

25RGB-SL

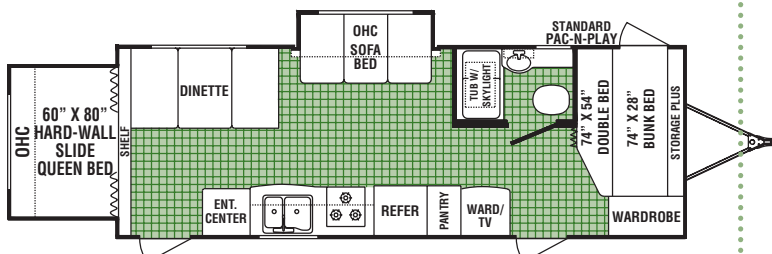

25QS

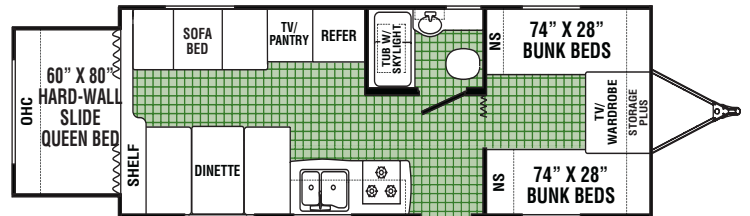

26QS

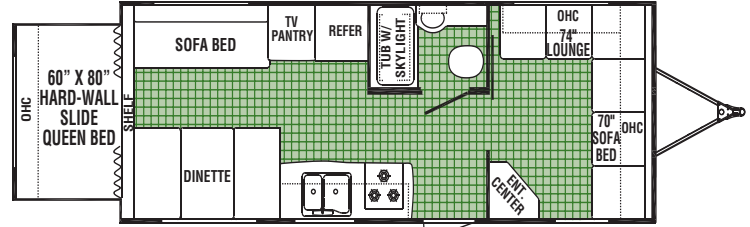

26QS-L

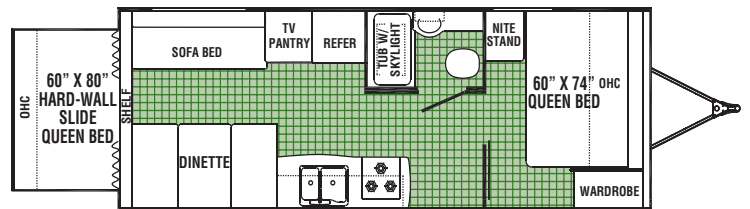

26QSQ

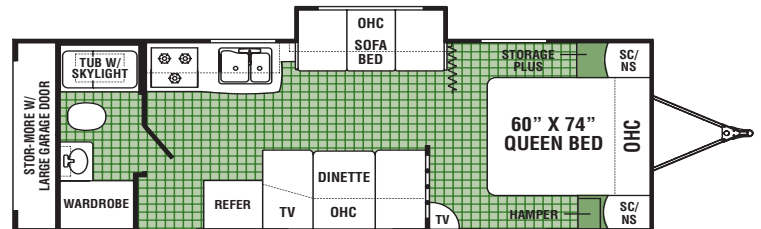

26RG-SL

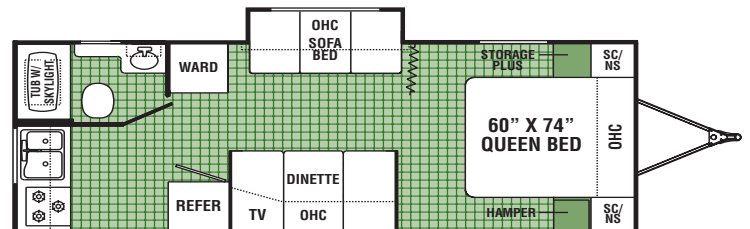

26RK-SL

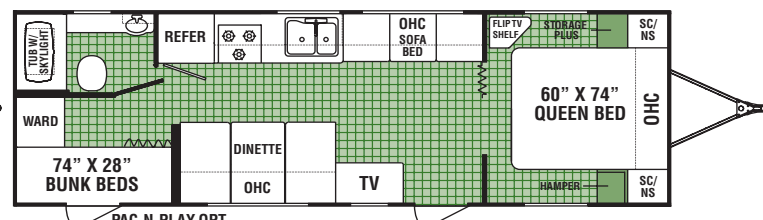

27BH

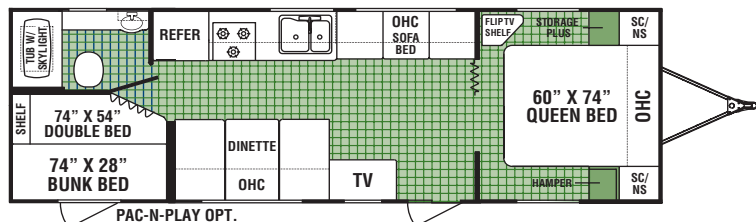

27BH (Shown with rear bunk over double bed option)

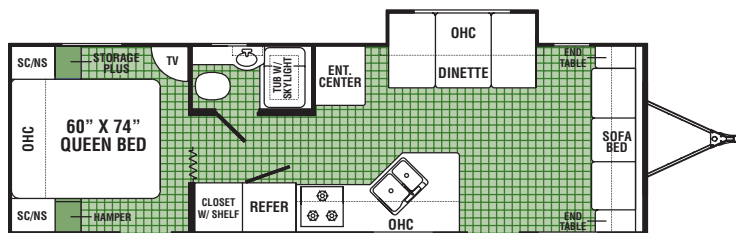

27RB-SL

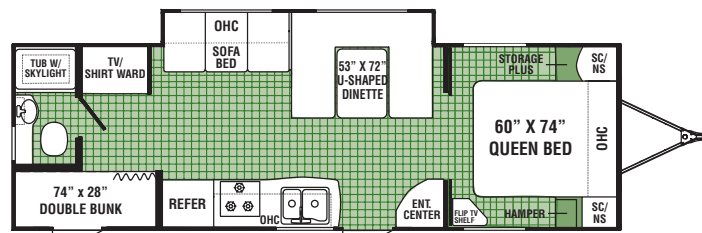

30BH-SL

## Exterior Features

### Expandable TT

8' Wide floorplans	■	■
2-20 lb LP bottles with ABS cover	■	N/A
Two 30 lb LP bottles with ABS cover	N/A	■
Key-locking "Easy Latch" tent doors	■	N/A
Self-Supporting bunk ends – no poles required	■	N/A
60" x 80" queen beds in tents	■	N/A
60" x 80" queen bed in hard-wall slide	N/A	■
26" radius corner entry door	■	■
Flush combo entry latch/deadbolt lock	■	■
ABS wheel wells	■	■
Tandem axles with 4-wheel electric brakes	■	■
6-Way welded aluminum laminated superstructure (roof, floor and walls)	■	■
Lite-weight European-style frame with lifetime rust through warranty	■	■
Rubber torsion "independent suspension" axles	■	■
ABS fender skirts	■	■
EPDM one-piece seamless rubber roof	■	■
Corrosion free laminated underbelly	■	■
Patio, step, & dump valve service lights	N/A	■
High-end designer graphics	■	■
Rain gutter with corner downspouts	■	■
Rear bumper and corner guards	■	■
Single entry step	■	■
Tinted radius clamp ring windows	■	■
Exterior step light with switch	■	■
Entry-assist handle at door	■	■
Break-away trailer switch	■	■
120V Exterior outlet	■	■
Safety glass	■	■
Roof ducted for air conditioning	N/A	■

## Interior Features

### Expandable TT

5" Thick, reversible dinette seats	■	■
Bathroom medicine cabinet	■	■
Designer window treatments	■	■
Fiberlink bathtub	■	■
Shower curtain	■	■
Glass décor light over dinette table	■	■
Residential tile-like linoleum	■	■
Mini blinds throughout	■	■
Power roof vent in bathroom	■	■
Color-coordinated bedspread	N/A	■
Clothes hamper/laundry basket with access to Storage Plus	N/A	■

## Appliances and Electrical

### Expandable TT

12V Electric slide-out motor	■	■
19M BTU forced air DSI furnace with wall thermostat	■	N/A
30M BTU forced air DSI furnace with wall thermostat (most models)	N/A	■
Ducted heat	■	■
30 Amp power cord with storage compartment	■	■
6 Gallon gas water heater with bypass	■	■
12V interior lights with wall switch	■	■
Fire extinguisher	■	■
LP detector	■	■
Carbon monoxide detector	■	■
Smoke detector	■	■
Norcold single door gas/electric refrigerator	■	N/A
6 Cubic ft. Norcold double door gas/electric refrigerator	OPT	■
Pre-wired for air conditioning	■	■
Pre-wired for cable TV and stereo	■	■
Range hood with 12V light and exhaust fan	■	■
Solid state converter with built-in battery charger	■	■
Systems monitor panel	■	■
Demand water pump	■	■
Stainless steel appliances	N/A	■
Foot flush toilet	N/A	■

## Options

### Camping Pack Group:

- 13.5 BTU air conditioning with wall thermostat
- AM/FM/CD player with two speakers
- A&E 8300 series awning
- TV antenna with cable prep
- Microwave
- Bunk end lights with fan
- Oven with three burner range

### Aero Pack Group:

- 13.5 BTU air conditioning with wall thermostat
- AM/FM/CD player with two speakers
- A&E 8300 series awning
- TV antenna with cable prep
- Microwave

## Other Optional Features

### Expandable TT

Exterior sound system	■	■
Audiovox 2-way radio system: four 5-mile range handsets & 12V wall mounted charger	■	■
Heated bunk mattress	■	N/A
Custom bike rack with truck receiver accessory	■	■
Spare tire with cover	■	■
Double door refrigerator	OPT	STD
3 Burner high-output range	■	STD
DSI water heater (gas/electric)	■	■
Heated holding tanks (3)	N/A	■
Hot/Cold Exterior shower	■	■
Stove cover	■	■
Tub surround	■	STD
Water filter system	■	■
Exterior barbeque grill	■	■
Bedroom carpet	N/A	■
Aluminum rims	N/A	■
Enclosed underbelly	N/A	■
Fantastic vent	N/A	■
Four corner stabilizer jacks with sand pads	STD	■
Roof ladder	N/A	■
Bi-fold shower door	■	■
Diamond plate lower front wall	■	■
Pac-n-play (see floorplans for availability)	■	■
Skylight in bath	■	STD

Your Local Dealer

2164 Caragana Court ■ Goshen, IN 46526  
 Sales: 574.534.1224 ■ Fax: 574.975.0556  
 Parts & Service: 574.537.0700  
[www.kodiak-rv.com](http://www.kodiak-rv.com)

