

American Eagle Floor Plans, Standard Features and Options



{American Eagle}

A M E R I C A N E A G L E C l a s s A D i e s e l 2 0 0 5



American Eagle

Floor Plans

40J

Triple Slide-Out
Sleeps 2

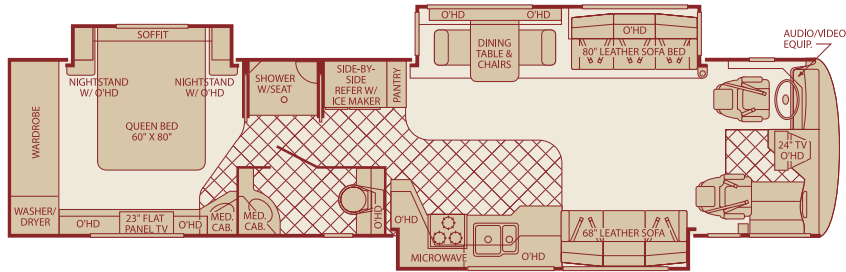

40L

Quad Slide-Out
Sleeps 2

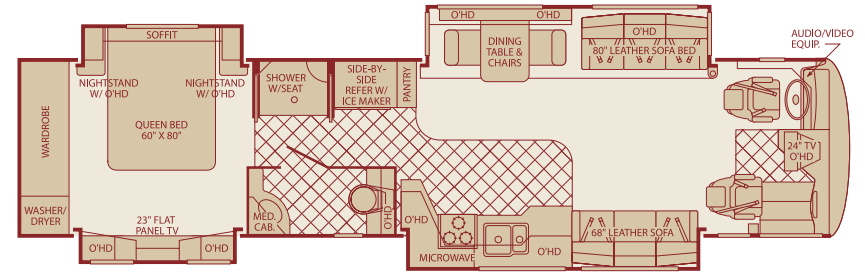

40V

Triple Slide-Out
Sleeps 2

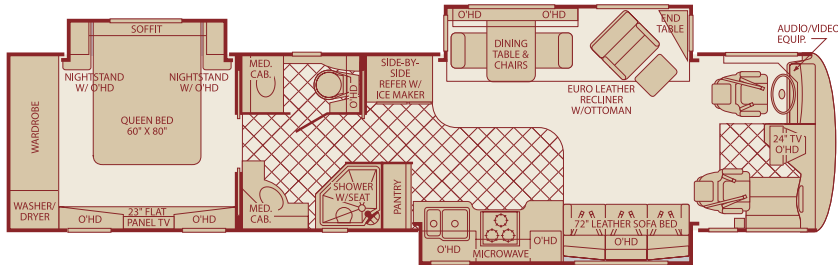

40W

Double Slide-Out
Sleeps 2

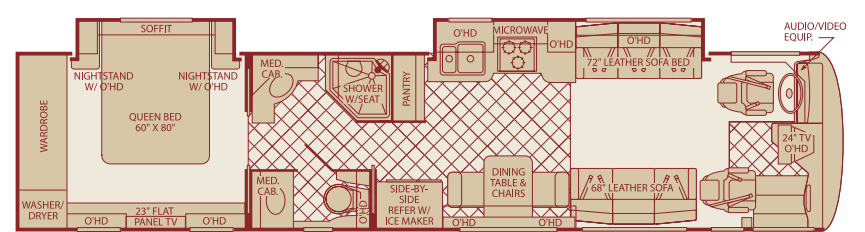

Options

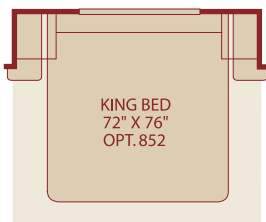

Available in all floor plans.



DUAL 32" FLAT PANEL TV
PACKAGE OPT. 356

Available in all floor plans.

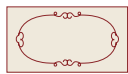

INLAID CARPET OPT. 904
Available in all floor plans.



FULL REAR
WARD
OPT. 891
OR OPT. 897

Available in all floor plans.
Options 897, 884 not
available in 42R & 42Y



SHIRTWARD
W/DRAWERS
REAR WALL
OPT. 880
OR OPT. 884

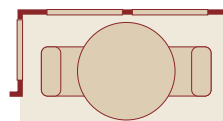

FREE-STANDING DINETTE
W/ BAY WINDOWS
OPT. 831

Available in floor plans:
40J, 40L, 40N, 40V,
42R, 42Y

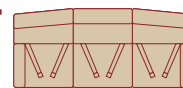

80" LEATHER SOFA
W/ AIR MATTRESS
OPT. 210

Available in floor plans:
40J, 40L, 42R, 42Y



72" LEATHER SOFA BED
W/ REMOVABLE ARMS
OPT. 636

Available in floor plans:
40N, 40Q, 40V, 40W



68" LEATHER SOFA W/
REMOVABLE ARMS
OPT. 637

Available in floor plans:
40J, 40L, 40Q, 40W,
42R, 42Y



LEATHER LOVE SEAT
OPT. 814
Available in floor plans:
40N, 40V



LEATHER EXTRA-
WIDE SEAT W/
POWER FOOTREST
OPT. 958
Available in
all floor plans.

Floor Plans

40N
Triple Slide-Out
Sleeps 2

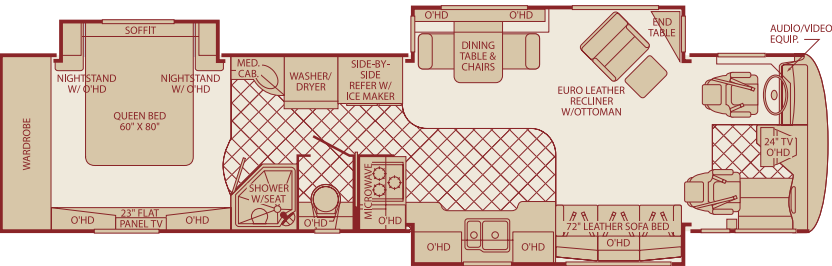

40Q
Double Slide-Out
Sleeps 2

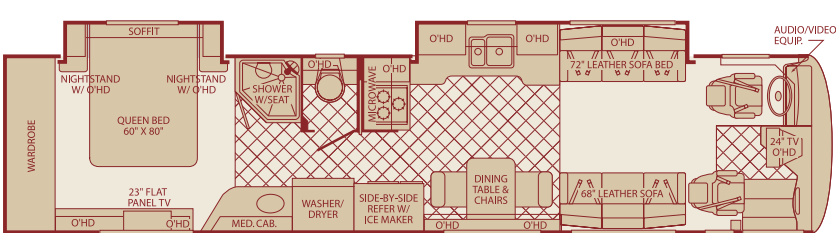

42R
Quad Slide-Out
Sleeps 2

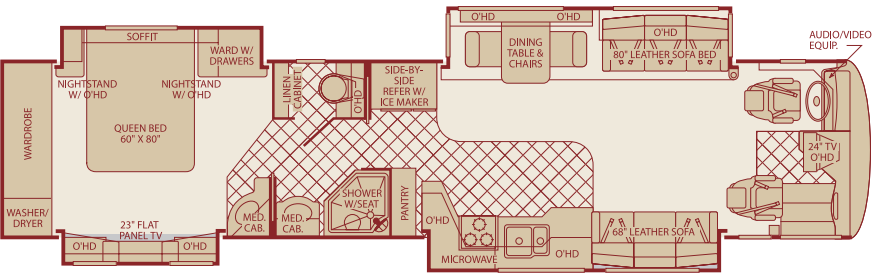

42Y
Triple Slide-Out
Sleeps 2

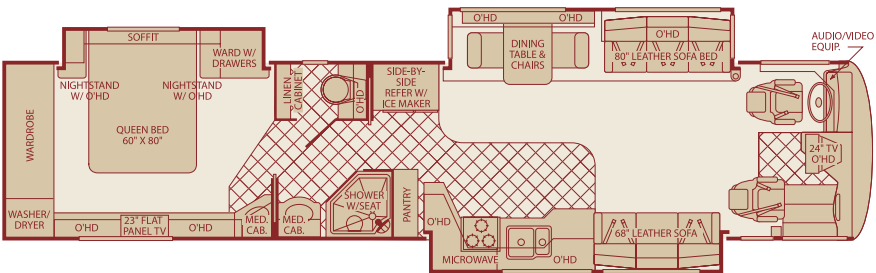

Seatbelt configuration may vary depending on options chosen. Sleeping capacity based on standard layout. Optional furniture may increase or decrease sleeping capacity.



UPHOLSTERED FACING
DINETTE BOOTH
OPT. 830
Available in floor plans:
40J, 40L, 40N, 40V,
42R, 42Y



PASSENGER SIDE SOFA
OVERHEAD OPT. 630
Available in
all floor plans.



NORCOLD 4 DOOR
REFRIGERATOR
W/ICE MAKER
OPT. 149
Available in
all floor plans.



DUAL 32\"/>



CERAMIC
2 BURNER
COOKTOP
OPT. 111
Available in
all floor plans.



WASHER/
DRYER READY
OPT. 129
Available in
all floor plans.

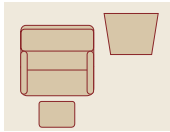

LEATHER RECLINER
W/FOOTREST
& END TABLE OPT. 494
Available in floor plans:
40J, 40L, 42R, 42Y

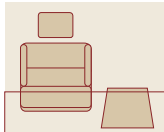

LEATHER RECLINER
W/FOOTREST AND
END TABLE OPT. 494
& PASSENGER SIDE SOFA
O'HEAD OPT. 630
Available in floor plans:
40Q, 40W

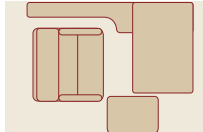

DESK W/FREE-STANDING
EURO LEATHER RECLINER
W/OTTOMAN OPT. 870
Available in floor plans:
40J, 40L, 42R, 42Y

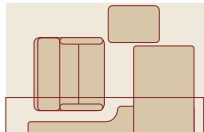

DESK W/FREE-STANDING
EURO LEATHER RECLINER
W/OTTOMAN OPT. 870
& PASSENGER SIDE SOFA
O'HEAD OPT. 630
Available in floor plans:
40Q, 40W

Weights and Measurements

WEIGHTS	40J	40L	40N	40Q	40V	40W	42R	42Y
GVWR (lbs.)¹	34,600	34,600	34,600	34,600	34,600	34,600	44,600	44,600
Front GAWR (lbs.)²	14,600	14,600	14,600	14,600	14,600	14,600	14,600	14,600
Rear GAWR (lbs.)²	20,000	20,000	20,000	20,000	20,000	20,000	20,000	20,000
Tag Axle GAWR (lbs.)²	N/A	N/A	N/A	N/A	N/A	N/A	10,000	10,000
Base Weight (lbs.)³	28,600	28,800	28,200	27,800	28,500	27,700	34,100	33,800
GCWR (lbs.)⁴	49,600	49,600	49,600	49,600	49,600	49,600	59,600	59,600
Hitch Rating Weight (lbs.)[*]	15,000	15,000	15,000	15,000	15,000	15,000	15,000	15,000
Tongue Weight (lbs.)[*]	1,500	1,500	1,500	1,500	1,500	1,500	1,500	1,500

MEASUREMENTS

Wheelbase	266"	266"	266"	266"	266"	266"	290"	290"
Overall Length⁵	39' 11.5"	39' 11.5"	39' 11.5"	39' 11.5"	39' 11.5"	39' 11.5"	41' 11.5"	41' 11.5"
Overall Height (with A/C)	12' 8"	12' 8"	12' 8"	12' 8"	12' 8"	12' 8"	12' 8"	12' 8"
Overall Width (maximum)⁶	101.5"	101.5"	101.5"	101.5"	101.5"	101.5"	101.5"	101.5"
Interior Height (maximum)	82"	82"	82"	82"	82"	82"	82"	82"
Interior Width (maximum)	96"	96"	96"	96"	96"	96"	96"	96"

TANK AND LIQUID CAPACITIES

Fresh Water Holding Tank (gal.)	95	95	95	95	95	95	120	120
Grey Water Holding Tank (gal.)	70	70	70	70	70	70	60	60
Black Water Holding Tank (gal.)	40	40	40	40	40	40	40	40
Appliance LPG Tank (gal.)(WC)⁷	38	38	38	38	38	38	38	38
Water Heater Tank (gal.)	10	10	10	10	10	10	10	10
Fuel Capacity (gal.)	125	125	125	125	125	125	150	150

Liquid Weight Reference: Water (gal.) = (8.3 lbs./3.8 kgs.) Fuel (gal.) = (7.1 lbs./3.2 kgs.) LPG (gal.) = (4.2 lbs./1.9 kgs.)

Metric Conversion: Multiply pounds x 0.453 to obtain kilograms. Multiply gallons x 3.785 to obtain liters.

CHASSIS (40 FT MODELS)

Frame: Liberty Chassis
Engine: Cat® C9 400 HP, 8.8L
Torque: 1150 lb.-ft. @ 1400 RPM
Transmission: Allison® 3000 MH, 6 Speed w/Electronic Shifter
Alternator Amps: 200 Amp Leece Neville
Tires: Goodyear® 295/80R 22.5 H

CHASSIS (42 FT MODELS)

Frame: Liberty Chassis
Engine: Cat® C13 525 HP, 12.5L
Torque: 1650 lb.-ft. @ 1200 RPM
Transmission: Allison® 4000 MH, 6 Speed w/Electronic Shifter
Alternator Amps: 200 Amp Leece Neville
Tires: Goodyear® 295/80R 22.5 H

1. GVWR (Gross Vehicle Weight Rating): Means the maximum permissible loaded weight of the motor home. The GVWR is equal to or greater than the sum of the unloaded vehicle weight plus the net carrying capacity.
 2. GAWR (Gross Axle Weight Rating): Means the maximum permissible loaded weight a specific axle is designed to carry.
 3. Base Weight: Means the estimated weight of the motor home without fuel, options, water, cargo or passengers.
 4. GCWR (Gross Combined Weight Rating): Means the value specified by the motor home manufacturer as the maximum allowable loaded weight of this motor home with its towed vehicle. Towing & braking capacities may differ. Refer to Fleetwood & chassis manufacturer manuals for complete information.
 5. Length taken from front bumper to rear bumper (excludes accessories).
 6. Excludes safety equipment & awnings.
 7. Tank Manufacturer's listed water capacity (WC). Actual LP Gas capacity is 80% of water listing as required by the safety code.
- N/A = Not Applicable
- * The chassis manufacturer recommends the installation of a supplemental brake-control system to activate the brakes on the vehicle or trailer you are towing.

IMPORTANT— PLEASE READ: Product information, photography and illustrations included in this publication were as accurate as possible at the time of printing. For further product information and changes, please visit our website at www.fleetwoodrv.com or contact your local Fleetwood dealer. Prices, materials, design and specifications are subject to change without notice. All weights, fuel, liquid capacities and dimensions are approximate. Fleetwood has designed its recreational vehicles to provide a variety of uses for customers. Each vehicle features optimal seating, sleeping, storage and fluid capacities. The user is responsible for selecting the proper combination of loads (i.e., occupants, equipment, fluids, cargo, etc.) to ensure that the vehicle's capacities are not exceeded.

Liberty Chassis

Fleetwood® Exclusive.

In true American Coach Fashion, American Coach set out to design a superior, one-of-a-kind chassis that would be able to overcome the structural challenges created by designing floor plans with triple and quad slide-outs. The result: The Liberty Chassis. This exclusive American Coach design (patent pending) strengthens the structural integrity of the driving platform by creating a strong and rigid frame that resists flexing and provides a comfortable and unforgettable driving experience.

- ❶ **Huge 15,000 lbs. Towing Capacity.** Easily tows your favorite vehicle.
- ❷ **Laminated Storage Liners.** Easy to maintain, neat, clean look, durable.
- ❸ **E-Coated Structure.** Protects against corrosion. Enhances longevity, quality and reliability.
- ❹ **All Steel Structure.** Minimizes flex, enhances driving experience, strength and longevity.
- ❺ **Center-Mounted Fuel Tank.** Improved weight distribution.
- ❻ **Independent Front Suspension.** Optimum handling, enhances driving experience.

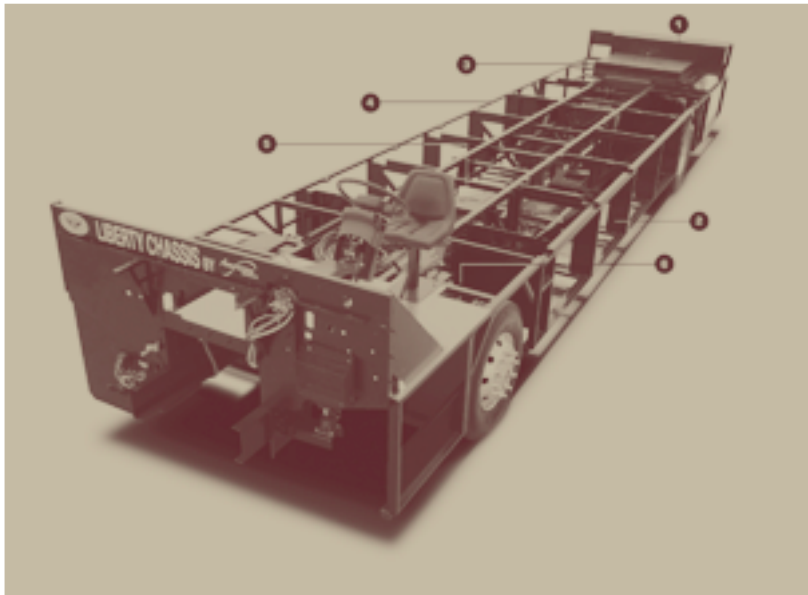

Setting the Standard in Motor Home Quality.

Fleetwood® prototypes are exposed to thousands of miles of durability testing. Those components that don't survive are redesigned until they do. This sets our standard in safety and durability.

Numerous floor plan choices. American Coach offers a wide variety of floor plans including double, triple and quad slides. This provides many choices to accommodate each customer's distinct needs.

Vacu-bond® Roof, Sidewalls and Floor. The Vacu-bond® process adds a great deal of structural integrity by laminating the sidewalls, floors and roof into a strong composite structure. This construction method is considered superior when compared to most competitors.

More Power. The 40' Eagle comes equipped with a Cat® C9 with 400HP engine with 1150 lb.-ft. of torque @ 1400 RPM. The 42' Eagle comes equipped with a Cat® C13 with 525HP engine with 1650 lb.-ft. of torque @ 1200 RPM. This gives you plenty of power to tour the country at any pace you like.

The Pneumatic Entry Door Air Lock is a unique feature that minimizes air intrusion, and wind noise when you are on the go. Avionics® has designed a superior entry door for American Coach.

Name Brand Components. Spartan®, Sony®, Dupont®, Avionics®, Flexsteel®, Fabrica®, Moen®, Onan®, Norcold® and Dometic® to name a few. We gather the best name brands in the industry to create a superior coach for you.

Standard Features

Interior

THROUGHOUT

- **TuffPEX® Plumbing System***
- **Energy Management System (50 Amp)***
- **Deluxe Ball Bearing, Full Extension Drawer Guides***
- **Whole Coach Water Filtration System***
- **Solid Hardwood Drawers w/Dovetail Joints***
- **Interior Multi Plexed Switches***
- **Centralized Control Panel Display Center***
- **Fabrica® Carpet***
- Magnum Energy 2500-Watt Inverter Charger
- Magnum Energy Battery Monitor
- Multi-Point Water Pump Switching
- Direct Spark Ignition 10 Gallon Water Heater 120V/LPG
- Sensa Tank RV 100 Tank Level Monitoring System (Interior & Exterior Monitor)
- Washer/Dryer (Vented)

DRIVER CONVENIENCE

- **Visteon® AM/FM Radio & Single CD–Dash***
- **Compass & Exterior Temperature Gauge***
- **Flexsteel® Leather 6-Way Power Driver Seat w/Heat/Power Lumbar***
- **Flexsteel® Leather 6-Way Power Passenger Seat***
- **Adjustable Brake & Throttle Pedals***
- **Tilt/Telescope Steering Wheel***

LIVING ROOM

- **Sony® Home Theater System***
- **Pre-Programmed Harmony® Remote Control (Controls All Electronics)***
- **Sony® VHS–4 Head Hi-Fi Stereo VCR***

BATHROOM

- **Solid Surface Lavy Countertop w/Solid Surface Sink & Delta® Faucet***
- **Moen® Hand Held Shower Head***
- **Diagonally Laid Porcelain Tile Floor***

- Diagonally Laid Porcelain Tile at Front Entry
- Automated Electrical Control System (Includes Whole House Surge Protector)
- Solar Charging Panel (70-Watt)
- Day/Night Pleated Shades
- (2) 13.5 M Low Profile Roof Air Conditioners (40' Models)
- Rigid Furnace Ducting System
- (3) 13.5 M Low Profile Roof Air Conditioners (42' Models)
- Dual 2-Stage High Efficient Furnaces w/Thermostat & Auto Ignition (15/22 M / 23/34 M)
- Entry Step Switch at Entry Wall
- Front Overhead Cabinet will include the Electronics
- Vinyl Padded Ceiling w/Decorative Air Plenum & Indirect Lighting
- Decorative Window Treatments
- 12V Halogen Ceiling Lighting System

- **Smart Wheel***
- **One-Piece Bus Style Windshield***
- **Power Driver/Passenger Sun Visors***
- Battery Disconnects
- Driver/Passenger Map Lights
- Passenger Drink Holder
- Solid Surface Drink Holder
- Pneumatic Step Well Cover
- Rear Vision System w/Audio (Camera & Monitor)
- (2) Auxiliary 12V Dash Receptacles

- **24" Sony® Vega TV***
- Flexsteel® Leather Recliner (40V & 40N Models Only)
- Flexsteel® Leather Loveseat (40Q, 40W, 40J, 40L, 42Y, & 42R)
- Flexsteel® Leather Sofa Bed

- Skylight in Shower
- Brass/Bronze Bath Accessories
- Medicine Overhead Cabinet
- Etched Glass Shower Door
- Fiberglass Shower Enclosure w/Molded Seat (Select Models)

- Skylight Cover (Select Models)
- Rain Sensor Power Roof Vents w/3-Speed Fan (All Vents–Galley, Bath & Shower Area)
- Lined Shelves
- Multi-Plexed Slide-Out Control Switches
- Choice of Walnut, Regency Cherry, Clear White Maple or Butterscotch Glaze Cabinetry
- Solid Core Raised Panel Cabinet Doors
- TV Cable Ready
- Park Telephone Ready
- Power TV Antenna w/Warning Alarm & (2) Jacks
- Hand Laid Wallpaper in Living Room, Galley, Lavy and Bedroom
- LPG Detector/Alarm
- Smoke Detector/Alarm
- Fire Extinguisher
- CO Detector/Alarm

- Back Lighted Instrument Panel
- Denso Climate Control System
- Front Windshield Privacy Curtain
- Driver Side Pull Down Shade
- Power Driver Window
- Cruise Control
- I.C.C. Light Switch
- Remote Auxiliary Start Switch
- Manual Air Dump Override Switch
- Top Mounted Intermittent Winshield Wipers w/Sprayer Nozzles

- Hardwood Front TV Overhead Cabinetry
- TracVision® Domed Digital Satellite System

- Shower Doors w/Positive Latch
- Shower Caddy (Solid Surface or Molded into the Shower Enclosure)
- Residential China Bowl Flush Toilet w/Hand Sprayer

GALLEY

- **Solid Surface Dinette Table w/Slide Out Extension & (4) Decorative Chairs***
- **Dometic® 120V/LPG 12 Cu. Ft. Side By Side Refrigerator w/Icemaker/Brushed Aluminum Finish***
- **Large Solid Surface 50/50 Double Bowl Galley Sink***
- **Delta® High Rise Galley Faucet***

BEDROOM

- **Solid Surface Nightstand Tops***
- **60" x 80" (Full Queen-Size) Innerspring Padded Pillow Top Mattress***
- **23" Sony® Flat Panel TV***
- **Cedar Lined Wardrobe***
- **Generator Start/Stop Switch in Bedroom***

• Diagonally Laid Porcelain Tile Floor*

- Silverware Tray
- Solid Surface Range Cover
- Brushed Chrome Soap Dispenser
- GE Advantium® Microwave/Convection Oven w/Brushed Aluminum Finish
- Recessed 3 Burner Range w/Oven w/Brushed Aluminum Finish

• Keyless Entry Remote Switch*

- Padded Fabric Headboard
- Key Locked Safe
- Day/Night Pleated Shades
- Hand Laid Wallpaper w/Decorative Border
- Solid Wood Panel Bath/Bedroom Doors

- Built-In Range Hood w/Light/Fan
- Solid Surface Galley Countertop & Sink Covers
- Dinette Base Cabinet w/Storage
- Cabinet Storage for the Sink and Range Covers
- Additional Receptacle Outlets in Galley
- 120V Outlet & Telephone Jack at Dinette

- 120V/12V AC/DC Central Electrical Panel
- Shoe Storage in Wardrobe Closet
- Wardrobe Light
- Secondary Phone Jack
- Second Solid Surface Lavy Sink w/Solid Surface Top (Select Models)

Options Interior

THROUGHOUT

- Flexsteel® 6-Way Power Passenger Spacious Seat w/Heat Power Lumbar/Electric Footrest
- Nuheat™ Heated Tile Floor
- Passenger Side Sofa Overhead
- Hydronic Heating System (N/A on 40L Model)
- Central Vacuum System w/Tool Kit

DRIVER CONVENIENCE

- Visteon® AM/FM CD-6 Radio In Dash w/Sirius® Satellite Radio (Includes One Year Subscription)
- CB Radio Ready (Power & Antenna)
- Color GPS Navigation System w/Trip Tek
- Color GPS Navigation System
- Night Vision-Raytheon
- Trip Tek
- OnStar® Navigation System (Includes One Year Subscription)

GALLEY

- "Insta-Hot" Hot & Cold Water Dispenser
- Recessed KitchenAid® 2-Burner Cook Top

- Nuheat™ Heated Tile Floor
- Norcold® 120V/LPG 12 cu. ft. (4) Door Refrigerator w/Icemaker/Brushed Aluminum Finish
- Galley to Entry Tile Flooring (Fabrica® Area Rugs Included w/Option/Carpeting Still Available Under Flush Floor Areas) (N/A on 40L Model)

BEDROOM

- Shirt Wardrobe w/Drawers at Rear Wall
- Bedroom Ceiling Fan
- King Bed (72" x 76")
- Full Length Wardrobe at Rear Wall
- Washer/Dryer Ready (Delete W/D, Add 2 Shelves)
- Heat Pump AC

LIVING ROOM

- Dual 32" Sony® Flat Panel TV's, Sony® Home Theater System, HD Components, (DSS Upgraded to "In-Motion") Second HD DSS Receiver and Bose® 3-2-1 Home Theater System in Bedroom

- 68" Flexsteel® Leather Sofa w/Removable Arms (Select Models)
- 68" Flexsteel® Loveseat w/Removable Arms (Select Models)
- 72" Flexsteel® Sofa Bed w/Removable Arms (Select Models)
- 80" Flexsteel® Leather Sofa Bed w/Air Mattress (Select Models)
- Flexsteel® Free Standing Leather Recliner w/Footrest (Includes End Table) (Select Models)
- Desk w/Flexsteel® Free Standing Leather Euro Chair w/Ottoman (Select Models)
- Facing Dinette (Upholstered Booth w/Storage No Additional Sleeping) (Select Models)
- Free Standing Dinette w/Bay Windows (Select Models)
- Fabrica® Inlaid Carpet-Living Room
- 58" Flexsteel® Leather Love Seat (Select Models)

* Denotes Fleetwood's Key Features

Standard Features

Exterior

THROUGHOUT

- **Hydraulic Genset Slide-Out***
- **Aluminum Wheels***
- **Onan® 7.5kW Quiet Diesel Generator w/Power Slide-Out (40' Models)***
- **Onan® 10.0kW Quiet Diesel Generator w/Power Slide-Out (42' Models)***
- **Chrome "Bus-Like" Heated Mirrors w/Remote Adjustment & Turn Signal Indicators***
- **Power Double Entry Step w/Last Out Feature***
- **Electric Patio Awning***
- **Dual Pane Windows w/Screens***
- **Trailer Hitch Receiver 15,000 lbs.***
- Automatic Generator Start Switch
- 295/80R LRH 22.5" Radial Tires
- Hadley® Air Horns
- Utility Light, Front & Rear
- (4) 12V Maintenance Free AGM House Batteries (Group 27)
- Electronic Battery Control Center

BODY STRUCTURE

- **Lightweight Aluminum Wall Construction***
- **Bonded One-Piece Windshield w/Steel Frame***
- **Vacu-bond® Sidewall, Roof & Floor Construction***

AUTOMOTIVE

- **Anti-Lock Brake System (ABS)***
- **4-Point Automatic Leveling Jacks***
- Allison® 3000 MH, 6-Speed Automatic Transmission (w/400HP Engines)

STORAGE

- **30" Front Entry Door w/Dead Bolt & Pneumatic (Air) Lock***
- **Power Luggage Door Locks w/Key Fob***

- Chrome Hitch Cover, Pin & Clip
- One-Piece Domed Fiberglass Roof
- (2) 12V Chassis Batteries—1000 cca Per Battery
- Gelcoat Fiberglass Exterior Sidewalls
- Fiberglass Front Quarter Panels/Wheel Trims
- Protective Vinyl Front Cover
- Xenon High Intensity Headlights
- Polished Stainless Steel Bumpers—Front & Rear
- Large Windshield Washer Bottle
- Entry Screen Door
- Stainless Brushed Polished Kick Plate Under Entry Door
- Window Awnings (Bedroom & Front Roadside Windows)
- Large Passenger Window
- Color Coded Awnings & Awning Arms
- Mud Flaps Front & Rear
- Floor Mounted LPG Tank, 38 Gallons
- Patio Receptacles

- Sound Insulation in Sub Floors, Front & Rear
- Steel Surface on Front Bulkhead/Engine Frame
- Interlocking Extrusions – Floor & Roof

- Allison® 4000 MH, 6-Speed Automatic Transmission (w/525 HP Engines)
- Air Ride Suspension w/Bilstein® Shocks/Spartan®

- **Drop In Pin Retention System for Side Hinged Doors***
- **Side Hinged Compartment Doors* (Most Locations)**

- Porch Light
- Full Width Rear Rock Guard w/Logo
- (4) Turn Signal Repeaters Per Side of Coach
- 25' Fresh Water Hose
- Variable Speed Aquatec Water Pump
- Water Heater By/Pass Check Valve
- Fresh Water Gravity Fill
- Water Pump Switches
- Holding Tanks w/Low Point Drain Valves
- Exterior Convenience Light at Dump Valves
- Dual Holding Tank
- San-T-Flush™ System
- Spray Wand w/Soap Dispenser & Paper Towel Holder
- Integrated Rear Upper Fiberglass Wing Deflector
- Power Cord Reel w/50 Amp Service
- 50' Air Service Line
- Two Piece Rear Ladder

- Insulated Storage Area
- Full Fiberglass Front & Rear Caps
- Heated Water & Holding Tank Compartments

- Exhaust Brake On-Off (C9)
- Engine Brake On-Off (Hi-Lo) (C13)
- Chassis Service Panel

- Luggage Compartment Lights
- (4) 12V Electrical Outlets in Exterior Luggage Compartments Near Each Corner of Coach

SAFETY/CONVENIENCE

- **Keyless Entry Door w/Key Fob & Remotes***
- **Tire Pressure Check Gauge***
- Auxiliary Fog Lamps

- 3 Point Integrated Seat Belt/Driver & Passenger Seats
- Docking Lights, Front & Rear
- Back-Up Alarm

- Deluxe Lighted Entry Assist Handle w/Logo
- Entry Door Awning

Options Exterior

THROUGHOUT

- Powertec 8.0 kW Diesel Generator w/Power Slide-Out (40' Models)
- Lexan Front Acrylic Shield
- Girard Electric Awning Package (All Electric—Bedroom, Front Roadside & Patio)
- Power Water Hose Reel
- (8) Exterior Graphic Packages
- "A" Tray Package (2) 90" (N/A on 42' w/ Hydro Hot, or 40L)
- "B" Tray Package (2) 54" & (2) 36" (N/A on 42' w/ Hydro Hot, or 40L)

- Spot Light
- VIP Factory Delivery
- "C" Tray Package (1) 90", (1) 54", (1) 36" (N/A on 42' w/ Hydro Hot, or 40L)
- "D" Tray Package (1) 54", (1) 36" (N/A on 42' w/ Hydro Hot)
- "E" Tray Package (1) 90" & (1) 54" (Available w/Hydro Hot Only)
- Exterior Entertainment Center (24" Vega TV w/Swivel Slide Tray w/ Top Mount Hinged Door) (Location is Under S/O Box on Select Models)

- Security Vision w/(2) Cameras
- Norcold® 12V/120V Chest Refrigerator/Freezer AC/DC
- Night Vision-Raytheon w/Front Acrylic Shield

BODY STRUCTURE

- Spartan® IFS Chassis w/Cat® C9 w/400HP (40' Models)
- Spartan® IFS Chassis w/Cat® C13 w/525HP (42' Models)
- CSA Spartan® Package
- Air & Hydraulic Leveling System

Fleetwood Exclusives

- **Liberty Chassis w/Electro Coated Platform***
- **VIP Factory Delivery***
- **Complete TuffPEX® Plumbing System***
- **Liberty Chassis w/Patent Pending***
- **Independent Front Suspension Standard***
- **55 Degree Turning Radius***
- **15,000 lb. Trailer Hitch Receiver***
- **"Maintenance Free" (4) Absorbed Glass Mat 12- Volt Batteries (AGM)***
- **Radius, Interlocking Aluminum Framed and Vacu-Bonded® Roof Structure***
- **Roof Mounted Engine Air Intake***

- **Wide Entry Door, with Pneumatic Entry Door Locks and "Doggy" Window.***
- **Denso Dash A/C System with Approximately 17,000 BTU Cooling.***
- **ESP—Energy System Protect (5,000 Joules of Surge Protection)***
- **Solid Surface Countertop Surfaces***
- **American Coach Design, Flexsteel® Furniture***
- **Fabrica® Carpet***
- **Interior Height—82"***

* Denotes Fleetwood's Key Features

What Drives You?

Maybe it's feeling like you're the only one on Earth. Perhaps it's the unique sense of closeness with the great outdoors. Or, it might be the joy that comes from spending quality time with family and friends. Whatever the reason, we know that you have a strong drive to experience everything that comes with spending time on the road. And for more than 50 years, we've shared that passion with you. Because we're RV enthusiasts ourselves, you can see our passion in the vehicles we design and build. Own a Fleetwood, and you'll feel like you're not just traveling, but embarking on an experience unlike any other. Set your own course for adventure and get out there and explore the world around you. Once you do, you'll see what it is that drives us — it's you.

RV OWNERCARE* is a limited one-year/15,000-mile and three-year/50,000-mile structural warranty, whichever occurs first, and it is fully transferable for the first 12 months. RV OWNERCARE is one of the RV industry's most comprehensive programs and includes systems, appliances, components and construction, with no deductible and no service charge. RV OWNERCARE coverage is provided from a company that will be around in the future to service your needs. See your nearest Fleetwood dealer for a full explanation of benefits and restrictions.

CLUB FLEETWOOD As a Fleetwood owner, you're eligible to become a member of our owners' group, Club Fleetwood. It's a perfect way to meet other Fleetwood owners who love to travel to beautiful resorts and vacation spots all across America. Call (877) 577-2560 and join the fun! Or visit www.fleetwood.com/clubs to learn more. For American Coach specific club information contact: American Coach Association (602) 625-7854, www.americancoachassoc.com or FMCA Chapter (505) 280-0513, www.americancoach-fmca.com.

FLEETWOODRV.COM To locate a dealer near you, visit our website or call 1-800-444-4905. We can also be contacted at Fleetwood Customer Relations, P.O. Box 7638, Riverside, CA 92513-7638.



www.fleetwoodrv.com

IMPORTANT—PLEASE READ Product information, photography and illustrations included in this publication were as accurate as possible at the time of printing. For further product information and changes, please visit our website at www.fleetwoodrv.com or contact your local Fleetwood dealer. Prices, materials, design and specifications are subject to change without notice. All weights, fuel, liquid capacities and dimensions are approximate. Fleetwood has designed its recreational vehicles to provide a variety of uses for customers. Each vehicle features optimal seating, sleeping, storage and fluid capacities. The user is responsible for selecting the proper combination of loads (i.e.: occupants, equipment, fluids, cargo, etc.) to ensure that the vehicle's capacities are not exceeded.

Your local Fleetwood dealer is:

*For complete info see your Fleetwood dealer. © 2004. Fleetwood Enterprises, Inc.
Printed in the USA. Inventory control number AE05F2 10/04.

