

GET DIRTY IN A

# SANDSTORM

TOY HAULER



BY FOREST RIVER INC.



## BIG VALUE IN A SMALL PACKAGE

The new Sandstorm SLC line of half ton toy haulers is based upon feedback from our customers just like you. You told us you wanted a lightweight towable. You said you wanted the flexibility of riding in the dunes or camping with the family in the mountains. And most importantly, you said you wanted value. That's why we now offer the lightweight and easy towing SLC line of toy haulers. If portability and affordability are a concern for you, check out the new SLC line from Sandstorm.



203 SLC SHOWN IN BLUE GRAPHICS

**SLC  
SERIES**

**SLC  
SERIES**

**SLR  
SERIES**

**SLR  
SERIES**

**SLR  
SERIES**

**SRS  
SERIES**

**SRS  
SERIES**

# FLOOR PLANS

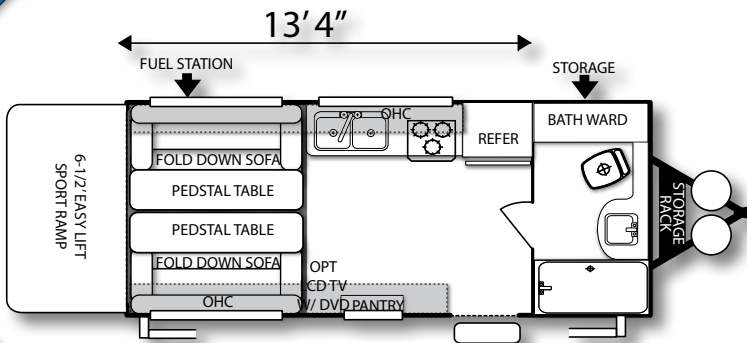

## 166 SLC

Hitch Weight .....692lbs  
 Dry Weight .....4,341lbs  
 GVWR .....7,692lbs  
 CCC.....3,351lbs  
 Fresh..... 56gal  
 Grey/Black ..... 40/40gal  
 Box Length..... 16'11"  
 Total Length..... 21'11"

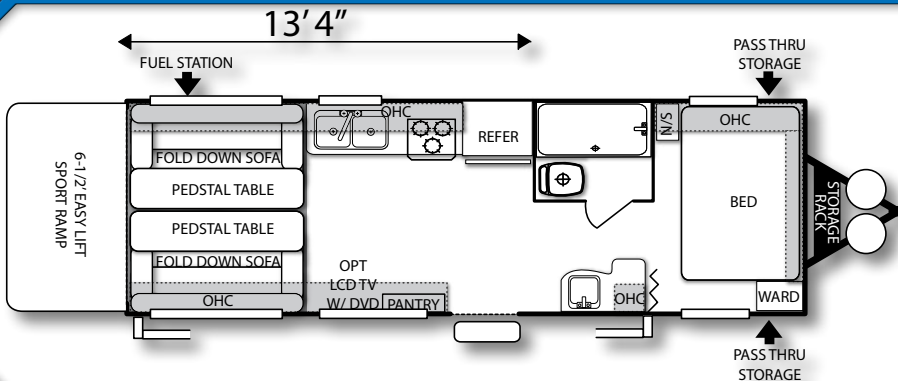

## 203 SLC

Hitch Weight .....661lbs  
 Dry Weight .....4,939lbs  
 GVWR .....7,661lbs  
 CCC.....2,722lbs  
 Fresh..... 56gal  
 Grey/Black ..... 40/40gal  
 Box Length..... 21'8"  
 Total Length..... 26'5"

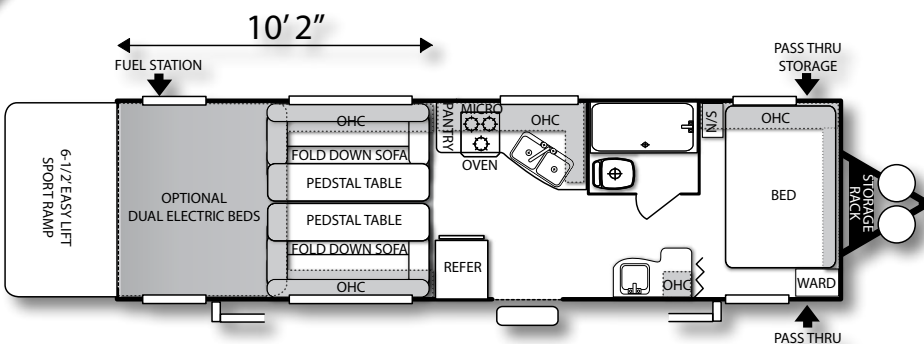

## 233 SLC

Hitch Weight .....876lbs  
 Dry Weight .....6,145lbs  
 GVWR .....10,500lbs  
 CCC.....4,925lbs  
 Fresh..... 56gal  
 Grey/Black ..... 40/40gal  
 Box Length..... 23'5"  
 Total Length..... 28'5"



**AFFORDABLE, FUN, AND FUNCTIONAL**



Oversized pass through storage compartments with interior lights are standard on front bedroom models. Notice the full interior finish and huge cargo access door. This is a perfect spot for storing larger items like camp chairs, coolers, and miscellaneous other gear.

Regardless of where your trip takes you, power will not be a problem. At Sandstorm we offer you the option of either a portable generator or a built in unit on every SLC model. The custom chassis is designed with a convenient front rack for transporting the portable generator pictured below. Fuel is not an issue because we put in a 35 gallon fuel station standard on every model.



203 show with Dune interior and optional equipment.

Doorside mood lighting. Only from Sandstorm.



Extra large windows, his and her reading lights, and a new partial walk-around bed design make the SLC bedroom easy to get into and more comfortable when you get there.



**SLC**  
**SERIES**

**SLC**  
**SERIES**

**SLR**  
**SERIES**

**SLR**  
**SERIES**

**SLR**  
**SERIES**

**SRS**  
**SERIES**

**SRS**  
**SERIES**

# SLC SERIES CONSTRUCTION & SAFETY

## AXLES/FLOOR/FRAME

- 10" ELECTRIC BRAKES 15" CHROME WHEELS
- 20# LP BOTTLES W/ MOLDED COVER
- 20K BTU FURNACE
- 3,500LB AXLES W/ ULTRA LUBE HUBS
- 5,200LB AXLES W/ ULTRA LUBE HUBS (T233)
- 6" I-BEAM CHASSIS BY LIPPERT COMPONENTS
- 6" TUBE OUTRIGGERS AT WHEEL WELLS
- CHROME SPARE TIRE & CARRIER
- DUAL BATTERY STORAGE
- FULL FLOOR STRINGERS W/ 16" CENTERS
- FULL LENGTH LINOLEUM FLOORING
- FULL LENGTH WELDED Z-OUTRIGGERS
- INSULATED & ENCLOSED DARCO UNDERBELLY
- ONE PIECE 5/8" FLOOR DECKING
- R-8 INSULATION IN FLOOR
- RADIAL TIRES
- RADIUS ENTRY STEPS
- SAFETY CHAINS & BRAKE-AWAY CABLE
- STABILIZER JACKS ALL CORNERS
- TONGUE MOUNTED STORAGE RACK
- WIDE TRACK AXLE SYSTEM

## RAMP & CARGO FEATURES

- 93" x 78" RAMP DOOR OPENING
- CENTER & SIDE RAIL 1,200LB TIE DOWNS
- EASY LIFT RAMP DOOR W/ HIDDEN SPRING ASSIST
- KEY LOCK RAMP DOOR
- RADIUS RAMP DOOR W/ 3,000LB RATING
- RAMP DOOR W/ POSI LOCK LATCHES

## HOLDING TANKS

- 56 GALLON FRESH WATER CAPACITY
- FUEL STATION W/ 35 GALLON TANK
- MOLDED 1 PIECE HOLDING TANKS BY INCA PLASTICS
- QUICK RELEASE FRESH WATER DRAIN

## INTERIOR

- 12 VOLT BATHROOM FAN
- 13.5 BTU A/C
- 3 BURNER COOK TOP
- 96" WALL TO WALL
- ABS TUB SURROUND
- AM/FM CD PLAYER W/ SPEAKERS & MP3 INPUT
- BATTERY DISCONNECT
- BED SPREAD W/ PILLOWS & SHAMS
- CARBON MONOXIDE DETECTOR
- DELUXE VALANCES W/ MINI BLINDS
- DISTRESSED CHERRYWOOD INTERIOR CABINERY
- DOMETIC 6 CUBIC FOOT DOUBLE DOOR REFER
- DUAL WALL MOUNTED, STEEL FRAMED SOFAS W/ TABLES
- FIRE EXTINGUISHER
- FOOT FLUSH PORCELAIN TOILET
- HALOGEN CEILING LIGHTS
- LIGHTED STORAGE COMPARTMENTS
- LP GAS LEAK DETECTOR
- METAL DRAWER GUIDES
- MICROWAVE W/ CAROUSEL
- PANTRY ( WHERE AVAILABLE)
- SINK COVERS
- SMOKE DETECTOR
- SOLID WOOD RAISED PANEL CABINET DOORS
- SYSTEMS MONITOR PANEL
- WATER HEATER 6 GALLON GAS W/ DSI (DIRECT SPARK IGNITION)

## SIDE WALL FEATURES

- WALL STUDS 16" CENTERS
- AWNING
- DOUBLE STUDDED AT WALL STRESS AREA
- EXTERIOR DIAMOND PLATE
- EXTERIOR SPEAKER PACKAGE
- HEAVY GAUGE ALUMINUM SIDING
- R-8 INSULATION IN WALLS
- RADIUS ENTRY DOOR
- RADIUS SLIDER WINDOWS W/ TINTED GLASS
- STEEL STRAPPED FOR ADDITIONAL SUPPORT
- WASH DOWN KIT W/ PRESSURE WASHER

## EXTERIOR LIGHTING

- 12 VOLT HITCH LIGHT
- BACK UP HIGH INTENSITY LIGHTS
- HIGH INTENSITY ENTRY LIGHT ON DIMMER SWITCH
- HIGH INTENSITY LIGHT ROAD SIDE
- HIGH INTENSITY LIGHTS REAR CARGO DOOR
- LED CLEARANCE & BRAKE LIGHTS

## ROOF FEATURES

- ONE PIECE RUBBER ROOF W/ 12YR WARRANTY
- R-8 INSULATION IN CEILING
- RAIN DOWN SPOUTS
- SKYLIGHT IN BATH
- TV ANTENNA

## SLC SERIES OPTIONS

- 3.5 PORTABLE GENERATOR
- 4G GENERAC GENERATOR
- 4.0 ONAN GENERATOR
- ADD A WALL SCREEN
- ADDITIONAL 50GAL FRESH WATER TANK (NA 166SLC)
- ALUMA-WALL FIBERGLASS EXTERIOR W/ BLOCK FOAM
- BLACK TANK FLUSH
- CARPET KIT
- CLARION "PRO AUDIO" SOUND SYSTEM
- CONVECTION MICROWAVE OVEN
- CSA CANADIAN APPROVAL
- DUAL ELECTRIC SPORT BEDS (PER FP)
- LCD TV W/ DVD IN LIVING AREA
- TOYLOK
- WATER FILTER SYSTEM
- WATER HEATER BY-PASS

# SLR

## SETTING THE NEW STANDARD

For the 2012 model year we've taken the guesswork out of buying a toy hauler. Introducing the SLR series of half ton and light duty three quarter ton trailers and fifth wheels. By including a built in Generac generator, 35 gallon fuel station, electric awning, flat panel LCD TV with DVD, and our pro audio sound system as standard equipment, we've made buying your new toy hauler a breeze. You'll just have to pick the color!



SANDSTORM TRAVEL TRAILER SLR SHOWN IN RED GRAPHICS

SLR  
SERIES

SLC  
SERIES

SLC  
SERIES

SLR  
SERIES

SLR  
SERIES

SRS  
SERIES

SRS  
SERIES

# FLOOR PLANS

## FRONT BATH FLOOR PLANS

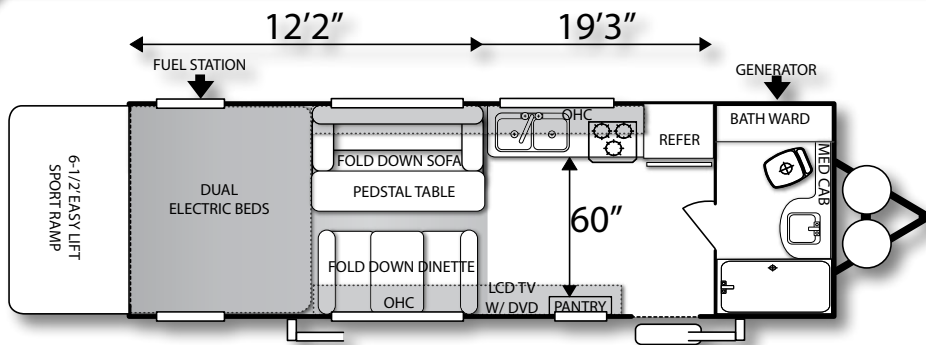

### 226 SLR

Hitch Weight .....1,030lbs  
 Dry Weight .....5,959lbs  
 GVWR .....11,000lbs  
 CCC.....5,041lbs  
 Fresh..... 106gal  
 Grey/Black ..... 40/40gal  
 Box Length..... 23'  
 Total Length ..... 26'7"

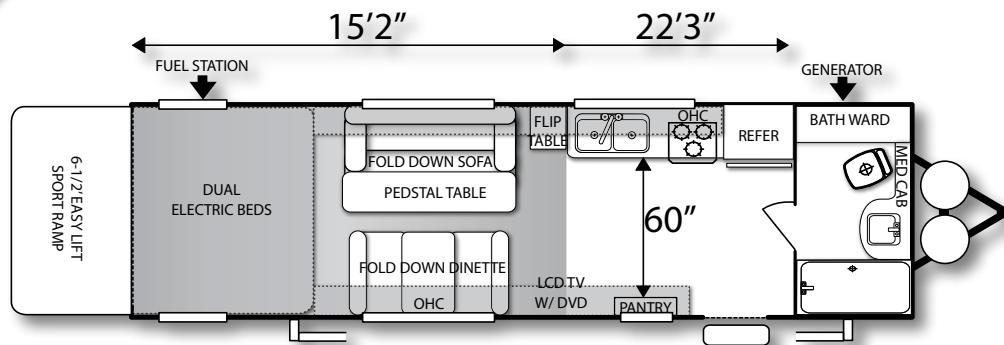

### 256 SLR

Hitch Weight .....1,185lbs  
 Dry Weight .....6,304lbs  
 GVWR .....11,000lbs  
 CCC.....4,696lbs  
 Fresh..... 106gal  
 Grey/Black ..... 40/40gal  
 Box Length..... 26'  
 Total Length ..... 29'7"



With so many innovative floorplans like the 226 SLR shown in Mocha decor above, the SLR series from Sandstorm brings you the right toyhauler at the right price.



DESIGNED TO WORK FOR THE WHOLE FAMILY

## FRONT BEDROOM FLOOR PLANS

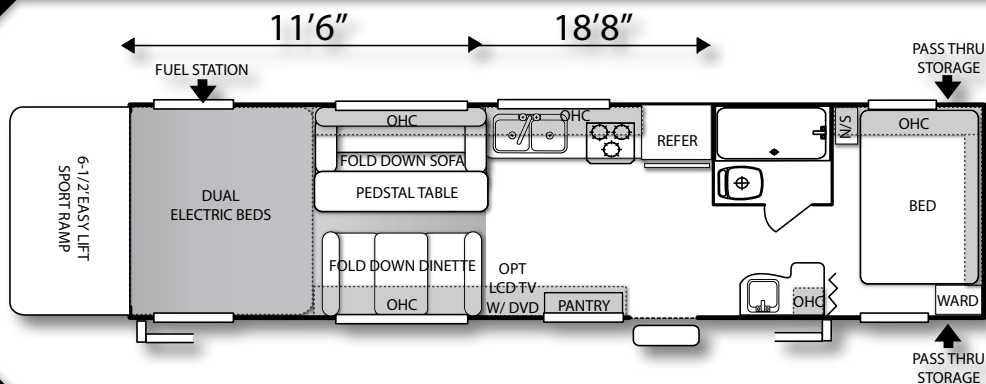

### 263 SLR

Hitch Weight .....1,003lbs  
 Dry Weight .....6,732lbs  
 GVWR .....11,000lbs  
 CCC.....4,268lbs  
 Fresh.....106gal  
 Grey/Black .....40/50gal  
 Box Length.....27'1"  
 Total Length .....31'

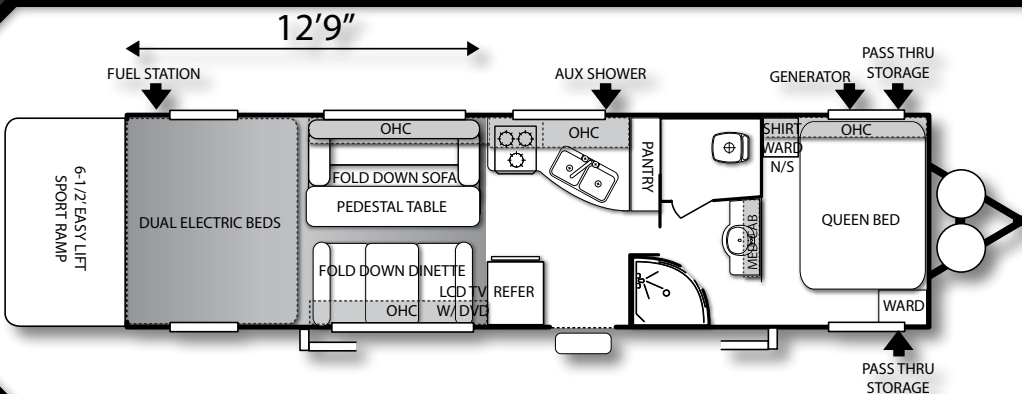

### 272 SLR

Hitch Weight .....1,305lbs  
 Dry Weight .....7,644lbs  
 GVWR .....11,500lbs  
 CCC.....3,856lbs  
 Fresh.....106gal  
 Grey/Black .....40/40gal  
 Box Length.....28'9"  
 Total Length .....32'7"

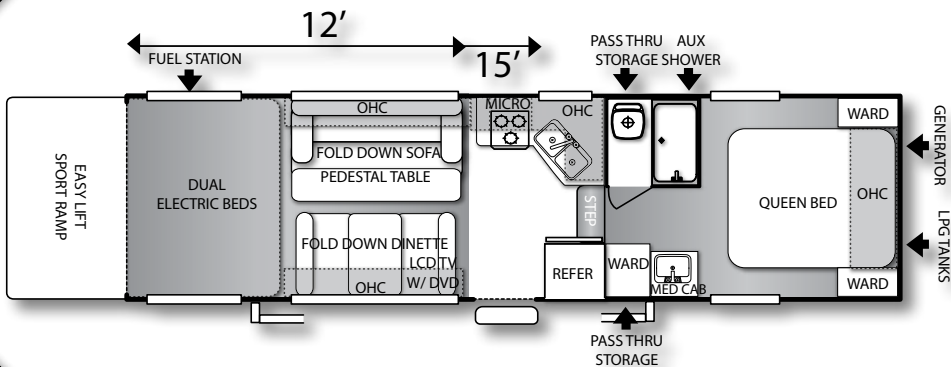

### 2935 SLR

Hitch Weight .....1,927lbs  
 Dry Weight .....7,720lbs  
 GVWR .....12,000lbs  
 CCC.....4,280lbs  
 Fresh.....106gal  
 Grey/Black .....40/40gal  
 Box Length.....29'1"  
 Total Length .....30'4"

SLR  
 SERIES

SLC  
 SERIES

SLC  
 SERIES

SLR  
 SERIES

SLR  
 SERIES

SRS  
 SERIES

SRS  
 SERIES



T263SLR Shown in Onyx Black decor, featuring new upgraded furniture and is built with a large view window in the kitchen allowing for more ambient lighting and better ventilation over our competitors. Also standard on all Sandstorms is an exterior pressure washer with retractable hose and adjustable nozzle.



# SLR

## FEATURE PACKED INSIDE AND OUT



Just push a button and the standard electric awning does the rest of the work for you.



The easy lift ramp door has hidden springs, radius edging, back up lights, and keyed locks for safety. The lightweight design is a secret, but you'll appreciate the engineering every time you lift the ramp.



The 2935 shown above comes loaded with all the kitchen amenities you need including home style pull out sprayer faucet, stove cover, and large slider window.

**SLR  
SERIES**

**SLC  
SERIES**

**SLC  
SERIES**

**SLR  
SERIES**

**SLR  
SERIES**

**SRS  
SERIES**

**SRS  
SERIES**

# SLR SERIES CONSTRUCTION & SAFETY

## AXLES/FLOOR/FRAME

- 12" ELECTRIC BRAKES
- 15" CHROME WHEELS
- 20K OR 30K BTU FURNACE (PER FP)
- 30# LP BOTTLES W/ MOLDED COVER (TRAVEL TRAILERS)
- 4.0 INSTALLED GENERAC GENERATOR CARB CERTIFIED
- 5,200LB AXLES W/ ULTRA LUBE HUBS
- 6" OR 8" I-BEAM CHASSIS BY LIPPERT (PER FP)
- 6" TUBE OUTRIGGERS AT WHEEL WELLS
- CHROME SPARE TIRE & CARRIER
- DUAL BATTERY STORAGE
- FULL LENGTH FLOOR STRINGERS W/ 16" CENTERS
- FULL LENGTH LINOLEUM FLOORING
- FULL LENGTH WELDED Z-OUTRIGGERS
- FULLY INSULATED & ENCLOSED DARCO UNDERBELLY
- MONSTER BASEMENT STORAGE (5TH WHEELS)
- ONE PIECE 5/8" FLOOR DECKING
- R-8 INSULATION IN FLOOR
- RADIAL TIRES
- RADIUS ENTRY STEPS
- SAFETY CHAINS & BRAKE-AWAY CABLE (TRAVEL TRAILERS)
- STABILIZER JACKS
- WIDE TRACK AXLE SYSTEM

## RAMP & CARGO FEATURES

- 58" x 78" QUAD RAMP DOOR OPENING
- 93" x 78" RAMP DOOR OPENING
- CENTER & SIDE RAIL 1,200LB TIE DOWNS
- EASY LIFT RAMP DOOR W/ HIDDEN SPRING ASSIST
- KEY LOCK RAMP DOOR
- RADIUS RAMP DOOR W/ 3,000LB RATING
- RAMP DOOR W/ POSI LOCK LATCHES

## HOLDING TANKS

- 106 GALLON FRESH WATER CAPACITY
- BLACK TANK FLUSH
- FUEL STATION W/ 35 GALLON TANK
- MOLDED 1 PIECE HOLDING TANKS BY INCA PLASTICS
- QUICK RELEASE FRESH WATER DRAIN

## INTERIOR

- 12 VOLT BATHROOM FAN
- 13.5 BTU A/C (DUCTED FRONT BEDROOMS)
- 96" WALL TO WALL
- ABS TUB SURROUND & BATH SKYLIGHT
- BATTERY DISCONNECT
- BED SPREAD W/ PILLOWS & SHAMS
- CARBON MONOXIDE DETECTOR
- CARPET KIT
- CLARION "PRO AUDIO" SOUND SYSTEM W/ SUB & AMP
- DELUXE VALANCES W/ MINI BLINDS
- DIAMOND PLATE INTERIOR
- DISTRESSED CHERRYWOOD INTERIOR CABINETRY
- DOMETIC 6 CUBIC FOOT DOUBLE DOOR REFER
- DUAL ELECTRIC SPORT BEDS
- FIRE EXTINGUISHER
- FOOT FLUSH PORCELAIN TOILET
- GOURMET 3 BURNER COOK TOP W/ COVER
- HALOGEN CEILING LIGHTS
- LCD TV W/ DVD IN LIVING AREA
- LIGHTED STORAGE COMPARTMENTS
- LP GAS LEAK DETECTOR
- MASTER CONTROL & SYSTEMS MONITOR PANEL
- METAL DRAWER GLIDES
- MICROWAVE W/ CAROUSEL
- PANTRY (PER FP)
- PICTURE WINDOW W/ FOLD DOWN DINETTE & TABLE
- SINK COVERS
- SMOKE DETECTOR
- SOLID WOOD RAISED PANEL CABINET DOORS
- WALL MOUNTED STEEL FRAMED SOFA W/ TABLE
- WATER HEATER 6 GALLON GAS W/ DSI (DIRECT SPARK IGNITION)

## SIDE WALL FEATURES

- WALL STUDS 16" CENTERS
- CUSTOM MOLDED FENDER SKIRTS
- DOUBLE STUDDED AT WALL STRESS AREA
- ELECTRIC AWNING
- EXTERIOR DIAMOND PLATE W/ RADIUS AUTO MOLD
- EXTERIOR SPEAKER PACKAGE
- HEAVY GAUGE ALUMINUM SIDING
- LP QUICK DISCONNECT
- R-8 INSULATION IN WALLS
- RADIUS ENTRY DOOR
- RADIUS SLIDER WINDOWS W/ TINTED GLASS
- SAFETY GLASS TINTED WINDOWS (5TH WHEELS)
- STEEL STRAPPED FOR ADDITIONAL SUPPORT
- WASH DOWN KIT W/ PRESSURE WASHER

## EXTERIOR LIGHTING

- 12 VOLT HITCH LIGHT
- BACK UP HIGH INTENSITY LIGHTS
- HIGH INTENSITY ENTRY LIGHTS ON DIMMER SWITCH
- HIGH INTENSITY LIGHT ROAD SIDE
- HIGH INTENSITY LIGHTS REAR CARGO DOOR
- LED CLEARANCE & BRAKE LIGHTS

## ROOF FEATURES

- ONE PIECE RUBBER ROOF W/ 12YR WARRANTY
- R-8 INSULATION IN CEILING
- RAIN DOWN SPOUTS
- SKYLIGHT IN BATH
- TV ANTENNA

# SLR SERIES OPTIONS

- 4.0 ONAN GENERATOR
- A/C 15,000 BTU UPGRADE
- ADD A WALL
- ALUMA-WALL FIBERGLASS EXTERIOR W/ BLOCK FOAM
- CEILING FAN (FW'S)
- CENTRAL VACUUM SYSTEM
- CONVECTION MICROWAVE OVEN
- CONVENIENCE PACKAGE W/ BBQ
- CREATE A BREEZE FAN
- CSA CANADIAN APPROVAL
- DECKED ROOF W/ LADDER
- DOUBLE INSULATION ROOF & FLOOR
- DOUBLE SOFA IPO LOWER QUEEN BED
- DUAL PANE WINDOWS
- EQUA-FLEX
- EXTRA LARGE 8 CUBIC REFER

- FRONT FIBERGLASS CAP
- HEAT STRIPS 12 VOLT
- INSULATED & ENCLOSED TANKS
- IPOD CRADLE
- LCD TV W/ DVD IN BEDROOM
- NIGHT SHADES
- SOLID SURFACE C-TOPS W/ PULL-OUT FAUCET & STAINLESS STEEL SINK
- POWER JACKS (TT'S)
- RAISED REFER PANEL
- SWIVEL CHAIRS (2) W/ TABLE IPO DINETTE
- TOUGH PLY FLOORING
- TOYLOK
- UPGRADED FURNITURE PACKAGE
- WATER FILTER SYSTEM
- WATER HEATER BY-PASS

# SRS

102" WIDEBODY CONSTRUCTION, BECAUSE SIZE MATTERS

The new SRS series has been designed to make every aspect of your trip more comfortable. Every SRS model features triple axles, 35 gallon fuel station, 18 gallon generator fuel tank, a beaver tailed ramp entry, and a built in Generac generator. The living area comes with our new upgraded SRS furniture package, pro audio sound, and a full size HD LCD TV with DVD player. Kitchens benefit from designer solid surface counter tops, extra large refrigerators, and a pull out spray nozzle for your convenience, while the bathrooms have large changing areas along with a new radius glass shower. On the outside you'll find high gloss gel coated sidewalls, radical new front and rear caps, LED running lights, and monster sized basement storage on the fifth wheel models. Check out the new SRS series from Sandstorm. You'll be surprised at everything we've packed into this mid priced toy hauler.



**SRS  
SERIES**

**SLC  
SERIES**

**SLC  
SERIES**

**SLR  
SERIES**

**SLR  
SERIES**

**SLR  
SERIES**

**SRS  
SERIES**

# FLOOR PLANS

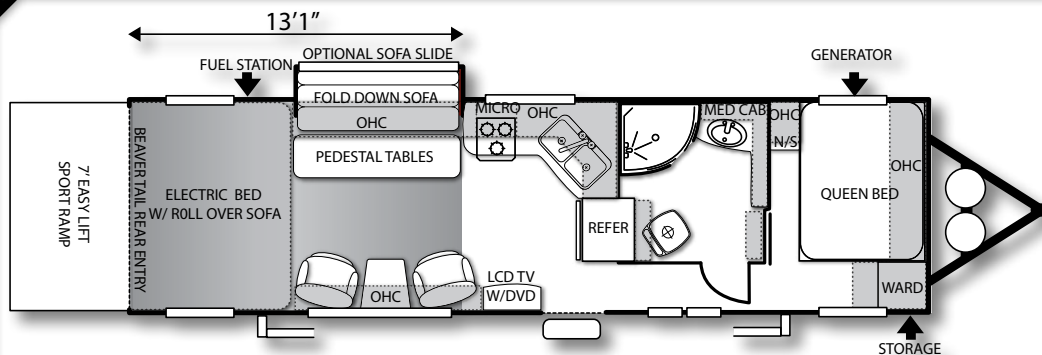

## 291 SRS

Hitch Weight .....1,204lbs  
 Dry Weight .....8,675lbs  
 GVWR .....13,500lbs  
 CCC .....4,825lbs  
 Fresh ..... 200gal  
 Grey/Black ..... 50/50gal  
 Box Length ..... 30'5"  
 Total Length ..... 34'1"

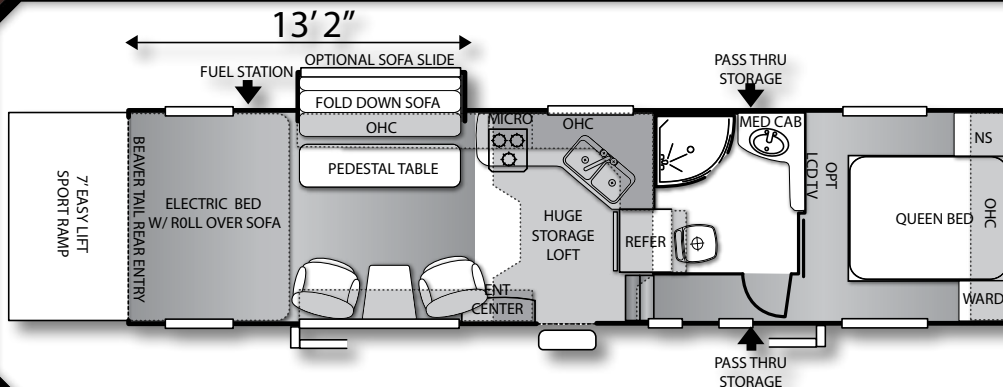

## 3215 SRS

Hitch Weight .....2,728lbs  
 Dry Weight .....10,034lbs  
 GVWR .....15,000lbs  
 CCC .....4,966lbs  
 Fresh ..... 200gal  
 Grey/Black ..... 50/50gal  
 Box Length ..... 32'5"  
 Total Length ..... 34'2"

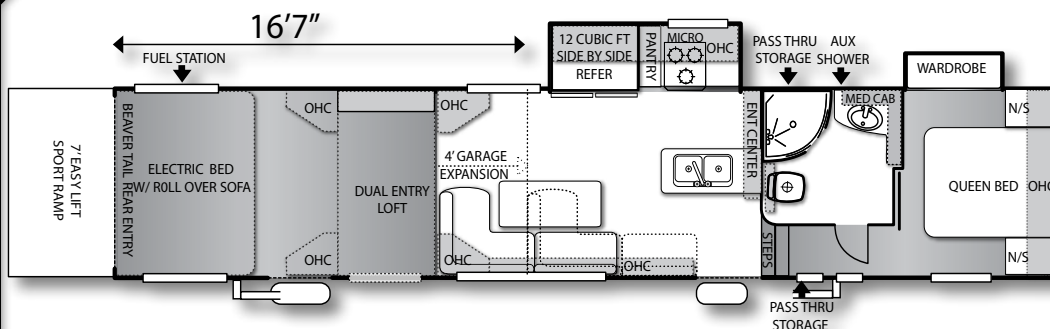

## 3975 SRS

Hitch Weight .....2,704lbs  
 Dry Weight .....13,121lbs  
 GVWR .....19,000lbs  
 CCC .....5,879lbs  
 Fresh ..... 200gal  
 Grey/Black ..... 50/50gal  
 Box Length ..... 39'5"  
 Total Length ..... 41'6"

**MORE FLOOR PLANS COMING!**

# SRS

FULL SIZED AND FULLY LOADED, ANY QUESTIONS?



SRS kitchens are well equipped for even the fussiest chefs. We start with upgraded distressed cherry cabinetry, solid surface counter tops with stainless steel sinks and a pull out sprayer faucet and matching sink covers. Then we increase the kitchen's appeal by adding additional pantry or overhead cabinet storage and solid wood drawers with heavy duty full length roller guides. SRS kitchen appliances consist of a gourmet cook top with cover, convection microwave oven and an extra large refrigerator.



The SRS Furniture package includes custom high back chairs and upgraded sofas with removable armrests, heavy duty padding and a new custom look for the 2012 model year.



Roughing it never felt so good. Full size walk around queen beds, pillow top mattresses and solid privacy door you'll feel right at home in our bedrooms.

**SRS  
SERIES**

**SLC  
SERIES**

**SLC  
SERIES**

**SLR  
SERIES**

**SLR  
SERIES**

**SLR  
SERIES**

**SRS  
SERIES**

# SRS SERIES CONSTRUCTION & SAFETY

## AXLES/FLOOR/FRAME

- 10" OR 12" I-BEAM CHASSIS BY LIPPERT (PER FP)
- 102" WIDE BODY CONSTRUCTION
- 12" ELECTRIC BRAKES
- 15" OR 16" ALUMINUM WHEELS & RADIAL TIRES (PER FP)
- 2" BY 3" FLOORS GARAGE MODELS & F3975 (SLIDE-BACK)
- 30# LP BOTTLES W/ MOLDED COVER (TRAVEL TRAILERS)
- 30K OR 40K BTU FURNACE (PER FP)
- 4.0 INSTALLED ONAN GENERATOR CARB CERTIFIED
- 5,200LB AXLES W/ ULTRA LUBE HUBS
- 5/8" FLOOR DECKING
- ALUMINUM SPARE TIRE & CARRIER
- DUAL BATTERY STORAGE
- FULL LENGTH FLOOR STRINGERS W/ 16" CENTERS (PER FP)
- FULL LENGTH LINOLEUM FLOORING
- FULL LENGTH WELDED Z-OUTRIGGERS
- FULLY INSULATED & ENCLOSED DARCO UNDERBELLY
- MONSTER BASEMENT STORAGE (5TH WHEELS)
- R-8 INSULATION IN FLOOR
- SAFETY CHAINS & BRAKE-AWAY CABLE (TRAVEL TRAILERS)
- STABILIZER JACKS
- TRIPLE RADIUS ENTRY STEPS
- WIDE TRACK AXLE SYSTEM

## RAMP & CARGO FEATURES

- 95" x 84" RAMP DOOR OPENING
- ADD-A-WALL
- CENTER & SIDE RAIL 1,200LB TIE DOWNS
- EASY LIFT RAMP DOOR W/ HIDDEN SPRING ASSIST
- KEY LOCK RAMP DOOR
- RADIUS RAMP DOOR W/ 3,000LB RATING
- RAMP DOOR W/ POSI LOCK LATCHES
- REAR OVERHEAD CABINETS (GARAGE MODELS)
- SLIDING GLASS CARGO DOOR (GARAGE MODELS)

## HOLDING TANKS

- 18 GALLON GENERATOR FUEL TANK
- 200 GALLON FRESH WATER CAPACITY
- BAFFLED TANKS FOR STRENGTH AND TOWABILITY
- BLACK TANK FLUSH
- FUEL STATION W/ 35 GALLON TANK
- MOLDED 1 PIECE HOLDING TANKS BY INCA PLASTICS
- QUICK RELEASE FRESH WATER DRAIN

## INTERIOR

- 8 CU FT DOMETIC DOUBLE DOOR REFER W/ INSERT
- 12 CU FT DOUBLE DOOR REFER (PER FP)
- 12 VOLT BATHROOM FAN
- 15K BTU DUCTED A/C
- 60" BY 80" RESIDENTIAL QUEEN BED
- 98" WALL TO WALL
- BATTERY DISCONNECT
- BED SPREAD W/ PILLOWS & SHAMS
- CARBON MONOXIDE DETECTOR
- CARPET KIT
- CEILING FAN (5TH WHEELS)
- CLARION "PRO AUDIO" SOUND SYSTEM W/ SUB & AMP
- CONVECTION MICROWAVE OVEN
- DELUXE VALANCES W/ MINI BLINDS
- DIAMOND PLATE INTERIOR
- DISTRESSED CHERRYWOOD INTERIOR CABINETRY
- DOUBLE SOFA IPO LOWER QUEEN BED
- FIRE EXTINGUISHER
- FOOT FLUSH PORCELAIN TOILET
- FULL LENGTH BALL BEARING DRAWER GUIDES
- GOURMET 3 BURNER COOK TOP W/ COVER
- HALOGEN CEILING LIGHTS
- LCD TV W/ DVD IN LIVING AREA
- LIGHTED STORAGE COMPARTMENTS
- LOFT BED W/ LADDER (PER FP)
- LP GAS LEAK DETECTOR
- MASTER CONTROL & SYSTEMS MONITOR PANEL
- NIGHT SHADES
- OVERSIZED RADIUS GLASS SHOWER W/ SKYLIGHT
- PANTRY (PER FP)
- SINK COVERS
- SMOKE DETECTOR
- SOLID SURFACE COUNTERTOPS W/ STAINLESS STEEL SINKS
- SOLID WOOD RAISED PANEL CABINET DOORS
- SRS CUSTOM SPORT FURNITURE PACKAGE
- SWIVEL CHAIRS W/ PICTURE WINDOW (PER FP)
- WALL MOUNTED STEEL FRAMED SOFA W/ TABLE (PER FP)
- WATER HEATER 10 GALLON GAS W/ DSI (DIRECT SPARK IGNITION)

## SIDE WALL FEATURES

- ALUMA SIDEWALLS W/ GEL COAT FIBERGLASS
- BLOCK WALL FOAM INSULATION
- MOLDED FENDER SKIRTS W/ LED SAFETY LIGHTS
- ELECTRIC AWNING
- EXTERIOR DIAMOND PLATE W/ RADIUS AUTO MOLD
- EXTERIOR SPEAKER PACKAGE
- LP QUICK DISCONNECT
- OUTSIDE SHOWER
- R-8 INSULATION IN WALLS
- RADIUS ENTRY DOOR
- RADIUS SLIDER WINDOWS W/ TINTED GLASS
- SAFETY GLASS TINTED WINDOWS (5TH WHEELS)
- WASH DOWN KIT W/ PRESSURE WASHER

## EXTERIOR LIGHTING

- 12 VOLT HITCH LIGHT
- BACK UP HIGH INTENSITY LIGHTS
- HIGH INTENSITY ENTRY LIGHTS ON DIMMER SWITCH
- HIGH INTENSITY LIGHT ROAD SIDE
- HIGH INTENSITY LIGHTS REAR CARGO DOOR
- LED CLEARANCE & BRAKE LIGHTS

## ROOF FEATURES

- FRONT & REAR CUSTOM FIBERGLASS CAPS
- FULL LENGTH WALK ON ROOF DECKING
- FULL LENGTH CROWNED DECK FOR WATER RUNOFF
- ONE PIECE RUBBER ROOF W/ 12YR WARRANTY
- R-8 INSULATION IN CEILING
- RAIN DOWN SPOUTS
- TOPLINE RETRACTABLE ROOF LADDER
- TV ANTENNA



# SRS SERIES OPTIONS

- A/C 13.5K BTU IN BEDROOM (REQ 5.5 GEN)
- CENTRAL VACUUM SYSTEM
- CREATE A BREEZE FAN
- CSA CANADIAN APPROVAL
- DOUBLE INSULATION ROOF & FLOOR
- DUAL PANE WINDOWS
- EQUA-FLEX
- HEAT STRIPS 12 VOLT
- INSULATED & ENCLOSED TANKS
- IPOD CRADLE (WHERE AVAILABLE)
- LCD TV W/ DVD IN BEDROOM
- ONAN 4.0KW GENERATOR
- ONAN 5.5KW GENERATOR W/ 50 AMP SERVICE
- POWER JACK TT
- SOFA SLIDE (PER FP)
- TOUGH PLY FLOORING
- TOYLOK
- WATER FILTER SYSTEM
- WATER HEATER BY-PASS
- WIRED FOR 2ND A/C (REQ 5.5KW GEN & 50 AMP SERVICE)



# “Peace of Mind”

## Forest River Inc. Exclusive Benefits

- Emergency Roadside Assistance
- Service Assistance
- Nationwide Service Appointment Assistance
- Mobile Mechanics
- \$2,000 Trip Interruption Reimbursement
- 24-Hour Toll-Free Emergency Message Service
- Custom Trip Routing and Full Color Maps

BY COACH-NET®



**Forest River, Inc. encourages our customers to purchase their Forest River products from a local dealership whenever possible for the following reasons:**

It is the goal of Forest River, Inc. that all of our RV owners fully enjoy the RV experience and that customer satisfaction meets or exceeds their expectations!

- 1) Forest River, Inc. dealers are independently owned and operated businesses so priority service and scheduling is at their discretion and is often provided to customers that purchased their unit at that dealership.
- 2) Purchasing locally allows customers to establish meaningful relationships with a dealer, enhancing the RV experience through assistance with product questions, user tips or RV regulations for your state or country, and much more!
- 3) Canadian customers must meet requirements to bring an RV purchased out of the country to their home. These requirements may involve additional inspections and certifications, taxes and fees. Your local Canadian Dealer is a professional at meeting these requirements.
- 4) Scheduling timely warranty repairs and adjustments through a local dealership provides far greater flexibility and convenience to you, the customer!

When you buy a Sandstorm Toy Hauler you are buying the assurance that all your warranty and service needs will be met as we are first in customer satisfaction for a Recreational Vehicle Manufacturer in Southern California according to our Better Business Bureau Rating. Not only are you buying from a company that is going to be around in a year, but also from one committed to the satisfaction of its customers. Having manufactured toy haulers for over 10 years, Forest River Inc. is considered one of the pioneers in the industry. Because every RV enthusiast has different needs, we offer a versatile array of floor plans and features. At Forest River our design team is always working towards improving the toy hauler of tomorrow.



**Learn More**  
Scan this barcode using a QR Reader on your smart phone to learn more about Forest River.



A Berkshire Hathaway company.

Dealer

## Southwest Division

255 S. Pepper Ave. Rialto, CA 92376

(909) 873-3777

[www.forestriverinc.com/sandstorm](http://www.forestriverinc.com/sandstorm)

All illustrations and specifications contained in this literature are based on the latest product information at time of publication. Forest River reserves the right to make changes in price, colors, materials, equipment, and specifications at any time without notice and assumes no responsibility for any error in this literature.