

MARLIN

T W O T H O U S A N D O N E



Specifications

Floorplans

NRV
NATIONAL R.V., INC.

F E A T U R I N G W H Y B U Y A M A R L I N ?

The all new Marlin® by National RV delivers everything you're looking for in a diesel pusher: Power, payload, handling, beauty and confidence. With all those bases covered, it's no wonder those looking to upgrade to a true diesel pusher are looking to the Marlin®. With its Cummins® 300 HP engine, awesome Spartan® stacked rail chassis and smooth Reyco®/Granning® independent front suspension, the Marlin® doesn't know the meaning of the phrase "roughing it".

PAGE

Why Buy A Marlin?	
2	Cummins® ISB Electronic 5.9 Liter 300 HP Diesel Engine
2	Reyco®/Granning® IFS System
3	Allison® MH3000 Transmission
3	Spartan® Summit GTi Chassis 26,000 lb. GVWR
4	Patented Duraframe®
4	Flush Floor Slideout
5	Laminated Roof
5	Laminated Sidewall
5	Laminated Floor
6	Interior Appointment
6	Insulated Windows
7	24 Hour Roadside Assistance

PAGE

Standard Features	
2	Body Construction
2	Electrical System & Lights
3	Interiors
4	Cockpit Features
4	Windows, Doors and Awnings
4	Heating, Vents and Air Conditioning
5	Chassis, Engine and Suspension
6	Appliances and Accessories
6	Safety Features
7	Plumbing and LPG Systems
7	Optional Features
8	Floorplans
9	Measurements



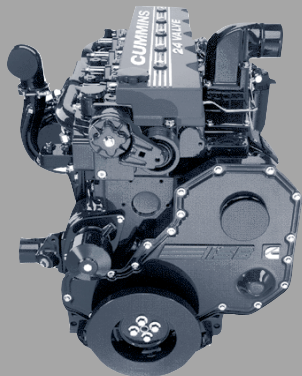

1. Cummins® ISB Electronic 5.9 Liter 300 HP Diesel Engine

- 300 Horsepower
- 660 ft. lbs. Torque
- Block Heater
- Exhaust Brake
- 160 Amp Alternator

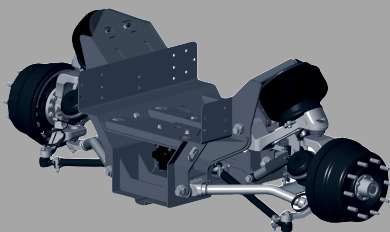

2. Reyco®/Granning® IFS System

- Computer Designed
- Full Air Ride
- Smooth, Steady Ride
- 10,500 lbs. GAWR
- Reduced Tread Wear

The Reyco®/Granning® IFS system is a triumph of automotive engineering, providing a smooth ride with steady handling, great traction and even tread wear.

Body Construction

- *Steel Framed Laminated Crowned Fiberglass Roof*
- *Steel Framed Laminated Fiberglass High Gloss Walls*
- *Flush Floor Electric Slide-Out Room with Laminated Walls*
- *Insulated Fiberglass Exterior Storage Compartment Doors with Integrated Locking Paddle Latches and Struts*
- Laminated Steel Framed Floor
- Molded High Gloss Full Fiberglass Caps Front and Rear with Integrated Bumpers
- Full Panoramic Tinted Windshield
- Soft Touch Fabric Ceiling Material
- Laminated Insulated Sheet Metal Lined Underbelly
- Custom Vinyl Exterior Graphics
- Aluminum Rear Ladder
- Automotive Undercoating As Required
- Steel Insulated Front Bulkhead

Electrical System & Lights

- *50 Amp 120 Volt Distribution Panel and Cord*
- *Dual 18 Watt Solar Panels*
- *Two 6 Volt Deep Cycle RV Batteries*
- *Fluorescent Ceiling Lighting*
- Generac® 6.6 KW LP Generator
- Battery Disconnect Switch
- Porch Light
- Patio Receptacle
- Entry Step Light
- Three Water Pump Switches (Kitchen, Bath and Dump Station)
- Decorative Overhead Dining Light
- Cosmetic Light in Bathroom
- Storage Compartment Lights

Interiors

- *Corian® Kitchen Counter Top*
- *Hide-A-Bed Sleeper Sofa with Designer Pillows*
- *Ceramic Tile Floor in Galley*
- *Day/Night Shades in Living Room*
- Praxis Oak Scratch Resistant Paneling
- Praxis Oak Raised Panel Cabinet Doors
- Telestruts on Overhead Storage Doors and Positive Catches on All Other Doors
- Ball Bearing Rolling Drawer Guides
- Wood Cutting Block Sink Cover
- Corian® Lavy Top in Bathroom
- Kitchen Waste Basket
- Bathroom Mirror with 1" Bevel and Frame
- Towel Bars in Bathroom
- Queen Bed (60" x 80") Head-to-Rear (M350 and M370)
- Queen Bed (60" x 80") Head-to-Side Slide Out (M390)
- Color Coordinated Bedspread, Pillows and Shams
- Radius Padded Headboard
- Nightstands with Corian® Tops
- Booth Dinette with Drawers
- Designer Hutch Shelf with Corian® and Beveled V-Grooved Mirrors (M370 and M390)
- Designer Vinyl Floor in Bath
- Nylon Carpeting and Pad in Bedroom and Living Area
- Mini Blinds in Bedroom and Galley
- Valances and Lambrequins in Living Area and Bedroom

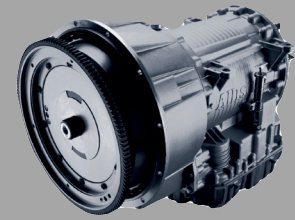

3. Allison® MH3000 Transmission

- Allison®'s Unmatched Reputation for Quality
- 6 Speed
- Smooth, Automatic Shifting
- Computer Controlled

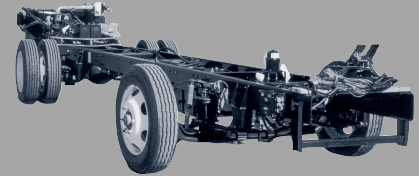

4. Spartan® Summit GTi Chassis 26,000 lb. GVWR

- Raised Rail Frame
- 26,000 lb. GVWR
- Full Air Ride Suspension
- Full Air Brakes
- Michelin Heavy Duty Tires
- Telescoping Tilt Steering Column

Summit GTi's innovative stacked rail frame design provides cavernous pass-through storage. Now you can have bus-style cargo bays at the attractive price of a Marlin®.

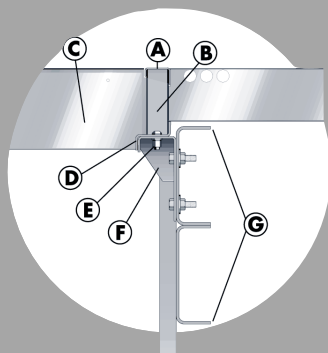

5. Patented Duraframe®

- A. Steel C-Channel
- B. 2" x 5" Steel Tube Risers
- C. Steel Outriggers
- D. Steel Z-Beam
- E. C5 Huck® Fastener
- F. Gusset
- G. Stacked Rail Chassis

National R.V.'s patented Duraframe®'s all-welded, all-steel construction allows maximum basement storage while providing unmatched strength and durability to the coach.

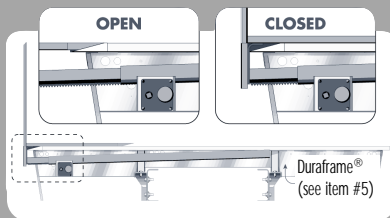

6. Flush Floor Slideout

- Innovative Flush Floor Design
- Power Gear Electric Slide Mechanism
- Rack and Pinion Operation
- Manual Override Mode
- Advanced Double-Bulb Weather Seals

Cockpit Features

- *Rear Vision System with Microphone*
- *Power Controlled Remote Heated Mirrors*
- *Rosen Aviation Style Sun Visors*
- AM/FM Stereo Cassette with Four Speakers
- Driver and Passenger Map Lights
- Auxiliary Driving Lights
- Pantographic Windshield Wipers
- Power Steering
- Electronic Cruise Control
- Tilt and Telescopic Steering Wheel
- Drive and Passenger Recliner Seats with Swivel Bases
- 12 Volt Receptacle in Console for Cellular Phone
- 12 Volt / 110 Volt Phone Outlet for Computer
- Two 2-Speed Dash Fans

Windows, Doors and Awnings

- *Radius Dual Pane Windows with Tinted Safety Glass*
- *Vinyl Patio Awning with Metal Cover*
- Sliding Windows in Living Area, Kitchen and Driving Area
- Power Entrance Step with Light
- Radius Entrance Door with Clear Glass, Roller Shade
- Entry Screen Door and Anti Skid Steps
- Tinted Skylight in Bathroom
- Entry Door Awning
- Slide-Out Topper Awning

Heating, Vents and Air Conditioning

- *Dual 13,500 BTU Ducted Roof A/C with Climate Control*
- *Ducted Dual Electronic Ignition Furnaces, 35,000 and 20,000 BTU (M370 and M390)*
- Dash Heating and A/C System with Defroster
- 35,000 BTU Electronic Ignition Furnace (M350)
- 12 Volt Roof Vent in Bathroom

Chassis, Engine and Suspension

- *Spartan® Summit GTi Chassis (26,000 GVWR, Raised Rail)*
- *Allison® MH 3000 6-Speed Automatic Transmission*
- *100 Gallon Fuel Capacity*
- *160 Amp Alternator*
- *Front Axle/Suspension: Air Suspension-Bilstein® Tuned Shocks, Dual Height Control Valves, Reyco® /Granning® IFS 1050; 9,000 lbs. GAWR*
- *Jacobs Extarder (Exhaust Brake)*
- Engine: Cummins[®] ISB Electronic 5.9 Liter 300 HP Diesel Engine
- Torque: 660 lbs. @ 1600 RPM
- Rear Axle: Meritor RS 19145, Drive Axle with "S" Cam Drum Brakes with Auto Slack Adjusters, 4:63 Gear Ratio
- Rear Suspension: Reyco[®] 610-AR, 17,000 lbs. GAWR Air Suspension with Two Air Springs, Bilstein[®] Shocks
- TRW[®] TAS .55 Power Steering with 50 Degree Turning Angle, Tilt and Telescoping Column, 18" Steering Wheel with Horn Button
- Stainless Steel Wheel Simulators with Valve Extensions
- Full Air Brakes (Drums) with Automatic Slack Adjusters and ABS
- Michelin[®] Radial Tires-Tire Size XRV 235/80R 22.5 Two Tires, XRV 235/80R 22.5 Four Tires
- Engine Block Heater with Switch in Driver's Cockpit (120V/750W)
- Air Cleaner Restriction Indicator
- 5,000 lb. Hitch Receiver with and Six Pin Connector

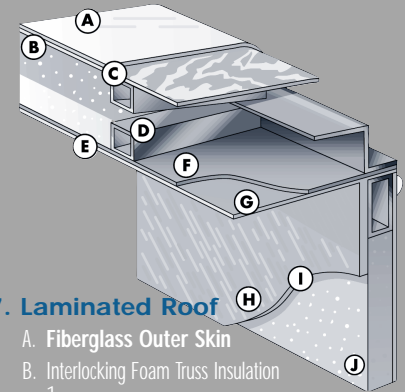

7. Laminated Roof

- A. Fiberglass Outer Skin
- B. Interlocking Foam Truss Insulation
- C. 1/4" Weyerhaeuser® Sturdi-Wood
- D. Welded Steel Frame
- E. Residential Style Flat Ceiling
- F. 1/4" Mahogany Luan Panel
- G. Sound Deadening Soft-Touch Ceiling

8. Laminated Sidewall

- H. Washable Vinyl Interior Wall
- I. 1/4" Mahogany Luan Paneling
- J. 2 lb. Density Precision Fit Foam Insulation
- K. Welded Steel Frame Construction
- L. High Gloss "Mende" Fiberglass Outer Skin

9. Laminated Floor

- M. Quality Floor Coverings
- N. 1/4" ACX Plywood Decking
- O. 3 lb. Density Precision Fit Foam Insulation
- P. Welded Steel Frame Construction
- Q. 1/4" Mahogany Luan with "True Grit" Skin
- R. True Grit Bonded Seal

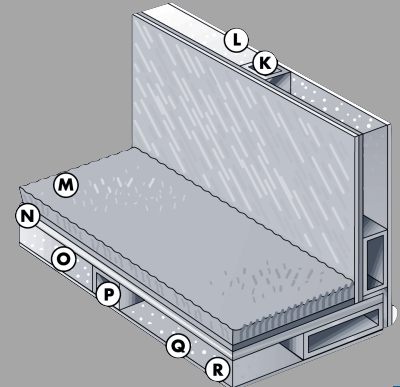



10. Interior Appointments

- Corian® Solid Surface Countertops
- Ceramic Tile Galley Area Floor
- One-Piece Fiberglass Garden Tub and Shower
- Steel Ball Bearing Drawer Slides
- 60" x 80" Queen Bed Standard on All Floor Plans

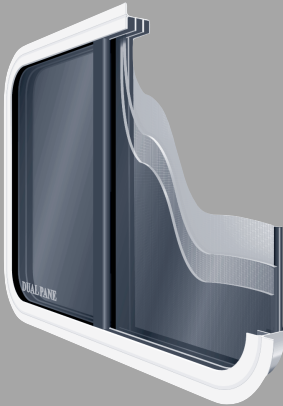

11. Insulated Windows

Radius dual pane insulated windows with tinted safety glass are standard equipment on all Marlin® coaches. They control interior comfort effectively and efficiently any time of the year in any climate. Dual pane windows also reduce noise levels inside your Marlin®.

Appliances and Accessories

- *One Cu. Ft. Space Maker Convection Microwave with Touch Control and Range Hood Systems Monitor Panel*
- 8 Cu. Ft. Two Way Refrigerator
- High Output Three Burner Cook Top
- Bi-Fold Range Cover with Corian® Surface
- TV Antenna and Booster with 12 Volt Receptacle and TV Jack(s)
- 19" Color TV with Remote in Living Area
- Video Switch Box with Cable TV Hook-Up and Phone Jacks

Safety Features

- *Carbon Monoxide Detector*
- *Driver and Passenger 3-point Seat Belts (Lap and Shoulder)*
- Fire Extinguisher
- Deadbolt Lock on Entrance Door
- 12 V GFI Protected Circuit (Kitchen, Bath and Exterior)
- LPG Detector
- Smoke Detector
- Egress Window(s)
- Deluxe Acrylic Exterior Grab Handle

Plumbing and LPG Systems

- *Water Heater By-Pass Valve*
- *One-Piece Fiberglass Tub/Shower*
- *Porcelain Toilet with Sprayer*
- *Holding Tank Rinsing System (Waste Tank Only)*
- Demand Water System and Water Pump
- Water Filter in Kitchen
- Six Gallon LPG Water Heater with Ignition (DSI)
- Pressured Water Fill and One Hand Water Distribution System
- Clear Glass Shower Enclosure
- Heated Systems Compartment with Easy Access to Hook-Ups
- Decorative Kitchen and Bath Faucets

Optional Features

- Bedroom Wardrobe Slide-Out with Awning (M350 and M370)
- 8 Ft. Refrigerator with Ice Maker
- Six Way Power Driver Seat
- 21" LP Gas Oven
- Corian[®] Counter Top Extension
- Leather Driver with Power and Passenger Seats
- Leather Faced Recliner
- Leather Faced Sleeper Sofa
- Dining Table with Two Wooden and Two Folding Chairs
- Two Non-Folding Wooden Dining Chairs
- 12 Ft. Side-By-Side Refrigerator with Ice Maker
- Combination Washer/Dryer
- 10 Gallon Gas/Electric Water Heater
- Digital Satellite System
- 13" Color TV with Remote (Bedroom)
- Generac 7.5 Quiet Diesel Generator
- 2,000 Watt Inverter/Converter with Remote On/Off Switch and Two Additional 6 Volt Deep Cycle Batteries
- Front Door Awning (N/A M370)
- CD Player and AM/FM Stereo with Four Speakers
- VCR



12. 24 Hour Roadside Assistance

- Free Coverage for 1 Year
- Coach Net is the Nation's Largest Emergency Roadside Assistance Network
- Free Trip Planning, Color Maps and More!
- Free Coverage for a Family Car or Tow Vehicle

About National RV

National RV has established itself as a premier motor home manufacturer with a reputation for offering innovative, quality products that feature a rich supply of value-added features for a reasonable price. National RV has over 37 years of experience as a manufacturer—not merely an assembler.

Many distinctive features are designed and manufactured in-house such as garden shower tubs, custom dashboards and luggage doors to guarantee quality and superior fit and finish.

National RV has also established itself as the company that listens and responds to the needs of our customers. National RV's employees are dedicated to producing quality recreational vehicles that will provide you with a lifetime of fond travel memories.

• Floorplans

M350

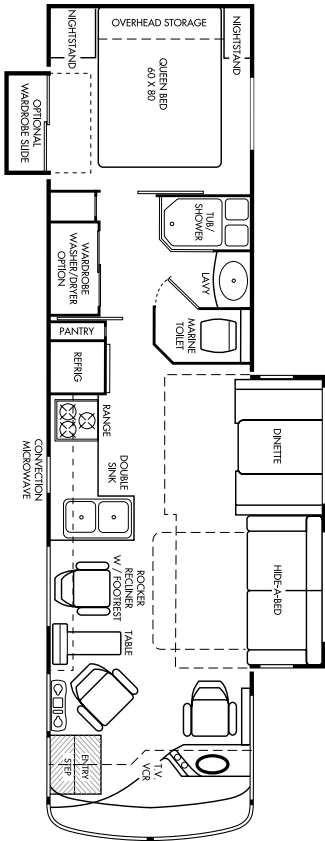

M370

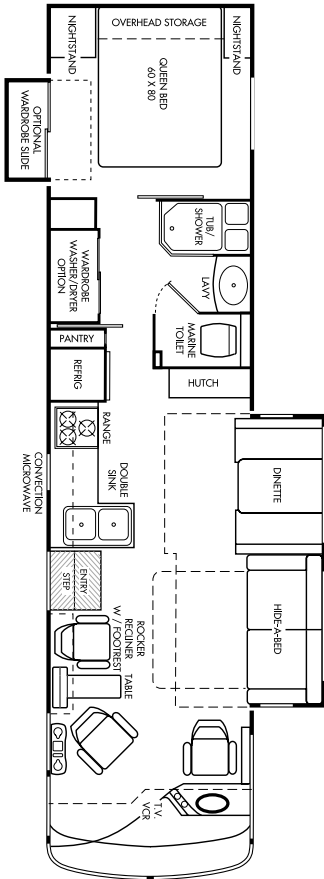

M390

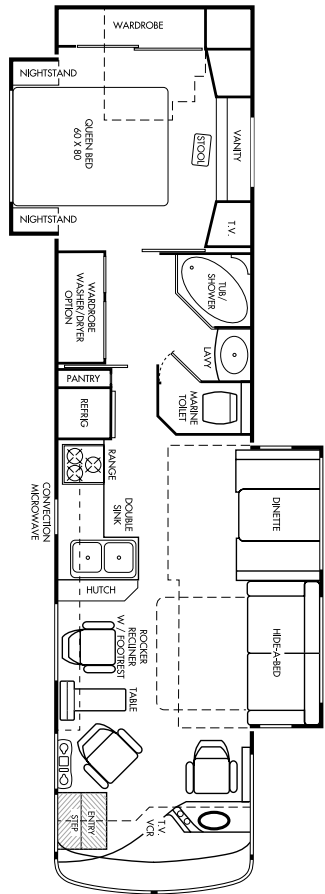

- Measurements

Weights (lbs.)	M350	M370	M390
Gross Vehicle Rating	26,000	26,000	26,000
Gross Combined Rating	31,000	31,000	31,000
Front Gross Axle Rating	9,000	9,000	9,000
Rear Gross Axle Rating	17,000	17,000	17,000
Unloaded Vehicle Weight	TBD	20,600	22,080
Maximum Carrying Capacity	TBD	5,400	3,920
Measurements			
Wheelbase	208"	228"	252"
Overall Length	TBD	37' 1"	39' 1"
Overall Height (road)	TBD	12' 1"	12' 2"
Interior Height	79 1/2"	79 1/2"	79 1/2"
Interior Width	98"	98"	98"
Exterior Width	102"	102"	102"
Tank Capacities (gal.)			
Water Heater	6/10	6/10	6/10
Gray Tank	50	50	50
Black Tank	50	50	50
Fresh Water Tank(s)	100	100	100
LPG Tank (Volume)	69	69	69

*All fuel and liquid capacities are approximate and dimensions may vary. The customer has the responsibility to select the proper combinations of loads without exceeding the chassis weight capacities.



www.nrvh.com
909.943.6007

3411 North Perris Blvd. Perris, CA 92571

Due to continued product improvement,
National R.V., Inc. reserves the right to
change materials, colors, specifications and
prices at any time without notification.

Copyright © 2000, National R.V., Inc. 11/00