

Mesa Ridge





Model: MF387RLS Shown with Diego Decor

Mesa Ridge
Fifth Wheels







Model: MR320RES Shown with Bloom Decor

MesaRidge
Travel Trailers





MR320RES



MR320RES



Model: MR291RLS



Outside Cook Center





SLIDE-OUT SYSTEM

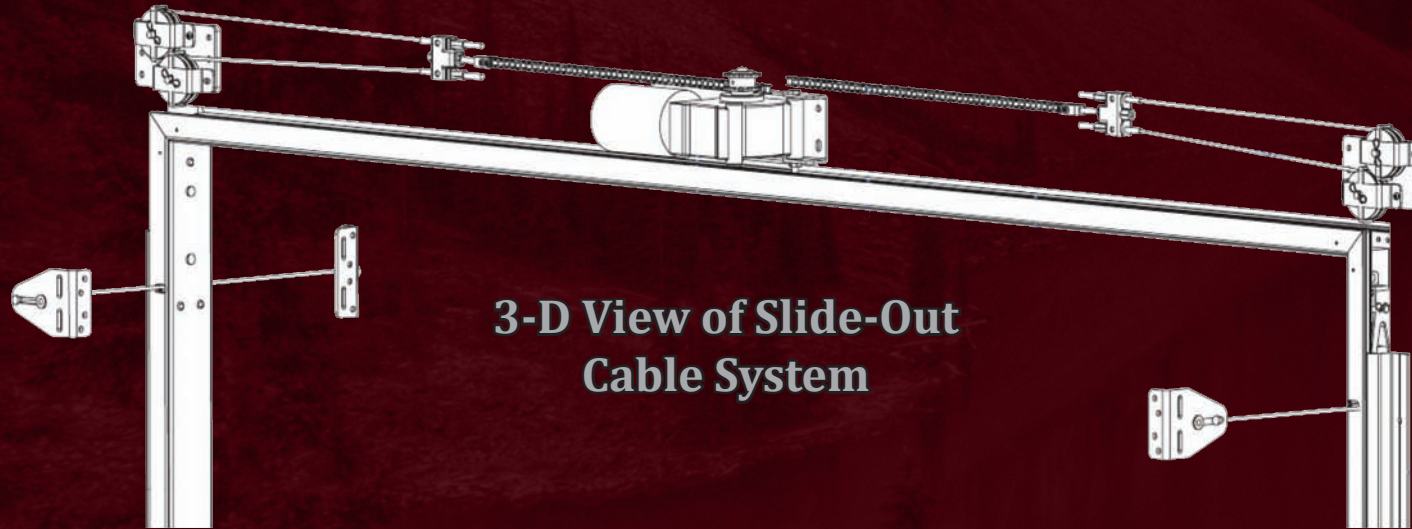

**3-D View of Slide-Out
Cable System**

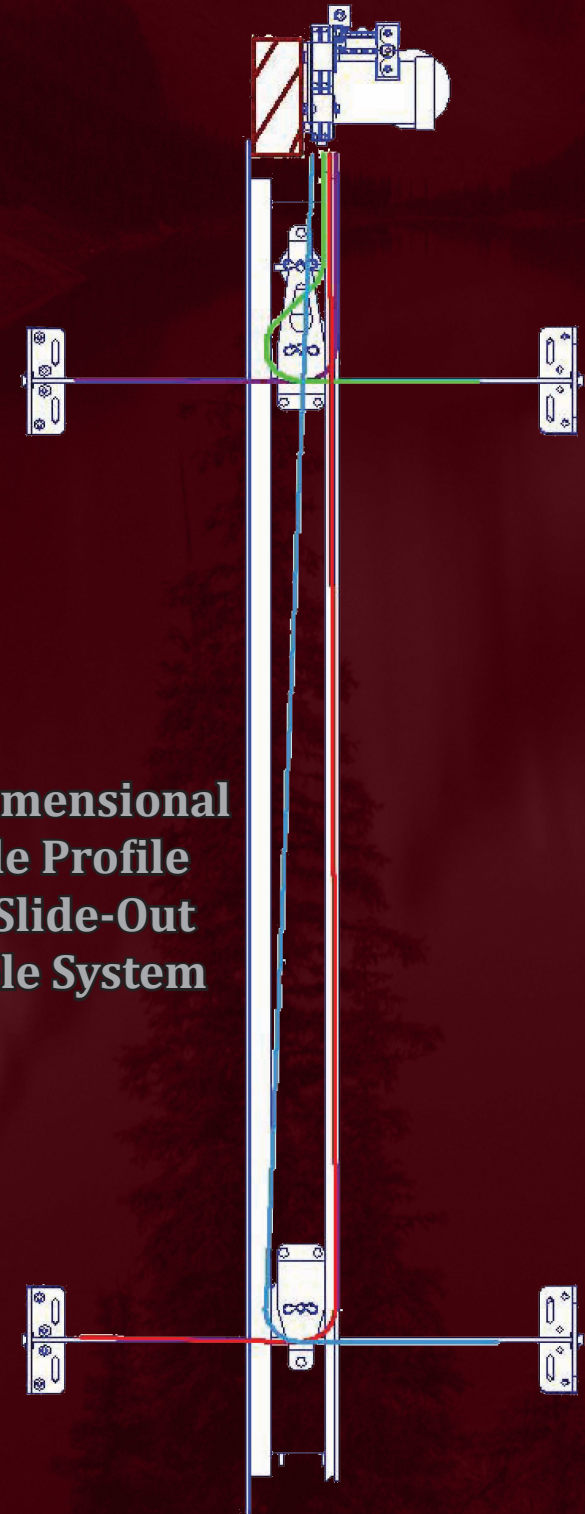

**1- Dimensional
Side Profile
Of Slide-Out
Cable System**

10 Reasons Why... Accu-Slide

1. Above floor design means more storage area for your RV
2. Lightweight design promotes fuel savings
3. High strength stainless steel aircraft cable is used for control
4. Cable control at all 4 room corners helps stop leaks
5. Working components are in your RV, safe from the elements
6. Locking motor secures room in or out to help stop leaks
7. Above floor design minimizes maintenance requirements
8. A clean system - no leaky hydraulic lines or greasy drives
9. Smooth, quiet room movement - no jumping or jerking
10. It's built in the U.S.A. and backed by BAL since 1972

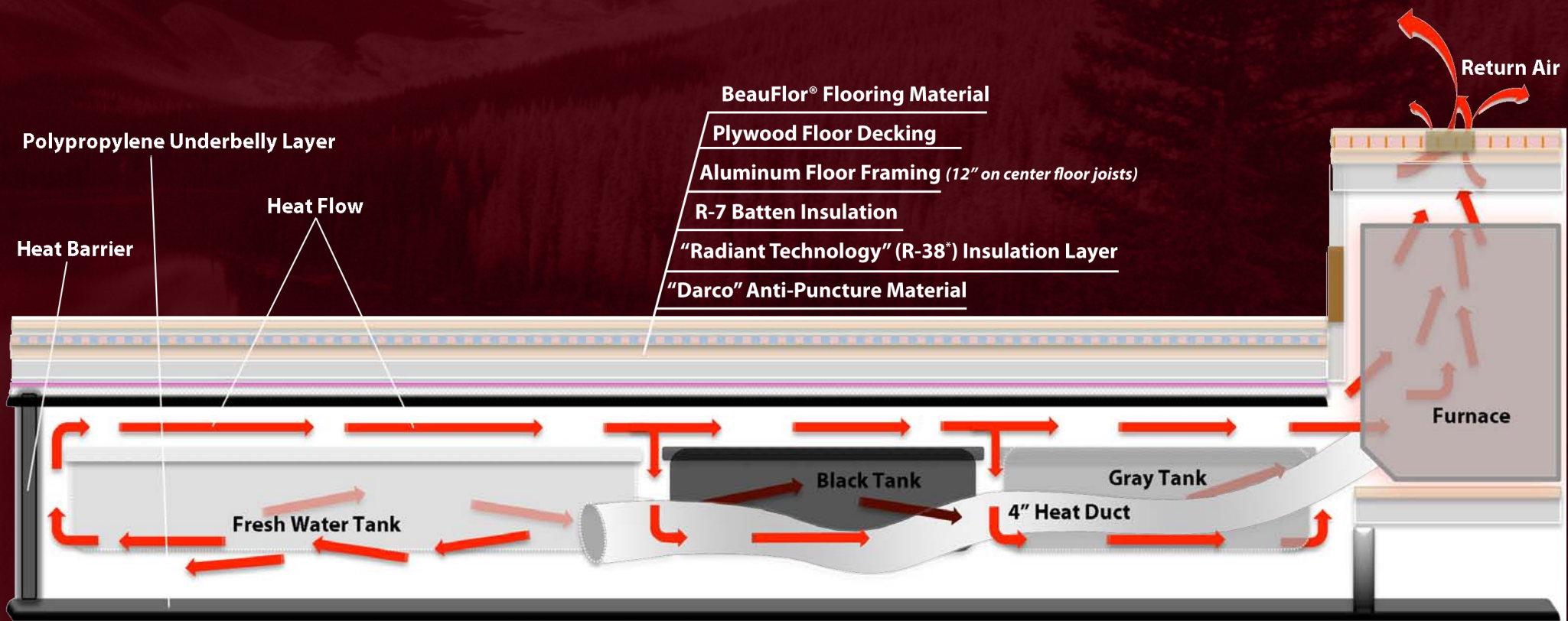

**Mesa Ridge Fifth Wheel Diagram Shown*

HEATING SYSTEM:

The Mesa Ridge product line has the most efficient heating system in the industry. The extra large 4" heat duct hose is placed right next to the fresh water tank. The suspended holding tanks are specifically designed to allow for heat to surround all sides adequately as it moves throughout the belly area. As the heat moves it reflects off of a "heat barrier" that is installed just behind the rear tank to keep the heat isolated to the tank area only. As the heat reflects, it moves its way forward where the heat naturally rises and then returns back into the camper through a return air vent. This system keeps the heat isolated, delivering as much heat to the tanks as possible while returning back into the camper for propane efficiency and maximum performance!

FIFTH WHEEL CONSTRUCTION

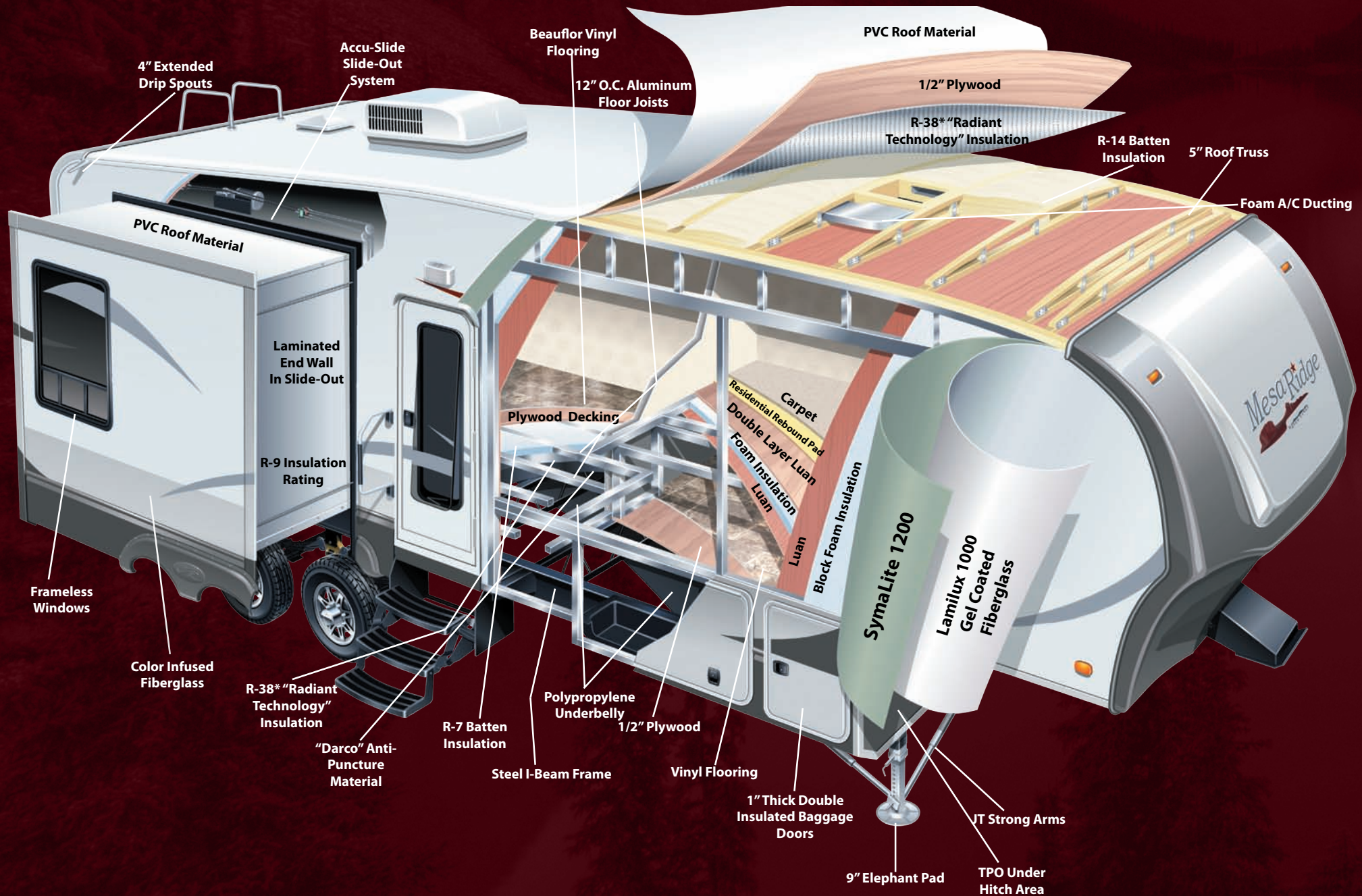

STANDARD FEATURES:

- HEAVY DUTY FULL EXTENSION DRAWER GUIDES
- DEXTER EZ FLEX SUSPENSION (FW)
- NITROGEN FILLED RADIAL TIRES
- LARGE LAVATORY SINK
- LP QUICK CONNECT
- 50 AMP SERVICE
- PORCELAIN TOILET W/ FOOT PEDAL FLUSH
- 80 LBS OF LP CAPACITY (FW)
- "MAXX AIR" VENT COVER
- EXTERIOR UTILITY CENTER W/ BLACK TANK FLUSH
- 100" WIDE BODY FRAME
- FRONT & REAR STABILIZER JACKS (TT)
- DEXTER EZ LUBE AXLES (FW)
- PVC ROOF MATERIAL
- 60 LBS OF LP CAPACITY (TT)

EXECUTIVE PACKAGE: (MANDATORY)

- ONE-TOUCH AUTOMATIC LEVELING SYSTEM (FW)
- 15,000 BTU A/C W/ "QUICK COOL" FEAT. (FW)
- KNOTTY ALDERWOOD CABINET DOORS
- FLAT SCREEN TV IN LIVING AREA
- 10 GAL. GAS/ELECTRIC WATER HEATER (FW)
- LED LIGHTING IN CEILING
- 12v CD/DVD/MP3/AM/FM/iPod STEREO
- CORIAN® COUNTERTOPS (FW)
- CROWN MOLDING
- MULTI-PORT SATELLITE HOOK-UP
- FANTASTIC FAN IN KITCHEN (FW)
- WIRED AND FRAMED FOR 2ND A/C
- DIGITAL TV ANTENNA W/ BOOSTER
- CAREFREE OF COLORADO POWER AWNING
- FULL VIEW VENTED ENTRANCE DOOR
- LARGE 8 CU FT REFRIGERATOR (FW)
- LED AWNING LIGHT (FW)
- FRAMELESS WINDOWS
- 30" OTR MICROWAVE (FW)
- CONCEALED HINGES

FOUR SEASONS PACKAGE: (MANDATORY)

- R-38* INSULATION IN ROOF & FLOOR
- HEATED AND ENCLOSED UNDERBELLY
- DIGITAL THERMOSTAT
- R-9 INSULATION IN SIDEWALL
- DOUBLE INSULATED BAGGAGE DOORS
- INSULATED SLIDE FLOORS
- ATWOOD® HIGH PERFORMANCE FURNACE
- HEATED STORAGE AREA
- HEATED & ENCLOSED DUMP VALVES

*CALCULATED

2-Year Limited Transferable Warranty

INTERIOR DECORS:



BLOOM

Sofa
Recliner
Booth Dinette
U-Booth/U-Lounge Seat



DIEGO

Sofa
Recliner
Booth Dinette
U-Booth/U-Lounge Seat



STEEL

Sofa
Recliner
Booth Dinette
U-Booth/U-Lounge Seat

OPTIONS:

- 26" BEDROOM TV
- FIREPLACE (MOST FLOORPLANS)
- DYSON VACUUM CLEANER
- ADDITIONAL FANTASTIC FAN
- RECLINERS IPO SWIVEL ROCKERS (MOST FLOORPLANS)
- ALL DARK WOOD
- 2 BAR STOOLS
- 2ND A/C (13.5k BTU DUCTED)
- DUAL PANE WINDOWS
- BBQ GRILL
- U-LOUNGE IPO TABLE & CHAIRS/SOFA (SELECT FLOORPLANS)

Optional U-Lounge



FIFTH WHEELS ONLY

- LP GENERATOR PREP
- CEILING FAN
- DINETTE BOOTH IPO TABLE & CHAIRS
- CORIAN® ISLAND ON CASTORS
- 12 CU. FT. REFER

TRAVEL TRAILERS ONLY

- 8 CU. FT. REFRIGERATOR
- POWER TONGUE JACK
- POWER FRONT & REAR STABILIZER JACKS
- LOCK ARM STABILIZER BARS
- 15k BTU MAIN A/C

**PLEASE CONTACT YOUR LOCAL DEALER TO ENSURE AVAILABILITY OF STANDARDS AND OPTIONS ON A SPECIFIC FLOORPLAN.

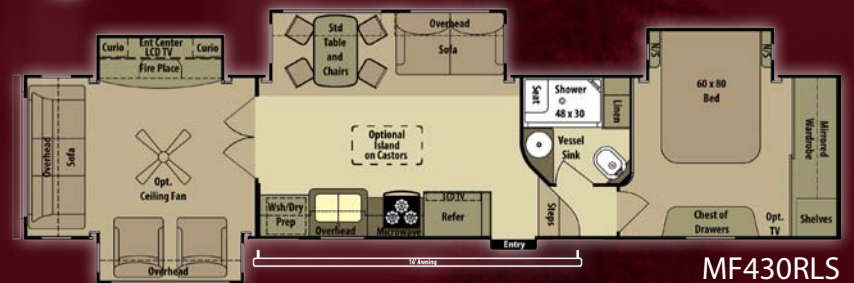
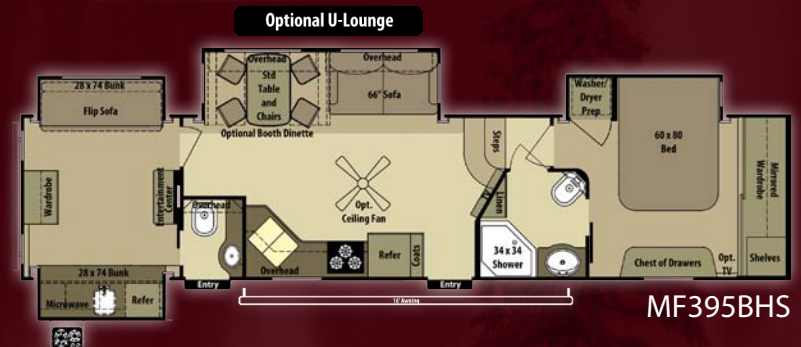
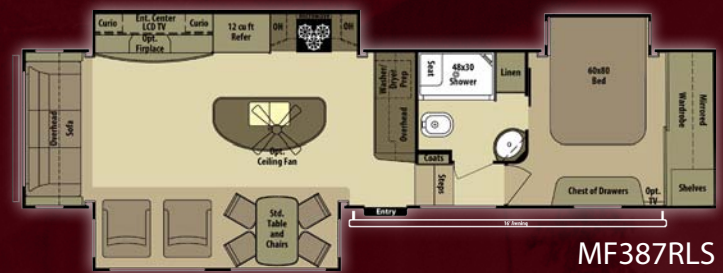

	GVWR	UVW	Hitch Wt.	Axle Wt.	Gross NCC	Ext. Length	Ext. Height	Fresh Water	Gray Water	Waste	Furnace (BTU's)
MF316RLS	10790	8555	1990	6565	2235	30'10"	155"	85	82	41	35,000
MF337RLS	12335	8825	1935	6890	3510	33'6"	155"	85	57	41	35,000
MF338RLS	12450	9625	2050	7575	2825	35'4"	155"	85	82	41	35,000
MF357RES	12570	9540	2170	7370	3030	35'2"	155"	85	57	41	35,000
MF367BHS	14055	10625	2055	8570	3430	36'10"	155"	85	62	41	35,000
MF387RLS	14281	10375	2281	8094	3906	37'	155"	85	82	41	35,000
MF395BHS	15990	11280	2005	9275	4710	39'4"	155"	85	74	74	40,000
MF430RLS	15600	11755	2425	9330	3845	39'4"	155"	85	82	41	40,000

MesaRidge
Fifth Wheels

MesaRidge Travel Trailers

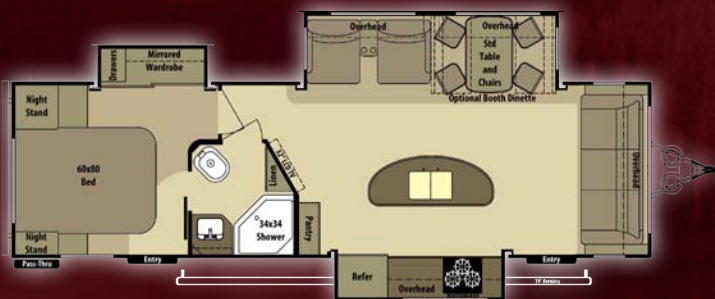

MR288FLR



MR291RLS

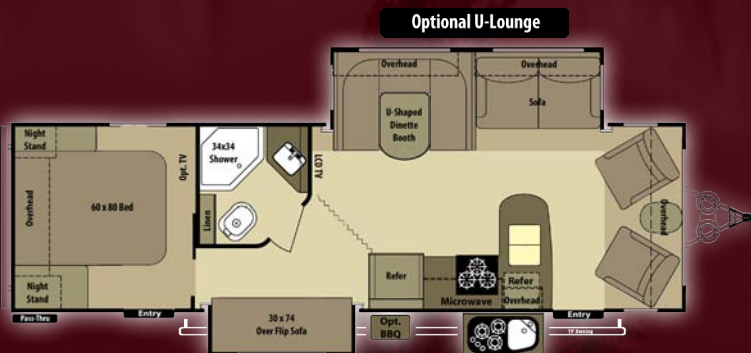

MR302BHS

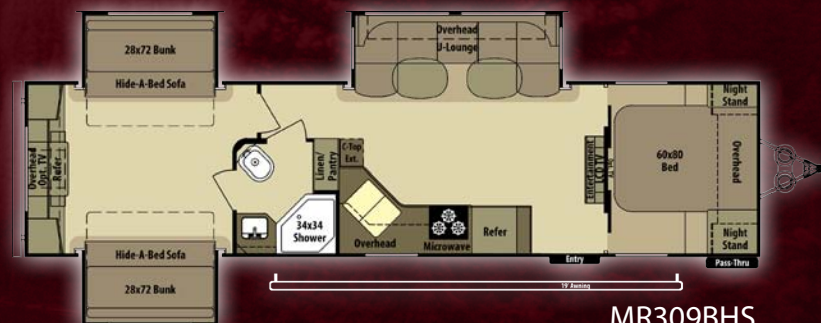

MR309BHS



MR316RLS



MR320RES

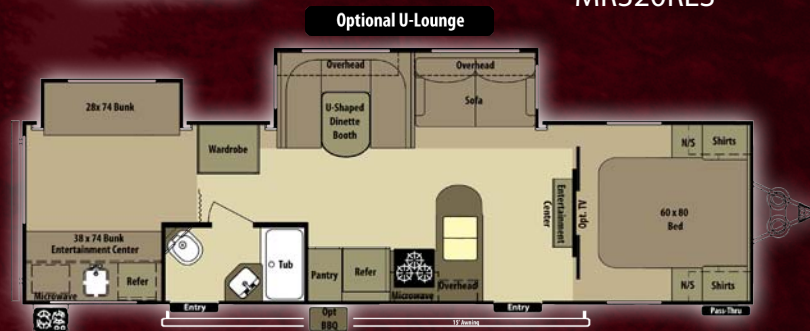

MR331BHS

	GVWR	UVW	Hitch Wt.	Axle Wt.	Gross NCC	Ext. Length	Ext. Height	Fresh Water	Gray Water	Waste	Furnace (BTU's)
MR288FLR	9800	7480	1000	6480	2320	33'6"	140"	50	60	30	30,000
MR291RLS	9795	7710	995	6715	2085	33'6"	140"	50	60	30	30,000
MR302BHS	9775	7655	975	6680	2120	33'	140"	50	60	30	30,000
MR309BHS	11375	8955	975	7980	2420	37'10"	140"	50	57	30	30,000
MR316RLS	9985	7745	1285	6460	2240	33'8"	140"	50	57	30	30,000
MR320RES	9985	7350	840	6510	2635	34'9"	140"	50	60	30	30,000
MR331BHS	10490	8125	800	7255	2365	36'8"	140"	50	60	30	30,000

Visit Us @ www.OpenRangeRV.com

- "Build Your Own"
- Detailed Floorplans & Specs
- Contact Information
- Photo Galleries
- Frequently Asked Questions
- Customer Testimonials
- Virtual 360° Videos
- Dealer Locator
- And Much More



OPEN RANGE

Open Range RV Company 3195 N. St. Rd. 5 Shipshewana, IN 46565

Phone: (260) 768-7771 - www.OpenRangeRV.com

Due to continual research and advances, manufacturer reserves the right to change specifications, design, price, and equipment without notice, and assumes no responsibility for any error in the literature. Some items shown are not included as standard or optional equipment

©2012 Open Range RV Company, Shipshewana, Indiana

Published Date: Dec. 14th, 2012

PURCHASE LOCALLY

Open Range RV strongly encourages our retail customers to purchase from their local dealership whenever possible due to the following reasons:

1) Our Dealers are, as a rule, independently owned and operated businesses. Outside of those customers they personally sold products to, they are not obligated to perform warranty service on Open Range RV products that were purchased elsewhere. There may be an occasion that the customer will be required to return to the point of purchase to satisfy warranty requirements.

2) Although many dealerships will eventually service products not purchased at their dealership, they will usually take care of their customers and other Open Range RV customers who are traveling away from their local dealer as a priority.

3) Local purchases allow a customer to establish a relationship with a dealer close to home. This relationship provides the customer with a convenient location for service and support from a "local" professional.

4) The opportunity for a thorough PDI (Pre Delivery Inspection) and product orientation is an additional benefit of buying from a local dealer. The opportunity for refresher courses or the ability to get questions answered more promptly is another additional benefit of buying from a local dealer.

5) For our Canadian customers, there are also requirements which must be met to bring an RV purchased out of the country to their home. Although not impossible, these requirements may involve such things as additional inspections, certifications, taxes and fees. The local Canadian Dealer is a professional at meeting these requirements.

6) Open Range's goal is for all RV Owners to fully enjoy their RV experience. In light of this goal, and considering the advantages of buying locally, we encourage you to be thorough when determining what product to purchase and which dealer to purchase it from as both are key to your ultimate satisfaction.

Your Open Range Dealer: