

HYPER LITE XLR

Forest River's
**#1 Selling
Toy Hauler
Brand**

Travel Trailers

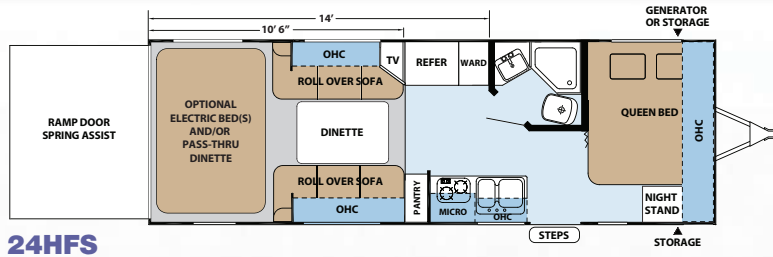

24HFS

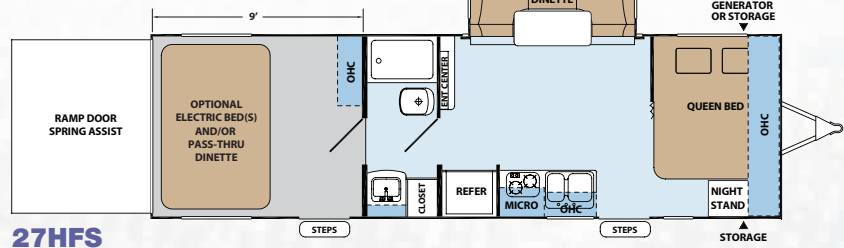

27HFS

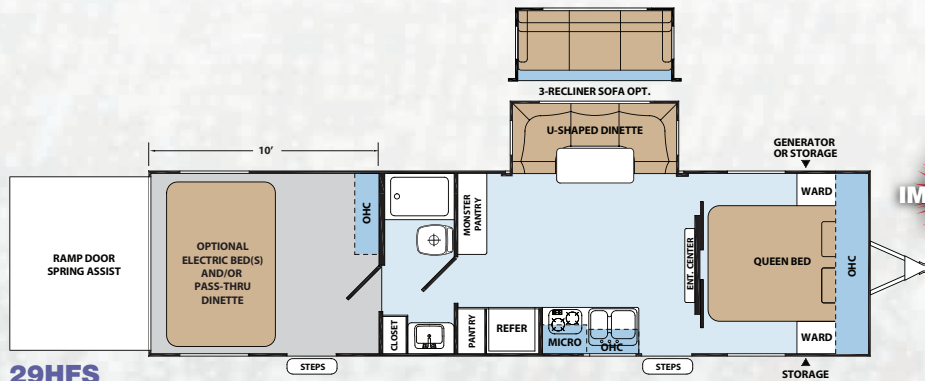

29HFS

IMPROVED!

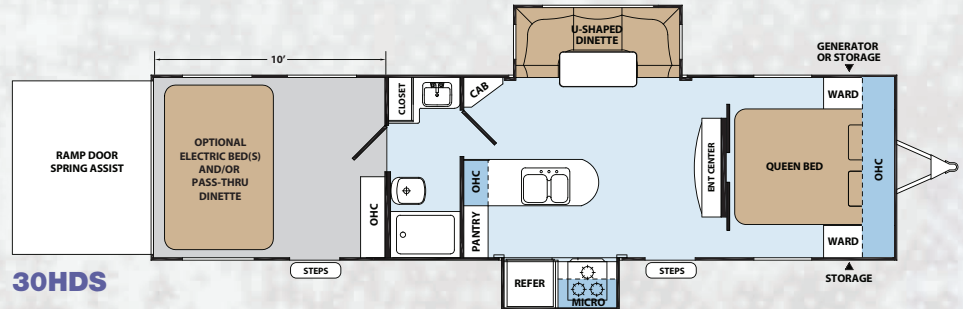

30HDS

NEW!

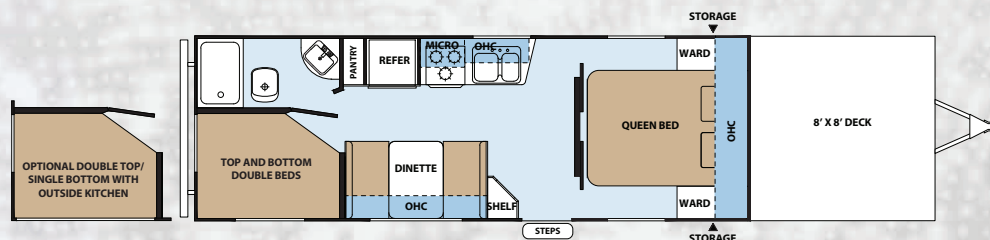

31FDK

NEW!

XLR Hyper Lite Features

Interior

- 12V Battery Disconnect
- Microwave
- Rounded Shower Rod w/Curtain
- 2-Burner Cook Top
- Kitchen Sink Covers
- Cognac Hardwood Maple Raised Panel Cabinetry
- AM/FM/CD/DVD/USB Bluetooth Stereo
- Bedroom USB Charging Station
- TV Antenna w/ Booster
- Night Shades in Living Room & Bedroom
- Shower/Tub Surround
- Skylight over Shower/Tub
- 6 Gallon Gas/Electric/DSI Water Heater
- 20,000 BTU Furnace

Exterior

- Reverse Activated Rear LED Flood Lights
- Patio Security Light
- Framed Tinted Safety Glass Windows
- Correct Track Axle Alignment System
- LED Lighting
- Aluminum Wheels
- Exterior TV Mount
- Secure Utility Convenience Center
- Front Diamond Plate Rock Guard
- Radius Entry Door

- Radius Baggage Doors
- Dexter E-Z Lube® Axles
- NitroFill™ Radial Tires
- 30 AMP Service
- Dual 20 lb. LP Bottles
- Four Corner Manual Stabilizer Jacks
- 96" Wide Construction
- 8" Powder Coated, I-Beam Chassis
- ¾" Marine Grade Plywood Floor
- Vacuum Bonded Sidewalls w/Block Foam Insulation
- 7' Insulated Spring Assist Ramp Door
- Cargo Entry Door
- Gas/Oil Resistant Flooring in Cargo Area
- Dual Flow Ram Air Vents
- 5,000 lb. Steel Reinforced Tie Downs
- Diamond Plate Tire Guard in Cargo Area
- Hot/Cold Outside Shower/Spray Port
- Electric Awning w/LED Lights
- Black Tank Flush
- Grey Rubber Roof

Options

■ Kick Start Package (Mandatory):

13.5K BTU Ducted A/C, Spare Tire, LP Quick Disconnect, Black Diamond Plate, Premium Graphics, Vintage Oak Vinyl Flooring, Generator Storage, Electric Awning w/LED Lights, Aluminum Wheels, LED Lighting, Black Tank Flush

■ Adrenaline Package:

Two-tone Grey Fiberglass with Graphics Upgrade, Solar Charger Input, Friction Hinge Door, Hid-N-Screen, Equa-Flex Suspension Enhancement

■ Extreme Weather Package:

Dual Pane Windows, 12V Heated Holding Tanks, Radiant Roof/Floor/Slide Out Floor/Front Insulation (R-38 @ 80°F)

- Power Tongue Jack
- Generator Prep (N/A 31FDK)
- 4.0 KW Onan CARB EVAP Generator (N/A 31FDK)
- Mobile Fuel Station (N/A 31FDK)
- 15K BTU A/C IPO 13.5K
- 32" LED TV (Living, Bedroom, Garage)
- Removable Cargo Carpet
- Convection Microwave
- Recliner Sofa IPO U-Dinette (27HFS, 29HFS, 30HDS)
- Electric Bed(s)
- Electric Bed w/Pass-thru Dinette
- VIP Party Deck

Hyper Lite Travel Trailers

Model	Hitch Weight	Ship Weight	Cargo Capacity	Exterior Length	Exterior Height	Exterior Width	Fresh Water	Grey Water	Black Water
24HFS	577	5526	3792	27' 5"	11' 2"	96	54	57	32
27HFS	992	5786	3947	30' 0"	11' 2"	96	54	57	32
29HFS	1032	6759	3014	33' 11"	11' 2"	96	54	57	32
30HDS	TBD	TBD	TBD	TBD	11' 2"	96	TBD	TBD	TBD
31FDK	832	5975	3466	36' 7"	11' 2"	96	54	57	32



Forest River

2421 Century Dr. ■ Goshen, IN 46528
 Phone: 574-642-0438 ■ Fax: 574-343-5909
 E-mail: XLRinfo@forestriverinc.com
www.forestriverinc.com/XLR
www.forestriveraccessories.com

CHECK US OUT ON:



Learn More
 Scan this barcode using a QR Reader on your smart phone to learn more about Forest River.



A Berkshire Hathaway company.

Actual towing capacity is dependent on your particular loading and towing circumstances, which includes GVWR, GAWR and GCWR, as well as adequate trailer brakes. Please refer to the Owners Manual of your vehicle for further information. All illustrations and specifications contained in this literature are based on the latest product information at the time of publication. Forest River, Inc. reserves the right to make changes in prices, colors, materials, equipment and specifications at anytime, without notice, and assumes no responsibility for any error in this literature. All units are shipped F.O.B. point of manufacture. 9/14 ©Forest River, Inc. 2014 XLR