

LET YOUR SENSE OF ADVENTURE SHOW YOU THE WAY

Recognized as a Consumers Digest Best Buy.*

New discoveries are just around the corner. The new Tioga® Arrow motor home gets you there in comfort and style, and all at an exceptional value.

It's even more fun when you get to take your recreational toys with you. The premium Ford® or Chevy™ chassis makes towing your ATVs or personal watercraft** easy, while providing superior performance and a flawless ride.

In the cab, driving is a delight in the ergonomically designed driver's compartment complete with cruise control, power locks and windows, Panasonic® AM/FM cassette stereo, and air conditioning.

Choose from four surprisingly spacious floor plans—due to the wide-body design—and a variety of sleeping arrangements to accommodate your lifestyle. With all the

excitement you'll generate in your travels, you and your crew will be ready to devour the best of meals. To plan and prepare your gourmet extravaganzas, use the Magic Chef® 3-burner, high-output range and oven, 6 cu. ft. Dometic® double-door refrigerator and stainless steel double sink. Later, relax on a Flexsteel® swivel lounge chair (Model 24D) or sofa bed.

And what ultimately sets this RV apart is the over 50 years of Fleetwood testing and research that makes your motor home a superb value.

The Tioga Arrow—the new Class C from Fleetwood RV. It's the best way to aim for discovering great times.



* Consumers Digest Best Buy 2000.

The BEST BUY SEAL is a registered trademark of Consumers Digest, Inc., used under license.

** Check your owner manual(s) for towing safety, rules and guidelines.

Ford® is a registered trademark of the Ford Motor Company • Chevy™ is a trademark of the General Motors Corporation.

Panasonic® is a registered trademark of Matsushita Electric Corporation of America • Magic Chef® is a registered trademark of Maytag, Dometic® is a registered trademark of AB Electrolux • Flexsteel® is a registered trademark of Flexsteel.



The bedroom is beautiful as well as practical with color-coordinated fabrics, window treatments and plenty of overhead storage.



Tioga Arrow is packed with the features you want—handcrafted wood cabinetry, durable flooring and name-brand appliances.

MODEL 23B

- Roomy Cabover Bed
- Sofa Bed and Dinette
- Fully Enclosed Bathroom
- Large Wardrobe Cabinet
- Rear Kitchen

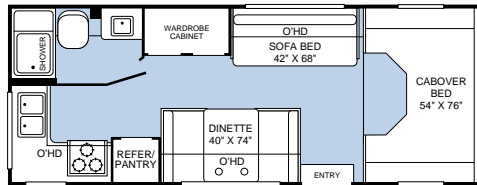

MODEL 24D

- Roomy Cabover Bed
- Dinette
- Lounge Chair
- Fully Enclosed Bathroom
- Double Bed or Optional Bunk Beds

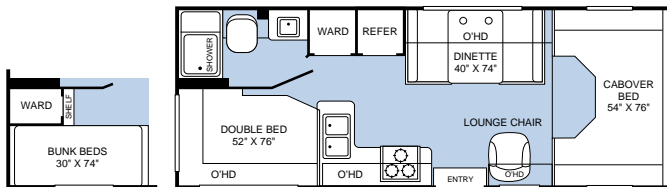

MODEL 29V

- Roomy Cabover Bed
- Sofa Bed and Dinette
- Split Bathroom
- Queen Bed or Optional Bunk Beds

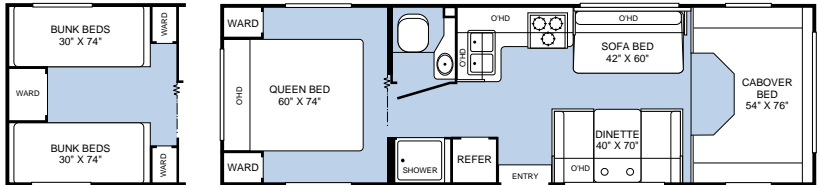

MODEL 31M

- Roomy Cabover Bed
- Sofa Bed and Dinette
- Fully Enclosed Bathroom
- Queen Bed or Optional Twin Beds

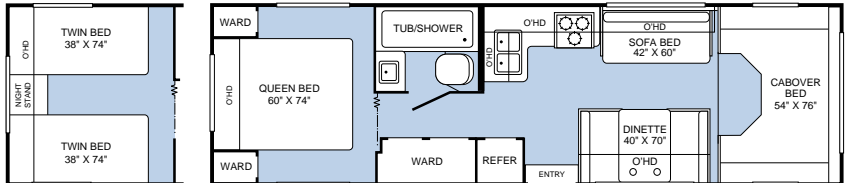

IMPORTANT – PLEASE READ: Product information and photography included in this brochure were as accurate as possible at the time of publication. For the most current product information and changes, please visit our website at www.fleetwood.com or contact your local Fleetwood dealer. Subsequent refinements may be evident in the actual product. Prices and specifications are subject to change without notice. All weights, fuel, liquid capacities and dimensions are approximate. Fleetwood has designed its recreational vehicles to provide a variety of uses for its customers. Each vehicle features optimal seating, sleeping, storage and fluid capacities. The user is responsible for selecting the proper combination of loads to ensure that the recreational vehicle's capacities are not exceeded.

2001 TIOGA ARROW STANDARD FEATURES

APPLIANCES

- Demand Water System
- 12V Bath Vent
- Television Antenna (Retractable)
- 6 cu.ft. Dometic® Double Door Refrigerator
- 3-Burner, High-Output Range with Oven
- 6-Gallon Water Heater with D.S.I.
- 20M BTU Auto Ignition Furnace (23B and 24D only)
- 25M BTU Auto Ignition Furnace (29V and 31M only)
- Pre-wired for Roof Air Conditioner
- AC/DC Power Converter
- Battery Charger
- GFI Circuit Protection
- 12V Lighting System
- Floor Mounted LPG Tank
- Marine Toilet

ELECTRICAL

- Auxiliary Battery
- Pre-wired for 4.0kW Generator

ENTERTAINMENT

- Pre-wired for Cable TV

EXTERIOR

- Smooth Fiberglass Sidewalls
- Steel Cage Vacubond Sidewalls
- Crowned Rubber Roof
- Seamless Rubber Roof
- Chrome Plated Front Bumper
- Powder Coated Sewer Hose Carrier Bumper
- 12V Patio Light
- GFI Protected Patio Receptacle
- Radius Cornered Windows
- Wheel Covers
- Spare Tire and Carrier
- Lockable, Exterior Storage Compartments

INTERIOR

- Foam Board Insulation
- Fabric Ceiling
- Stainless Steel Double Galley Sink
- Molded Tub/Shower Pan
- Shower Curtain
- Mini-Blinds (Bedroom Area)
- Pleated Shades (Living Area)
- Entry Door with Screen and Window
- Entry Door with Dead Bolt Lock
- Side Dinette

INTERIOR (CONT.)

- Innerspring Mattress (Not available on 23B)
- 54" x 76" Cabover Bed
- Wood Drawers
- Radius Cornered Countertops
- Vinyl Flooring – Galley/Lavy
- Bedspread (Not available on 23B)

INTERIOR AUTOMOTIVE

- Panasonic® AM/FM/Cassette Stereo
- Cab Air Conditioner
- Auxiliary Start Circuit
- Cruise Control
- Power Locks and Windows
- Beverage Cup Holder (Chassis OEM)
- Cab Seats with Armrest, Adjustable, Reclinable

SAFETY

- Smoke Detector/Alarm
- Fire Extinguisher
- LPG Leak Detector/Alarm
- CO Detector/Alarm
- 3-Point Seat Belts on Driver/Passenger Seats
- Driver/Passenger Air Bags (Ford only)

2001 TIOGA ARROW SPECIFICATIONS

FORD® CHASSIS	23B	24D	29V	31M
Engine LD	6.8L/V10	6.8L/V10	6.8L/V10	6.8L/V10
Wheelbase	158"	158"	190"	220"
GVWR lbs/kgs (1)	11,500/5,221	11,500/5,221	14,050/6,379	14,050/6,379
Front GAWR lbs/kgs (2)	4,600/2,088	4,600/2,088	4,600/2,088	4,600/2,088
Rear GAWR lbs/kgs (2)	7,810/3,546	7,810/3,546	9,450/4,290	9,450/4,290
Base Weight lbs/kgs (3)	8,529/3,872	8,665/3,934	9,600/4,358	10,214/4,637
GCWR (6.8L w/4.10 Differential-E30) lbs/kgs (4)	15,000/6,810	15,000/6,810	N/A	N/A
GCWR (6.8L w/4.63 Differential-E40) lbs/kgs (4)	N/A	N/A	17,550/7,967	17,550/7,967
Hitch Rating/Tongue Weight (lbs)	3,500/350	3,500/350	3,500/350	3,500/350
Hitch Rating/Tongue Weight (kgs)	1,580/158	1,580/158	1,580/158	1,580/158
Fuel Capacity gal/lbs (6.1 lbs/gal)	55/336	55/336	55/336	55/336

CHEVY™ CHASSIS	23B	24D	29V	31M
Engine LD	74L	74L	74L	N/A
Wheelbase	159"	159"	191"	N/A
GVWR lbs/kgs (1)	12,300/5,584	12,300/5,584	12,300/5,584	N/A
Front GAWR lbs/kgs (2)	4,300/1,952	4,300/1,952	4,300/1,952	N/A
Rear GAWR lbs/kgs (2)	8,600/3,904	8,600/3,904	8,600/3,904	N/A
Base Weight lbs/kgs (3)	8,704/3,952	8,840/4,013	9,426/4,279	N/A
GCWR (7.4L w/4.10 Differential) lbs/kgs (4)	15,800/7,173	15,800/7,173	15,800/7,173	N/A
Hitch Rating/Tongue Weight (lbs)	3,500/350	3,500/350	3,500/350	N/A
Hitch Rating/Tongue Weight (kgs)	1,580/158	1,580/158	1,580/158	N/A
Fuel Capacity gal/lbs (6.1 lbs/gal)	55/336	55/336	55/336	N/A

DIMENSIONS	23B	24D	29V	31M
Ford® Length (5)	24' 0"	25' 0"	29' 3"	31' 1"
Chevy™ Length (5)	24' 5"	25' 5"	29' 8"	N/A
Height	131"	131"	131"	131"
Width (maximum) (6)	99"	99"	99"	99"
Interior Height (maximum)	79"	79"	79"	79"
Interior Width (maximum)	96"	96"	96"	96"

LIQUID CAPACITIES (GAL/LTR)	23B	24D	29V	31M
Fresh Water Holding Tank (8.3 lbs/gal)	35/132	30/114	30/114	30/114
Grey Water Holding Tank (8.3 lbs/gal)	36/136	36/136	37/140	37/140
Black Water Holding Tank (8.3 lbs/gal)	35/132	35/132	37/140	37/140
Appliance LPG Tank (4.5 lbs/gal) (WC) (7)	14/53	14/53	14/53	14/53
Water Heater Tank (8.3 lbs/gal)	6/23	6/23	6/23	6/23

METRIC CONVERSIONS:

Feet to meters: ft x .304 = meters Lbs to kgs: lbs x .454 = kgs Gallons to liters: gal x 3.78 = ltrs

Triton™ is a trademark of the Ford Motor Company.
Vortec™ is a trademark of the General Motors Corporation • Onan® is a registered trademark of Cummins.

2001 TIOGA ARROW OPTIONS

APPLIANCES	23B	24D	29V	31M
Samsung® Microwave Oven	OPT	OPT	OPT	OPT
A/C 13.5M Roof	OPT	OPT	OPT	OPT
Range Cover	OPT	OPT	OPT	OPT

ELECTRICAL	23B	24D	29V	31M
4.0kW Generator Onan® MicroQuiet	OPT	OPT	OPT	OPT
Manual Battery Disconnect	OPT	OPT	OPT	OPT
CSA	OPT	OPT	OPT	OPT

ENTERTAINMENT	23B	24D	29V	31M
Panasonic® AM/FM/CD Stereo	OPT	OPT	OPT	OPT
Panasonic® 6-Disk CD Changer	OPT	OPT	OPT	OPT

EXTERIOR	23B	24D	29V	31M
Awning (USA only)	OPT	OPT	OPT	OPT
Aluminum Running Boards	OPT	OPT	OPT	OPT
Trailer Hitch	OPT	OPT	OPT	OPT
Ladder	OPT	OPT	OPT	OPT
Undercoating	OPT	OPT	OPT	OPT
Stainless Steel Wheel Simulators	OPT	OPT	OPT	OPT

EXTERIOR AUTOMOTIVE	23B	24D	29V	31M
Chevy™ Chassis 74L - Vortec™ Engine	OPT	OPT	OPT	N/A
Ford® Chassis 6.8L - Triton™ Engine	OPT	OPT	OPT	OPT

1. GVWR (Gross Vehicle Weight Rating): Means the maximum permissible loaded weight of the motor home. The GVWR is equal to or greater than the sum of the unloaded vehicle weight plus the net carrying capacity.
 2. GAWR (Gross Axle Weight Rating): Means the maximum permissible loaded weight a specific axle is designed to carry.
 3. BW (Base Weight): Means the weight of the motor home without fuel, options, water, cargo or passengers.
 4. GCWR (Gross Combined Weight Rating): Means the value specified by the motor home manufacturer as the maximum allowable loaded weight of this motor home with its towed vehicle. Towing and braking capacities may differ. Refer to Fleetwood and chassis manufacturer manuals for complete information.
 5. Length taken from front bumper to rear bumper.
 6. Excludes safety equipment and awnings.
 7. Tank Manufacturer's listed water capacity (WC). Actual LPG capacity is 80% of water listing as required by the safety code.
- N/A : Information not available at the time of publication.

Your motor home takes you to new adventures every day. And since this home will be an enduring part of your life, we offer a selection of colors and textures that are a fine blend of classic and contemporary style. We search to obtain quality fabrics that are elegant, yet durable, to keep up with your active lifestyle. Year after year, the look will be as welcoming to you as it is to your guests.

RAINFOREST GREEN



THUNDERSKY BLUE

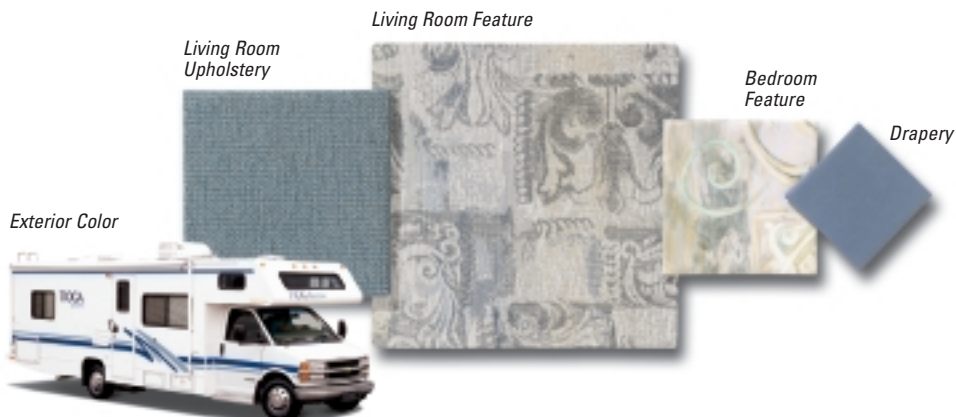

www.fleetwood.com

Visit our website to find a dealer near you, learn more about other Fleetwood products or purchase Fleetwood branded apparel. Or call 1-800-444-4905.

FOR CUSTOMER ASSISTANCE, call toll free 24 hours a day at 1-800-322-8216, visit our website, or you may write to Fleetwood Enterprises, Inc., P.O. Box 7638, Riverside, CA 92513-7638.

IMPORTANT—PLEASE READ: Product information and photography included in this brochure were as accurate as possible at the time of publication. For the most current product information and changes, please visit our website at www.fleetwood.com or contact your local Fleetwood dealer. Subsequent refinements may be evident in the actual product. Prices and specifications are subject to change without notice. All weights, fuel, liquid capacities and dimensions are approximate. Fleetwood has designed its recreational vehicles to provide a variety of uses for its customers. Each vehicle features optimal seating, sleeping, storage and fluid capacities. The user is responsible for selecting the proper combination of loads to ensure that the recreational vehicle's capacities are not exceeded.

FLEETWOOD. RV

America's Favorite Recreational Vehicles

Fleetwood Enterprises, Inc., RV Marketing, P.O. Box 7638, Riverside, CA 92513-7638

Your local Fleetwood RV dealer is:



This award certifies that Fleetwood has met Ford's rigid quality standards for utilizing a Ford chassis.