

XLR THUNDERBOLT

# XLR THUNDERBOLT



A division of Forest River Inc.,  
a Berkshire Hathaway company





# XLR THUNDERBOLT

## **XLR THUNDERBOLT** LET THE GOOD TIMES ROLL

Nothing gets your attention like a Thunderbolt. It turns heads inside and out with amazing living spaces and a list of standard luxury amenities planned for easy living. These models feature the largest frameless windows in the industry.







**395AMP** Thunderbolt's interior styling sets the stage for a good time with exclusive tiger stripe Corian® countertops, an ultra-deep 60/40 stainless steel sink with high-rise gooseneck faucet, a quad door 12 cu. ft. refrigerator, contemporary pendant lighting and a spacious pantry.

## DECOR

KAHLUA

ABSOLUTE CARBON

BOURBON

IRISH WHISKEY





# XLR THUNDERBOLT

## **XLR THUNDERBOLT** **DRESSED TO THRILL**

It's the attention to detail that sets XLR Thunderbolt apart. Living spaces are designed to maximize every square inch of space. Thunderbolt's decor is dramatic and inviting. Furnishings are plush. Colors are rich. The Thunderbolt makes a statement that turns heads, while creating a fun atmosphere that gets the good times rollin'.







**395AMP** This master suite features his and hers wardrobes, a computer workstation, a lift-up vanity, a built-in dresser with deep drawers, plenty of walk around bed space and a full, floor-to-ceiling entertainment center (not shown).

**395AMP** This ample bathroom has an exclusive tiger stripe Corian® countertop and boasts one of the largest vanities in the industry, complete with a generous medicine cabinet. Cool blue shower mood lighting looks hot.





# KLAR

## THUNDERBOLT

**300X12** goes beyond what others offer with a choice of 10', 12' and 14' garage models. Our 12' garage provides more space, is lighter and a better value than the competition.



## **XLR THUNDERBOLT**

### **IT'S LOADED!**

You feel like a high roller when you step up to the XLR Thunderbolt. After a day of playing hard, rich deep earthtones and vibrant accents with contemporary styling give a warm welcome feeling that sets this stylish RV apart from the rest.



**300X12** This REV IT UP package with a U-shaped party dinette has slide out extended seating on both ends. Kitchen features include a 22" oven with 3-burner cooktop and cabinet that blows the competition away.

**300X12** features a contemporary bedroom with large wardrobe slide out and designer accent wall.





**386X12** Variety is the spice of life. With XLR, you can change things up. The spacious living area is available with optional theater seating, plus a free standing table and chairs, a 42" flat screen TV and an electric fireplace. Stairs offer safe access to the upper loft sleeping area.





*Kegerator keeps beer fresh so the party can go on and on.*



*A powerful cordless vacuum by Dyson is available as an option.*



*5,000 lb flush-mounted D-ring.*



*Outdoor entertainment center is standard on the 395AMP.*



*Recessed dove-tail storage compartment is standard in the AMP series.*



*VIP Party Deck (Not available on 10' garage models).*

*Rockstar entertainment center moves with the party.*



*The Bitchin Outdoor Kitchen™ Includes: Weber® grill, refrigerator, stainless steel sink with hot and cold water hook-ups, 5 gallon gray tank, 2 tier bar top, all weather ready!*

*Optional garage organizer.*



*Washer/Dryer prep is in the garage instead of the bedroom closet.*



**XLR THUNDERBOLT**  
**FEATURES YOU**  
**DON'T WANT TO MISS**





## 2012 XLR THUNDERBOLT FLOORPLANS

**300X14\***  
**300X12**  
**300X10**

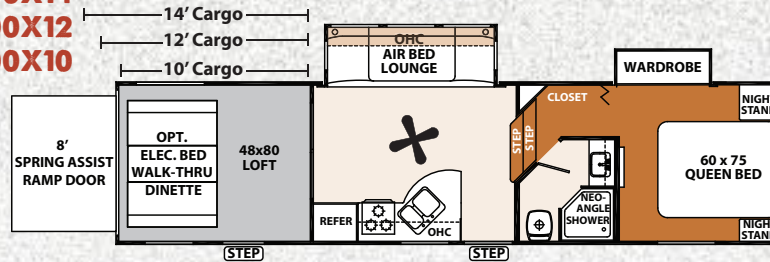

**35X14**  
**35X12**  
**35X10**

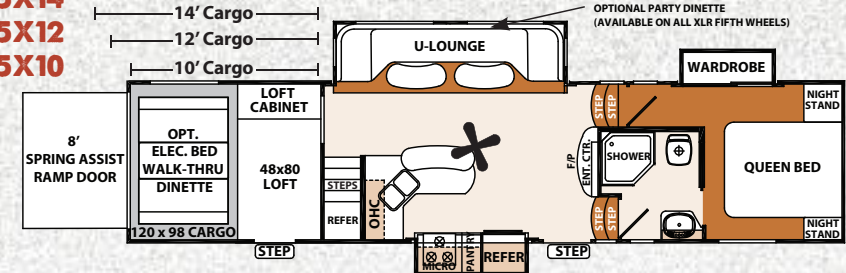

**386X12**

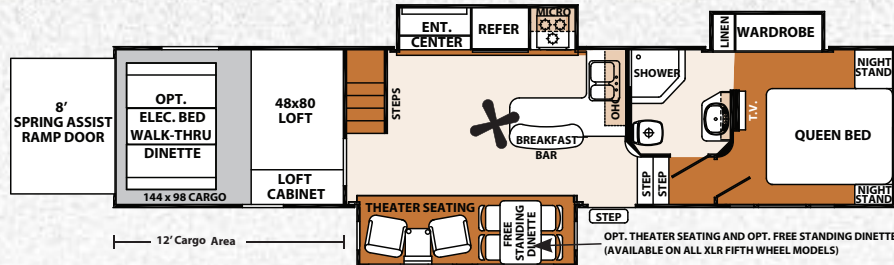

**40X12**



**380AMP**

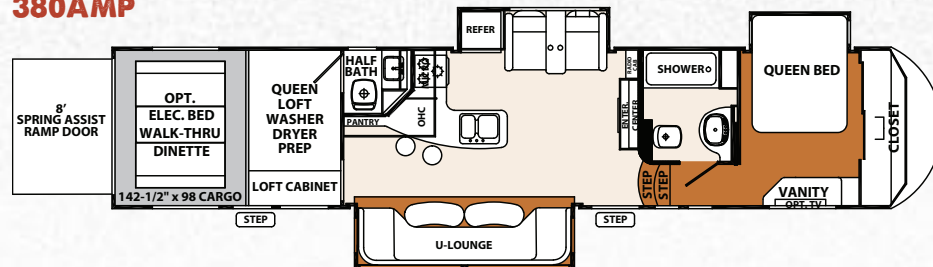

**395AMP**

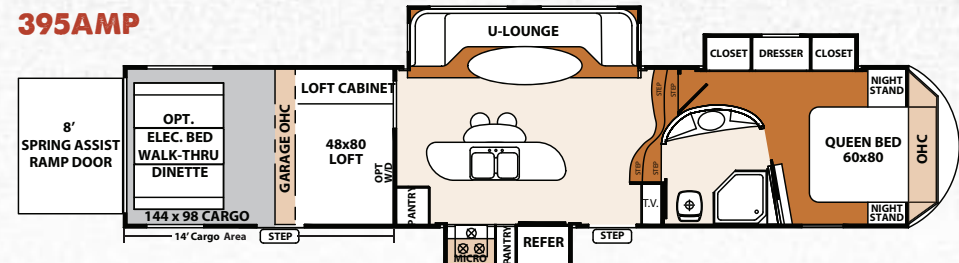

## EXTERIOR GRAPHICS OPTIONS

**STANDARD - HAVOC RED**

**TREMOR BRONZE**

**HAVOC RED - PARTIAL PAINT**





## 2012 XLR THUNDERBOLT FEATURES

### INTERIOR STANDARDS

- Professionally Designed Interiors
- Maple Raised Panel Cabinetry
- Premium Textured Countertops
- Crown Molding
- Night Shades
- Single Lever High Arcing Faucet
- Ceiling Fan (Select models)
- Attic Ventilation System
- Brownstone Laminated Countertops
- Residential Large Microwave
- Stainless Steel Deep Bowl Kitchen Sink
- 7'6" Slide Room Height (AMP Series only)
- Living Room LCD HDTV
- Multi-Zone Entertainment Control Module
- Indoor/Outdoor Speaker Selector Switch
- 15K BTU Air Conditioner
- 150 Gallons Fresh Water (AMP Series only)
- Wired & Framed for 2nd A/C (Bedroom)
- Bathroom Fantastic Fan
- LED Shower Light
- 12 Gallon Gas/Electric/DSI Water Heater
- Washer/Dryer Prep In Cargo Area (N/A on 10' Garage Models)
- Retractable Hid-N-Screen Wall
- Temperature Controlled Garage (Select models)
- Dovetail Storage Box (AMP Series only)

### EXTERIOR STANDARDS

- Vacuum-Bonded Alum. Framed Construction
- POLYDET® High Gloss Fiberglass Sidewalls
- Gel Coat Radius Front Cap w/LED Lights
- Exterior LED Brake Lights and Marker Lights
- 6,000 lb EZ Lube Axles
- 16" Spider Aluminum Wheels
- Tri-Tone Metal Skirting
- 50 AMP Service
- 100 AMP Converter
- Exclusive Hitch Pin Cover
- Generator Ready w/Fuel Tank - 18 Gal.
- Ultra View Frameless Windows
- Electric Awning
- Strut Assisted Entry Doors
- Slam Latch Baggage Doors
- Premium Ramp Door Compression Locks
- Reverse Activated Rear Flood Lights
- Self-adjusting SchwinTek Slide System (Select Slides)
- Black Laminated Slide-Out End Walls
- Satellite HD Ready Prewire
- Outside Shower
- Enclosed Termination Valves
- Triple 30# LP Tanks (AMP Series only)

### OPTIONAL EQUIPMENT

- **Rev It Up Package** (Corian kitchen & bath, undermount deep bowl stainless steel sink, Corian sink covers, residential high rise faucet w/pull down sprayer, laser cut Thunderbolt backsplash)
- **Arctic Weather Package** (R40-E roof, floors, gooseneck and cap, R24-E slide floor, dual pane windows, 12V heated holding tanks)
- **Man Cave Garage Package** (Rock Star entertainment center w/32" LCD TV, dual 10" subwoofers, 4 speakers, 2 sport rockers, Kegerator, ground effects exterior lighting)
- **Beer Blast Package** (Kegerator, 22" LCD TV)
- **The Bitchin Outdoor Kitchen™** (Weber® grill, refrigerator, stainless steel sink w/hot and cold water hook-ups, 5 gallon gray tank, 2 tier bar top, all weather ready!)
- **Rockstar Entertainment Center** (32" LCD TV, Kicker 300W Amp, 10" subwoofers & (4) speakers, AM/FM/CD/MP3/DVD stereo, external 110V, HDMI, gaming connections, TV/cable/satellite hook-up)
- 5.5kw Onan CARB EVAP Generator
- Mobile Fuel Station w/Fuel Tank (30 gal.)
- Electric Rear Stabilizer Jacks
- Frame Mounted Toy Lok
- Party Dinette IPO Booth/Sofa
- Free Standing Table & Chairs

- Theater Seating IPO Sofa
- Sliding Glass Patio Door (Select models)
- 2nd Air Conditioner - Bedroom
- Dyson Digital Slim Cordless Vacuum
- Bedroom TV w/Exterior Bracket
- 8 Function Wireless Remote w/Touch Screen Control
- Wireless Back Up/Security Camera
- Kegerator
- Removable Cargo Carpet Kit
- VIP Party Deck (N/A 10' Garage Models)
- Electric Bed w/Bottom Pass Thru Dinette
- Cargo Shower Upgrade (40X12 only)

### XLR THUNDERBOLT FIFTH WHEEL SPECIFICATIONS

Model	Hitch Weight	Ship Weight	GVWR	Cargo Capacity	Exterior Length	Exterior Height	Exterior Width	Fresh Water	Gray Water	Black Water	Awning Size
300X10	1504	10789	13540	2751	36'0"	13'2"	102"	100	64	32	18'
300X12	1672	11194	13672	2478	38'0"	13'2"	102"	100	64	32	18'
300X14	1838	11725	18000	8113	41'0"	13'2"	102"	100	64	32	18'
35X10	2389	12744	18000	5256	38'1"	13'2"	102"	100	86	32	14'
35X12	2300	13402	18000	4598	39'11"	13'2"	102"	100	86	32	14'
35X14	2977	13648	18000	4352	41'11"	13'2"	102"	100	86	32	14'
386X12	2355	14459	18000	3541	43'4"	13'2"	102"	100	54	54	14'
40X12	2522	14554	18000	3446	41'8"	13'2"	102"	100	54	108	14'
380AMP	TBA	TBA	18000	2673	42'3"	13'2"	102"	162	54	108	13'
395AMP	2853	14772	18000	3228	43'9"	13'2"	102"	162	130	54	21'

ROCKSTAR RED - FULL BODY PAINT



BLACK PEARL - FULL BODY PAINT



HD SUNSET - FULL BODY PAINT





# XLR THUNDERBOLT



**386X12**  
with Partial Paint

**395AMP**  
with Havoc Red graphics



## WHY XLR THUNDERBOLT?

With Thunderbolt, the good times just keep on rollin'. Loaded with standard features and brand-name appliances like Dyson and Kicker Stereos, life on the road has never been better. XLR has tailored the Thunderbolt to meet the highest standard – yours. The exteriors are hot and the interiors are cool. With double and triple slide-outs, 10', 12' and 14' garages, and a 102" widebody design with vacuum bonded aluminum construction, the choice of rock-solid configurations is up to you.

### FOREST RIVER

2431 E. Kercher Road ■ Goshen, IN 46526  
E-mail: [XLRinfo@forestriverinc.com](mailto:XLRinfo@forestriverinc.com) ■ Phone: 574-975-0279 ■ Fax: 574-343-5909  
[www.forestriverinc.com/XLR](http://www.forestriverinc.com/XLR) ■ [www.forestriveraccessories.com](http://www.forestriveraccessories.com)

CHECK US OUT ON:



Actual towing capacity is dependent on your particular loading and towing circumstances, which includes GVWR, GAWR and GCWR, as well as adequate trailer brakes. Please refer to the Owners Manual of your vehicle for further information. Floor plans, features and specifications are subject to change without notice.  
11/11/10M ©2011 XLR



### PRE-DELIVERY INSPECTION FACILITY

20,000 square feet of quality assurance. The bare essentials for a premium product. This state-of-the-art facility gives immediate daily feedback to production for quality assurance in every unit built.



- 1) Forest River, Inc. dealers are independently owned and operated businesses so priority service and scheduling is at their discretion and is often provided to customers that purchased their unit at that dealership.
- 2) Purchasing locally allows customers to establish meaningful relationships with a dealer, enhancing the RV experience through assistance with product questions, user tips or RV regulations for your state or country, and much more!
- 3) Canadian customers must meet requirements to bring an RV purchased out of the country to their home. These requirements may involve additional inspections and certifications, taxes and fees. Your local Canadian Dealer is a professional at meeting these requirements.
- 4) Scheduling timely warranty repairs and adjustments through a local dealership provides far greater flexibility and convenience to you, the customer!

Forest River, Inc. encourages our customers to purchase their Forest River products from a local dealership whenever possible for the following reasons:

It is the goal of Forest River, Inc. that all of our RV owners fully enjoy the RV experience and that customer satisfaction meets or exceeds their expectations!



#### Learn More

Scan this barcode using a QR Reader on your smart phone to learn more about Forest River.



A Berkshire Hathaway company.

**YOUR XLR THUNDERBOLT DEALER**