

2008 FLOOR PLANS

Flush Floor Slide Outs on all Models

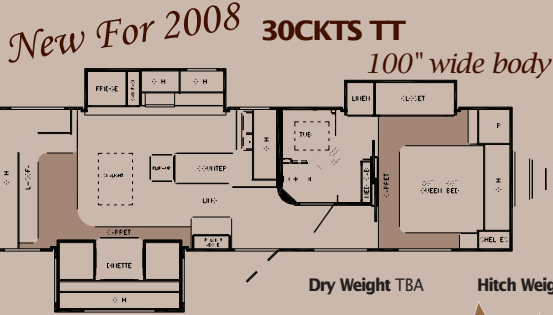
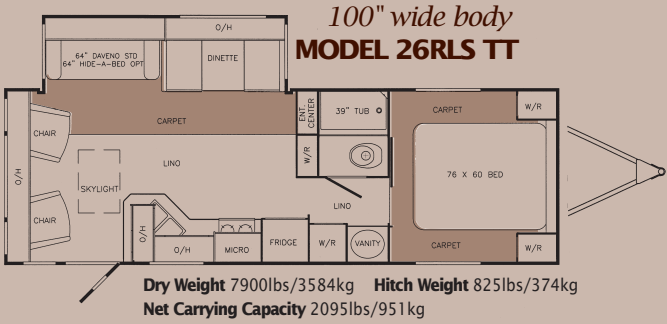
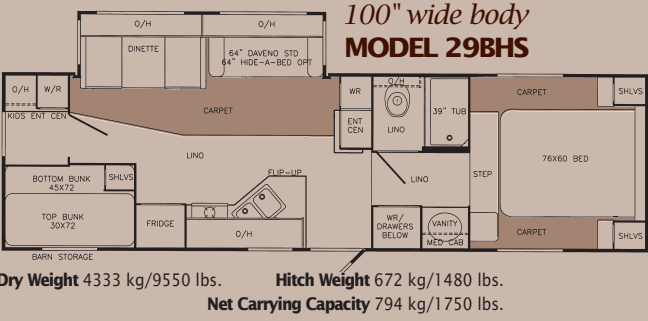

New For 2008

MODEL 32.5BHQs 100" wide body

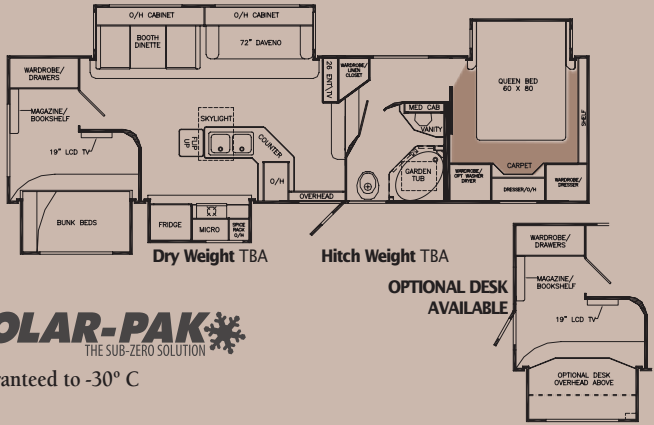

POLAR-PAK
THE SUB-ZERO SOLUTION

Guaranteed to -30° C

2008 SPECIFICATIONS

	29BHS	32.5BHQs	26RLS TT	28CKDS TT	30CKTS TT
Exterior Length	9.3 M/30'6"	10.3m/33'10"	9.3M/30'8"	9.9M/32'6"	10.5m/34'5"
Exterior Width	2.5 M/8'4"	2.5m/ 8' 4"	2.5 M/8'4"	2.5 M/8'4"	2.5m/ 8' 4"
Exterior Height	3.7 M/12'2"	3.9/12'9"	3.4M/11'4"	3.4M/11'4"	3.4m/11' 4"
Bedroom Height	1.8 M/5'9"	2.0m/6'6"	2.0M/6'8"	2.0M/6'8"	2.0m/6'8"
G.V.W.R.	5127 kg/11,300 lbs.	TBA	4535 kg/9,995 lbs.	4763 kg/10,500 lbs.	TBA
Exterior Storage	152 Cu. Ft.	160 cu. ft.	35 Cu. Ft.	74 Cu. Ft.	50 Cu. Ft.
Fresh Water Capacity	241 L/ 64 US Gal.	232L/61 US G	198 L/52 US Gal.	218 L/58 US Gal.	198L/52 US G.
Toilet Tank Capacity	203 L/ 53.4 US Gal.	203L/53.4 US G.	203 L/53 US Gal.	144 L/38 US Gal.	203L/53.4 US G
Grey Tank	194 L/51 US Gal.	194L/51 US G.	194 L/51 US Gal.	144 L/38 US Gal.	194L/51 US G.
Radial Tire Size	ST235/80R16-D	ST235/85R 16G	ST235/80R16-D	ST235/80R16-D	ST235/80R 16 D
Propane Capacity	2x30 lbs.	2x30 lbs.	2x30 lbs.	2 x 30 lbs	2 x 30 lbs.
Axle Capacity	10,400 lbs.	14,000 lbs	10,400 lbs.	10,400 lbs.	12,000 lbs.
Furnace Size (DSI)	35,000 BTU	40,000 + 18,000 BTU	35,000 BTU	35,000 BTU	35,000 BTU
Water Heater "XT"	36 L/10 US GAL	36 L/10 US GAL	36 L/10 US GAL	23 L/6 US GAL	36 L/10 US GAL
Awning	16'	18'	17'	17'	15'

The manufacturer reserves the right to improve or modify the product which may change specifications, designs or prices. Information contained herein is from data available at time of printing. All products meet or exceed CSA and RVIA standards.

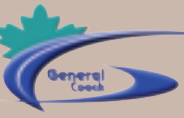

GENERAL COACH
P.O. Box 700, Oliver, B.C. V0H 1T0
Telephone: (250) 498-3471
Fax: (250) 498-3240
E-mail: gcsales@generalcoach.bc.ca
Website: www.generalcoach.bc.ca

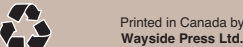

Proudly Presented By



General Coach provides you with a two-year limited warranty on your fifth wheel trailer. Additionally, General Coach includes a six-year limited warranty which covers the structural integrity of your vehicle. This added warranty is unique to the recreational vehicle industry and should be one of your very serious considerations when choosing your next R.V.



Canada's Best! Don't Settle for Less!

Guaranteed to -30° C

2008

Citation
Fifth Wheel & Travel Trailers



North America's Best
POLAR-PAK
THE SUB-ZERO SOLUTION



Model 26RLS TT Lancaster Decor

Unmatched liveability, cozy comfort and superior quality are foremost in the Citation. The Model 26RLS Travel Trailer is shown here in the rich Lancaster Decor. Quality crafted residential furniture is upholstered with woven, durable, high quality fabrics. Kitchens feature abundant overhead cabinets, numerous drawers and spacious counters for maximum interior storage and easy food preparation. Citation utilizes customer proven name brand appliances and components, with two-year warranties for your worry-free travel. You'll really appreciate the thoughtful design of Citation's bedrooms. Spacious headroom, large wardrobes and large drawers on quality, double steel guides and rollers is just the beginning. All beds have a lift-up feature to access valuable storage below and residential quality coil spring mattresses will ensure your sleeping comfort. Outside, large exterior storage compartments accommodate all of your hobby and leisure items...and then some!

EXTERIOR

- **Aluminum Wheels**
- Colour Co-ordinated fiberglass skirts
- "Filon" fiberglass with a 2 year warranty against fading or discoloring
- Vacuum laminated walls - framed and steel reinforced
- **"Aerodynamic"** seamless fiberglass front cap
- Fiberglass one piece fender skirts
- Fiberglass compartment doors -
- Convenient retainer clips on all compartment doors
- Dual battery compartment - 5th Wheels
- Large heated front storage compartments
- 4'x4' cargo door on curbside - Model 29BHS, 32.5BHQS
- Roadside and hitch lights

- Interior switched patio light
- Entrance door with secure deadbolt lock
- Automotive quality clearance and tail lights
- Retractable non-skid triple entrance steps
- Goodyear Marathon radial tires
- Radial spare tire
- Dexter axles with 4 shock absorbers and leaf springs
- Heavy duty electric brakes - 12"
- High performance polypropylene undersiding. Seamless and non-corrosive. Stronger than galvanized steel
- Roof rack and ladder
- "Dicor" seamless vinyl roof - 12 year warranty against weather damage
- **Adjustable Height Spring Hangers**

- Full 3/8" plywood roof deck - residential 2x3 stud Crowned 6" Truss ceiling -
- Maxi-frame, heavy-duty steel chassis with superior number of 12 gauge full-width crossmembers
- Chassis protected w/full undercoating
- Steel frame welded to meet or exceed CSA specifications
- Canada's only framed vacuum bonded wall with a **6 Year Structural Warranty**
- Full frame floor w/5/8 plywood glued and screwed "No Floor Vents"
- All plywood construction - no substitutes
- Vacuum bonded walls mounted directly on top of floor - dustproof seal
- Roof mounted directly on top of sidewall
- EPS block insulation - dimensionally stable - totally non-toxic, non-allergenic; No CFC's or HFC's - ultra high density - 16 PSI
- All interior and exterior components secured w/screws to stud reinforcing
- Electric gear driven rack and pinion slide with manual override - self locking for travel
- Solar panel pre-wire
- Rear and front stabilizer jacks, Travel Trailers
- Rear stabilizer jacks, all fifth wheels
- Flush floor slide outs w/vacuum laminated framed and insulated floor
- **"Heated holding & fresh water tanks"**

INTERIOR

- Beech cabinet doors and drawer fronts
- Spring filled daveno - easy conversion for sleeping
- 40" wide dinettes with high density foam
- Exterior TV cable & Phone
- Co-ordinated valances and fabric blinds
- Residential steel drawer guides w/birch drawers
- Deep Stainless Steel kitchen sink
- Co-ordinated bedspread with pillows - "Eurotop" spring mattress
- Queen and twin beds with gas lift struts and storage below
- Plywood counter tops with hardwood edge
- Seamless residential fiberglass tub enclosure
- Slide-out can rack in Model 28CKDS, 30CKTS, 32.5BHQS
- Beech knife block in counter
- Brushed nickel cabinet hardware

QUALITY BRAND NAME APPLIANCES

- Wedgewood three-burner high output range w/oven Piezo ignition on range top
- 8' Norcold refrigerator
- 9' Dometic refrigerator 26RLS only
- Atwood "XT" water heater gas/electric
- Aluminum laminate refrigerator door panels
- Hydroflame Excalibur DSI furnace - in cabinet ducted forced air
- AM/FM stereo-"CD/DVD Player" with bedroom shut-off switch

STANDARD FEATURES

- * A & E 8500 Series deluxe awning
- * Awnings on all slide outs
- * Duotherm Ceiling ducted roof air 13,500 BTU
- * "Fantastic" vent fan - STD on fifth wheels
- * Thermopane "Hehr" windows - Solar Reflective
- * Fold away assist rail
- * Microwave oven
- * Winegard TV antenna with power boost
- * Chrome rear bumper cover
- * Black tank flush system
- * Electric front jacks with quick release pins - Fifth Wheels
- * CO Detector, Propane Leak Detector
- * "Dayliter" residential dual pane skylights - Lifetime warranty
- * 12 Volt Disconnect
- * BBQ Quick Connect

Canada's only RV Guaranteed to -30° C

We are General Coach, a western Canadian company that manufactures the well known Citation line of quality recreational vehicles. For over 57 years we have been consumer established as builders of high value, superior quality R.V.'s with proven high resale value. Your comfort and satisfaction are ensured. Residential quality components and residential style construction techniques are used by skilled, long term employees dedicated to quality workmanship.

Citation is designed for western Canadian climate and conditions with standard features second to none. Your peace of mind with your purchase decision is reinforced by Citation's **Six Year Limited Structural Integrity Warranty. Quality You Can Afford!**

“ I love the skylights! Natural light is let in so we don't have to worry about turning lights on all the time. Nice floor plan for a family with kids (28CKDS TT). Overall we are completely satisfied and are happy we spent the extra to get a well built unit. You get what you pay for!

~D & K, Hinton, AB

”



28CKDS TT Mocha Decor