

A W I N N I N G  
TRADITION



*from American Coach*

*The American Tradition*  
2001 Season





*Red Auerbach on winning.*

*“When people are used to winning, they put out a little more.”*

*When you become an American Coach owner, you also become a member of the American Coach team. A winning combination of sales, manufacturing and service professionals who take a great deal of pride in every coach we build.*

*American Coach embodies the very essence of what it takes to always emerge a winner. Hard work. Winning attitudes. And an unrelenting passion for being the best at what we do.*

*Many of the same values embraced by legendary coaches such as Red Auerbach. A coach who constantly raised the bar and brought out the best in all his players and those around him.*

*American Coach works to instill pride of ownership and a sense of belonging. And nowhere is that more evident than at American Coach Team Rallies... where hundreds of owners travel hundreds of miles to savor the moment and taste the victory.*

WELCOME TO THE TEAM. WELCOME TO AMERICAN COACH.

TM 2000 Estate of Red Auerbach under license authorized by CMG Worldwide Inc. [www.cmgww.com](http://www.cmgww.com)

## EXTERIOR GRAPHICS



*Copper Oasis*



*Winter White*



*Blue Illusion*



*Golden Fern*



## 40TMS

### Standard Features

- |                                   |  |
|-----------------------------------|--|
| 1. Nightstand w/Overhead          | 11. Microwave  |
| 2. Speaker Sofit w/Lighting       | 12. 3 Burner w/Oven  |
| 3. Queen Bed 60" x 80" Slide-out  | 13. Table w/Flexsteel® Fabric Chairs                       |
| 4. Rear Wardrobe                  | 14. Galley Overhead  |
| 5. 20" Rear TV                    | 15. Flexsteel® Fabric Easy Bed                             |
| 6. Wardrobe w/Washer Cabinet      | 16. Flexsteel® Fabric Love Seat                            |
| 7. Shower                         | 17. Overhead Storage                                       |
| 8. Linen Cabinet                  | 18. Flexsteel® Fabric Driver/Passenger w/Power Driver Seat |
| 9. Pantry                         | 19. 27" Front TV in Overhead                               |
| 10. Side-By-Side Ref. w/Ice-Maker |  |

#### BEDROOM OPTIONS



#### LIVING AREA OPTIONS

Desk w/Flexsteel® Fabric Chair



Flexsteel® Leather Easy Bed, Leather Love Seat, Leather Driver/Pass Seats w/Power Lumbar

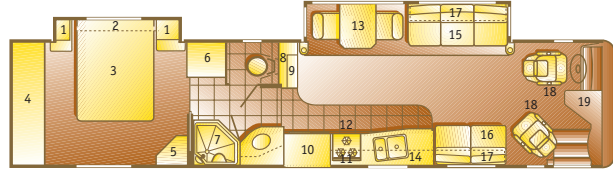

#### COCKPIT OPTIONS

Flexsteel® Leather Driver/Pass Seats w/Power Driver Seat w/Manual Lumbar

#### GALLEY OPTIONS

Facing Dinette

Norcold® 4-Door Fridge w/Ice-Maker

Flexsteel® Leather Love Seat

Flexsteel® Leather Easy Bed

#### LIVING AREA OPTIONS

## 40Tqs

### Standard Features

- |                                   |  |
|-----------------------------------|--|
| 1. Nightstand w/Overhead          | 10. 3 Burner w/Oven  |
| 2. Speaker Sofit w/Lighting       | 11. Galley Overhead  |
| 3. Queen Bed 60" x 80" Slide-out  | 12. Table w/Flexsteel® Fabric Chairs                       |
| 4. Rear Wardrobe                  | 13. Flexsteel® Fabric Easy Bed                             |
| 5. 20" Rear TV                    | 14. Flexsteel® Fabric J-Love Seat                          |
| 6. Washer/Dryer w/Hamper Rollouts | 15. Overhead Storage                                       |
| 7. Shower                         | 16. Flexsteel® Fabric Driver/Passenger w/Power Driver Seat |
| 8. Side-By-Side Ref. w/Ice-Maker  | 17. 27" Front TV in Overhead                               |
| 9. Microwave                      |  |

#### BEDROOM OPTIONS



#### LIVING AREA OPTIONS

Desk w/Flexsteel® Leather Recliner



Flexsteel® Leather Easy Bed, Leather Love Seat, Leather Driver/Pass Seats w/Lumbar

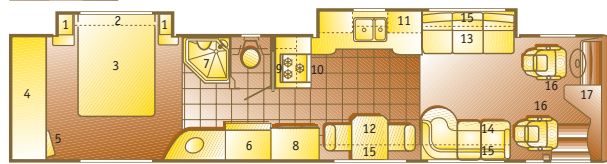

#### COCKPIT OPTIONS

Flexsteel® Leather Driver/Pass Seats w/Power Driver Seat w/Manual Lumbar

#### GALLEY OPTIONS

Facing Dinette

Norcold® 4-Door Fridge w/Ice-Maker

Flexsteel® Leather Love Seat

Flexsteel® Leather Easy Bed

Flexsteel® Leather J-Love Seat

#### LIVING AREA OPTIONS

## 40Tks

### Standard Features

- |                                      |  |
|--------------------------------------|--|
| 1. Nightstand w/Overhead             | 10. Microwave  |
| 2. Speaker Sofit w/Lighting          | 11. 3 Burner w/Oven  |
| 3. Queen Bed 60" x 80" Slide-out     | 12. Table w/Flexsteel® Fabric Chairs                       |
| 4. Rear Wardrobe                     | 13. Galley Overhead  |
| 5. 20" Rear TV                       | 14. Flexsteel® Fabric Easy Bed                             |
| 6. Linen w/Drawers & Hamper Rollouts | 15. Flexsteel® Fabric J-Love Seat                          |
| 7. Shower                            | 16. Overhead Storage                                       |
| 8. Pantry/Washer/Dryer               | 17. Flexsteel® Fabric Driver/Passenger w/Power Driver Seat |
| 9. Side-By-Side Ref. w/Ice-Maker     | 18. 27" Front TV in Overhead                               |

#### BEDROOM OPTIONS



#### LIVING AREA OPTIONS

Desk w/Flexsteel® Leather Recliner



Flexsteel® Leather Easy Bed, Leather Love Seat, Leather Driver/Pass Seats w/Lumbar

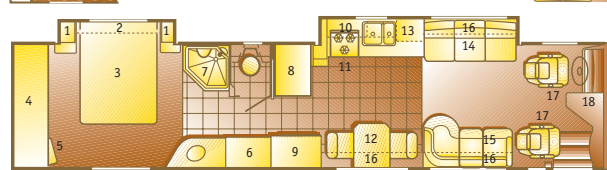

#### COCKPIT OPTIONS

Flexsteel® Leather Driver/Pass Seats w/Power Driver Seat w/Manual Lumbar

#### GALLEY OPTIONS

Facing Dinette

Norcold® 4-Door Fridge w/Ice-Maker

Flexsteel® Leather Love Seat

Flexsteel® Leather Easy Bed

Flexsteel® Leather J-Love Seat

#### LIVING AREA OPTIONS

## 40ThS

### Standard Features

- |                                  |  |
|----------------------------------|--|
| 1. Nightstand w/Overhead         | 11. 3 Burner w/Oven  |
| 2. Speaker Sofit w/Lighting      | 12. Galley Overhead  |
| 3. Queen Bed 60" x 80" Slide-out | 13. Table w/Flexsteel® Fabric Chairs                       |
| 4. Rear Wardrobe                 | 14. Flexsteel® Fabric Easy Bed                             |
| 5. 20" Rear TV                   | 15. Flexsteel® Fabric J-Love Seat                          |
| 6. Washer/Dryer                  | 16. Flexsteel® Fabric Driver/Passenger w/Power Driver Seat |
| 7. Shower                        | 17. 27" Front TV in Overhead                               |
| 8. Pantry                        | 18. Overhead Storage                                       |
| 9. Side-By-Side Ref. w/Ice-Maker |  |
| 10. Microwave                    |  |

Desk w/Flexsteel® Leather Recliner/Easy Bed

#### LIVING AREA OPTIONS

Flexsteel® Leather Recliner w/Table



Flexsteel® Leather Easy Bed, Leather Love Seat, Leather Driver/Pass Seats w/Lumbar

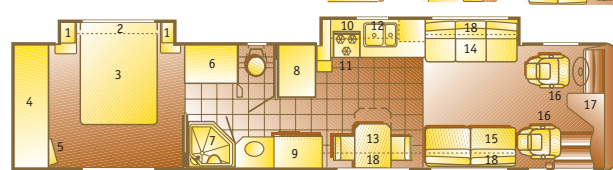

#### COCKPIT OPTIONS

Flexsteel® Leather Driver/Pass Seats w/Power Driver Seat w/Manual Lumbar

Shirtward w/Drwns



#### BEDROOM OPTIONS

Facing Dinette

Norcold® 4-Door Fridge w/Ice-Maker

Recessed Cooktop

Flexsteel® Leather Love Seat

Flexsteel® Leather Easy Bed

Flexsteel® Leather J-Love Seat

#### LIVING AREA OPTIONS

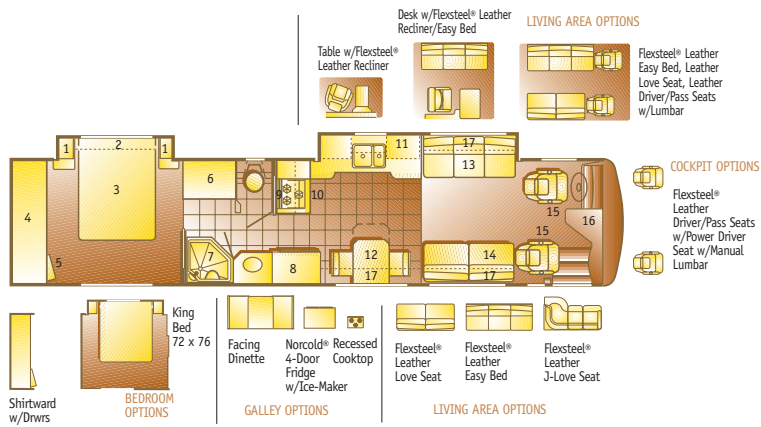

## 40TuS

### Standard Features

1. Nightstand w/Overhead
2. Speaker Soft w/Lighting
3. Queen Bed 60" x 80" Slide-out
4. Rear Wardrobe
5. 20" Rear TV
6. Washer/Dryer
7. Shower
8. Side-By-Side Ref. w/Ice-Maker
9. Microwave
10. 3 Burner w/Oven
11. Galley Overhead
12. Table w/Flexsteel® Fabric Chairs
13. Flexsteel® Fabric Easy Bed
14. Flexsteel® Fabric J-Love Seat
15. Flexsteel® Fabric Driver/Passenger w/Power Driver Seat
16. 27" Front TV in Overhead
17. Overhead Storage

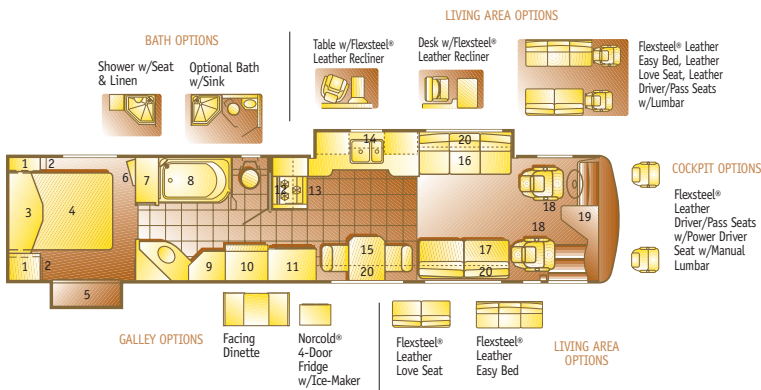

## 40TdS

### Standard Features

1. Shirt Ward
2. Nightstand
3. Rear Overhead Storage
4. Offset Queen Bed 60" x 80"
5. Wardrobe Slide-out
6. 20" Rear TV
7. Storage Drawers
8. Shower/Tub
9. Wardrobe
10. Washer/Dryer
11. Side-By-Side Ref. w/Ice-Maker
12. Microwave
13. 3 Burner w/Oven
14. Galley Overhead
15. Table w/Flexsteel® Fabric Chairs
16. Flexsteel® Fabric Easy Bed
17. Flexsteel® Fabric Love Seat
18. Flexsteel® Fabric Driver/Passenger w/Power Driver Seat
19. 27" Front TV in Overhead
20. Overhead Storage

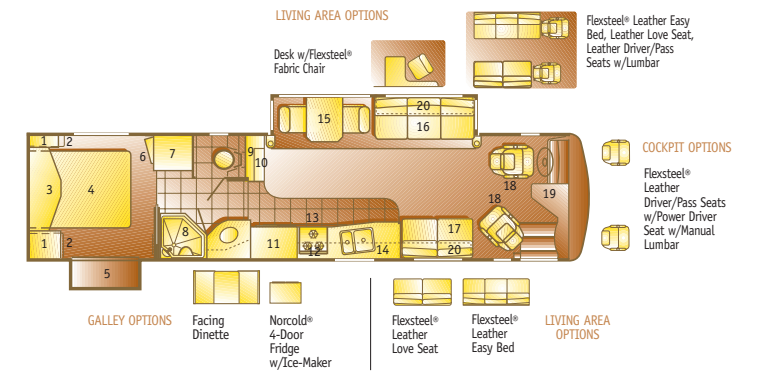

## 40TRS

### Standard Features

1. Shirt Ward
2. Nightstand
3. Rear Overhead Storage
4. Offset Queen Bed 60" x 80"
5. Wardrobe Slide-out
6. 20" Rear TV
7. Wardrobe w/Washer Cabinet
8. Shower
9. Linen Cabinet
10. Pantry
11. Side-By-Side Ref. w/Ice-Maker
12. Microwave
13. 3 Burner w/Oven
14. Galley Overhead
15. Table w/Flexsteel® Fabric Chairs
16. Flexsteel® Fabric Easy Bed
17. Flexsteel® Fabric Love Seat
18. Flexsteel® Fabric Driver/Passenger w/Power Driver Seat
19. 27" Front TV in Overhead
20. Overhead Storage

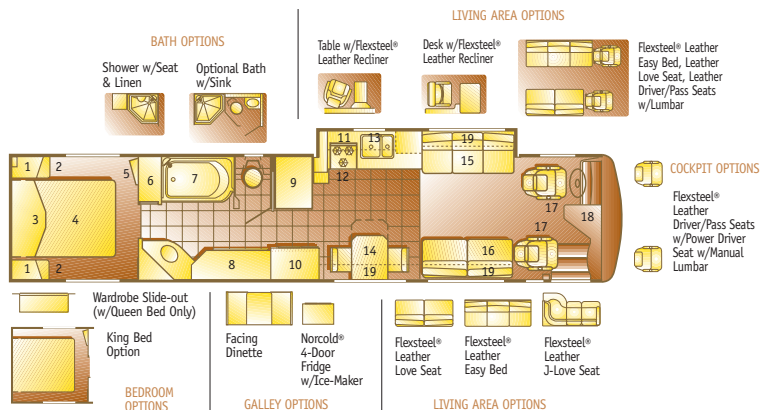

## 40TvS

### Standard Features

1. Shirt Ward
2. Nightstand
3. Rear Overhead Storage
4. Queen Bed 60" x 80"
5. 20" Rear TV
6. Storage Drawers
7. Shower/Tub
8. Wardrobe
9. Pantry/Washer/Dryer
10. Side-By-Side Ref. w/Ice-Maker
11. Microwave
12. 3 Burner w/Oven
13. Galley Overhead
14. Table w/Flexsteel® Fabric Chairs
15. Flexsteel® Fabric Easy Bed
16. Flexsteel® Fabric Love Seat
17. Flexsteel® Fabric Driver/Passenger w/Power Driver Seat
18. 27" Front TV in Overhead
19. Overhead Storage

# STANDARD & OPTIONAL FEATURES

## AUTOMOTIVE

- S Engine - Cummins® C.8.3 Liter, 315 hp ISC Diesel
- S Transmission - Allison® 3000 MH, 6-Speed Automatic
- S Spartan® Mountain Master Chassis
- S Independent Front Suspension
- S Bus Style 50" Large Windshield
- S Intermittent Wipers
- S Tilt/Telescoping Steering Wheel
- S Double Swivel Visors
- S Back Lighted Instrument Panel
- S Driver/Passenger Wood Drink Tray
- S (4) 6V House Batteries on Slide-out Tray, 440 Amp
- S (2) 12V Chassis Batteries - 2000 CCA
- S Electronic Battery Control Center
- S Undercoating
- S (4) Cast Aluminum Wheels
- S Battery Disconnect Switches
- S Denso Climate Control System
- S Trailer Hitch Receiver 10,000 Lb. Capacity
- S Cruise Control
- S Auxiliary Start Circuit
- S Auxiliary Fog Lights
- S Radial Tires
- S Tire Pressure Check Gauge
- S 3-Point Leveling Jacks
- S Flexsteel® Fabric Driver/Passenger Seats w/Manual Lumbar/6-Way Power Driver Seat
- S Sony® Rear Vision System with One-Way Audio
- S Sony® AM/FM Cassette/CD
- S CB Radio Ready
- S White "Bus-Like" Heated Mirrors with Remote Adjustments
- S Mud Flaps
- S Utility Light - Front & Rear
- S Air Horns
- S I.C.C. Light Switch
- S Anti-Lock Braking System (ABS)
- S Full Air Brakes with Automatic Slack Adjusters
- S Air Ride Suspension with Bilstein® Shocks
- S Pneumatic Pop-up Stepwell Cover
- S Pac® Brake
- S Architectural Dash with Large Analog Gauges
- S Power Driver Window
- O V.I.P. Delivery
- O Flexsteel® Leather Driver/Passenger Seats w/Manual Lumbar/6-Way Power Driver Seat
- O Sony® 10 Pack Disc Player
- O Hand-Held CB
- O Manual Air Dump Override Switch

## STRUCTURAL

- S Stacked Rail Chassis Frame
- S Hand Laid Fiberglass Exterior Sidewalls
- S Steel Reinforced Vacubond Sidewall, Roof & Floor Construction
- S Steel Outriggers on Chassis
- S Heated Water & Holding Tank Compartments
- S Vacubond Insulated Storage Area

## EXTERIOR

- S Domed Rubber Roof with Radius Corners
- S Exterior Rinse Hose
- S Full Fiberglass Front & Rear Caps
- S Fiberglass Front Fascia
- S Fiberglass Front & Rear Quarter Panels
- S Porch Light
- S Halogen Headlamps
- S 40 Gallon LPG Tank (40TDS, 40TVS, 40TQS, 40TKS, 40THS, 40TUS)
- S 30 Gallon LPG Tank (40TMS, 37TRS)
- S Exterior Graphics (4 Colors)
- S Patio Awning 20'
- S 10' RS Living Area Awning (40TVS, 40TKS)
- S 12' RS Living Area Awning (40TDS, 40TMS, 37TRS, 40TQS)

- S 5' RS/DS Bedroom Area Awning (2) (40TMS, 40TVS, 40TKS, 40TQS)
- S 5' RS Bedroom Awning (40TDS, 37TRS)
- S Power Single Entry Step
- S 31" Front Entry Door with Dead Bolt & Pneumatic (Air) Lock
- S Entry Assist Handles
- S Exterior Flip-Up Storage Doors
- S Luggage Compartment Lights
- S Protective Bra Cover
- S Front & Rear Docking Lights
- S Awning/Drip Rail Molding (37TRS, 40TDS)
- S Dual Pane Windows w/Screens
- S Park Telephone Ready
- S Patio Receptacle
- S San-T-Flush on Black Tank
- O Two-Piece Ladder
- O Solar Charging Panel
- O Keyless Entry
- O 54" Compartment Slide-Out Storage Tray
- O 12' D/S Awning (40TDS, 40TVS, 40TKS, 40TQS)
- O 9' D/S Awning (40TMS, 37TRS)

## APPLIANCES

- S (2) 13.5 M Low Profile Roof Air Conditioner
- S Onan® 7.5 kw Quiet Diesel Generator
- S Front Slide-out Manual
- S Dual Furnaces w/Thermostat & Auto Ignition, 20M/34M BTU (37TRS)
- S Dual Furnaces w/Thermostat & Auto Ignition, 34M BTU Each (40TDS, 40TMS, 40TKS, 40TQS, 40TVS)
- S Dometic® 120V/LPG Electric Side-By-Side Refrigerator w/Ice Maker
- S Recessed 3 Burner Range with Oven & Corian® Cover
- S Microwave/Convection Oven w/Built-In Range Hood
- S Water Filter
- S TV Antenna with Jack
- S Washer/Dryer
- S 27" Stereo Color TV (Front) w/Remote
- S 20" Stereo Color TV (Rear) with Remote
- S VHS - VCR (Stereo)
- S Heart Interface® Source Manager 20 - 2000 Watt Continuous Inverter, 100 Amp Converter, Intelligent Transfer Switching
- S Link 1001 Battery Monitor
- S Multi-Point Water Pump Switching
- S Residential China Bowl Toilet with Flush
- S 10 Gallon Water Heater 120V/LPG
- S Smoke Detector/Alarm
- S Fire Extinguisher
- S LPG Leak Detector/Alarm
- S Carbon Monoxide Detector/Alarm
- S 50 Amp Power Cord
- S Continuous Ducted Ceiling A/C
- S Water Heater By-Pass
- O Auto Gen Start
- O Norcold® 120V/LPG 4-Door Refer w/Ice Maker
- O Recessed 3 Burner Range with Corian® Cover
- O DVD Player
- O Heart Interface® Source Manager 25 - 2500 Watt Continuous Inverter, 130 Amp Converter, Intelligent Transfer Switching

## GALLEY

- S Corian® Sink Covers
- S Corian® Galley Top
- S Extra Large Stainless Steel Kitchen Sink, Double Bowl
- S Single Lever Galley Faucet
- S Ceramic Tile Flooring
- S Wood Refrigerator Door Inserts
- S Corian® Dinette Table with Extension & 4 Chairs
- S Pantry with Adjustable Shelves (40TKS, 40TVS, 40THS)
- S 120 Volt Outlet & Telephone Jack at Dinette
- S Electric Slide-Out
- O Nuheat Heated Tile Floor
- O Booth Dinette

## BATH

- S Corian® Lavy Top w/Porcelain Bowl & Moen® Faucet
- S Deluxe Medicine Cabinet
- S Deluxe Fiberglass Tub/Shower Enclosure w/Caddy (40TDS, 40TVS)
- S Deluxe Fiberglass Shower w/Fold-Down Seat (37TRS, 40TMS, 40TKS, 40TQS)
- S Ceramic Tile Flooring
- S Skylight in Shower
- S Power Bath Vent
- S Residential Size Sink
- S Glass Shower Door
- S Moen® Hand Held Shower Head
- O Obscure Glass in Shower
- O Deluxe Fiberglass Shower w/Fold-Down Seat (40TDS, 40TVS)
- O Enlarged Water Closet w/Second Corian® Sink, Deluxe Fiberglass Shower w/Fold-Down Seat (40TDS, 40TVS)
- O Nuheat Heated Tile Floor
- O Shirt Wards with Drawers (40TVS)
- O Full Wardrobe with Drawers (40TVS)

## BEDROOM

- S Restonic® Reversible Pillowtop Mattress w/Soft & Firm Sides
- S 60" x 80" Queen Bed
- S Comforter with Shams & Throw Pillows (2)
- S Day/Night Pleated Shades
- S Electric Wardrobe Slide-Out (40TDS, 37TRS)
- S Corian® Nightstand Tops
- O King Bed (40TVS)
- O Electric Wardrobe Slide-Out (40TVS)

## INTERIOR

- S TV Antenna
- S Monitor Panel
- S Alpine Oak, Walnut, Cherry or Clear White Maple Cabinetry
- S Wood Drawers
- S Beveled Glass Mirrors
- S Cedar-Lined Wardrobe
- S Wardrobe Light
- S Custom Decors (4 Interiors)
- S Wall-To-Wall Carpet (Bedroom & Living Areas)
- S Mini-Blinds
- S Sofa Pillows (2)
- S Roller Guide Drawer Slides with Ship Locks
- S Indirect Lighting
- S Fluorescent Lighting
- S Decor Lighting
- S 70" Fabric Love Seat by Flexsteel® (40TDS, 40TVS)
- S 72" Fabric Easy Bed Sofa by Flexsteel® w/1 Drawer (40TDS, 40TVS)
- S 54" Fabric Love Seat by Flexsteel® (37TRS)
- S 74" Fabric Easy Bed by Flexsteel® w/1 Drawer (37TRS)
- O 74" Leather Easy Bed by Flexsteel® w/1 Drawer (37TRS)
- O Flexsteel® Leather Living Room — Easy Bed, Love Seat, Driver/Passenger Seats w/Manual Lumbar
- O Computer Desk w/Flexsteel® Leather Recliner/ (40TDS, 40TVS, 40TKS, 40TQS)
- O Laptop Desk w/Flexsteel® Fabric Chair (37TRS, 40TMS)
- O Flexsteel® Leather Recliner w/Table (40TDS, 40TVS)
- O Flexsteel Leather J-Love seat (40TDS, 40TVS)
- O Day/Night Pleated Shades (Living Area & Dinette)
- O 70" Leather Love Seat by Flexsteel® (40TDS, 40TVS)
- O 72" Leather Easy Bed Sofa by Flexsteel® w/1 Drawer (40TDS, 40TVS)
- O 54" Leather Love Seat by Flexsteel® (37TRS)

## DIMENSIONS & CAPACITIES

### WEIGHTS (POUNDS)

	40 TMS	40 TQS	40 TKS	37 TRS	40 TDS	40 TVS	40 THS	40 TUS
GVWR (Note #1)	31,000	31,000	31,000	31,000	31,000	31,000	31,000	31,000
GCWR (Note #4)	41,000	41,000	41,000	41,000	41,000	41,000	41,000	41,000
GAWR (front) #2	12,000	12,000	12,000	12,000	12,000	12,000	12,000	12,000
GAWR (rear) #2	19,000	19,000	19,000	19,000	19,000	19,000	19,000	19,000
UVW (Note #3)	26,600	27,500	27,300	26,000	27,100	26,900	27,300	27,500

Hitch Rating 5,000 lb, Maximum Tongue Weight is 500 lb with weight carrying hitch head  
Hitch Rating 10,000 lb, Maximum Tongue Weight is 1,000 lb with weight distributing hitch head

### MEASUREMENTS

	40 TMS	40 TQS	40 TKS	37 TRS	40 TDS	40 TVS	40 THS	40 TUS
Wheelbase	266"	266"	266"	230"	266"	266"	266"	266"
Overall Length (Note #5)	40'	40'	40'	36' 10"	40'	40'	40'	40'
Overall Height w/AC	12' 2"	12' 2"	12' 2"	12' 2"	12' 2"	12' 2"	12' 2"	12' 2"
Interior Height (max.)	82"	82"	82"	82"	82"	82"	82"	82"
Interior Width (max.)	96"	96"	96"	96"	96"	96"	96"	96"
Exterior Width (max.) #6	101.5"	101.5"	101.5"	101.5"	101.5"	101.5"	101.5"	101.5"

Note #1: GVWR (Gross Vehicle Weight Rating): Means the maximum permissible loaded weight of the motor home. The GVWR is equal to or greater than the sum of the unloaded vehicle weight plus the net carrying capacity.

Note #2: GAWR (Gross Axle Weight Rating): Means the maximum permissible loaded weight a specific axle is designed to carry.

Note #3: UVW (Unloaded Vehicle Weight): Means the weight of a motor home as manufactured at the factory with full fuel, engine oil and coolants. The above UVW's represent a motor home with typical options. UVW will vary significantly based on option selection.

Note #4: GCWR (Gross Combined Weight Rating): Means the value specified by the motor home manufacturer as the maximum allowable loaded weight of this motor home with its towed vehicle. Towing and braking capacities may differ. Refer to Fleetwood and chassis manufacturer manuals for complete information.

Note #5: Length taken from front bumper to rear bumper.

Note #6: Excludes safety equipment and awnings.

Note #7: Tank Manufacturer's listed water capacity (WC). Actual LPG capacity is 80% of water listing as required by the safety code.

### TANK & LIQUID CAPACITIES (GALLONS)

	40 TMS	40 TQS	40 TKS	37 TRS	40 TDS	40 TVS	40 THS	40 TUS
Grey Water Tank	48	60	60	48	60	60	60	60
(Waste) Black Water Tank	48	40	40	48	40	40	40	40
Fresh Water Tank	85	95	95	85	95	95	95	95
L.P. Tank (Note #7)	32.5	50.4	50.4	38.5	50.4	50.4	50.4	50.4
Water Heater	10	10	10	10	10	10	10	10
Fuel Tank w/Dual Side Fills	125	125	125	125	125	125	125	125

Note: Water weighs 8.3 lb/gal, LPG weighs 4.5 lb/gal, Diesel Fuel weighs 7.0 lb/gal

### CHASSIS

Frame	Spartan® Mountain Master Stacked Rail
Engine	Cummins® C.8.3L/315 hp ISC
Torque	950 @ 1300 RPM
Cubic Inch	504.5
Transmission	Allison® 3000 MH, 6-Speed World w/Electronic Shifter
Alternator Amps	200 Amp Leece Neville
Tires	275/80 R22.5 LRH Low Profile Highway Radial



Fleetwood Motorhomes of Indiana, Inc. • Plant #44 • 1031 U.S. 224 East • Decatur, Indiana 46733-5006 • (219) 728-2121 (800) 648-6582

PLEASE READ: Product information and photography included in this brochure were as accurate as possible at the time of publication. For the most current product information and changes, please visit our website at [www.fleetwood.com](http://www.fleetwood.com) or contact your local Fleetwood dealer. Subsequent refinements may be evident in the actual product. Prices and specifications are subject to change without notice. All weights, fuel, liquid capacities and dimensions are approximate. Fleetwood has designed its recreational vehicles to provide a variety of uses for its customers. Each vehicle features optimal seating, sleeping, storage and fluid capacities. The user is responsible for selecting the proper combination of loads to ensure that the recreational vehicle's capacities are not exceeded.

**FLEETWOOD® RV**