

Kountry Star Diesel Pushers



PO Box 30 • Nappanee, IN 46550-0030
219/773-7791 FAX 219/773-2895

Newmar's newest Kountry Star motorhome is America's only diesel pusher that can be ordered either with or without a 12-foot-long power slideout section.

Built on a Spartan chassis with a 250-hp turbo-charged Cummins diesel engine, the all-new Kountry Star offers an ideal blend of interior spaciousness, overall beauty and topnotch road performance -- all for the surprisingly low base price of \$122,380.

Compare the Kountry Star with other motorhomes, and we think you'll agree it is the best value in diesel pushers today!



1992 KOUNTRY STAR DIESEL PUSHER

Specifications

MODELS:

- 38WDSK-SS
- 38CBSA-SS

POWER PLANT:

- Cummins 6CTA8.3 engine
- Turbo-charged, intercooled
- 250 hp @2400 rpm
- 660 ft. lbs. of torque @1700 rpm
- Allison MT-643 transmission

GENERAL SPECIFICATIONS:

- 252" wheelbase
- Tilt/telescoping steering wheel
- Dana cruise control
- 235/80R X 22.5 Michelin tires
- 160-amp alternator
- Chassis batteries (2)
- Coach battery (1)
- Self-leveling air ride
- Back-up alarm
- Gross Vehicle Weight Rating 26,000 lbs.
- Gross Combination Weight Rating 31,000 lbs.
- Unloaded weight wet, 22,300* lbs.
- Cargo capacity, 3,700* lbs.
- Concealed, locking utility hookup compartment
- Engine, generator & batteries on roller frames for convenient servicing
- 100 cu. ft. (approximate) of insulated and lighted basement storage space
- Available with driver's door and 7.5-kw Onan diesel generator (options)

CAPACITIES (approximate):

- 115 gal. fresh water
- 60 gal. black water
- 60 gal. gray water
- 100 gal. diesel fuel
- 32 gal. LP fuel

DIMENSIONS (approximate):

- Overall length 38 feet
- Overall width 96 inches
- Overall height 11 feet 8 inches (with low-profile air conditioning)
- Interior height 78 inches
- Interior width 90.5 inches

FRONT AXLE:

- Eaton EFA 12F4
- Oil-lubricated bearings
- 15 x 4 cam air brakes
- 9,000-lb. air suspension
- 4 shock absorbers

REAR AXLE:

- Eaton 1905S
- 3.73-1 gear ratio
- Oil-lubricated wheel bearings
- 16.5 X 7 cam air brakes
- 17,000-lb. air suspension



*denotes with most popular options

38WDSK-SS

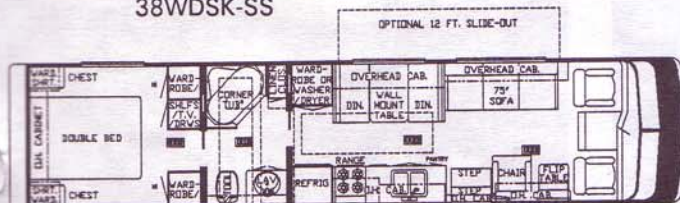

38CBSA-SS

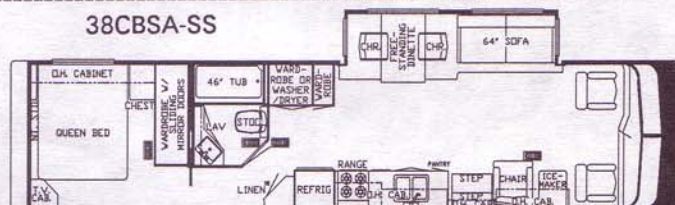

1992 KOUNTRY STAR DIESEL PUSHER

Standards and Options

Air Conditioning, Heating, LP

- O Air cond, central Penguin 13.5 BTU (1)
- O Air cond, central Penguin 13.5 (extra)
- S Furnace 31M elec ignition)
- O Furnace 35M ILO std
- S Heat, in-floor ducted
- S LP gas tank, 32 gallon

Appliances and Accessories

- S Bath accessories, brass (1 towel bar, tis hldr, 1 towel ring, 1 robe hook)
- O Blender
- S Faucet for kitchen sink, single handle
- S Faucet for shower & lavatory, double handle deluxe (brass)
- O Microwave oven (Sharp 22")
- O Microwave oven, 30" convection (Sharp) w/4-burner hot plate (as appl)
- S Microwave prep (for 22" x 15")
- S Range cover, bi-fold
- S Range hood w/light & fan
- S Range, Magic Chef 4-burner w/oven, 18" porcelain, blk glass door w/pilot
- S Refrigerator, Norcold dbl-dr 6062 2-way
- O Refrigerator, Norcold dbl-dr 6082
- O Refrigerator, Norcold dbl-dr 683 3-way
- O Safe
- S Shower, exterior hookup
- S Sink, kitchen double porcelain
- S Stool, Aqua Magic Starlite
- O Stool, china w/spray attachment
- O Tub or shower enclosure
- S Tub/shower, fiberglass
- O Washer/dryer prep w/plumbing, recept & shelf (certain models)
- O Washer/dryer, two-piece (Sears)
- O Water filtering system w/drink dispenser
- S Water heater, 6-gal gas w/elect ignition
- O Wtr htr, 10 gal gas/elect, w/reignitor
- O Water heater bypass kit

Cabinets and Furniture

- S Bed, queen (60" x 75") (where applic)
- O Cabinetry, bleached oak hardwood with raised-panel doors
- S Cabinetry, oak hardwd w/rsd panel drs
- O Chairs, folding, 2 extra (w/large slideout)
- O Countertop extension (where applic)
- S Dinette w/innersprg cushns (see layout)
- O Drawer, below fixed dinette seat (each)
- O Drawers, wood w/metal guides, rollers
- S Lifts for storage under fixed beds
- O Pull-out pantry (where applic)
- O Seat, 6-way power ILO std
- S Seat, driver/passenger swivel & recliner
- S Snack tray
- O Table, freestanding w/2 folding chairs

Chassis features

- S 1000-watt engine block heater
- S Back-up alarm
- S Brakes, power
- S Chassis - Spartan (diesel 250 hp) with radial tires & 100-gal fuel tank
- S Cruise control
- S Heater/air condit, high-output deluxe
- S Intermittent wipers
- S Power steering
- S Steering wheel, tilt & telescope
- S Tinted windshield
- S Transmission cooler

Electrical & Lighting Equipment

- S Battery, 115-amp Sears Die Hard deep cycle
- O Battery, 115-amp sears Die Hard deep cycle, extra
- O Battery disconnect
- O CB radio with antenna
- S Converter, 30 amp w/charger
- O Converter, 40 amp w/charger
- S Electrical service, 30 amp
- O Electrical service, 50 amp
- O Electrical service prep for 50 amps
- O Flexible cord for 50-amp service
- O Gen, 7.5-kw Onan w/2 remote switches & auto changeover (diesel)
- O Horn (air)
- O Inverter
- O Light, exterior security (choose location)
- O Light, remote-controlled (on roof, spot & flood)
- O Lighting, fluorescent recessed in ceiling
- O Lights, docking (recessed)
- O Lights, fog
- S Monitor panel
- S Recept, 110V GFI (interior & exterior)
- S Stereo, AM/FM cassette, clock
- S Switch for emergency engine start
- S TV antenna w/power booster & 2 jacks
- S TV cable hookup
- O TV, color 9" AC/DC w/remote control
- S TV, color 13" AC w/remote control
- O TV jack, exterior on door side
- O TV jack w/splitter (extra) select location
- O TV monitor, closed-circuit rear view & backup lights
- O TV satellite dish, 6' with decoder
- O TV video switch
- O Telephone jack, interior (select location)
- O VCR
- O VCR prep (where applic)

Exterior Features

- S Exterior front & rear gelcoated fiberglass end caps
- S Exterior sides, gelcoated fiberglass
- O Mirrors, exterior w/convex & defrost
- O Mirrors, exterior w/convex, remote control, defrost & turn signal
- O Roof rack & ladder
- S Roof, rubber
- O Slide out, 12' w/built-in dinette (if appl)
- O Slide out, 12' w/2 folding chairs
- S Step, 12-volt w/non-skid surface
- S Step, fold-down in front bumper

Interior Features

- S Bedspread, quilted w/reversed shams & accent pillow (1 queen or 1 pr twins)
- S Ceiling, woven soft touch
- O Countertop, ceramic tile
- S Decorative clock
- S Floor covering, carpet w/deluxe pad throughout
- O Floor covering, vinyl in kitchen area
- O Floor covering, hrwd parquet in kitchen
- S Sink covers (2)
- O Window trtmnt, day/night shades ILO std (liv, din & bdrm)
- S Window trtmnt, mini blinds (kitch, bath)
- S Window trtmnt, textured mini blinds & lambrquins

Safety Features

- O Customer pick up
- O LP leak detector
- O Security system
- O State seal

Option Packages

PACKAGE I, PREFERRED EQUIPMENT

- Air horns
- Automatic hydraulic leveling jacks
- Central A/C (two 13.5 Penguin)
- Elect service, 50 amps, flex cord
- Generator, 7.5-kw Onan diesel

PACKAGE J, PREFERRED EQUIPMENT

- 6082 Norcold refrigerator
- Driver's seat, 6-way power
- Exterior mirrors, remote/defrost
- Lights, fluorescent in ceiling
- Microwave/convection w/4-burner
- Parquet floor in kitchen
- Skylight in bathroom
- Tub enclosure
- VCR
- Wtr htr, 10-gal gas/elec/reignitor
- Window day/night soft shades

PACKAGE K, PREFERRED EQUIPMENT

- Battery disconnect
- China stool w/spray attachment
- Converter, 40 amp w/charger
- Dark tinted windows
- Docking lights
- Door bell
- Extra battery
- Fog lights
- Hitch w/wire connector
- LP leak detector
- Pull-out pantry
- Rear view monitor w/backup lights
- Roof rack & ladder
- Water filter w/drink dispenser

Pumping Systems

- O Heat pads for holding tanks, 110V
- S Sewage holding tank rinse
- S Sewage hose holder
- S Tank, gray water, 60 gal (approx)
- S Tank, sewage hldng, 60 gal (approx)
- S Water capacity, 115 gal (approx)
- S Water hose w/auto rewind, city hookup
- S Water system, demand w/12V pump & 5/8" polybutylene lines

Running Gear & Construction

- O Hitch for towing car, w/wire connector
- S Insul, R5 fiberglass, sides, walls & roof
- O Insul, Polar Pak (R7 sides/flr, R10 roof)
- O Jacks, hydraulic leveling, auto controls
- S Mud flaps (front and rear)
- S Shock absorbers
- S Structure, aluminum sides/roof
- S Suspension, self-leveling air ride
- S Undercoating
- S Wheels, polished aluminum

Windows doors awnings-vents

- O Awning for windows, matching side awning (A & E 8500) each
- O Awning for windows, matching side awning (A & E 9000) each
- O Awning, side (A & E 8500)
- O Awning, side (A & E 9000)
- O Awning tension rafter for side awning
- O Door bell
- O Door, driver's side w/power window & passenger side panel
- O Skylight in bathroom w/soft shade
- O Vent, 12V Fantastic 3-spd w/power opener (choose location)
- S Vent, 12V in bath area w/wall switch
- O Vent, 12V in ceiling w/wall switch (choose location)
- O Window, radius dark tint ILO std
- S Windows, radius slider safety glass



"With the rooms slid out, the interior opens up like that of a fifth-wheel trailer. The broad sweep of space up front is impressive and does a lot to reduce any closed-in feeling..."

MotorHome magazine

"...I predict that Newmar has unveiled a true winner. Not only for themselves, but also for their customers who choose to buy one."

Don Magary

Family Motor Coaching

Thank you for your interest in Newmar Corporation's new Kountry Star diesel pusher motorhome. We are very proud of it, just as we are proud of all the other motorhomes, the fifth-wheels and the travel trailers that we build.

Through our nationwide network of dealers, we sell RV products that are designed and built for many years of over-the-road-use. Please spend a few minutes at one of those dealerships and examine our coaches carefully. We know you will be pleased by what you see.

For the name and address of the Kountry Star dealership nearest your home, and for the latest color literature about our full range of Class A motorhomes, please write to the address below.



355 N DELAWARE ST
P O BOX 30
NAPPANEE IN 46550-0030
(219) 773-7791 FAX (219) 773-2895