

MONTE VISTA

High Profile Fifth Wheels

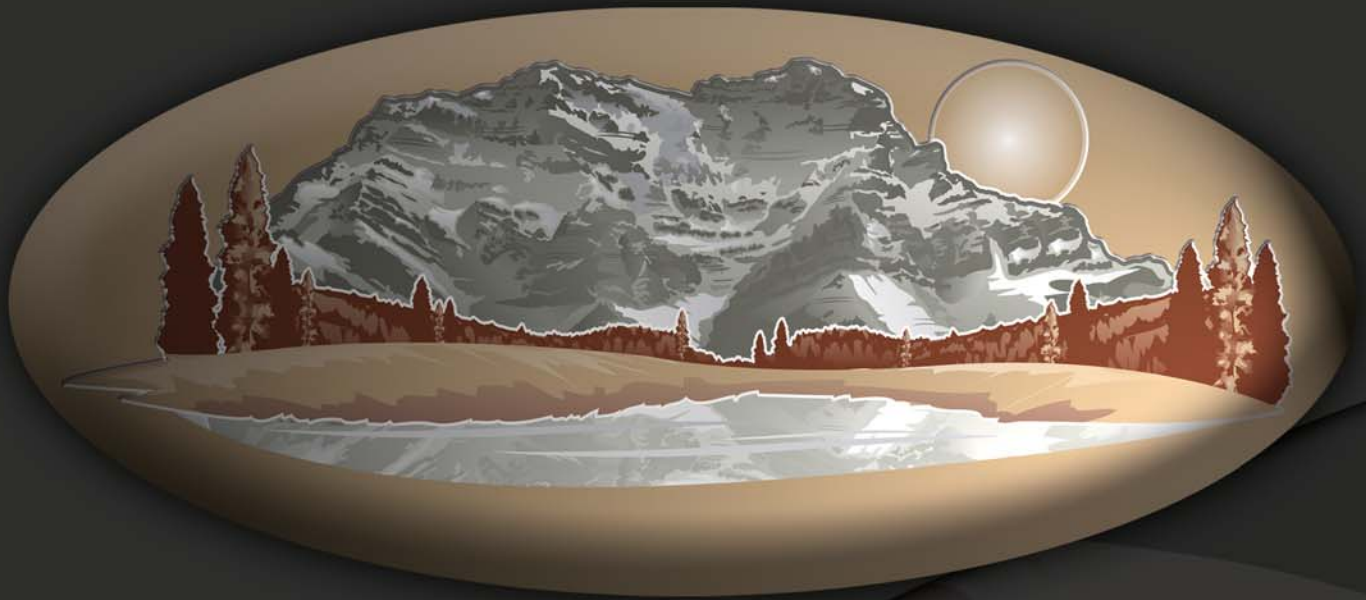

Premium Features - Residential Design - Affordable Luxury



Monte Vista

Residential design and premium features place Monte Vista in a class by itself. Solid hardwood cabinet doors and frames, 12 gallon water heater, home theater system, premium lighting, large appliances and designer bath and kitchen fixtures are just a few of the traits that make Monte Vista the right choice for you and your family.



*Surround yourself in
luxury and style.*





Beautiful Bath and Bedroom Suites

Monte Vista's magnificent master bedroom suite was meticulously designed for comfort and versatility. The bathroom features a two-piece marbled, neo-angle shower with a rain-glass door.

Monte Vista Premium Construction

MOR/ryde System



The MOR/ryde RE system works with the existing leaf springs and axles, but replaces the steel leaf spring equalizer. It isolates and absorbs road shock and increases the dynamic travel of the leaf spring suspension.

The MOR/ryde RE system provides better protection of your trailer with up to a 30% improvement in the dampening of road shock. Reduced road travel shock means less wear and tear on your trailer's components. Monte Vista and MOR/ryde - you will feel the difference.

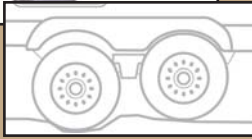

MOR/ryde System

RI4, 5-Layer Roof Construction

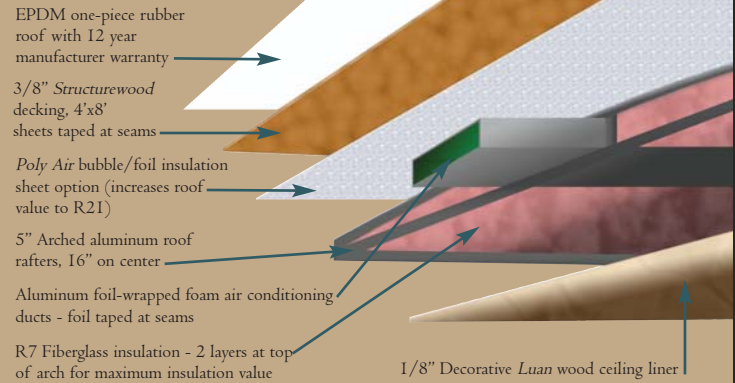

Hardwood Cabinet Stiles



Monte Vista features solid ash hardwood cabinet doors and solid ash cabinet stiles (frames). The hardwood stiles are screwed together and are stained to match the doors. Hardwood doors and stiles will retain their factory new appearance for years of durable use.

Most competitors use vinyl-wrapped MDF fiberboard doors and stapled vinyl-wrapped stiles.

Premium Laminated Wall Construction

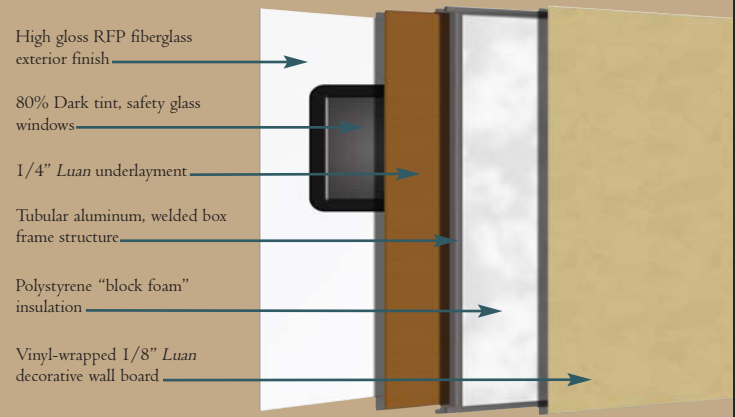

6-Way Welded Aluminum Cage Construction

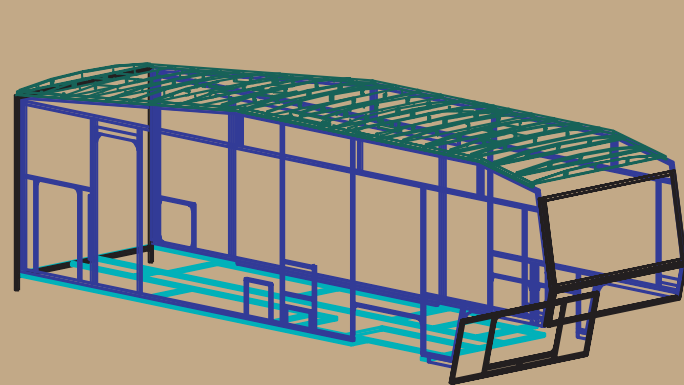

Laminated Floor Construction

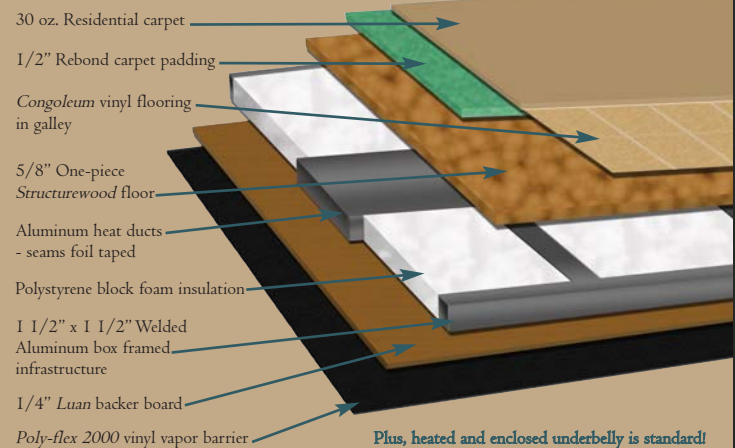

Insulation "R" Values

Roof	RI4
Sidewalls	R9
Floor	RI7
Front/Rear Wall	R9

Heated/Enclosed & Insulated Underbelly

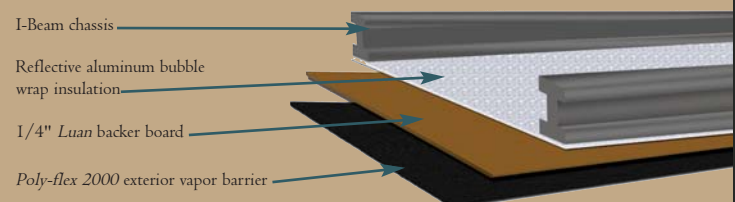

Monte Vista Premium Floorplans

31BG-MV

Length	35 ft.
Exterior Width	8 ft.
Exterior Height	12 ft. 2 in.
Hitch Dry Weight	1990 lbs.
Gross Vehicle Weight	14,400 lbs.
Unloaded Vehicle Weight	10,239 lbs.
Net Cargo Capacity	4161 lbs.
Fresh Water Capacity	46 gal.
Grey Water Capacity	66/33 gal.
Black Water Capacity	42 gal.
Tire Size	ST235/80R16(E)
Furnace Size (BTU's)	35,000
Water Heater	12 gal.
Awning Length	15 ft.

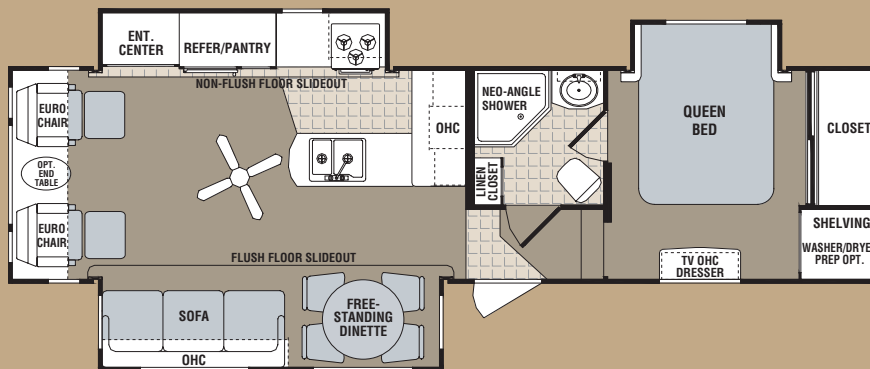

33RE-MV

Length	36 ft. 6 in.
Exterior Width	8 ft.
Exterior Height	12 ft. 2 in.
Hitch Dry Weight	1843 lbs.
Gross Vehicle Weight	14,400 lbs.
Unloaded Vehicle Weight	10,606 lbs.
Net Cargo Capacity	3794 lbs.
Fresh Water Capacity	46 gal.
Grey Water Capacity	33/66 gal.
Black Water Capacity	75 gal.
Tire Size	ST235/80R16(E)
Furnace Size (BTU's)	35,000
Water Heater	12 gal.
Awning Length	16 ft.

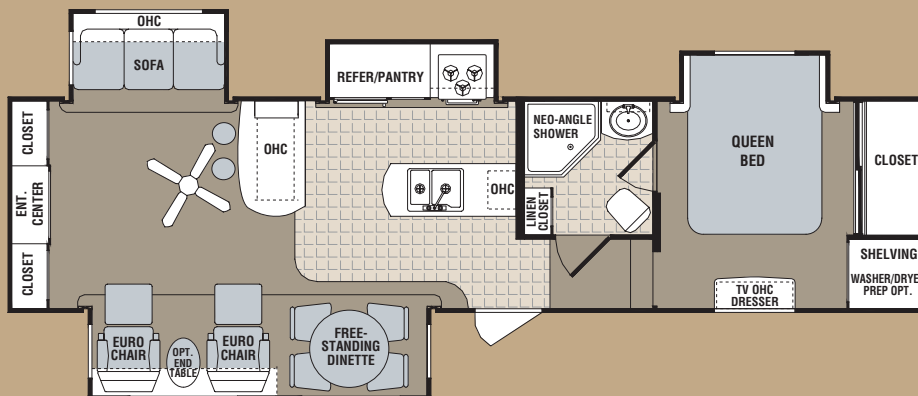

33RL-MV

Length	36 ft. 5 in.
Exterior Width	8 ft.
Exterior Height	12 ft. 2 in.
Hitch Dry Weight	1974 lbs.
Gross Vehicle Weight	14,400 lbs.
Unloaded Vehicle Weight	10,174 lbs.
Net Cargo Capacity	4227 lbs.
Fresh Water Capacity	46 gal.
Grey Water Capacity	42/42/33 gal.
Black Water Capacity	42 gal.
Tire Size	ST235/80R16(E)
Furnace Size (BTU's)	35,000
Water Heater	12 gal.
Awning Length	16 ft.

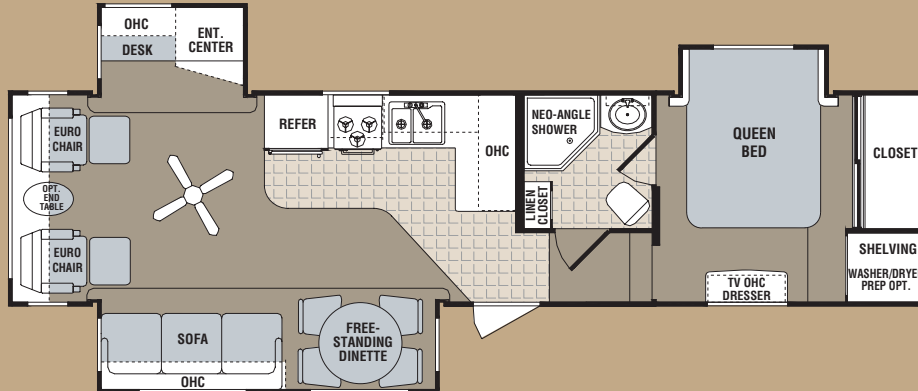

34QL-MV

Length	NA
Exterior Width	8 ft.
Exterior Height	NA
Hitch Dry Weight	NA
Gross Vehicle Weight	NA
Unloaded Vehicle Weight	NA
Net Cargo Capacity	NA
Fresh Water Capacity	NA
Grey Water Capacity	NA
Black Water Capacity	NA
Tire Size	ST235/80R16(E)
Furnace Size (BTU's)	35,000
Water Heater	12 gal.
Awning Length	NA

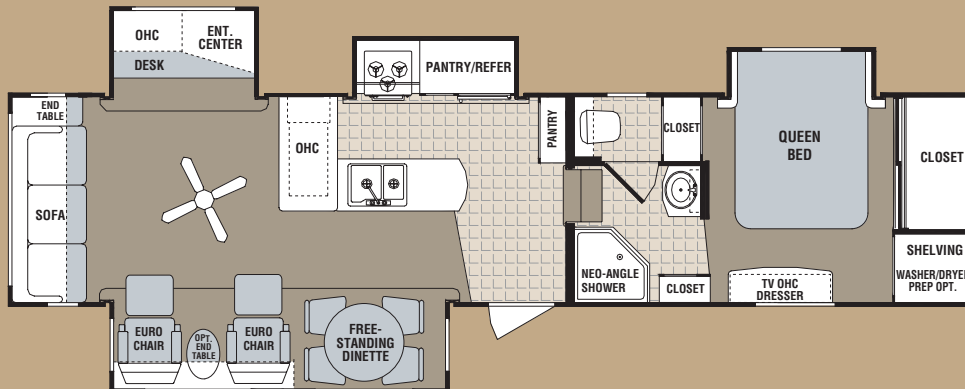

Vehicle loading - Every effort has been made to provide the greatest number of options for the recreational vehicle owner. Along with these choices comes the responsibility to manage the loads that are imposed by the choices that they remain within the manufacturer's specified chassis weight limits. Do not overload the recreational vehicle. Some optional equipment not included. Net carrying capacity (NCC) is determined by subtracting unloaded vehicle weight (UVW) from gross vehicle weight (GVWR) and includes fluids, options and cargo. Liquid capacities and weights are approximations only. Warning - This information is intended as a guide only. Weights of individual vehicles may vary. Consult your owner's manual for complete loading, weighing and towing instructions. *UVW and Hitch Dry Weight are base weights of units without options. Each unit includes a weight label which lists specific weight information for that unit. Product information, specifications, and photography in this brochure were as accurate as possible at time of printing. Photographs may contain some features that are optional on your vehicle. Since we continually strive to improve our products, actual products may differ. Prices and specifications are subject to change without notice. All capacities are approximate and dimensions are nominal. Some features or options may be different or unavailable in Canada. Vehicles are designed for recreational use only and not intended for use as a primary residence. All product brand names used in this brochure are registered trademarks of Thor Industries Inc. Unauthorized use of trademarks is prohibited by law.

Monte Vista Premium Floorplans

34QB-MV

Length	NA
Exterior Width	8 ft.
Exterior Height	NA
Hitch Dry Weight	NA
Gross Vehicle Weight	NA
Unloaded Vehicle Weight	NA
Net Cargo Capacity	NA
Fresh Water Capacity	46 gal.
Grey Water Capacity	NA
Black Water Capacity	NA
Tire Size	ST235/80R16(E)
Furnace Size (BTU's)	35,000
Water Heater	12 gal.
Awning Length	NA

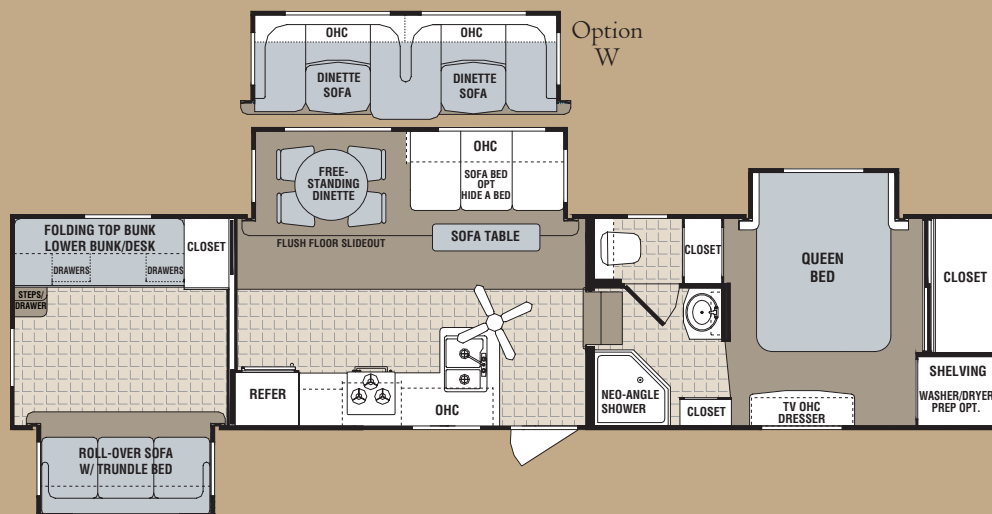

34QB-MV Rear Living Area Options

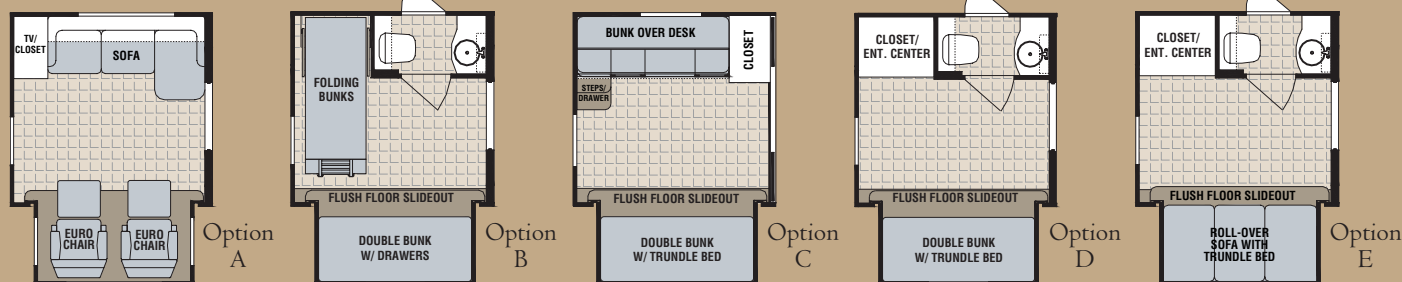

35RB-MV

Length	38 ft. 9.5 in.
Exterior Width	8 ft.
Exterior Height	12 ft. 2 in.
Hitch Dry Weight	1810 lbs.
Gross Vehicle Weight	15,500 lbs.
Unloaded Vehicle Weight	12,130 lbs.
Net Cargo Capacity	3370 lbs.
Fresh Water Capacity	46 gal.
Grey Water Capacity	42/42/33 gal.
Black Water Capacity	75 gal.
Tire Size	ST235/80R16(E)
Furnace Size (BTU's)	35,000
Water Heater	12 gal.
Awning Length	16 ft.

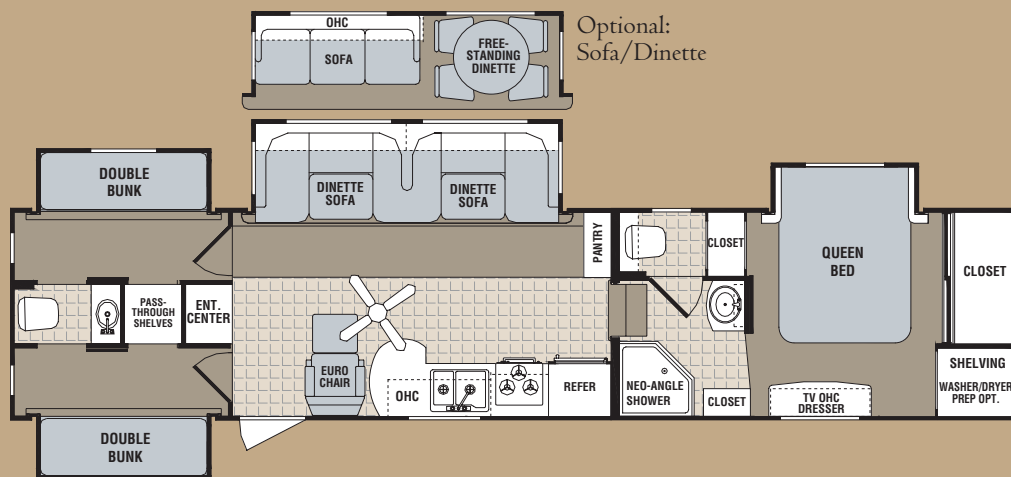

Spacious "W" Sofa/Dinette

Monte Vista's exclusive "W" sofa/dinette slide is available in the 34QB-MV and 35RB-MV floorplans to greatly expand your seating area. Both sofa/dinette's convert into beds for extra sleeping space. Don't need the extra seating? Both floorplans are available with the traditional hide-a-bed sofa and free-standing table slide room.



Monte Vista: More Standard Features - More Value

Frame/Chassis Construction

Cambered 10" Steel I-Beam Frame Rails
Powder-Coated Frame
10" Steel Crossmembers
"Ladder Design" Construction
Laser-Aligned Steel Outriggers
6000 lb. Tandem Axles (7000 lb. on 35RB) *
Leaf-Spring Suspension
MOR/ryde RE Rubber Shear Spring Equalizer**
Ultra-lube Hubs *
8 Lug Hubs
Steel Silver Rims
ST235/80R16E Tires
Electric 12.25" Drum Braking System
Electric "Worm Gear" Slide System
Flush Floor Main Slide System
Above Floor, Steel, Electric Bedroom Slide
Extended Hitch Pin
Optional: MOR/ryde Rubber Hitch Pin
Optional: Aluminum Alloy Rims

Body/Coach Construction

Sidewalls

RFP High Gloss Gel Coat Fiberglass Exterior
Laminated Construction
Aluminum-Framed, Welded Box Infrastructure
Luan Fiberglass Underlayment
Polystyrene "Block Foam" Insulation
Vinyl-Wrapped Luan Interior Wall Panel
80% Tinted, Radius Corner, "Safety Glass"
UV-Rated Windows*
3M Automotive Film Graphics
"Tuff Coat" Painted Aluminum Radius Skirt

Front & Rear Walls

Front Cap: Gel-Coat Molded Fiberglass
Rear Wall: RFP High Gloss Gel Coat Fiberglass Exterior
Aluminum Framed, Welded Box Infrastructure
Laminated Construction
1/4" Luan Wood Exterior Wall Panel
80% Tinted, Radius Corner, "Safety Glass"
UV-Rated Windows (Where Applicable)*
Polystyrene "Block Foam" Insulation
Vinyl-Wrapped Luan Interior Wall Panel

Primary Floor

3" Vacuum-Bonded, One-Piece Floor
Aluminum-Framed, Welded Box Infrastructure
Polystyrene "Block Foam" Insulation
1/4" Luan Panel
Vinyl Vapor Barrier
5/8" Structurewood One-Piece Decking

Bath/Bedroom Floor

3" Vacuum Bonded One-Piece Floor
Aluminum-Framed, Welded Box Infrastructure
Polystyrene "Block Foam" Insulation
1/4" Luan Panel
5/8" Structurewood One-Piece Decking

Sub-Floor/Underbelly

Laminated Construction-2 Piece Application
Poly-flex 2000 Exterior Vapor Barrier
Applied to .25" Luan Substrate
"Reflectex" Aluminum Bubble Wrap Insulation

Roof/Ceiling

Aluminum Roof Truss with 5" Tapered Box 3/8" Structurewood Roof Decking
R14 Roof Insulation
Aluminum Radius Roof to Wall Transition
EPDM Rubber Roof Membrane - 12 Year Warranty
Optional: R21 Roof Insulation

Storage Compartment

Aluminum Luggage Door Frames
1" Thick Luggage Door with Lock
Lighted Baggage Areas
Ozite-Lined Compartment

Windows, Doors and Awnings

80% Tinted, Radius Corner, "Safety Glass"
UV-Rated Windows*
Vented Windows
Egress Window in Bedroom
Domed, Tinted Skylight Above Shower
30" Radius Entry Door & Dead Bolt Lock Screen Door
8500 Series A&E Awning **
Raised Panel Interior Doors
Pivoting XL Entry Assist Handle
Optional: Duo-Pane Windows
Optional: Slide-out Awning Toppers

Exterior Features

Deluxe "Quick Release" Pull Pins *
Electric Front Jacks*
16" Spare Tire with Undermount Carrier Lift Kit*
Underbelly (2 piece) - Heated & Enclosed
10" Deep, Steel, Triple Entry Steps
- Welded to Frame
Lighted Entry Step
Enclosed/Vented Battery Box
Molded ABS Fender Wells
Exterior Patio Light
Exterior Hitch Light
Gravity Water Fill
Hot & Cold Shower System
Black Tank Flush System
City Water Fill with Locking Protective Door
Cable Hook-up
Phone Hook-up
Satellite Hook-up
Rear Ladder *
Attic Roof Vent *
Drip Rail Gutter System
Extended Gutter Spout

Interior Systems

Electrical Systems & Lighting

Interior Electrical Command Center
50 Amp Electrical Service
Detachable Marine-Grade Power Cord
55 Amp Converter
110v GFI Exterior Receptacle
12v Battery Converter/Charger with Overcharge Protection
Battery Box
Residential Wall Switches
12v Lighting
Decorative Wall Scones in Bedroom
Fluorescent Lighting in Galley *
Optional: Fluorescent Lighting Package Throughout

Plumbing System

12 Gallon Gas and Electric Hot Water Heater **
Quick-Connect Coiled 25 ft. Hose with Sprayer *
Shurflo Water Pump
"PEX" Polyethylene Tubing
Metal Pressure Fittings
Sewer Hose Storage System
Hot and Cold Water Low Point Drains
46 Gallon Fresh Water Tank
Grey Water Tank: See Floorplan Specs for Details
Black Water Tank: See Floorplan Specs for Details
Remote Water Heater Switch

Climate Control

35K BTU Furnace **
Forced Air Ducted Heat
Forced Air Heat in Underbelly
15K BTU Air Conditioner with Quick Cool Vent *
Ceiling Ducted AC Vents
Ceiling Fan - 42" Reversible with Halogen Light Kit*
Mold Resistant, Aluminum-Wrapped AC Plenum
Optional: 2nd AC 13.5 BTU Direct Feed in Bedroom
Optional: Fantastic Fan in Bedroom (NA with CSA, NA with 2nd AC Option)
Optional: Fantastic Fan in Galley/Main Living
Optional: 12v Tank Pads
Optional: R21 Roof Insulation
Optional: Fireplace

Cabinetry & Countertops

Drilled & Screwed Hardwood Cabinet Construction
Premium Formica Textured Countertops
Solid Ash & Stained Cabinet Stiles/Frames **
Solid Ash Raised Panel Cabinet Doors
Solid Ash Drawer Fronts
7-Ply Residential-Grade Plywood Drawer Construction
Metal Drawer Glides & Teflon Rollers
Ball-bearing Drawer Catch
Brushed Nickel Hardware
Glass Inserts with Solid Ash Frames
Above Sofa

Window Treatments

Day/Night Shades (NA in Bunk Area) **
Mini-Blinds (at Kitchen Sink Window)
Designer Hard Valance
Designer Hard-Sided Lambrequins For Privacy

Entertainment Systems

5:1 Home Theater System with Remote **
Satellite Prep *
Cable Jack
TV Antenna with Power Booster
Bedroom TV Prep
Optional: 24" Stereo TV

Galley Area

Armstrong Linoleum with "Tough Guard"
Solid Metal J-Faucet *
Sink Covers
XL Dual Basin Sink

Furniture & Appliances

Jack-Knife Sofa with Storage
Euro Chairs (2) (Where Applicable)
Free-Standing Table (Round) **
Queen-Size Mattress
8 cu.ft. Double Door Refrigerator **
Brushed Metal Refrigerator Inserts **
Exhaust Fan
Amana 3-Burner Stovetop
Range Cover - 2 Piece Metal *
Water Purifier
Interior Utility Center
Howard Miller Clock *
Optional: 10 cu.ft. Refrigerator
Optional: Hide-A-Bed Sofa
Optional: Central Vacuum System
Optional: Booth Dinette
Optional: End Table with Lamp
Optional: Second A/C

Bath Area

2-Piece Marbled Neo-Angle Shower Enclosure*
Rain-Glass Shower Walls & Door, Designed for Privacy
Brushed Nickel Shower Hardware and Wand
Large Medicine Cabinet with Lights & Mirror
Stainless Steel Vanity Sink
Residential-Style Brushed Nickel Vanity Faucet
6 Panel Privacy Door
Residential, Six-Panel Lavatory Doors with Lever Handle
Porcelain Bowl Thetford Toilet
Power Vent
Toilet Tissue Holder
Brushed Nickel Bathroom Accessories
Towel Hooks & Bar
Linen Closet

Bedroom Area

Nightstand
Chest of Drawers
Overhead Cabinet
TV Prep
Egress Window
6 Panel Privacy Door
Premium Bedspread Package & Window Coverings
Below Bed Storage
Front Wardrobe Ensemble
Sliding Mirrored Doors with Hanging Storage
Overhead Cabinet Storage
Optional: Washer/Dryer Prep

Safety Features

Fire Extinguisher
Dead-Bolt Locks on Entry Doors
120v GFI Protected Exterior Receptacle
LP Gas Detector
Smoke Detectors
Egress Windows
Safety Glass
10" Deep Entry Step *
Entry Step Light
Patio Light *
XL Folding Entry Assist Handle *
Solid Wood Exit Handle
Front, Rear & Side Amber Road Lights

* Monte Vista Convenience Package

** Monte Vista Premium Package

Monte Vista Decors



Camilla Glade



Arabian Scarlet

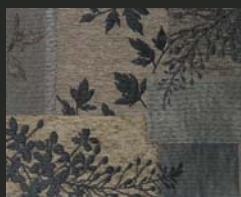

Fusion Pewter



Raine Blue

www.MonteVista-rv.com

Your Local Dealer