



By
Open Range



Enjoying the Journey.....



On a Mission

At Open Range RV, we are on a mission to...

Fulfill the trailer needs of our dealer base and retail customers, and in doing so, exceed their expectations for service, quality and value.

Earn our dealers', retail customers' and employees' long-term loyalty by delivering more than we promise, in a fair and honest business manner.

Motivate our employees to provide exceptional service and quality to our retail customers and dealers.

Compensate our employees fairly and provide opportunity for personal growth within our company.

Although it is our goal to provide a product that exceeds our customer needs and level of quality, we do not strive to be the biggest or the most profitable. In the end, we believe satisfied customers, dealers and employees will bring growth and long term profitability for all.

For almost 30 years, I have had the great fortune to work in the amazing industry of RV manufacturing. This industry runs through my blood and is the passion of my life. This has been a dream come true for me and my family. I would like to thank everyone who believed in us as an RV Manufacturer. At Open Range our motto is ENJOY THE JOURNEY!

It has been an amazing JOURNEY so far! Come join us on this great JOURNEY, we don't want you to miss another moment of it.

Enjoy the Journey!

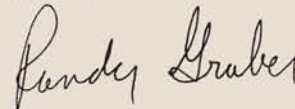
A handwritten signature in black ink that reads "Randy Graber". The signature is fluid and cursive, with the first name "Randy" and last name "Graber" clearly distinguishable.

Randy Graber, President
Open Range RV Company

Light
by Open Range



LF297RLS in Bloom Decor (All Dark Wood Option)



DEEP POTS & PANS DRAWER

- Conveniently Placed Under Kitchen Stove
- Extra-Deep to Fit All Your Pots & Pans
- Ball Bearing Guides for Easy Access



LF297RLS Kitchen

WASHER/DRYER PREP
(Most FW Floorplans)



LF297RLS Side Isle Bath



LF297RLS Bedroom in Bloom Decor

***RADIUS BED BASE WITH
TONS OF STORAGE***

- Easy Lift Strut Assist
- Radius Base for Easy "Walk Around"
- Full Depth Base to Fit All Your Items



Fifth Wheel Floorplans

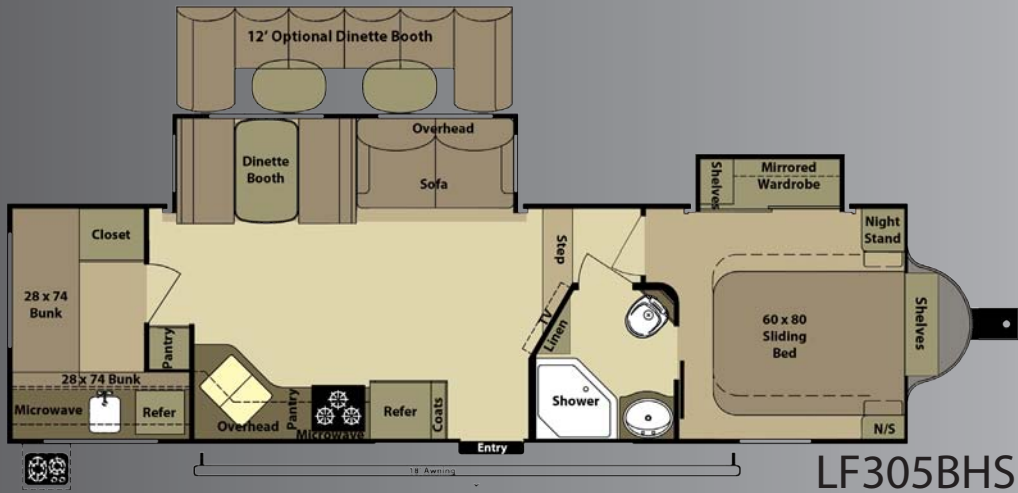

| | GVWR | UVW | Hitch Wt. | Axle Wt. | Gross NCC | Ext. Length | Ext. Height | Ext. Width | Water Heater Gas/Elec | Fresh Water | Gray Water | Waste | LP Gas (Lbs) | Furnace (BTU's) | Tire Size | Awning Size |
|----------|------|------|-----------|----------|-----------|-------------|-------------|------------|-----------------------|-------------|------------|-------|--------------|-----------------|-----------|-------------|
| LF289RES | 9995 | 7885 | 1320 | 6565 | 2110 | 31'3" | 149" | 100" | 6 Gal | 50 | 62 | 31 | 60 | 34,000 | 15" | 14' |
| LF297RLS | 9995 | 7465 | 1265 | 6470 | 2530 | 31'3" | 149" | 100" | 6 Gal | 50 | 62 | 31 | 60 | 34,000 | 15" | 14' |
| LF305BHS | 9995 | 7940 | 1400 | 6540 | 2055 | 34'8" | 149" | 100" | 6 Gal | 50 | 62 | 31 | 60 | 34,000 | 15" | 16' |

Travel Trailer Floorplans

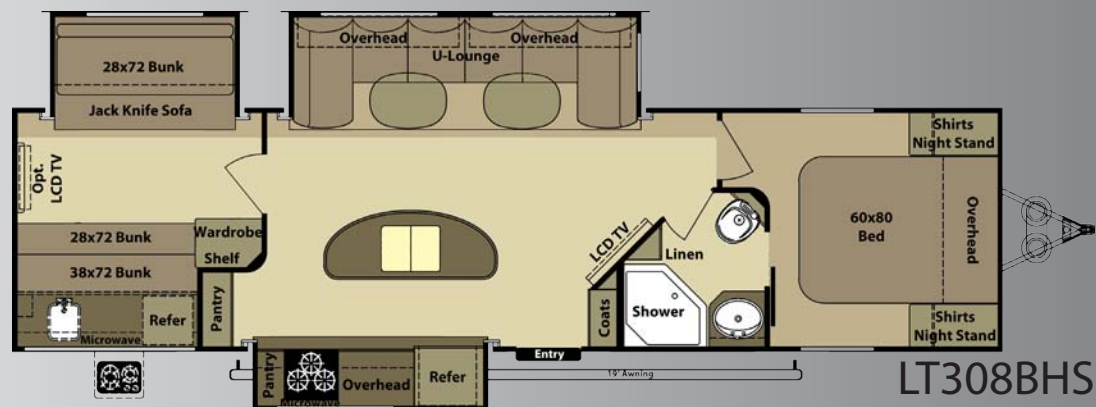
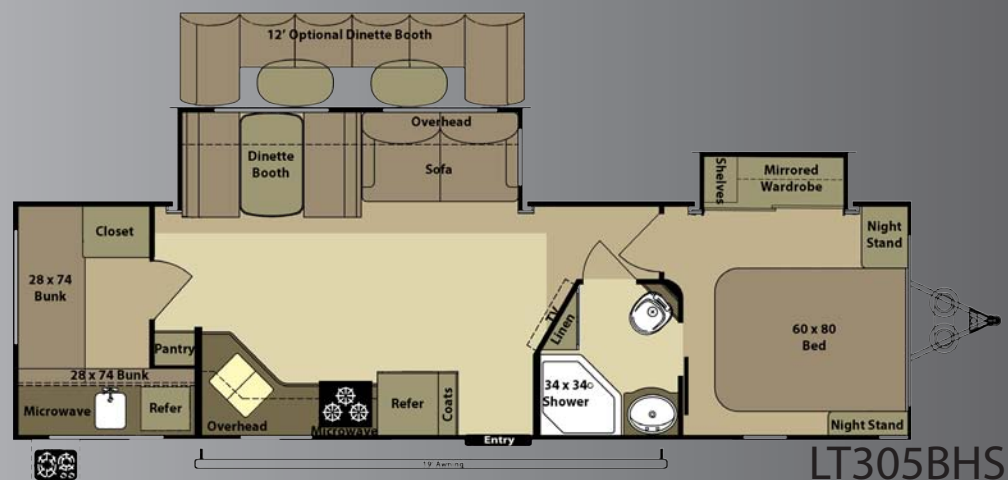

| | GVWR | UVW | Hitch Wt. | Axle Wt. | Gross NCC | Ext. Length | Ext. Height | Ext. Width | Water Heater Gas/Elec | Fresh Water | Gray Water | Waste | LP Gas (Lbs) | Furnace (BTU's) | Tire Size | Awning Size |
|----------|------|------|-----------|----------|-----------|-------------|-------------|------------|-----------------------|-------------|------------|-------|--------------|-----------------|-----------|-------------|
| LT274RLS | 8800 | 6265 | 720 | 5545 | 2535 | 31' | 125" | 100" | 6 Gal | 50 | 62 | 31 | 40 | 30,000 | 15" | 13' |
| LT305BHS | 9595 | 6805 | 795 | 6010 | 2790 | 34'4" | 125" | 100" | 6 Gal | 50 | 62 | 31 | 40 | 30,000 | 15" | 16' |
| LT308BHS | TBD | TBD | TBD | TBD | TBD | 36'10" | 125" | 100" | 6 Gal | 50 | 62 | 31 | 40 | 30,000 | 15" | 19' |

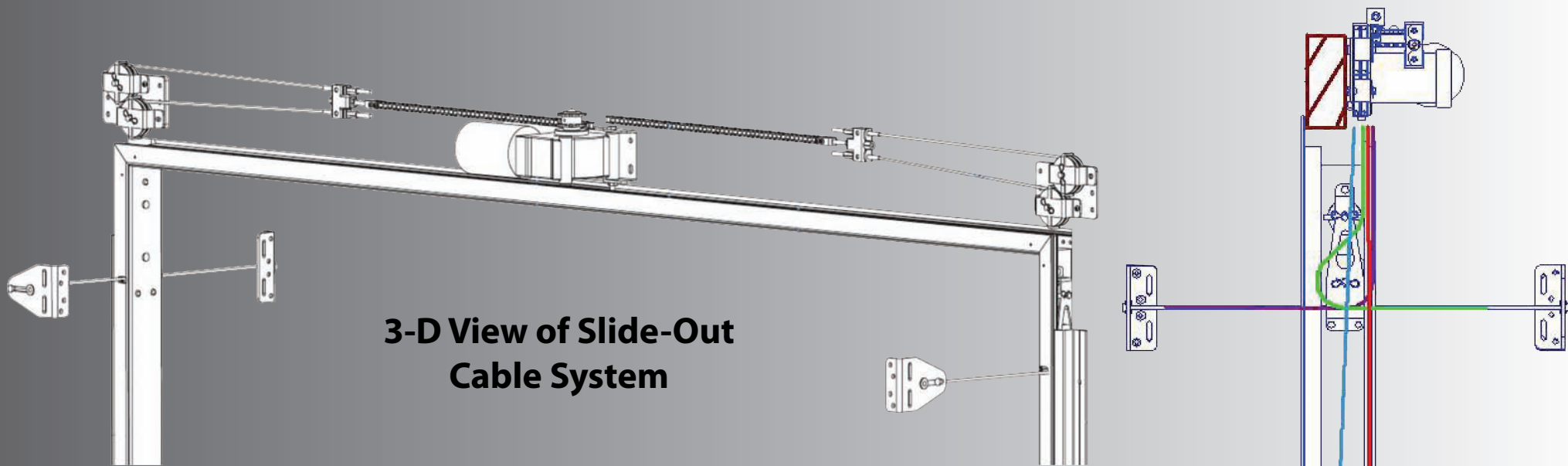

**3-D View of Slide-Out
Cable System**

10 Reasons Why... Accu-Slide

- 1. Above floor design means more storage area for your RV**
- 2. Lightweight design promotes fuel savings**
- 3. High strength stainless steel aircraft cable is used for control**
- 4. Cable control at all 4 room corners helps stop leaks**
- 5. Working components are in your RV, safe from the elements**
- 6. Locking motor secures room in or out to help stop leaks**
- 7. Above floor design minimizes maintenance requirements**
- 8. A clean system - no leaky hydraulic lines or greasy drives**
- 9. Smooth, quiet room movement - no jumping or jerking**
- 10. It's built in the U.S.A. and backed by BAL since 1972**

1- Dimensional Side Profile Of Slide-Out Cable System

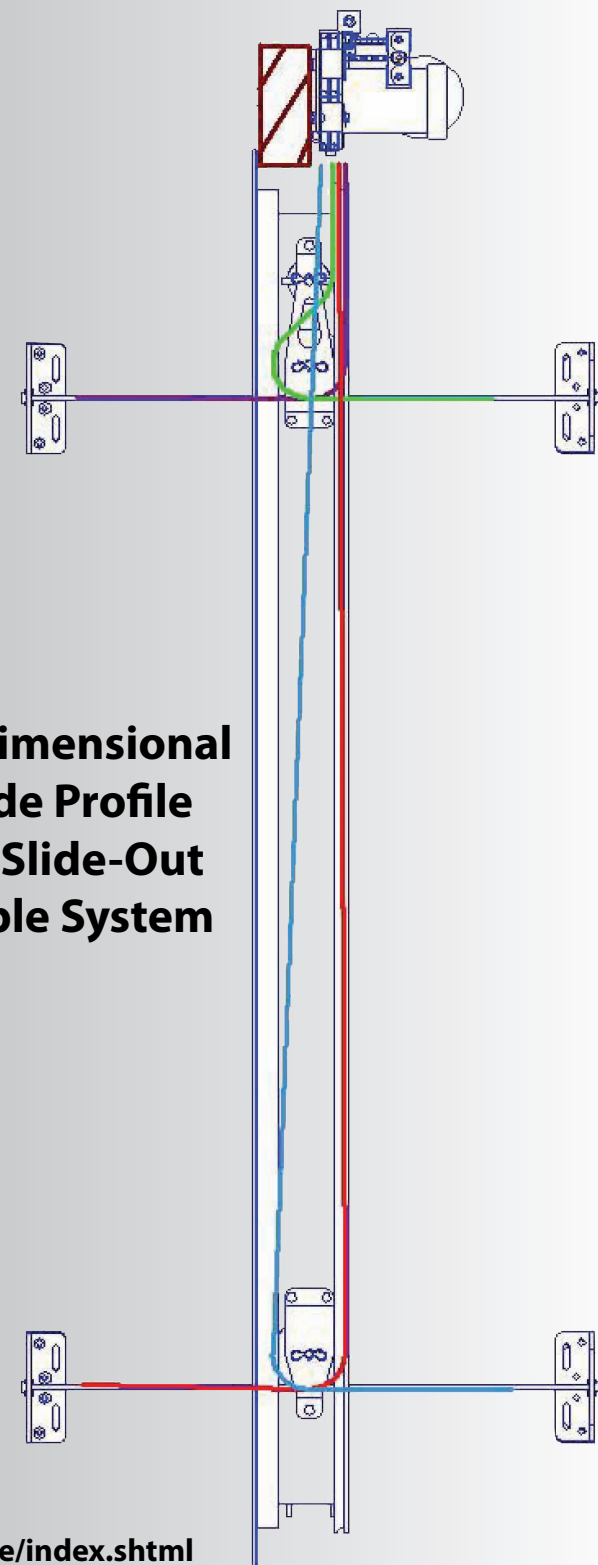

Construction Cutaway



Interior Construction

**100 lb. FULL EXTENSION
DRAWER GUIDES**



CABINET CONSTRUCTION



- Face Frames are Tube Drilled and Screwed for Maximum Strength

HARDWOOD CABINET CONSTRUCTION



- Hardwood Cabinet Door Frames & Drawer Faces
- Lumber Core Stiles
- Mortis & Tenon Joints
- Residential Style Hidden Hinges

7-LAYER BEAUFLOR® VINYL FLOORING
7-Year Warranty

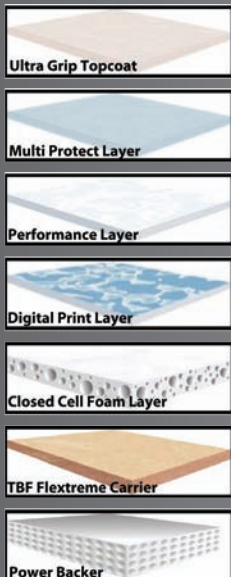

**MORTIS & TENON CABINET
CONSTRUCTION**



HIDDEN HINGES



- Elegant Euro-Style Spring Loaded Hardware
- Keeps Doors Closed Tightly
- Fully Adjustable to Customize Fit

Exterior Construction

PLYWOOD ROOF DECKING

- 350 lb. "Walk-On" Rating
- Constructed with Real Plywood
- More Durable
- Better Quality



- Ultra Violet Resistant
- No Streaking or Chalking
- No Reconditioning Needed
- 30% Lighter Weight than EPDM Rubber Roof
- Self Extinguishing
- Can be Recycled

PVC RUBBER ROOF MATERIAL



AUTOMOTIVE STYLE WINDOW SEAL



SYMALITE 1200 SIDEWALL SUBSTRATE

Outside Wall Section

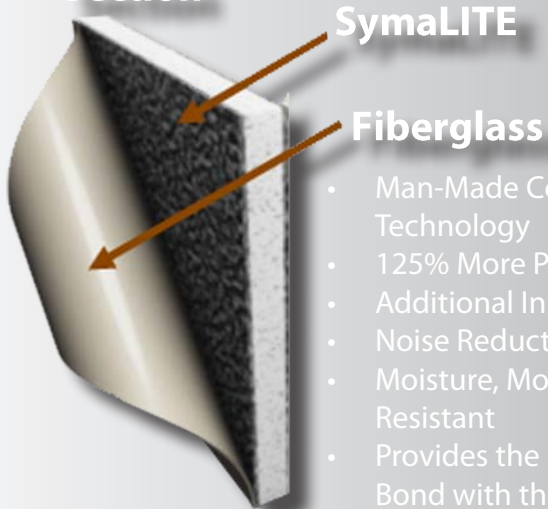

- Man-Made Composite Technology
- 125% More Puncture Proof
- Additional Insulator
- Noise Reduction
- Moisture, Mold, & Swell Resistant
- Provides the Best Possible Bond with the Fiberglass

PVC FOAM SEALS

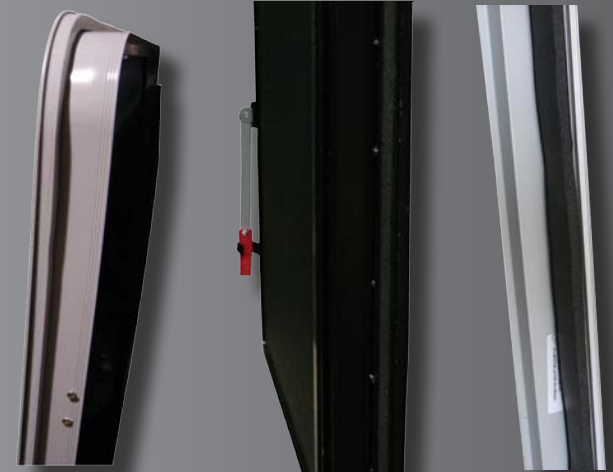

- At 30% Compression the PVC Foam Seal is 100% Waterproof
- Permanent Seal that Won't Deteriorate
- Provides a Complete and Consistent Seal Throughout

Exterior Features



Digital TV Antenna

Automotive Style Window Seals

Shown with Aftermarket Gooseneck Adapter

90° Turn Radius Front Cap even in 5.5' Truck Bed

90° Turn Radius Front Cap

King Combo Kingpin

4" Extended Drip Spouts

13,500 BTU Ducted A/C

Power Awning

MAXAIR
VENT CORP

Color Infused Fiberglass

Power Landing Gear

Full View Vented Entrance Door

Large Front Storage Area (Generator Prep Capable)

LP Storage Area

15" Aluminum Wheels

Nitro-Fill™
Nitrogen

Equa-Flex Suspension

Wide Stance Axles

LP Quick Connect

Stabilizer Jacks

FOUR SEASONS PROTECTION PACKAGE



- Atwood High Performance Furnace
- Heated Storage Area
- Insulated Slide Floors
- Vented Attic
- Double Insulated Baggage Doors
- Digital Thermostat
- Heated Underbelly
- Heated and Enclosed Dump Valves
- R-38 Roof Insulation*
- R-38 Floor Insulation*
- R-9 Sidewalls

LIGHT HEATING DIAGRAM

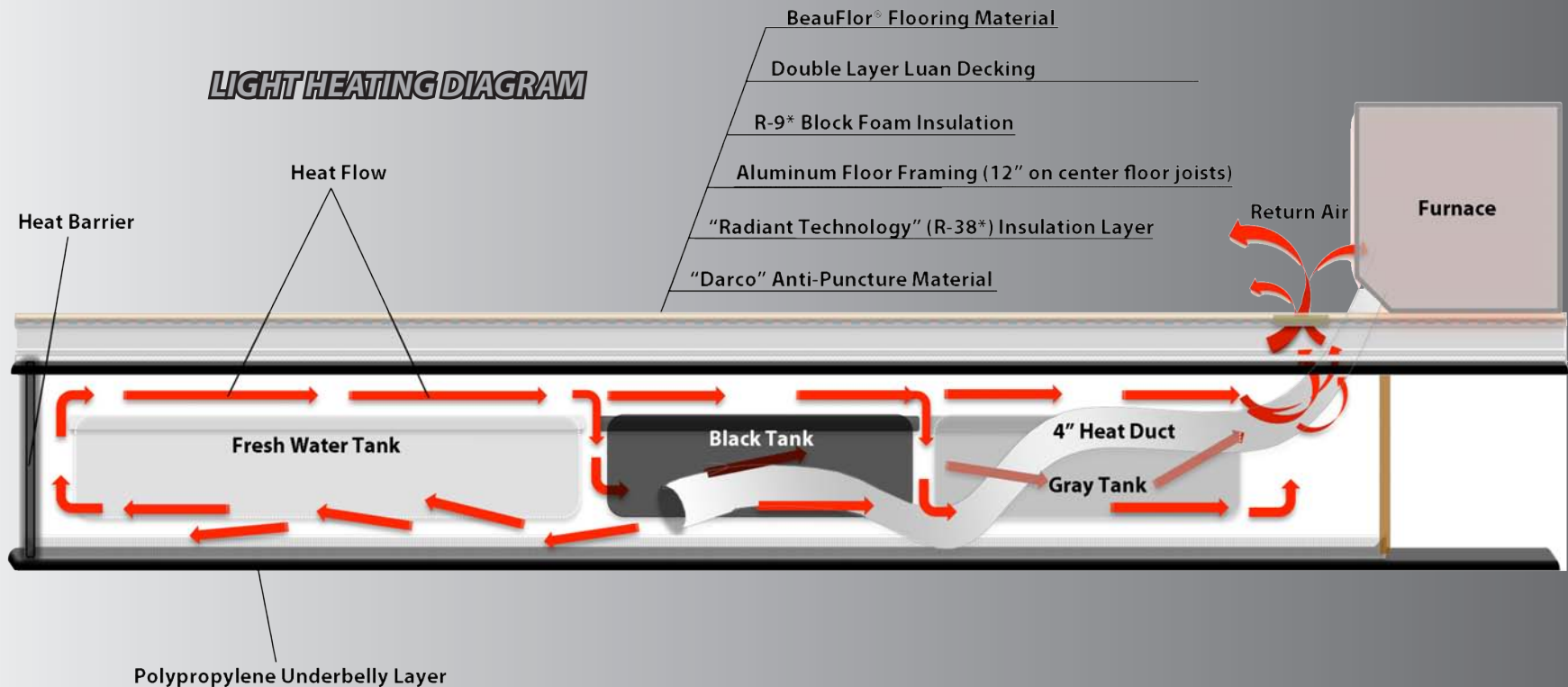

*=Calculated

Executive Package

Interior:

- Flat Screen TV in Living Area
- 12v DC/DVD/MP3/AM/FM/iPod® Stereo
- Sofa Bed w/Air Mattress
- "Comfort Cloud" Pillowtop Mattress
- Heavy Duty Full Extension Drawer Guides
- Knotty Alderwood Cabinet Doors
- Fantastic Fan in Kitchen
- Dual Skylights in Living Area
- Wired and Framed for 2nd A/C in Bedroom
- Concealed Hinges
- LED Lighting in Ceiling
- Crown Molding

Exterior:

- Multi-Port Satellite Hook-Up
- Digital TV Antenna w/ Booster
- Carefree of Colorado Power Awning
- LP Quick Connect
- Full View Vented Entrance Door
- LED Tailights



Equipped with
**JACK® DIGITAL
HDTV ANTENNA**

with Integrated SureLock
TV Signal Meter!

- * No need to crank up or down and is always ready for travel
- * Built-in signal meter for fast and accurate antenna pointing
- * Full 360° rotation allows for precise antenna pointing with no "dead spot"

A PRODUCT OF
**KING
CONTROLS**

Decors

Bloom



Diego



Heather



Travel Trailer Standards

- Exterior Utility Center w/ Black Tank Flush
- Equa Flex Suspension
- Front and Rear Stabilzer Jacks
- Nitrogen Filled Radial Tires
- Gel Coated Fiberglass Walls
- 40lbs of LP Capacity
- 100" Wide Body w/ Wide Stance Axles
- PVC Rubber Roof
- 50 Amp Service
- "Maxx Air" Vent Cover
- 15" Aluminum Wheels
- 42" Deep Main Slide

**TWO-YEAR LIMITED
TRANSFERABLE WARRANTY**

Fifth Wheel Standards

- Exterior Utility Center w/ Black Tank Flush
- Equa Flex Suspension
- Contoured Front Cap w/ 90 Degree Turn in 5.5' Bed
- Front and Rear Stabilzer Jacks
- Nitrogen Filled Radial Tires
- Gel Coated Fiberglass Walls
- 60lbs of LP Capacity
- 100" Wide Body w/ Wide Stance Axles
- PVC Rubber Roof
- 50 Amp Service
- "Maxx Air" Vent Cover
- 15" Aluminum Wheels
- 42" Deep Main Slide
- Washer/Dryer Prep (Most Floorplans)
- Generator Prep Capable
- Fantastic Fan in Kitchen

PURCHASE LOCALLY

Open Range RV strongly encourages our retail customers to purchase from their local dealership whenever possible due to the following reasons:

1) Our Dealers are, as a rule, independently owned and operated businesses. Outside of those customers they personally sold products to, they are not obligated to perform warranty service on Open Range RV products that were purchased elsewhere. There may be an occasion that the customer will be required to return to the point of purchase to satisfy warranty requirements.

2) Although many dealerships will eventually service products not purchased at their dealership, they will usually take care of their customers and other Open Range RV customers who are traveling away from their local dealer as a priority.

3) Local purchases allow a customer to establish a relationship with a dealer close to home. This relationship provides the customer with a convenient location for service and support from a "local" professional.

4) The opportunity for a thorough PDI (Pre Delivery Inspection) and product orientation is an additional benefit of buying from a local dealer. The opportunity for refresher courses or the ability to get questions answered more promptly is another additional benefit of buying from a local dealer.

5) For our Canadian customers, there are also requirements which must be met to bring an RV purchased out of the country to their home. Although not impossible, these requirements may involve such things as additional inspections, certifications, taxes and fees. The local Canadian Dealer is a professional at meeting these requirements.

6) Open Range's goal is for all RV Owners to fully enjoy their RV experience. In light of this goal, and considering the advantages of buying locally, we encourage you to be thorough when determining what product to purchase and which dealer to purchase it from as both are key to your ultimate satisfaction.

Your Open Range Dealer:



Open Range RV Company 3195 N. St. Rd. 5 Shipshewana, IN 46565

Phone: (260) 768-7771 - www.OpenRangeRV.com

Due to continual research and advances, manufacturer reserves the right to change specifications, design, price, and equipment without notice, and assumes no responsibility for any error in the literature. Some items shown are not included as standard or optional equipment

©2012 Open Range RV Company, Shipshewana, Indiana

Published Date: June 25th, 2012