

96



ELECTRA

5th Wheel, Travel Trailer & Sport Floor Plans & Specs.



Plum Textured

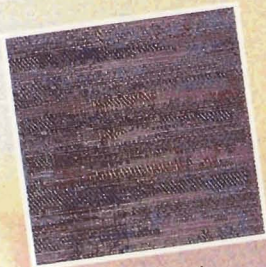

BlueTextured



Teal Textured



Plum Velvet

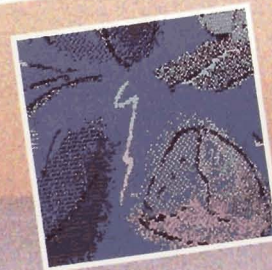

Blue Velvet



Teal Velvet

Electra & Electra Sport Floor Plans

Electra Sport



18-RB
Optional O.H.
Bunk Cab.

Electra Sport

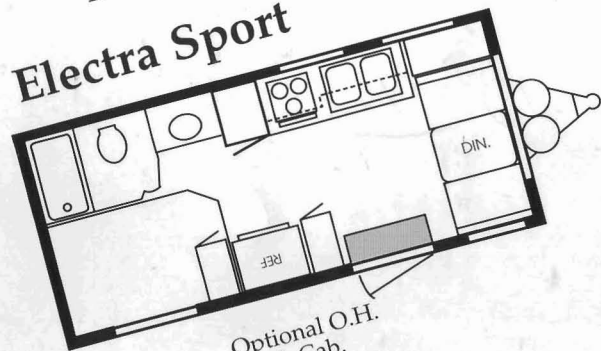

18-FD
Optional O.H.
Bunk Cab.

Electra Sport

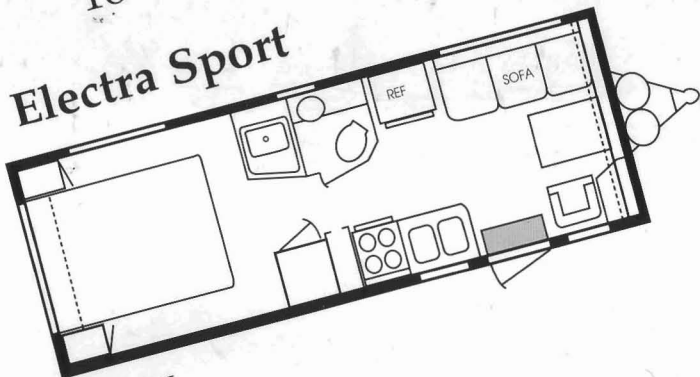

24-FL

Electra Sport

Electra

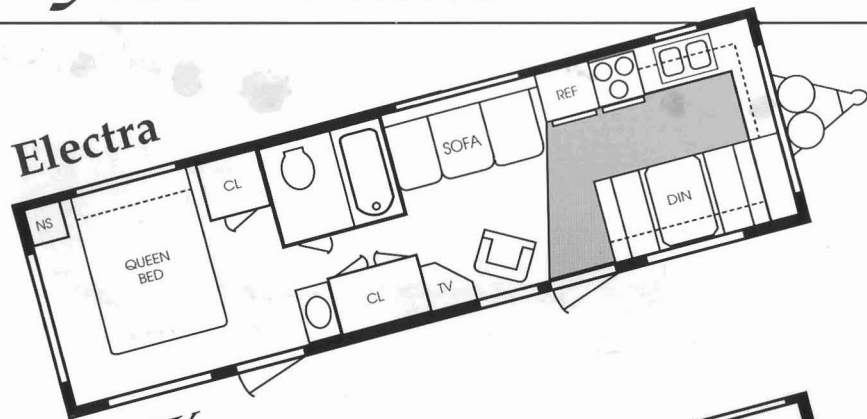

28-FK

Electra

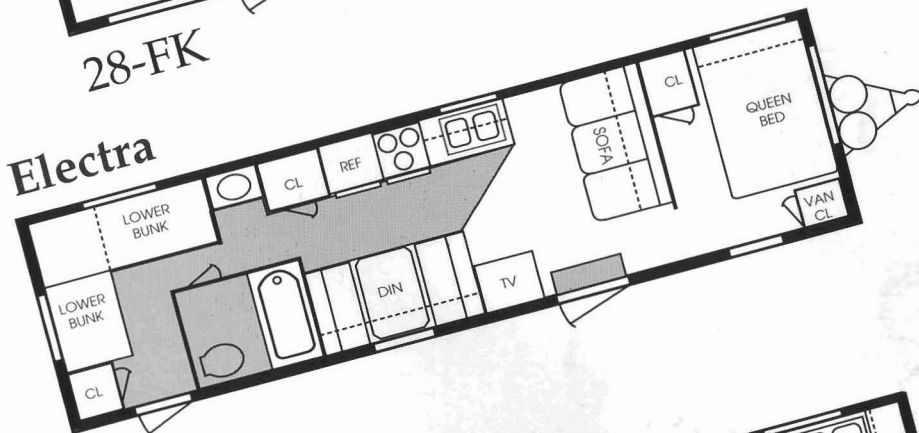

30-2B

Electra

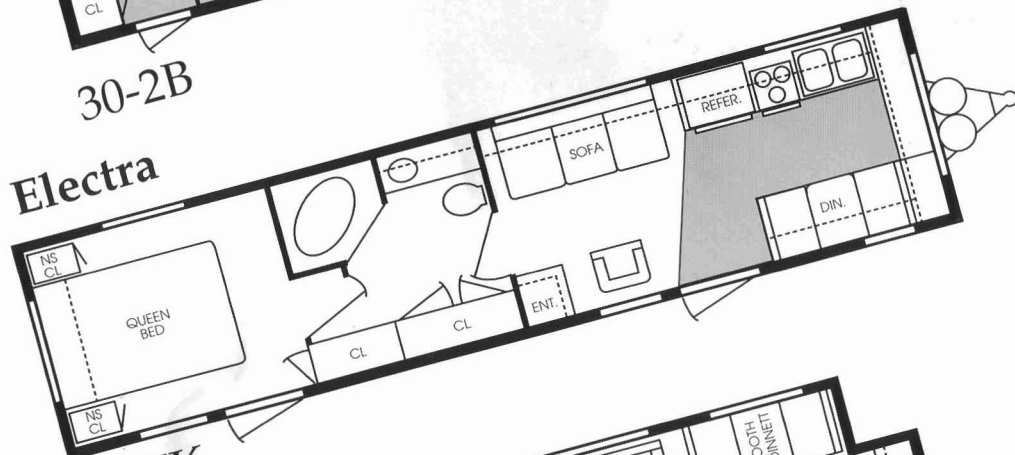

31-FK

Electra

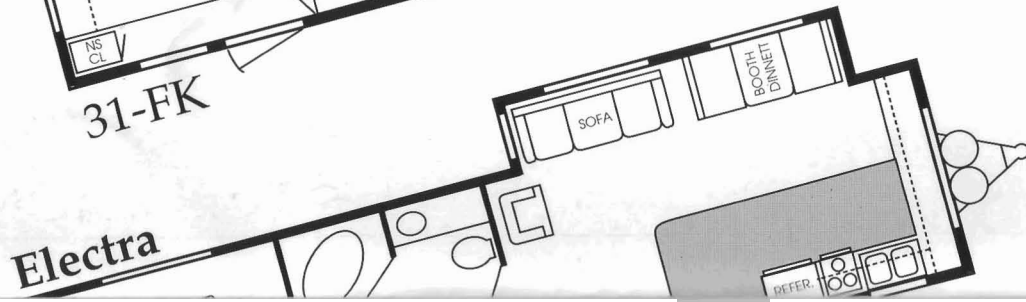



22-FWRL

Electra & Electra Sport

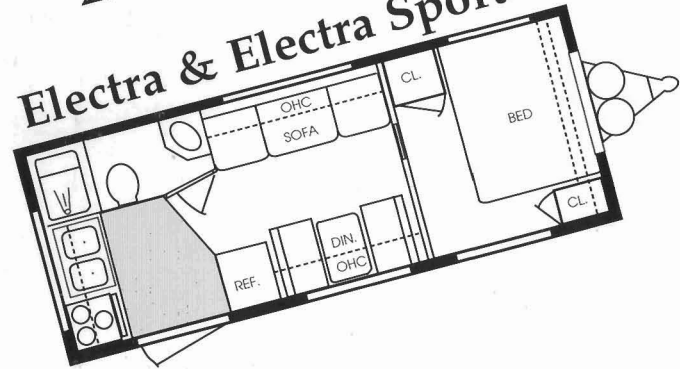

22-RK

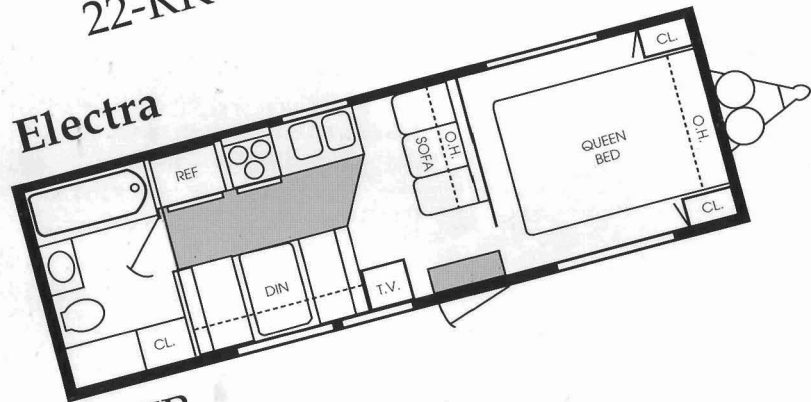

26-FB

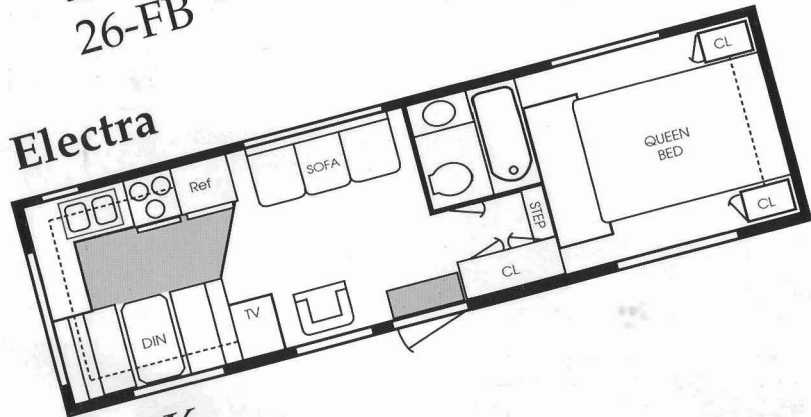

27-RK

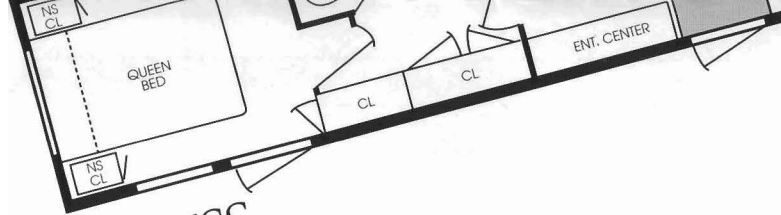

32-FKSS

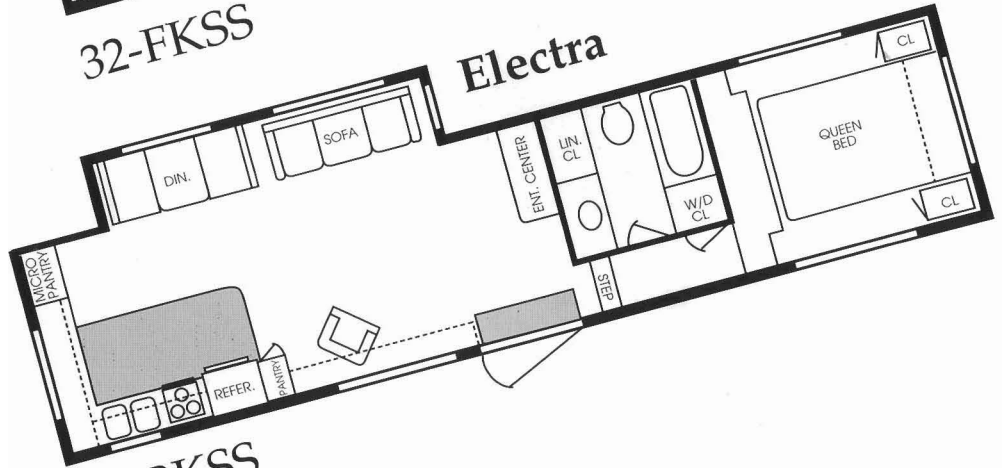

32-RKSS

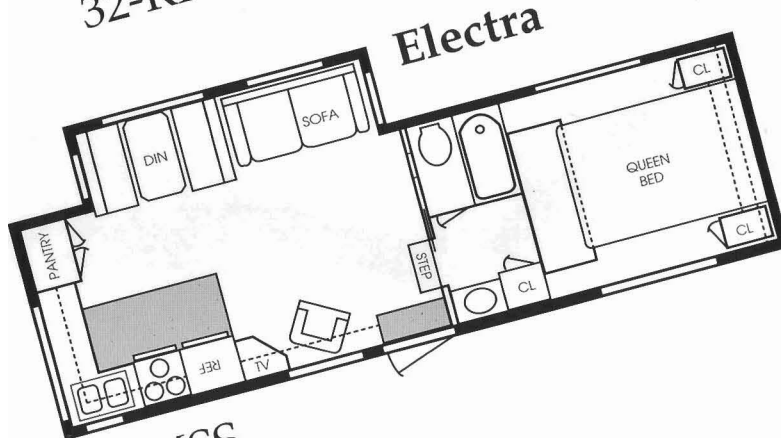

27-RKSS

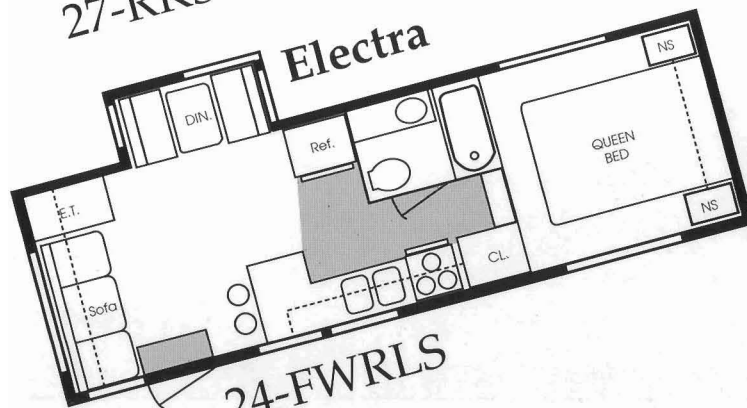

24-FWRLS

Electra & Electra Sport Specifications

Comfort/ accommodations	Sport 18RB	Sport 18FD	Sport 24FL	Sport 22FWRL	Sport & El 22RK	Electra 26FB	Electra 28FK	Electra 30-2B	Electra 31FK	Electra 32FKSS	Electra 32RKSS	Electra 27RKSS	Electra 24FWRLS
SLEEPING AREA	2	2	2	3	2	3	3	4	3	3	3	3	3
FURNACE W/12 VOLT FAN & THERMOSTAT	•	•	•	•	•	•	•	•	•	•	•	•	•
DUAL LP TANKS W/REGULATOR 30# & CHANGEOVER (GALS)	7	7	7	7	7	7	7	7	7	7	7	7	7
WASTE WATER HOLDING TANKS (APPROX GALS)	60	60	60	60	60	60	60	60	60	90	90	90	60
DEMAND WATER SYSTEM W/12V PUMP (APPROX GALS)	36	36	36	36	36	36	36	36	36	56	56	56	36
TANDEM AXLE W/4 WHEEL ELECTRIC BRAKES	•	•	•	•	•	•	•	•	•	•	•	•	•
SKYLINE ROOF VENTS (#)	2	2	3	3	3	3	3	3	3	3	3	3	3
RETRACTABLE Reg ENTRY STEP Sport	Dbl Sng	Dbl Sng	Dbl Sng	Dbl Sng	Dbl Sng	Dbl	Dbl	Dbl	Dbl	Tpl	Tpl	Tpl	Tpl Tpl
DIMENSIONS													
RADIAL TIRE SIZE	ST205 75R15	ST205 75R15	ST205 75R15	ST205 75R15	ST205 75R15	ST205 75R15	ST205 75R15	ST205 75R15	ST205 75R15	ST225 75R15	ST225 75R15	ST225 75R15	ST225 75R15
TIRE LOAD RANGE	C	C	C	C	C	C	C	D	C	D	D	D	D
GROSS DRY WEIGHT	N/A	N/A	N/A	N/A	4320	4720	5220	5340	5320	8540	8200	7040	N/A
HITCH DRY WEIGHT	N/A	N/A	N/A	N/A	460	620	860	580	780	1660	1600	1200	N/A
AXLE DRY WEIGHT	N/A	N/A	N/A	N/A	3860	4100	4360	4700	4540	6880	6600	5840	N/A
GROSS VEHICLE WEIGHT RATING	7000	7000	7000	7000	7000	7000	7000	7000	7000	8800	10400	8800	8800
LENGTH	18'10"	18'10"	N/A	N/A	23'2"	29'1"	31'2"	31'2"	N/A	N/A	33'1"	27'11"	33'1"

At Electra we constantly improve our product: as a result all specifications, dimensions and features in this brochure were as accurate as possible at the time of publication. Selected decor items shown in the photographs are not part of the product unless specified differently.



Check it out & Check it off...

Electra & Electra Sport Standard Features

ELECTRA

- ☐ Awning
- ☐ 13,500 BTU Ducted A/C
- TV antenna w/booster
- ☐ Cable TV
- ☐ 2-30# LP Bottles W/Auto Changeover
- ☐ Power Bath Vent
- ☐ Rear Window Stoneguard (5th Wheels)
- ☐ Patio Light
- ☐ Extra Tough Rubber Roof
- ☐ Double Entry Steps – Non Slide Outs
- ☐ Triple Entry Steps – Slide Outs
- ☐ Dead Bolt Lock
- ☐ Large Radius Tinted Jalousie Windows
- ☐ Safety Glass Picture Windows
- ☐ 30" Wide Radius Entry Door (Most Models)
- ☐ Carpeted Storage Compartment (Stand Up 5th Wheel)
- ☐ Sewer Hose Storage
- ☐ Radial Tires
- ☐ Hydraulic Glide On Slide Out Models W/Manual Over-ride
- ☐ Sofa Bolsters (Except Free Standing Sofas With Arms)
- ☐ Microwave Oven
- ☐ Double Door Refrigerator

- ☐ 3 Burner Range W/9,000 BTU Burner
- ☐ 21" Oven W/Black Glass Door
- ☐ 6 Gal. LP + 110 Volt Water Heater W/DSI
- ☐ Stereo Cassette W/4 Speakers
- ☐ Bedroom TV Outlet W/Tray
- ☐ Power Range Hood
- ☐ Monitor Panel
- ☐ 45 Amp Converter W/Charger
- ☐ Queen Bed (Most Models) W/Bed Lifts
- ☐ Innerspring Mattress
- ☐ Interior Grab Handle
- ☐ Shower Surround W/Bi-fold Shower Door
- ☐ Deluxe Flip Sofa
- ☐ Swivel Rocking Chair (where shown)
- ☐ Mini Blinds All Windows
- ☐ Large Stainless Steel Kitchen Sink
- ☐ 1 Sink Cover
- ☐ Solid Oak Framed Cabinet Doors
- ☐ Residential Style Interior Doors
- ☐ Kitchen, Bedroom Roof Vents
- ☐ Adjustable Ceiling A/C Ducts
- ☐ Vinyl Floor – Kitchen & Entry
- ☐ Water Heater By-Pass
- ☐ Smoke Detector
- ☐ Fire Extinguisher

OPTIONS

- ☐ Twin Bed
- ☐ Extra Large 2 Door Refrigerator
- ☐ Raised Oak Refrigerator Door
- ☐ Free-standing Dining Table w/Chairs
- ☐ Two Extra Dining Room Chairs
- ☐ Ceiling Fan (5th Wheels Only)
- ☐ Roof Rack Ladder
- ☐ 15,000 BTU Ducted Air Conditioning
- ☐ Recliner Chair in Place of Spare Tire
- ☐ Power Jack
- ☐ Phone Jack
- ☐ Hide-A-Bed Sofa
- ☐ Outside Shower (Some Models)

ELECTRA SPORT

- ☐ 2-30# LP Bottles W/Auto Changeover
- ☐ Power Bath Vent
- ☐ Patio Light
- ☐ Extra Tough Rubber Roof
- ☐ Dead Bolt Lock
- ☐ Safety Glass Picture Windows
- ☐ Sewer Hose Storage
- ☐ Radial Tires
- ☐ 36 AMP Converter w/Charger
- ☐ Sofa Bolsters (Except Free Standing Sofas With Arms)
- ☐ 3 Burner Range W/9,000 BTU Burner

- ☐ 21" Oven W/Black Glass Door
- ☐ Power Range Hood
- ☐ Monitor Panel
- ☐ Innerspring Mattress
- ☐ Interior Grab Handle
- ☐ Shower Curtain
- ☐ Swivel Rocking Chair (Where Shown)
- ☐ Lined Privacy Curtains
- ☐ Large Stainless Steel Kitchen Sink
- ☐ Solid Oak Framed Cabinet Doors
- ☐ Residential Style Interior Doors
- ☐ Adjustable Ceiling A/C Ducts
- ☐ Vinyl Floor – Kitchen & Entry
- ☐ Water Heater By-Pass
- ☐ Smoke Detector
- ☐ Fire Extinguisher

OPTIONS

- ☐ Twin Bed
- ☐ Free-standing Dining Table w/Chairs
- ☐ Two Extra Dining Room Chairs
- ☐ Ceiling Fan (5th Wheels Only)
- ☐ Roof Rack Ladder
- ☐ Power Jack
- ☐ Phone Jack
- ☐ Outside Shower (Some Models)

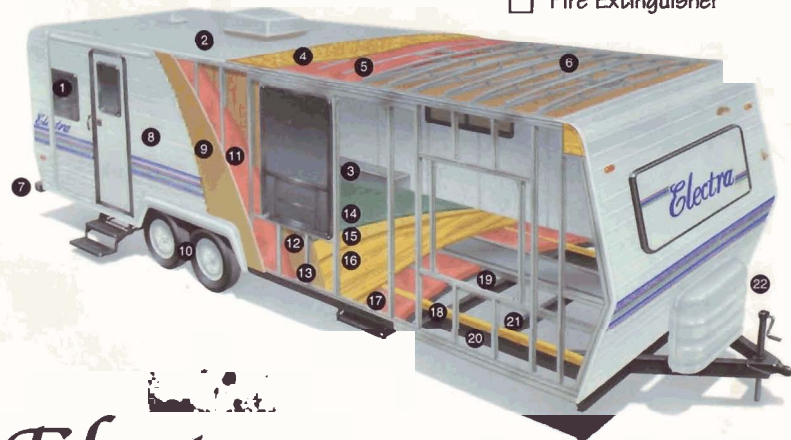

Electra & Electra Sport

1. Tinted Radius Corner Jalousie Windows
2. Dicor Corp. Brite-Ply™ Seamless EPDM roofing membrane
3. Galvanized Wheel Wells
4. 3/8" Roof Decking
5. Cut and Custom Fit Fiberglass Insulation
6. 4-5/8" Aluminum Truss Rafters
7. Hose Bumper w/Cover
8. Bright white aluminum siding
9. Foam Core Blanket
10. Radial Tires w/Styled Wheels
11. Cut and Custom Fit Insulation
12. Vinyl Interior Wall Panel
13. 1-1/2" x 1-1/2" Welded Tubular Sidewall
14. 30 oz. Plush Carpeting
15. Foam Carpet Pad
16. 5/8" Tongue and Groove Decking
17. Radius Entry Door
18. 2" x 3" longitudinal floor joists
19. Darco® Underbelly
20. Steel Tube Main Rail
21. Steel Cross Member
22. LP Bottle Cover

Electra

R.V. Manufacturing, Inc.

P.O. Box 338

Bristol, IN 46507

Printed on Recycled Paper



THOR
AMERICA'S BEST RV VALUE