



What in the world is a Razorback, you ask?!? Razorback is a fascinating and elegant sand formation formed when wind drives fine loose grains of rock and minerals in multiple directions, creating a knife-edged ridge on the top of a dune.

Razorback Standards & Options

Exterior

Steel Loops on Chassis for Outside Security Lock
Dual Battery Tray
Front Cargo/Generator Rack
Oversized Exterior Storage Compartments
Cargo Ramp Loading Lights
Rear Security/Work Lights
Black Trim Windows w/Tinted Safety Glass
Diamond Plate Rock Guard
Radius Entry Door
Triple Entry Steps
Keyed Ramp Door Latches
2" Quick Release Dump Valve on Fresh Water Tank

Garage

7' Insulated Bottom Hinged Spring Assisted Ramp Door
Tuff-Ply Gas/Oil Resistant Dovetail Flooring
Metal Ram Air Vents
Fuel Station w/12V Pump, 30 GAL Fuel Tank & Static Line
2,500 LB Tie Down Rings
Dovetail Rear Entry
Flat Floor Design – No Wheel Wells

Equipment

Heavy-Duty Axles
(4) 12" Electric Brakes
Electric Power Awning w/Adjustable Legs
Steel Wheels
Radial Tires
6 GAL LP/Electric Water Heater w/DSI
30 AMP Service w/Power Cord
55 AMP Converter
Black Tank Flush
Forced Air Furnace
Dual 7.5 GAL (30 LB each) LP Tanks w/Cover
Front & Rear Stabilizer Jacks

Construction

102" Wide Body
I-Beam Chassis (8" – 1950, 2150, 2650) (10" – 2950)
Steel Reinforced Garage Floor
7/8" One-Piece Floor Decking (main floor)
5" Trussed Roof
Fiberglass Insulation in Roof, Floor & Walls
1" Thick Insulated Baggage Doors
Heated & Enclosed Water Tanks

Interior

Jensen Stereo w/AM/FM/CD/DVD/Player w/AUX,
4 Interior Speakers, 2 Exterior Marine Speakers
13,500 BTU Ducted AC (1950 non-ducted)
LCD HDTV w/Outside Entertainment Bracket
(19" – 1950, 2150) (24" – 2650) (32" – 2950)
Razorback Central Command Center
12V Disconnect Switch
6 CU FT LP/Electric Refrigerator w/Black Front Panel
3-Burner Range
Fantastic Fan in Kitchen
Microwave/Convection Oven
Bottle Opener in Kitchen
Kitchen Sink Cover
Cherry Shaker Style Cabinet Doors
Residential Cabinet Hardware
Overhead Cargo Netting
Laundry Chute in Bedroom (n/a 1950)
Custom Razorback Foldaway Furniture
Beauflor® Flooring
Foot Flush Toilet
Puck Lighting above Cabinets
Metal Drawer Guides
Hard Lambrequin Window Treatments
Multiple Cable TV Connections
Directional Digital TV Antenna
Metal Blinds
Shower/Tub Surround
Skylight over Shower/Tub
Power Bathroom Exhaust Fan
Mirrored Medicine Cabinet
Oversized Tinted Safety Glass Windows
Up to 17' of Cargo Space

Options

Jensen Speaker Upgrade w/Powered Subwoofer
Onan® 4.0 KW Generator w/Start/Stop Switch, Hour Meter & Fuel Gauge
15,000 BTU AC Upgrade
Rear Screen Wall
8 CU FT Refrigerator Upgrade
Fiberglass Skin Upgrade
Aluminum Wheels (16" – 2950)
Spare Tire w/Carrier
Electric Bed Lift in Garage w/Dual Beds & Ladder (2650, 2950)
Electric Bed Lift in Garage w/Top Bed, Flip Up Bottom Sofa Sleeper & Ladder (2650, 2950)
Razorback Logo Chair
2 Razorback Logo Chairs IPS Sit-n-Sleep Dinette (2650)



Acu-Weight Certification

All Razorbacks are weighed as they leave the actory, giving you the exact weight of your unit, including options!



Razorback Decor - Ramsey Cranapple



Your Local Dealer

Disclaimer: Product information is as accurate as possible as of the date of publication of this brochure. Features, floorplans and specifications are subject to change without notice. Please also consult our website for more current product information and specifications.

Tow Vehicle Disclaimer CAUTION: Owners of Dutchmen Manufacturing, Inc., recreational vehicles are solely responsible for the selection and proper use of tow vehicles. All customers should consult with a motor vehicle manufacturer or their dealer concerning the purchase and use of suitable tow vehicles for Dutchmen products. Dutchmen disclaims any liability or damages suffered as a result of the selection, operation, use or misuse of a tow vehicle. Dutchmen's limited warranty does not cover damage to the recreational vehicle or the tow vehicle as a result of the selection, operation, use or misuse of the tow vehicle.

RAZORBACK



TOY HAULERS





RAZORBACK HAS A FLOORPLAN TO SUIT EVERY FAMILY ACTIVITY!



2950



Razorback's interior creature comforts include an LCD TV with outside entertainment bracket, large refrigerator, 3-burner range, great seating, cherry Shaker-style cabinet doors, thoughtful lighting placement, and even a laundry chute in the bedroom!

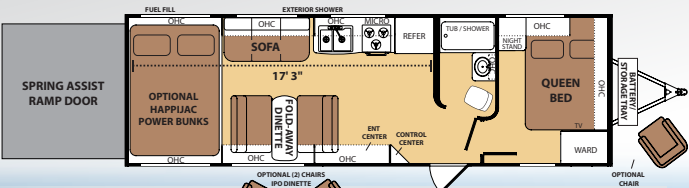

2650	
UVW	7,384
Hitch	1,012
Cargo	3,616
Overall Height	12' 1"
Overall Length	31' 1"
Fresh Water Tank	86
Black Water Tank	42
Grey Water Tank	42
Tire Size	ST225/75R15(D)
Garage	17' 3"



2650

Razorback offers the best way we know for your family and friends to connect while enjoying the great outdoors! From its practical, no-nonsense design and comfy interiors to its unlimited versatility, Razorback offers something for everyone.



2950	
UVW	8,129
Hitch	1,362
Cargo	3,871
Overall Height	12' 3"
Overall Length	34' 8"
Fresh Water Tank	86
Black Water Tank	42
Grey Water Tank	42
Tire Size	ST235/80R16(E)
Garage	10'

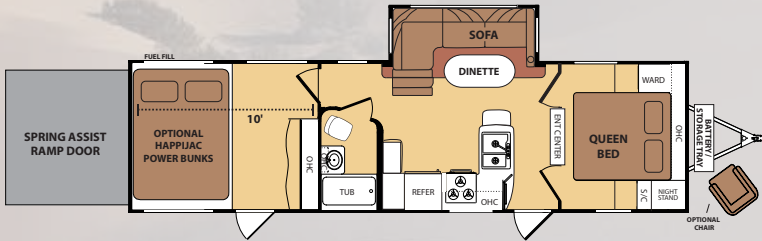

1950



Our no-nonsense garage areas offer a variety of living accommodations, from hauling toys and a fantastic play area for the kids, a family room or even a second bedroom. And no matter which model you choose, all are towable by half-ton vehicles.



2150



Our kid-proof fabrics, generous counter and storage spaces and attention to detail will make your family's total camping experience that much more rewarding. Razorback's 8.5-foot wide body is supported by a rugged 8-to 10-inch I-beam chassis and heavy-duty axles.

2150	
UVW	5,672
Hitch	786
Cargo	3,828
Overall Height	12' 1"
Overall Length	26'
Fresh Water Tank	86
Black Water Tank	42
Grey Water Tank	42
Tire Size	ST225/75R15(D)
Garage	12' 3"

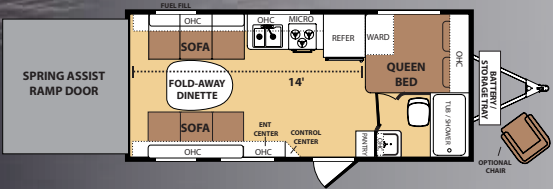
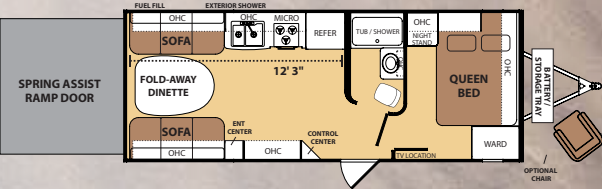

1950	
UVW	5,661
Hitch	816
Cargo	3,340
Overall Height	11' 8"
Overall Length	24' 8"
Fresh Water Tank	76
Black Water Tank	42
Grey Water Tank	42
Tire Size	ST225/75R15(D)
Garage	14'