

2006

Ultra

GULF STREAM



COACH, INCORPORATED

FAMILY VALUE

The Ultimate Minihome Experience



Ultra Super-C



GALLEY • MODEL 6316

GALLEY CONVENIENCE...

Our wide-open galley offers all the comforts of your kitchen at home. 3-burner high performance range; 2-door, 2-way refrigerator and large convection microwave, you will be able to prepare any of your family's favorite meals.



KING BED • MODEL 6331



**STORAGE GARAGE
MODEL 6316 SUPER C ONLY**

GARAGE...

Enormous, four point access (3 exterior, 1 interior), one-piece molded fiberglass storage garage designed to maximize storage capacity and accessibility.



LIVING ROOM • MODEL 6316

SPACIOUS LIVING...

Open living areas that incorporate the largest slide rooms in the class C market and residential style furniture make home away from home very comfortable.

The side cab-over entertainment center featuring a large TV and plenty of storage for music and movies to entertain everyone on a rainy day or quiet evening.

ENTERTAINMENT...

The optional overhead entertainment center featuring a large flat screen TV and plenty of storage for music and movies to entertain everyone on a rainy day or quiet evening.



OPTIONAL OVERHEAD ENTERTAINMENT CENTER

GULF STREAM



COACH, INCORPORATED

FAMILY VALUE

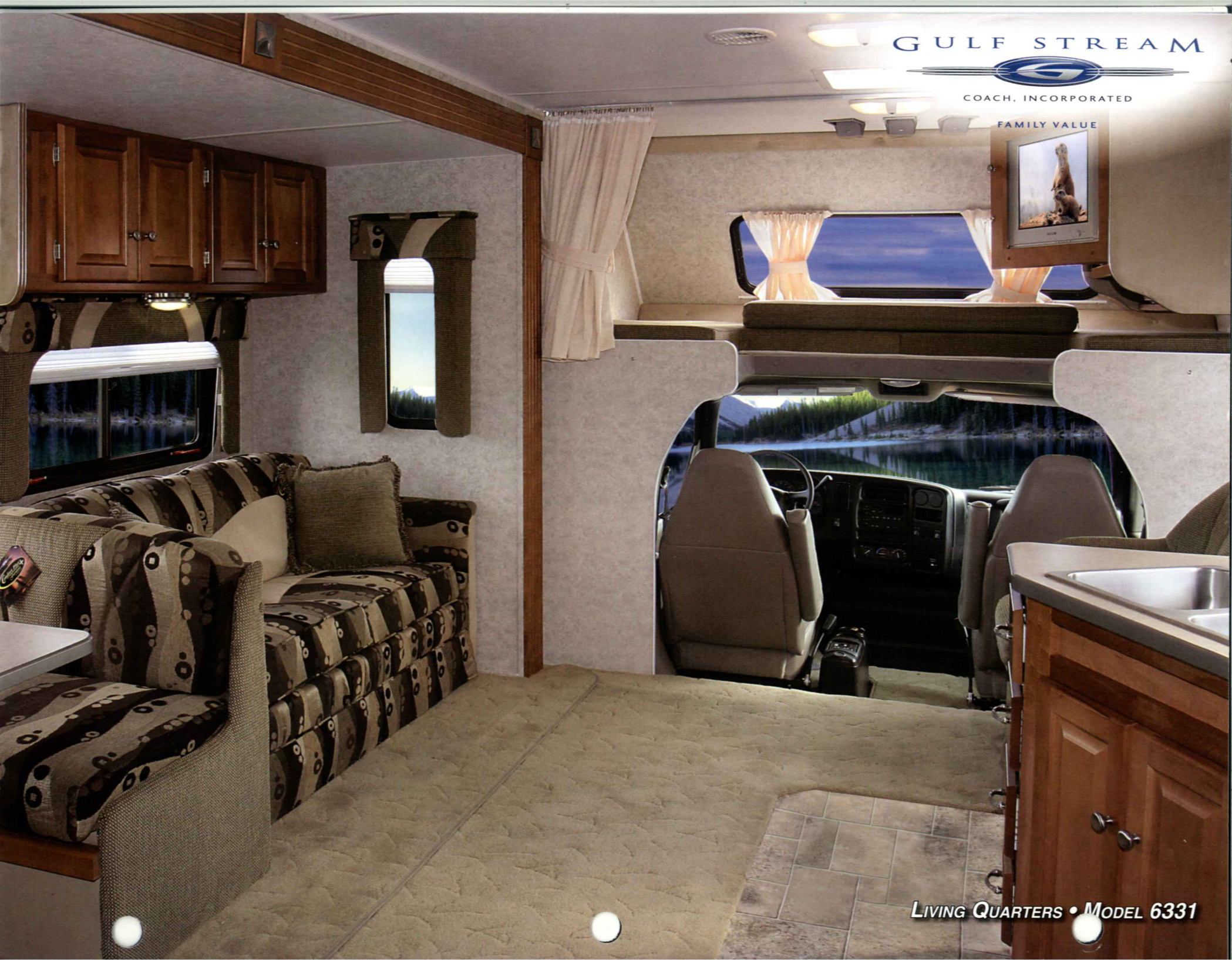

LIVING QUARTERS • MODEL 6331

Ultra Super-C

Chevy Kodiak Chassis

BROUGHT TO YOU EXCLUSIVELY
BY GULF STREAM COACH



Multi-Leaf
Suspension

Rust-Prohibitive
Coating on Frame

Four Wheel
Disc Breaking

Breakaway
Mirrors

Ergonomically
Spaced Steps

Easy Access
Pull Forward Hood

Powerful Chevrolet
Vortec Gas Engine

Up-Level Headlights
with chrome treated
front bumper and grill

- INTENSE 19,500 LB. GVWR
- UP TO 3,000 LBS. CARGO CARRYING CAPACITY*
- SUPERIOR TOWING CAPACITY 26,000 GCWR
- 10,000 LB. HITCH RATING
- 19.5" TIRES
- DRIVER AND PASSENGER AIRBAGS
- DAYTIME RUNNING LIGHTS
- AM/FM CD PLAYER

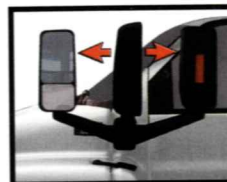

Breakaway mirrors fold 90 degrees inward or outward to manage tight spaces reducing the risk of damage.



126-square inch-surface mirror including a 6x7 inch convex section on both mirrors.

STABIL-RIDE Suspension System

The best just got better. The optional Stabil-Ride™ suspension system integrates parabolic leaf springs, auxiliary springs, a stabilizer bar and tuned shocks, designed to provide a low maintenance, stable ride comparable to the ride of a diesel pusher. Enjoy unsurpassed handling with reduced body sway particularly while cornering and superior straight-line stability.

SUPERIOR VISIBILITY



Negotiating a tricky curve in the campground or on a major city street there will be no reason to worry while you're in the Chevrolet Kodiak. With a 54 degree turning radius, giant mirrors, large windshield and sloped hood this vehicle drives more like a light duty truck. Sloped hood allows the driver to see just a mere 13 feet in front of them, doubling their field of vision versus the traditional 26 feet.

CHEVROLET KODIAK C5500
VISIBILITY AT 13 FEET

FORD F450/F550
VISIBILITY AT 26 FEET



VORTECTM 8.1 LITRE V8 GASOLINE ENGINE (standard)

HP	Torque LB-FT
325hp	450

DURAMAXTM 6600 V8 TURBO DIESEL (optional)

HP	Torque LB-FT
300hp	520

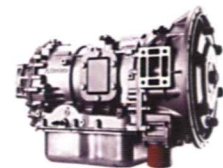

ALLISONTM 1000 SERIES AUTOMATIC TRANSMISSION (standard)

5 speed	Gross Torque (lb-ft)
1000	545

BEST-IN-CLASS TURNING RADIUS



**Chevy Kodiak
C4500/C5500**
35' Turn Diameter
54° Wheel Cut

Midsize Car

For
F-450/F-550* - 52°

*CCC (Cargo Carrying Capacity) is equal to the GVWR minus each of the following: UVW, full (potable) water weight (including water heater), full LP Gas weight, and SCWR

MODEL 6316 BK



Chassis	Chevy Kodiak	Height w/AC	11'-10.5"	Black	52 gal.
Engine	325 Hp. V-8	Width	101"	LP Gas Tank	64 lbs.
Fuel	80	Wheelbase	213.5"	Furnace (BTU's)	30,000
GVWR	19,500	Fresh	54 gal.	Water Heater w/DSI	6 gal.
Length	32'-7"	Grey	52 gal.	Ext Storage	153.48

MODEL 6331 BK



Chassis	Chevy Kodiak	Height w/AC	11'-10.5"	Black	52 gal.
Engine	325 Hp. V-8	Width	101"	LP Gas Tank	64 lbs.
Fuel	80	Wheelbase	225.5"	Furnace (BTU's)	30,000
GVWR	19,500	Fresh	94 gal.	Water Heater w/DSI	6 gal.
Length	33'-9"	Grey	52 gal.	Ext Storage	60.4

* 100 Gal. fresh water includes hot water heater

MODEL 6340 BK



Chassis	Chevy Kodiak	Height w/AC	11'-10.5"	Black	52 gal.
Engine	325 Hp. V-8	Width	101"	LP Gas Tank	64 lbs.
Fuel	80	Wheelbase	239"	Furnace (BTU's)	30,000
GVWR	19,500	Fresh	94 gal.	Water Heater w/DSI	6 gal.
Length	34'-9"	Grey	52 gal.	Ext Storage	99.52

* 100 Gal. fresh water includes hot water heater

GULF STREAM



COACH, INCORPORATED

FAMILY VALUE

Chassis

- CHEVY, KODIAK V8 ENGINE, 80 GAL FUEL TANK W/POWER LOCKS & WINDOWS

Structural

- SLIDE OUT ROOM (SOFA, DIN)
- SLIDE OUT ROOM (KING BED) (6331)
- SLIDE OUT ROOM (BED/WARDROBE) (6340)
- WELDED ALUMINUM PERIMETER FRAME
- LAMINATED RADIUS DUCTED ROOF
- LAMINATED STEEL FRAME FLOOR W/METAL UNDERBELLY

Exterior

- RADIUS TINTED WINDOWS
- SLIDE OUT TOPPER (6316)
- (2) SLIDE OUT TOPPERS (6331 6340)
- BASEMENT STORAGE
- SPRING CLIPS FOR STORAGE DOORS
- BUMPER COVER
- DOUBLE ELECTRIC STEP
- STAINLESS STEEL WHEEL INSERTS
- UNDERCOAT PAINT
- REAR MUD FLAPS
- HEATED & REMOTE EXTERIOR SIDEVIEW MIRRORS

Décor

- ROLL GOODS IN KITCHEN, BATH, & HALL; CARPET OTHER AREAS

Heating & Cooling

- DASH AC
- 13,500 BTU DUCTED AC
- 30,000 BTU FURNACE (6316)
- 35,000 BTU FURNACE (6331 6340)

Electrical

- JENSEN FOLD DOWN TV TRAY (6316)
- CEILING LIGHT WALL SWITCH

- MONITOR PANEL
- GENERATOR SWITCH & HOUR METER
- TV JACK IN BEDROOM
- CABLE TV READY
- CD PLAYER IN CAB
- TV ANTENNA W/AMP & BOOST

Bath

- NEO-ANGLE SHOWER W/PLATINUM SHOWER DOOR (6316, 6331)
- SKYDOME
- POWER BATH VENT

Power

- AUXILIARY BATTERY
- 30 AMP SERVICE W/CONVERTER & AUTO CHANGE OVER
- GENERATOR PREP
- BATTERY DISCONNECT

Furnishings

- QUEEN BED W/LIFTS, INNERSPRING MATTRESS, BEDSPREAD & PILLOWS (6316 6340)
- KING BED W/LIFTS, INNERSPRING MATTRESS, BEDSPREAD & PILLOWS (6331)
- SINGLE BARREL CHAIR
- 2-WAY D/P SEATS W/ARMRESTS
- H-A-B SOFA
- PLEATED PRIVACY DOOR
- PLEATED NIGHT SHADES THROUGHOUT
- INSIDE HANDRAIL

Appliances

- 6 GAL ELECTRONIC IGNITION WATER HEATER W/BY-PASS VALVE
- LP GAS TANK
- CARBON MONOXIDE DETECTOR
- LP LEAK DETECTOR
- 2-WAY DBL DOOR REFER

Popular Options

- ☐ SUPER C PACKAGE (REQUIRED) M&T CABINET DOORS (RAISED PANEL IN KITCHEN & LR) HARDWOOD STILES & TRIM COMFORT PLUS DINETTE UPGRADED LIGHTING SUPERSLICK FIBERGLASS EXTERIOR WALLS OTR CONVECTION MICROWAVE W/3-BURNER TOP 10,000 LB HITCH RUNNING BOARDS
- ☐ STABIL-RIDE SUSPENSION SYSTEM (REQUIRED)
- ☐ DIESEL PACKAGE DURAMAX 6.6 L DIESEL CHASSIS ELECTRONIC EXHAUST BRAKE 3.6 ONAN LP GENERATOR
- ☐ JACKS
- ☐ EXTERIOR PAINTED SKIRT
- ☐ 15,000 BTU DUCTED AC IPO 13,500 AC
- ☐ HEATED HOLDING TANKS
- ☐ 4.0 ONAN GENERATOR - ENCLOSED
- ☐ 4.0 GENERAC GENERATOR - ENCLOSED
- ☐ EMERGENCY START SWITCH
- ☐ DUAL AUXILIARY BATTERIES
- ☐ BACK-UP MONITOR
- ☐ 3-SPEED FANTASTIC FAN (KITCHEN)
- ☐ FLUORESCENT LIGHT
- ☐ DSS PRE-WIRE
- ☐ DVD PLAYER
- ☐ HOME THEATRE SURROUND SOUND
- ☐ SIDE CABOVER ENTERTAINMENT CENTER W/FLAT SCREEN COLOR TV
- ☐ OUTSIDE ENTERTAINMENT CENTER
- ☐ PHONE JACK
- ☐ FULL CABOVER ENTERTAINMENT CENTER W/FLAT SCREEN COLOR TV
- ☐ REAR FLAT SCREEN COLOR TV W/REMOTE (6331)
- ☐ 16" ROLL OUT AWNING
- ☐ FRONT WINDOW
- ☐ REAR WINDOW
- ☐ LADDER
- ☐ SPARE TIRE & CARRIER (6331 6340)
- ☐ LRG 2-WAY DOUBLE DOOR REFER
- ☐ RANGE COVER

**24 MONTH
24,000 MILE
WARRANTY
ON STRUCTURAL
COMPONENTS***

1 year or 12,000 mile total use warranty under normal use against defects in material and/or workmanship in construction and original components. For purposes of this warranty, structural components shall be limited to the structure of the side walls, front and back walls, roof and floor. See the official written Gulf Stream Coach, Inc. Warranty for details.

Coach-Net®

24 HR. EMERGENCY ROADSIDE ASSISTANCE

- One Year Coach-Net Membership
- Towing and Winching
- Flat Tire Change
- Mobile Mechanic
- Delivery of emergency fluids
- Jump-Start / Battery
- Lockout

Gulf Stream Exclusive Features & Benefits

SOLID HARDWOOD CABINETRY



PREDRILLED HARDWOOD CONSTRUCTION

Our residential style cabinets are constructed of solid hardwood doors and fronts that are predrilled and screwed then they are stained and top coated with a furniture grade finish that provides long lasting beauty and durability as well as adding strength and quietness to your motorhome.

COMPETITOR'S CABINETRY

Other companies use wrapped cabinet fronts prone to peeling, fading and tearing. The softer composite wood used does not hold screws as well as hardwood resulting in loss of strength and squeaking. Discoloration will degrade the beauty and lower the value of the motorhome.

GALVANIZED STEEL STORAGE COMPARTMENTS

Seamless, carpeted, galvanized steel storage compartments safely cradle your valuables. Rust protective paint and foam sealed for extended life and a quiet ride.

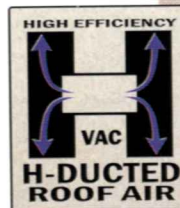

Dual metal H-Ducted air conditioning system with foil bubble wrapped insulation for improved climate control.

Comfort Plus Furniture



Unlike traditional plywood and foam seating Comfort Plus Seating features the strength of steel and the comfort of a sprung dinette cushion.

FLUSH FLOOR Slide out



Gulf Stream Class C's offer flush floor slides for a residential look and feel with 6 foot ceilings in the slideroom.

SUPER STRENGTH TRUSS SYSTEM



6" & 8" C CHANNEL EXTENSION

The super strength truss system is unmatched in the class C industry. The structural subfloor foundation begins by welding a network of integrated steel trusses to the chassis rail. Specifically designed to distribute and transfer the tremendous forces from the coach to the chassis rail these trusses are individually tested to withstand 6,000 pounds each.

When the chassis is stretched, Gulf Stream stands alone in the industry by using a full (6" on LE) or (8" on Super C) C channel extension versus the traditional 4" or less. This practice adds to the strength of the foundation and offers peace of mind that towing is safe on an extension that is true to the chassis.



Cradle of Strength

OR
rooms



The Gulf Stream Class C's have nearly 7' interior ceilings for a residential look and feel with 6 foot ceilings in the slideroom.

TUFF-TRUSS
6000 lbs.



1. Seamless Rubber Roof For Greater Energy Efficiency and Dependability.
2. Luan Decking for Additional Strength.
3. Molded, High Density EPS (Expanded Polystyrene) Roof Brick Insulation - Provided Consistent Insulation Value as well as Superior Dimensional Rigidity.
4. One-Piece Formed Aluminum Air Conditioning Duct, Completely Surrounded By EPS Insulation.
5. Bubble-Wrapped Foil Insulation Provides Superior Insulation and Helps Prevent Condensation.
6. Rugged Welded Tubular Aluminum Roof Framing.
7. Rugged Heavy-Gauge Tubular Aluminum, Fixture Welded to Form the Sidewall Framing.
8. High-Density EPS Insulation Provides Superior Lamination and Bonding Characteristics and Insures Greater Energy Efficiency.
9. Interior Wall Panels Securely Laminated to Sidewall Framing.
10. "Super Slick" Fiberglass Exterior Vacuum-bond Laminated to Sidewall Framing for Lasting Beauty and Durability. (Option)
11. High-Quality Stain-Resistant Carpeting Available in Designer Coordinated Colors.
12. Extra-Thick Padding Under Carpet Provides Extra Comfort and Increases Carpet Durability.
13. Floor Decking Laminated to Steel Floor Structure Assures a Quiet, Long-Lasting Rigid Floor and comes with a 10-Year Warranty.
14. Heavy-Gauge Tubular Steel Framing, Fixture Welded for Extra Strength and Stability.
15. Heavy-gauge Tubular Steel Framed, Fixture Welded Floor Truss System Provides the Strongest Class C Foundation in the Industry.
16. Seamless Layer of Galvanized Steel Securely Laminated to the Steel Floor Framing.
17. Galvanized Steel Used to Form Each Storage & Holding Compartment.
18. Durable All-Weather Carpeting Completes Each Accessible Storage Compartment, Providing Extra Protection for Luggage and Valuables.
19. Rust-Prohibitive Paint Coating Applied to All Steel Framing Assures Corrosion and Rust Protection.
20. The Industry's Strongest, Most Spacious Exterior Storage Compartments.

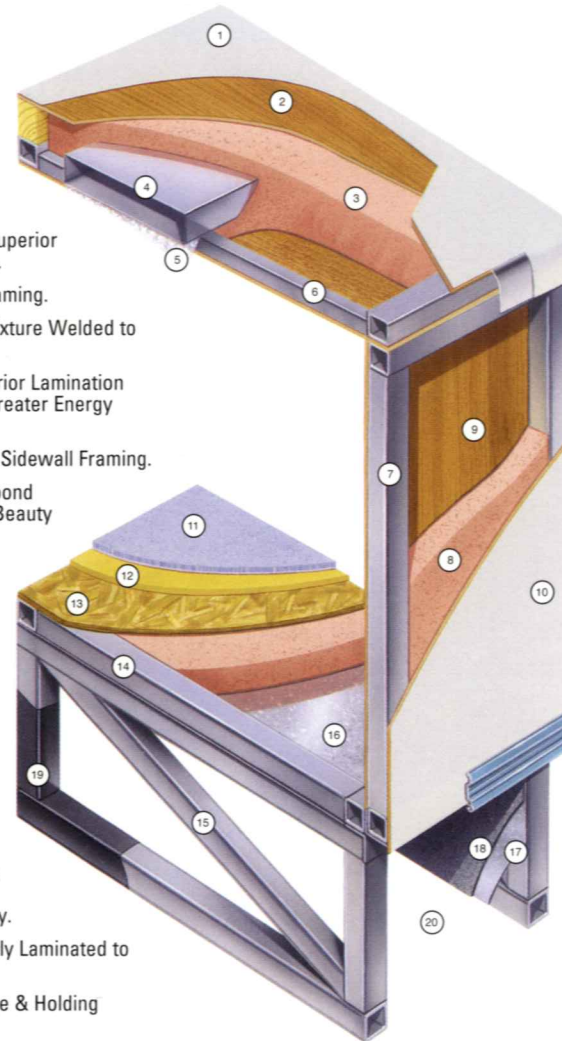

TAKE THE TIME TO COMPARE...

and you will see the exceptional value of a Gulf Stream Coach

Ultra Limited Edition



BEDROOM • MODEL 6254

CORNER BEDROOM...

Unique space saving corner bedroom provides more open floorspace in the living area by eliminating the wasted space on both sides of the bed.

STORAGE...

Many Limited Edition floorplans have cavernous storage areas under the bed equipped with gas charged lifters for easy opening and aluminum frame lid for strength.

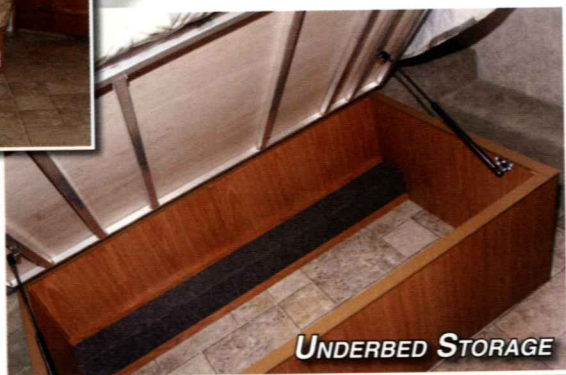

UNDERBED STORAGE



GALLEY • MODEL 6236

KITCHEN...

Our rear corner galley offers all the comforts of your kitchen at home. 3-burner high performance range; 2-door, 2-way refrigerator and large convection microwave, you will be able to prepare any of your family's favorite meals.

SPACIOUS LIVING...

Open living areas that incorporate large slide rooms and residential style furniture make home away from home very comfortable.



LIVING ROOM • MODEL 6236



OPTIONAL
SIDE CAB-OVER ENTERTAINMENT CENTER

ENTERTAINMENT...

The optional side cab-over entertainment center featuring a large flat screen TV and plenty of storage for music and movies to entertain everyone on a rainy day or quiet evening.

GULF STREAM



COACH, INCORPORATED

FAMILY VALUE



LIVING QUARTERS • MODEL 6316

Ultra Limited Edition

MODEL 6211

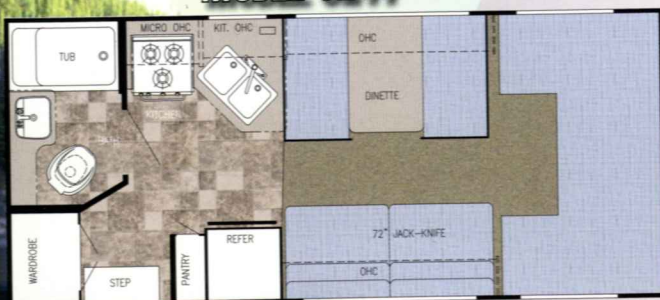

Chassis	Ford E350
Engine	Ford V-10
Fuel	37
GVWR	10,700
Length	22'-4"
Height w/AC	11'-6"
Width	101"
Wheelbase	138"
Fresh	22 gal.
Grey	30 gal.
Black	30 gal.
LP Gas Tank	42 lbs.
Furnace (BTU's)	25,000
Water Heater w/DSI	6 gal.
Ext Storage	3.8 cu. ft.

MODEL 6236



Chassis	Ford E450	Height w/AC	11'-6"	Black	30 gal.
Engine	Ford V-10	Width	101"	LP Gas Tank	64 lbs.
Fuel	55	Wheelbase	176"	Furnace (BTU's)	25,000
GVWR	14,050	Fresh	32 gal.	Water Heater w/DSI	6 gal.
Length	24'-10"	Grey	30 gal.	Ext Storage	20.8 cu. ft.

MODEL 6254



Chassis	Ford E450	Height w/AC	11'-6"	Black	30 gal.
Engine	Ford V-10	Width	101"	LP Gas Tank	64 lbs.
Fuel	55	Wheelbase	179"	Furnace (BTU's)	25,000
GVWR	14,050	Fresh	32 gal.	Water Heater w/DSI	6 gal.
Length	25'-11"	Grey	30 gal.	Ext Storage	42.0 cu. ft.

MODEL 6280



Chassis	Ford E450	Height w/AC	11'-6"	Black	36 gal.
Engine	Ford V-10	Width	101"	LP Gas Tank	42 lbs.
Fuel	55	Wheelbase	196"	Furnace (BTU's)	25,000
GVWR	14,050	Fresh	34 gal.	Water Heater w/DSI	6 gal.
Length	29'-7"	Grey	36 gal.	Ext Storage	59.45 cu. ft.

MODEL 6295



Chassis	Ford E450	Fresh	34 gal.
Engine	Ford V-10	Grey	36 gal.
Fuel	55	Black	36 gal.
GVWR	14,050	LP Gas Tank	64 lbs.
Length	29'-9"	Furnace (BTU's)	30,000
Height w/AC	11'-6"	Water Heater w/DSI	6 gal.
Width	101"	Ext Storage	31.62 cu. ft.
Wheelbase	208"		

MODEL 6316 D



Chassis	Ford E450	Height w/AC	11'-6"	Black	36 gal.
Engine	Ford V-10	Width	101"	LP Gas Tank	64 lbs.
Fuel	55	Wheelbase	208"	Furnace (BTU's)	30,000
GVWR	14,050	Fresh	34 gal.	Water Heater w/DSI	6 gal.
Length	31'-7"	Grey	36 gal.	Ext Storage	49.80 cu. ft.

Chassis

- 138" WB, FORD E-35, V-10 ENGINE, 35 GAL FUEL TANK & POWER LOCKS & WINDOWS (6211)
- 158" WB, FORD E-45, V-10 ENGINE, 55 GAL FUEL TANK & POWER LOCK WINDOWS (NA 6211)

Structural

- SLIDE OUT ROOM (H-A-B SOFA) (6236 6295)
- SLIDE OUT ROOM (REFER, DIN) (6254)
- SLIDE OUT ROOM (BED) (6295)
- SLIDE OUT ROOM (SOFA, DIN) (6316)
- WELDED ALUMINUM PERIMETER FRAME
- LAMINATED RADIUS DUCTED ROOF
- LAMINATED STEEL FRAME FLOOR W/METAL UNDERBELLY

Exterior

- SMOOTH FIBERGLASS EXTERIOR WALLS
- RADIUS TINTED WINDOWS
- SLIDE OUT TOPPER (6236 6254 6316)
- (2) SLIDE OUT TOPPERS (6295)
- BASEMENT STORAGE
- SPRING CLIPS FOR STORAGE DOORS
- BUMPER COVER
- SINGLE MANUAL STEP (NA 6211)
- DOUBLE ELECTRIC STEP (6211)
- MAG LOOK WHEEL COVERS
- UNDERCOAT PAINT
- EXTERIOR SIDEVIEW MIRRORS
- REAR MUD FLAPS

Décor

- VINYL CARPET RUNNER
- ROLL GOODS IN KITCHEN, BATH, & HALL; CARPET OTHER AREAS

Heating & Cooling

- DASH AC
- 13,500 BTU DUCTED ROOF A/C
- 25,000 BTU FURNACE (NA 6295 6316)
- 30,000 BTU FURNACE (6295 6316)

Electrical

- CEILING LIGHT WALL SWITCH
- MONITOR PANEL
- GENERATOR SWITCH & HOUR METER
- TV JACK IN BEDROOM (NA 6211 6236)
- TV ANTENNA WITH AMP & BOOST
- CABLE TV READY
- CD PLAYER
- BEDROOM TV SHELF (NA 6211 6236 6254 6295)

Bath

- TUB SURROUND (NA 6316)
- CORNER SHOWER W/PLATINUM
- NEO-ANGLE SHOWER DOOR (6316)
- SKYDOME (NA 6211 6254)
- POWER BATH VENT

Power

- BATTERY DISCONNECT
- AUXILIARY BATTERY
- CONVERTER WITH CHARGER & AUTO CHANGE OVER
- GENERATOR PREP

Furnishings

- QUEEN BED W/INNERSPRING MATTRESS & BEDSPREAD (6254)
- QUEEN BED W/LIFTS, INNERSPRING MATTRESS & BEDSPREAD (6295 6280 6295 6316)
- ALUMINUM FRAME BED BASE & TOP (NA 6211 6236 6254)

- SINGLE BARREL CHAIR (6254 6316)
- DINETTE BOOTH BED
- 2-WAY DR/PASS SEATS W/ARM REST
- J-KNIFE SOFA (6211 6280 6316)
- PLEATED PRIVACY DOOR (6275 6280 6295 6316)
- PLEATED NIGHT SHADES THROUGHOUT
- PRIVACY CURTAIN IN BEDRM (6254)
- HAB SOFA (6236 6295)
- INSIDE HANDRAIL

Appliances

- 6 GAL ELECTRONIC IGNITION WATER HEATER W/BY-PASS VALVE
- LP GAS TANK
- CARBON MONOXIDE DETECTOR
- LP LEAK DETECTOR
- 2-WAY DOUBLE DOOR REFER

Coach-Net®
24 HR. EMERGENCY ROADSIDE ASSISTANCE

- One Year Coach-Net Membership
- Towing and Winching
- Flat Tire Change
- Mobile Mechanic
- Delivery of emergency Fluids
- Jump-Start / Battery Boost
- Lockout

**24 MONTH
24,000 MILE
WARRANTY
ON STRUCTURAL
COMPONENTS***

*1 year or 12,000 miles total use warranty under normal use against defects in material and/or workmanship in construction and original components. For purposes of this warranty, "Structural components" shall be defined as the structure of the side walls, front and back walls, roof and floor. See the official written Gulf Stream Coach, Inc. Warranty for details.

GULF STREAM



COACH, INCORPORATED

FAMILY VALUE

STANDARD
EXTERIOR
GRAPHICS



OPTIONAL
PAINTED SKIRT



Popular Options

- LE PACKAGE (REQUIRED)
 - M&T CABINET DOORS (RAISED PANEL IN KITCHEN & LIVING ROOM)
 - DELUXE EXTERIOR MIRRORS
 - OTR CONVECTION MICROWAVE W/3-BURNER TOP
 - COMFORT PLUS DINETTE
 - UPGRADE LIGHTING
 - HARDWOOD STILES & TRIM
- UPGRADED WOOD DASH (NA CHEVY CHASSIS)
- CARPET THROUGHOUT COACH
- ROLL GOODS THROUGHOUT COACH
- 139" WB, CHEVY VORTEC 6.0 ENG., 35 GAL FUEL TANK (6211)
- 159" WB, CHEVY VORTEC 6.0 ENG., 57 GAL FUEL TANK (6280)
- FORD DIESEL TURBO CHASSIS (6280)
- 15,000 BTU DUCTED AC IPO 13,500
- SOLAR CHARGE W/13,500 BTU DUCTED AC
- SOLAR CHARGE W/15,000 BTU DUCTED AC
- HEATED HOLDING TANKS
- EMERGENCY START SWITCH
- 4.0 ONAN GENERATOR - ENCLOSED
- 4.0 GENERAC GENERATOR - ENCLOSED
- 3.6 ONAN GENERATOR W/LP CONVERSION KIT (6280 DIESEL ONLY)
- BACK-UP MONITOR
- 3-SPEED FANTASTIC FAN
- FLUORESCENT LIGHT
- DSS PRE-WIRE (NA 6211)
- REAR FLAT SCREEN COLOR TV W/REMOTE (6295)
- SINGLE ELECTRIC STEP (STD 6211)
- DVD PLAYER
- SIDE CABOVER ENTERTAINMENT CENTER W/FLAT SCREEN COLOR TV
- CABOVER ENTERTAINMENT CENTER W/FLAT SCREEN COLOR TV
- OUTSIDE ENTERTAINMENT CENTER (6254 6280 6295 6316)
- J-KNIFE SOFA IPO DINETTE (6211 6236 6280 6295)
- TWIN BUNK BED W/WARDROBE, INNERSPRING MATTRESSES (6280)
- BUNK BED W/DIN, INNERSPRING MATTRESSES (6280)
- SECOND REAR PRIVACY CURTAIN (6280)
- PHONE JACK
- HEATED & REMOTE MIRRORS
- SPARE TIRE & CARRIER
- STAINLESS STEEL WHEEL LINERS
- ALUMINUM RUNNING BOARDS
- FIBERGLASS RUNNING BOARDS
- EXTERIOR PAINTED SKIRT AREA
- SLICK FIBERGLASS EXTERIOR WALLS
- OUTSIDE RINSE & WASH SPRAY SYSTEM (6280 6295 6316)
- HITCH W/PLUG
- 12'-3" ROLL OUT AWNING (6236)
- 13'-5" ROLL OUT AWNING (6211 6280 6295)
- 16' ROLL OUT AWNING (6316)
- 17' ROLL OUT AWNING (6254)
- SLIDE OUT PANTRY W/(4) BASKETS (6295)
- LADDER
- FRONT WINDOW
- REAR WINDOW (6280 6295 6316)
- GLASS SHOWER DOOR (6280)
- BI-FOLD SHOWER DOOR IPO CURTAIN (6211 6236 6254 6295)
- DELUXE STOOL (6211 6295 6316)
- LARGE 2-WAY DOUBLE DOOR REFER (#3862)
- RANGE COVER



GULF STREAM



COACH, INCORPORATED

FAMILY VALUE

POST OFFICE BOX 1005

• YOUR GULF STREAM COACH DEALER •

NAPPANEE, IN 46550

GULF STREAM FACILITIES...

Located in the heart of the Amish country, the complex, along with Gulf Stream's affiliate, Fairmont Homes, Inc., covers over 400 acres and includes more than 1.5 million square feet of state-of-the-art manufacturing facilities. With over 20 years of manufacturing experience producing quality Recreational Vehicles, Gulf Stream is the leading manufacturer of high quality and high value RV products that are distributed through a partnership relation with independent dealers who are focused on meeting customer expectations.

EXCEPTIONAL VALUE...

Your family and friends will feel safe and comfortable wrapped in Gulf Stream's "Cradle of Strength". Comfort, Quietness and Insulation from the elements is what you will experience from Gulf Stream's "Tried and Tested" Motorhomes. Compare... and you will find the exceptional value of a Gulf Stream Motorhome.



The Gulf Streamers RV Club is a valuable benefit to all Gulf Stream owners. Members enjoy staying active and participating in the various rallies and caravans offered throughout the United States and Canada. The Main Stream, the club Magazine, with up-to-date product information, service tips and company highlights. Members benefit from the Emergency Road Service and Gulf Streamers Insurance options. Both are available at competitive rates with friendly, reliable service. The 10% discount program at campgrounds throughout the U.S. and Canada. As a member, you'll receive discounts at National Theme Parks and special attractions, including RV and travel guides, directories and magazines.

Gulf Streamers spend time touring attractions, enjoying fabulous meals, taking in area highlights and shows to help make the most out of your RV experience. Special rallies throughout the year include Gulf Stream supplier seminars, complimentary minor repairs by Gulf Stream technicians, Gulf Stream dealer product displays and round table discussions to voice your product improvement ideas.



VISIT

WWW.GULFSTREAMRV.COM

FOR MORE DETAILED INFORMATION...
OR CALL 1-800-765-8787-EXT. 3288

For more information and available options, contact your local Gulf Stream dealer, www.gulfstreamRV.com or Gulf Stream Coach, Inc. Gulf Stream Coach, Inc., reserves the right to make changes in prices, colors, materials, components and specifications and to discontinue models at any time without notice or obligation. Gulf Stream Coach, Inc., assumes no responsibility for any error in type or print reproduction of specifications or floorplans in this brochure. Photographs may show equipment or items that are optional and are not included in the purchase price of the coach. Test drive and review a current model at your nearest Gulf Stream dealer. © 2002 Gulf Stream Coach, Inc., Nappanee, Indiana U.S.A.

11/05-SP-15K