

The Original Ultra-Lite Travel Trailer

# AEROLITE & CUB

Ultra-Lite Expandables

DESIGNED FOR MINIVANS, SUV'S, CROSSOVER VEHICLES & HALF-TON TRUCKS!



EXPLORE YOUR HORIZONS



# CUB ULTRA-LITE EXPANDABLES

The industry's best Expandable, featuring innovative floorplans with Therm-a-Rest® tent ends!



For active families on the go, Cub Expandables add sleeping space without the additional length and weight of traditional travel trailers. The ultra-lite design and aerodynamic profile make Cub a dream to tow.

Plus, the interior of Cub is packed with high-end features, including designer décor, large kitchens with abundant storage, expansive living spaces and comfortable sleeping areas. So, when it is time for your next expandable travel trailer, choose Cub, your best value in ultra-lite expandable travel trailers.



7 Floorplans starting at  
2528 lbs!

Cub Expandable 214 in Spring Green





# AEROLITE ULTRA-LITE TRAVEL TRAILERS

Aerolite - The Original Ultra-Lite Travel Trailer

Since 1996



Aerolite Travel Trailer 31RL-DSL in Pearl Grey shown with Residential Furniture Package Option



Aerolite, the original Ultra-Lite travel trailer, features 18 innovative floorplans, ranging from 24' to 35'. With units light enough to be towed by SUV's, minivans, crossover vehicles and light trucks, we are sure to have the best model for your family.

Just because Aerolite is an Ultra-Lite, it doesn't mean your trailer is light on storage. With spacious countertop and cabinet space and oversized pass-through exterior storage, it's easy to take everything along on your next adventure.

Aerolite - The original & still the leader in Ultra-Lite technology.

**Base weights starting at  
3555 lbs!**

## Harmony White Cabinetry Package

An attractive Harmony White Cabinetry Package with Cherry plank linoleum is available with any Cub Expandable or Aerolite Travel Trailer.





# ULTRA-LITE FULLY LAMINATED, 6-WAY ALUMINUM FRAMED CONSTRUCTION

**STRONG, DURABLE  
ULTRA-LITE  
CONSTRUCTION**



## AEROLITE AND CUB Expandable & Travel Trailer Key Construction Features

- I-beam powder-coated chassis
- Enclosed and heated underbelly (NA Expandables)
- Equa-Flex suspension
- 6-Way welded, aluminum framed body
- 6-Way lamination - walls, roof & floor
- Tinted safety glass windows
- Aerodynamic front profile
- Up to 6'6" Interior height
- Nitrogen filled radial tires
- Aluminum framed dinette/furniture
- Diamond plate front rock guard

## Revolutionary Therm-a-Rest® Tent



Cub Expandables, the leading innovator in ultra-lite RV technology, and Therm-a-Rest®, inventor of the self-inflating camping mattress and manufacturer of premium outdoor equipment, have teamed up to develop the innovative new "Auto-pop" tent. Cub chose Therm-a-Rest® to design this ground-breaking product because of the company's 30-plus years of experience enhancing the comfort of outdoor enthusiasts. The result is an RV tent that features easier setup, more livable comfort, and greater protection than anything that's come before.

Aerolite and Cub features aluminum-framed dinette frames. Aluminum frames are more durable than wood-framed structures and save weight.



## AERODYNAMIC ULTRA-LITE DESIGN FOR BETTER FUEL ECONOMY!

### AEROLITE & CUB DÉCOR CHOICES

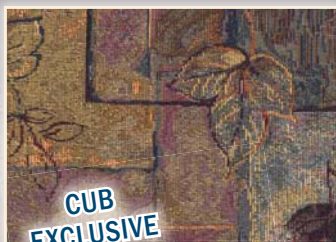

PLUM LEAF



VANILLA MOCHA



TOMMY GREEN



NICKEL



SPRING GREEN



GLACIER BLUE



CARAMEL APPLE



PEARL GREY



# CUB ULTRA-LITE EXPANDABLES FLOORPLANS

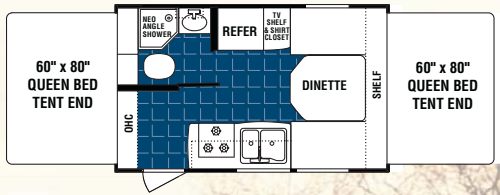

160

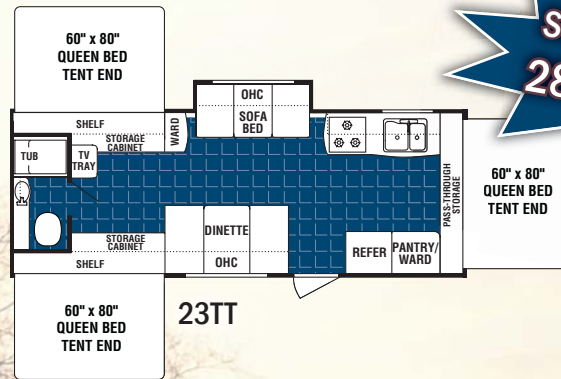

23TT

**STARTING AT  
2862 LBS!**

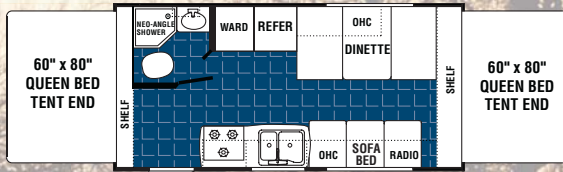

185

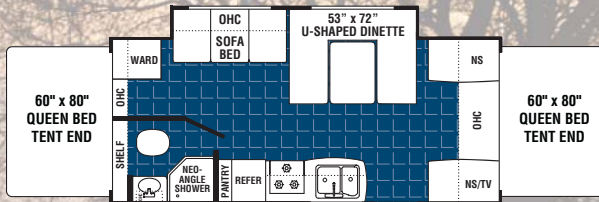

214

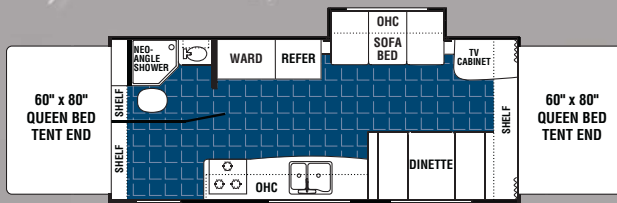

235

## ULTRA-LITE EXPANDABLE TOY HAULERS

185THV

214THV

## WEIGHTS & SPECIFICATIONS

	160	185	214	235	23TT	185THV	214THV
Axle Weight	2528	3206	3696	3524	3857	3754	4690
Dry Hitch Weight	334	286	373	362	517	612	419
Unloaded Vehicle Weight	2862	3492	4069	3886	4374	4366	5109
Net Cargo Capacity	888	1508	1231	1414	1093	2634	2391
Exterior Length (closed)	17'6"	20'4"	24'1"	24'4"	26'4"	29'6"	32'10"
Exterior Height with A/C	9'8"	9'8"	9'8"	9'8"	9'8"	10'7"	10'7"
Exterior Width	8'	8'	8'	8'	8'	8'	8'
Fresh Water Tank (Gal.)	38	38	38	38	38	38/38	38/38
Gray Water Tank (Gal.)	39	39	39	39	39	39	39
Black Water Tank (Gal.)	22	22	28	22	28	22	28
Furnace Size (BTUs)	18,000	18,000	19,000	19,000	19,000	19,000	19,000

Tire Size (all models, NA THV): ST205/75D14(C) Tire Size THV: LT235/75R15(C)  
Interior Height (all Expandable models): 6'4"

## REAL WEIGHTS!

**DID YOU KNOW** that every Aerolite and Cub is weighed at the factory as it leaves the production line? Our certified weight includes options!



Most competitors publish only a base weight that does not include options. Make sure that you know what the "real" weight of the unit is before you buy your next ultra-lite trailer.

Vehicle loading - Every effort has been made to provide the greatest number of options for the recreational vehicle owner. Along with these choices comes the responsibility to manage the loads that are imposed by the choices that they remain within the manufacturer's specified chassis weight limits. Do not overload the recreational vehicle. Some optional equipment not included.

Net carrying capacity (NCC) is determined by subtracting unloaded vehicle weight (UVW) from gross vehicle weight (GVWR) and includes fluids, options and cargo. Liquid capacities and weights are approximations only. Warning - This information is intended as a guide only. Weights of individual vehicles may vary. Consult your owner's manual for complete loading, weighing and towing instructions. \*UVW and Hitch Dry Weight are base weights of units without options. Each unit includes a weight label which lists specific weight information for that unit.



# AEROLITE ULTRA-LITE TRAVEL TRAILERS

## FLOORPLANS

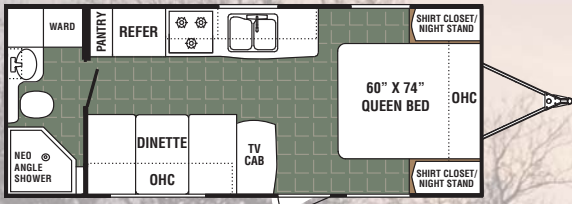

19FL

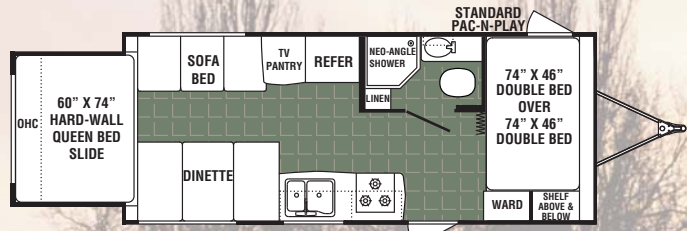

21QS

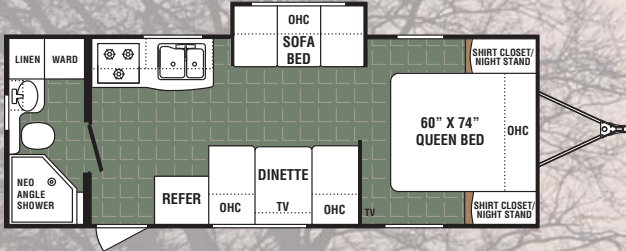

24RB-SL

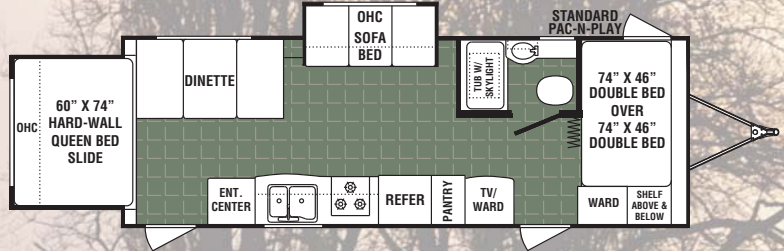

25QS

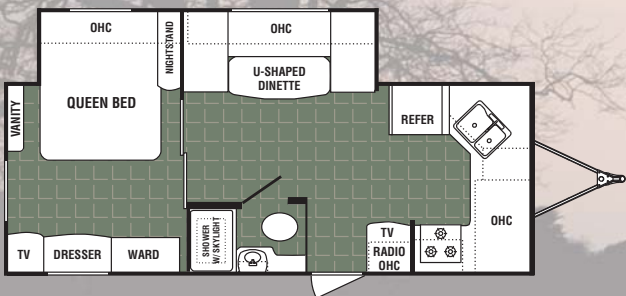

25FKS-DS

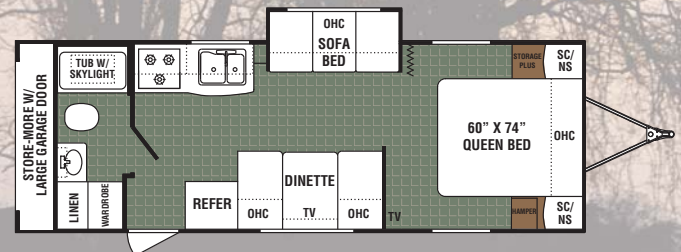

26RG-SL

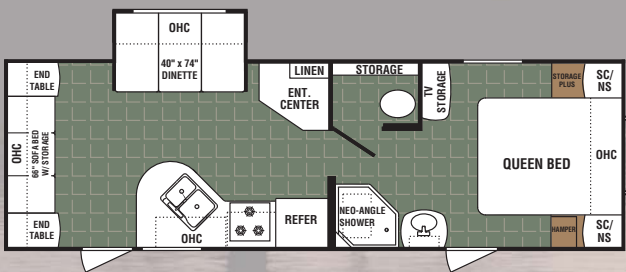

27CD-SL Option: Two chairs in place of rear sofa

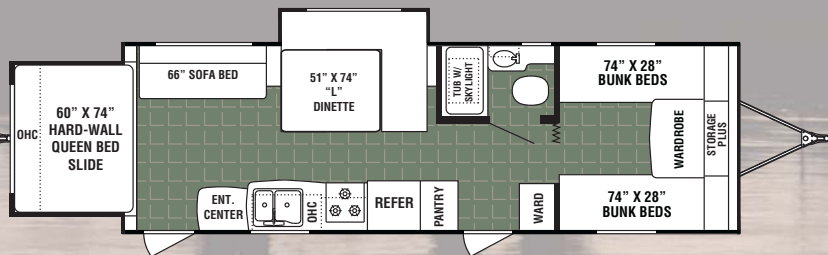

27QSBH-SL

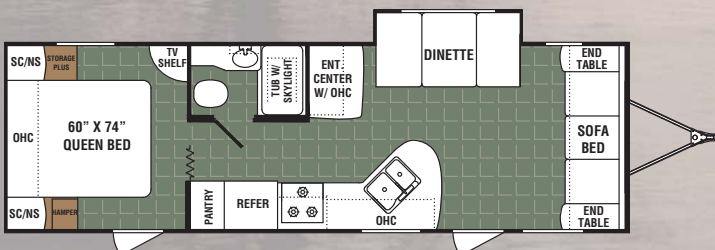

27RB-SL Option: Two chairs in place of front sofa

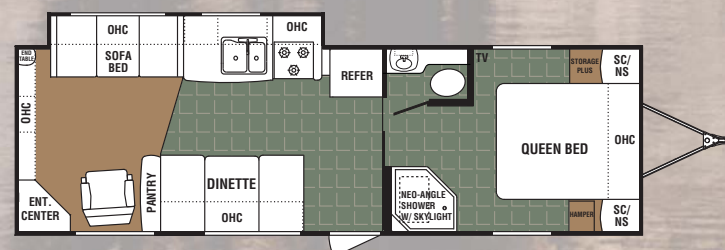

29RLK-SL

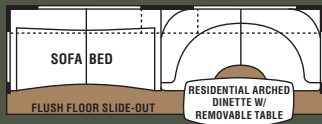

**Residential Furniture Package Option**  
Aerolite DSL floorplans are available with a Residential Furniture Package option that includes an upgraded sofa with air bed and an arched dinette with removable table.

**MOST FLOORPLANS  
WEIGH LESS  
THAN 5000 LBS!**

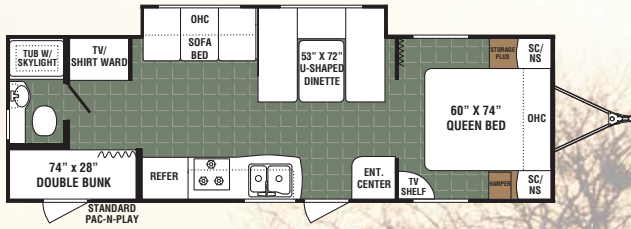

**30BH-SL**

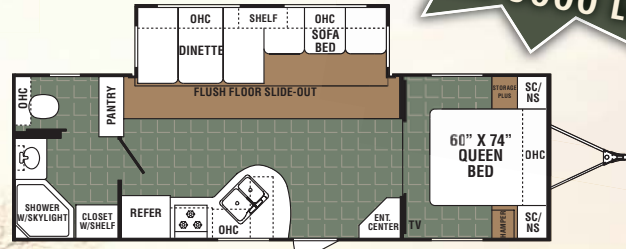

**27FB-DSL** Option: Residential Furniture Package

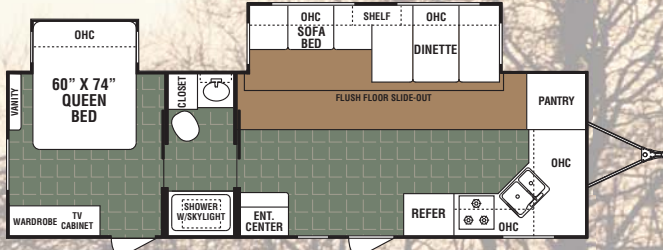

**27FK-DSL-BS** Option: Residential Furniture Package

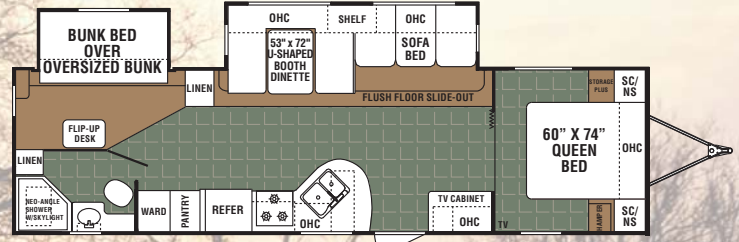

**31BH-DSL** Option: Residential Furniture Package

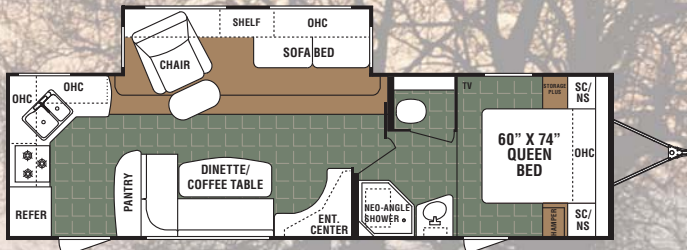

**31RK-DSL** Option: Residential Furniture Package

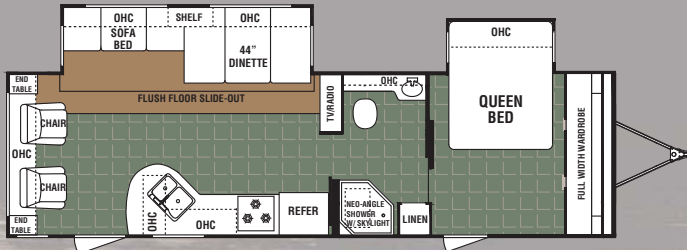

**31RL-DSL** Option: Residential Furniture Package

## ULTRA-LITE TOY HAULERS

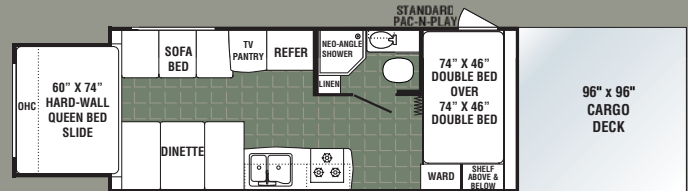

**21QSTHV**

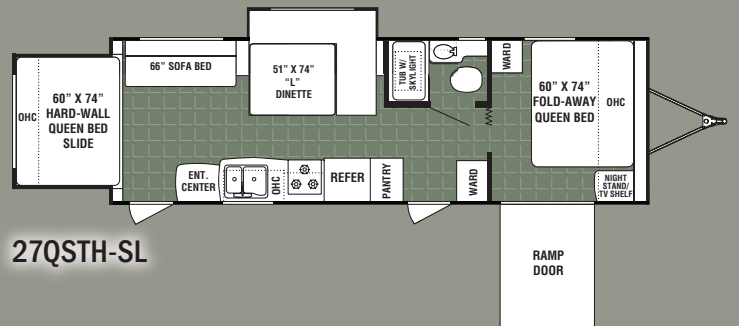

**27QSTH-SL**

## WEIGHTS & SPECIFICATIONS

	19FL	21QS	21QS THV	24RB-SL	25FKS-DS	25QS	26RG-SL	27CD-SL	27QSBSL-SL	27QSTH-SL	27RB-SL	29RLK-SL	30BH-SL	27FB-DSL	27FK-DSL-BS	31BH-DSL	31RK-DSL	31RL-DSL
Axle Weight	3555	3732	4375	3894	4297	4224	4112	4618	4627	4772	4234	4320	4319	5203	5573	5738	5567	5922
Dry Hitch Weight	397	515	639	454	726	384	467	420	382	402	549	698	485	501	626	723	701	674
Unloaded Vehicle Weight	3952	4247	5014	4348	5023	4608	4579	5038	5009	5174	4783	5018	4804	5704	6199	6461	6268	6596
Net Cargo Capacity	1448	1153	2686	1652	977	1392	1421	1562	990	2326	1217	1582	1196	1796	1301	1039	2132	1804
Exterior Length (closed)	24'1"	24'5"	33'4"	26'4"	26'2"	27'1"	28'8"	30'4"	30'4"	30'4"	30'4"	30'11"	30'4"	30'4"	32'4"	35'5"	33'9"	33'9"
Exterior Height w/AC	10'5"	10'5"	10'7"	10'5"	10'5"	10'5"	10'5"	10'5"	10'5"	10'5"	10'5"	10'5"	10'5"	10'8"	10'8"	10'8"	10'8"	10'11"
Exterior Width	8'	8'	8'	8'	8'	8'	8'	8'	8'	8'	8'	8'	8'	8'	8'	8'	8'	8'
Fresh Water Tanks (Gal.)	38	38	38/38	38	38	38	38	38	38	38	38	38	38	46	46	46	46	46
Gray Water Tanks (Gal.)	39	39	39	39	39/39	39	39	39	39	39	28	39	39	39	39/39	39	39/39	39
Black Water Tanks (Gal.)	28	22	22	28	22	22	28	34	22	22	34	34	22	34	34	34	34	34
Furnace Size (BTUs)	19,000	19,000	19,000	19,000	19,000	30,000	19,000	30,000	30,000	30,000	30,000	30,000	30,000	30,000	30,000	30,000	30,000	30,000
Tire Size	■	■	□	■	■	■	■	■	■	■	■	■	■	●	●	●	●	○

■ = Tire Size ST205/75D14(C) □ = Tire Size ST235/75R15(D) ● = Tire Size ST205/75R15(C) ○ = Tire Size ST225/75R15(D)

Interior Height (all Travel Trailer models): 6'6"

See page 5 for vehicle loading information.



# MORE STANDARD FEATURES

FROM THE LEADER IN ULTRA-LITE TECHNOLOGY

## STANDARD FEATURES

	CUB	AEROLITE
6-Way welded aluminum, laminated superstructure (roof, floor and walls)	•	•
Lightweight I-beam frame with E-coat finish	•	•
EPDM one-piece seamless rubber roof	•	•
Enclosed underbelly		•
8' Wide floorplans	•	•
Pac-N-Play exterior storage in bunkhouse	•	•
A & E awning	•	•
Four corner stabilizer jacks with sand pads	•	•
Diamond plate rock guard	•	•
ABS wheel wells and fender skirts	•	•
Equa-Flex suspension system with tandem axles and 4-wheel electric brakes	•	•
Nitrogen filled radial tires	•	•
Spare tire with cover	•	•
Dual battery tray	•	•
2 5/16" coupler	•	•
Rain gutter with corner downspouts	•	•
Hot/cold exterior shower	•	•
4" Square rear bumper with sewer hose storage - bike rack ready	•	•
Tinted, radius corner, clamp ring safety glass windows	•	•
Entry-assist handle at door	•	•
Break-away trailer switch	•	•
120V Exterior outlet	•	•
Two 20 lb. LP bottles with ABS cover	•	
Two 30 lb. LP bottles with ABS cover		•
Radius corner entry door	•	•
Flush combo entry latch/dead bolt lock	•	•
Exterior service lights		•
Therm-a-Rest auto-pop half dome, self-supporting bunk end with futon mattress	•	
Key-locking "easy latch" tent doors	•	
60" x 80" Queen beds in tents	•	
THULE Smart RV System mounting pods with external 110V outlet and cable jack mounted at eye level for picnic table use	•	•
Acu-weight system - All units weighed before leaving the factory	•	•

## Interior Features

Aluminum framed dinette construction	•	•
Solid wood drawers with residential drawer glides	•	•
Residential tile-like linoleum	•	•
Mini blinds	•	•
Designer window treatments	•	•
Stainless steel sink with hi-rise galley faucet	•	•
Fire extinguisher	•	•
LP/Carbon monoxide/smoke detectors	•	•

## Bathroom Features

Fiberlink bathtub	•	•
Shower curtain	•	•
Glass shower door with neo-angle shower (see floorplan for availability)	•	•
Medicine cabinet	•	•
Power roof vent	•	•
Skylight in bath	•	•
Tub surround	•	•

## Bedroom Features

Bunk end lights with fan	•	
4" Thick Futon mattress in bed ends	•	
Innerspring mattress		•
Designer bedroom package with bedspread, headboard and window treatments (see floorplans)		•
Clothes hamper with access to under floor "Storage Plus" (see floorplans)		•

## Appliances & Electrical

Norcold double door gas/electric refrigerator	•	•
13.5 BTU air conditioning	•	•
In-roof ducting for air conditioning (NA 19FL)		•
12V AM/FM/CD stereo with MP3 port and 2 speakers for dry camping	•	•
12V Electric slide-out motor	•	•
30 Amp power cord with storage compartment	•	•
6 Gallon gas/electric water heater with DSI	•	•
12V Interior lights with wall switch	•	•
TV antenna	•	•
Microwave	•	•
Range with oven and stove cover	•	•
Range hood with 12V light and exhaust fan	•	•
Solid state converter with built-in battery charger	•	•
Systems monitor panel	•	•
12V Demand water pump	•	•

Some features listed above may be part of a "Value Package"  
Contact your local dealer for the details

## OPTIONAL FEATURES

Harmony white wood package with cherry plank linoleum	OPT	OPT
THULE Smart RV Package 1: table, 2 chairs, countertop, 2 hooks, trash bin, table caddy	OPT	OPT
THULE Smart RV Package 2: table, 2 chairs, trash bin, table caddy	OPT	OPT
Electric awning	OPT	OPT
Exterior sound system	OPT	OPT
Electric heat pads holding tanks (NA CSA)	OPT	OPT
Water filter system with spout	OPT	OPT
Exterior barbecue grill	OPT	OPT
Aluminum rims	OPT	OPT
Fantastic vent (most models)	OPT	OPT
15", 19" and 26" Flat screen LCD TV with removable Thule wall mount (see floorplans)	OPT	OPT
Free standing dinette (27' models and larger)	NA	OPT
Removable easy clean bedroom carpet	NA	OPT
Bi-fold shower door	NA	OPT
Surround sound system with CD/DVD player	NA	OPT
Pillow top mattress	NA	OPT
15,000 BTU AC (27' models and larger)	NA	OPT
Wall recliner (see floorplans)	NA	OPT
Roof access ladder	NA	OPT
Bike rack (most floorplans)	NA	OPT
Residential Furniture Package (27FB-DSL, 27FK-DSL-BS, 31BH-DSL, 31RK-DSL, 31RL-DSL models only) Includes: upgraded sofa and arched dinette	NA	OPT
Elite Pack (27FB-DSL, 27FK-DSL-BS, 31BH-DSL, 31RK-DSL, 31RL-DSL models only) Includes: hide-a-bed, large double door refrigerator, entry assist handle, lighting package, clock, wall border, dark tinted windows, night shades, raised panel refrigerator door	NA	OPT

Visit us on the web for  
**MORE PHOTOS, NEW FLOORPLANS,  
WARRANTY INFORMATION & MORE!**

**www.AERO-RV.com**

YOUR LOCAL DEALER

ONE YEAR LIMITED WARRANTY  
See Owner's Manual For Details

**THOR**  
INDUSTRIES, INC.

Dutchmen Manufacturing, Inc.  
2164 Caragana Court, Goshen, IN 46526  
Ph. 574.534.1224 - Fax 574.975.0556

Product information, specifications, and photography in this brochure were as accurate as possible at time of printing. Photographs may contain some features that are optional on your vehicle. Since we continually strive to improve our products, actual products may differ. Prices and specifications are subject to change without notice. All capacities are approximate and dimensions are nominal. Some features shown are optional and may be different or unavailable in Canada. Vehicles are designed for recreational use only and not intended for use as a primary residence. All product brand names used in this brochure are registered trademarks of Thor Industries, Inc. Unauthorized use of trademarks is prohibited by law.  
rev.1AC2/09 ©2009 Thor Industries, Inc.