



## STANDARD AND OPTIONAL FEATURES

### Denali Value Package

#### SOLID SURFACE Countertops

- Stainless Steel 60/40 Under-Mount Sink
- Deluxe Metal Pull Out Faucet
- Serving Tray Sink Covers

#### ULTRA STORAGE Cabinetry

- Raised Panel Hardwood Sierra Oak Cabinets, Doors and Drawers
- Pre-Drilled, Screwed Cabinet Construction
- Full Extension Ball Bearing Drawer Glides
- Full Height Pantry, Full Access Cabinets
- Large Pots and Pans Storage Drawers
- Built-in Countertop Extension
- Dedicated Trash Storage Area

#### INTERIOR CENTRAL COMMAND CENTER

- Convenient Location for Main Switches and Monitor Panel

#### BEAU-FLOR Floor Covering

- Upgraded Vinyl Flooring Designed to withstand Extreme Temperature Changes

#### SUPER LOUNGE SLIDE ROOMS

- Oversized U-Shaped Dinette (See Floor Plans)
- Extra Large Storage Drawers Below U-Shaped Dinettes
- Comfort Air - Hide A Bed Sofa with Air Mattress (Mandatory Option)
- Extra Large Storage Drawer Below Sofa

#### Other Denali Value Package Features

- Black Refrigerator Front
- Night Shades Throughout
- Swivel Rockers (See Floor Plans)
- Decorative Hardwood Slide-Out Fascia
- Laundry Chute (See Floor Plans)
- Porcelain Foot Flush Toilet
- Skylight Over Tub or Shower
- Deluxe Pillowtop Mattress
- Residential Carpet with Padding

#### Body/Coach Construction

##### SUPER LITE Construction

#### Walls

- Welded Aluminum Side Wall Construction
- Fully Insulated and Laminated Walls
- Gel Coat Filon Fiberglass Exterior

#### Roof

- Fully Decked Truss Style Walk-On Roof
- 5" Tapered Truss Roof Rafters
- 3/8" Wood Decking
- Residential Fiberglass Insulation
- One-Piece EPDM Rubber Roof Membrane
- Roof Attic Vents
- Radiant Foil Insulation

#### Floor

- 2" X 3" Floor Joists, 12" on Center
- Polypropylene Water Resistant Barrier Attached to Bottom of Floor Structure
- Residential Fiberglass Insulation
- Radiant Foil Insulation
- 5/8" Marine-Grade Plywood Floor
- In Floor Aluminum Heating Duct System
- Insulated and Enclosed Underbelly with Heat Ducted to Tanks

#### ALL WEATHER PREMIUM Insulation Package

- R40 Insulation Rating - Floors, Roof, Front and Gooseneck
- R24 Slide Room Floor
- R9 Walls
- Ducted Heat to Underbelly
- Fully Heated and Enclosed Underbelly
- Enclosed Dump Valves
- Radiant Foil Roof Insulation
- Ventilated Attic

#### Exterior Features

##### EASY HITCH FRONT CAP (Fifth Wheels)

- Front Cap with Expanded Turning Radius for Short Bed Trucks
- Back Up Mirror in Front Cap
- LED Docking Lights

#### EXTERIOR CONVENIENCE CENTER (Fifth Wheels)

- Convenient Location for Utilities
- Black Tank Flush, City Water Fill, Cargo Light
- Detachable Power Cord
- Power Cord Storage Hook with Outside Hanging Clip

#### Other Exterior Features

- Radial Tires
- Spare Tire/Carrier/Cover
- Extended Hitch Pin (Fifth Wheels)
- Radius Corner Entry Door with Dead Bolt Lock
- Full View Screen Door
- Extra Large Entry Assist Handle
- 12V Electric Slideout System with Triple-Seal
- Steel I-Beam Powder Coated Chassis
- Triple Entry Steps with Radius Edges
- Molded Fender Skirts
- Exterior Scare Light
- Exterior Hitch Light
- Cable and Satellite Hook-Ups
- Drip Rail Gutter with Extended Spouts
- Dual 30 Pound LP Bottles with Easy Access Cover
- Sewer Hose Storage
- Dark Tint Safety Glass Windows

#### Other Exterior Features (cont.)

- Black Tank Flush
- EZ Lube Axles
- 6 Lug - 15" Wheels
- 4 Wheel Electric Drum Brakes
- LP Quick Connect

#### Interior Features

##### MEDIA CENTER Premium

##### Entertainment System

- LCD HD Flat Screen TV
- AM/FM/CD/DVD
- Mp3 & IPOD Player Hookup on Stereo
- 4 Int & 2 Ext Speakers with Zone Switch
- Satellite Prep, Cable Jack & Digital TV Antenna with Power Booster
- TV Cable/Electrical Hookups Under Awning
- Hide-A-Bed Sofa with Comfort Air Sleeper

#### Appliance Package

- Oven with Three-Burner Cook Top and Piezo Ignition Oven with Three Burner Cooktop
- Residential Microwave with Turntable
- 6.3 Cubic Foot Double Door Refrigerator
- 6 Gal. Gas/Electric/DSI Water Heater with Bypass
- 13,500 BTU Ducted Air Conditioner
- 30,000 BTU Forced Air Heating System
- Wall Mount Digital Thermostat

#### Electrical, Plumbing & Lighting

- 30 Amp Electrical Service
- 65 Amp Power Converter with Battery Charger
- 110v GFI Receptacles
- Decorative Ceiling Light Above Dinette
- 12V Water Pump
- Hot and Cold Water Low Point Drains
- Water Heater
- Range Hood with 12V Light and Fan
- Monitor Panel
- Smoke Detector
- Carbon Monoxide Detector

#### Climate Control

- 30,000 BTU Furnace Forced Air Heating System
- 13.5K Air Conditioner with Quick Cool Vent
- Ceiling Ducted AC Vents
- Insulated and Foil Wrapped AC Ducting

#### Bedroom Area

- Designer Bedsread, Headboard and Window Coverings
- Below Bed Storage with Gas Struts
- Laundry Chute

#### Bath Area

- Residential Tubs and Showers
- Tub Surround
- Neo-Angle Glass Shower
- Medicine Cabinet with Mirror
- Power Roof Vent
- Bath Tissue Holder
- Towel Hooks and Bar

#### COACHNET ROADSIDE ASSISTANCE PROGRAM

- 1 Year/24 Hr Road Side Assistance Program

#### NITRO-FILL NITROGEN TIRE INFLATION SYSTEM

- Nitrogen Filled Radial Tires
- Helps Protect Tires from Excessive Wear and Deflation

#### Options - All Models

##### DENALI LUXURY PACKAGE

- 8 Cubic Foot Refrigerator
- 10 Gallon Gas DSI Water Heater
- Remote Control System: (Operates)
  - Power Front Landing Gear (Fifth Wheels)
  - Power Rear Stabilizers (Fifth Wheels)
  - Power Front and Rear Stabilizer Jacks (Travel Trailers)
  - Power Patio Awning
  - Exterior Patio Lights
  - Main Slide Out Room

#### Other Options - All Models

- Free Standing Dinette with Four Chairs
- 15K BTU Living Room AC IPO 13K BTU
- 15" Aluminum Rims
- Second Air Mattress Hide-A-Bed (311BH Only)
- Roof Ladder
- Dual Pane Windows

#### Options - Fifth Wheels Only

- 50 Amp Service with Prep for Second A/C
- 16" Aluminum Rims (Some Models)

Some features listed above may be part of a value package - Contact your local dealer for the details

Product information, specifications and photography in this brochure were as accurate as possible at time of printing. Prices and specifications are subject to change without notice. All capacities are approximate and dimensions are nominal. Some features are optional

Follow "DutchmenRV" on



[www.denali-rv.com](http://www.denali-rv.com)

Dutchmen Manufacturing, Inc. PO BOX 2164 • 2164 Caragana Court • Goshen, Indiana 46527 Sales: 574.537.0600 Fax: 574.975.0626

Rev 11/10 © Thor Industries

**Your Local Dealer**



# DENALI

by Dutchmen

## Super-Lite Mid Profile Fifth Wheels

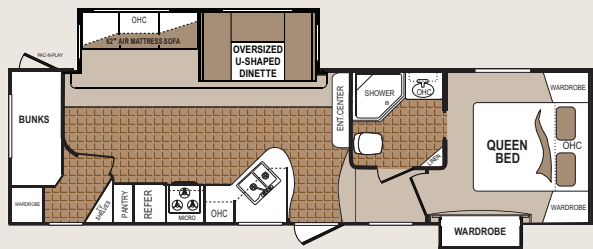

258BHX

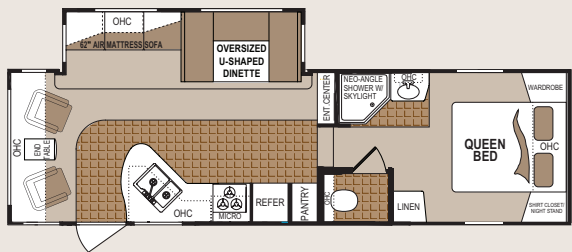

259RLX

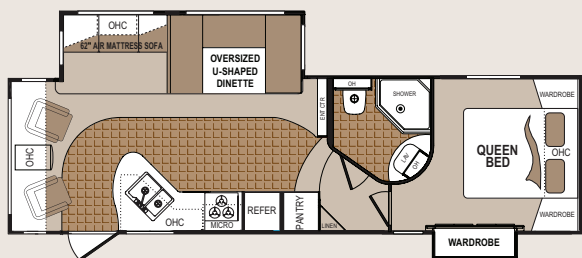

262RLX

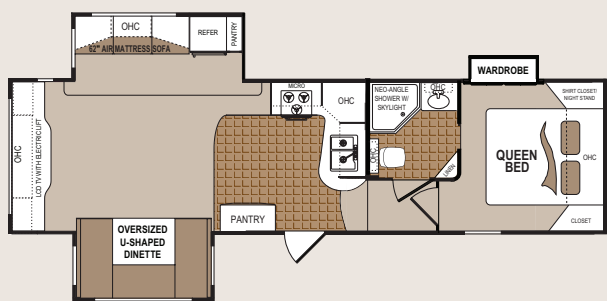

274REX

## Mid-High Profile Fifth Wheels

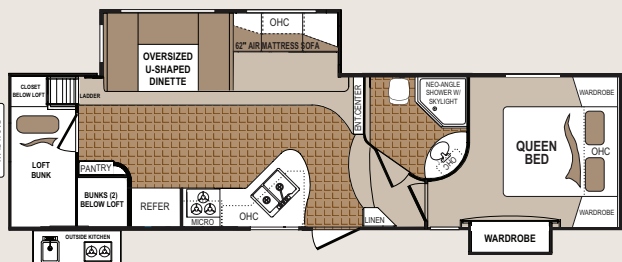

280LBS

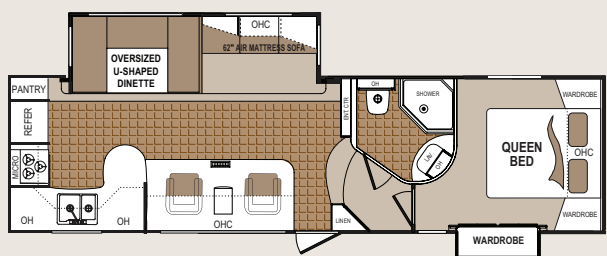

290RKS

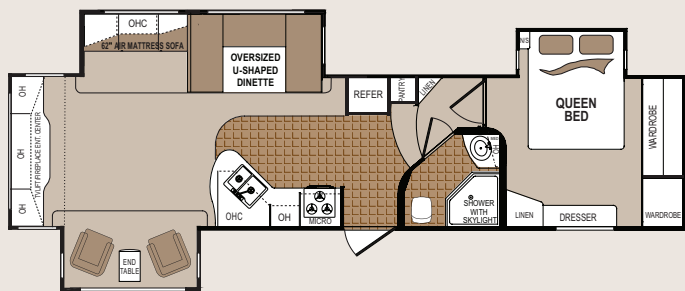

310RES

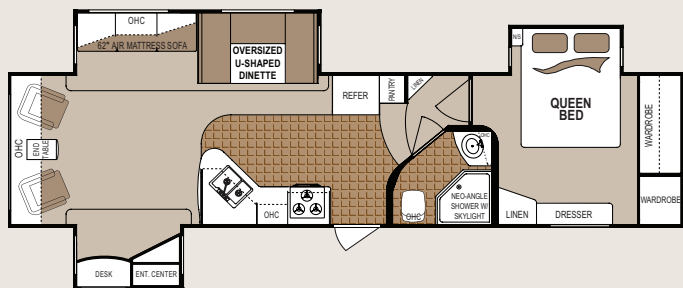

320RLS

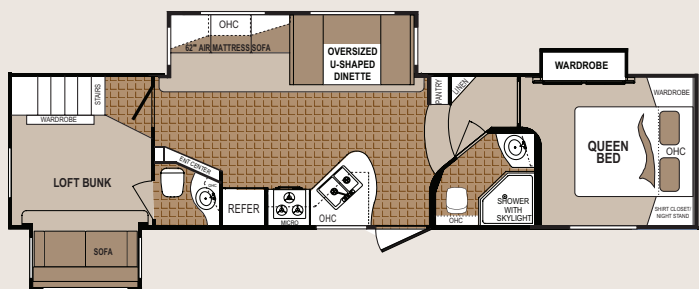

324LBS



## Travel Trailers

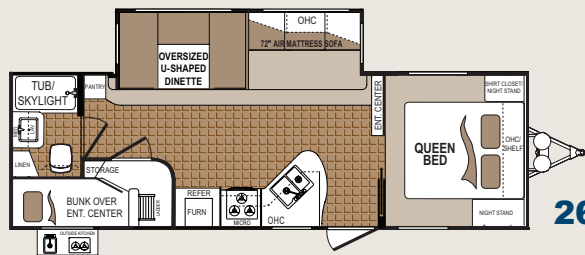

261BH

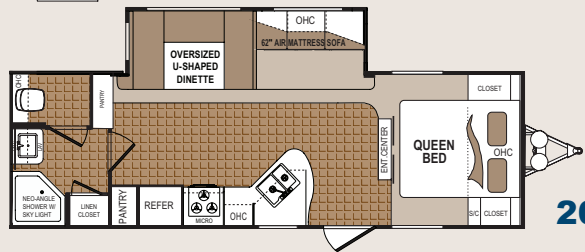

262RB

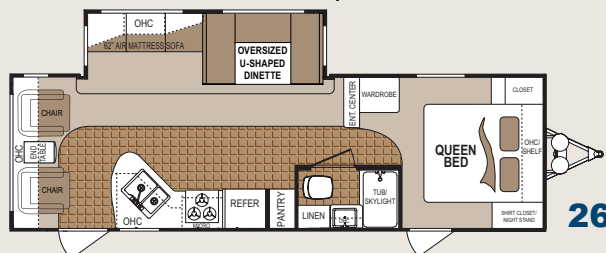

265RL

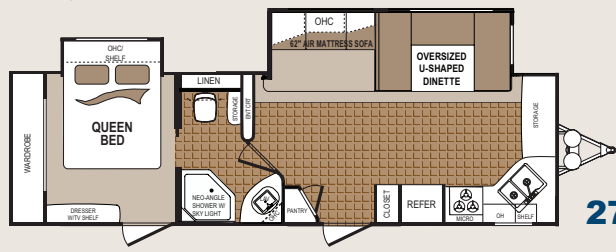

270FK

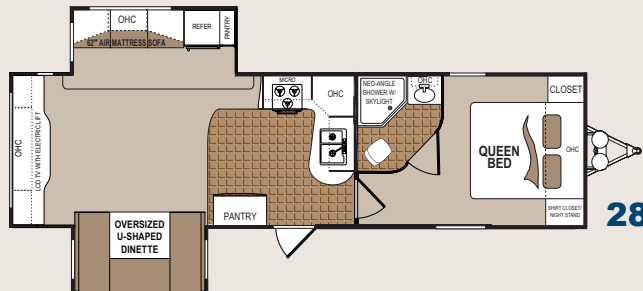

285RE

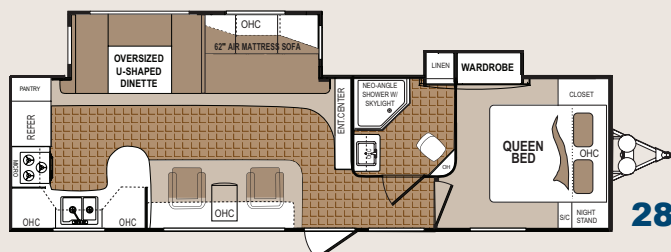

289RK

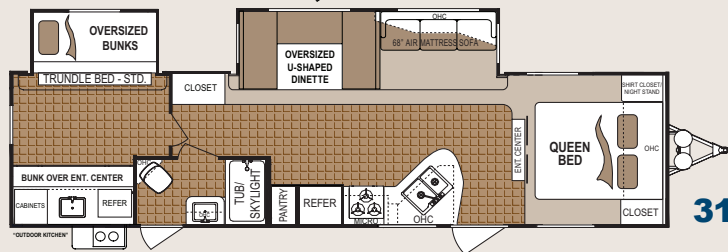

311BH

## WEIGHTS & SPECIFICATIONS

MODEL	HITCH (LBS)	UNLOADED WEIGHT (LBS)	CARGO CAPACITY (LBS)	OVERALL HEIGHT	OVERALL LENGTH	FRESH WATER TANK(S)	BLACK WATER TANK(S)	GREY WATER TANK(S)	FURNACE BTUH OUTPUT
258BHX	1665	8144	2416	11'	31' 3"	46	33	75	30,000
259RLX	1484	7534	3026	11' 4"	30' 5"	46	42	42	30,000
261BH	807	6550	2542	11' 4"	29' 11"	46	33	33	30,000
262RB	786	6476	3204	11'	29' 10"	46	42	42	30,000
262RLX	1601	7794	2766	12'	30' 11"	46	33	75	30,000
265RL	798	6724	2956	11'	30' 11"	46	42	42	30,000
270FK	1294	7138	2542	11' 4"	31' 11"	46	33	66	30,000
274REX	1595	8284	2276	12'	31' 7"	46	33	33	30,000
280LBS	1703	8610	1950	12' 4"	33' 4"	46	33	75	34,000
285RE	782	7266	2414	11' 4"	32' 10"	46	33	33	30,000
289RK	934	7442	2238	11' 4"	33' 8"	46	42	84	30,000
290RKS	1720	8378	3814	12' 4"	32' 8"	46	33	33	34,000
310RES	2001	9600	2592	12' 4"	35' 9"	46	42	84	30,000
311BH	TBA	TBA	TBA	11' 2"	35' 7"	46	42	84	30,000
320RLS	2026	9210	2982	12'	35' 9"	46	42	84	30,000
324LBS	1430	9666	2526	12' 6"	36' 3"	46	84	84	34,000