

1972

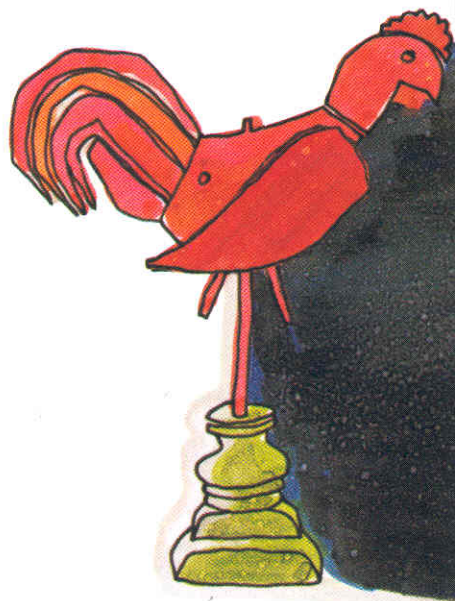

WINNEBAGO®

DECLARE YOUR INDEPENDENCE...GO THE WINNEBAGO ROUTE.



See it your way in a Winnebago...

They left their homelands in search of new freedom. Ahead were countless unknowns. But they were an independent breed who brought to our shores a tradition of determination. From Yorktown to Williamsburg; New Hope to Boston, the American colonies prospered. As craftsmen they inspired new works and left a heritage we preserve and admire today.

In their wisdom a spirit of independence swept the land leaving in the wake our great American traditions. Even today we feel the intense spirit of our forefathers. It lives in a countless number of villages and townships everywhere along the Winnebago route.

Today, self contained comforts can take you to the back door of our American heritage. Winnebago makes it easy. Fun. And exciting. Our *Indian* line of motor homes offers a cross section of the finest recreation vehicles ever built for those with a driving spirit of independence.



Each of the Winnebago *Indians* offers exceptional sleeping facilities with a fold-away front overhead bunk, thick foam mattresses, and twin wall-mounted reading lamps. Either twin beds or a triple fold lounge greets an evening of slumber. Such great sleeping features will prepare anyone to greet a new day of exciting, rewarding adventure when traveling the Winnebago route.

Because you'll spend many hours driving the Winnebago route, we've made the driver's compartment a comfortable, inviting place. There are handsome appointments like vinyl swivel bucket seats with arm and head rests, and a recessed padded dash that contains the conveniently grouped driving instruments. For night travel, a blackout curtain may be pulled the full width of your motor home. Side fresh air vents, an inside rear view mirror, and map reading lights are a few of the other thoughtful standard equipment items that are yours on each of the *Indian* models.





Your home away from home...



For a feast of thanksgiving or more traditional tastes, Winnebago wrote the book on motor home kitchen features. Our *Indian* kitchen and dining facilities are not just added on. They are designed and built as integral parts of your motor home.

Both *Indians* feature a large 6 cubic foot gas/electric refrigerator which can store a bounty of fresh produce, meats, and beverages. A 4 burner stove and automatic oven makes preparing meals a delight. For storage, over 24 feet of overhead cabinets provides enough room for Wedgewood China or your everyday wear.

A double stainless steel sink, an overhead stove vent, and fully color coordinated countertops and backsplash leads to the obvious conclusion that nothing has been left to chance. Maximum value and function have been designed and built into each Winnebago *Indian* motor home.





Every color coordinated *Indian* bathroom offers complete and thoughtful conveniences for travel. A Fiberglass shower, shower curtain, and deluxe medicine cabinet sample the bathroom features. All *Indians* provide a marine type toilet with 30 gallon holding tank, and a 36 gallon pressurized fresh water system that includes a 6 gallon water heater. Added value has been designed and built right into every *Indian* bathroom. Just check all the standard equipment features you get with those provided in other motor homes. It's easy to see why Winnebago outsells all other motor home manufacturers.

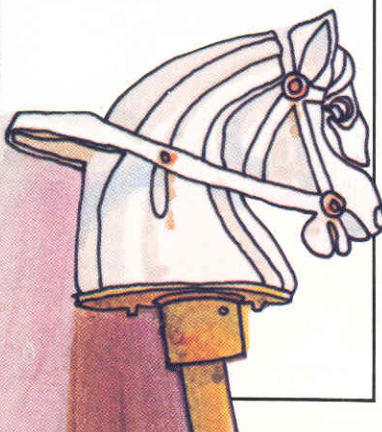
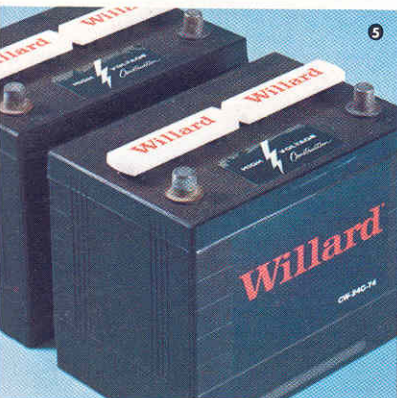
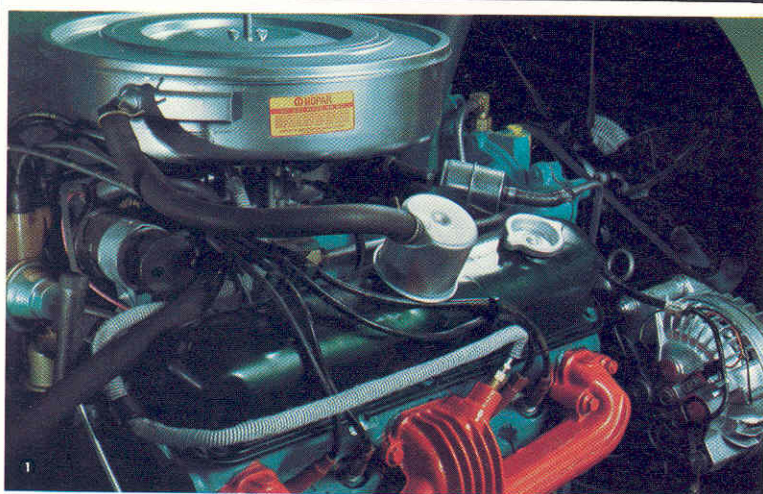

Standard Equipment

A full complement of thoughtful, standard equipment features are provided in both Winnebago *Indian* motor homes. Compare these items as you shop for your best motor home buy.

Interior Features: ☐ Wall-to-wall foam padded nylon carpet ☐ Pre-finished washable vinyl paneled interior ☐ All overhead cabinets have magnetic door catches ☐ Drawers for storage ☐ Convenient 110-volt duplex outlets on separate 110-volt wiring system ☐ Complete set of 12-volt bulbs ☐ Attractive curtains on positive track rods ☐ Hollow core cabinet doors ☒ 23,000 BTU forced air furnace

Kitchen Features: ☒ 6 cu. ft. gas/electric refrigerator ☐ Color coordinated back splash in galley area ☐ Sink cover doubles as bread board ☐ 4-burner stove with automatic oven ☐ Stainless steel double sink

Dinette Features: ☐ Dinette seats have reversible covers with zippers and 5" thick foam ☐ Overhead cabinets above dinette ☐ Dinette converts into bed ☐ Galley extension (D-22 only)

Exterior Features: ☐ All windows tinted and radius cornered ☐ Insulated Thermo-Panel® Construction ☐ Pre-finished aluminum exterior and underbelly ☐ 25 ft. rubberized 110-volt power cord permanently installed with outside access compartment ☐ Rear storage trunk with 12-volt light and lock ☐ Two sky light roof vents ☐ Two large side mirrors ☐ Glide-away step with self-cleaning mesh tread

Safety Features: ☐ Clearance lights comply with laws in every state ☐ Backup lights, parking lights, turn signals with safety flashers ☐ Extra side-mounted turn signals ☐ Door lock complies with National Highway Safety Bureau standard number 206 ☐ Fire extinguisher

Utilities: ☐ City water hook-up ☐ Double 20 lb. LP gas bottles ☐ 12-volt changeover lighting system operates from battery or external 110-volt supply

Sleeping Features: ☐ Wardrobe ☐ Accordion style fold-away front bunk bed with foam mattress and twin reading lights over driver's compartment ☐ Bedroom privacy curtain ☐ Triple fold lounge in D-22 ☐ Twin beds in D-24

Bathroom Features: ☐ Marine toilet with 30 gallon holding tank ☐ 36 gallon pressurized water system with 12-volt pressure pump ☐ 6 gallon water heater ☐ Lavatory ☐ Push button phone head shower ☐ Deluxe medicine cabinet ☐ Power roof vent in bath ☐ Shower curtain ☐ Bath tub (D-24 only)

Driver's Compartment: ☐ Padded dash and arm rest ☐ Removable instrument cluster panel ☐ Vinyl blackout curtain for driver's compartment ☐ Driver compartment fresh air side vents ☐ Deluxe swivel contoured bucket seats upholstered with quilted heavy duty vinyl for driver and co-pilot ☐ Cigarette lighter ☐ 2 ash trays ☐ Map light ☐ Inside rear view mirror ☐ Recessed dash glove compartment with door

Automotive Features: ☒ Twin heavy duty 70 amp batteries with slide out tray ☐ Heavy duty alternator ☐ 4 adjustable defroster vents with blower ☐ Fresh-air automotive heater with blower ☐ Mechanical jack ☐ Windshield washers and wipers ☐ Spare wheel ☐ Tire carrier and cover ☒ Dodge V-8, 413 cu. in. engine ☒ Power steering ☐ Power brakes ☐ Automatic transmission

Anatomy of a motor home / D-22 Indian

- ① Thermo-Panel® Construction in door
- ② Stainless steel double sink
- ③ 8 roomy overhead cabinets for storage
- ④ Deluxe 4-burner LP gas range with automatic oven and roof vent
- ⑤ 6 cubic foot gas/electric refrigerator
- ⑥ Double closet
- ⑦ Forced air ducted heating system
- ⑧ Automotive heater
- ⑨ Thermo-Panel® Construction for roof, floor, and walls with lifetime warranty

- ⑩ 36 gallon pressurized water system and 12-volt pressure pump (additional 30 gallon tank available as an option)
- ⑪ 6 gallon water heater
- ⑫ 12-volt/110 volt converter
- ⑬ Compartment for optional Onan auxiliary power plant
- ⑭ Deluxe wall-to-wall carpeting
- ⑮ Steel cross members under floor
- ⑯ Built-in lavatory with deluxe medicine cabinet
- ⑰ Flexible phone head shower
- ⑱ Marine type toilet
- ⑲ Moulded Fiberglas shower pan
- ⑳ Aluminum underbelly
- ㉑ Dual rear wheels
- ㉒ Polyfoam dinette cushions have quilted stain resistant fabric

- ㉓ Unique boxed in padded dinette backs prevent cushion from flopping out
- ㉔ Convenient slide out battery tray with twin 70 amp. batteries (220 amp. battery is available as an option)
- ㉕ Rear full length divider curtain with nylon rollers
- ㉖ Deluxe contoured swivel bucket seats are upholstered with quilted heavy duty vinyl for both driver and co-pilot
- ㉗ Twin fresh air vents for good air circulation
- ㉘ Power brakes
- ㉙ Power steering
- ㉚ 3-speed automatic transmission

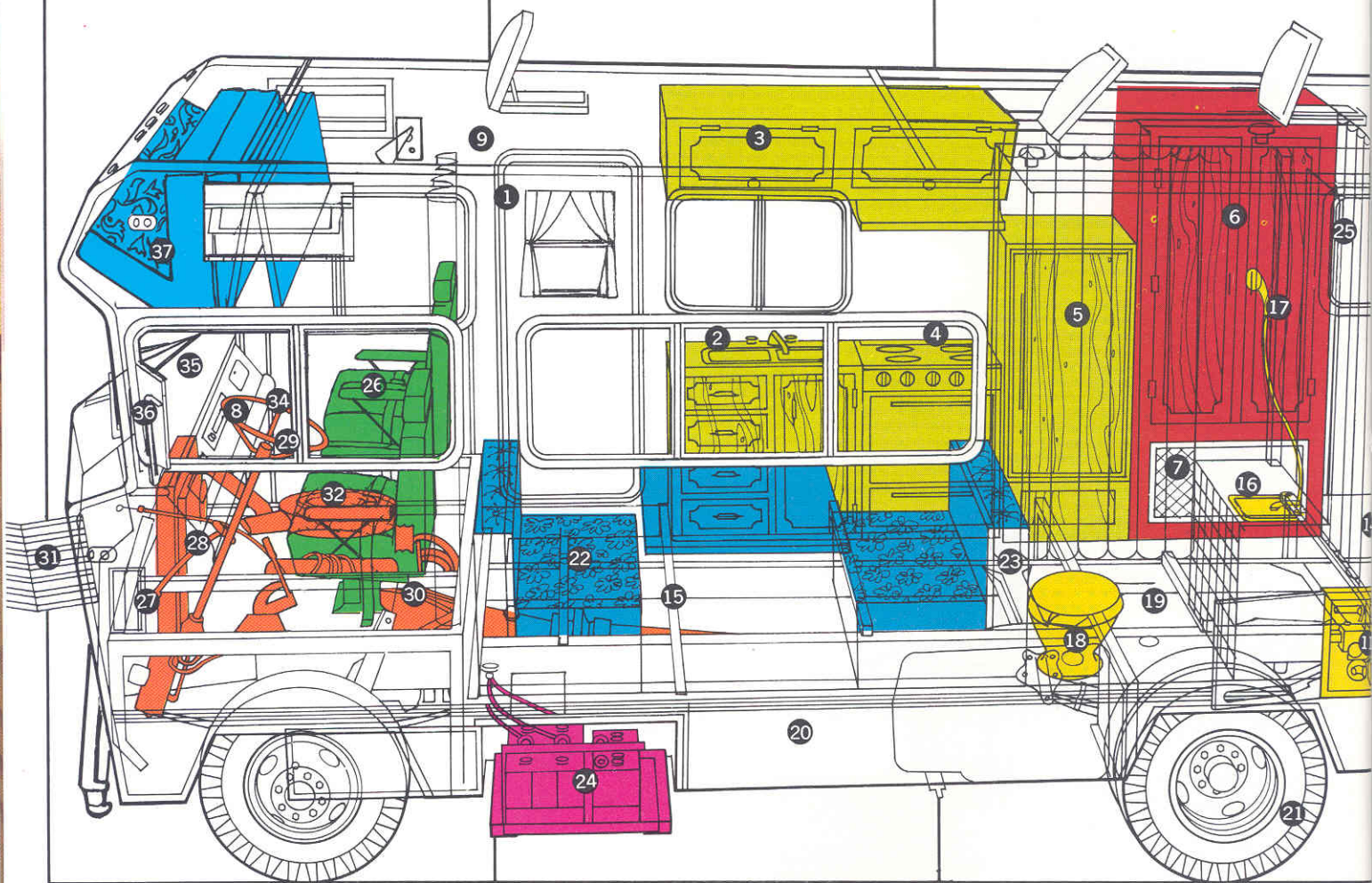

WINNEBAGO

- 31 Front end access door for water, oil, and windshield washer refill
- 32 Dodge M-300 chassis, V-8, 413 cubic inch engine
- 33 Safety glass windows
- 34 Map reading light
- 35 Thick padded dash
- 36 Right and left side rear view mirrors
- 37 Accordion style fold-a-way front bunk bed with foam mattress and twin reading lights over driver's compartment
- 38 Styrofoam** brand foam insulation throughout

All descriptive and pictorial representations of the products in this brochure are believed to be current at the time of publication. However, due to changes in suppliers, design and production, accuracy cannot be guaranteed. Therefore, equipment, colors, material specifications and model availability are subject to change without notice. Please contact your Winnebago dealer for current model specifications.



*Thermo-Panel and Kap are registered trademarks of Winnebago Industries, Inc.

**Styrofoam is a registered trademark of the Dow Chemical Company.

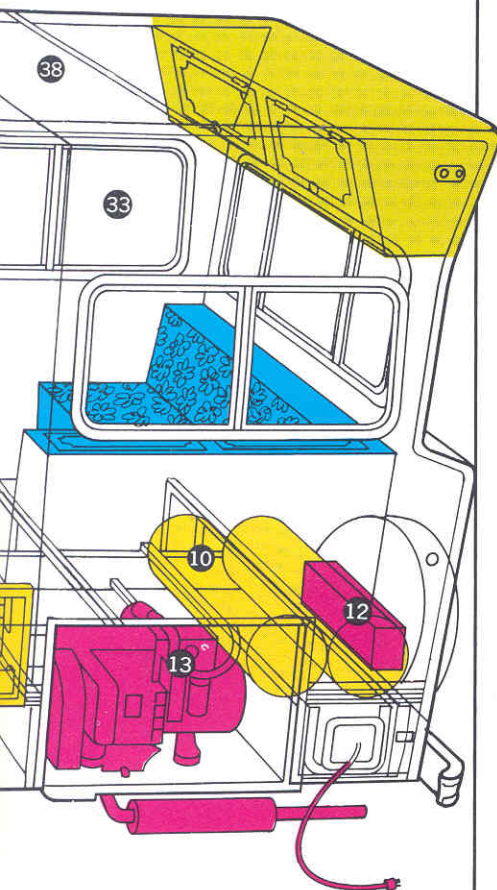

Thermo-Panel® Guarantee

Each new Winnebago motor home, travel trailer, camper coach, or Kap® Pickup Cover using our exclusive Thermo-Panel® Construction process is GUARANTEED against defects in lamination for the lifetime of the product to the original purchaser.

About our brochure cover:

America's rich heritage lives in a score of ways after nearly three centuries. The D-22 Indian was photographed on location at the Jenny Grist Mill not far from such historic sites as Plymouth Rock, the Mayflower II, and the restored Plymouth Plantation at

Plymouth, Massachusetts. The Jenny Grist Mill, the first water powered grist mill in America, is restored and in daily operation. You can visit the mill and a countless number of historic sites anywhere along the Winnebago route.

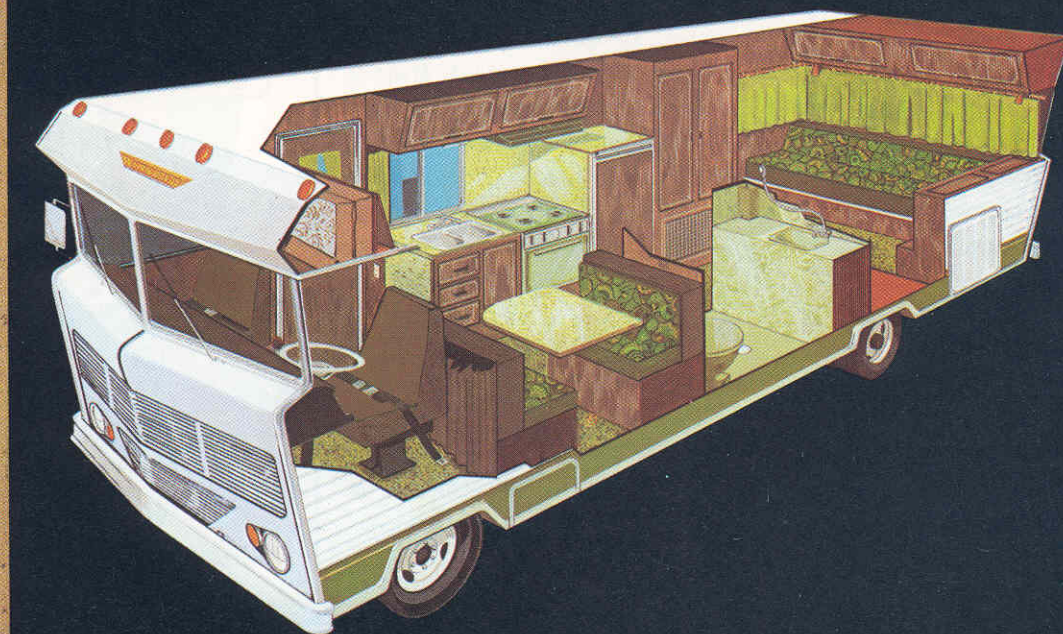

D-22 Indian

Interior motor home comfort inspired the Winnebago D-22 floor plan. Besides the deluxe kitchen, color coordinated bath, and wall-to-wall carpeting, there's a full width rear gauchó that offers a relaxed, comfortable environment for all social occasions.

At night, the gauchó converts easily to a large double bed. (For you 6 footers, ask for a special no-cost optional 49" x 86" bed.)

On the road, your D-22 handles perfectly. Effortless driving is yours with the big V-8, 413 cubic inch engine, automatic transmission, power brakes, and power steering.

The D-22 is a pleasure to drive.

There's never been a motor home anywhere along the Winnebago route that offers more. See for yourself why Winnebago leads the motor home industry. The D-22 Indian certainly accounts for one big reason.

D-22 Specifications

Length, 22'11" / Width, 7'6" / Height, 9'5" / Dodge M-300 chassis / 137" wheelbase / Tires, 7.50 x 16, 6-ply front and dual rear wheels / 60 amp alternator / (2) 70 amp-hour battery / 413 cubic inch engine / V-8 / 265 horsepower / Positive crankcase ventilation system / 3-speed automatic transmission on dash / Power steering / Power brakes.

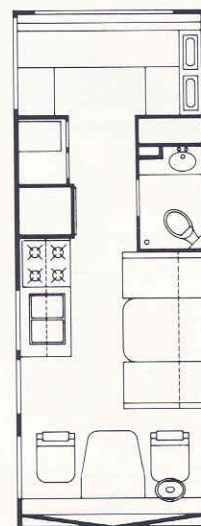

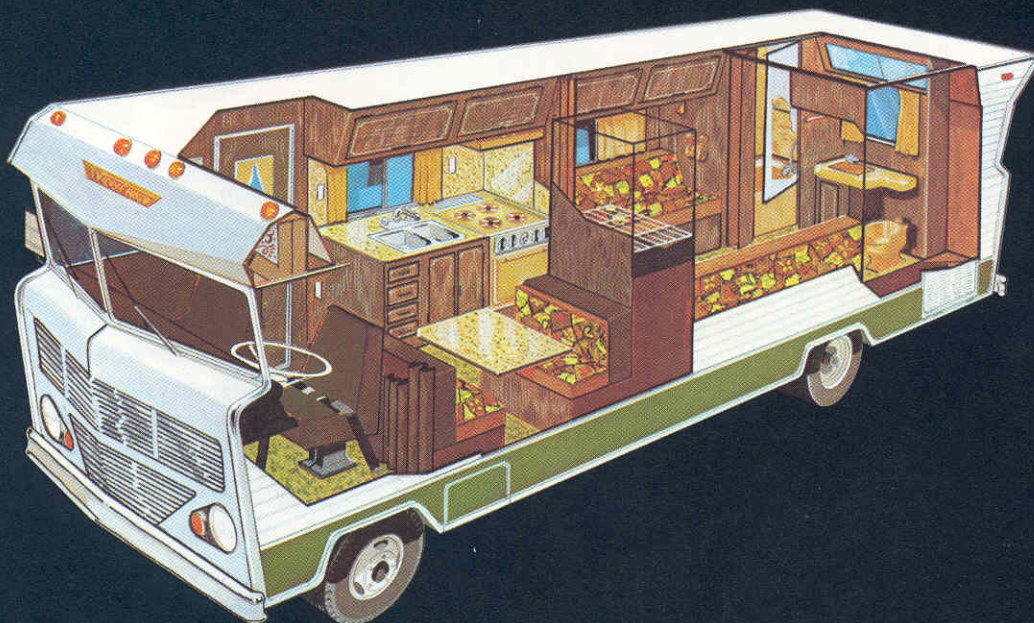

D-24 Indian

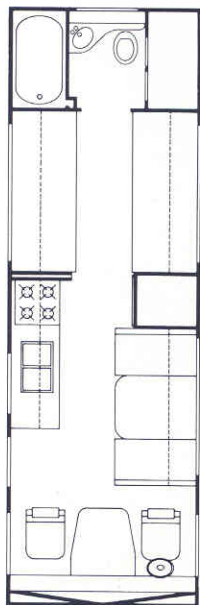

The D-24 *Indian* offers a roomy floor plan and a world of comfortable living accommodations for any season. Perhaps you'll most enjoy the efficient kitchen and dining arrangement. Or perhaps you'll particularly enjoy the comfortable social area with facing lounges that easily convert to full twin beds.

The spacious rear bathroom is, without doubt, the most complete and most efficient yet designed for total motor home comfort. It's a man sized bathroom with all conveniences built-in. Other features include forced air ducted heating, wall-to-wall carpeting, and a front overhead bunk for sleeping extra guests.

We're flattered so many have copied our D-24 *Indian* floor plan. Yet we invite you to compare our D-24 with all others. Dollar for dollar, feature for feature, you'll discover for yourself why the D-24 is both generous in design and value.

D-24 Specifications

Length, 24'5" / Width, 7'6" / Height, 9'5" / Dodge M-375 chassis / 159" wheelbase / Tires, 7.50 x 16, 8-ply front and dual rear wheels / 60 amp alternator / (2) 70 amp-hour battery / 413 cubic inch engine / V-8 / 265 horsepower / Positive crankcase ventilation system / 3-speed automatic transmission on dash / Power steering / Power brakes.

Your Winnebago - A tradition of value and quality.

Winnebago Industries, Inc., designs, engineers, and builds a complete line of outstanding recreation vehicles. With the nation's largest and strongest network of dealers, Winnebago commands an enviable reputation for product availability, quality workmanship, and service. You'll find an authorized dealer close at hand no matter where you might be traveling.

Winnebago is a publicly owned company and in 1970 began trading its stock on the New York Stock Exchange. All products are backed by a financially strong and well respected company that continues in its role as the industry leader.

Winnebago continues to outsell all other motor home manufacturers. The reason is simple enough. We offer you the best recreation vehicle at the lowest possible price.

Winnebago combines raw material buying power with mass production efficiency and vertical integration. Vertical integration simply means that Winnebago manufactures most of its own component parts. That saves money, and insures that all components meet our own high standards of quality and workmanship.

Whether you're a newcomer to the recreation vehicle field, or a seasoned veteran, there's a Winnebago product for you. When you go the Winnebago route, you've purchased the finest RV product that money can buy.



When you buy Winnebago, you're automatically eligible for membership in Winnebago International Travelers Club. W.I.T. is your chance to join in the total fun of recreation vehicle living. You can participate in local rallies, weekend caravan tours or join exciting trips to the far corners of the world.

Your W.I.T. membership also entitles you to big savings on recreation vehicle insurance coverage. And discounts on a growing number of items from campgrounds to sportswear. In addition, every W.I.T. member receives a monthly newspaper to keep everyone informed on the latest local, national, and international happenings. W.I.T. is just another nice thing about owning a Winnebago.

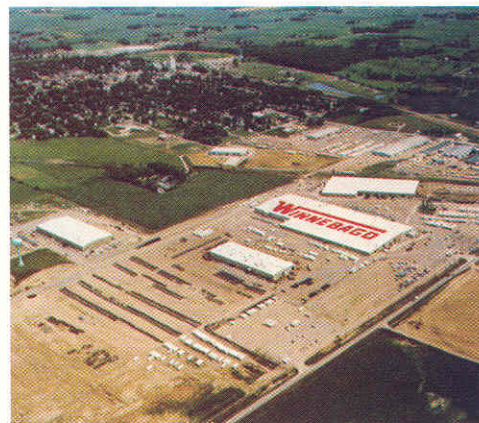

color schemes aplenty

For 1972, our designers have selected three distinctive color schemes. You may select either the Springtime Green, Autumn Rust or Aztec Gold interior. Each scheme strikingly compliments the Shady Elm wall paneling, Consoweld countertops, and kitchen appliances.

Indian bathrooms offer a contrasting Marlite wall paneling and decorator selected appointments. The flattering wall-to-wall carpeting materials blend perfectly with matching drapery and cushion fabrics.

Indian appliances were selected to complement each of the three color schemes. In simple terms Winnebago interiors blend perfectly with your good taste. Both *Indians* are by any design, exceptional motor homes.

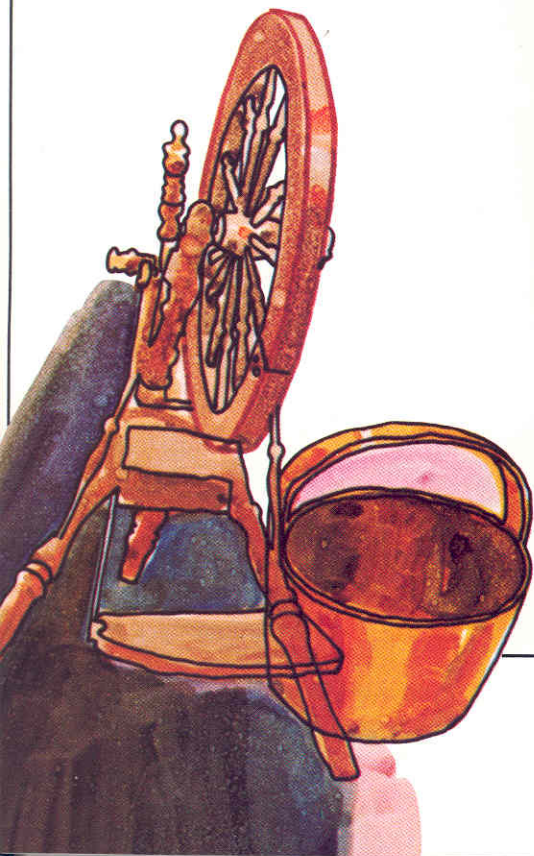
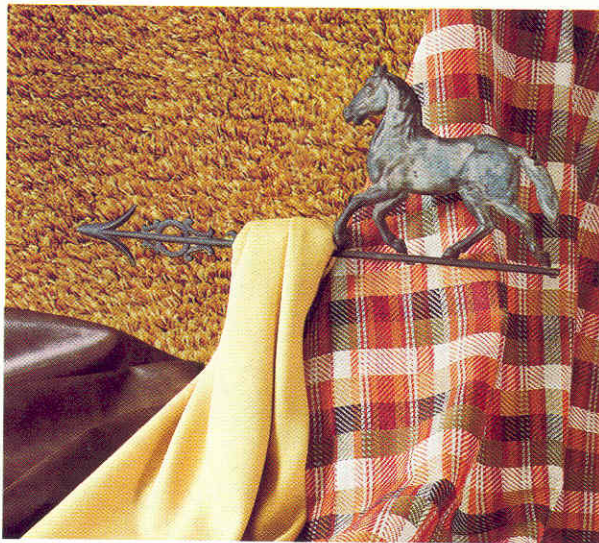
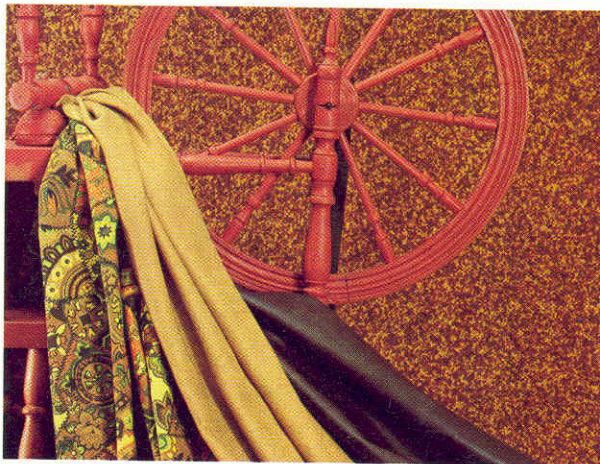

Optional Equipment

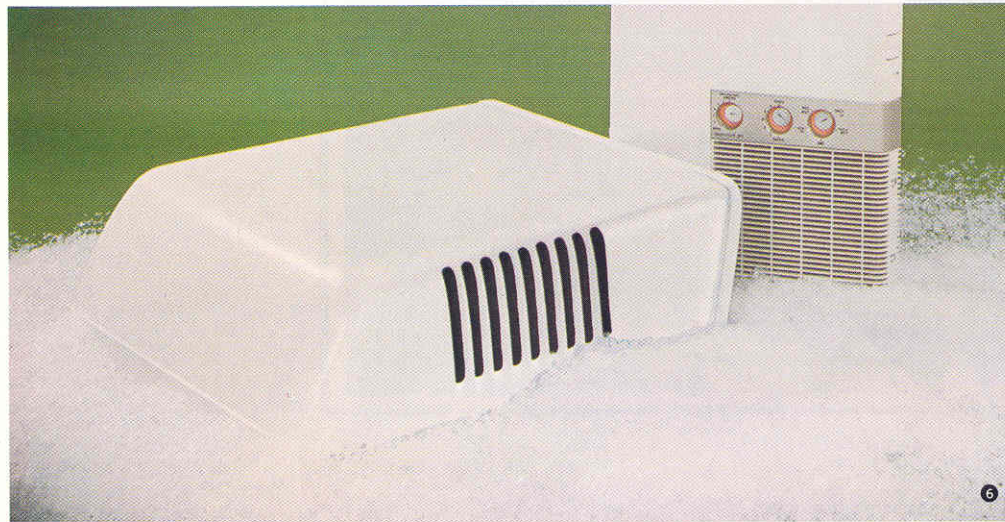

This year Winnebago makes it easy for you to select the optional equipment items that offer maximum comfort and convenience. Based on years of actual customer orders, we now offer optional equipment packages of those items most frequently asked for.

The color codes used below will help you identify the items available in option packages A through F. For example, if you select option package "C", you get all the items indicated in light blue on the accompanying chart.

Option package A	Option package D
Option package B	Option package E
Option package C	Option package F

Optional equipment items listed below are available for purchase individually or in combination with any of the option packages or convenience groups.

- 2 Thermasan waste disposal system
- 30,000 BTU furnace
- 4 Automotive air conditioning
- Built-in vacuum cleaner
- 5 Water purification system
- 7 TV antenna
- Monomatic toilet "A"
- Monomatic toilet "W"
- Chrome bumpers
- Rear window washer and wiper
- Limited slip rear axle
- Luggage rack and ladder
- Front overhead cabinet (exchange for front bunk)
- Motor Aid water heater
- Galley extension (D-24 only)
- Stereo tape system
- FM radio and stereo tape system
- AM/FM radio
- Roll out side awning
- Mor-Ryde rubber suspension system
- Undercoating
- 5000 Onan generator**
- Battery charger (with voltage converter)
- Convex mirrors
- Twin bunks (D-24 only)
- Bolsters (1 set)

OPTION	D-22						D-24					
	A	B	C	D	E	F	A	B	C	D	E	F
Driver's Convenience Group:												
Headrests												
Beverage tray												
Sun visors												
Arm rests												
Tire Group:												
Spare tire												
Snow tires (exchange per tire)												
Power Convenience Group:												
Battery gauge												
Hourmeter												
LP Group:												
40 lb LP tanks												
30 lb LP tanks												
Automatic LP regulator												
Utility Group:												
Auxiliary water *												
① Holding and water tank gauge												
12,000 BTU 110 volt air conditioning												
⑥ 10,000 BTU 110 volt air conditioning												
⑧ 2500 watt Onan generator **												
4000 watt Onan generator **												
Full gaucha												
7 cu. ft. refrigerator												
Auxiliary gas tank												
Double co-pilot seat												
Trailer hitch												
220 amp battery												
AM radio												
⑤ AM/FM radio												
Cruise control												
Rear bunk (D-22) Left bunk (D-24)												
Wire and gas line												
Bolsters (2 sets)												
Screen door												
Front wrap around curtain												
* with heavy duty air compressor												
** with super sound proofing												

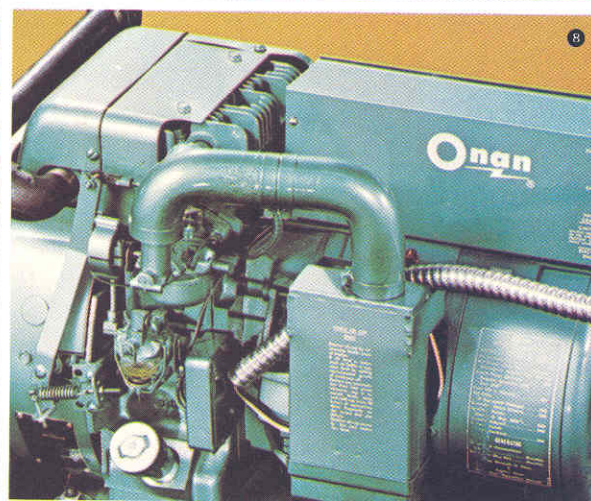
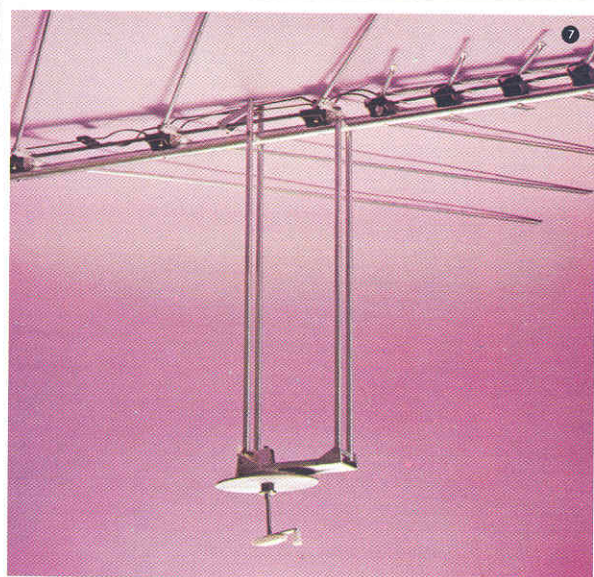



WINNEBAGO INDUSTRIES, INC.
FOREST CITY, IOWA 50436



Chieftain

A variety of distinctively elegant motor home floor plans are available in the exclusive CHIEFTAIN line. For the ultimate in motor home travel luxury, the Winnebago route leads to CHIEFTAIN, the top of the line in motor home living.

Brave

For the high spirited young at heart, Winnebago offers the BRAVE line of motor homes. There's the D-18 Minnie Winnie, a fully self-contained motor home at the industry's best price. And there are other BRAVES economically priced; yet big in value.

Trailers

A variety of trailer lengths and versatile floor plans await your personal inspection.

Campers

Winnebago offers the perfect camper coach for your individual needs.

Kaps

Because we offer more models, there's a Kap® Pickup Cover that will fit your specific needs.