

FIFTH WHEEL & TRAVEL TRAILERS

*Canada's Best! Don't Settle for Less!*



2007

*Citation*  
S U P R E M E



North America's Best **POLAR-PAK**   
THE SUB-ZERO SOLUTION



## Supreme Livability

Experience the "At Home" comfort and livability that only Citation Supreme quality provides. Residential style, "All Season" features are endless! "Stormtite" double glazed thermopane windows, "Dayliter" dual-pane residential skylights, energy saving 2-stage furnaces and exclusive attic ventilation system keeps you warm and condensation free.

What you "can't see" is where Citation excels with surprising features like Nev-R-Lube axles, "Whisper King" water pumps, XT 16 gal. water heaters and pillowtop "Ultimate" mattresses.

New for 2007 is the expansive 34.5 CKTS Platinum with a large island kitchen and a living area that is a comfortable 352 sq.ft. Solid surface counters, Norcold 10 cu.ft. fridge, recessed stovetop and sink, slide-out garbage can, can racks and halogen lighting highlight the kitchen. A handy fold down desk, standard 32" LCD HD TV on a swivel arm with a DVD theatre surround sound system and optional fireplace accent the Entertainment Center area. Hydraulic disc brakes w/lube shackles and Mor-Ryde pin box provide towing safety and a utility compartment houses exterior conveniences such as pop-out hose reel, dump valves and exterior shower. Our unmatched features, quality construction and wide body design provide year round comfort, exclusive livability and worry-free travel.

**Don't Settle for Less!**

*New for 2007, Model 34.5 CKTS - Amaryllis Decor*



*Model 34.5 CKTS Entertainment Center and Slide-Out Kitchen*





We are General Coach, a division of Thor Industries Inc., a western Canadian company that manufactures the well known Citation brand of quality recreational vehicles. For over 55 years we have been consumer established as

builders of high value, superior quality RV's with proven high resale value.

Because we are a limited capacity production company we do not mass produce our products allowing us to ensure strict quality control standards which, in turn, ensures your comfort and satisfaction. Residential quality components and residential style construction techniques are utilized by skilled, conscientious, long term employees dedicated to quality workmanship.

Citation by General Coach is designed for recreational use in western Canadian climate and conditions with "Polar Pak" features second to none. Your peace of mind with your purchase decision is reinforced by Citation's **Six Year Limited Structural Integrity Warranty.**

### **Why a Thor Product Is Your Best RV Value.**

Thor industries, Inc., proudly traces its history back nearly seventy years to the pioneering days of the RV industry with the founding of Airstream, the industry's oldest and most renowned brand. Our total commitment to quality and our philosophy of putting our customers first has led to our continuous growth; today Thor is the largest manufacturer of travel trailers and fifth wheels, a major manufacturer of motorhomes and the largest builder of small and mid-size buses in North America. Thor's strong financial condition and years of solid growth are your assurance that we will be here to serve you for years to come. We think this extra peace of mind is important when you are making a significant investment. Our customers are always #1 with us.

“ General Coach makes a top-line product. We just purchased our fifth General Coach 5th Wheel and are proud of the 34RLTS model - the quality is exceptional, the layout very functional and the decor warm and inviting. Needless to say, we would highly recommend a General Coach product over and above anything else on the market as you receive true value for your dollar. We go to the Calgary RV show every February and no other manufacturer, in our opinion, manufactures a product as good! Warranty and follow-up service at the dealer has always been excellent.

Don & Doreen W.  
Calgary, Alberta



## **Table of Contents**

### **FIFTH WHEELS**

Model 26RKS .....	3
Model 29CKS .....	4
Model 29.5RLS .....	5
Model 29RKDS .....	6
Model 30RLDS .....	7
Model 31CKDS XL .....	8
Model 31.5RLS .....	9
Model 32.5TKS .....	10
Model 33RLTS .....	11
Model 34RLTS .....	12
Model 34.5CKTS PLATINUM XL ..	13

### **TRAVEL TRAILER**

Model 30RLS .....	14
Polar Pak Your Subzero Solution ..	15
Feature Photos .....	16-18
Construction Detail .....	19

## **Citation Supreme, Don't Settle for Less!**

Production information, specifications, photography in this brochure were as accurate as possible at time of printing. Photographs may contain some features that are optional on your vehicle. Since we continually strive to improve our products, actual products may differ. Prices and specifications are subject to change without notice. All capacities are approximate and dimensions are nominal. All products meet or exceed CSA or RVIA standards.

Check with your local dealer for a complete list of options and features on the model you are considering.





The popular Model 34RLTS is shown above in the rich Woodhaven interior. The beautiful cabinetry is adorned with rich, solid beech cabinet doors and modern brushed nickel hardware. Drawers are made with steel guides and rollers for smooth operation. "Taymor" residential single lever faucets with pull-out spray have a lifetime warranty - just part of our commitment to using top quality components. The modern polymer sink is scratch and dent resistant to ensure lasting appeal. All triple slide models have quality "Karadon" solid surface countertops and extra space is provided by a flip-up counter extension. Strategically placed durable linoleum and high quality plush carpets accent this practical, attractive layout.

### Model 34RLTS in Woodhaven Decor



The cozy rear living room of the Model 34RLTS shown with the optional leather fabric recliner chairs and electric fireplace. A 27" flatscreen TV and DVD home theatre surround sound are standard amenities. A computer desk and chair provide a practical workstation while skylights and large solar reflective windows supply extra lighting and spaciousness to the interior. A Rainsensor Fantastic Fan controlled by a convenient wall switch intakes or exhausts with superb airflow. Roofs are 6" thick with R11 insulation. Only General Coach provides a unique "Attic Ventilation System" which consists of a covered vent that allows fresh air into the roof cavity at the rear and a two speed fan that exchanges the air in the roof cavity. This controls condensation in winter and keeps your coach cooler in summer. Just a part of North America's Best \*Polar Pak!

Our low volume production levels allow extra attention to detail and the pride of quality workmanship is evident in all General Coach products.

Model 34RLTS Woodhaven Decor



# FIFTH WHEEL MODEL 26RKS

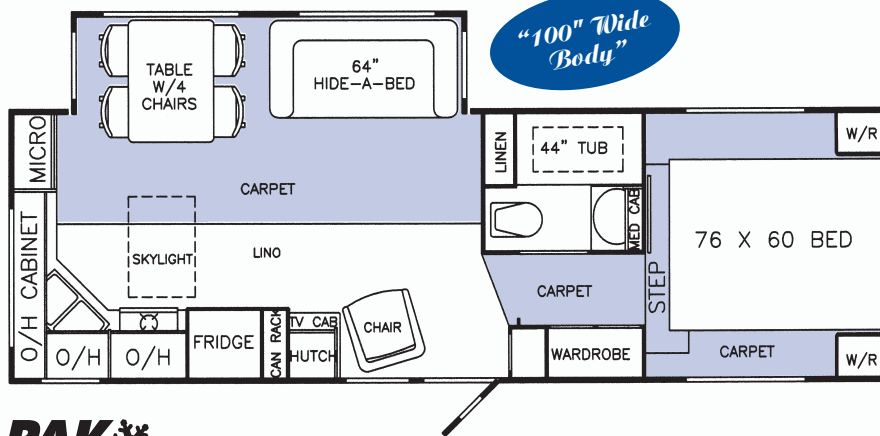

## SPECIFICATIONS

<b>GVWR</b>	4991 Kg/11,000 lbs.
<b>Dry Weight</b>	4072 Kg/8,975 lbs.
<b>Net Carrying Capacity</b>	919 Kg/2,025 lbs.
<b>Axle Capacity</b>	4719 Kg/10,400 lbs.
<b>Hitch Weight</b>	628 Kg/1,385 lbs.
<b>Height*</b>	3.6 M/11'10"
<b>Width</b>	2.5 M/8'4"
<b>Length</b>	8.4 M/27'5"
<b>Exterior Storage</b>	65 cu. ft.

\* Approximate height to top of air conditioner

**POLAR-PAK**  
THE SUB-ZERO SOLUTION

## STANDARD FEATURES

### BATH/BEDROOM

- ◆ "Taymor" Vanity Faucet
- ◆ Power Vent in Bath
- ◆ CO Detector
- ◆ Residential Fiberglass Tub W/Glass Door
- ◆ Escape Window in Bedroom
- ◆ Porcelain Toilet
- ◆ Pillowtop "Ultimate" Mattress
- ◆ 5'9" Bedroom Height
- ◆ Co-ord. Bedspread & Pillows
- ◆ Day/Nite Fabric Blinds
- ◆ Tooth Brush Holder, Soap Dish
- \* Residential Skylight with Moisture Control & Blind

### KITCHEN

- ◆ Knife Block
- ◆ Jensen Range Hood W/Systems Monitor
- ◆ "Atwood" High Output Range
- ◆ "Norcold" 8 cu.ft. Fridge W/Aluminum Laminate Door Panels
- \* Residential Skylight with Moisture Control & Blind
- ◆ Raised Beech Cabinet Doors
- ◆ Polymer Kitchen Sink W/"Taymor" Faucet W/Spray
- ◆ Kitchen Drawers-Birch Plywood-Nylon Rollers & Steel Guides
- ◆ Hardwood Table & 4 Chairs
- ◆ Fluorescent Light in Ceiling
- ◆ Pull Out Can Rack

### LIVING ROOM

- ◆ Cable/Telephone Hook Up
- ◆ Smoke Detector
- ◆ Fire Extinguisher
- ◆ AM/FM Stereo/CD Player W/4 Speakers
- ◆ Cocktail Chair - 28" Recliner
- ◆ 120 V. Lights & Receptacles in Slide Out
- ◆ Day/Nite Fabric Blinds
- ◆ Raised Beech Cabinet Doors
- ◆ Fluorescent Light in Ceiling
- ◆ Solid Beech & Fabric Fascia - L.R. Slide

## SUPREME STANDARD FEATURES

- ◆ Central Roof AC-13.5
- ◆ 15' Awning A+E
- ◆ Microwave Oven
- ◆ TV Antenna
- \* "Fantastic" Rain Sensor Vent Fan
- ◆ Black Tank Flush
- ◆ Extended Pin Box
- ◆ Fold Away Assist Rail
- ◆ Hide A Bed - 64"
- ◆ Propane Leak Detector
- \* "Stormite" Thermopane Windows
- ◆ TV Shelf/BR
- ◆ 16" Aluminum Wheels (4)

Features & Specifications are subject to change without notice or obligation.

### EXTERIOR

- ◆ "Medallion Filon" High Gloss Fiberglass
- ◆ Solar Reflective Radius Corner Windows
- ◆ Aerodynamic Front Fiberglass Cap
- ◆ Seamless Fiberglass Frt. & Rear Caps
- ◆ Fiberglass Skirts/Fenders
- ◆ Entrance Step Boot Shelf
- \* Compartment Doors w/1" Insulation
- ◆ BBQ Quick Connect
- ◆ Roof Rack & Ladder
- ◆ Shock Absorbers (4)
- ◆ 2 Rear Stab. Jacks
- ◆ Elec. Front Jacks W/Quick Release Pins
- ◆ "MorRyde" Pin Box System
- ◆ "Dicor" Vinyl Roof
- ◆ Seamless Polypropylene Undersiding
- \* 2" Vac-U-Lam Sidewalls W/Db'l. Plywood
- ◆ Basement Storage-Full Width
- ◆ Dexter Nev-R-Lube Axles W/12" Brakes
- ◆ 16" Radials w/Spare
- \* 3/8" Plywood Roof Deck
- ◆ 8' Sewer Hose Compartment
- ◆ Automotive Undercoat
- ◆ Curbside Scare Light
- ◆ Adjustable Height Spring Hangers

### MECHANICAL/CONSTRUCTION

- \* Crowned Truss Roof R-11 Insulation
- \* Attic Ventilation System
- \* 2 Stage Furnace 23-34 BTU
- \* Heated & Encl. Holding & Fresh Water Tanks
- ◆ 12V Disconnect
- ◆ 45 Amp Power Converter W/Batt. Charger
- ◆ Detachable 30 Amp Power Cord
- ◆ Hot Water Bypass Valves
- ◆ XT9 Gas/Elec. Water Heater W/DSI-23 L (6 US Gal.)
- ◆ Whisper King Water Pump
- ◆ Fresh Water 232 L (61 US Gal.)
- ◆ Toilet Holding Tank 203 L (53.4 US Gal.)
- ◆ Grey Water 194 L (51 US Gal.)
- ◆ Dual Propane Bottles 13.6 Kg ea. (30 lbs. ea.)
- ◆ Electric "Sta-Tite" Slide Out W/Manual Override-"Flush Floor"
- ◆ Auto Change Over Propane Reg.
- ◆ Solar Panel & Satellite Prewire
- ◆ Antifreeze Pick Up System
- \* Insulated Slide Out Floor 2 3/8"

### OPTIONS AVAILABLE

- ◆ "Weather Pro" Electric Awning\*
- ◆ Awning Upgrade 9000 Series
- ◆ Central Vacuum
- ◆ Dinette ILO F/S Table\*
- ◆ Electric Rear Stabilizer Jacks\*
- ◆ Exterior Shower\*
- ◆ Hideabed w/Footrest
- ◆ Hideabed w/Air Mattress
- ◆ Memory Foam Mattress Pad
- ◆ Round Dining Table
- ◆ Twin Beds\*
- ◆ Solar Panel\* 100W
- ◆ Water Filter
- ◆ "Norcold" 10 cu. ft. Fridge
- ◆ Beech Fridge Panels

\* Before Production Only.

**VEHICLE LOADING:** Every effort has been made to provide the greatest number of options for the recreation vehicle owner. Along with these choices comes the responsibility to manage the loads that are imposed by the choices so that they remain within the manufacturer's specified chassis weight limits. Do not overload the recreation vehicle.

**DRY WEIGHT** is the total weight of the trailer with standard features included and all tanks empty.

**NET CARRYING CAPACITY** is calculated with standard features only and all tanks empty. Any options, fluids, or dealer added options must be subtracted from the Net Carrying Capacity to determine the remaining cargo allowance.

**WARNING:** This information is intended as a guide only. Weights of individual vehicles may vary. Consult your owner's manual for complete loading, weighing, and towing instructions.







# FIFTH WHEEL MODEL 29CKS

## SPECIFICATIONS

<b>GVWR</b>
5672 Kg/12,500 lbs.
<b>Dry Weight</b>
4578 Kg/10,090 lbs.
<b>Net Carrying Capacity</b>
1094 Kg/2,410 lbs.
<b>Axle Capacity</b>
5430 Kg/12,000 lbs.
<b>Hitch Weight</b>
846 Kg/1,865 lbs.
<b>Height*</b>
3.9 M/12'8"
<b>Width</b>
2.5 M/8'4"
<b>Length</b>
9.2 M/30'3"
<b>Exterior Storage</b>
89 cu. ft.

\* Approximate height to top of air conditioner

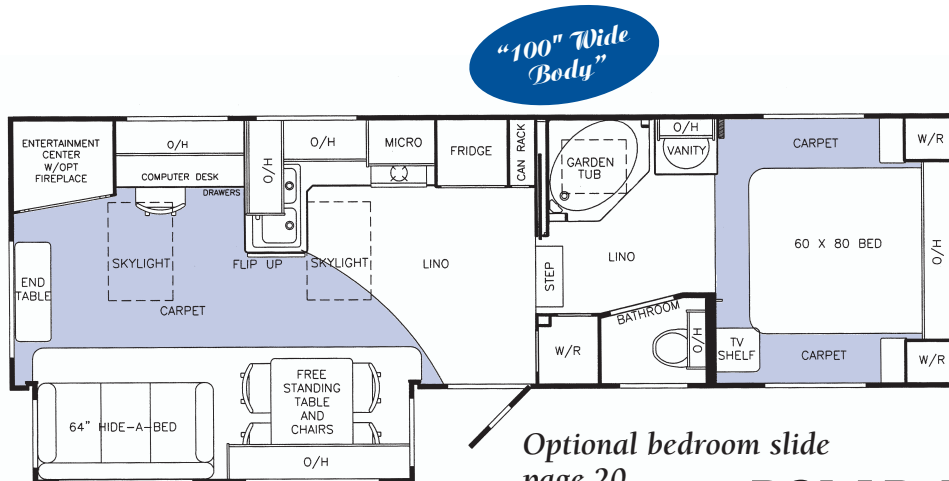

Optional bedroom slide  
page 20

**POLAR-PAK**  
THE SUB-ZERO SOLUTION

## STANDARD FEATURES

### BATH/BEDROOM

- ◆ "Taymor" Vanity Faucet
- ◆ Power Vent in Toilet Compartment
- ◆ CO Detector
- ◆ Residential Fiberglass Garden Tub W/Glass Door
- ◆ Escape Window
- \* ◆ "Fantastic" Vent Fan Bathroom
- ◆ 6'0" Bedroom Height
- ◆ Pillowtop "Ultimate" Mattress
- ◆ Co-ord. Bedspread & Pillows
- ◆ Day/Nite Fabric Blinds
- ◆ TV Shelf in Bedroom
- ◆ Porcelain Toilet W/Pedal Flush
- \* ◆ Residential Skylight with Moisture Control

### KITCHEN

- ◆ Knife Block
- ◆ Jensen Range Hood W/Systems Monitor
- ◆ "Atwood" High Output Range
- ◆ "Norcold" 8 cu. ft. Fridge W/Aluminum Laminate Door Panels
- ◆ Hardwood Table & 4 Chairs
- ◆ Polymer Kitchen Sink W/"Taymor" Faucet W/Spray
- ◆ Kitchen Drawers-Birch
- ◆ Plywood-Nylon Rollers & Steel Guides
- ◆ Raised Beech Cabinet Doors
- ◆ Fluorescent Light in Ceiling
- ◆ Double Can Storage Rack
- \* ◆ "Fantastic Rain Sensor" Vent Fan
- \* ◆ Residential Skylight with Moisture Control & Blind
- ◆ Cental Vacuum w/Sweep

### LIVING ROOM

- ◆ Cable/Telephone Hook Up
- ◆ Fire Extinguisher & Smoke Detector
- ◆ Residential CD & DVD Stereo with Surround Sound
- ◆ Computer Desk w/Chair
- ◆ 120 V. Lights & Receptacle in Slide Out
- ◆ Day/Nite Fabric Blinds
- ◆ Raised Beech Cabinet Doors
- ◆ Beech End Table 36x13
- ◆ Co-ord. "C" Valances
- ◆ Fluorescent Light in Ceiling
- ◆ 27" Flatscreen TV
- \* ◆ Residential Skylight with Moisture Control & Blind

## SUPREME STANDARD FEATURES

- ◆ Central Roof AC-13.5 BTU
- ◆ 15' Awning A+E - 8500
- ◆ Microwave Oven
- ◆ TV Antenna
- ◆ "Medallion Filon" Exterior
- ◆ Black Tank Flush
- ◆ Antifreeze Pickup System
- ◆ Hide A Bed - 64"
- ◆ Propane Leak Detector
- ◆ TV Shelf/BR

### EXTERIOR

- \* ◆ Solar Reflective "Stormtite" Windows with Thermopane Glass
- ◆ Fiberglass Skirts/Fenders
- ◆ Aerodynamic Fuelsaver Front Fiberglass Cap
- \* ◆ Compartment Doors w/1" Insulation
- ◆ Roof Rack & Ladder
- ◆ Entrance Step Boot Shelf
- ◆ Shock Absorbers (4)
- ◆ 2 Rear Stab. Jacks
- ◆ Elec. Front Jacks W/Quick Release Pins
- ◆ MorRyde Pin Box System
- ◆ Exterior Shower in Compartment
- ◆ "Dicor" Vinyl Roof
- ◆ Hitch Hook Up Light
- ◆ Seamless Polypropylene Undersiding
- \* ◆ 2" Vac-U-Lam Sidewalls W/DbL. Plywood
- ◆ Basement Storage - Lighted
- ◆ Battery Compartment Quad Recessed
- ◆ Dexter Nev-R-Lube Axles W/12" Brakes
- ◆ 16" Radials w/Spare
- \* ◆ 3/8" Plywood Roof Deck
- ◆ 8' Sewer Hose Compartment
- ◆ Automotive Undercoat
- ◆ Curbside Scare Light
- ◆ Adjustable Height Spring Hangers
- ◆ BBQ Quick Connect

### MECHANICAL/CONSTRUCTION

- \* ◆ Crowned Truss Roof R-11 Ins.
- ◆ Attic Ventilation System
- \* ◆ 2 Stage Furnace 23-34 BTU
- \* ◆ Heated & Encl. Holding & Fresh Water Tanks
- ◆ 12V Disconnect
- ◆ 45 Amp Power Converter W/Batt. Charger
- ◆ 50 Amp Service with Detachable Cord
- ◆ Hot Water Bypass Valves
- ◆ XT16 Gas/Elec. Water Heater W/DSI-36 L (10 US Gal.)
- \* ◆ Attic Ventilation System\*
- ◆ Whisper King Water Pump
- ◆ Fresh Water 232 L (61 US Gal.)
- \* ◆ Insulated Slide Out Floor 2 3/8"
- ◆ Toilet Holding Tank 203 L (53.4 US Gal.)
- ◆ Grey Water 194 L (51 US Gal.)
- ◆ Dual Propane Bottles 13.6 Kg ea. (30 lbs. ea.)
- ◆ Electric "Sta-Tite" Slide Outs W/Manual Override
- ◆ Auto Change Over Propane Reg.
- \* ◆ Cable Ext. Terminal Valves
- ◆ Solar Panel & Satellite Pre-wire
- ◆ Aluminum Wheels (4)

### OPTIONS AVAILABLE

- ◆ Bedroom Slide Out - page 20
- ◆ Awning Upgrade 9000 Series
- ◆ Awning on Bedroom Slide
- ◆ "Weather Pro" Electric Awning
- ◆ Laminate Kitchen Floor
- ◆ Dinette ILO F/S Table\*
- ◆ Generator Compartment (25x33)\*
- ◆ Round Dining Table
- ◆ Electric Rear Stabilizer Jacks\*
- ◆ Electric Fireplace
- ◆ Coffee Table
- ◆ Recliner w/Flip Up Shelf ILO Computer Desk\*
- ◆ 2 Recliners ILO Hide-a-Bed
- ◆ Twin Beds\* (N/A w/Br. Slide)
- ◆ Solar Panel\* 100W
- ◆ Garden Shower ILO Bathtub\*
- ◆ Water Filter
- ◆ "Norcold" 10 cu. ft. Fridge
- ◆ Beech Fridge Panels
- ◆ Hide-a-Bed w/Footrest
- ◆ Hide-A-Bed w/Air Mattress
- ◆ Memory Foam Mattress Pad
- ◆ Solid Surface Kitchen & Vanity Counters\*
- ◆ Drawers in Entertainment Center
- ◆ ILO Fireplace

\* Before Production Only.

Specifications are subject to change without notice or obligation.



# FIFTH WHEEL MODEL 29.5RLS

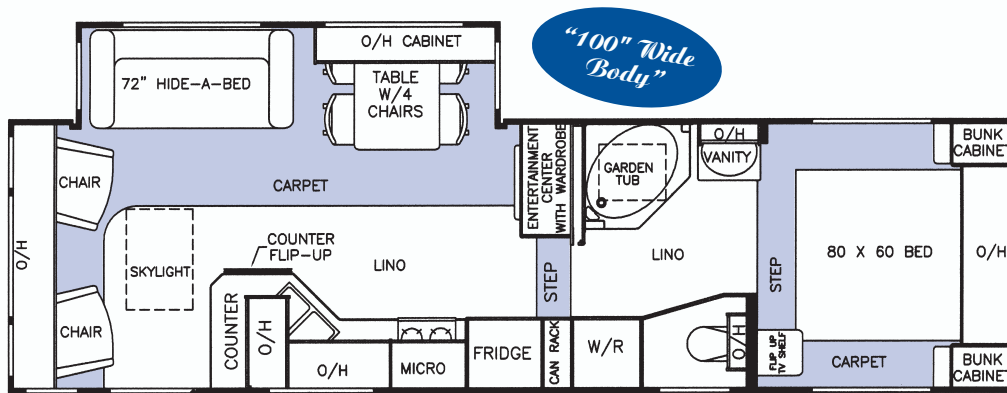

Optional bedroom slide  
page 20

**POLAR-PAK**  
THE SUB-ZERO SOLUTION

## STANDARD FEATURES

### SPECIFICATIONS

<b>GVWR</b>	5672 Kg/12,500 lbs.
<b>Dry Weight</b>	4627 Kg/10,200 lbs.
<b>Net Carrying Capacity</b>	1043 Kg/2,300 lbs.
<b>Axle Capacity</b>	5430 Kg/12,000 lbs.
<b>Hitch Weight</b>	987 Kg/2,175 lbs.
<b>Height*</b>	3.8 M/12'4"
<b>Width</b>	2.5 M/8'4"
<b>Length</b>	9.4 M/30'11"
<b>Exterior Storage</b>	86 cu. ft.

\* Approximate height to top of air conditioner

### BATH/BEDROOM

- ◆ "Taymor" Vanity Faucet
- ◆ Power Vent in Bath
- ◆ CO Detector
- ◆ Residential Fiberglass Garden Tub W/Glass Door
- \* Residential Skylight with Moisture Control
- ◆ Escape Window
- \* "Fantastic" Vent Fan
- ◆ 6'0" Bedroom Height
- ◆ Pillowtop "Ultimate" Mattress
- ◆ Co-ord. Bedspread & Pillows
- ◆ Day/Nite Fabric Blinds
- ◆ TV Shelf in Bedroom
- ◆ Porcelain Toilet W/Pedal Flush
- ◆ Tooth Brush Holder, Soap Dish

### KITCHEN

- ◆ Knife Block
- ◆ Jensen Range Hood W/Systems Monitor
- ◆ "Atwood" High Output Range
- ◆ "Norcold" 8 cu. ft. Fridge W/Aluminum Laminate Door Panels
- ◆ Hardwood Table & 4 Chairs
- ◆ Central Vacuum w/Sweep
- ◆ Polymer Kitchen Sink
- W/"Taymor" Faucet W/Spray
- ◆ Kitchen Drawers-Birch Plywood-Nylon Rollers & Steel Guides
- ◆ Raised Beech Cabinet Doors
- ◆ Fluorescent Light in Ceiling
- ◆ Double Can Storage Rack
- \* Residential Skylight with Moisture Control & Blind

### LIVING ROOM

- ◆ Cable/Telephone Hook Up
- ◆ Fire Extinguisher & Smoke Detector
- ◆ Residential Home Theater CD & DVD Stereo System 120 V.
- ◆ 120 V. Lights & Receptacle in Slide Out
- ◆ 2 Cocktail Chairs-28" Recliner
- ◆ Day/Nite Fabric Blinds
- ◆ Raised Beech Cabinet Doors
- ◆ Beech End Table
- ◆ Fluorescent Light in Ceiling
- ◆ 27" Flatscreen TV
- ◆ Beech & Fabric Fascia - L.R. Slide
- \* "Fantastic Rain Sensor" Vent Fan

### SUPREME STANDARD FEATURES

- ◆ Central Roof AC-13.5 BTU
- ◆ 16' Awning A+E
- ◆ Microwave Oven
- ◆ TV Antenna
- ◆ Recessed Quad Battery Compartment
- ◆ Black Tank Flush
- ◆ Hide A Bed - 72'
- ◆ Propane Leak Detector
- ◆ TV Shelf/BR

### EXTERIOR

- ◆ "Medallion Filon" High Gloss Fiberglass
- \* Stormite Windows Thermopane Glass
- ◆ Fiberglass Skirts/Fenders
- \* Compartment Doors w/1" Insulation
- ◆ Roof Rack & Ladder
- ◆ Shock Absorbers (4)
- ◆ 2 Rear Stab. Jacks
- ◆ Elec. Front Jacks W/Quick Release
- ◆ MorRyde Pin Box System
- ◆ Aerodynamic Fuel Saver Front Fiberglass Cap
- ◆ Entrance Step Boot Shelf
- ◆ Exterior Shower in Compartment
- ◆ "Dicor" Vinyl Roof
- ◆ Hitch Hook Up Light
- ◆ BBQ Quick Connect
- ◆ Seamless Polypropylene Undersiding
- \* 2" Vac-U-Lam Sidewalls W/DbL. Plywood
- ◆ Basement Storage-Lighted
- ◆ Dexter Nev-R-Lube Axles W/12" Brakes
- ◆ 16" Radials w/Spare
- \* 3/8" Plywood Roof Deck
- ◆ 8' Sewer Hose Compartment
- ◆ Automotive Undercoat
- ◆ Curbside Scare Light
- ◆ Adjustable Height Spring Hangers

### MECHANICAL/CONSTRUCTION

- \* Crowned Truss Roof R-11 Ins.
- \* Attic Ventilation System
- \* 2 Stage Furnace 23-34 BTU
- \* Heated & Encl. Holding & Fresh Water Tanks
- ◆ 12V Disconnect
- ◆ 45 Amp Power Converter W/Batt. Charger
- ◆ 50 Amp Service with Detachable Cord
- ◆ Hot Water Bypass Valves
- ◆ XT16 Gas/Elec. Water Heater W/DSI-36 L (10 US Gal.)
- ◆ Whisper King Water Pump
- ◆ Fresh Water 232 L (61 US Gal.)
- ◆ Toilet Holding Tank 203 L (53.4 US Gal.)
- \* Cable Ext. - Termination Valves
- ◆ Grey Water 194 L (51 US Gal.)
- ◆ Dual Propane Bottles 13.6 Kg ea. (30 lbs. ea.)
- ◆ Electric "Sta-Tite" Slide Out W/Manual Override-"Flush Floor"
- ◆ Auto Change Over Propane Reg.
- ◆ Slide Out Propane Tray
- ◆ Solar Panel & Satellite Pre-wire
- ◆ Aluminum Wheels (4)
- ◆ Antifreeze Pick Up System
- \* Insulated Slide Out Floors 2 3/8"

### OPTIONS AVAILABLE

- ◆ "Weather Pro" Electric Awning\*
- ◆ Awning Upgrade 9000 Series
- ◆ Bedroom Slide-Out - page 20
- ◆ Awning on Bedroom Slide
- ◆ Dinette ILO F/S Table\*
- ◆ Exterior Shower\*
- ◆ Round Dining Table
- ◆ Laminate Kitchen Floor\*
- ◆ Beech Fridge Panels
- ◆ Electric Rear Stabilizer Jacks\*
- ◆ Electric Fireplace (in lieu of Wardrobe)
- ◆ Twin Beds\* (N/A w/BR Slide)
- ◆ Solar Panel\* 100W
- ◆ Garden Shower ILO Bathtub\*
- ◆ Water Filter
- ◆ "Norcold" 10 cu. ft. Fridge
- ◆ Generator Compartment\* (25x33)
- ◆ Solid Surface Kitchen & Vanity Counters\*
- ◆ Memory Foam Mattress Pad
- ◆ Hide-A-Bed w/Air Mattress
- ◆ Hide-A-Bed w/Footrest

\* Before Production Only.

Specifications are subject to change without notice or obligation.





# FIFTH WHEEL MODEL 29RKDS

## SPECIFICATIONS

<b>GVWR</b>
5898 Kg/13,000 lbs.
<b>Dry Weight</b>
4812 Kg/10,605 lbs.
<b>Net Carrying Capacity</b>
1087 Kg/2,395 lbs.
<b>Axle Capacity</b>
5430 Kg/12,000 lbs.
<b>Hitch Weight</b>
1069 Kg/2,355 lbs.
<b>Height*</b>
3.8 M/12'6"
<b>Width</b>
2.5 M/8'4"
<b>Length</b>
9.2 M/30'2"
<b>Exterior Storage</b>
97 cu. ft.

\* Approximate height to top of air conditioner

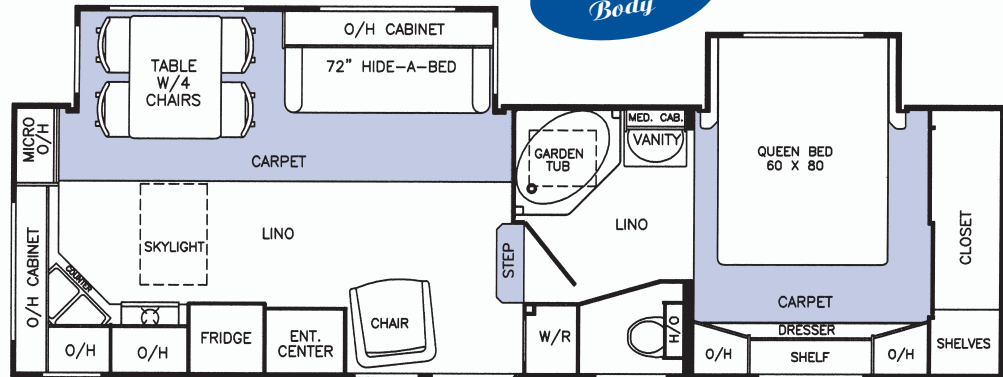

**POLAR-PAK**  
THE SUB-ZERO SOLUTION

## STANDARD FEATURES

### BATH/BEDROOM

- ◆ "Taymor" Vanity Faucet
- ◆ Power Vent in Bath
- ◆ CO Detector
- ◆ Residential Fiberglass Tub W/Glass Door
- ◆ Porcelain Toilet W/Pedal Flush
- ◆ Escape Window
- ◆ 6'0" Bedroom Height
- ◆ \* "Fantastic" Vent Fan
- ◆ Pillowtop "Ultimate" Mattress
- ◆ Co-ord. Bedspread & Pillows
- ◆ Color Co-ord. Valances
- ◆ Day/Nite Fabric Blinds
- ◆ TV Pre-Wire in Bedroom
- ◆ "Sta-Tite" Slide W/Manual Override
- ◆ Tooth Brush Holder, Soap Dish
- ◆ \* Residential Skylight with Moisture Control over Tub

### KITCHEN

- ◆ Knife Block
- ◆ Jensen Range Hood W/Systems Monitor
- ◆ "Atwood" High Output Range
- ◆ Norcold 8 cu. ft. Fridge W/Aluminum Laminate Door Panels
- ◆ Polymer Kitchen Sink W/"Taymor" Faucet W/Spray
- ◆ \* "Fantastic Rain Sensor" Vent Fan
- ◆ Kitchen Drawers-Birch Plywood-Nylon Rollers & Steel Guides
- ◆ Hardwood Table & 4 Chairs
- ◆ Fluorescent Light in Ceiling
- ◆ Double Can Storage Rack
- ◆ Raised Beech Cabinet Doors
- ◆ Cental Vacuum w/Sweep

### LIVING ROOM

- ◆ Cable/Telephone Hook Up
- ◆ Smoke Detector
- ◆ Fire Extinguisher
- ◆ Cocktail Chair 28" (Recliner)
- ◆ Beech End Table
- ◆ 120 V. Lights & Receptacle in Slide Out
- ◆ Beech & Fascia Fascia - L.R. Slide
- ◆ Co-ord. "C" Valances
- ◆ Day/Nite Fabric Blinds
- ◆ Fluorescent Light in Ceiling
- ◆ Residential Home Theater Stereo System w/CD & DVD Player - 120 V
- ◆ 20" Flatscreen TV

### SUPREME STANDARD FEATURES

- ◆ \* Central Roof AC-15 BTU W/Heat Pump
- ◆ 18' Awning A+E
- ◆ Microwave Oven
- ◆ TV Antenna
- ◆ Battery Tray Quad
- ◆ Black Tank Flush
- ◆ Fold Away Assist Rail
- ◆ Hide A Bed - 72"
- ◆ Propane Leak Detector
- ◆ \* Residential Skylight/Kitchen with Moisture Control & Blind

### EXTERIOR

- ◆ "Medallion Filon" High Gloss Fiberglass
- ◆ \* Stormite Windows-Thermopane Glass
- ◆ Aerodynamic Fuel Saver Front Fiberglass Cap
- ◆ Fiberglass Skirts/Fenders
- ◆ \* Compartment Doors w/1" Insulation
- ◆ Entrance Step Boot Shelf
- ◆ Exterior Shower in Compartment
- ◆ Roof Rack & Ladder
- ◆ BBQ Quick Connect
- ◆ Shock Absorbers (4)
- ◆ 2 Rear Stab. Jacks
- ◆ Elec. Front Jacks W/Quick Release Pins
- ◆ MorRyde Pin Box System
- ◆ "Dicor" Vinyl Roof
- ◆ Curbside Scare Light
- ◆ Seamless Polypropylene Undersiding
- ◆ \* 2" Vac-U-Lam Sidewalls W/DbL Plywood
- ◆ Full Width Storage-Lined & Lighted
- ◆ Dexter Nev-R-Lube Axles W/12" Brakes
- ◆ 16" Radials w/Spare
- ◆ 3/8" Plywood Roof Deck
- ◆ 8' Sewer Hose Compartment
- ◆ Automotive Undercoat
- ◆ Adjustable Height Spring Hangers

### MECHANICAL/CONSTRUCTION

- ◆ \* Crowned Truss Roof R-11 Insulation
- ◆ Attic Ventilation System
- ◆ \* 2 Stage Furnace 23-34 BTU
- ◆ \* Heated & Encl. Holding & Fresh Water Tanks
- ◆ 12V Disconnect
- ◆ 45 Amp Power Converter W/Batt. Charger
- ◆ 50 Amp Service with Detachable Cord
- ◆ Hot Water Bypass Valves
- ◆ XT16 Gas/Elec. Water Heater W/DSI-36 L (10 US Gal.)
- ◆ Whisper King Water Pump
- ◆ Fresh Water 241 L (64 US Gal.)
- ◆ \* Cable Ext. - Termination Valves
- ◆ Toilet Holding Tank 203 L (53.4 US Gal.)
- ◆ Grey Water 194 L (51 US Gal.)
- ◆ Dual Propane Bottles 13.6 Kg ea. (30 lbs. ea.)
- ◆ Electric "Sta-Tite" Slide Outs W/Manual Override-"Flush Floor"
- ◆ Auto Change Over Propane Reg.
- ◆ Solar Panel & Satellite Pre-wire
- ◆ Aluminum Wheels (4)
- ◆ Antifreeze Pick Up System
- ◆ \* Insulated Slide Out Floors 2 3/8"

### OPTIONS AVAILABLE

- ◆ "Weather Pro" Electric Awning\*
- ◆ Awning Upgrade 9000 Series
- ◆ Awning on Bedroom Slide
- ◆ Computer Shelf-Lift Up
- ◆ Laminate Kitchen Floor
- ◆ Dinette ILO F/S Table\*
- ◆ Beech Coffee Table
- ◆ Solid Surface Kitchen & Vanity Counter\*
- ◆ Bedroom Pocket Door
- ◆ Round Dining Table
- ◆ Solar Panel\* 100W
- ◆ Garden Shower ILO Bathtub\*
- ◆ Water Filter
- ◆ "Norcold" 10 cu. ft. Fridge
- ◆ Beech Fridge Panels
- ◆ Generator Compartment\* (25x33)
- ◆ Electric Rear Stabilizer Jacks\*
- ◆ Hide-A-Bed w/Air Mattress
- ◆ Hide-A-Bed w/Footrest
- ◆ Memory Foam Mattress Pad
- \* Before Production Only.

Specifications are subject to change without notice or obligation.





# FIFTH WHEEL MODEL 30RLDS



"This is an unbelievable unit! Due to relentless rain on our annual trek, the entire group of 10 was able to converge for meals and entertainment. The best unit in entire campsite."

Dan Olsen, Edmonton, AB

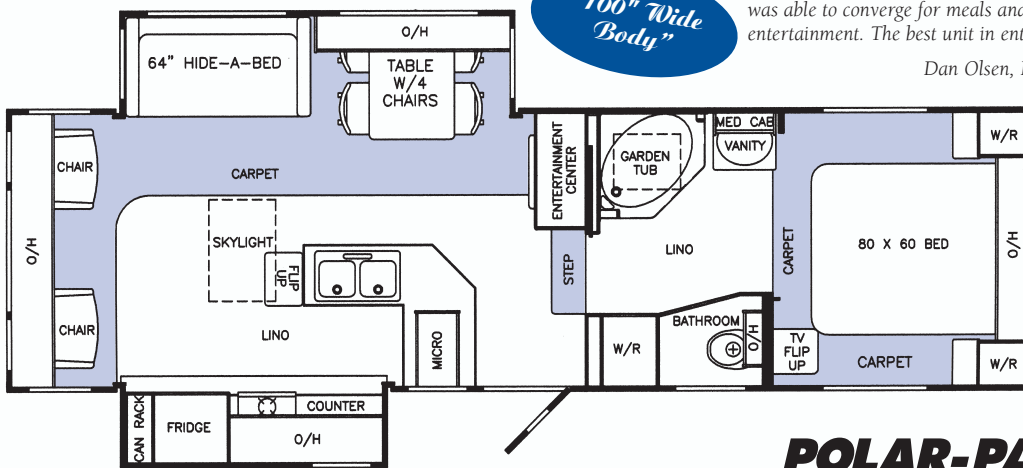

## SPECIFICATIONS

<b>GVWR</b>	5944 Kg/13,100 lbs.
<b>Dry Weight</b>	4948 Kg/10,905 lbs.
<b>Net Carrying Capacity</b>	996 Kg/2,195 lbs.
<b>Axle Capacity</b>	5445 Kg/12,000 lbs.
<b>Hitch Weight</b>	894 Kg/1,970 lbs.
<b>Height*</b>	3.8 M/12'4"
<b>Width</b>	2.5 M/8'4"
<b>Length</b>	9.6 M/31'5"
<b>Exterior Storage</b>	86 cu. ft.

\* Approximate height to top of air conditioner

## STANDARD FEATURES

### BATH/BEDROOM

- ◆ "Taymor" Vanity Faucet
- ◆ Power Vent in Bath
- ◆ CO Detector
- ◆ Residential Fiberglass Shower W/Glass Door
- ◆ Porcelain Toilet W/Pedal Flush
- ◆ Escape Window
- \* ◆ "Fantastic" Vent Fan
- ◆ 6'0" Bedroom Height
- ◆ Pillowtop "Ultimate" Mattress
- ◆ Co-ord. Bedspread & Pillows
- ◆ Day/Nite Fabric Blinds
- \* ◆ Residential Skylight with Moisture Control over Tub
- ◆ TV Pre-Wire in Bedroom W/TV Shelf
- ◆ Tooth Brush Holder, Soap Dish

### KITCHEN

- ◆ Knife Block
- ◆ Jensen Range Hood W/Systems Monitor
- ◆ "Atwood" High Output Range
- ◆ "Norcold" 8 cu. ft. Fridge W/Aluminum Laminate Door Panels
- ◆ Hardwood Table & 4 Chairs
- ◆ Polymer Kitchen Sink W/"Taymor" Faucet W/Spray
- ◆ Kitchen Drawers-Birch
- Plywood-Nylon Rollers & Steel Guides
- ◆ Raised Beech Cabinet Doors
- ◆ Fluorescent Light in Ceiling
- ◆ Beech & Fabric Fascia - Kitchen Slide
- \* ◆ Residential Skylight with Moisture Control & Blind
- ◆ Central Vacuum w/Sweep

### LIVING ROOM

- ◆ Cable/Telephone Hook Up
- ◆ Smoke Detector
- ◆ Fire Extinguisher
- ◆ 120 V. Lights & Receptacle in Slide Out
- ◆ 2 -30" Fabric Recliner Chairs
- ◆ Beech End Table
- ◆ Day/Nite Fabric Blinds
- ◆ Electric "Sta-Tite" Slide W/Manual Override-"Flush Floor"
- ◆ Fluorescent Light in Ceiling
- ◆ 27" Flatscreen TV
- ◆ Beech & Fabric Fascia - L.R. Slide
- \* ◆ "Fantastic Rain Sensor" Vent Fan

## SUPREME STANDARD FEATURES

- ◆ Central Roof AC-13.5 BTU
- ◆ Aluminum Wheels (4)
- ◆ 16" Awning
- ◆ Microwave Oven
- ◆ TV Antenna
- ◆ Recessed Quad Battery Compartment
- ◆ Black Tank Flush
- ◆ Fold Away Assist Rail
- ◆ Hide A Bed - 64"
- ◆ Propane Leak Detector
- ◆ Residential Home Theater Stereo System w/CD & DVD Player - 120V

**POLAR-PAK**  
THE SUB-ZERO SOLUTION

### EXTERIOR

- ◆ Medallion Filon High Gloss Fiberglass
- \* ◆ Stormite Windows--Thermopane Glass
- ◆ Aerodynamic Fuel Saver Front Fiberglass Cap
- ◆ Fiberglass Skirts/Fenders
- ◆ Entrance Step Boot Shelf
- \* ◆ Compartment Doors w/1" Insulation
- ◆ Roof Rack & Ladder
- ◆ Shock Absorbers (4)
- ◆ 2 Rear Stab. Jacks
- ◆ "Dicor" Vinyl Roof
- ◆ Elec. Front Jacks W/Quick Release Pins
- ◆ MorRyde Pin Box System
- ◆ Hitch Hook Up Light
- ◆ BBQ Quick Connect
- ◆ Seamless Polypropylene Undersiding
- \* ◆ 2" Vac-U-Lam Sidewalls W/Dbl. Plywood
- \* ◆ 3/8" Plywood Roof Deck
- ◆ Locking Water Fill & Power Cord Compartment
- ◆ Exterior Shower in Compartment
- ◆ Dexter Nev-R-Lube Axles W/12" Brakes
- ◆ 16" Radials w/Spare
- ◆ 8' Sewer Hose Compartment
- ◆ Automotive Undercoat
- ◆ Curbside Scare Light
- ◆ Adjustable Height Spring Hangers

### MECHANICAL/CONSTRUCTION

- \* ◆ Crowned Truss Roof R-11 Insulation
- \* ◆ Attic Ventilation System
- \* ◆ 2 Stage Furnace 23-34 BTU
- \* ◆ Heated & Encl. Holding & Fresh Water Tanks
- ◆ 12V Disconnect
- ◆ 45 Amp Power Converter W/Batt. Charger
- ◆ 50 Amp Service with Detachable Cord
- ◆ Hot Water Bypass Valves
- ◆ XT16 Gas/Elec. Water Heater W/DSI-36 L (10 US Gal.)
- ◆ Whisper King Water Pump
- \* ◆ Cable Ext. - Termination Valves
- ◆ Toilet Holding Tank
- ◆ Fresh Water 232 L (61 US Gal.)
- ◆ Grey Water 194 L (51 US Gal.)
- ◆ Dual Propane Bottles 13.6 Kg ea. (30 lbs. ea.)
- ◆ Auto Change Propane Regulator
- ◆ Slide Out Propane Tray
- ◆ Solar Panel & Satellite Pre-wire
- ◆ Antifreeze Pick Up System
- \* ◆ Insulated Slide Out Floors 2 3/8"

### OPTIONS AVAILABLE

- ◆ Awning Upgrade 9000 Series
- ◆ Awning on Bedroom Slide
- ◆ Beech Coffee Table
- ◆ Laminate Kitchen Floor
- ◆ Dinette ILO F/S Table\*
- ◆ Bedroom Slide Out - page 20
- ◆ Solid Surface Kitchen & Vanity Counter\*
- ◆ "Fabric Leather" Recliners 30"
- ◆ Round Dining Table
- ◆ Solar Panel\* 100W
- ◆ Water Filter
- ◆ Shower ILO Garden Tub
- ◆ "Norcold" 10 cu. ft. Fridge
- ◆ Beech Fridge Panels
- ◆ Generator Compartment\* (25x33)
- ◆ Electric Fireplace in Ent. Center\*
- ◆ Electric Rear Stabilizer Jacks
- ◆ Hide-A-Bed w/Footrest
- ◆ Hide-A-Bed w/Air Mattress
- ◆ Memory Foam Mattress Pad

\* Before Production Only.





# FIFTH WHEEL MODEL 31CKDS XL

## SPECIFICATIONS

### GVWR

5898 Kg/13,000 lbs.

### Dry Weight

5148 Kg/11,350 lbs.

### Net Carrying Capacity

748 Kg/1,650 lbs.

### Axle Capacity

5430 Kg/12,000 lbs.

### Hitch Weight

980 Kg/2,160 lbs.

### Height\*

3.9 M/12'9"

### Width

2.5 M/8'4"

### Length

9.9 M/32'4"

### Exterior Storage

101 cu. ft.

"100" Wide Body"

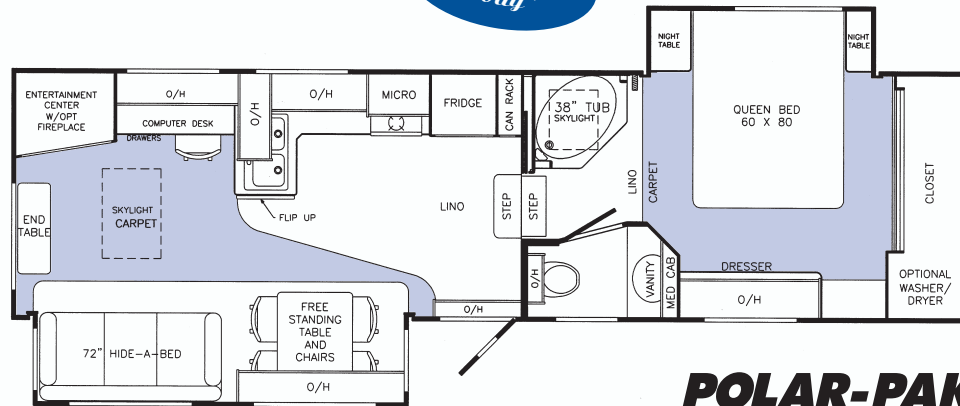

**POLAR-PAK**  
THE SUB-ZERO SOLUTION

\* Approximate height to top of air conditioner

## STANDARD FEATURES

### BATH/BEDROOM

- ◆ "Taymor" Vanity Faucet
- ◆ Power Vent in Toilet Compartment
- ◆ CO Detector
- ◆ Residential Fiberglass Garden Tub W/Glass Door
- ◆ Porcelain Toilet W/Pedal Flush
- ◆ Escape Window
- \* ◆ "Fantastic" Vent Fan
- ◆ Flat Floor Bath & Bedroom
- ◆ 6'6" Bedroom Height
- ◆ Pillowtop "Ultimate" Mattress
- ◆ Co-ord. Bedspread & Pillows
- ◆ Day/Nite Fabric Blinds
- ◆ "Sta-Tite" BR Slide W/Manual Override
- ◆ TV Pre-Wire in Bedroom
- ◆ Tooth Brush Holder, Soap Dish
- ◆ Clothes Hamper in Bedroom

### KITCHEN

- ◆ Knife Block
- ◆ Jensen Range Hood W/Systems Monitor
- ◆ "Atwood" High Output Range
- ◆ Norcold 8 cu. ft. Fridge W/Aluminum Laminate Door Panels
- ◆ 7'7" Interior Height
- ◆ Fluorescent Light in Ceiling
- ◆ Hardwood Table & 4 Chairs
- ◆ Polymer Kitchen Sink W/"Taymor" Faucet W/Spray
- ◆ Kitchen Drawers—Birch Plywood—Nylon Rollers & Steel Guides
- ◆ Raised Beech Cabinet Doors
- ◆ Central Vacuum w/Sweep

### LIVING ROOM

- ◆ Cable/Telephone Hook Up
- ◆ Fire Extinguisher & Smoke Detector
- ◆ 120 V. Lights & Receptacle in Slide Out
- ◆ Co-ord. "C" Valances
- ◆ Day/Nite Fabric Blinds
- ◆ Electric "Sta-Tite" Slide W/Manual Override—"Flush Floor"
- ◆ Fluorescent Light in Ceiling
- ◆ Beech End Table 36x13
- ◆ 27" Flatscreen TV
- ◆ Beech & Fabric Fascia - L.R. Slide
- \* ◆ "Fantastic Rain Sensor" Vent Fan
- ◆ Computer Desk w/Chair
- ◆ 6'2" Height in Slide Out

### SUPREME STANDARD FEATURES

- \* ◆ Central Roof AC—15 BTU W/Heat Pump
- ◆ 15' Awning
- ◆ Microwave Oven
- ◆ TV Antenna
- ◆ Black Tank Flush
- ◆ Fold Away Assist Rail
- ◆ Hide A Bed - 72"
- ◆ Propane Leak Detector
- \* ◆ Residential Skylights/Living Room & Kitchen w/Moisture Control
- \* ◆ Residential Skylight/Tub w/Moisture Control
- ◆ Residential Home Theater Stereo System w/CD & DVD Player - 120V

### EXTERIOR

- ◆ Medallion Filon High Gloss Fiberglass
- \* ◆ Stormtite Windows—Thermopane Glass
- ◆ Aerodynamic Fuel Saver Front Fiberglass Cap
- ◆ Fiberglass Skirts/Fenders
- ◆ Entrance Step Boot Shelf
- \* ◆ Compartment Doors w/1" Insulation
- ◆ Exterior Shower in Compartment
- ◆ Roof Rack & Ladder
- ◆ Shock Absorbers (4)
- ◆ 2 Rear Stab. Jacks
- ◆ Rubber Membrane Roof
- ◆ Elec. Front Jacks W/Quick Release Pins
- ◆ MorRyde Pin Box System
- ◆ Hitch Hook Up Light
- ◆ BBQ Quick Connect
- ◆ Seamless Polypropylene Undersiding
- \* ◆ 2" Vac-U-Lam Sidewalls W/Dbl. Plywood
- \* ◆ 3/8" Plywood Roof Deck
- ◆ Locking Water Fill & Power Cord Compartment
- ◆ Dexter Nev-R-Lube Axles W/12" Brakes
- ◆ 16" Radials w/Spare
- ◆ 8' Sewer Hose Compartment
- ◆ Automotive Undercoat
- ◆ Curbside Scare Light
- ◆ Adjustable Height Spring Hangers

### MECHANICAL/CONSTRUCTION

- \* ◆ Crowned Truss Roof R-11 Insulation
- \* ◆ Attic Ventilation System
- \* ◆ 2 Stage Furnace 25-40 BTU
- \* ◆ Heated & Encl. Holding & Fresh Water Tanks
- ◆ 12V Disconnect
- ◆ Recessed Quad Battery Compartment
- ◆ 45 Amp Power Converter W/Batt. Charger
- ◆ 50 Amp Service with Detachable Cord
- ◆ Hot Water Bypass Valves
- ◆ Pre-Plumb for Washer & Dryer
- ◆ XT16 Gas/Elec. Water Heater W/DSI—36 L (10 US Gal.)
- ◆ Whisper King Water Pump
- ◆ Aluminum Wheels (4)
- ◆ Cable Ext. - Termination Valves
- ◆ Toilet Holding Tank 203 L (53.4 US Gal.)
- ◆ Fresh Water 232 L (61 US Gal.)
- ◆ Grey Water 194 L (51 US Gal.)
- ◆ Dual Propane Bottles 13.6 Kg ea. (30 lbs. ea.)
- ◆ Auto Change Propane Regulator
- ◆ Solar Panel & Satellite Pre-wire
- ◆ Antifreeze Pick Up System
- \* ◆ Insulated Slide Out Floors 2 3/8"

### OPTIONS AVAILABLE

- ◆ "Weather Pro" Electric Awning\*
- ◆ Awning Upgrade 9000 Series
- ◆ Awning on Bedroom Slide
- ◆ Laminate Kitchen Floor\*
- ◆ Dinette ILO F/S Table\*
- ◆ Electric Fireplace
- ◆ Solid Surface Kitchen & Computer Counters\*
- ◆ "Norcold" 10 cu. ft. Fridge
- ◆ Beech Fridge Panels
- ◆ King Bed 72x80\*
- ◆ Hideabed w/Footrest
- ◆ Hide-A-Bed w/Air Mattress
- ◆ Memory Foam Mattress Pad
- ◆ Drawers in Entertainment Center
- ◆ Round Dining Table
- ◆ Washer & Dryer 1 piece Splendide
- ◆ Solar Panel\* 100W
- ◆ Water Filter
- ◆ 19" LCD TV in Bedroom
- ◆ Recliner w/flip up shelf ILO Computer Desk & Chair\*
- ◆ Generator Compartment\* (25x33)
- ◆ Electric Rear Stabilizer Jacks\*

\* Before Production Only.

Specifications are subject to change without notice or obligation.





# FIFTH WHEEL MODEL 31.5RLS

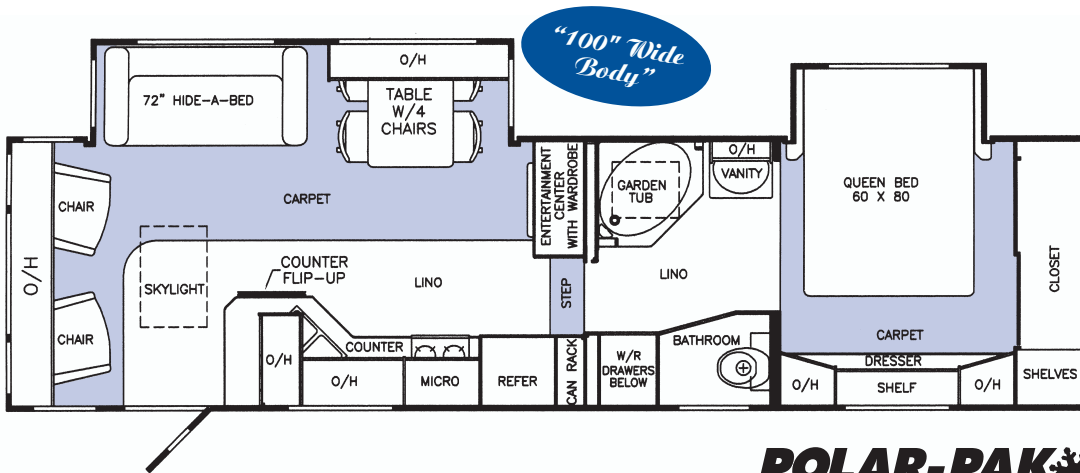

"100" Wide Body

**POLAR-PAK**  
THE SUB-ZERO SOLUTION

## SPECIFICATIONS

<b>GVWR</b>	6125 Kg/13,500 lbs.
<b>Dry Weight</b>	5253 Kg/11,580 lbs.
<b>Net Carrying Capacity</b>	871 Kg/1,920 lbs.
<b>Axle Capacity</b>	5430 Kg/12,000 lbs.
<b>Hitch Weight</b>	1132 Kg/2,495 lbs.
<b>Height*</b>	3.8 M/12'4"
<b>Width</b>	2.5 M/8'4"
<b>Length</b>	10.0 M/32'11"
<b>Exterior Storage</b>	107 cu. ft.

\* Approximate height to top of air conditioner

## STANDARD FEATURES

### BATH/BEDROOM

- ◆ "Taymor" Vanity Faucet
- ◆ Power Vent in Bath
- ◆ CO Detector
- ◆ Residential Fiberglass Shower W/Glass Door
- ◆ Porcelain Toilet W/Pedal Flush
- ◆ Escape Window
- \* ◆ "Fantastic" Vent Fan
- ◆ 6'0" Bedroom Height
- ◆ Pillowtop "Ultimate" Mattress
- ◆ Co-ord. Bedspread & Pillows
- ◆ Day/Nite Fabric Blinds
- ◆ "Sta-Tite" BR Slide W/Manual Override
- ◆ TV Pre-Wire in Bedroom
- ◆ Tooth Brush Holder, Soap Dish
- ◆ Clothes Hamper in Bedroom

### KITCHEN

- ◆ Knife Block
- ◆ Jensen Range Hood W/Systems Monitor
- ◆ "Atwood" High Output Range
- ◆ Norcold 8 cu. ft. Fridge W/Aluminum Laminate Door Panels
- ◆ Fluorescent Light in Ceiling
- ◆ Hardwood Table & 4 Chairs
- ◆ Polymer Kitchen Sink W/"Taymor" Faucet W/Spray
- ◆ Kitchen Drawers-Birch Plywood-Nylon Rollers & Steel Guides
- ◆ Raised Beech Cabinet Doors
- ◆ Central Vacuum w/Sweep

### LIVING ROOM

- ◆ Cable/Telephone Hook Up
- ◆ Fire Extinguisher & Smoke Detector
- ◆ 120 V. Lights & Receptacle in Slide Out
- ◆ Beech End Table
- ◆ 2 - 30" Fabric Recliner Chairs
- ◆ Co-ord. "C" Valances
- ◆ Day/Nite Fabric Blinds
- ◆ Electric "Sta-Tite" Slide W/Manual Override-"Flush Floor"
- ◆ Fluorescent Light in Ceiling
- ◆ 27" Flatscreen TV
- ◆ Beech & Fabric Fascia - L.R. Slide
- \* ◆ "Fantastic Rain Sensor" Vent Fan

## SUPREME STANDARD FEATURES

- \* ◆ Central Roof AC-15 BTU W/Heat Pump
- ◆ 18' Awning
- ◆ Microwave Oven
- ◆ TV Antenna
- ◆ Black Tank Flush
- ◆ Fold Away Assist Rail
- ◆ Hide A Bed "72"
- ◆ Propane Leak Detector
- \* ◆ Residential Skylight/Living Room with Moisture Control & Blind
- \* ◆ Residential Skylight/Tub with Moisture Control
- ◆ Residential Home Theater Stereo System w/CD & DVD Player - 120V

### EXTERIOR

- ◆ Medallion Filon High Gloss Fiberglass
- \* ◆ Stormtite Windows-Thermopane Glass
- ◆ Aerodynamic Fuel Saver Front Fiberglass Cap
- ◆ Fiberglass Skirts/Fenders
- ◆ Entrance Step Boot Shelf
- \* ◆ Compartment Doors w/1" Insulation
- ◆ Exterior Shower in Compartment
- ◆ Roof Rack & Ladder
- ◆ Shock Absorbers (4)
- ◆ 2 Rear Stab. Jacks
- ◆ "Dicor Vinyl" Roof
- ◆ Elec. Front Jacks W/Quick Release Pins
- ◆ MorRyde Pin Box System
- ◆ Hitch Hook Up Light
- ◆ BBQ Quick Connect
- ◆ Seamless Polypropylene Undersiding
- \* ◆ 2" Vac-U-Lam Sidewalls W/Dbl. Plywood
- \* ◆ 3/8" Plywood Roof Deck
- ◆ Locking Water Fill & Power Cord Compartment
- ◆ Dexter Nev-R-Lube Axles W/12" Brakes
- ◆ 16" Radials w/Spare
- ◆ 8' Sewer Hose Compartment
- ◆ Automotive Undercoat
- ◆ Curbside Scare Light
- ◆ Adjustable Height Spring Hangers

### MECHANICAL/CONSTRUCTION

- \* ◆ Crowned Truss Roof R-11 Insulation
- \* ◆ Attic Ventilation System
- \* ◆ 2 Stage Furnace 25-40 BTU
- \* ◆ Heated & Encl. Holding & Fresh Water Tanks
- ◆ 12V Disconnect
- ◆ Recessed Quad Battery Compartment
- ◆ 45 Amp Power Converter W/Batt. Charger
- ◆ 50 Amp Service with Detachable Cord
- ◆ Hot Water Bypass Valves
- ◆ XT16 Gas/Elec. Water Heater W/DSI-36 L (10 US Gal.)
- ◆ Whisper King Water Pump
- ◆ Aluminum Wheels (4)
- \* ◆ Cable Ext. - Termination Valves
- ◆ Toilet Holding Tank 203 L (53.4 US Gal.)
- ◆ Fresh Water 232 L (61 US Gal.)
- ◆ Grey Water 194 L (51 US Gal.)
- ◆ Dual Propane Bottles 13.6 Kg ea. (30 lbs. ea.)
- ◆ Auto Change Propane Regulator
- ◆ Pre-Plumbed for Washer/Dryer
- ◆ Slide Out Propane Tray
- ◆ Solar Panel & Satellite Pre-wire
- ◆ Antifreeze Pick Up System
- \* ◆ Insulated Slide Out Floors 2 3/8"

### OPTIONS AVAILABLE

- ◆ "Weather Pro" Electric Awning\*
- ◆ Awning Upgrade 9000 Series
- ◆ Awning on Bedroom Slide
- ◆ Laminate Kitchen Floor\*
- ◆ Beech Coffee Table
- ◆ 19" LCD TV in Bedroom
- ◆ Dinette ILO F/S Table\*
- ◆ Washer/Dryer Cabinet
- ◆ Washer/Dryer-1 pc. Splendide\*
- ◆ Solid Surface Kitchen & Vanity Counter\*
- ◆ "Norcold" 10 cu. ft. Fridge
- ◆ Beech Fridge Panels
- ◆ Round Dining Table
- ◆ "Fabric Leather" Recliners 30"
- ◆ Solar Panel\* 100W
- ◆ Water Filter
- ◆ Bedroom Pocket Door\*
- ◆ Generator Compartment\* (25x33)
- ◆ Electric Rear Stabilizer Jacks\*
- ◆ Electric Fireplace in Ent. Center\*
- ◆ Hide-A-Bed w/Air Mattress
- ◆ Hide-A-Bed w/Footrest
- ◆ Memory Foam Mattress Pad

\* Before Production Only.

Specifications are subject to change without notice or obligation.





# FIFTH WHEEL MODEL 32.5TKS

## SPECIFICATIONS

### GVWR

6715 Kg/14,800 lbs.

### Dry Weight

5633 Kg/12,415 lbs.

### Net Carrying Capacity

1082 Kg/2,385 lbs.

### Axle Capacity

6352 Kg/14,000 lbs.

### Hitch Weight

1180 Kg/2,600 lbs.

### Height\*

3.9 M/12'6"

### Width

2.5 M/8'4"

### Length

10.4 M/34'

### Exterior Storage

106 cu. ft.

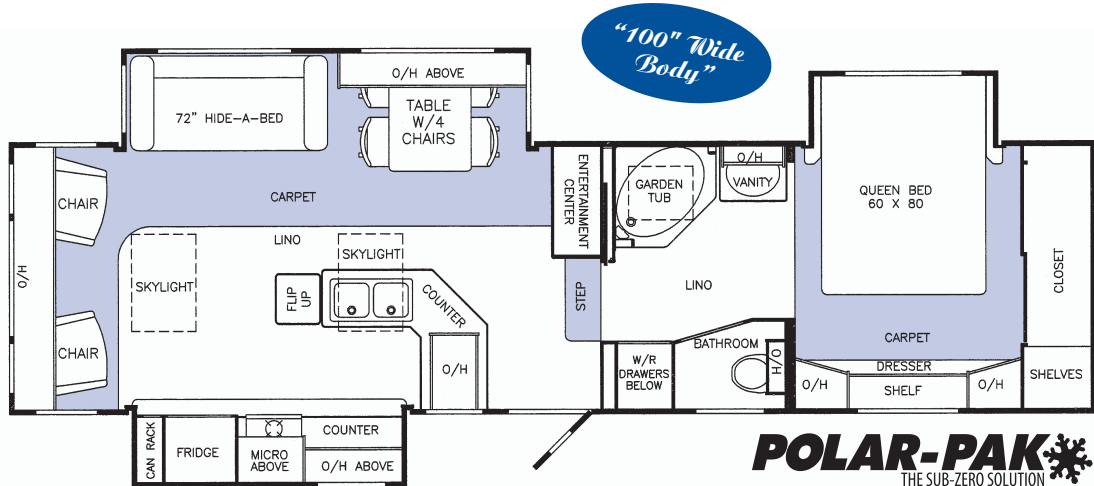

**POLAR-PAK**  
THE SUB-ZERO SOLUTION

\* Approximate height to top of air conditioner

## STANDARD FEATURES

### BATH/BEDROOM

- ◆ Fiberglass Garden Tub Enclosure W/Residential Faucet
- ◆ Porcelain Toilet W/Pedal Flush
- ◆ 6'0" Bedroom Height
- ◆ Pillowtop "Ultimate" Mattress
- ◆ Bedspread & Pillows
- ◆ Day/Nite Fabric Blinds
- \* "Fantastic" Vent Fan
- ◆ "Karadon" Solid Surface Vanity
- ◆ "Sta-Tite" Slide W/Manual Override

- ◆ TV Pre-Wire in Bedroom
- \* Residential Skylight/Shower with Moisture Control
- ◆ Vanity W/Polymer Sink & "Taymor" Residential Faucet
- ◆ Fluorescent Light in Bath
- ◆ Tooth Brush Holder, Soap Dish
- ◆ CO Detector
- ◆ Clothes Hamper in Bedroom

### KITCHEN

- ◆ Large Countertops W/Polymer Sink & Residential "Taymor" Faucet W/Spray
- ◆ Knife Block
- ◆ "Atwood" High Output Range Top
- ◆ "Norcold" 8 cu. ft. Fridge W/Aluminum Laminate Door Panels
- ◆ Kitchen Drawers-Birch Plywood-Nylon Rollers & Steel Guides
- ◆ "Karadon" Solid Surface Countertop
- ◆ Raised Beech Cabinet Doors
- ◆ Hardwood Table & 4 Chairs
- ◆ Fluorescent Lights in Ceiling

- \* "Fantastic Rain Sensor" Vent Fan
- \* Residential Skylight with Moisture Control & Blind
- ◆ Propane Leak Detector
- ◆ Clock
- ◆ Convection Microwave W/120V Range Hood
- ◆ Decorative Mirror
- ◆ Double Can Storage Rack
- ◆ Beech & Fabric Fascia - Kitchen Slide
- ◆ Central Vacuum w/Sweep

### LIVING ROOM

- ◆ 27" Flatscreen TV
- ◆ Residential Home Theater Stereo W/CD & DVD Player
- ◆ Surround Sound
- ◆ Cable/Telephone Hook Up
- ◆ Video Control Center
- ◆ Fire Extinguisher & Smoke Detector
- ◆ 120 V. Lights & Receptacle in Slide Out
- ◆ Day/Nite Fabric Blinds

- ◆ Beech End Table
- ◆ Electric "Sta-Tite" Rack & Pinion Super Slides-"Flush Floor"
- ◆ Fluorescent Lights in Ceiling
- ◆ Hide A Bed - 72"
- ◆ TV Antenna
- ◆ 2 - 30" Fabric Recliner Chairs
- ◆ Reading Lights
- \* Residential Skylight with Moisture Control & Blind
- ◆ Beech & Fabric Fascia - L.R. Slide

### EXTERIOR

- ◆ Medallion Filon High Gloss Fiberglass
- ◆ Entrance Door - 30"
- \* Stormtite Windows-Thermopane Glass
- ◆ Roof Rack & Ladder
- ◆ Shock Absorbers (4)
- ◆ "Dicor" Vinyl Seamless Roof
- ◆ 2 Rear Stab. Jacks
- ◆ Elec. Front Jacks W/Quick Release Pins
- ◆ MorRyde Pin Box System
- ◆ Aerodynamic Fuel Saver Front Fiberglass Cap
- ◆ Entrance Step Boot Shelf

- ◆ Exterior Shower in Compartment
- ◆ Aluminum Wheels (4)
- ◆ Hitch Hook Up Light
- ◆ BBQ Quick Connect
- ◆ Seamless Polypropylene Undersiding
- ◆ 8' Sewer Hose Compartment
- ◆ Automotive Undercoat
- \* Central Roof AC W/Heat Pump
- ◆ 18' Awning A&E
- ◆ Fold Away Assist Rail
- ◆ Underslung Tire
- ◆ Curbside Scare Light
- \* Compartment Doors w/1" Ins.

### MECHANICAL/CONSTRUCTION

- \* 2" Vac-U-Lam Sidewalls
- \* 3/8" Plywood Roof Deck
- \* Tapered Truss Roof
- \* R-11 Insulation - Roof
- \* Attic Ventilation System
- ◆ 16" Radials
- ◆ Dexter Nev-R-Lube Axles W/Elec. Brakes (12")
- \* "Dual" 2 Stage Furnaces 23-34 BTU
- \* Heated & Insulated Holding Tank Compartments
- ◆ 12V Disconnect
- ◆ Recessed Quad Battery Compartment
- ◆ 45 Amp Power Converter W/Batt. Charger
- ◆ 50 Amp Service with Detachable Cord

- \* Cable Ext. - Termination Valves
- \* Insulated Slide Out Floors 2<sup>3</sup>/<sub>8</sub>"
- ◆ XT16 Gas/Elec. DSI Water Heater 36 L (10 US Gal.) W/Bypass Valves
- ◆ Whisper King Water Pump
- ◆ Toilet Holding Tank 203 L (53.4 US Gal.)
- ◆ Fresh Water 232 L (61 US Gal.)
- ◆ Grey Water 194 L (51 US Gal.)
- ◆ Dual Propane Bottles 13.6 Kg ea. (30 lbs. ea.) W/Auto CO Reg.
- ◆ Slide Out Propane Tray
- ◆ Black Tank Flush
- ◆ Pre-Wire for Solar Panel
- ◆ Solar Panel & Satellite Pre-wire
- ◆ Antifreeze Pick Up System
- ◆ Adjustable Height Spring Hangers

### OPTIONS AVAILABLE

- ◆ Awning Upgrade 9000 Series
- ◆ Awning on Bedroom Slide
- ◆ Coffee Table
- ◆ Laminate Kitchen Floor\*
- ◆ Dinette ILO F/S Table\*
- ◆ "Fabric Leather" Recliners - 30"\*
- ◆ "Fabric Leather" Hide-a-bed
- ◆ Range w/Deep Oven\*
- ◆ Bedroom Pocket Door\*
- ◆ Electric Rear Stabilizer Jacks
- ◆ Garden Shower ILO Garden Tub\*
- ◆ Round Dining Table
- ◆ Solar Panel\* 100W
- ◆ "Norcold" 10 cu. ft. Fridge
- ◆ Beech Fridge Panels
- ◆ Washer/Dryer Cabinet
- ◆ Washer/Dryer-1 pc. Splendide\*
- ◆ Water Filter
- ◆ Generator Compartment\* (25x33)
- ◆ Hide-A-Bed w/Air Mattress
- ◆ Hide-A-Bed w/Footrest
- ◆ Memory Foam Mattress Pad
- ◆ 19" LCD TV in Bedroom
- \* Before Production Only.

Specifications are subject to change without notice or obligation.



# FIFTH WHEEL MODEL 33RLTS

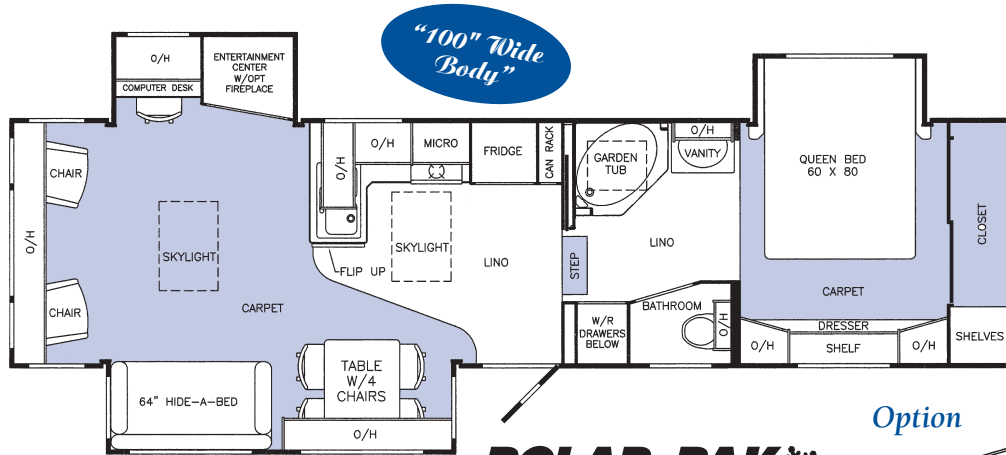

**POLAR-PAK**  
THE SUB-ZERO SOLUTION

Option

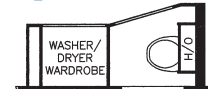

## SPECIFICATIONS

<b>GVWR</b>	6715 Kg/14,800 lbs.
<b>Dry Weight</b>	5633 Kg/12,415 lbs.
<b>Net Carrying Capacity</b>	1082 Kg/2,385 lbs.
<b>Axle Capacity</b>	6352 Kg/14,000 lbs.
<b>Hitch Weight</b>	1069 Kg/2,355 lbs.
<b>Height*</b>	3.8 M/12'4"
<b>Width</b>	2.5 M/8'4"
<b>Length</b>	10.5 M/34'4"
<b>Exterior Storage</b>	113 cu. ft.

\* Approximate height to top of air conditioner

## STANDARD FEATURES

### BATH/BEDROOM

- ◆ Fiberglass Garden Tub Enclosure W/Residential Faucet
- ◆ Porcelain Toilet W/Pedal Flush
- ◆ 6'0" Bedroom Height
- ◆ Pillowtop "Ultimate" Mattress
- ◆ Bedspread & Pillows
- ◆ Day/Nite Fabric Blinds
- ◆ "Fantastic" Vent Fan
- ◆ "Karadon" Solid Surface Vanity
- ◆ "Sta-Tite" Slide W/Manual Override
- ◆ TV Pre-Wire in Bedroom
- ◆ Residential Skylight/Shower w/Moisture Control
- ◆ Vanity W/Polymer Sink & Residential "Taymor" Faucet
- ◆ Fluorescent Light in Bath
- ◆ Tooth Brush Holder, Soap Dish
- ◆ CO Detector
- ◆ Clothes Hamper in Bedroom

### KITCHEN

- ◆ Large Countertops W/Polymer Sink & Residential "Taymor" Faucet W/Spray
- ◆ Knife Block
- ◆ "Atwood" High Output Range Top
- ◆ "Norcold" 8 cu. ft. Fridge W/Aluminum Laminate Door Panels
- ◆ Kitchen Drawers—Birch Plywood—Nylon Rollers & Steel Guides
- ◆ Double Can Storage Rack
- ◆ "Karadon" Solid Surface Countertop
- ◆ Raised Beech Cabinet Doors
- ◆ Hardwood Table & 4 Chairs
- ◆ Fluorescent Lights in Ceiling
- ◆ Residential Skylight w/Moisture Control & Blind
- ◆ Propane Leak Detector
- ◆ Clock
- ◆ Convection Microwave W/120V Range Hood
- ◆ Decorative Mirror
- ◆ Central Vacuum w/Sweep

### LIVING ROOM

- ◆ 27" Flatscreen TV
- ◆ Residential Home Theater Stereo W/DVD Player & Surround Sound
- ◆ Cable/Telephone Hook Up
- ◆ Video Control Center
- ◆ Fire Extinguisher & Smoke Detector
- ◆ 120 V. Lights & Receptacle in Slide Out
- ◆ Day/Nite Fabric Blinds
- ◆ Chair at Computer Desk
- ◆ Beech End Table
- ◆ Electric "Sta-Tite" Rack & Pinion Super Slides—"Flush Floor"
- ◆ Insulated Slide Floors 2 3/8"
- ◆ Fluorescent Lights in Ceiling
- ◆ Hide A Bed - 64"
- ◆ TV Antenna
- ◆ 2 - 30" Fabric Recliner Chairs
- ◆ Reading Lights
- ◆ Residential Skylight w/Moisture Control & Blind
- ◆ Solid Beech Fascia - Entertainment Centre Slide
- ◆ "Fantastic" Rain Sensor Vent Fan

### EXTERIOR

- ◆ Medallion Filon High Gloss Fiberglass
- ◆ Entrance Door - 30"
- ◆ Stormite Windows—Thermopane Glass
- ◆ Aerodynamic Fuel Saver Front Fiberglass Cap
- ◆ Roof Rack & Ladder
- ◆ Entrance Step Boot Shelf
- ◆ Shock Absorbers (4)
- ◆ "Dicor" Vinyl Seamless Roof
- ◆ 2 Rear Stab. Jacks
- ◆ Elec. Front Jacks W/Quick Release Pins
- ◆ MorRyde Pin Box System
- ◆ Aluminum Wheels (4)
- ◆ Hitch Hook Up Light
- ◆ BBQ Quick Connect
- ◆ Seamless Polypropylene Undersiding
- ◆ 8' Sewer Hose Compartment
- ◆ Automotive Undercoat
- ◆ Central Roof AC W/Heat Pump
- ◆ 15' Awning
- ◆ Fold Away Assist Rail
- ◆ Underslung Tire
- ◆ Curbside Scare Light
- ◆ Compartment Doors w/1" Ins.
- ◆ Exterior Shower in Compartment

### MECHANICAL/CONSTRUCTION

- ◆ 2" Vac-U-Lam Sidewalls
- ◆ 3/8" Plywood Roof Deck
- ◆ Tapered Truss Roof
- ◆ R-11 Insulation - Roof
- ◆ Attic Ventilation System
- ◆ 16" Radials
- ◆ Dexter Nev-R-Lube Axles W/Elec. Brakes (12 1/4" x 3 3/8")
- ◆ "Dual" 2 Stage Furnaces 23-34 BTU each
- ◆ Heated & Insulated Holding Tank Compartments
- ◆ 12V Disconnect
- ◆ Recessed Quad Battery Compartment
- ◆ 45 Amp Power Converter W/Batt. Charger
- ◆ 50 Amp Service with Detachable Cord
- ◆ Cable Ext. - Termination Valves
- ◆ XT16 Gas/Elec. DSI Water Heater 36 L (10 US Gal.) W/Bypass Valves
- ◆ Whisper King Water Pump
- ◆ Toilet Holding Tank 203 L (53.4 US Gal.)
- ◆ Fresh Water 232 L (61 US Gal.)
- ◆ Grey Water 194 L (51 US Gal.)
- ◆ Dual Propane Bottles 13.6 Kg ea. (30 lbs. ea.) W/Auto CO Reg.
- ◆ Slide Out Propane Tray
- ◆ Black Tank Flush
- ◆ Aluminum Wheels (4)
- ◆ Solar Panel & Satellite Pre-wire
- ◆ Antifreeze Pick Up System
- ◆ Adjustable Height Spring Hangers

### OPTIONS AVAILABLE

- ◆ "Weather Pro" Electric Awning\*
- ◆ Awning Upgrade 9000 Series
- ◆ Awning on Bedroom Slide
- ◆ Coffee Table
- ◆ Dinette ILO F/S Table\*
- ◆ Electric Fireplace
- ◆ Laminate Kitchen Floor\*
- ◆ Bedroom Pocket Door\*
- ◆ "Fabric Leather" Recliners - 30"
- ◆ Range w/Deep Oven\*
- ◆ Garden Shower ILO Garden Tub\*
- ◆ Round Dining Table
- ◆ "Norcold" 10 cu. ft. Fridge
- ◆ Beech Fridge Panels
- ◆ Solar Panel\* 100W
- ◆ Washer/Dryer Cabinet
- ◆ Washer/Dryer—1 pc. Splendide
- ◆ Water Filter
- ◆ Generator Compartment\* (25x33)
- ◆ Electric Rear Stabilizer Jacks\*
- ◆ Hide-A-Bed w/Air Mattress
- ◆ Hide-A-Bed w/Footrest
- ◆ Memory Foam Mattress Pad
- ◆ Drawers in Entertainment Center\*
- ◆ 19 LCD TV in Bedroom

\* Before Production Only.

Specifications are subject to change without notice or obligation.





# FIFTH WHEEL MODEL 34RLTS

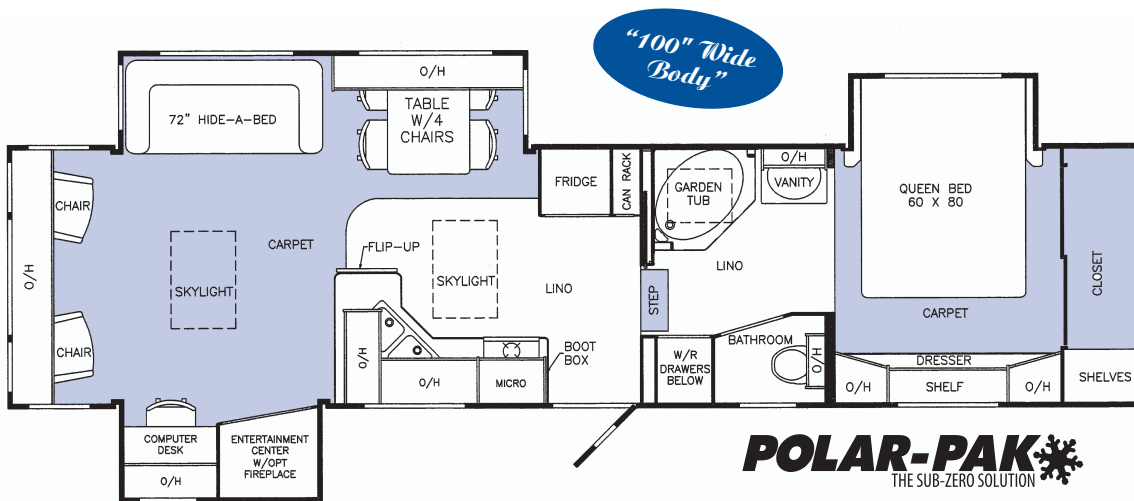

## SPECIFICATIONS

<b>GVWR</b>	6806 Kg/14,800 lbs.
<b>Dry Weight</b>	56942 Kg/12,550 lbs.
<b>Net Carrying Capacity</b>	1021 Kg/2,250 lbs.
<b>Axle Capacity</b>	6352 Kg/14,000 lbs.
<b>Hitch Weight</b>	935 Kg/2,060 lbs.
<b>Height*</b>	3.8 M/12'4"
<b>Width</b>	2.5 M/8'4"
<b>Length</b>	10.7 M/35'3"
<b>Exterior Storage</b>	113 cu. ft.

\* Approximate height to top of air conditioner

## STANDARD FEATURES

### BATH/BEDROOM

- ◆ Fiberglass Garden Tub Enclosure W/Residential Faucet
- ◆ Porcelain Toilet W/Pedal Flush
- ◆ 6'0" Bedroom Height
- ◆ Pillowtop "Ultimate" Mattress
- ◆ Bedspread & Pillows
- ◆ Day/Nite Fabric Blinds
- \* ◆ "Fantastic" Vent Fan
- ◆ "Karadon" Solid Surface Vanity
- ◆ "Sta-Tite" Slide W/Manual Override
- ◆ TV Pre-Wire in Bedroom
- \* ◆ Residential Skylight with Moisture Control
- ◆ Vanity W/Polymer Sink & Taymor Faucet
- ◆ Fluorescent Light in Bath
- ◆ Tooth Brush Holder, Soap Dish
- ◆ CO Detector
- ◆ Clothes Hamper in Bedroom

### KITCHEN

- ◆ Large Countertop W/Polymer Sink & "Taymor" Faucet W/Spray
- ◆ Knife Block
- ◆ "Atwood" High Output Range Top
- ◆ Norcold 8 cu. ft. Fridge W/Aluminum Laminate Door Panels
- ◆ Kitchen Drawers-Birch Plywood-Nylon Rollers & Steel Guides
- ◆ "Karadon" Solid Surface Countertop
- ◆ Raised Beech Cabinet Doors
- ◆ Hardwood Table & 4 Chairs
- ◆ Fluorescent Lights in Ceiling
- \* ◆ "Fantastic Rain Sensor" Vent Fan
- \* ◆ Residential Skylight with Moisture Control & Blind
- ◆ Propane Leak Detector
- ◆ Clock
- ◆ Convection Microwave W/120V Range Hood
- ◆ Decorative Mirror
- ◆ Double Can Storage Rack
- ◆ Central Vacuum w/Sweep

### LIVING ROOM

- ◆ 27" Flatscreen TV
- ◆ Residential Home Theatre Stereo W/CD & DVD Player & Surround Sound
- ◆ Cable/Telephone Hook Up
- ◆ Fire Extinguisher & Smoke Detector
- ◆ 120 V. Lights & Receptacle in Slide Out
- ◆ Day/Nite Fabric Blinds
- ◆ Beech & Fabric Fascia - L.R. Slides
- ◆ Electric "Sta-Tite" Rack & Pinion Super Slides-"Flush Floor"
- ◆ Fluorescent Lights in Ceiling
- ◆ Hide A Bed - 72"
- ◆ TV Antenna
- ◆ 2 - 30" Fabric Recliner Chairs
- ◆ Reading Lights
- \* ◆ Residential Skylight with Moisture Control & Blind
- ◆ Chair at Computer Desk
- ◆ Beech End Table
- ◆ Video Control Center

### EXTERIOR

- ◆ Entrance Door - 30"
- \* ◆ Stormtite Windows--Thermopane Glass
- ◆ Seamless Fiberglass Caps
- ◆ Aerodynamic Fuel Saver Front Fiberglass Cap
- ◆ Entrance Step Boot Shelf
- ◆ Roof Rack & Ladder
- ◆ Shock Absorbers (4)
- ◆ "Dicor" Vinyl Seamless Roof
- ◆ 2 Rear Stab. Jacks
- ◆ Elec. Front Jacks W/Quick Release Pins
- ◆ MorRyde Pin Box System
- ◆ Hitch Hook Up Light
- ◆ BBQ Quick Connect
- ◆ Seamless Polypropylene Undersiding
- ◆ 8' Sewer Hose Compartment
- ◆ Exterior Shower in Compartment
- ◆ Automotive Undercoat
- ◆ Central Roof AC W/Heat Pump
- ◆ 20' Awning A&E
- ◆ Fold Away Assist Rail
- ◆ Underslung Tire
- ◆ Curbside Scare Light
- \* ◆ Compartment Doors w/1" Ins.

### MECHANICAL/CONSTRUCTION

- \* ◆ 2" Vac-U-Lam Sidewalls
- \* ◆ 3/8" Plywood Roof Deck
- \* ◆ Tapered Truss Roof
- \* ◆ R-11 Insulation - Roof
- \* ◆ Attic Ventilation System
- ◆ 16" Radials
- ◆ Dexter Nev-R-Lube Axles W/Elec. Brakes (12<sup>1</sup>/<sub>4</sub>" x 3<sup>3</sup>/<sub>8</sub>")
- \* ◆ "Dual" 2 Stage Furnaces 23-34 BTU
- \* ◆ Heated & Insulated Holding Tank Compartments
- ◆ 12V Disconnect
- ◆ Recessed Quad Battery Compartment
- ◆ 45 Amp Power Converter W/Batt. Charger
- ◆ 50 Amp Service with Detachable Cord
- \* ◆ Insulated Slide Floors 2<sup>3</sup>/<sub>8</sub>"
- ◆ XT16 Gas/Elec. DSI Water Heater 36 L (10 US Gal.) W/Bypass Valves
- ◆ Whisper King Water Pump
- ◆ Toilet Holding Tank 203 L (53.4 US Gal.)
- ◆ Fresh Water 232 L (61 US Gal.)
- ◆ Grey Water 194 L (51 US Gal.)
- ◆ Dual Propane Bottles 13.6 Kg ea. (30 lbs. ea.) W/Auto CO Reg.
- ◆ Slide Out Propane Tray
- ◆ Black Tank Flush
- ◆ Solar Panel & Satellite Pre-wire
- ◆ Adjustable Height Spring Hangers

### OPTIONS AVAILABLE

- ◆ "Weather Pro" Electric Awning\*
- ◆ Awning Upgrade 9000 Series
- ◆ Awning on Bedroom Slide
- ◆ Coffee Table
- ◆ Laminate Kitchen Floor\*
- ◆ Dinette ILO F/S Table\*
- ◆ Bedroom Pocket Door\*
- ◆ Electric Fireplace
- ◆ "Fabric Leather" Recliners - 30"\*
- ◆ "Fabric Leather" Hide-a-bed - 72"
- ◆ Garden Shower ILO Garden Tub\*
- ◆ Round Dining Table
- ◆ Electric Rear Stabilizer Jacks\*
- ◆ Solar Panel\* 100W
- ◆ "Norcold" 10 cu. ft. Fridge
- ◆ Beech Fridge Panels
- ◆ Washer/Dryer Cabinet
- ◆ Washer/Dryer-1 pc. Splendide
- ◆ Generator Compartment\* (25x33)
- ◆ Water Filter
- ◆ Range w/Oven\*
- ◆ Hydraulic Disc Brakes w/Lube Shackles\*
- ◆ Hide-A-Bed w/Air Mattress
- ◆ Hide-A-Bed w/Footrest
- ◆ Memory Foam Mattress Pad
- ◆ Drawers in Entertainment Center
- ◆ 19" LCD TV in Bedroom
- \* Before Production Only.

Specifications are subject to change without notice or obligation.





# FIFTH WHEEL MODEL 34.5CKTS PLATINUM XL



New for 2007

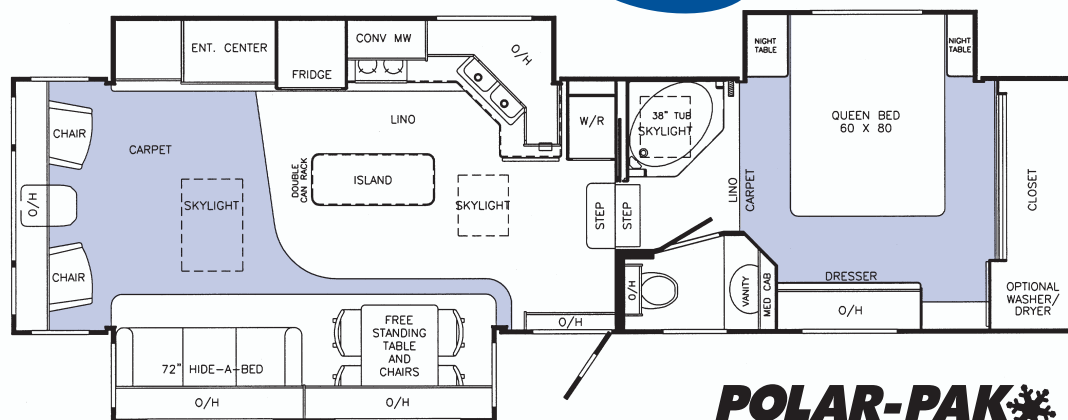

**POLAR-PAK**  
THE SUB-ZERO SOLUTION

## SPECIFICATIONS

<b>GVWR</b>	7033 Kg/15,500 lbs.
<b>Dry Weight</b>	5885 Kg/12,970 lbs.
<b>Net Carrying Capacity</b>	1150 Kg/2,530 lbs.
<b>Axle Capacity</b>	6352 Kg/14,000 lbs.
<b>Hitch Weight</b>	985 Kg/2,170 lbs.
<b>Height*</b>	3.9 M/12'9"
<b>Width</b>	2.5 M/8'4"
<b>Length</b>	10.7 M/35'4"
<b>Exterior Storage</b>	94 cu. ft.

\* Approximate height to top of air conditioner

## STANDARD FEATURES

### BATH/BEDROOM

- Fiberglass Garden Tub Enclosure w/Residential Faucet
- Porcelain Toilet w/Pedal Flush
- 6'6" Bedroom Height
- Pillowtop "Ultimate" Mattress
- Bedspread & Pillows
- Day/Nite Fabric Blinds
- \* "Fantastic" Vent Fan
- "Karadon" Solid Surface Vanity
- "Sta-Tite" Slide w/Manual Override
- TV & Satellite Pre-Wire in Bedroom
- \* Residential Skylight with Moisture Control
- Vanity w/Polymer Sink & Taymor Faucet
- Fluorescent Light in Bath
- Tooth Brush Holder, Soap Dish
- CO Detector
- Clothes Hamper in Bedroom
- Preplumb for Washer/Dryer

### KITCHEN

- Large Polymer Sink & "Taymor" Faucet w/Spray
- Undermounted Sink w/Solid Surface Covers
- Recessed "Atwood" High Output Range Top w/Solid Surface Cover
- Norcold 10 cu. ft. Fridge w/Aluminum Laminate Door Panels
- Kitchen Drawers—Birch Plywood—Nylon Rollers & Steel Guides
- "Karadon" Solid Surface Countertop
- 7'7" Interior Height
- Raised Beech Cabinet Doors
- Hardwood Table & 4 Chairs
- Fluorescent Lights in Ceiling
- \* "Fantastic Rain Sensor" Vent Fan
- \* Residential Skylight with Moisture Control & Blind
- Propane Leak Detector
- Clock
- Convection Microwave w/120V Range Hood
- Decorative Mirror
- Double Can Storage Rack
- Central Vacuum w/Sweep
- Slide-Out Garbage Can

### LIVING ROOM

- Residential Home Theatre Stereo w/CD & DVD Player & Surround Sound
- Cable/Telephone Hook Up
- Fire Extinguisher & Smoke Detector
- 120 V. Lights & Receptacle in Slide Out
- Day/Nite Fabric Blinds
- Beech & Fabric Fascia - L.R. Slides
- Electric "Sta-Tite" Rack & Pinion Super Slides—"Flush Floor"
- Fluorescent Lights in Ceiling
- 6'2" Height in Slide
- Hide A Bed - 72"
- TV Antenna
- 2 - 30" Fabric Recliner Chairs
- Reading Lights
- \* Residential Skylight with Moisture Control & Blind
- Fold Down Computer Desk in Entertainment Center
- Beech End Table
- Video Control Center
- 32" Toshiba LCD TV w/Swing Out Arm
- Recessed Halogen Lights

### EXTERIOR

- Entrance Door - 30"
- \* Stormite Windows—Thermopane Glass
- Aerodynamic Fuel Saver Front Fiberglass Cap
- Roof Rack & Ladder
- Entrance Step Boot Shelf
- Shock Absorbers (4)
- "Dicor" EPDM Seamless Roof
- 2 Rear Stab. Jacks
- Elec. Front Jacks w/Quick Release Pins
- MorRyde Pin Box System
- Hitch Hook Up Light
- Seamless Polypropylene Undersiding
- 8' Sewer Hose Compartment
- Exterior Shower in Compartment
- Utility Compartment w/Hose Reel
- Automotive Undercoat
- Central Roof AC w/Heat Pump
- 15' Awning A&E
- Fold Away Assist Rail
- Underslung Tire
- Curbside Scare Light
- \* Compartment Doors w/1" Ins.
- BBQ Quick Connect

### MECHANICAL/CONSTRUCTION

- 2" Vac-U-Lam Sidewalls
- 3/8" Plywood Roof Deck
- Tapered Truss Roof
- R-11 Insulation - Roof
- Attic Ventilation System
- 16" Radials
- Dexter Nev-R-Lube Axles
- W/Hydraulic Disc Brakes w/Lube Shackles
- \* "Dual" 2 Stage Furnaces 23-34 BTU
- \* Heated & Insulated Holding Tank Compartments
- 12V Disconnect
- Recessed Quad Battery Compartment
- 45 Amp Power Converter
- W/Batt. Charger
- 50 Amp Service w/Detachable Cord
- \* Insulated Slide Floors 2 3/8"
- XT16 Gas/Elec. DSI Water Heater 36 L (10 US Gal.) w/Bypass Valves
- Whisper King Water Pump
- Toilet Holding Tank 203 L (53.4 US Gal.)
- Fresh Water 232 L (61 US Gal.)
- Grey Water 194 L (51 US Gal.)
- Dual Propane Bottles 13.6 Kg ea. (30 lbs. ea.) w/Auto CO Reg.
- Slide Out Propane Tray
- Black Tank Flush
- Solar Panel & Satellite Pre-wire
- Adjustable Height Spring Hangers

### OPTIONS AVAILABLE

- "Weather Pro" Electric Awnings
- Awning Upgrade 9000 Series
- Awning on Kitchen Slide
- Awning on Living Room Slide
- Awning on Bedroom Slide
- Coffee Table
- Laminate Kitchen Floor\*
- Dinette ILO F/S Table\*
- "Fabric Leather" Recliners - 30"
- "Fabric Leather" Hide-a-bed
- Range w/Deep Oven\*
- Electric Rear Stabilizer Jacks
- Garden Shower ILO Garden Tub\*
- Dishwasher\*
- Round Dining Table
- Solar Panel\* 100W
- King Bed 72x80 ILO Queen
- Washer/Dryer—1 pc. Splendide\*
- Water Filter
- Generator Compartment\* (25x33)
- Hide-A-Bed w/Air Mattress
- Hide-A-Bed w/Footrest
- Memory Foam Mattress Pad - Queen or King
- 19" LCD TV in Bedroom
- \* Before Production Only.

Specifications are subject to change without notice or obligation.





# TRAVEL TRAILER MODEL 30RLS

## SPECIFICATIONS

<b>GVWR</b>	5263 Kg/11,600 lbs.
<b>Dry Weight</b>	4454 Kg/9,820 lbs.
<b>Net Carrying Capacity</b>	807 Kg/1,780 lbs.
<b>Axle Capacity</b>	5455 Kg/12,000 lbs.
<b>Hitch Weight</b>	381 Kg/840 lbs.
<b>Height*</b>	3.4 M/11'3"
<b>Width</b>	2.5 M/8'4"
<b>Length</b>	10.6 M/34'11"
<b>Exterior Storage</b>	35 cu. ft.

\* Approximate height to top of air conditioner

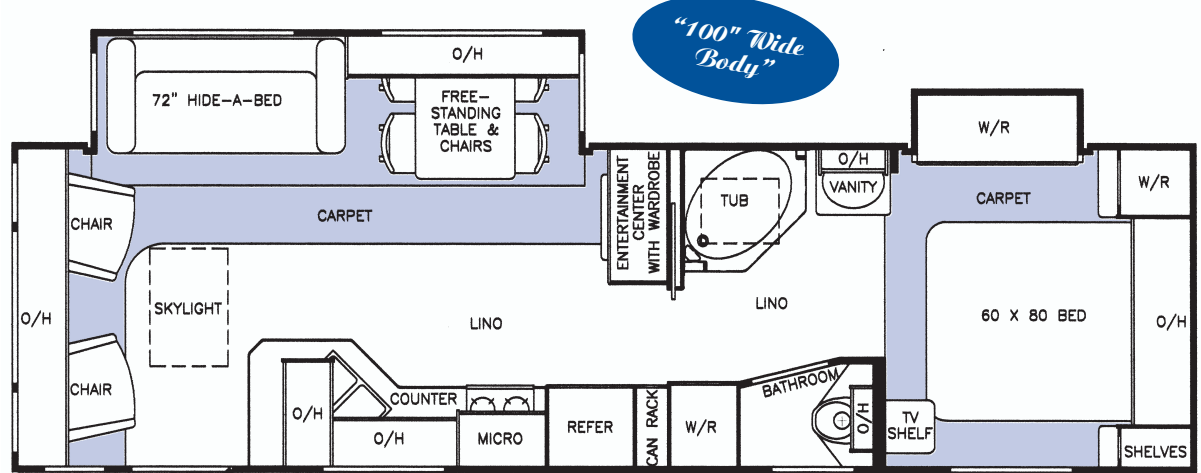

"100" Wide Body"

**POLAR-PAK**  
THE SUB-ZERO SOLUTION

## STANDARD FEATURES

### BATH/BEDROOM

- ◆ "Taymor" Vanity Faucet
- ◆ Power Vent in Toilet Compartment
- ◆ GFI Receptacle/Bath
- ◆ Residential Fiberglass Garden Tub
- ◆ Wardrobe Slide Out
- ◆ Day/Nite Fabric Blinds
- ◆ Pillowtop "Ultimate" Mattress
- ◆ Co-ord. Bedspread w/Pillows
- ◆ Residential Skylight with Moisture Control
- ◆ Glass Shower Door
- ◆ CO Detector
- ◆ "Fantastic" Vent Fan
- ◆ Porcelain Toilet

### KITCHEN

- ◆ Knife Block
- ◆ Jensen Range Hood W/Systems Monitor
- ◆ "Atwood" High Output Range
- ◆ "Norcold" 8 cu. ft. Fridge W/Aluminum Laminate Door Panels
- ◆ Raised Beech Cabinet Doors
- ◆ Polymer Kitchen Sink W/"Taymor" Faucet w/Spray
- ◆ Kitchen Drawers-Birch Plywood-Nylon Rollers & Steel Guides
- ◆ Hardwood Table & 4 Chairs
- ◆ Fluorescent Light in Ceiling
- ◆ "Fantastic Rain Sensor" Vent Fan
- ◆ 6'8" Interior Height
- ◆ Central Vacuum w/Sweep

### LIVING ROOM

- ◆ Cable/Telephone Hook Up
- ◆ Residential Skylight with Moisture Control
- ◆ Slide Out W/120 V. Lights & Receptacle
- ◆ Day/Nite Fabric Blinds
- ◆ Home Theatre Stereo w/CD, DVD & Surround Sound
- ◆ Satellite Pre-Wire
- ◆ "Sta-Tite" Rack/Pinion Slide Mechanism-"Flush Floor"
- ◆ Raised Beech Cabinet Doors
- ◆ Beech End Table
- ◆ Fluorescent Light in Ceiling
- ◆ 2 - 28" Recliners
- ◆ 27" Flat Screen TV

### SUPREME STANDARD FEATURES

- ◆ Central Roof AC-13.5
- ◆ Awning 18' A&E 8500
- ◆ Microwave Oven
- ◆ TV Antenna
- ◆ Black Tank Flush
- ◆ Fold Away Assist Rail
- ◆ Hide A Bed - 72"
- ◆ 16" Aluminum Wheels (4)
- ◆ Antifreeze Pickup System
- ◆ Roof Rack & Ladder
- ◆ Stabilizer Jacks-Front & Rear
- ◆ TV Shelf/BR
- ◆ Propane Leak Detector

### EXTERIOR

- ◆ Stormite Windows Thermopane Glass
- ◆ "Medallion Filon" Fiberglass Exterior
- ◆ Aerodynamic Fiberglass Caps
- ◆ Propane Bottles Cover
- ◆ Fiberglass Radius Skirt & Fenders
- ◆ Compartment Doors w/1" Ins.
- ◆ "Dicor" Seamless Vinyl Roof
- ◆ Power Front Jack w/light
- ◆ Full Width Exterior Storage
- ◆ Hitch Hook Up Light
- ◆ Entrance Step Boot Shelf
- ◆ BBQ Quick Connect
- ◆ Polypropylene Undersiding
- ◆ Golf Club Storage
- ◆ Curbside Scare Light

### MECHANICAL/CONSTRUCTION

- ◆ Crowned Truss Roof R-11 Insulation
- ◆ Attic Ventilation System
- ◆ 2 Stage Furnace 23-34 BTU
- ◆ 45 Amp Power Converter W/Batt. Charger
- ◆ 30 Amp Service with Detachable Cord
- ◆ Hot Water Bypass Valves
- ◆ XT16 Gas/Elec. Water Heater W/DSI 36 L (10 US Gal.)
- ◆ Whisper King Water Pump
- ◆ Toilet Holding Tank 203 L (53 US Gal.)
- ◆ 12V Disconnect
- ◆ Fresh Water 232 L (61 US Gal.)
- ◆ Grey Water 194 L (51 US Gal.)
- ◆ Dual Propane Bottles 13.6 Kg ea. (30 lbs. ea.)
- ◆ Insulated Slide Floors 2 3/8"
- ◆ Auto Change Over Propane Regulator
- ◆ 2" Vac-U-Lam Sidewalls W/Db'l. Plywood
- ◆ Full Frame Construction
- ◆ 3/8" Plywood Decked Roof
- ◆ 16" Goodyear Radials
- ◆ 2-6,000 lbs. "Dexter Nev-R-Lube Axles" 100,000 Mile Warranty
- ◆ 4 Shock Absorbers & Leaf Springs
- ◆ Heated & Enclosed Holding & Fresh Water Tanks
- ◆ Solar Panel & Satellite Pre-Wire
- ◆ Antifreeze Pickup System

### OPTIONS AVAILABLE

- ◆ "Weather Pro" Electric Awning
- ◆ Awning Upgrade 9000 Series
- ◆ Awning on Bedroom Slide
- ◆ Awning on Livingroom Slide
- ◆ Dinette ILO F/S Table\*
- ◆ Exterior Shower\*
- ◆ Electric Rear Stabilizer Jacks\*
- ◆ Coffee Table
- ◆ Laminate Kitchen Floor
- ◆ "Norcold" 10 cu. ft. Fridge\*
- ◆ Beech Fridge Door Panels
- ◆ Round Dining Table
- ◆ "Fabric Leather" Recliners 28"
- ◆ Solar Panel\* 100W
- ◆ Garden Shower ILO Garden Tub\*
- ◆ Water Filter
- ◆ Hide-A-Bed w/Air Mattress
- ◆ Hide-a-Bed w/Footrest
- ◆ Memory Foam Mattress Pad

\* Before Production Only.

# POLAR PAK FEATURES



## \*NORTH AMERICA'S BEST POLAR PAK! - YOUR SUB ZERO SOLUTION



General Coach has developed the best all season product available today. The exclusive Polar Pak Features are a combination of Canadian residential components and proven all season residential construction techniques. Our full wood frame Vacuum laminated walls are 2" thick, residential style truss roof and framed floor with 5/8" plywood will not sweat or conduct heat and cold as aluminum framing.



The "Dayliter" skylights from Richmond, BC are the best residential skylight on the market today. Only "Dayliter" skylights control interior moisture build up by catching the moisture in a drip rail and weeping the moisture to the exterior not back into the unit or into the roof cavity. Integral venting allows air to flow between the dual aircraft acrylic panes to prevent frost or moisture forming.



Made in Canada "Stormtite" thermopane windows are proven to be the best all season windows with an extra heavy duty frame and the only framed sliding section that locks in the closed position for a positive seal against dust and moisture. The solar reflective glass also provides daytime privacy and reduces heat build up by 10 to 15%.



The exclusive "Attic" ventilation system allows fresh air to be circulated through the ceiling cavity to reduce heat in the summer and condensation in the winter. The system consists of a fresh air intake at the rear of the unit and a 12 volt marine extraction fan on the roof above the bedroom. The fan is controlled by a 2 speed switch in the roadside cabinet.

"Excalibur XT" Two Stage furnaces conserve fuel and reduce noise for quieter nights. Set the digital thermostat and let the furnace take over. During cold start-ups the furnace operates on the high BTU. and high fan for quick quiet warm up. Then, when the temperature is reached the furnace automatically switches to low BTU and low fan to maintain the set temperature. The Models 32.5TKS and larger have 2 separate furnace systems for the best control of temperature through out the unit.

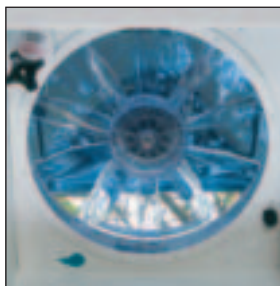

All models have the "Fantastic" Rain Sensor vent fans in the living area. The rain sensor is controlled from a wall thermostat that can be set according to temperature and humidity. Larger models also have a "Fantastic" vent fan above the vanity to control the bathroom humidity.



Holding Tanks are enclosed within a steel compartment that is insulated and heated with a direct duct from the furnace. Most models have the dump valve handles located above in a heated storage compartment, easy access and protected from road hazards. Compartment doors have 1" of High Density Foam Insulation.

**North America's  
Best Polar Pak!**

**POLAR-PAK**  
THE SUB-ZERO SOLUTION



*Specifications are subject to change without notice or obligation.*







The Model 32.5TKS rear lounge triple slide boasts an exceptionally open floor plan and a generous kitchen area due to General Coach's exclusive 100" wide body design. Comfortable, residential hide-a-beds are available with several options including footrests, air mattress and leather fabric.

Model 32.5TKS – Amaryllis Decor

“When we purchased our previous General Coach 5th Wheel we were sent a survey form. There were 3 things that we felt could have been improved upon. You actually listen to customers! When we chose our new General Coach 5th Wheel (Model 30RLDS) those suggestions were made. We're really pleased to deal with a company who does listen to and care about their customers. Also, the workmanship and comfort of our unit are tops. The people who are on the assembly line truly take pride in their work and it shows, when you look at how well these units are built inside and out.

Lloyd & Jan Harvey  
Cranbrook, British Columbia



The Model 30RLDS kitchen features a large double pull out can rack, deluxe "Atwood" high output range, numerous large full depth drawers, deep, scratch resistant polymer fiberglass sink and a top quality "Taymor" faucet with spray. The optional "Norcold" 10 cubic foot refrigerator maximizes usable storage space.

Our unique slide out construction features a 2 3/8" thick full frame insulated floor; a solid beech and fabric fascia and is double sealed in the open or closed position. The slide system combines a rack and pinion drive with steel rollers and a built in travel locking system. No cables or hydraulics to worry about.



Model 30RLDS

Specifications are subject to change without notice or obligation.



The ever popular Model 26RKS is shown above in the vibrant Savannah interior. The length of this model makes it easily towable yet this unit is very versatile with an abundance of cupboards and numerous drawers. Appliances including the appliances are in a modern platinum finish. the Hide-A-Bed has an optional flip-out footrest and reversible color pillows.



Hand-cranked stabilizing becomes a backache of the past with the optional Quick Draw Electric Stabilizer Jacks. Both jacks operate together and ensure equal pressure is on both legs. A touch of the switch results in a level and stable unit. The maximum support is 3200 lbs. A 3 Year warranty provides peace of mind.

Optional "Carefree" Awnings over the Bedroom Slide Out provides extra protection from the elements. The Bedroom slide outs are optional in the Models 29CKS, 29.5RLS, 30RLDS and standard in Model 29RKDS, 31.5RLS and larger.







The top selling rear kitchen Model 29RKDS shown in the rich Autumn Fern decor combines exceptional residential livability in a very towable 30'. Abundant storage with the full width kitchen cabinetry and superb lighting from the large residential skylight and numerous windows ensures your comfort. The optional "Norcold" 10 cubic foot refrigerator is a great addition for the full timer. The "Atwood" XT Water heater that provides the equivalent hot water to a 16 gallon tank with only a 10 gallon tank.



*"We've only used our 29RKDS one season, but so far we love it!"*  
Lorne & Jean W., Duncan, BC

Model 29RKDS Autumn Fern Decor

## *Don't Settle for Less!*



Shown above is the Model 33RLTS in the plush Savannah interior with a superb view of the exterior from the spacious dining table and chairs. All triple slide models have a convection microwave oven and range top standard. 50 Amp Service is a standard feature in Models 29 and up to ensure adequate power for all your needs. Additionally, all triple slide models incorporate 2 "Two Stage" furnaces - part of General Coach's Polar Pak - The Best in North America!





The luxurious Model 30RLS Travel Trailer in Autumn Fern Decor

## SUPREME CONSTRUCTION CROWNED ROOF

- 1 "Dicor" vinyl roof, seamless, overlaps the sidewall, 12 year warranty
- 2  $\frac{3}{8}$ " plywood deck, screwed to truss
- 3 Fiberglass insulation R-11 full width
- 4 Engineered residential crowned truss,  $5\frac{1}{4}$ " thick in centre sloped to  $3\frac{1}{2}$ " on the ends
- 5 Insulated rigid air conditioning duct - 2"
- 6 Drip rail with down spouts
- 7 Interior ceiling panel - plywood

## VACUUM BONDED WALL

- 8 "Medallion Filon" gelcoat panels
- 9 Plywood substrate
- 10 Kiln dried studs - 2x2, 2x4, 2x6
- 11 Ultra high density rigid polystyrene insulation
- 12 Interior panel - plywood

Walls on all models are framed utilizing 2" x 2", 2" x 3" and 2" x 6" kiln dried studs, steel reinforced and mounted directly on top of the foundation floor.

The sidewalls are individually laminated, cured under vacuum pressure and tear tested for a perfect bond prior to installation. Laminated to plywood, the Filon gelcoat panels are warranted for 2 years materials and labor and guarantees a high resale value as it retains colour and lustre and won't rust, corrode, ding or dent.

**POLAR-PAK** ❄️  
THE SUB-ZERO SOLUTION

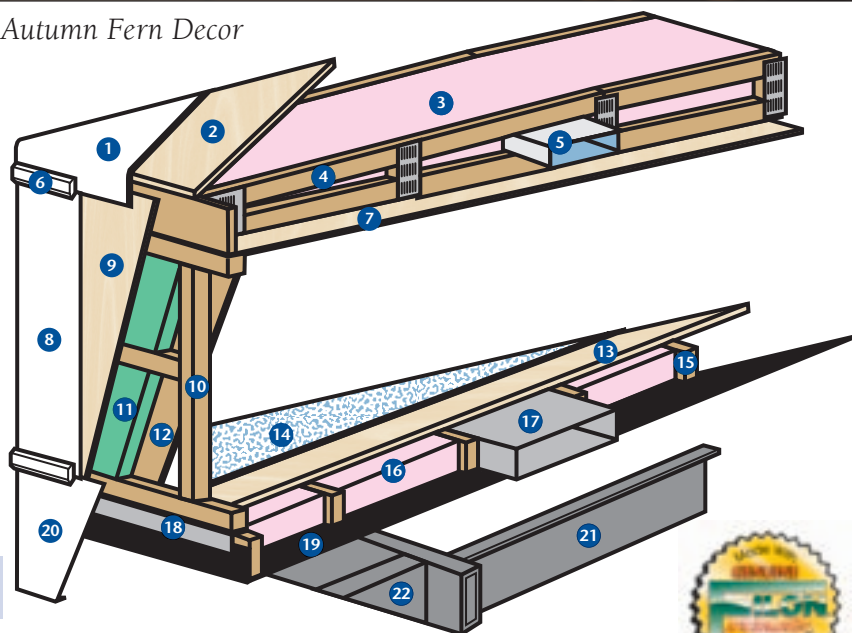

## FOUNDATION FLOOR

- 13  $\frac{5}{8}$ " plywood tongue & groove deck - glued and screwed to studs
- 14 Vinyl flooring residential installation
- 15 Kiln dried studs
- 16 Fiberglass insulation
- 17 Galvanized steel heat ducting (not all models)
- 18 Galvanized steel flashing

- 19 Seamless polypropylene undersiding complete wrap up sides, front and rear
- 20 Fiberglass radius skirt, double sealed at marriage
- 21 Floor is bolted to steel chassis. Steel is fully undercoated with automotive undercoat. Holding tanks are enclosed, insulated and protected within the 12 gauge steel chassis members and heated directly from the furnace.
- 22 12 gauge steel outriggers support full width of floor.





The Models 31CKDS and 34.5CKTS have a unique level floor throughout the bath and bedroom area allowing a king bed option before production. The units are pre-plumbed for an optional washer-dryer combination in the front wardrobe. Overhead cabinetry in these models allows for an optional 19" LCD TV and abundant storage is provided by deep drawers and large mirrored wardrobe.

Model 31CKDS, 34.5CKTS bedroom

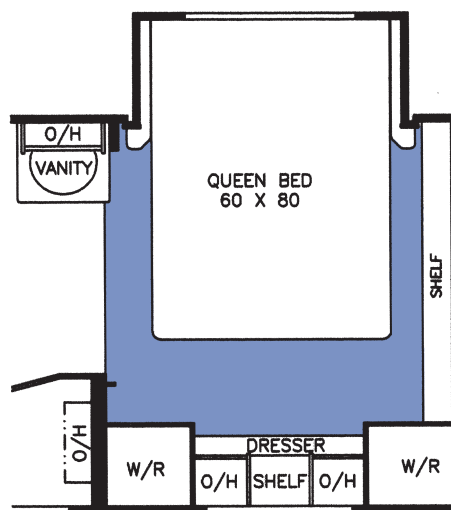

#### OPTIONAL BEDSLIDE

Models 29CKS, 29.5RLS, 30RLDS  
FIFTH WHEEL



Most models with the Garden Tub can be ordered with the optional garden shower designed for ease of access. The optional pocket door improves bedroom privacy and is available in most walk thru bath models.

**Don't Settle for Less!**

Optional Pocket Door to Bedroom  
& Optional Shower in lieu of Garden Tub.





## Citation Supreme - Don't Settle for Less!!

General Coach is proud of our 99% customer satisfaction record.  
But don't take our word for it, ask our owners for *their opinions*.

“Just letting you know that we made our yearly trip to Jasper this year and we stayed in the same cold weather as we did in the 28.5. We had no problems with sewer valves freezing and everything worked fine

Rae S.  
Prince George, British Columbia

“We have been extremely pleased with the performance of our General Coach. We looked at many different brands of 5th wheel over the last few years and talked to many Rvers. Your product certainly stood out in many ways and General Coach's reputation is very good in the RV community. There are many, many features that make our travels extremely comfortable and enjoyable.

Alan & Shirley N.  
Surrey, British Columbia

“We have found after buying two new units from the same dealer and manufacturer that the service and quality is outstanding and we would have no problem recommending both.

Dave R.  
Oliver, British Columbia

“Every trailer has its pluses and minuses. One gets used to them in time, so there aren't any major “dislikes”. That's why I bought 4 in 10 years.

Gerhard K.  
Kelowna, British Columbia

“The Model 33RLTS is an outstanding unit, with few if any features left out. Please thank all the engineers, designers and staff for a job well done.

Elaine & John P.  
Fort McMurray, Alberta

“In 1989, we took five factory tours in BC and Alberta, including General Coach in Oliver. General Coach was the best quality and had the most attractive appearance. Although the price was slightly more than the others, we bought our first General Coach in 1991 and have never been sorry. In October of 2000, we bought our second General Coach Fifth Wheel. The quality is still excellent and with more features, we really enjoy our trailer. We get lots of compliments in campgrounds. We certainly appreciate the value for our dollars. Thanks for building a great fifth wheel.

Cleave & Diane B.  
Maple Ridge, British Columbia

“We believe that the General Coach line is one of the top lines in North America. We have owned 7 General Coach products.

Heinz & Marlene L.  
150 Mile House, British Columbia

“As we have had this unit 2 years now I believe this survey is now very complete. I am impressed with the warranty schedule offered by General Coach and appreciative of your warranty manager who has assisted us throughout. Thank you for a great coach.

Rex & Hazel B.  
Saskatoon, Saskatchewan

“Overall very satisfied, would like to see unit a little lighter but accept weight for solid construction. The quality is excellent both inside and out. I have recommended you to family and friends. Just love our fifth wheel.

Roy E.  
Kelowna, British Columbia

“Having had considerable experience trailering with 6 different manufacturers' products, we are happy to say we are pleased with every aspect of our General Coach 5th Wheel. Perhaps the best comment is to simply state that the built-in quality of this product speaks to our comfort, enjoyment and the sense of pride we realize from our home away from home.

Don & Marg C.  
Kamloops, British Columbia

“It is warm in the winter as I work in it all year round in the oil field.

Alan S.  
Redcliffe, Alberta

“We owned the 1991 for 10 years. We had no problems at all with the 1991. So far we like our new 34RLTS.

Barb & Ray C.  
Fort St. John, British Columbia

“We've travelled at least 4900 kms, east to Kenora, north to Meadow Lake and south to the border. The Mor-Ryde is a treat. It takes the road echo out of the truck. Manitoba and Saskatchewan roads are the test of this device. Finish of our unit is of a very high standard. My wife is so happy with the storage and arrangement of the unit. We were up north and had both furnaces going - worked great and quiet.

Clare C.  
Penticton, British Columbia

The following is an excerpt from the “RV Times” magazine:

“We really do enjoy your publication. Our last trip was of three months duration: 16,200 miles, most of them in Canada. We would like to sing the praise of our new trailer built by General Coach in B.C. Our travel is always off-season and we looked for something that would be comfortable on the Alaska Highway in winter. More Canadians should know about this product.

Eva B.  
Skagway, Alaska



## Our Commitment to Customer Satisfaction

Citation's full two-year limited warranty is reinforced by a limited six-year structural integrity warranty and a two-year component warranty. Quality assurance you can depend on! This added warranty is unique to the recreational vehicle industry and should be one of your very serious considerations when choosing your next R.V.

Citation is backed by a national dealer and service network that is some 100 strong and stretches from coast-to-coast as well as affiliates in the U.S.A. for

North American worry free travel. These dealers and dealer service technicians will gladly attest to the excellence of Citation's construction and quality.

Join thousands of General Coach customers in North America and take command of the road with your Citation. A buying decision you'll never regret.

We are very proud of our highly skilled people who exercise extreme care in the manufacture of every Citation. We invite you to visit us at General Coach, see the quality process yourself. We know you'll be impressed and we know you'll love the Okanagan Valley.



*Model 30 RLS Travel Trailer*



**GENERAL COACH**

P.O. Box 700

Oliver, BC V0H 1T0

Telephone: (250) 498-3471

Fax: (250) 498-3240

[gcsales@otvcablelan.net](mailto:gcsales@otvcablelan.net)

[www.generalcoach.bc.ca](http://www.generalcoach.bc.ca)

*Proudly Presented By*

**POLAR-PAK** ❄️  
THE SUB-ZERO SOLUTION



**THOR**  
CANADA'S BEST RV VALUE



Printed in Canada by  
Wayside Press Ltd.