

20
AMBASSADOR®
06

HOLIDAY RAMBLER®
This is Living®





THE BIG LEAGUE IS CALLING YOU.

With a prestige all its own, a luxury diesel motorcoach is a big step up. And there's no better way to experience the excitement than in a 2006 Ambassador. Simply put, this coach is an unbeatable value, setting the standard in its class for power, performance, features and craftsmanship. We invite you to take a closer look at all the details — from the stylish creature comforts to the ride and handling of the Roadmaster chassis. Plus, be sure to factor in the many invaluable benefits of joining the Holiday Rambler family. Before long, we think you'll agree: the Ambassador is the perfect answer.

A





TALL, BRIGHT AND HANDSOME.

The Ambassador is loaded with features you'll fall in love with — starting with the spacious new ceiling height of seven feet. Throughout the coach, you'll enjoy residential details and gorgeous woodwork, with raised panel hardwood cabinet doors, crown molding and hardwood slide-out fascia with fluted accents and a decorative center block. Plank flooring and textured padded carpeting combine to offer warm styling and worry-free durability. And you'll have a wide range of impressive furniture options to customize your floorplan to fit your lifestyle.



- A) Wherever your travels lead, you'll look forward to coming home to the roomy luxury of the Ambassador's private quarters. The bed slide-out (not available on the 37PBD) is now a whopping 30 inches deep, giving you more floor space than ever before. The queen bed features a hardwood headboard with raised panel inserts and beautifully styled bedspread and pillow shams. And each floorplan offers thoughtfully arranged storage to help you keep things neatly stowed away.
- B) The bathroom is bright and cheerful, with a skylight and decorative vanity lights. The one-piece fiberglass shower cleans up easily and has an obscure glass enclosure with two handy towel bars. You'll have plenty of space to securely store all your essentials in the vanity and medicine cabinet. And it's all topped off with the contemporary styling of the solid surface countertop and integrated sink.
- C) The kitchen brings together gracious styling with roomy workspace and storage space and high-quality appliances. You'll love the seamless styling of the polished solid surface countertop with an under-mounted plexus-stone sink. For convenience, there's a single-lever faucet with pullout sprayer, as well as a second faucet for filtered water. And to create great meals in a snap, you'll have a high-output three-burner cooktop and a versatile combination microwave/convection oven.

THE MARRIAGE OF STYLE AND SAFETY.

The Ambassador's plush cockpit is designed with everything you need for a better driving experience and superior protection. It all starts behind the scenes, with the Roadmaster chassis' steel cage cockpit construction and steel firewall, as well as the adjustable brake and accelerator pedals. The eagle burlwood dash is well organized with easy-to-read gauges, and all the controls are within easy reach. Soft touch vinyl seats (OptimaLeather™ in the Liz Claiborne decors) offer the convenience of six-way power controls and a power footrest on the co-pilot's seat.



- A) The Roadmaster chassis provides for large pass-through storage spaces, accommodating larger items with ease. In addition, our side-hinged baggage doors are easier to open, increase your visibility and make it a snap to load and unload.
- B) The Onan® 8.0 kW Quiet Diesel generator is accessed through the front cap on a pullout tray, making it easy to reach for servicing.
- C) A rear vision system with audio and an adjustable camera lets you see and hear what's behind the coach. A new upgrade this year is an optional 3-camera system with an adjustable center camera. In addition, the optional Aladdin™ Junior system uses the monitor to display its many valuable functions.



- The Ambassador's stylish front cap is accented by numerous safety features. Our exclusive Panaview™ 1-piece windshield provides the largest unobstructed view in the industry. Slender side pillars increase your peripheral vision, and the wipers are conveniently mounted below your field of view. The 17.5" chrome power heated mirrors are also mounted on the front cap — so you don't have to turn your head away from the road.



1-PIECE WINDSHIELD



WHERE ALL THE DETAILS COME TOGETHER.

Holiday Rambler has long set the standard with warm, inviting interiors that feature a perfect harmony of fabrics, accents and carpeting. We've also led the way with stunning woodwork and superb craftsmanship, including raised panel hardwood cabinet doors, hardwood end panels, wood drawer boxes and heavy-duty ball bearing guides. Select the combination that suits you best to customize your Ambassador and make it distinctively your own.

- A. BEDSPREAD
- B. SOFA
- C. CORIAN®
- D. ACCENT
- E. CARPET

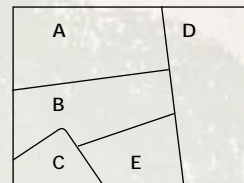

BRUSHED NICKEL



SPANISH MOSS

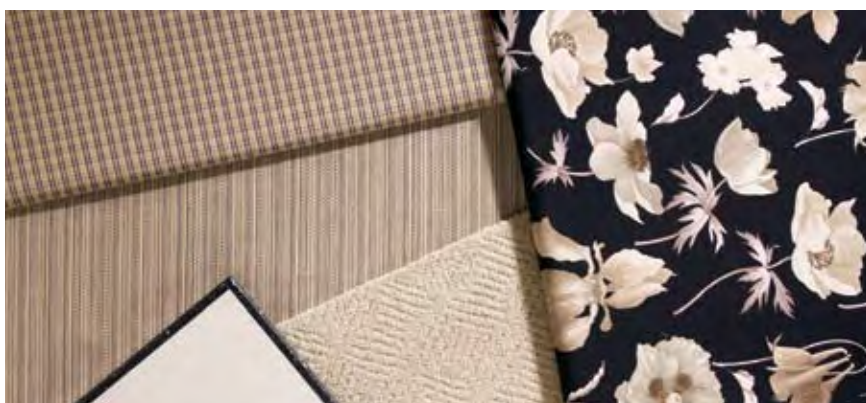

BLACKWOOD MANOR II — LIZ CLAIBORNE



AMBASSADOR HARDWARE

Our elegant cabinet hardware design features a satin brass finish.



Manufactured in, not added on. For added protection against stains, soil repellent is applied to virtually all upholstery fabric during the finishing process for superior coverage.*

*Brand and application of upholstery fabric protection may vary depending on date recreational vehicle was manufactured.



NEW VINTAGE OAK



CHAMPAGNE SELECT



NEWPORT CHERRY



CANYON MOSAIC — LIZ CLAIBORNE

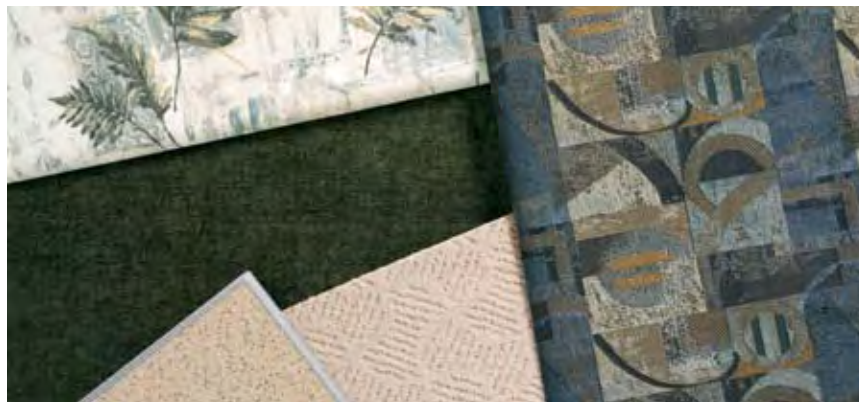

MESA PINE



EXTERIOR COLORS/WOODS/FABRICS

AT HOLIDAYRAMBLER.COM, WE'RE ALWAYS OPEN.

Visit our website anytime day or night to check out the latest product news and updates. You can also take a factory tour, find a dealer near you, get information on club events and much more. It's also an easy way to contact us via e-mail.

www.holidayrambler.com

WE'VE GOT YOUR BACK.



- Live customer support 24/7/365
- 350 Nationwide Service Centers
- Free first-year enrollment in our Owner Advantage Roadside Assistance Program
- Call 1-800-634-0855 or 1-800-650-7337 to arrange a tour of one of our state-of-the-art production facilities in Indiana or Oregon.

ROADMASTER RAISED RAIL RR8R CHASSIS

The 2006 Ambassador owes its remarkable performance to the Roadmaster Raised Rail RR8R Series chassis. You'll marvel at the seamless ride and handling that's only possible in a chassis that's designed exclusively for a luxury motorcoach and custom-built to the exact specifications of each floorplan. We invite you to take a few minutes and discover all the ways Roadmaster offers you the very best in safety, reliability, comfort and convenience.



The Ambassador features Holiday Rambler's exclusive Alumaframe® Superstructure. Our revolutionary system of interlocking aluminum H and C-Channel crossmembers runs the entire length of the unit, with double-welded intersections for added strength. This rigid design is both lighter and sturdier than wood or tubular aluminum frames — and much more reliable than butt-welded or screwed joint designs. From dirt roads to potholes, you can count on Alumaframe® to handle the relentless stresses of the road and provide superior structural integrity for many years to come.

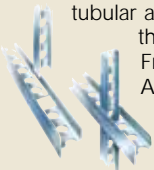

Alumaframe®



Wood



Aluminum
(Butt-Welded)



Alumaframe®
(C-Channel)

A steel cage cockpit gives the Roadmaster chassis incomparable strength and safety in the front of the coach.

Every Roadmaster chassis features a steel firewall for added protection in the cockpit.

Other features include a 3/8" thick frame rail — compared to the 1/4" of other manufacturers — and a stacked aluminum intercooler and radiator for optimum heat transfer and cooling.

For extra strength and reliability, our slide-out boxes feature exclusive multi-layer construction for maximum insulation and less chance of warping, twisting or shifting.



Dual fuel fill allows you to fill the tank from either side of the coach, for greater convenience and flexibility at the pump.

Eight outboard-mounted air bags work in conjunction with eight gas-powered shock absorbers to prevent road trauma from ever reaching the coach.

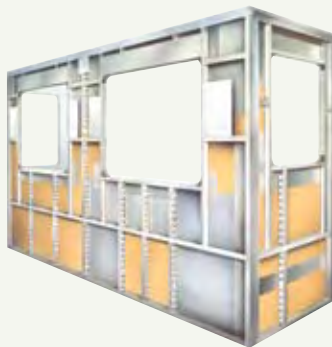

SLIDE-OUT CONSTRUCTION:

When you get a Holiday Rambler, you can be sure the slide-out boxes are some of the strongest and most reliable you'll find anywhere. They feature our exclusive multi-layer construction to give you maximum insulation and to reduce the chance of warping, twisting or shifting.

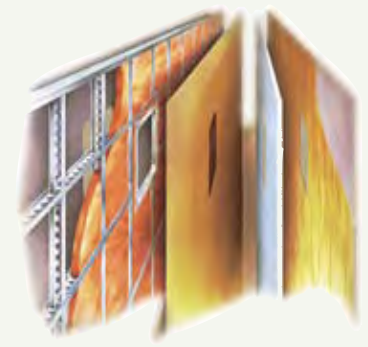

TRUSS SYSTEM WITH RUST INHIBITOR:

This steel truss system is engineered as part of the chassis and provides outstanding strength and rigidity, as well as the convenience of pass-through storage. To prevent corrosion, the structure is pre-primed and coated with rust-inhibiting paint.



Monitored leveling sensors continually adjust the air pressure at each axle to maintain a level ride and eliminate nosediving, weight transfer and floating on curved roads. This system also stabilizes the coach on uneven surfaces.

The exclusive raised rail design provides for larger full pass-through storage bays with flush floors.

A 10,000 lb. tow hitch rating is the highest in its class.

The Ambassador features a gutsy standard Cummins® ISC 330 diesel engine with Allison® 3000 MH 6-Speed World Transmission and electronic shifter.

**9-LAYER ROOF:** (top to bottom)

- One-piece peaked fiberglass roof
- Luaun backing
- Thick, tapered bead foam insulation
- Aluminum double I-beam superstructure filled with fiberglass insulation
- Vapor barrier
- Structure foam: thermal insulative barrier
- 1/2" bead foam insulation
- Foam padding for extra insulation
- Padded vinyl ceiling

SIDEWALL CONSTRUCTION: (left to right)

- Gel coat fiberglass
- Interlocking C-Channel filled with 1-1/2" fiberglass insulation glued in place so it doesn't sag or leave spaces uninsulated
- Vapor barrier
- Bead foam saves energy and provides a thermal insulative barrier
- Interior paneling

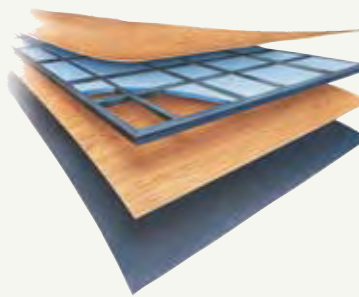
**FLOOR CONSTRUCTION:** (top to bottom)

- Structurwood™
- 1-1/2" x 1-1/2" square tubular frame
- Blue foam
- Luaun
- Darco

| BODY CONSTRUCTION: FEATURES | | OPTIONS |
|--|---|---|
| <ul style="list-style-type: none"> • Alumaframe® Superstructure • Steel Cage Cockpit Construction • One-Piece Peaked Fiberglass Roof with Fiberglass Insulation • Smooth Gel Coat Fiberglass Exterior Walls • Front and Rear Molded Fiberglass Caps • Panaview™ One-Piece Front Windshield • 84" Interior Height • One-Piece Generator Access Door • Pullout Generator Tray with One-Piece Door • Rear Engine Doors with Struts • Fiberglass Engine Cover • Steel-Framed Floor on Steel Trusses • Laminated Structurwood™ Flooring • Electric Flush-Floor Stepwell Cover • Interior Paneling with 3/4" Insulation | <ul style="list-style-type: none"> • Foam Insulated Floor Framing with Luaun Backer • 17.5" Chrome Power Heated Remote Mirrors • Headlamp with Turn Signal • Fog Lights • Flush-Mounted Metal Fuel Doors • 30" Deep Bedroom Slide-Outs (N/A: 37PBD) • Side-Hinged Baggage Doors; All Door Locations with Redesigned Extrusion and Latch Locations • One-Piece Polyethylene Pass-Through Storage Compartment • Wheel Mud Flaps • Full-Length Mud Flap • 3M Film Front Mask • Deluxe Full-Body Paint • Roof Ladder • Undercoating | <ul style="list-style-type: none"> • Standard Run Savings Package Includes: 3-Camera Rear Vision System with Audio and Adjustable Center Camera, Pillowtop Mattress, Exterior Tank Monitor Gauge, Dual 13.5M BTU Air Conditioner with Heat Pumps, Fantastic 12V Attic Fan with Rain Sensor and Electronic Wall Thermostat in Bath • Storage Bay Slide-Out Tray, Pass-Through • Slide-Out Battery Tray |
| CHASSIS/ENGINE/SUSPENSION: FEATURES | | |
| <ul style="list-style-type: none"> • Roadmaster Raised Rail Chassis RR8R • Cummins® ISC 330 Engine with Allison® 3,000 MH 6-Speed World Transmission and Electronic Shifter • Engine Displacement: 8.3L/506 Cu. In. • Torque: 950 lbs./ft. Max. Net at 1,300 RPM • Polished Stainless Steel Engine Exhaust Tailpipe Tip • Fuel Tank Capacity 100 Gallon • Dual Fuel Fill | <ul style="list-style-type: none"> • 160 Amp Alternator • Rear Axle Ratio: 4.30:1 • Radial Tires: 275/70R/22.5 • Polished Aluminum Wheels • 8 Gas Monroe® Shocks • 8 Outboard-Mounted Air Bags • Anti-Lock Braking System with Full Air Brake • Automatic Traction Control • Exhaust Brake | <ul style="list-style-type: none"> • Auto Slack Adjusters • Pre-Wire for Supplemental Braking System • Transmission Temperature Gauge • Air Cleaner Restrictor Gauge • Fuel and Water Separator • Remote Transmission Fill • Fully Automatic Leveling System (3 Point) • 10,000 Lb. Hitch Receiver with Dual Connector 4-Pin or 7-Pin |
| COCKPIT: FEATURES | | OPTIONS |
| <ul style="list-style-type: none"> • Automotive Dash with Eagle Burlwood Instrumentation Panel • 12V Chassis Battery Gauge on Dash • CD Player/Radio with Sirius-Ready Compatibility • Wood Framed Cabinet Doors with Smoked Glass over Front Entertainment Center Systems (N/A: 40SKT) • Front Cab over Televisions Secured with Steel Framing (N/A: 40SKT) • Rear Vision System with Audio and Adjustable Camera • Adjustable Brake and Accelerator Pedals • Intermittent Windshield Wipers • 6-Quart Tank for Windshield Fluid with Fluid Sensor to Tank and Low Wash Indicator on Dash • Tilt/Telescoping Steering Wheel • Cruise Control • Power Steering | <ul style="list-style-type: none"> • ICC Light Switch to Driver's Side Console • Audio Low Air Alarm • Air Horns • Molded Co-Pilot Side Console with Map Pocket and Two-Tier Cup Holder • Front Power Sunvisors with Integrated Motor • Pilot and Co-Pilot Pull-Down Sunshades • Soft Touch Vinyl Pilot and Co-Pilot Seats (All Decors, except Blackwood Manor II Decor by Liz Claiborne) • New Style Distressed OptimaLeather™ Pilot and Co-Pilot Seats with Blackwood Manor II and Canyon Mosaic Decors by Liz Claiborne • Six-Way Power Pilot Seat • Six-Way Power Co-Pilot Seat with Powered Footrest • Carpeted Driver and Passenger Floor Mats | <ul style="list-style-type: none"> • 3-Camera Rear Vision System with Audio and Adjustable Center Camera • OptimaLeather™ Pilot and Co-Pilot Seats • Auxiliary Defroster • Aladdin™ Junior System |
| APPLIANCES AND ACCESSORIES: FEATURES | | OPTIONS |
| <ul style="list-style-type: none"> • Large Four-Door Refrigerator with Ice Maker • High-Output Three-Burner Cooktop without Oven • Removable Solid Surface Range Covers • Convection Spacesaver Microwave • 24" Stereo Color TV with Remote Control in Cockpit Overhead (N/A: 40SKT) • 32" Flat Screen LCD TV in Living Area Hutch (40SKT) • 20" Color TV with Remote Control in Bedroom (N/A: 40DFD, 40SKT) • 20" LCD Color TV with Remote Control in Bedroom (40DFD, 40SKT) • TV Antenna | <ul style="list-style-type: none"> • Home Theater System with DVD/VCR Player with Surround Sound Speakers (N/A: 40SKT) • Home Theater Surround Sound System added to Radio Stereo with DVD Player (40SKT) • Exterior Hook-Ups for DSS Dish and Cable • CB Prep • Digital Satellite System Prep • Interior Cable Television Hook-Up and Telephone Jacks • Exterior Gas Line Hook-Up Prep for LP Accessories • Washer/Dryer Prep (N/A: 40PLQ) | <ul style="list-style-type: none"> • High-Output Three-Burner Range with Oven (Replaces Wastebasket Storage) (N/A: 40PET) • Combination Washer/Dryer • Exterior Entertainment Center, CD Player Radio with Two Speakers • 26" Flatscreen LCD Television in Front Cockpit Overhead (N/A: 40SKT) • Fully Automatic Digital Satellite System • Exterior Entertainment Center (26" LCD/AM/FM/CD Radio with two Speakers) (Hide-a-Bed Sofa N/A Roadside or Curbside on 40DFD with this Option) (N/A: 37PBD, 40SKT) |

| INTERIOR: FEATURES | OPTIONS |
|---|--|
| <ul style="list-style-type: none"> • New Vintage Oak Cabinetry • Raised Panel Hardwood Cabinet Doors • Hardwood Cabinet End Panels • Refrigerator Raised Panel Hardwood Inserts • New Decorative Wallboard • New Wallpaper Border Bath • Self-Supporting Top-Hinged Overhead Storage Doors and Positive Catches on All Other Doors • Heavy-Duty Ball Bearing Drawer Guides • Wood Cabinet Drawer Boxes • Metal Interior Grab Handle on Dash at Entry Door • Satin Brass Cabinetry Hardware and Bath Accessories • Polished Solid Surface Kitchen Countertop with Under-Mounted Plexus-Stone Sink with Two Sink Covers • Recessed Kitchen Countertop Extensions (N/A: 37PBD, 40SKT) • Toe Kicks Kitchen and Bath Base Cabinets (N/A: 40PET) • Flip-Up Countertop Extension for Lavatory in Rear Bathroom (40DFD) • Solid Surface Bath Lavatory Countertop with Integrated Bowl • Dinette Tops Laminated with Solid Surface Edge • All Other Countertops Hardwood with Beveled Edge except Kitchen, Bath Lavatory and Dinette • Kitchen Overhead Cabinets with Adjustable Shelf (N/A: 38PDQ, 40PLQ) • Second Kitchen Pantry next to Refrigerator; Roll-Out Storage in Upper and Lower Cabinet (37PBD) • Silverware Drawer with Organizer, Kitchen Base Cabinets • Kitchen: Solid Surface Wall Application behind Stove Area • Laminate Tile Flooring Throughout Entryway, Kitchen and Bath • Textured Style Nylon Carpeting with Pad in Living Area and Bedroom | <ul style="list-style-type: none"> • Engine Rug Cover • Soft Touch Padded Vinyl Ceiling • Hardwood Slide-Out Fascia Design with Fluted Accents and Decorative Center Block • Hutch Cabinet in Living Area with Decorative Glass and Accent Mirror between Countertop and Overhead Cabinet (37PBD) • Accent Mirrors on Living Area Bath Wall Living Room Side or Side of Refrigerator Cabinet (N/A: 37PBD, 40PET, 40DFD, 40SKT) • Decorative Picture in Bedroom (N/A: 37PBD) • Decorative Picture in Living Room (40SKT) • Hardwood Raised Panel Bathroom Door • Crown Molding in Bedroom and Living Area on All Open Walls • Medicine Cabinet with Adjustable Shelves (N/A on Angle Cabinets) • Bathroom Lavatory Mirror • Towel Bar inside Private Bath • Two Towel Rings in Bathroom • Oversized Rear Wardrobe Closet with Deluxe Mirror Door Frames Brass with Decorative Hardwood Header (N/A: 37PBD, 40PLQ) • Bedroom Swing-Away TV Cabinets (37PBD, 40PET) • Roadside Bedroom Slide-Out Wardrobe (37PBD) • Bedroom Dresser Foot of Bed and Decorative Furniture Leg (40PET, 40DST, 40SKT) • Bedroom Wardrobe Slide-Out Foot of Bed (N/A: 37PBD, 40PET, 40DST, 40SKT) • Bedspread Pillow Shams with Two Decorative Pillows • Hardwood Headboard with Raised Panel Inserts • Pleated Day/Night Blackout Shades in Living Area and Bedroom • Mini Blinds in Kitchen and Bathroom • Soil Repellant Protection on Fabric <ul style="list-style-type: none"> • Decors: Brushed Nickel, Mesa Pine, Spanish Moss, Canyon Mosaic — Liz Claiborne, Blackwood Manor II — Liz Claiborne • Wood Choices: Newport Cherry and Champagne Select |
| FURNITURE: FEATURES | OPTIONS |
| <ul style="list-style-type: none"> • Queen Bed with Overhead Cabinet and Nightstands • Party Table behind Co-Pilot Seat (37PBD) • Arched Back Wood Booth Dinette with Table Top and 30" Drawers (N/A: 40PET, 40DFD) • Freestanding Dinette with Full-Length Wall Cabinet, Two Freestanding Chairs and Two Folding Chairs (40PET, 40DFD) • Roadside: Fabric Sleeper Sofa with Two Pillows • Curbside: Fabric Sleeper Sofa with Two Pillows (N/A: 37PBD) • Curbside: New Style Fabric Barrel Chair (37PBD) • New Style Fabric Barrel Chair and New Style Desk Chair Bedroom (Roadside Chair Replaced with Washer and Dryer Option) (40PLQ) | <ul style="list-style-type: none"> • Pillowtop Mattress • Roadside: Fabric Hide-A-Bed Sofa with Air Mattress and Two Pillows (N/A: 40PLQ) • Curbside: OptimaLeather™ Sleeper Sofa with Two Pillows • Curbside: OptimaLeather™ Hide-A-Bed Sofa with Air Mattress and Two Pillows (40PLQ, 40DST) • Curbside: OptimaLeather™ Recliner in Place of Barrel Chair (37PBD) • Curbside: OptimaLeather™ Euro-Recliner Chair with Heat, Massage and Ottoman in Place of Barrel Chair (37PBD) • Curbside: Computer Workstation with 26" LCD TV and OptimaLeather™ Euro-Recliner with Ottoman, Heat and Massage (Replaces Front Cockpit TV) (N/A: 37PBD, 40PLQ, 40PET, 40SKT) <ul style="list-style-type: none"> • Fabric Barrel Chair in Place of Desk Chair Bedroom (N/A with Washer and Dryer Option) (40PLQ) • Curbside Desk Bedroom in Place of Fabric Barrel Chair (40PLQ) • King Bed with One Nightstand (40PET, 40PDQ) • Freestanding Dinette with Full-Length Wall Cabinet, Two New Style Freestanding Chairs and Two Folding Chairs. Standard on 40PET and 40DFD. |

| WINDOWS, DOORS AND AWNINGS: FEATURES | | OPTIONS |
|--|--|--|
| <ul style="list-style-type: none"> Radius Flush-Mounted Dual Pane Safety Glass Dark Tinted Slider Windows Armless Powered Front Door Awning Front Entry Door with Removable Screen and Anti-Skid Steps Exterior Entry Door Grab Handle Metal Interior Grab Handle on Dash at Entry Door Eclipse Automatic Patio Awning | <ul style="list-style-type: none"> Topper Slide-Out Awnings Living Area and Bedroom Window Awnings on All Slide-Out House Windows except Kitchen Windows and Slide-Out Windows under Patio Awning Tinted Skylight in Bathroom with Protecta Glaze Protecta Glaze Tinted Plexiglas® Skylight in Kitchen with Pleated Shade | <ul style="list-style-type: none"> Bedroom Skylight with Shade (40PLQ) Bedroom Window Awning on Sidewall (37PBD, 40PET, 40DST, 40DFD) |
| SAFETY: FEATURES | | |
| <ul style="list-style-type: none"> Fire Extinguisher Deadbolt Lock on Entrance Door 120V GFI Protected Circuit Kitchen, Bath and Exterior | <ul style="list-style-type: none"> LP Gas Detector Smoke Detector Carbon Monoxide Detector | <ul style="list-style-type: none"> Driver and Passenger Three-Point Seat Belts Third Brake Safety Light Egress Window |
| ELECTRICAL SYSTEMS AND LIGHTS: FEATURES | | |
| <ul style="list-style-type: none"> 50 Amp 120V Distribution Panel and Manual Retracting Power Cord Reel Energy Management System 2,000 Watt Inverter Onan® 8.0 kW QD Diesel Generator on Pullout Tray Four 6V House Batteries Two 12V Heavy Duty Chassis Batteries Battery Disconnect Switch at Front Door 12V and 110V Outlet in Cockpit Area Porch Light and Exterior Step Light on Same Switch Exterior Power Entry Step with Light Interior Stepwell Entry Step Lights Lights in Outside Storage Compartments 120V Receptacles in Outside Storage Compartment | <ul style="list-style-type: none"> Underhood Utility Light Receptacle and Phone Jack in Dinette Area Directional Map Lights Pilot and Co-Pilot Seats Halogen Light on Driver and Passenger Overhead Redesigned Convenience Center in Hallway Fluorescent Light(s) under Kitchen Overhead Fluorescent Ceiling Lights Throughout Fluorescent Ceiling Lights inside Living Area Slide-Out House Decorative Framed Galley Ceiling Fluorescent Light with Skylight | <ul style="list-style-type: none"> Decorative Lighting Satin Brass Living Room Wall Light, Dinette Overhead and Cosmetic Vanity Light Halogen Lights under Living Room, Dining Room and Bedroom Dresser Overhead Cabinets Gem Lights over Bed Satin Brass Finish with His and Hers Switches |
| | | OPTIONS |
| | | <ul style="list-style-type: none"> Exterior Tank Monitor Gauge in Wet Bay |
| PLUMBING AND LP SYSTEMS: FEATURES | | OPTIONS |
| <ul style="list-style-type: none"> Kitchen Composite Under-Mounted Sink with New Style Single Lever Satin Nickel Faucet with Pullout Sprayer Separate Satin Nickel Faucet for Filtered Water Bath Lavatory Faucet Double Handle Satin Brass Finish Demand Water System and Water Pump 10 Gallon LP Gas/Electric Water Heater with Electronic Ignition, DSI Winterization Valving System Water Heater Bypass Valving | <ul style="list-style-type: none"> New Style Porcelain Toilet with Sprayer (N/A: 40DFD, 40SKT) Thetford China Toilet Electric Silent Plus (40SKT)(Rear Only, 40DST) (Front and Rear, 40DFD) No-Fuss Flush Holding Tank Rinsing System Insulated Systems Compartment with Easy Access to Hook-Up Shower inside Wet Bay with Hot/Cold Water Soap Dispenser inside Utility Bay Gravity and Pressurized Water Fill Contained Storage Area for Sewer Hose (N/A with RV Sani-Con System Option) One-Piece Fiberglass Shower Brass Shower Door Frame with Obscure Glass | <ul style="list-style-type: none"> RV Sani-Con 1 System Holding Tank Flush System (Replaces Contained Storage Area for Sewer Hose) Electric Automatic Winterization Power Water Hose Reel Bathtub in Place of Shower. Standard on 40DST and 40DFD. |
| HEATING, VENTS AND AIR CONDITIONING: FEATURES | | OPTIONS |
| <ul style="list-style-type: none"> One 13.5M BTU and One 11.0M BTU Roof Air Conditioner with Ducted Air and Digital Thermostat Control Electronic Ignition Furnace (40M BTU 37PBD, 40DFD) (One 31M and 20M BTU 38PDQ, 40PDQ, 40PET, 40PLQ, 40DST, 40SKT) Electronic AC/Heat Climate Control System In-Floor Ducted Heating System Bath Powered Attic Fan with Wall Control of Automatic Dome and Fan Power | <ul style="list-style-type: none"> Kitchen Powered Attic Fan with Wall Control of Automatic Dome and Fan Power 12V Heater in Wet Bay Wood Louver Air Return Grill for Furnace Metal Floor Registers Antique Brass | <ul style="list-style-type: none"> Dual 13.5M BTU Air Conditioner with Heat Pumps in Place of One 13.5M BTU and One 11.0M BTU Roof Air Conditioner Fantastic 12V Attic Fan with Rain Sensor with Electronic Wall Thermostat in Kitchen Fantastic 12V Attic Fan with Rain Sensor with Electronic Wall Thermostat in Bath |

| Weights | 37PBD | 38PDQ | 40PDQ | 40PET |
|---|--------|--------|--------|--------|
| Gross Vehicle Weight Rating (Lbs.) | 33,000 | 33,000 | 33,000 | 33,000 |
| Gross Combined Weight Rating (Lbs.)* | 43,000 | 43,000 | 43,000 | 43,000 |
| Gross Axle Weight Rating (Front) (Lbs.) | 13,000 | 13,000 | 13,000 | 13,000 |
| Gross Axle Weight Rating (Rear) (Lbs.) | 20,000 | 20,000 | 20,000 | 20,000 |

Measurements

| | | | | |
|-------------------------|---------|--------|---------|---------|
| Wheelbase | 225" | 237" | 261" | 261" |
| Overall Length | 37' 10" | 39' 3" | 40' 10" | 40' 10" |
| Overall Height with A/C | 12' 6" | 12' 6" | 12' 6" | 12' 6" |
| Interior Height | 7' 0" | 7' 0" | 7' 0" | 7' 0" |
| Interior Width | 94.5" | 94.5" | 94.5" | 94.5" |
| Exterior Width | 100.5" | 100.5" | 100.5" | 100.5" |

Tank Capacity**

| | | | | |
|---------------------|-----|-----|-----|-----|
| Water Heater (Gal.) | 10 | 10 | 10 | 10 |
| Gray Tank (Gal.) | 60 | 60 | 60 | 60 |
| Black Tank (Gal.) | 40 | 40 | 40 | 40 |
| Fresh Tank (Gal.) | 100 | 100 | 100 | 100 |
| Fuel Tank (Gal.) | 100 | 100 | 100 | 100 |
| LP Tank (Gal.)*** | 40 | 40 | 40 | 40 |

| Weights | 40PLQ | 40DST | 40DFD | 40SKT |
|---|--------|--------|--------|--------|
| Gross Vehicle Weight Rating (Lbs.) | 33,000 | 33,000 | 33,000 | 33,000 |
| Gross Combined Weight Rating (Lbs.)* | 43,000 | 43,000 | 43,000 | 43,000 |
| Gross Axle Weight Rating (Front) (Lbs.) | 13,000 | 13,000 | 13,000 | 13,000 |
| Gross Axle Weight Rating (Rear) (Lbs.) | 20,000 | 20,000 | 20,000 | 20,000 |

Measurements

| | | | | |
|-------------------------|---------|---------|---------|---------|
| Wheelbase | 261" | 261" | 261" | 261" |
| Overall Length | 40' 10" | 40' 10" | 40' 10" | 40' 10" |
| Overall Height with A/C | 12' 6" | 12' 6" | 12' 6" | 12' 6" |
| Interior Height | 7' 0" | 7' 0" | 7' 0" | 7' 0" |
| Interior Width | 94.5" | 94.5" | 94.5" | 94.5" |
| Exterior Width | 100.5" | 100.5" | 100.5" | 100.5" |

Tank Capacity**

| | | | | |
|---------------------|-----|-----|-----|-----|
| Water Heater (Gal.) | 10 | 10 | 10 | 10 |
| Gray Tank (Gal.) | 60 | 60 | 60 | 60 |
| Black Tank (Gal.) | 40 | 40 | 40 | 40 |
| Fresh Tank (Gal.) | 100 | 100 | 100 | 100 |
| Fuel Tank (Gal.) | 100 | 100 | 100 | 100 |
| LP Tank (Gal.)*** | 40 | 40 | 40 | 40 |

* Towing capacity is limited by GCWR: your vehicle's towing capacity is the difference between the GCWR and the actual vehicle weight, including all water, fuel, passengers and cargo. Your towed vehicle should be equipped with auxiliary brakes if the weight of the towed vehicle exceeds 1,000 lbs. Consult your owner's manual for further towing information.

** Variances in the fabrication and installation of the tanks may cause the actual "usable capacity" to be greater or less than the capacities designated above.

*** Actual filled LP capacity is 80% of listing due to safety shut-off required on tank.

Due to the large variety of options and floorplan arrangements available to our customers, actual weights for each unit can differ significantly. Holiday Rambler provides a weight sticker on each unit we produce which includes that unit's tank capacities and approximate weight. Consult your local Holiday Rambler dealer for unit availability and further information.

The information printed in this brochure reflects product design, fabrication, and component parts at the date of printing. The manufacturer reserves the right, at any time, to make changes in product design or material or component specifications as its sole option, without notice. This includes the substitution of components of a different brand or trade name, which will result in comparable performance. All information printed in this brochure is subject to change after the date of printing. Some features shown or mentioned in this brochure are optional and may only be available in selected floorplans. Photographs may show props or decorations that are not standard equipment on Holiday Rambler models. Holiday Rambler, the HR logo and its design, are registered trademarks. All other products and company names are trademarks and/or registered trademarks of their respective holders.

While the color of the motorhome's exterior and the interior fabrics depicted in this sales brochure are fair and reasonable depictions, the colors depicted may not be an exact match of the actual colors because of the variances in photo-processing and variances caused by inserting the photographs within the sales brochure. Due to product improvements, changes during the model year and/or transcription errors that may occur, information represented within this brochure may not be accurate at the time of your purchase. If certain information is significant to your purchasing decision, please confirm the information with your dealer prior to submitting your order.

The actual overall length of the recreational vehicle may differ from that indicated in the brochure due to variances in the manufacturing process and/or installed components. The actual length may be greater or less than that indicated.

Component part and appliance manufacturers issue limited warranties covering those portions of the recreational vehicle not covered by the Limited Warranties issued by Monaco Coach Corporation. To learn which specific component parts and appliances are excluded from the Limited Warranties issued by Monaco Coach Corporation, please contact your selling dealership or Monaco Coach Corporation directly, or review the warranty packet inside the recreational vehicle.

37PBD

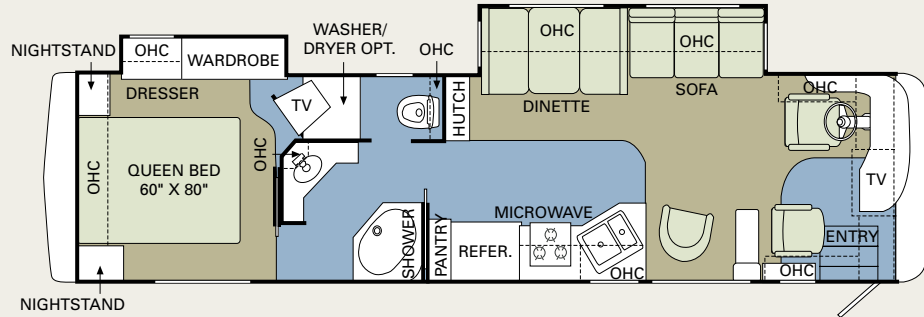

38PDQ

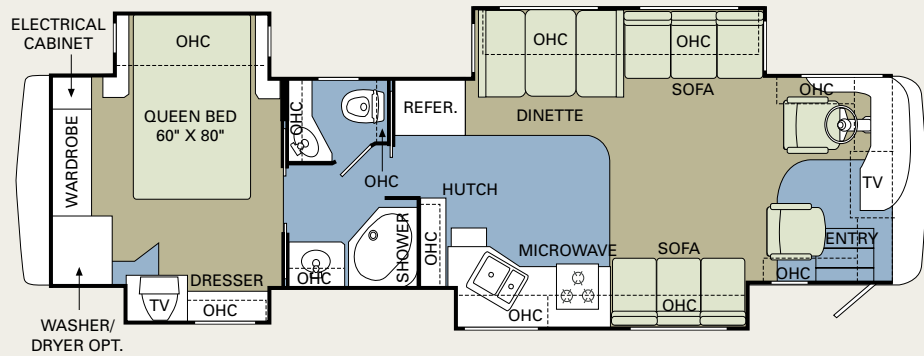

40PDQ

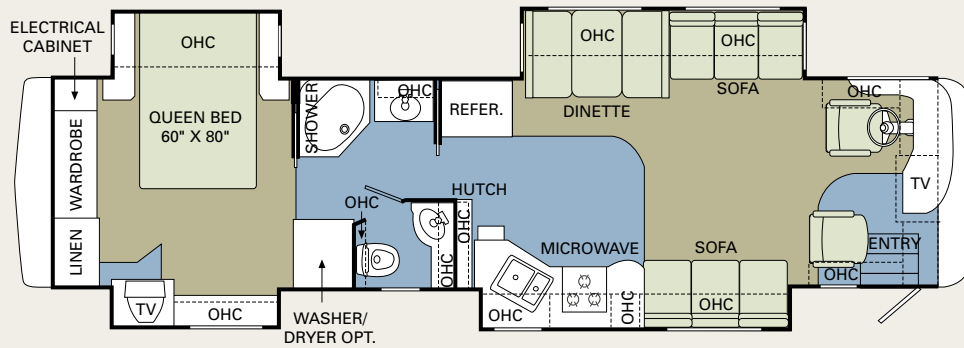

40PET

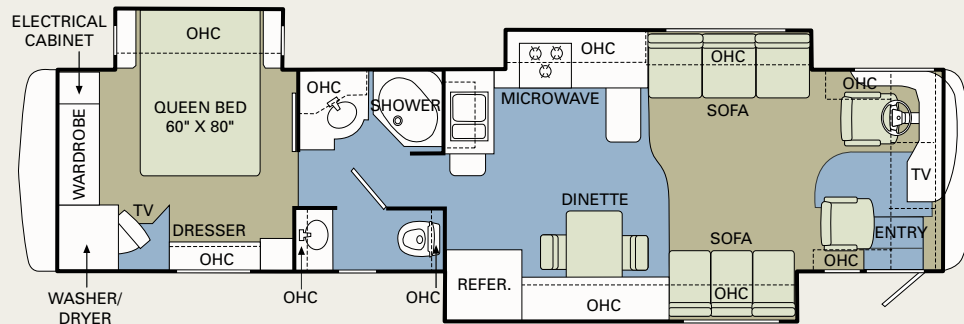

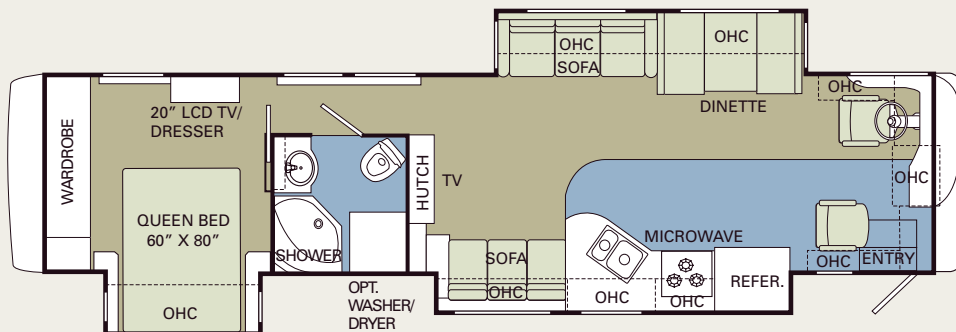
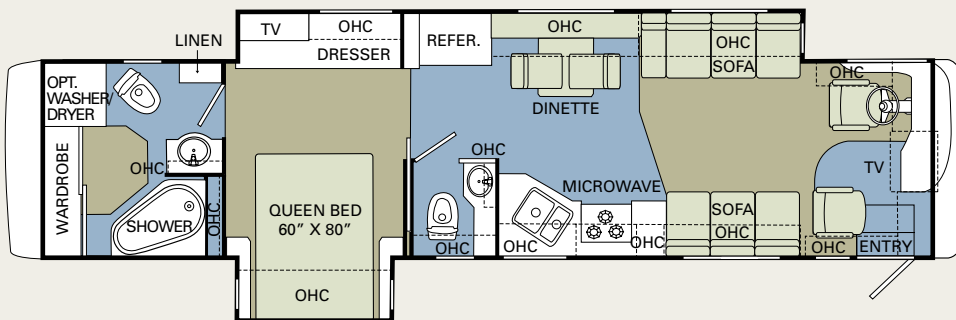
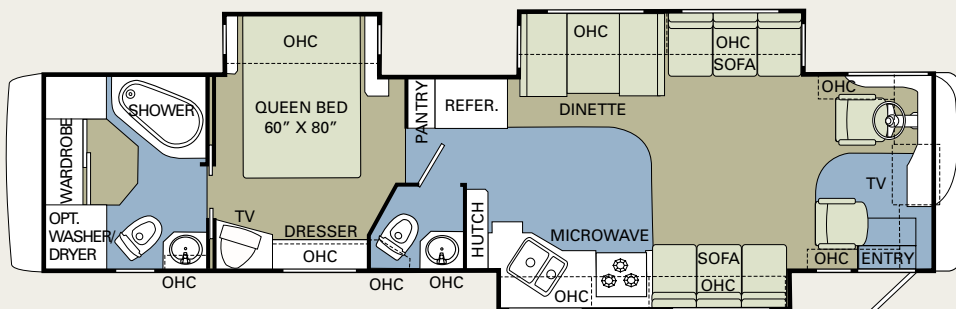
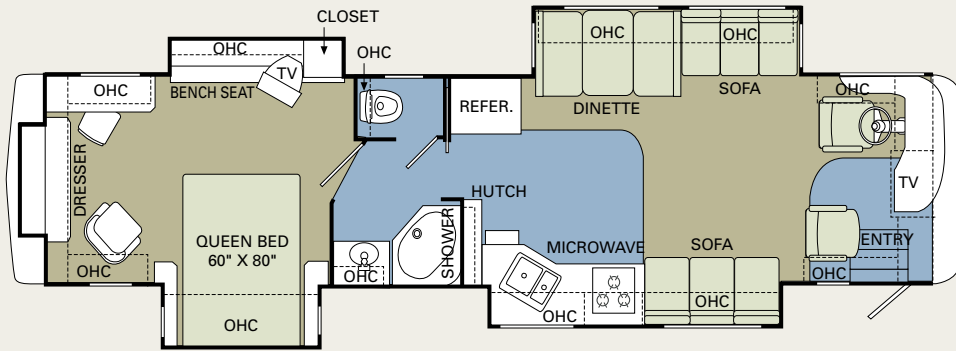

CARPET LAMINATE TILE

20 AMBASSADOR® 06



Thank you for taking a closer look at the 2006 Ambassador. In addition to its state-of-the-art technologies and creature comforts, this luxury diesel coach includes countless conveniences and safety innovations you'll want to experience firsthand. Poke around. Kick the tires. Open and shut every door and drawer — twice. And most importantly, take a drive. You can count on our expert sales team to answer all your questions and demonstrate why this truly is the best experience the road has to offer.

WARRANTIES

12 MONTH/24,000 MILE basic limited warranty

5 YEAR/50,000 MILE limited warranty on aluminum or steel frame structure of sidewall, roof, front and rear cap

3 YEAR/36,000 MILE limited warranty on Roadmaster chassis

Applies to certain models. See owner's manual for complete details.



606 Nelson's Parkway Wakarusa, IN 46573

www.holidayrambler.com
(800) 245-4778

ALL EYES ON THE ROAD AHEAD.

If you're considering a Holiday Rambler, chances are you share our pioneer spirit. For us, it goes back to 1953, the year we introduced our first travel trailer. Since then, our countless innovations have helped create a rich, rewarding lifestyle — and a new way for families like yours to go exploring.

Yes, we're proud of our heritage — but we're not looking back. In these pages, you'll discover that we continue to lead the entire industry. With exciting new features, powerful chassis, remarkable floorplans and, as always, more ways of keeping you and your loved ones safe.

Whether you're looking for the value of a towable, the convenience and economy of a gas motorhome or the top-of-the-line luxury of a diesel coach — Holiday Rambler has an unbeatable model for your budget. Because in 2006, one thing's for sure. We're still paving the way.



MONACO COACH CORPORATION

Monaco is traded on the New York Stock Exchange under the listing MNC.
© 2005, Monaco Coach Corporation 01/06 NPN:BROHAMB Litho in USA.

