

2003 Skamper

# Skamper

*Expandables & Travel Trailers*



**Discover the New Frontier**





## *Skamper 7' Models*

*The industry's original ultra lightweight trailer, the Skamper 7' model line offers more storage than you'd believe possible in an ultra lightweight unit. Always the leader in innovation, the Skamper 7' features an abundance of special features and amenities throughout each unit.*

**Tile-like linoleum, oak framed cabinet doors and premium fabrics standard**



**25FBBH in Forest Green**



**Aerodynamic lightweight and easy to tow**

2003  
Skamper 7'  
Travel Trailer  
Floor Plans

S19FB

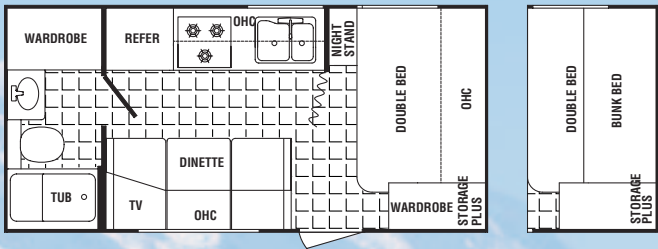

S21RDB

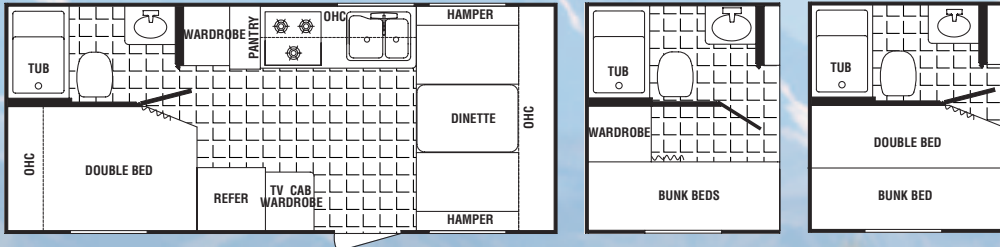

S23FB

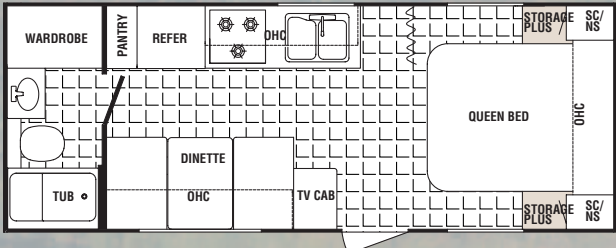

S23RDB

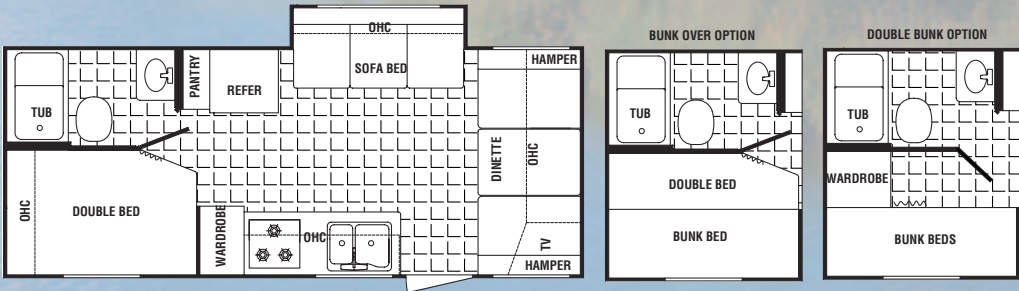

S25BG

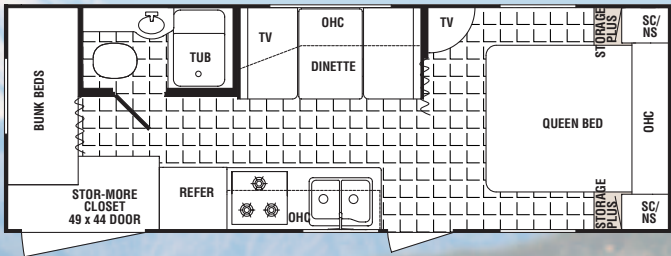

S25FBBH

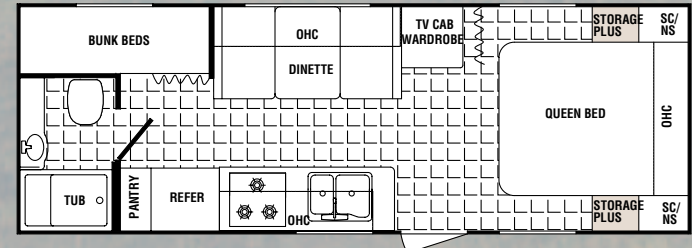

S25FB-SL

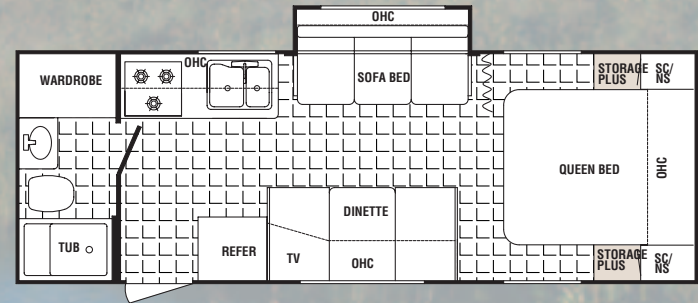



## Skamper 8' Models

**B**uilt with an ultra lightweight all aluminum super structure, the Skamper 8' is aerodynamically designed for easy towing and handling without giving up interior living space. With floor plans available featuring double width slides and every unit loaded with standard features and amenities, we're sure to have the model that's right for your family. Skamper 8 - the new standard in ultra lightweight travel trailers.



Aluminum framed, laminated walls, floor and roof



26RK in Moody Green

26RK



Kitchen features an oversize wardrobe with lots of storage!

2003  
Skamper 8'  
Travel Trailer  
Floor Plans

S25FQ

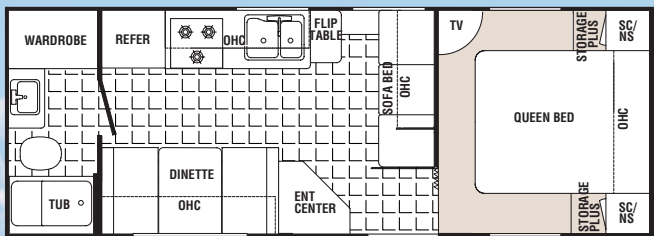

S26QS

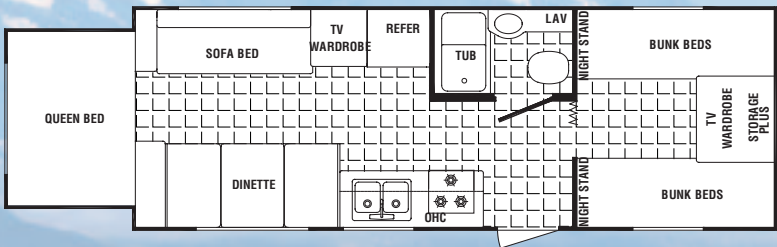

S26RK

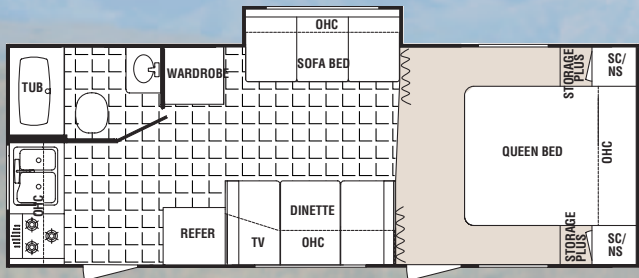

S27BH

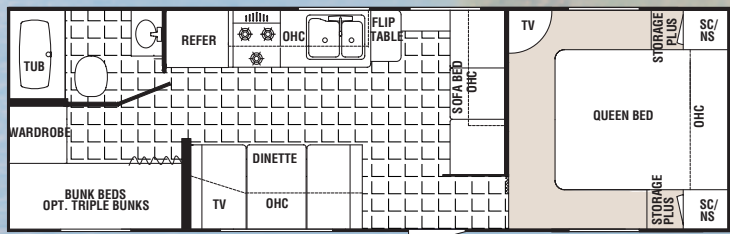

S28RL

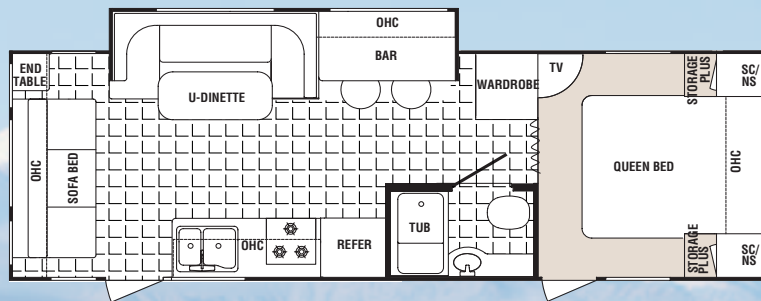

S30FB

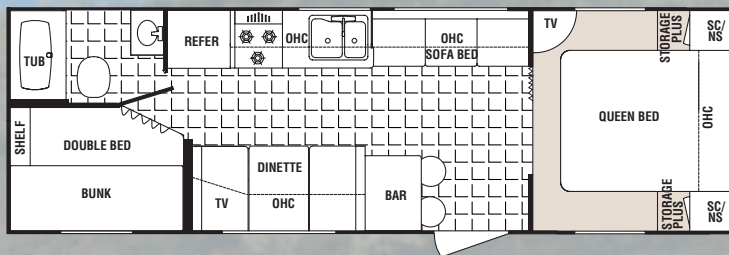

S30GS

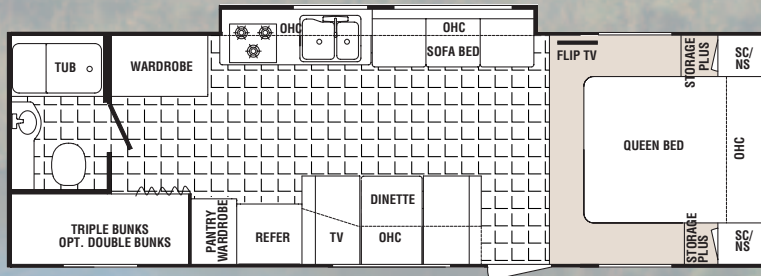

S30FB DOUBLE BUNK OPTION

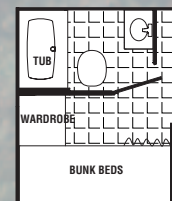

S30FB TRIPLE BUNK OPTION

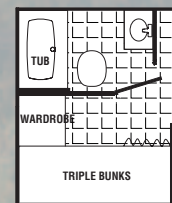



## Skamper Kodiak

**T**he Skamper Kodiak is packed with features without packing a big price. Its innovative design includes a European style ultra lightweight frame and all aluminum super structure that give it strength and durability along with towing ease. For active families on the go, expandable travel trailers add sleeping space without adding length and extra weight to the unit. Bunk ends feature sturdy CAVLAR-15 tents that carry a 5-year warranty to ensure top quality and satisfaction.



Kodiaks feature spacious kitchens and lots of cabinet and counter space



5" dinette and bunk cushions, privacy curtains and tile-like linoleum. All standard



Expandables feature CAVLAR-15 tents with a 5 year warranty

2003 Kodiak  
Expandable  
Travel Trailer  
Floor Plans

K160

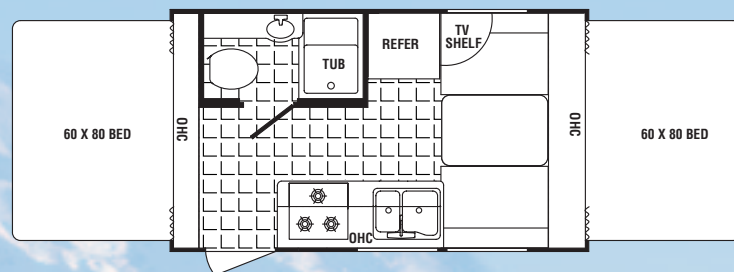

K190

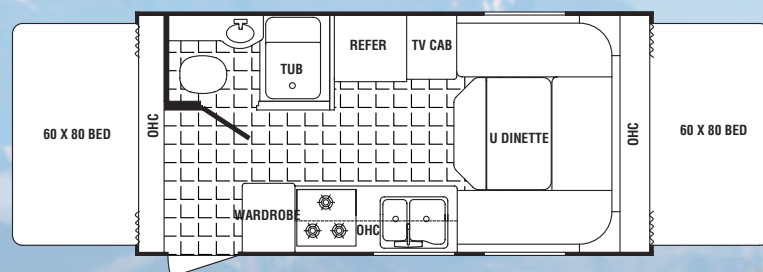

K195

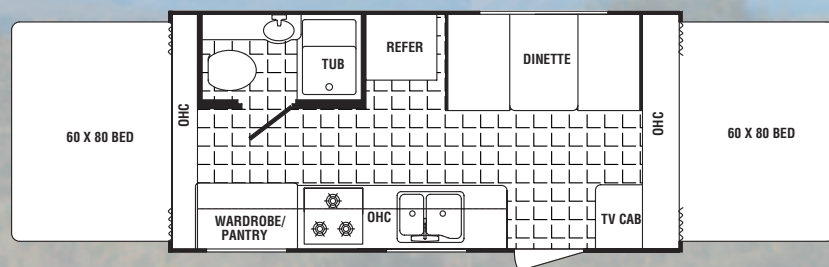

K210

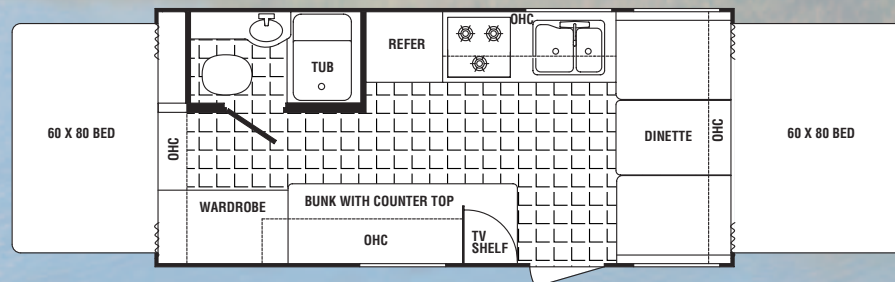

K210 Floor Plan Options

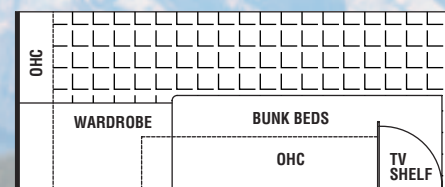

DOUBLE BUNK OPTION

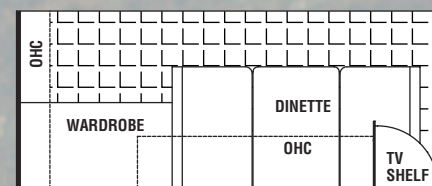

DINETTE OPTION

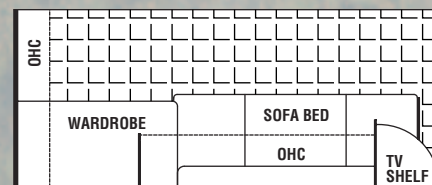

SOFA OPTION



2003 Kodiak  
Expandable  
Travel Trailer  
Floor Plans

K214

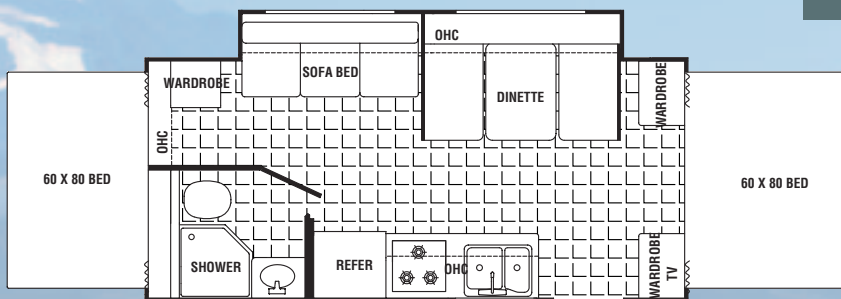

K215

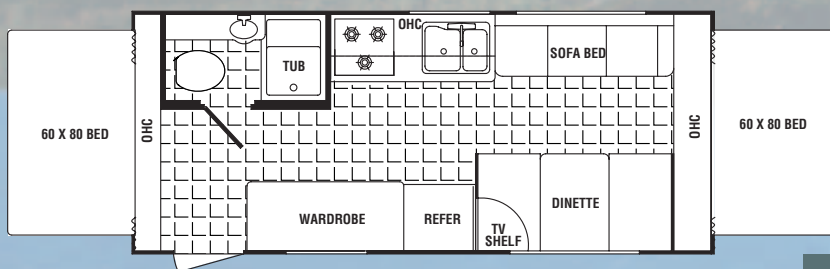

K230F

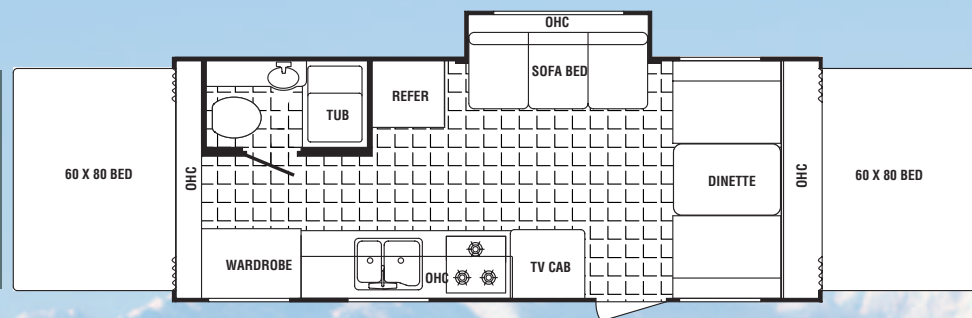

K230R

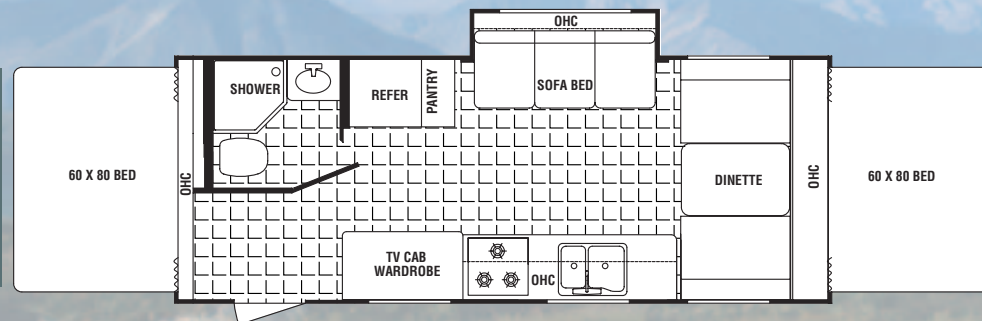

K235

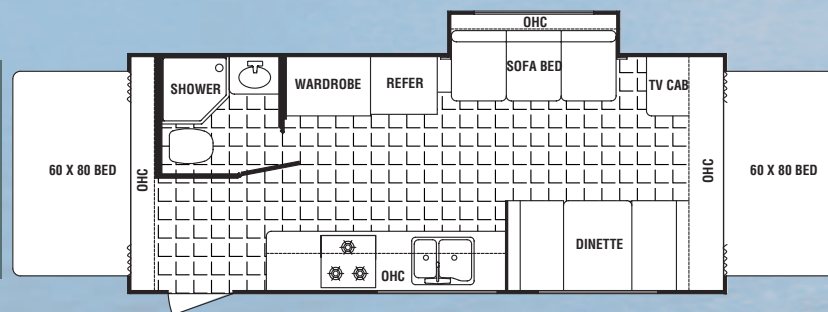



2003  
Travel Trailer  
Standards & Options

	KODIAK	SEVENS	EIGHTS
<b>Standard Exterior Features</b>			
Norco ultra lite chassis	•	•	•
AL-KO torsion	•	•	•
Tandem axles (N/A Kodiak K160) with 4 wheel electric brakes	•	•	•
Single step	•	•	•
EPDM one piece seamless rubber roof	•	•	•
Corrosion-free laminated Darco underbelly	•	•	•
Welded aluminum laminated frame (roof, floor and walls)	•	•	•
Front mounted battery tray	•	•	•
Rain gutter with corner downspouts	•	•	•
Four corner stabilizer jacks	•	OPT	OPT
2-20 lb. LP bottles with ABS cover	•	•	•
2-30 lb. LP bottles with ABS cover	•	•	•
26" radius entry door	•	•	•
ABS fender skirts	•	•	•
Ozite carpet in pass thru storage areas	•	•	•
ABS wheel wells	•	•	•
Tinted radius clamp ring windows	•	•	•
Full front ABS cap with enclosed LP bottles and battery	•	•	•
Flush combo entry latch/dead bolt lock	•	•	•
<b>Standard Appliances and Electrical</b>			
Sub-floor thermostatically controlled heated fresh water tank	•	•	•
Norcold single door gas/electric refrigerator	•	•	•
Norcold double door gas/electric refrigerator	OPT	OPT	•
Systems monitor panel	•	•	•
Forced air DSI furnace with wall thermostat	20M BTU	20M BTU	30M BTU
Ducted heat	•	•	•
Pre-wired for A/C	•	•	•
Pre-wired for cable TV	•	•	•
Pre-wired for stereo	•	•	•
Range hood with 12 volt light and exhaust fan	•	•	•
6 gallon gas water heater with bypass	•	•	•
Fire extinguisher	•	•	•
LPG leak detector	•	•	•
Smoke detector	•	•	•
Solid state converter with built-in battery charger	•	•	•
Patio light	•	•	•
3 burner high output range with oven	•	•	•
3 burner high output range	•	•	•
<b>Standard Interior Features</b>			
Shower curtain	•	•	•
Residential tile-like linoleum	•	•	•
Power roof vent in bathroom	•	•	•
Décor wallpaper border	•	•	•
Bathroom medicine cabinet (not all models)	•	•	•
TV shelf	•	•	•
Mini blinds throughout	•	•	•
Fiberlink bathtub	•	•	•

	KODIAK	SEVENS	EIGHTS
<b>Standard Interior Features (continued)</b>			
Towel storage bin in bathroom	•	•	•
5" thick dinette cushions	•	•	•
Trash bag holder	•	•	•
Coat rack	•	•	•
Magazine rack	•	•	•
Double bowl white acrylic sink with high rise faucet with dual sink covers	•	•	•
Oak mortise tenon cabinet doors	•	•	•
Safety cable on front and rear bunks	•	•	•
Powder coated radius tent poles	•	•	•
Pin-up lights in the bedroom	•	•	•
Glass décor light over dinette table	•	•	•
Adjustable pantry shelves (not all models)	•	•	•
Décor coordinated bedspread	•	•	•
Skylight roof vents	•	•	•
<b>Optional Features</b>			
Heated waste holding tanks	•	•	•
DSI water heater (gas/electric)	•	•	•
Spare tire with cover	•	•	•
13.5 air conditioning	•	•	•
Spray-away wash station	•	•	•
AM/FM/CD Player	•	•	•
Microwave	•	•	•
Oven with range (N/A S30GS)	•	•	STD
Awning	•	•	•
Stove cover	•	•	•
6 cubic foot double door refrigerator	•	•	STD
Bunk light with fan	•	•	•
Water filter system	•	•	•
Vitco RVQ grill	•	•	•
Sand pads on jacks	•	•	•
TV antenna	•	•	•
Tub surround	•	•	STD
ABS slide tray (pass thru storage)	•	•	•
Bedroom carpet	•	•	STD
Fantastic vent	•	•	•
Roof rack and ladder (N/A 26RK)	•	•	•
Skylight in bathroom	•	•	•
Safety glass	•	•	•
Demand water pump	•	•	•

2003  
Fabrics  
Weights & Measures

Moody  
Blue &  
Green



Forest  
Green

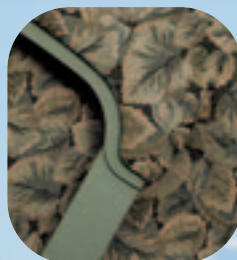

Cranmist  
Green &  
Rose



### Kodiak Expandable Travel Trailer Weight Chart

	K160	K190	K195	K210	K210B	K210D	K210S	K214	K215	K230F	K230R	K235
Traveling Length	16'4"	19'	19'8"	21'9"	21'9"	21'9"	21'9"	22'	22'	23'8"	23'8"	24'4"
Expanded Length	20'6"	23'6"	23'6"	25'6"	25'6"	25'6"	25'6"	25'6"	25'6"	27'6"	27'6"	28'1"
Exterior Width	8'	8'	8'	8'	8'	8'	8'	8'	8'	8'	8'	8'
Exterior Height (w/ A/C)	9'6"	9'6"	9'6"	9'6"	9'6"	9'6"	9'6"	9'6"	9'5"	9'5"	9'5"	9'5"
Hitch Dry Weight	160	240	180	340	420	420	420	312	380	400	420	360
Gross Vehicle Weight	3660	5960	5900	6060	6140	6140	6140	6140	6100	6120	6140	6080
Unloaded Vehicle Wt.	2508	3102	2903	3188	3268	3308	3256	3812	3188	3648	3668	3668
Net Cargo Capacity	1152	2858	2997	2872	2872	2832	2884	2328	2912	2472	2472	2412
Fresh Water Capacity	30	30	30	30	30	30	30	30	30	30	30	30
Dual Holding Tanks Cap.	62	62	62	72	72	72	72	62	62	62	62	62
Tire Size	ST205/75D14C for all											
Furnace Size (BTU's)	20	20	20	20	20	20	20	20	20	20	20	20

### Skamper 7' Travel Trailer Weight Chart

	S19FB	S21RDB	S23FB	S23RDB	S25BG	S25FBBH	S25FBSL
Length	19'4"	21'9"	23'8"	23'7"	25'7"	25'11"	25'
Exterior Width	7'5"	7'5"	7'5"	7'5"	7'5"	7'5"	7'5"
Exterior Height	9'6"	9'6"	9'6"	9'6"	9'6"	9'6"	9'6"
Hitch Dry Weight	240	360	220	TBD	220	260	200
Gross Vehicle Weight	5960	4760	5940	TBD	5940	5980	5920
Unloaded Vehicle Wt.	2968	3008	3168	TBD	3700	3488	3448
Net Cargo Capacity	2992	1520	2772	TBD	2240	2660	2240
Fresh Water Capacity	30	30	30	30	30	30	30
Dual Holding Tanks Cap.	72	62	62	72	62	62	62
Tire Size	ST205/75D14C for all						
Furnace Size (BTU's)	20	20	20	20	20	20	20

### Skamper 8' Travel Trailer Weight Chart

	S25FQ	S26QS	S26RK	S27BH	S28RL	S30FB	S30GS
Length	27'1"	TBD	27'5"	30'	30'2"	30'3"	30'
Exterior Width	8'	8'	8'	8'	8'	8'	8'
Exterior Height	9'9"	9'9"	9'9"	9'9"	9'9"	9'9"	9'9"
Hitch Dry Weight	440	TBD	432	312	356	228	328
Gross Vehicle Weight	6040	TBD	6032	5912	5956	5888	5928
Unloaded Vehicle Wt.	4072	TBD	4194	4524	4788	4468	4622
Net Cargo Capacity	1968	TBD	1838	1388	1168	1420	1306
Fresh Water Capacity	30	30	30	30	30	30	30
Dual Holding Tanks Cap.	62	62	62	62	62	62	62
Tire Size	ST205/75D14C for all						
Furnace Size (BTU's)	30	30	30	30	30	30	30



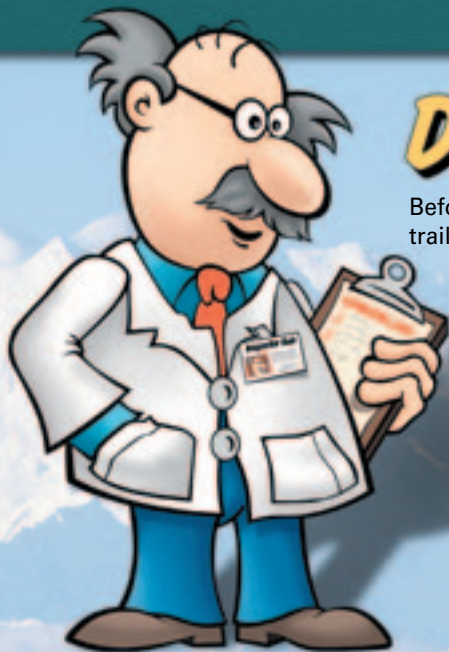

# DARE TO COMPARE VALUE CHECK LIST

Before you make your purchase decision, compare Skamper's features to the competition. We are sure you will agree that Skamper is the best trailer for the best price in the industry.

	SKAMPER	COMPETITION
<b>Construction Features</b>		
2 Year Bumper to Hitch Warranty - The Best in the Industry	✓	
5 Year Structural Warranty	✓	
12 Year Rubber Roof Warranty	✓	
1 year Customer Care Roadside Assistance Program Included with Purchase	✓	
Welded Aluminum Structure (Floor, Roof, Walls)	✓	
Laminated Fiberglass Walls	✓	
Norco Ultra-lite Chassis	✓	
Rubber Torsion Axle(s)	✓	
14" Tires	✓	
26" Radius Entry Door	✓	
Clamp Ring Radius Corner Windows	✓	
Flush Mount Radius Corner Luggage Doors	✓	
Large Storage-plus Pass Thru Storage Compartments (Most Models)	✓	
High Intensity Porch Light with Interior and Exterior Switch	✓	
Corrosion Resistant ABS LP Bottle Cover	✓	
Standard Heat Pad on Fresh Water Tank	✓	
Fresh and Waste Water Tanks Mounted Below Floor - Allows for Extra Interior Storage	✓	
"Rain Gutter" Moldings with Drip Spout	✓	
<b>Interior Features</b>		
Tile-like Linoleum	✓	
Oak Framed, Mortise & Tenon Construction Cabinet Doors	✓	
Mini Blinds On All Windows	✓	
Ducted Heat	✓	
Norcold Refrigerator w/Adjustable Temperature Settings	✓	
Wall Mounted Monitor Panel	✓	

	SKAMPER	COMPETITION
<b>Interior Features (cont.)</b>		
6 gal. Gas Water Heater - Water Heater By-pass for Winterization	✓	
Hard Valances with Lambrequins (Living Room)	✓	
Hard Valances with Sculptured Curtains (Bedroom Only)	✓	
Cable TV Jack - Standard	✓	
Gas Support Struts on Beds for Access to Extra Storage	✓	
TV Shelf and Outlet in Bedroom	✓	
Power Roof Vent in Bath	✓	
Fiberlink (Fiberglass/ABS) Bathtub	✓	
Fiberlink One Piece Tub Surround (8's Only)	✓	
Large, Dual Bowl, Acrylic Kitchen Sink	✓	
Flush Mount, Form Fitted Sink Covers (2)	✓	
High Rise Faucet	✓	
Roll Over Style Sofa (Bed)	✓	
<b>Optional Features</b>		
13.5 BTU Air Conditioner	✓	
Spare Tire w/Cover	✓	
TV Antenna	✓	
Awning	✓	
Exterior Vitco Grill	✓	
Exterior Spray Away Wash Station (15' Coiled Hose)	✓	
Safety Glass	✓	
Water Filter	✓	
Fiberlink 1 Piece Tub Surround (Expandables & 7's)	✓	
1 cu ft/1000 Watt Microwave Oven	✓	
Features subject to change without notice. Not all features available on all products.		



# Just Show Your Card & Go!

We build our products better and we protect you with the industry's best warranty coverage, but we know that sometimes things can go wrong on the road. So when you become the proud owner of a new Skamper, it's just the beginning of our exclusive 'round-the-clock Customer Care Program.

Customer Care provides complete and fully paid roadside assistance, emergency road service, and special warranty support benefits that go with you wherever you travel. You get immediate access to fast, dependable service when and where you need it.

Add our toll-free warranty and service appointment assistance and a technical assistance hot line and you have the security and peace of mind of full-time support.

Our exclusive 24-hour Customer Care benefits include:

- Fully paid emergency roadside assistance
- Free jump starts
- Free fuel delivery
- Free lock-out service
- Free on-site mechanical service in the event of a breakdown
- 24-hour technical hot line
- Toll-free service appointment scheduling nationwide
- Warranty service assistance at over 6,800 qualified service agencies
- Free customer trip routing and map service.

At Skamper we want you to be able to enjoy your new trailer or fifth wheel to the fullest. That's why we've provided Skamper Customer Care to take care of the problems that could spoil your travels.

Product information, specifications, and photography in this brochure were as accurate as possible at time of printing. Photographs may contain some features that are optional on your vehicle. Since we continually strive to improve our products, actual products may differ. Prices and specifications are subject to change without notice. **All capacities are approximate and dimensions are nominal. Some features shown are optional and may be different or unavailable in Canada.** Vehicles are designed for recreational use only and not intended for use as a primary residence.

This brochure is printed on recycled paper as part of Thor's corporate effort to minimize waste and conserve our natural resources. Providing safe, fuel-efficient recreational vehicles is Thor's way of further demonstrating our role as the industry leader in safeguarding our nation's environment.

Skamper invites you to check out the following companies to further enhance your RV experience:



[rvaa.com](http://rvaa.com)



[funroads.com](http://funroads.com)



[reeseprod.com](http://reeseprod.com)



[rbwindustries.com](http://rbwindustries.com)



[trailair.com](http://trailair.com)

# The Industry's Best Warranty... By Far!

We're so confident in the design and construction of our products that they are covered by Thor's exclusive Full 2-Year Standard Warranty: "Hitch-to-bumper" coverage to protect your RV investment.

## Your Full 2-Year Warranty Includes:\*

- |                |                        |                |
|----------------|------------------------|----------------|
| • Refrigerator | • Slide-out Mechanisms | • LP tanks     |
| • Furnace      | • Power converter      | • Water heater |
| • Range        | • Plumbing             | • TV antenna   |
| • Microwave    | • Electrical           | • Lavatory     |
| • Water pump   | • Doors                | • Awnings      |
| • House stereo | • And much more...     |                |

\*See individual company warranty statements for details.

## Why a Thor Product Is Your Best RV Value:

Thor Industries, Inc., listed on the New York Stock Exchange, proudly traces its history back over seventy years to the pioneering days of the RV industry with the founding of Airstream, the industry's oldest and most renowned brand. Our total commitment to quality and our philosophy of putting our customers first has led to our continuous growth. Today, Thor is the largest builder of RVs. Thor's strong financial condition and years of solid growth are your assurance that we will be here to serve you for years to come. We think this extra peace of mind is important when you are making a significant investment. Because our customers are always #1 with us, we work harder than other manufacturers to satisfy you.



**THOR**  
AMERICA'S BEST RV VALUE

305 Steury Ave. • Goshen, IN 46528

574.534.1224 • Fax 574.533.3807

Service, Warranty and Parts 574.537.0700

[www.skamper-rv.com](http://www.skamper-rv.com)

Your Local Dealer