

The 1999 Cougar Ultra-Lite

Designed for Towing by Today's Sports Utility Vehicles, Minivans, and Trucks

COUGAR
by Keystone



"The RV With Attitude"

"The RV With Attitude"

The Cougar, with its stunning graphics gleaming against its white fiberglass finish, makes a strong statement on the road and in the campground. Featuring an exterior with minimal exposed moldings and fasteners—to reduce maintenance and keep your Cougar looking new for years to come.

Inside, you'll know it's a Keystone from the way we've built comfort and convenience into every detail! With the Cougar, you get it all—Ultra-Lite-weight economy and ease of travel, with the customized features to match your life style.



Hi Folks,
After taking the Cougar across the U.S. and Canada, I'm happy to say it was a dream to tow. We hardly knew it was behind us. Our home away from home has been a hit where ever we've camped. I think we're going to stay a few more days. I come to see you soon.
On the road,
Nicole & Dave

FEATURES

- **Aerodynamic Front Profile** — Molded Front Cap Hides LP Bottles and Provides Improved Towability
- **Independent Torsion Suspension System** — For Easier, Safer Towing
- **Aluminum Framed 2" Thick Walls, Roof and Floor** — 33% Thicker than Other Brands, Providing Better Insulation and More Strength per Square Inch
- **Totally Enclosed Underbelly** — All Heat Ducts and Water Tanks Are Enclosed, Leaving More Room for Interior Storage, and Creating a Lower Center of Gravity for Easier Towing
- **A Smart Interior Look for Today's Buyer** — Residential Hardware and Oak Cabinet Doors, 5"-Thick Dense Foam Cushions, Well Appointed Kitchens, and Tailored Window Treatment
- **Optional Skylights** — Provide an Open Feeling and Room to Stand Up in the Shower
- **Aluminum Framed Bed and Dinette Bases** — Add Strength while Dramatically Reducing Weight
- **Wind Foil™ Low Profile Slide Rooms** — Cougar's low exterior height allows great towability. Other brands simply don't compare.

You Asked for It...So Keystone RV Company Created It!



Cougar's curved lower wrap, molded fender skirts, and baggage doors (below) are all designed with no outside fasteners or moldings. We design for low maintenance as well as great looks!



Beautiful and spacious, yet light-weight and strong.

The Cougar's revolutionary design shows Keystone knows today's RVers expect more than the standard. For example, all of our wood cabinets are assembled with screws, instead of staples like most brands. Quality RV production is in the details.

S-Series Travel Trailers

7' 3" Wide

These Cougar S-Series Ultra-Lites are the perfect fit for your minivan or sport utility vehicles.

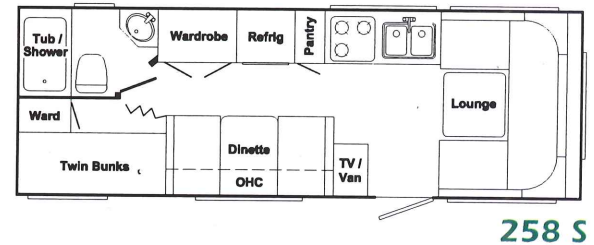
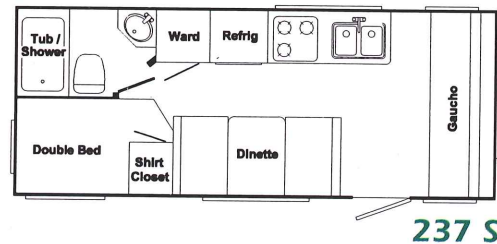
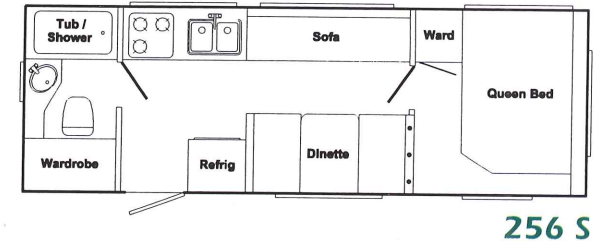
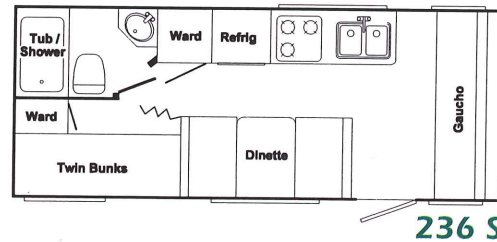
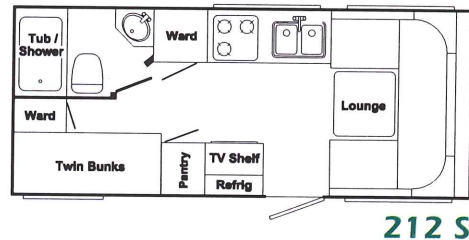
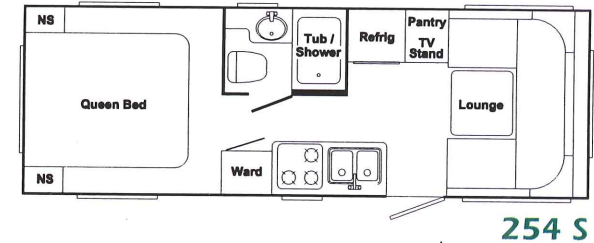
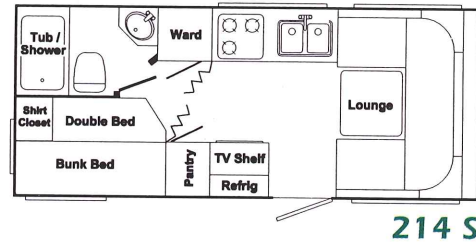
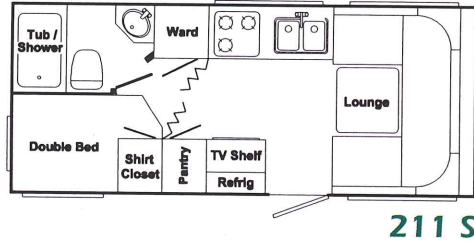

Choose from Two Designer Interiors

The Cougar is available in Green Earth or Blue Sunset. The subtle tones allow for your own decorating style.

Consider a Slide-Out Model

Thanks to Keystone design and engineering, you can have a trouble-free, tightly insulated slide-out in your S-Series or E-Series Travel Trailer. All Cougar slide rooms feature our Wind Foil™ design, allowing greater towability due to its low exterior height.

Slide-Out

S-Series

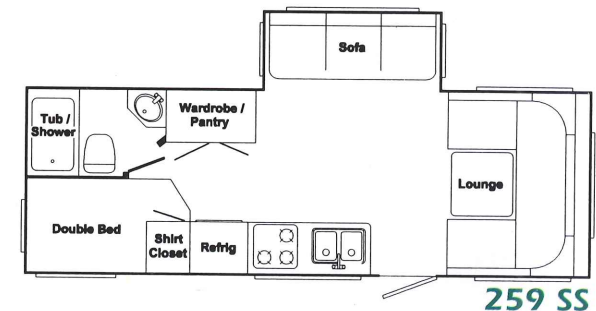

E-Series Travel Trailers

8' Wide

These Cougar E-Series Ultra-Lite travel trailers provide more room while still offering lightweight, easy towing.

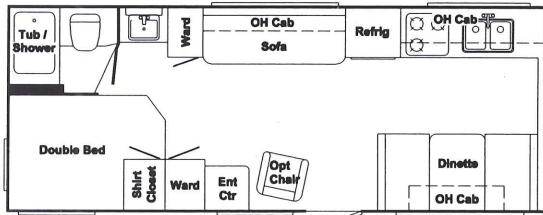

245 E

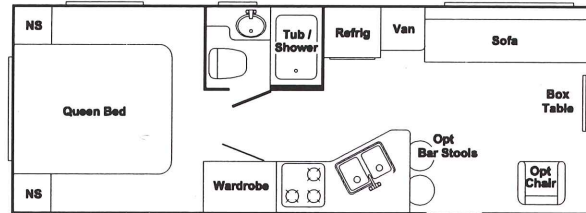

261 E

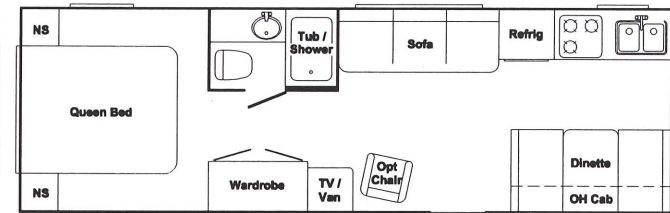

296 E

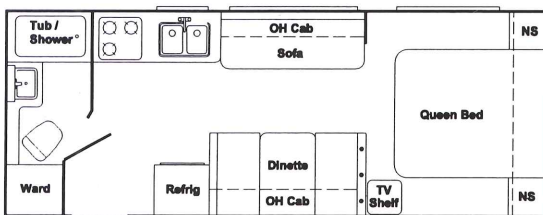

246 E

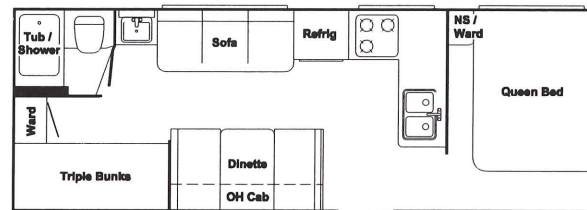

279 E

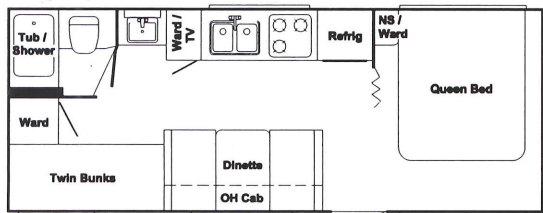

247 E

**5-Year Structural Warranty
on All Cougar Models¹**

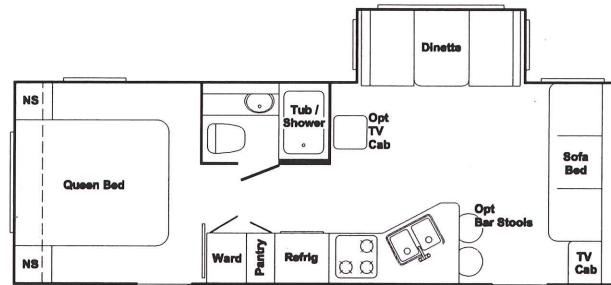

277 ES

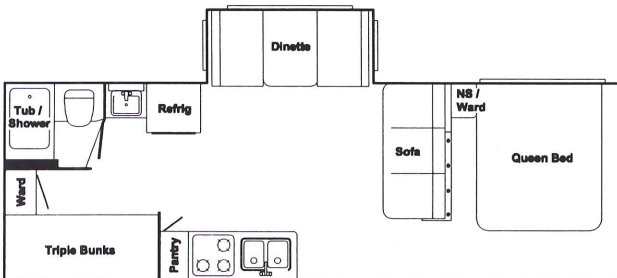

276 ES

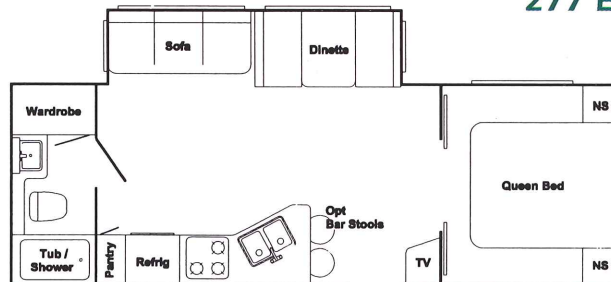

278 ES

Options

E-Series



Natural Lighting

Skylights are Optional on Every Cougar to Add to the Airy, Roomy Atmosphere

E-Series Fifth Wheels 8' Wide

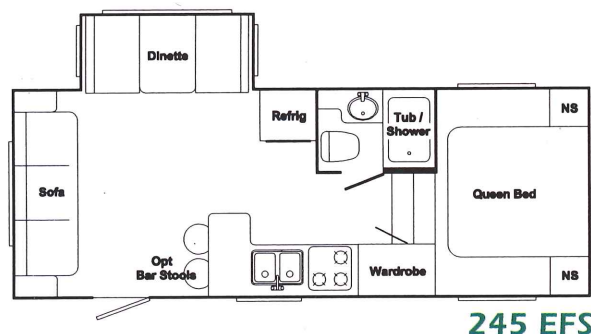

245 EFS

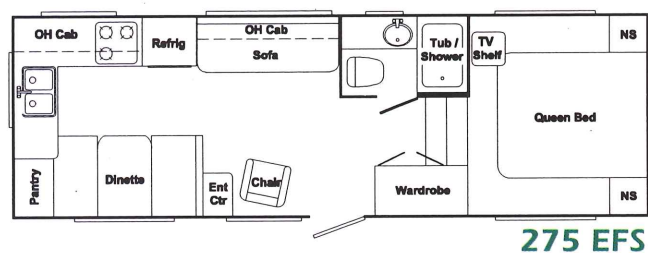

275 EFS

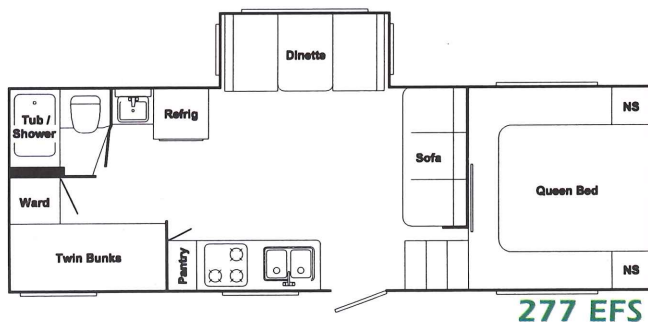

277 EFS

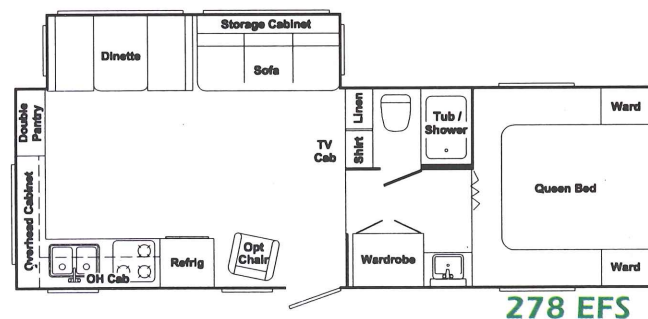

278 EFS

A Place for It All

The Cougar provides more than ample storage space. A. Large, forward exterior storage. B. Easy access under bed storage. C. Roomy overhead, all wood cabinetry. Yet another reason we made it light...so you can add your own weight.

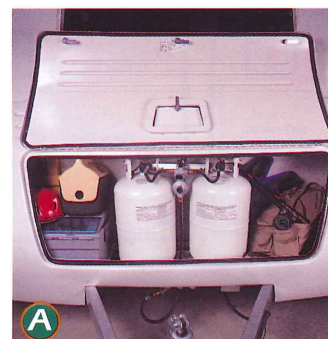

A

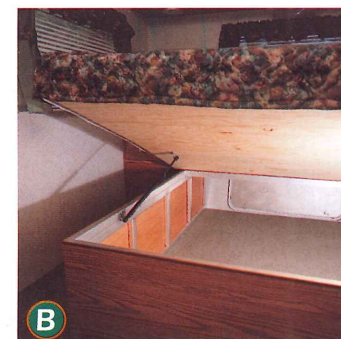

B

S-Series Travel Trailers

Cougar Model	211S	212S	214S	236S	237S	254S	256S	258S	259SS
Unloaded Vehicle Weight (UVW)	2876	2876	2916	3150*	3200*	3256	3300*	3350*	4021
Gross Vehicle Weight Rating (GVWR)	4760	4900	4900	4900	4900	4940	5000	5000	5400*
Carrying Capacity	1884	2024	1984	1750	1700	1684	1700	1650	1379
Hitch Weight*	340	300	340*	380*	400*	540*	550*	550*	600*
Exterior Length	21'6"	21'6"	21'6"	23'6"	23'6"	25'6"	25'6"	25'6"	25'6"
Exterior Width	7'3"	7'3"	7'3"	7'3"	7'3"	7'3"	7'3"	7'3"	7'3"
Exterior Height**	9'4"	9'4"	9'4"	9'4"	9'4"	9'4"	9'4"	9'4"	9'4"
Fresh Water Capacity (Gal.)	30	30	30	30	30	30	30	30	30
Waste Water Capacity (Gal.)	25	25	25	25	25	25	25	25	25
Grey Water Capacity (Gal.)	25	25	25	25	25	25	25	25	25

E-Series Travel Trailers

Cougar Model	245E	246E	247E	261E	276ES	277ES	278ES	279E	296E
Unloaded Vehicle Weight (UVW)	3695	3695	3690*	3776	4600*	4600*	4860*	4100*	4300*
Gross Vehicle Weight Rating (GVWR)	6140	6200	6200	6200	6200	6200	6800	6200	6300
Carrying Capacity	2445	2505	2510	2424	1600*	1600*	1940*	2100*	2000*
Hitch Weight*	540	530	530	530	530	530	530	530	630
Exterior Length	25'6"	25'6"	25'6"	26'6"	28'	28'	28'	28'	30'
Exterior Width	8'	8'	8'	8'	8'	8'	8'	8'	8'
Exterior Height**	9'5"	9'5"	9'5"	9'5"	9'5"	9'5"	N/A	9'5"	9'5"
Fresh Water Capacity (Gal.)	30	30	30	30	30	30	30	30	30
Waste Water Capacity (Gal.)	30	30	30	30	30	30	30	30	30
Grey Water Capacity (Gal.)	30	30	30	30	30	30	30	30	30

E-Series Fifth Wheels

Cougar Model	245EFS	275EF	277EFS	278EFS
Unloaded Vehicle Weight (UVW)	5200*	5500*	5900*	6300*
Gross Vehicle Weight Rating (GVWR)	7600*	7600*	7600*	8000*
Carrying Capacity	2400*	2100*	1700*	1700*
Hitch Weight*	700	800	900	900
Exterior Length	24'6"	27'6"	27'6"	27'6"
Exterior Width	8'	8'	8'	8'
Exterior Height**	N/A	N/A	N/A	N/A
Fresh Water Capacity (Gal.)	30	30	30	30
Waste Water Capacity (Gal.)	30	30	30	30
Grey Water Capacity (Gal.)	30	30	30	30



C

Weights are approximate and based on standard features.

*Estimated weight

**To top of air conditioner

1998 Tow Vehicle Guide

The following Tow Vehicle Guide may assist you in selecting the Cougar that fits with the capabilities of your tow vehicle. We provide this guide, for your convenience, as a general reference only. We encourage you to work with your dealer regarding the capabilities of your specific tow vehicle.

VEHICLE	ENGINE	TOW LIMIT	VEHICLE	ENGINE	TOW LIMIT	VEHICLE	ENGINE	TOW LIMIT
ACURA SLX	3.2 V-6	5000	FORD (cont.) Aerostar Wagon (2WD) Club Wagon Club Wagon Club Wagon Reg. Crown Victoria Expedition (2WD) Expedition (4WD) Expedition (4WD) Explorer 2Dr. (2WD) Explorer 2Dr. (4WD) Explorer 4Dr. (2WD) Explorer 4Dr. (4WD) Explorer 4Dr. (2WD) F-150 Reg. Cab (2WD) F-150 Reg. Cab (2WD) Ranger Reg. Cab (2WD) Ranger Reg. Cab (2WD) Ranger Reg. Cab (2WD)	3.0 V-6 4.2 V-6 4.6 V-8 5.4 V-8 4.6 V-8 4.6 V-8 5.4 V-8 5.0 V-8 SOHC 4.0 V-6 SOHC 4.0 V-6 SOHC 4.0 V-6 SOHC 4.0 V-6 5.0 V-8 4.2 V-6 4.6 V-8 2.3 I-4 3.0 V-6 4.0 V-6	3600 4700 6100 7000 2000 5900 6100 7900 5000 4800 5800 5600 6700 5800 7200 2300 4000 6000	MAZDA B2300 (2WD) B4000 (2WD) B4000 (4WD) MPV (2WD) MPV (AWD)	2.3 I-4 4.0 V-6 4.0 V-6 3.0 V-6 3.0 V-6	2300 5900 5600 4300 4000
AM GENERAL Hummer (2-passenger) Hummer (2-passenger) Hummer (2-passenger)	Gas Diesel Turbodiesel	8760 8650 8580	HONDA Passport	3.2 V-6	4500	MERCURY Cougar XR7 Grand Marquis Mountaineer Villager	All 4.6 V-8 5.0 V-8 3.0 V-6	2000 2000 6700 3500
BUICK Regal	3.8 V-6	2000	INFINITI QX4 5000 (Prelim.)	3.3 V-6		NISSAN Pathfinder Pickup (All) Quest	3.3 V-6 2.4 I-4 3.0 V-6	5000 3500 3500
CADILLAC DeVille/All	4.6 V-8	3000	ISUZU Hombre/Rodeo Rodeo Trooper Hombre 5500 (Prelim.)	2.2, 2.6 I-4 3.2 V-6 3.2 V-6 4.3 V-6	2000 4500 5000	OLDSMOBILE Bravada Silhouette	4.3 V-6 3.4 V-6	5000 3500
CHEVROLET/GMC Astro/Safari (AWD) Astro/Safari (RWD) Blazer/Jimmy (2WD) Express/Savana/G1500 Express/Savana/G1500 Express/Savana/G1500 Express/Savana/G2500 Express/Savana/G2500 Express/Savana/G2500/3500 K1500 Reg./Ext. Cab (4WD) S-Series/Sonoma Venture	4.3 V-6 4.3 V-6 4.3 V-6 4.3 V-6 5.0 V-8 5.7 V-8 4.3 V-6 5.0 V-8 5.7 V-8 4.3 V-8 4.3 V-6 3.4 V-6	5000 5500 5500 4500 5000 6000 5000 5000 7000 5000 5500 3500	JAGUAR All models	All	3307	PLYMOUTH Voyager (FWD) Voyager (FWD)	2.4 I-4 3.3 V-6	2000 3500
CHRYSLER Concorde, LHS Cirrus, Sebring Convertible Town & Country	All 2.5 V-6 3.3, 3.8 V-6	2000 2000 3500	JEEP Cherokee Cherokee/Grand Cherokee Grand Cherokee TSI Grand Cherokee Limited	2.5 I-4 4.0 I-6 5.2 V-8 5.9 V-8	2000 5000 6700 6700	PONTIAC Tran Sport	3.4 V-6	3500
DODGE Caravan Caravan Dakota (2WD) Reg. Cab Dakota (2WD) Reg. Cab Dakota (2WD) Reg. Cab Dakota (2WD) Club Cab Dakota (2WD) Club Cab Dakota (4WD) Reg. Cab Dakota (4WD) Reg. Cab Dakota (4WD) Club Cab Dakota (4WD) Club Cab Dakota (4WD) Club Cab Intrepid Ram (2WD) 1500 All Cab Ram (2WD) 1500 All Cab Ram Wagon B1500/2500	2.4 I-4 3.3, 3.8 V-6 2.5 I-4 3.9 V-6 5.2 V-8 3.9 V-6 5.2 V-8 3.9 V-6 5.2 V-8 3.9 V-6 5.2 V-8 All 3.9 V-6 5.2, 5.9 V-8 3.9 V-6	2000 3500 2300 5500 6700 5200 6400 5200 6500 5000 6200 2000 3600 8100 4800	KIA Sportage	2.0 I-4	2000	SAAB All	All	2000
EAGLE Vision	All V-6	2000	LAND ROVER Defender 90 Discovery Range Rover	All All All	3500 5500 6500	SUBARU Legacy Outback	2.5 I-4	2000
FORD Aerostar Ext. Wagon (2WD) Aerostar Ext. Wagon (2WD) Aerostar Ext. Wagon (AWD)	3.0 V-6 4.0 V-6 4.0 V-6	4000 4400 4200	LEXUS LS/ES models LX450	All 4.5 I-6	2000 5000	TOYOTA 4 Runner 4 Runner Camry/Avalon Land Cruiser Previa Tacoma Tacoma T100 (2WD) Std. Cab T100 (2WD) All Cab	2.7 I-4 3.4 V-6 All 4.5 I-6 2.4 I-4 All I-4 3.4 V-6 2.7 I-4 3.4 V-6	3500 5000 2000 5000 3500 3500 5000 4000 5200
			LINCOLN All	4.6 V-8	2000	VOLKSWAGON Eurovan	All	4400
						VOLVO All	All	3300

*The above tow ratings are the highest available for the respective models. Certain optional equipment may be required and other restrictions may apply. For exact specifications, contact your automotive dealer.

Features and Options

Exterior

2" Thick Aluminum Framed and Laminated Walls, Roof and Floor / White fiberglass skin / Powder coat frame with 2" coupler / Rubber roof / One-piece ABS molded front cap / Seamless radius lower wrap / Flush and radius baggage doors / 26" wide entry door / Double 20-lb. LP bottle (S-Series) / Double 30-lb. LP bottle (E-Series) / Enclosed underbelly with heated tanks / Independent torsion suspension / Roto cast wheel wells / Molded fender skirts with hidden fasteners / Flush mounted front rock guard / Customized graphics / 13" radial tires (S-Series) / 14" radial tires (E-Series)

Electrical

Amber patio light / Pre-wire for A/C, microwave and stereo / 45 amp. converter / Cellular phone hook-up / Monitor panel

Bath

ABS tub surround / Medicine cabinet with mirror / Power roof vent / Towel bar, toothbrush holder, and toilet tissue holder

Appliances/Equipment

Single Door Refrigerator (S-Series) / Double Door Refrigerator (E-Series) / 3-burner range top / Range hood with light / 6-gal. gas water heater (S-Series) / 6-gal. DSI water heater (E-Series) / A/C ready / Water heater bypass kit / Laminated galley top with double bowl acrylic sink and high-profile spout / Copper LP gas lines

Interior

Indoor/Outdoor dinette table / Reversible dinette cushions with vinyl backs / Colorful valances with tieback side curtains / Miniblinds / Congoleum no-wax vinyl floor / Partial carpet (E-Series) / Cathedral top, oak mortise and tenon cabinet doors / Slide-out storage trays under kitchen sink / Headboard and bedspread / Fire extinguisher / Smoke detector / Wallpaper border accent in kitchen and/or living area

Options

Microwave / Convection microwave / 13,500 BTU A/C / Patio awning / Swivel rocker / Bar stools / Spare tire / 4 Stabilizer jacks / TV antenna / AM/FM cassette stereo / AM/FM CD stereo / Cabinet bunk bed / 2 Skylights

Due to continuous product development and improvement, Keystone RV Company reserves the right to make changes in specifications, and/or standard and optional features at any time, without prior notice. 11/98

¹Consult our written warranty for details of 5-year Structural Warranty.

Your Cougar Dealer



Keystone Quality

The Cougar Ultra-Lite is a product of Keystone RV Company. Keystone has been formed by a group of owner/managers who left key positions at major corporations in the recreational vehicle industry. We created Keystone to bring alive our concept of what quality really means. We must have filled a great need—since opening our doors, we've become the fastest growing company in the industry, with over 200 dealers across the nation and six manufacturing plants in the U.S. Of course, creating excellent recreational vehicles like the Cougar is our highest quality objective. But at Keystone, we believe that there are many more ingredients to quality. Product excellence is where we begin. Then...

Quality Means People Who Care

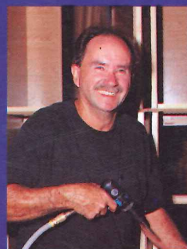

Charlie Weeden,
Wood Finisher

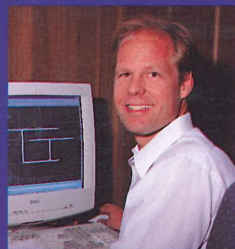

Mark Bullock,
Director of Engineering



Ann Spratt,
Quality Control

Another big part of the quality incentive at Keystone involves showing concern and respect for our customers, our dealers, our suppliers, and each other. Our employees are as proud of their teamwork as they are of our product. Our owner/manager team works to set the example. We believe we have developed a company culture where people come first.

Quality Is An Attitude

At Keystone, we love RVing and the beautiful outdoors, so our commitment to quality involves the desire to produce convenient, feature-loaded, outstanding RVs for families all over America. Further, we respect the fact that for many, the selection of your RV will be one of your life's biggest purchases, next to your home and your children's education. Our mission is to make that purchase one of the best values you'll ever find. Because of this goal, we strive to support our dealers as they educate and guide you in this important decision. And we welcome your inquiries and/or visits to our corporate headquarters in Northern Indiana.

Quality Means Backing Our Products

Service for your Cougar is available across the U.S. and Canada. Keystone's "Instant Service" Warranty means that you will have dependable, qualified technicians to care for your Cougar, if you should ever require this assistance. Keystone, "Your Towable Specialist," welcomes you as a Cougar customer. Once you join the family of Keystone owners, you will find that our definition of quality also means that we sincerely value your business, and will continue to serve you long after your purchase has been made.

Cougar is a Division of:



**Keystone RV
Company™**

17400 Hackberry Drive

Goshen, IN 46526

(219) 533-3713

www.keystonerv.com