

REGENCY 06



REGENCY 06

Never compromise.

Loaded with many of the features found in our larger Class A motorhomes, Regency is ideal for couples and small families who want a compact motor home but still want to travel first class. From the oak cabinetry in its well appointed kitchen to the many thoughtful extras we've added to its luxuriously furnished living area and, Regency offers more of what you need to make life on the road truly special.



C30G shown with Wrangler Decor



Need extra sleeping room? Regency has it covered with its spacious bunk and smartly designed dinette that quickly converts into a bed.

Available on select models, this pull-out pantry is a great way to keep your kitchen supplies neatly organized.



The chef will love Regency's ample galley storage space and its convection microwave oven (select models only).



Regency's charming bedroom is beautifully finished off with a decorative bedspread and matching pillows.

Floor Plans

CARPET OPTIONAL CARPET LINOLEUM

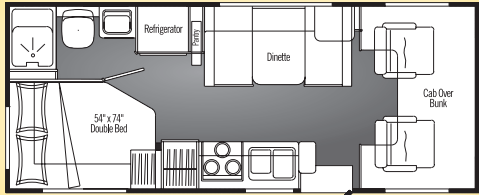

C22

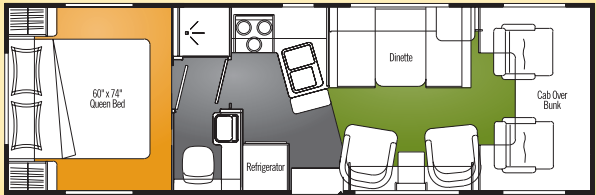

C28

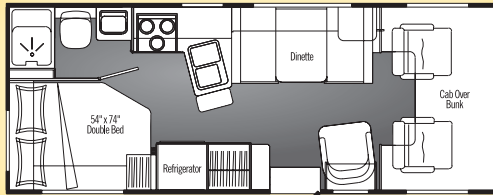

C24

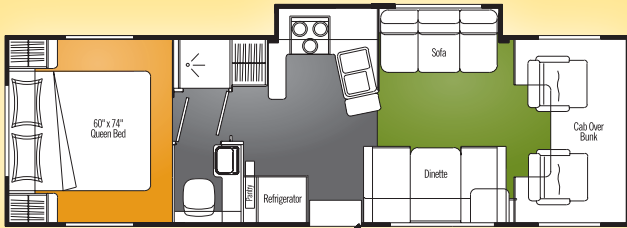

C30G

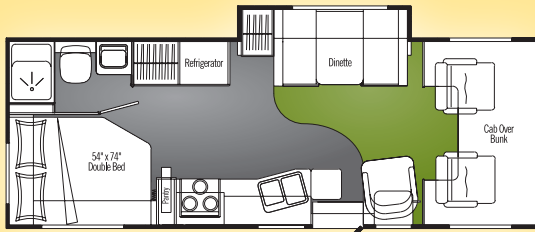

C25D

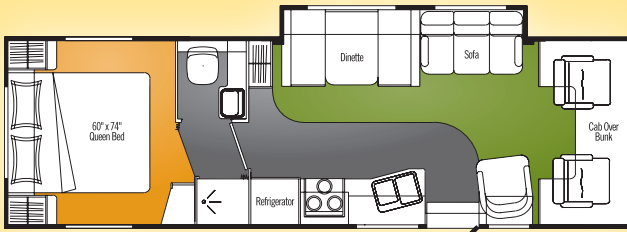

C31F

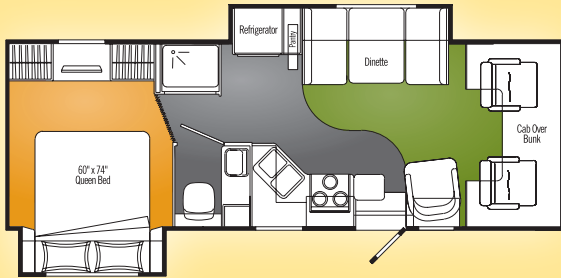

C27DB

Specifications

REGENCY 2006	C22	C24	C25D	C27DB	C28	C30G	C31F
GVWR — lbs. (kg)	11,500 (5 216)	14,050 (6 373)	14,050 (6 373)	14,050 (6 373)	14,050 (6 373)	14,050 (6 373)	14,050 (6 373)
UVW — lbs. (kg)	9,167 (4 158)	9,558 (4 336)	11,243 (5 101)	11,793 (5 351)	10,666 (4 838)	11,328 (5 140)	11,878 (5 389)
NCC — lbs. (kg)	2,333 (1 058)	4,492 (2 037)	2,807 (1 274)	2,257 (1 022)	3,384 (1 535)	2,722 (1 233)	2,172 (984)
Wheelbase — in. (mm)	158 (4 013)	158 (4 013)	185 (4 699)	185 (4 699)	190 (4 826)	208 (5 283)	218 (5 537)
Length* — ft. (mm)	22' 11" (6 985)	24' 3" (7 391)	26' 4" (8 026)	27' 8" (8 433)	28' 7" (8 712)	30' 1" (9 169)	31' 2" (9 500)
Width — ft. (mm)	8' 4" (2 534)	8' 4" (2 534)	8' 4" (2 534)	8' 4" (2 534)	8' 4" (2 534)	8' 4" (2 534)	8' 4" (2 534)
Height** — ft. (mm)	10' 8" (3 251)	10' 8" (3 251)	10' 8" (3 251)	11' 2" (3 401)	10' 8" (3 251)	10' 8" (3 251)	10' 8" (3 251)
Water Tank Capacity*** — U.S. gal. (L)	36 (137)	36 (137)	36 (137)	36 (137)	36 (137)	36 (137)	36 (137)
Holding Tank Capacity — U.S. gal. (L)	64 (243)	64 (243)	64 (243)	64 (243)	64 (243)	64 (243)	64 (243)
Fuel Capacity — U.S. gal. (L)	55 (209)	55 (209)	55 (209)	55 (209)	55 (209)	55 (209)	55 (209)
Propane Capacity — U.S. gal. (L)	17.5 (66)	17.5 (66)	17.5 (66)	17.5 (66)	17.5 (66)	17.5 (66)	17.5 (66)

*Not including spare tire **Includes air conditioner ***Includes water heater

GVWR (GROSS VEHICLE WEIGHT RATING)

The maximum permissible weight of this motorhome. The GVWR is equal to or greater than the sum of the unloaded vehicle weight (UVW) plus the net carrying capacity (NCC).

UVW (UNLOADED VEHICLE WEIGHT)

The weight of the motorhome as built at the factory with full fuel, engine oil, and coolants. The UVW does not include cargo, fresh water, LP gas, occupants, factory or dealer installed accessories.

NCC (NET CARRYING CAPACITY)

The maximum weight of all occupants, including the driver, personal belongings, food, fresh water, LP gas, tools, tongue weight of towed vehicle, factory and dealer installed accessories, etc., that can be carried by this motorhome. (NCC is equal to or less than GVWR minus UVW.)

Please see your dealer for weights of factory installed options.

Colour Options

GREAT PLAINS

WRANGLER

STRUCTURE

NIAGARA FALLS

SOFA

BEDSPREAD

ACCENT

CARPET

CAPTAIN
CHAIRS

Standards and Options

VEHICULAR	C22	C24	C250	C270B	C28	C30G	C31F
Air Conditioning – Chassis	S	S	S	S	S	S	S
Block Heater	S	S	S	S	S	S	S
Chassis – Ford 11,500 GVW, E-350, 6.8L EFI V-10 Triton	S	-	-	-	-	-	-
Chassis – Ford 14,050 GVW, E-450, 6.0 L Powerstroke Diesel with LP Generator Ready	-	0	-	-	0	-	-
Chassis – Ford 14,050 GVW, E-450, 6.8L EFI V-10 Triton	-	S	S	S	S	S	S
Cruise Control and Tilt Steering Wheel	S	S	S	S	S	S	S
Hitch – Trailer Hitch Receiver with Wiring, 350-3500 lbs.	S	S	S	S	S	S	S
Light – High Mounted Rear Stop Light, LED Long Life	S	S	S	S	S	S	S
Mirror – Interior Rear View Mirror	S	S	S	S	S	S	S
Mirrors – Automotive Styled Exterior Mirrors	S	S	S	S	S	S	S
Power Windows and Door Locks	S	S	S	S	S	S	S
Seat – Power Driver's Seat	S	S	S	S	S	S	S
Spare Tire – Crank Down Underfloor Mount	-	-	-	-	S	S	S
Spare Tire – Underfloor	-	-	-	S	-	-	-
Spare Tire with Carrier	S	S	S	-	-	-	-
Switch – Battery Selector Switch for Radio	S	S	S	S	S	S	S
Tires – Radial Ply	S	S	S	S	S	S	S
Transmission – Automatic with Overdrive	S	S	S	S	S	S	S
Undercoating – Chassis	S	S	S	S	S	S	S
Wheel Simulators	S	S	S	S	S	S	S
CONSTRUCTION							
Aluminium Framed Vacuum Bonded Insulated Wall and Roof Construction	S	S	S	S	S	S	S
Floor – Steel Framed Vacuum Bonded Insulated Floor Construction	S	S	S	S	S	S	S
Roof – One Piece EPDM Roof	S	S	S	S	S	S	S
Vacuum Bonded Filon Plus FRP Sidewalls	S	S	S	S	S	S	S
Windows – Tinted Radius Cornered Windows	S	S	S	S	S	S	S
EXTERIOR							
Doors – Exterior Flush Radius Style Baggage Doors	S	S	S	S	S	S	S
Light – Porch Light with Yellow Lens and Interior Wall Switch	S	S	S	S	S	S	S
Running Boards – Fibreglass Flares and Running Boards	S	S	S	S	S	S	S
Storage – Below Floor Pass Through Storage Compartment at Rear	-	-	-	S	-	-	-
Storage – Pass Through Storage Compartment at Rear	-	-	-	-	S	S	S
INTERIOR							
Blind – Venetian Blind in Galley	S	S	S	S	S	S	S
Cabinet – Storage Cabinets on Sides of Overhead Bunk	S	S	S	S	S	S	S
Cabinet – TV Cabinet with Tambour Doors	S	S	S	-	S	S	-
Cabinets – Oak Finished Cabinet Construction	S	S	S	S	S	S	S
Detectors – Electronic Smoke, LP and CO Detectors	S	S	S	S	S	S	S
Doors – Raised Solid Oak Cabinet Doors	S	S	S	S	S	S	S

INTERIOR (CONTINUED)	C22	C24	C250	C270B	C28	C30G	C31F
Drapes – Privacy Drape, Bedroom	S	S	S	-	-	-	-
Drapes – Privacy Drape, Cab	S	S	S	S	S	S	S
Drawers – Full Extension Ball Bearing Drawer Tracks	S	S	S	S	S	S	S
Fire Extinguisher – Dry Chemical	S	S	S	S	S	S	S
Flooring – Carpet in Living Area	-	-	0	0	0	0	0
Flooring – Carpeted Bedroom	-	-	-	S	S	S	S
Flooring – Vinyl Flooring in Galley, Living Area and Bathroom	S	S	S	S	S	S	S
Handle – Oak Assist Handle at Bunk	S	S	S	-	S	S	S
Magazine Rack – Oak Magazine Rack on Cab Wall	S	S	S	S	S	S	S
Shades – Pleated Day/Night Shades	S	S	S	S	S	S	S
Shelf – Bedroom TV Shelf	-	-	-	-	0	0	S
FURNITURE							
Bed – Single Bed above Drivers Area	-	-	-	S	-	-	S
Bed – Twin Beds	-	-	-	-	0	0	0
Booth Dinette – Wall Mount Dinette Table, 5" Laminated Cushions	S	S	S	S	S	S	S
Chair – Swivel Cocktail Chair	-	S	S	S	-	-	S
Chair – Swivel Cocktail Chairs (2) with Oak Flip Table	-	-	-	-	S	-	-
Love Seat – Cloth	-	-	-	-	-	-	S
Mattress – Innerspring 54" x 74"	S	S	S	-	-	-	-
Mattress – Innerspring 60" x 74"	-	-	-	S	S	S	S
Pillows – Coordinated Pillows for Living Area	0	0	0	0	0	0	0
Sofa – 62" with Flip-Up Seat Storage	-	-	-	-	-	S	-
Sofa – Jackknife 66" with Flip-Up Seat Storage in Lieu of Cocktail Chairs and Flip Table	-	-	-	-	0	-	-
GALLEY							
Bi-Fold Range Cover	S	S	S	S	S	S	S
Convection Microwave – OTR with Light and 110 Volt Vent Fan, Cooktop and Drawers	-	-	-	S	-	0	-
Cooktop – 3 Burner Range/Oven with High Output Burner	S	S	S	-	S	S	S
Countertop – Radius Solid Oak Trim on Countertops	S	S	S	S	S	S	S
Microwave – OTR with Light and Vent Fan	-	-	-	-	-	S	-
Microwave Oven	S	S	S	-	S	-	S
Range Hood – Lighted Power Range Hood	S	S	S	-	S	-	S
Refrigerator – Dometic Double Door LP/Electric 6 cu. ft.	S	S	S	S	S	S	S
Refrigerator Inserts – Oak Framed, Raised Panel Fridge Inserts	-	-	-	S	-	-	-
Sink – Acrylic Deep Bowl with Cutting Board Cover	S	S	S	S	S	S	S
LAVATORY							
Fan – Power Bath Vent	S	S	S	S	S	S	S
Hooks – Robe Hooks in Shower	S	S	S	S	S	S	S
Toilet – Sealant Traveller Lite, China, Foot Flush	S	S	S	S	S	S	S

S Standard 0 Optional

Standards and Options (CONTINUED)



	C22	C24	C25D	C27DB	C28	C30G	C31F
ENTERTAINMENT							
CD Changer – 10 Stack CD Changer	0	0	0	0	0	0	0
Entertainment Console – Over Cab with 20" AC TV and DVD VCR Combo	-	-	-	0	-	-	0
Entertainment Console – Over Cab with 20" AC TV and Slide-Out Single Bed (N/A with Diesel Option)	0	0	0	-	0	0	-
Receptacles – Twin 110 Volt Outlets at Entertainment Cabinet	S	S	S	S	S	S	S
Stereo – AM/FM Weather Band Receiver with Cassette/CD Player, Big Button	0	0	0	0	0	0	0
Stereo – AM/FM Weather Band Receiver with CD Player in Dash, Big Button	S	S	S	S	S	S	S
TV – Flip-Down 15" LCD TV in Bedroom	-	-	-	0	-	-	-
TV Antenna – Roof Top Retractable Antenna with Booster	S	S	S	S	S	S	S
HEATING, VENTILATING AND AIR CONDITIONING							
Air Conditioner – 13,500 BTU Roof Air Conditioner with Heat Strip	S	S	S	S	S	S	S
Fan – Thermal Controlled	0	0	0	0	0	0	0
Fan – Thermal Controlled in Bedroom	-	-	-	0	0	0	0
Furnace – 35,000 BTU Furnace	S	S	S	S	S	S	S
ELECTRICAL							
Battery – Second RV Coach Battery (1 Standard)	0	0	0	0	0	0	0
Bidirectional Isolator Relay Delay (BIRD) Battery Charging	S	S	S	S	S	S	S
Cable TV Hook-Up	S	S	S	S	S	S	S
Converter – Power Converter with Battery Charger, Auto Changeover Switch	S	S	S	S	S	S	S
Cord – 25 ft. Power Cord	S	S	S	S	S	S	S
Generator – 3.6 KW Onan MicroQuiet® LP Generator (optional with 6.0 L Diesel Engine Only)	-	0	-	-	0	-	-
Generator – 4.0 KW Onan MicroQuiet®	0	0	0	0	0	0	0
Generator Ready	S	S	S	S	S	S	S
Pre-Wire for Rear View Camera	-	-	S	S	S	S	S
Receptacle – GFI Patio 110 Volt Receptacle	S	S	S	S	S	S	S
Switch – 12 Volt Battery Disconnect	S	S	S	S	S	S	S

	C22	C24	C25D	C27DB	C28	C30G	C31F
PLUMBING AND LP SYSTEMS							
Black Tank Flush with Atmospheric Break	S	S	S	S	S	S	S
Monitor Panel – Grey, Black, Fresh Water and Battery Charge	S	S	S	S	S	S	S
Pick-Up Kit – Antifreeze Pick-Up Kit	S	S	S	S	S	S	S
Valve – Water Heater By-Pass Valve	S	S	S	S	S	S	S
Water Heater – Electronic Ignition LP Water Heater	S	S	S	S	S	S	S
SYSTEMS							
Rear View Camera/Monitor – Colour	0	0	0	0	0	0	0
OPTIONAL AWNING PACKAGES							
Awning – A&E 8500 Patio Awning – Vinyl (length shown)	10	11	13	12	18	19	20
PACKAGES							
XL Package Includes: Continental Tire Cover, Electric Step, Light Package in Baggage Compartments, Painted Skirts, Thermal Pane Windows, Fibreglass Front And Rear Mask, Enclosed, Insulated and Heated Holding Tanks, Rear Auxiliary Heater, Slide-Out Battery Tray, Fabric Headliner	-	S	S	S	S	S	S
Customer Value Package (Mandatory Option) Includes: Skylight in Shower, Exterior Shower with Shut-Off Valves for Winterizing, Exterior Ladder, Rust Protection, Rear Airbag Assist Suspension, Satellite Pre-Wire	0	0	0	0	0	0	0
Factory PDI	0	0	0	0	0	0	0
S Standard 0 Optional							



RECREATIONAL VEHICLES

Triple E Recreational Vehicles P.O. Box 1230, Winkler, Manitoba, Canada R6W 4C4 Telephone: (204) 325-4361 Fax: (204) 325-5241

www.tripleerv.com

Triple E Recreational Vehicles meet or surpass CSA-CRVA-RVIA standards covering electrical services, gas services, plumbing services and vehicular safety. Regency Motorhomes exceed 96" in width. In some states, 96" is the maximum width of vehicles travelling some or all state roads. It is the responsibility of the owner to be familiar with the road usage laws of the states in which you travel. Product improvement is a continuing process at Triple E Recreational Vehicles. Thus, we reserve the right to change specifications on any or all products without prior notice; errors and omissions excepted. Triple E Recreational Vehicles is under no obligation to undertake modification to units manufactured prior to changes on specifications. Brochure pictures may be shown with optional equipment. Colours may not be exactly as shown due to the printing process. Please see your dealer for specific colours.

