

# TUNDRA

2006 Super-Lite Travel Trailers & Fifth Wheels



*Never Stop Exploring*





# TUNDRA

2006 "Super-Lite" Travel Trailers & Fifth Wheels



Designed to be towed by most half-ton trucks, Tundra is the new standard in "Super-Lite" recreational vehicle technology. Our "Super-Lite" construction starts with a six-way welded aluminum framed superstructure. The walls, roof, and floor are insulated with high density foam and are laminated to the superstructure. This "Super-Lite" construction process is designed to maximize living space and storage without adding the weight you will find in most recreational vehicles.

But, there is more to a recreational vehicle than the construction. Tundra's interiors are as impressive as its revolutionary design. Tundra features unique floorplans with large living areas, kitchens, baths and bedrooms. Stunning high-end designer décors, residential-style furnishings, and brand name appliances are a few of the many features that define Tundra. Compare our features to the competition and we are sure you will agree that Tundra is your best value when it comes to "Super-Lite" travel trailers and fifth wheels.

*Never Stop Exploring*





Sizable bedrooms with queen beds and generous storage areas are staples of the Tundra product line.

Plus, a designer headboard with bedspread pillows and matching curtains are standard!



Tundra floorplans feature spacious galleys with ample countertop and storage space. A double door refrigerator, large oven with cooktop, large microwave oven and a range hood with light and fan are standard features on all Tundra models. Plus, many floorplans include a bonus storage pantry and a large pots and pans drawer.



# TUNDRA

## 2006 SUPER-LITE TRAVEL TRAILERS

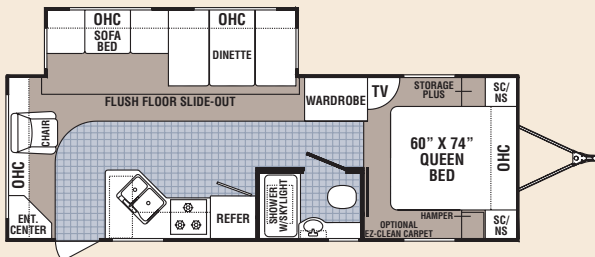

26RL-DSL

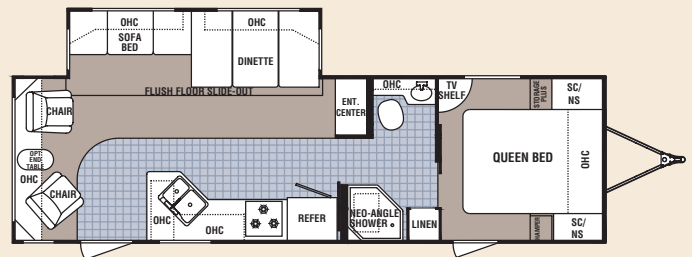

30RL-DSL

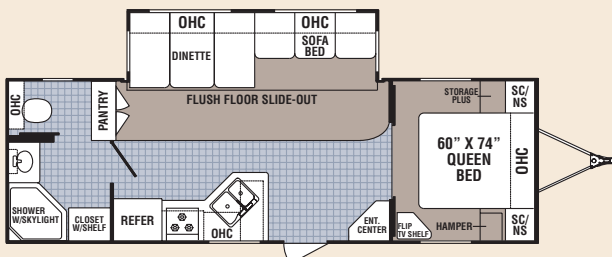

27FB-DSL

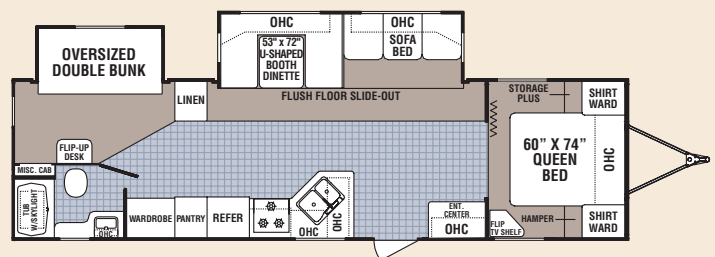

31BH-DSL

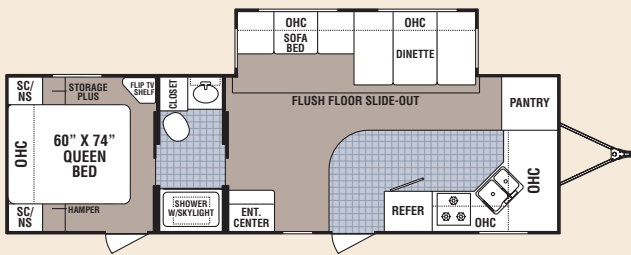

27FK-DSL

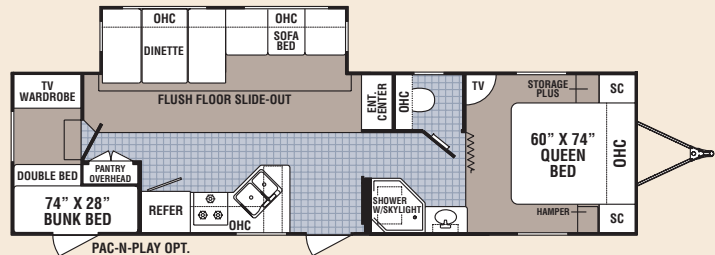

31BK-DSL (available with Pac-n-Play storage option)

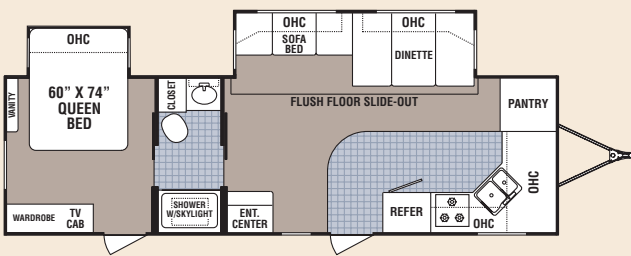

27FK-DSL-BS

CHECK OUT OUR WEBSITE FOR  
PRODUCT UPDATES, NEW  
FEATURES AND FLOORPLANS.  
[WWW.TUNDRA-RV.COM](http://WWW.TUNDRA-RV.COM)



Free Good Sam  
Club 6 month  
trial membership  
when you purchase  
a Tundra trailer.

\*Details will arrive in the mail 4  
to 6 weeks after purchase.

### POWER V CHASSIS

#### A TUNDRA EXCLUSIVE!

Developed exclusively for Tundra, the *Power-V* is the latest in chassis design.

The *Power-V Chassis* is designed to be lightweight while rigid to carry maximum loads. *Power-V* features a lifetime rust-through warranty with durable powder-coat over E-coat paint finish.

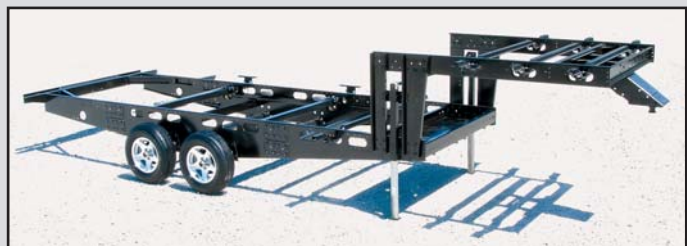

**Tundra's Super-Lite construction means larger floorplans that weigh 1000-1500 lbs. less than traditionally built RV's!**

## 2006 SUPER-LITE FIFTH WHEELS



### 19FT - The Truck Camper Alternative Only weighs 4,672 lbs!

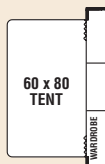

Tent Option

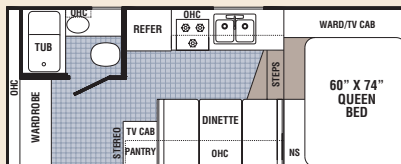

#### 19FT-M5 Designed for half-ton trucks

(Refer to your truck owners manual for tow rating)

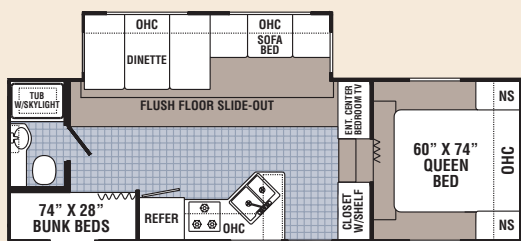

**24BH-M5** (available with Pac-n-Play storage option)

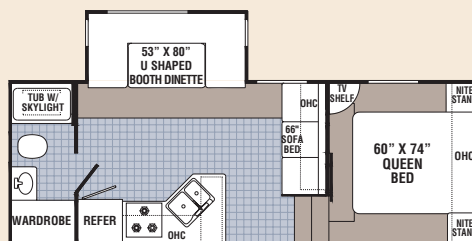

**24CK-M5**

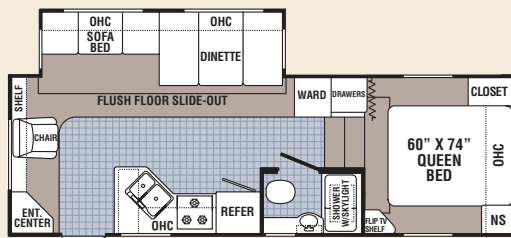

**24RL-M5**

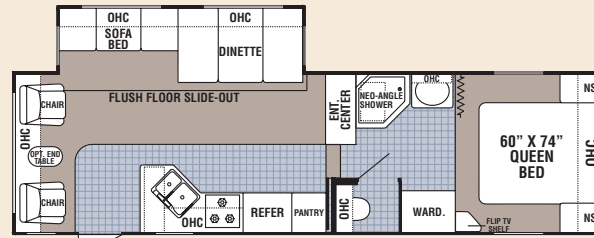

**27RL-M5**

### Travel Trailers

### Fifth Wheels

	26RL-DSL	27FB-DSL	27FK-DSL	27FK-DSL-BS	30RL-SL	31BH-DSL	31BK-DSL	19FT-M5	24BH-M5	24CK-M5	24RL-M5	27RL-M5
*Axle Weight	NA	4979	5139	5585	5412	5530	NA	4065	NA	4700	NA	NA
*Dry Hitch Weight	NA	542	752	632	613	930	NA	833	NA	877	NA	NA
*Unloaded Vehicle Weight	NA	5521	5891	6217	6025	6460	NA	4898	NA	5577	NA	NA
GVWR	NA	7600	7600	7600	7600	7600	NA	6240	NA	8400	NA	NA
Cargo Capacity	NA	2079	1709	1383	1575	1140	NA	1342	NA	2823	NA	NA
Exterior Length	29'7"	30'6"	32'6"	32'6"	32'6"	35'6"	35'6"	22'9"	NA	25'3"	NA	NA
Exterior Width	8'	8'	8'	8'	8'	8'	8'	8'	8'	8'	8'	8'
Exterior Height w/A/C	10'8"	10'8"	10'8"	10'8"	10'8"	10'8"	10'8"	10'8"	12'1"	12'1"	12'1"	12'1"
Fresh Water Tank	46	46	46	46	46	46	46	46	46	46	46	46
Grey Water Tank	34	34	68	68	34	34	34	34	34	34	34	68
Black Water Tank	34	34	34	34	34	34	34	22	34	22	34	34
Tire Size	ST205/75R15(C)	ST205/75R15(C)	ST205/75R15(D)	ST205/75R15(D)	ST205/75D15(C)	ST205/75D15(C)	ST205/75R15(C)	ST205/75R15(C)	ST205/75R15(C)	ST205/75R15(C)	ST205/75R15(C)	ST205/75R15(C)
Furnace Size	30,000	30,000	30,000	30,000	30,000	30,000	30,000	30,000	30,000	30,000	30,000	30,000

Vehicle loading – Every effort has been made to provide the greatest number of options for the recreation vehicle owner. Along with these choices comes the responsibility to manage the loads that are imposed by the choices that they remain within the manufacturer's specified chassis weight limits. Do not overload the recreational vehicle. Net carrying capacity (NCC) is determined by subtracting unloaded vehicle weight (UVW) from gross vehicle weight (GVWR) and includes fluids, options and cargo. Liquid capacities and weights are approximations only. Warning – This information is intended as a guide only. Weights of individual vehicles may vary. Consult your owner's manual for complete loading, weighing and towing instructions.

\*Axle weight, UVW and Dry Hitch Weight are base weights of units without options. Each unit includes a weight label which lists specific weight information for that unit.

Photographs may contain some features that are optional on your vehicle. Since we continually strive to improve our products, actual products may differ. Prices and specifications are subject to change without notice. All capacities are approximate and dimensions are nominal. Some features shown are optional and may be different or unavailable in Canada.



# TUNDRA

## Super-Lite Construction

### CHASSIS

1. Folding entry step – low step height for easy entry
2. Ultra-lube hubs. Grease Zerk makes wheel bearings easy to lube. Extends life of bearings
3. Rubber torsion “independent suspension” axles - the smoothest ride in the industry!
4. All tanks mounted in frame. Lowers the center of gravity, and saves valuable interior storage space
5. 46 Gallon fresh water tank with Quick Drain feature. Tank design prevents water from standing in tanks during storage. One of the largest fresh water tanks in the industry!
6. Optional enclosed underbelly protects tanks and floor from the hazards of the road (Part of the Alaska Package)
7. Power-V lightweight chassis with durable powder-coat over E-coat paint finish
8. Twin 30 lb. LP tanks with optional ABS cover

9. Integrated heavy duty safety chains

### WALLS

**5-Ply construction. Fully laminated, aluminum framed construction.**

10. Tubular aluminum welded frame – reinforced around door
11. Dark tinted, safety glass radius corner windows
12. Insulated baggage doors with key locks and finger pulls
13. ABS fender skirts
14. Decorative wall board
15. Lauan wood backer
16. High density structural foam insulation
17. Lauan plywood backer
18. Smooth fiberglass with premium graphics package
19. Pass-through storage compartment (where available)
20. Aerodynamic front profile

### ROOF

**5-Ply construction. Fully laminated, aluminum framed construction.**

21. Tubular aluminum radius framed roof reinforced at A/C
22. Lauan wood backer
23. One-piece EPDM rubber roof with 12 year manufacturer's material warranty
24. High density structural foam insulation
25. Lauan wood backer
26. Decorative ceiling board

### FLOOR

**5-Ply construction. Fully laminated, aluminum framed floor structure.**

27. One-piece composite wheel wells (non-slide & SL models)
28. Residential vinyl flooring – full length of coach
29. Residential carpet with pad (most models)
30. Two layers of floor decking over aluminum frame and foam
31. High density structural foam
32. Plywood base with polypropylene waterproof vapor barrier
33. Tubular aluminum framed floor, reinforced at tanks

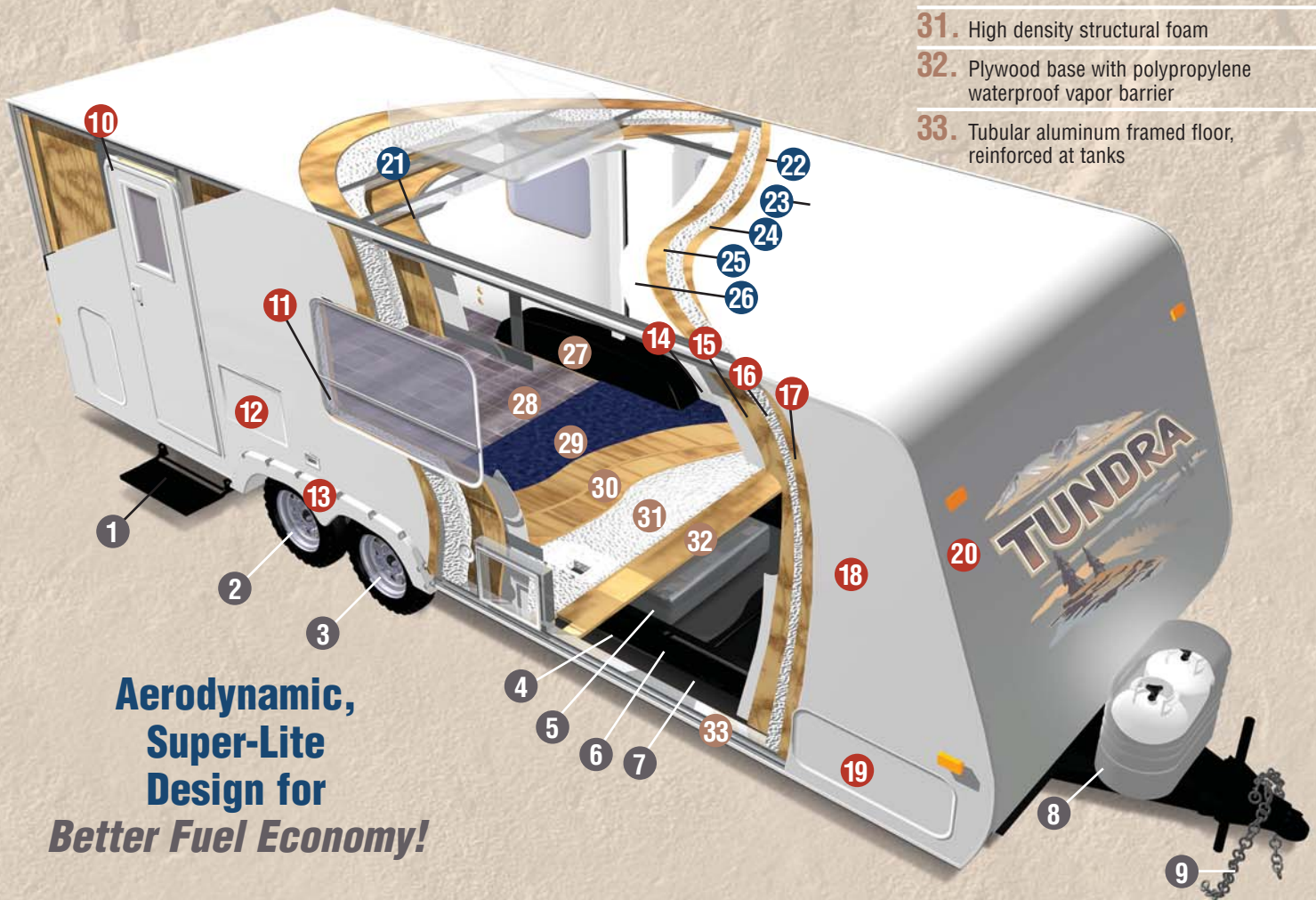

**Aerodynamic,  
Super-Lite  
Design for  
Better Fuel Economy!**



## Premium Standard Features



Tundra's dinette seat, bunk beds, queen beds and pass-through storage compartments are aluminum framed. They are lighter and more durable than the competitors' wood frame structures.



All fresh water tanks are mounted in the frame, which lowers the center of gravity and saves valuable interior storage space. The 46 gallon fresh water tank features a quick drain design that prevents water from standing in the tanks during storage. This is the largest fresh water tank in the industry!

80% Dark tint windows keep your Tundra cool on warm days.



Oversized, pass-through storage compartment is carpeted and includes a convenience light. (most models)



## Alaska Upgrade Package



Upgrade your Tundra! The Alaska Upgrade Package includes aluminum rims, an enclosed underbelly and 12V heat pads on the fresh, grey and black water tanks. (Heat pads not available in Canada)

The enclosed underbelly enhances the aerodynamics of Tundra and protects the fresh water, holding tanks and floor from the hazards of the road.



## Popular Options

### A. Industry Exclusive! - AudioLite™ Speakers

Tundra features *AudioLITE™* exterior speakers by *Intier®*. Utilizing the latest "NXT surface sound technology," *AudioLITE™* speakers provide crisp, undistorted sound. Plus, they are impact resistant and waterproof.



### B. 8" Lift Kit Package

Tundra's 19FT-M5 is available with Dunlop Rover LT235/75R15 mud and snow tires for off-road use.



### C. Bike Carrier

Tundra's easy to use bike carrier mounts on the travel trailer's "A-frame." It securely holds three adult or children's bicycles. The option also includes a 2" trailer hitch mount that allows you to use the bike rack on your truck, van or SUV.



### D. Exterior Grill

Take your cooking outside with Tundra's exterior barbecue grill.

### E. Water Heater Upgrade

Upgrade your Tundra with the six gallon gas/electric water heater with direct spark ignition (DSI).



### F. 2-Way Radio Package

*Audiovox* two-way radios include 4 five-mile range radios and a 12V charger base station.



### G. Night Shades

These fabric blinds include a light filtering shade that provides a room darkening shade for privacy at night.



### H. Exterior Shower

Tundra's exterior shower features hot and cold water, a quick connect coil hose and a sprayer.





# TUNDRA

## STANDARD FEATURES

### Standard Exterior Features

- Super-lite aerodynamic design
- Power-V lite-weight chassis with highly durable e-coat and powder coat finish
- Rubber torsion "independent suspension" axles with 4-wheel electric brakes
- Laminated 5" crowned roof structure
- EPDM one piece seamless rubber roof
- Welded aluminum/laminated super-structure (roof, floor and walls)
- Radius corner entry door with deadbolt lock
- Composite wheel wells
- Folding entry step
- High-end designer graphics
- Rain gutters with corner downspout's
- Color ABS fender skirts
- Break-away trailer switch
- 120V exterior outlet

- Dark-tint, radius clamp ring safety glass windows
- Step light with switch (exterior)
- "Storage Plus" exterior pass-through storage with light (most models)
- Two 30 lb. LP tanks with ABS cover
- Courtesy light at hitch
- Electric slide motor
- Electric front jack (fifth wheels)

### Appliances and Electrical

- Norcold double-door gas/electric refrigerator
- 3 Burner range with "quick boil" burner and large oven
- Range hood with 12V light and exhaust fan
- Systems monitor panel
- Ducted heat
- Forced air DSI furnace with wall thermostat
- Roof ducted for A/C

- Pre-wired for A/C
- Pre-wired for stereo
- Solid state converter with built-in battery charger
- LPG/Smoke/CO detector
- Fire extinguisher
- Data/phone jack
- 30 Amp power cord with exterior storage compartment
- Demand water pump

### Standard Interior Features

- Raised panel cabinet doors
- Residential tile-like flooring
- Carpet throughout
- Décor wallboard with easy-clean vinyl coating
- Reversible arched back dinette seats
- Premium light fixtures
- Décor-coordinated wallpaper border
- Mini blinds throughout
- Designer glass light over dinette table (most models)
- Designer window treatments

- Premium sofa with roll-over design
- Skylight roof vents
- TV shelf/cabinet
- Miniblinds throughout

### Kitchen Features

- Residential faucet
- Trash bag holder below sink
- Double bowl stainless steel sink

### Bedroom Features

- Designer lights in bedroom
- Décor-coordinated bedspread and headboard

- Mirrored wardrobe closets

### Bath Features

- Power roof vent in bathroom
- Skylight over tub/shower
- Medicine cabinet (most models)
- Fiberlink bathtub with curtain or neo-angle shower tub
- Tub/shower surround

## OPTIONAL FEATURES

### Tundra Pack

- 13.5 BTU air conditioner with wall thermostat
- AM/FM/CD player with speakers
- A&E 8300 series awning
- TV antenna with cable prep
- Large microwave

### Alaska Package

(Also available separately)

- Aluminum rims
- Enclosed Underbelly
- Heated holding tanks (3)

### Other Optional Features

- Four corner stabilizer jacks
- Roof ladder (N/A 26RK)
- Exterior barbecue
- Exterior hot and cold spray-away station
- Fantastic vent
- Night shades
- Bike rack
- Water filter with spout

- 15,000 BTU roof A/C
- Stove cover
- Pac-n-Play storage compartment (where available)
- Free-standing dinette (some models)
- AudioLite exterior sound system with 2 speakers
- Chair with ottoman
- Spare tire (with carrier on DSL, cover on others)

- Exterior entry-assist handle at door
- Gas/electric water heater with DSI
- Hide-a-bed sofa
- 8" Lift kit package (19FT-M5)
- Audiovox two-way radio system with 4 radios and wall-mounted charger



**1 YEAR BUMPER TO HITCH  
LIMITED WARRANTY**

**2 YEAR STRUCTURAL &  
APPLIANCE LIMITED WARRANTY**

\*See owner's manual for complete warranty details.

### TUNDRA

2164 Caragana Court ■ Goshen, IN 46526  
(574) 534-1224 ■ Fax: (574) 975-0556

**www.tundra-rv.com**

*Your Local Dealer:*

## Decor Choices



**Ebony**



**Heron Blue**



**Mulberry**



**Pear**