

NEW MID-YEAR FLOORPLANS FIFTH-WHEEL TRAILERS

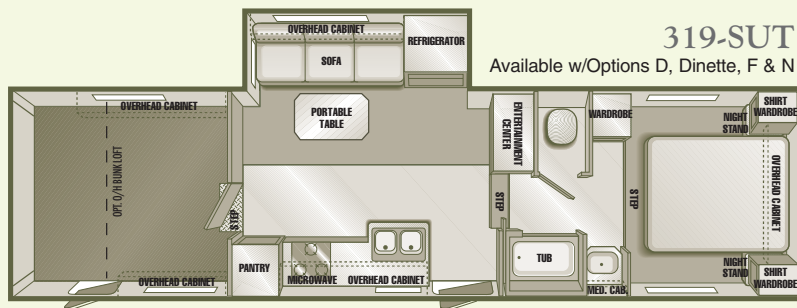

SUT



319-SUT

Available w/Options D, Dinette, F & N

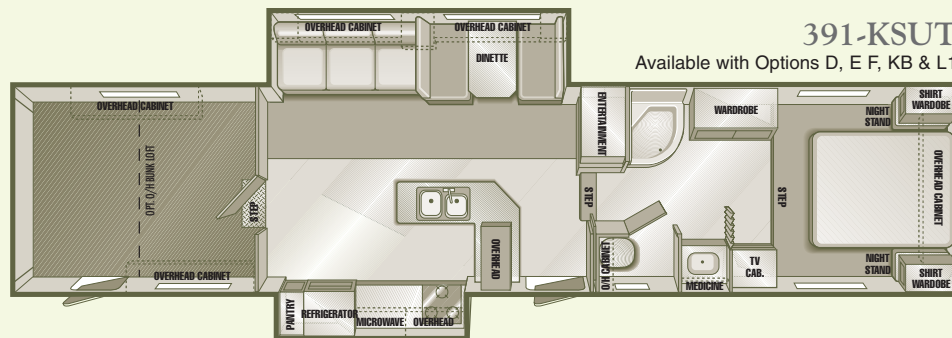

391-KSUT

Available with Options D, E F, KB & L1

SPECIFICATIONS

	319-SUT	391-KSUT
EXTERIOR LENGTH*	32'- 1"	39'- 7"
EXTERIOR HEIGHT**	12'- 6"	12'- 6"
EXTERIOR WIDTH	8'-2 1/2"	8'-2 1/2"
INTERIOR HEIGHT	7'-5"	7'-5"
GARAGE LENGTH	9'	10'
DRY HITCH WEIGHT***	2,510	2,663
DRY GROSS WEIGHT***	10,305	12,657
GVWR	15,000	18,000
CARRYING CAPACITY	4,695	5,343
AXLES	Double	Triple
TIRE SIZE	ST235/80R16D	ST235/80R16D
HITCH HEIGHT	46"	46"
OPTIONAL AWNING SIZE	16"	16"
FURNACE SIZE	31M BTU	35M BTU
DOMESTIC GAS/EL. REFER.	Double Door	Double Door
FRESH WATER CAPACITY	60	60
BLACK WATER TANK CAP.	50	50
GRAY WATER TANK CAP.	90	90
SLEEPING CAP.	4	6

AVAILABLE WITH THESE OPTIONS

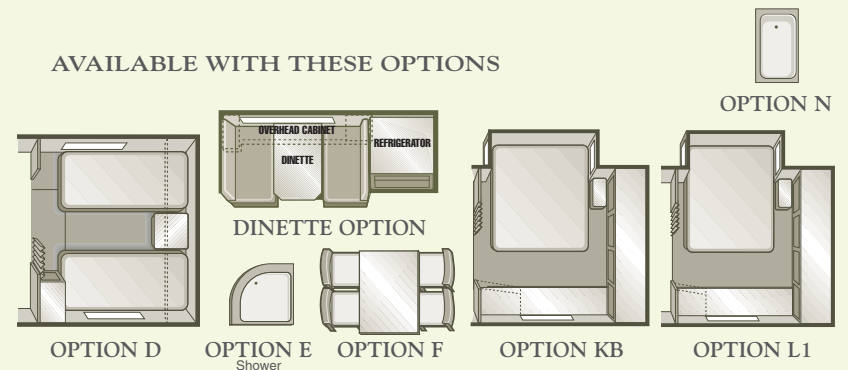

*This handout is an addendum to our SUT brochure. Please see that literature for photography, standards, options, disclaimers and additional information. More information available at sunnybrookrv.com or consult your local SunnyBrook or Mobile Scout dealer.