

2007 Super-Lite Travel Trailers & Fifth Wheels

# TUNDRA



*Never Stop Exploring*



# TUNDRA

2007 "Super-Lite" Travel Trailers & Fifth Wheels



*D*esigned to be towed by most half-ton trucks, Tundra is the new standard in "Super-Lite" recreational vehicle technology. Our "Super-Lite" construction starts with a six-way welded aluminum framed superstructure. The walls, roof, and floor are insulated with high density foam and are laminated to the superstructure. This "Super-Lite" construction process is designed to maximize living space and storage without adding the weight you will find in most recreational vehicles.

But, there is more to Tundra than its Super-Lite construction. Tundra's interiors are as impressive as its revolutionary design. Tundra features unique floorplans with large living areas, kitchens, baths and bedrooms. Stunning high-end designer décors, residential-style furnishings, and brand name appliances are a few of the many features that define Tundra. Compare our features to the competition and we are sure you will agree that Tundra is your best value when it comes to "Super-Lite" travel trailers and fifth wheels.

*Never Stop Exploring*



Sizable bedrooms with queen beds and generous storage areas are staples of the Tundra product line. Plus, a designer headboard with bedspread pillows and matching curtains are standard!



Tundra's dinette seat, bunk beds, queen beds and pass-through storage compartments are aluminum framed. They are lighter and more durable than the competitors' wood frame structures.

Tundra floorplans feature spacious galleys with ample countertop and storage space. A double door refrigerator, large oven with cooktop, large microwave oven and a range hood with light and fan are standard features on all Tundra models.

Plus, many floorplans include a bonus storage pantry and a large pots and pans drawer.





# TUNDRA

## 2007 SUPER-LITE TRAVEL TRAILERS

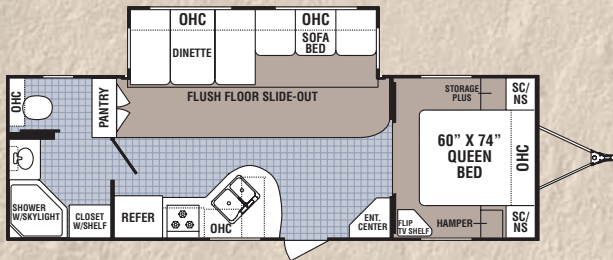

27FB-DSL

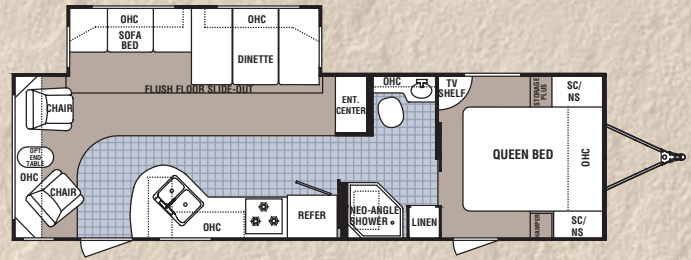

30RL-DSL

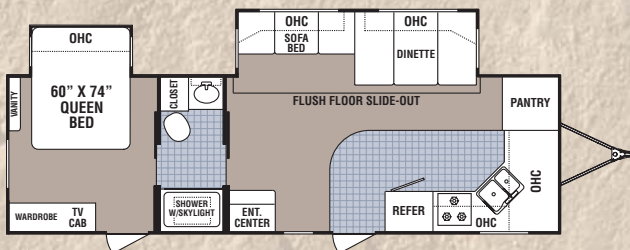

27FK-DSLBS

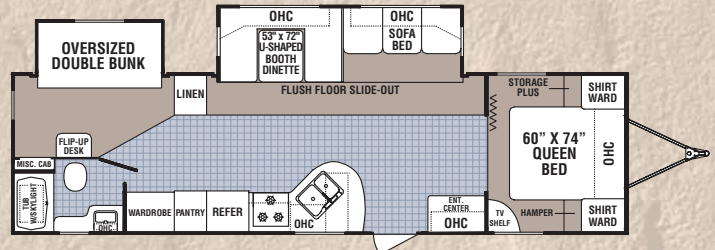

31BH-DSL

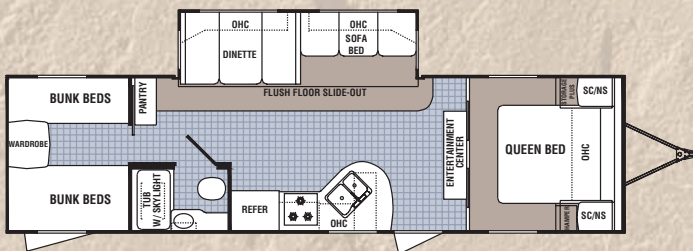

30QB-DSL

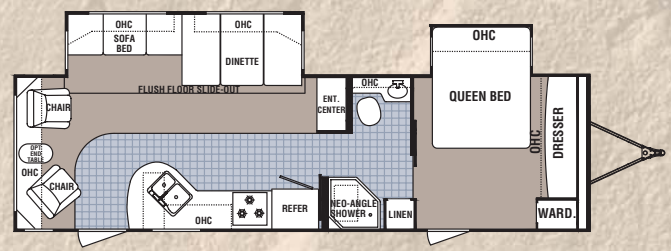

31RL-DSL

### POWER V CHASSIS

#### A TUNDRA EXCLUSIVE!

Developed exclusively for Tundra, the *Power-V* is the latest in chassis design.

The *Power-V Chassis* is designed to be lightweight while rigid to carry maximum loads. *Power-V* features a lifetime rust-through warranty with durable powder-coat over E-coat paint finish.

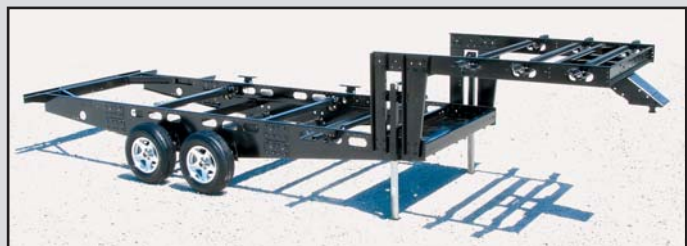



**Tundra's Super-Lite construction means larger floorplans that weigh 1000-1500 lbs. less than traditionally built RV's!**

## 2007 SUPER-LITE FIFTH WHEELS

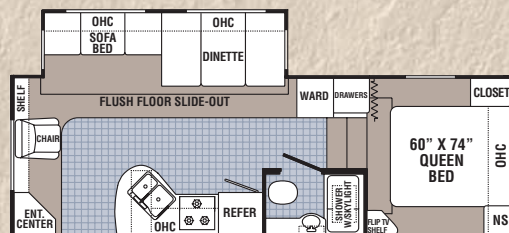

**24RL-M5**

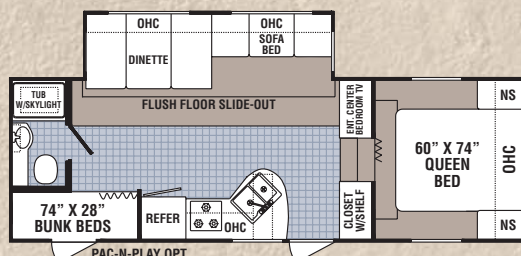

**24BH-M5** (available with Pac-n-Play storage option)

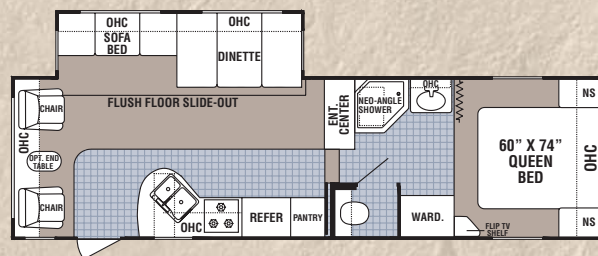

**27RL-M5**

### Travel Trailers

### Fifth Wheels

	27FB-DSL	27FK-DSLBS	30QB-DSL	30RL-SL	31BH-DSL	31RL-DSL	24BH-M5	24RL-M5	27RL-M5
*Axle Weight	4798	5306	NA	5085	5298	5644	5006	4712	5296
*Dry Hitch Weight	523	534	NA	618	733	613	1052	1089	1125
*Unloaded Vehicle Weight	5321	5840	NA	5703	6031	6257	6058	5801	6421
GVWR	7600	7600	NA	7600	7600	7600	8400	8400	8400
Cargo Capacity	2279	1760	NA	1897	1569	1343	2342	2599	1979
Exterior Length	30'4"	32'4"	35'5"	32'4"	35'5"	33'9"	28'0"	26'10"	30'6"
Exterior Width	8'	8'	8'	8'	8'	8'	8'	8'	8'
Exterior Height w/A/C	10'8"	10'8"	10'8"	10'8"	10'8"	10'8"	12'2"	12'2"	12'2"
Fresh Water Tank	46	46	46	46	46	46	46	46	46
Grey Water Tank	36	72	36	36	36	36	36	36	36
Black Water Tank	34	36	34	34	34	34	36	36	36
Tire Size	ST205/ 75R15(C)	ST205/ 75R15(D)	ST205/ 75R15(D)	ST205/ 75D15(C)	ST205/ 75D15(C)	ST205/ 75R15(C)	ST205/ 75R15(C)	ST205/ 75R15(C)	ST205/ 75R15(C)
Furnace Size	30,000	30,000	30,000	30,000	30,000	30,000	30,000	30,000	30,000

Vehicle loading – Every effort has been made to provide the greatest number of options for the recreation vehicle owner. Along with these choices comes the responsibility to manage the loads that are imposed by the choices that they remain within the manufacturer's specified chassis weight limits. Do not overload the recreational vehicle. Net carrying capacity (NCC) is determined by subtracting unloaded vehicle weight (UVW) from gross vehicle weight (GVWR) and includes fluids, options and cargo. Liquid capacities and weights are approximations only. Warning – This information is intended as a guide only. Weights of individual vehicles may vary. Consult your owner's manual for complete loading, weighing and towing instructions.

\*Axle weight, UVW and Dry Hitch Weight are base weights of units without options. Each unit includes a weight label which lists specific weight information for that unit.

Photographs may contain some features that are optional on your vehicle. Since we continually strive to improve our products, actual products may differ. Prices and specifications are subject to change without notice. All capacities are approximate and dimensions are nominal. Some features shown are optional and may be different or unavailable in Canada.



# TUNDRA

## Super-Lite Construction

### CHASSIS

1. Folding entry step – low step height for easy entry
2. Ultra-lube hubs. Grease Zerk makes wheel bearings easy to lube. Extends life of bearings
3. Rubber torsion “independent suspension” axles - the smoothest ride in the industry!
4. All tanks mounted in frame. Lowers the center of gravity, and saves valuable interior storage space
5. 46 Gallon fresh water tank. Tank design prevents water from standing in tanks during storage. One of the largest fresh water tanks in the industry!
6. Optional enclosed underbelly protects tanks and floor from the hazards of the road
7. *Power-V* lightweight chassis with durable powder-coat over E-coat paint finish
8. Twin 30 lb. LP tanks with ABS cover
9. Integrated heavy duty safety chains

### WALLS

**5-Ply construction. Fully laminated, aluminum framed construction.**

10. Tubular aluminum welded frame – reinforced around door
11. Dark tinted, safety glass radius corner windows
12. Insulated baggage doors with key locks and finger pulls
13. ABS fender skirts
14. Decorative wall board
15. *Luan* wood backer
16. High density structural foam insulation
17. *Luan* plywood backer
18. Smooth fiberglass with premium graphics package
19. Pass-through storage compartment (where available)
20. Aerodynamic front profile

### ROOF

**5-Ply construction. Fully laminated, aluminum framed construction.**

21. Tubular aluminum radius framed roof reinforced at A/C
22. *Luan* wood backer
23. One-piece EPDM rubber roof with 12 year manufacturer's material warranty
24. High density structural foam insulation
25. *Luan* wood backer
26. Decorative ceiling board

### FLOOR

**5-Ply construction. Fully laminated, aluminum framed floor structure.**

27. One-piece composite wheel wells (non-slide & SL models)
28. Residential vinyl flooring – full length of coach
29. Residential carpet with pad (most models)
30. Two layers of floor decking over aluminum frame and foam
31. High density structural foam
32. Plywood base with polypropylene waterproof vapor barrier
33. Tubular aluminum framed floor, reinforced at tanks

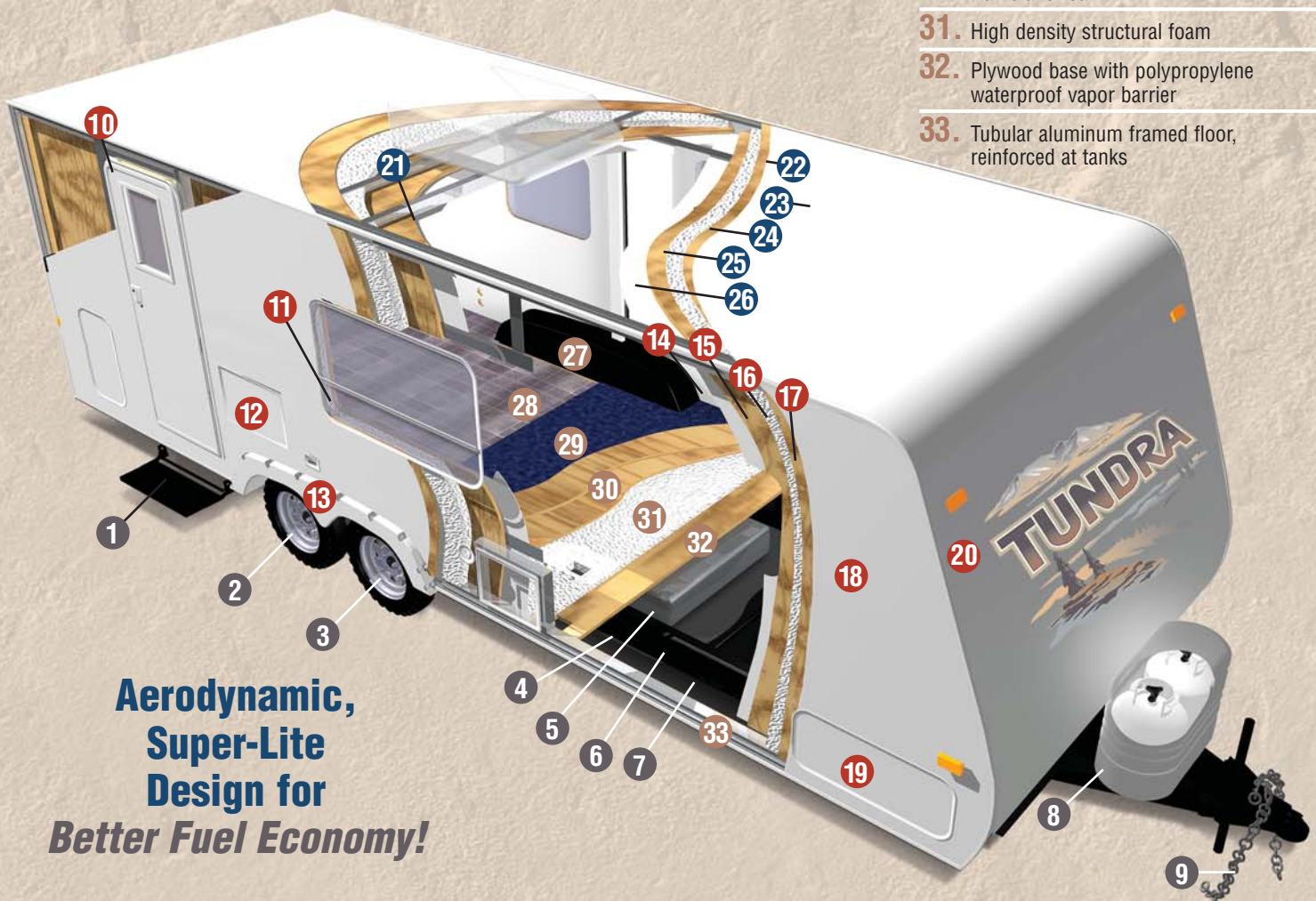

**Aerodynamic,  
Super-Lite  
Design for  
Better Fuel Economy!**



# INTRODUCING

# THULE<sup>®</sup>

SWEDEN

# SMART RV

Thule, the industry leader in cargo management systems for cars and trucks, has partnered with Tundra to create the Smart RV System. This patented system allows Tundra owners to create a functional outdoor living area that's easy to set up and enjoy.

The Smart RV system uses a number of factory-installed anchor pods mounted on the exterior of the trailer.\* The accessories mount to the pods in seconds using Thule's innovative quick-release latch system.

The optional Thule Smart RV Camping Package includes:

- Smart RV table with 2 chairs
- 2 Universal hooks
- Smart RV countertop

## Smart RV Universal Hook

Here's a great way to wrap cables and cords, hang lanterns and bug zappers, or just dry out your towels!

- 2 Universal hooks per kit
- Rugged powder-coated steel tubes
- Foam padding offers cushion and extra grip



## Smart RV Countertop

The perfect surface for a blender, a radio or anything else you've just gotta have to enjoy the great outdoors!

- Blow-molded 40" x 16" polyethylene countertop
- Support arms adjust to ensure a level table surface



## Smart RV Table and Chairs

Bring the dining room outdoors with our patented "stable table" system.

- 48" x 24" Heavy duty polyethylene table top with powder-coated adjustable legs
- (2) Camping chairs with Thule logo. Made with black, weather resistant fabric

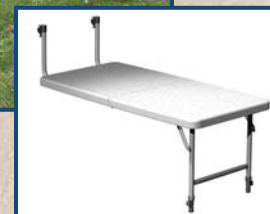

\*Thule system is for use on units built after serial number 120671.

Units include wall bracing to accept Thule Pods.

## Popular Options

### A. Surround Sound with CD/DVD Player

Upgrade your Tundra with a 5-in-1 surround sound system with CD/DVD player and a 15" LCD flat panel TV.

### B. Industry Exclusive! - AudioLite™ Speakers

Tundra features *AudioLITE*™ exterior speakers by *Intier*®. Utilizing the latest "NXT surface sound technology," *AudioLITE*™ speakers provide crisp, undistorted sound. Plus, they are impact resistant and waterproof.

### C. Diamond Plate Rock Guard

Diamond plate protects your investment from damage caused by hazards of the road.

### D. Water Heater Upgrade

Upgrade your Tundra with the six gallon gas/electric water heater with direct spark ignition (DSI).

### E. Exterior Shower

Tundra's exterior shower features hot and cold water, a quick connect coil hose and a sprayer.

### F. Exterior Grill

Take your cooking outside with Tundra's exterior barbecue grill.

### G. Bike Carrier

Tundra's easy to use bike carrier mounts on the travel trailer's "A-frame." It securely holds three adult or children's bicycles.





# TUNDRA

## STANDARD FEATURES

### Standard Exterior Features

- Super-lite aerodynamic design
- Power-V lite-weight chassis with highly durable e-coat and powder coat finish
- Rubber torsion "independent suspension" axles with 4-wheel electric brakes
- Laminated 5" crowned roof structure
- EPDM one piece seamless rubber roof
- Welded aluminum/laminated super-structure (roof, floor and walls)
- Radius corner entry door with deadbolt lock
- Composite wheel wells
- Folding entry step
- High-end designer graphics
- Rain gutters with corner downspout's
- Color ABS fender skirts
- Break-away trailer switch
- 120V exterior outlet

- Dark-tint, radius clamp ring safety glass windows
- Step light with switch
- "Storage Plus" exterior pass-through storage with light (most models)
- Two 30 lb. LP tanks with ABS cover
- Courtesy light at hitch
- Courtesy light at tank drain
- Electric slide motor
- Electric front jack (fifth wheels)

### Appliances and Electrical

- 6 Cu.ft. *Norcold* double-door gas/electric refrigerator
- 3 Burner range with "quick boil" burner and large oven
- Range hood with 12V light and exhaust fan
- Systems monitor panel
- Ducted heat
- Forced air DSI furnace with wall thermostat

- Roof ducted for A/C
- Pre-wired for A/C
- Pre-wired for stereo
- Solid state converter with built-in battery charger
- LPG/Smoke/CO detector
- Fire extinguisher
- Data/phone jack
- 30 Amp power cord with exterior storage compartment
- Demand water pump

### Standard Interior Features

- Raised panel cabinet doors
- Residential tile-like flooring
- Carpet (as shown)
- Décor wallboard with easy-clean vinyl coating
- Reversible arched back dinette seats
- Premium light fixtures
- Décor-coordinated wallpaper border
- Mini blinds throughout
- Designer window treatments

- Designer glass light over dinette table (most models)
- Premium sofa with roll-over design
- Skylight roof vents
- TV shelf/cabinet

### Kitchen Features

- Residential faucet
- Double bowl sink

### Bedroom Features

- Designer lights in bedroom
- Décor-coordinated bedspread and headboard
- Mirrored wardrobe closets

### Bath Features

- Power roof vent in bathroom
- Skylight over tub/shower
- Medicine cabinet (most models)
- Fiberlink bathtub with curtain or neo-angle shower tub
- Tub/shower surround

## OPTIONAL FEATURES

### Tundra Pack

- 13.5 BTU air conditioner with wall thermostat
- AM/FM/CD player with speakers
- A&E 8300 series awning
- TV antenna with cable prep
- Large microwave

### Other Optional Features

- Aluminum rims
- Enclosed Underbelly

- Heated holding tanks (3)
- Four corner stabilizer jacks
- Roof ladder (N/A 26RK)
- Exterior barbecue
- Exterior hot and cold spray-away station
- *Fantastic* vent
- Night shades
- Bike rack
- Water filter with spout
- 15,000 BTU roof A/C

- Stove cover
- Pac-n-Play storage compartment (where available)
- Free-standing dinette (some models)
- *AudioLite* exterior sound system with 2 speakers
- Spare tire (with carrier on DSL, cover on others)
- Exterior entry-assist handle at door
- Gas/electric water heater with DSI
- Hide-a-bed sofa

- Surround sound system with DC/DVD
- 15" Flat screen TV
- Bifold shower door
- Diamond plate front wall
- "Zero wall" recliner
- 8 Cu.ft. *Norcold* double-door gas/electric refrigerator upgrade
- *Thule* SmartRV Package



**1 YEAR BUMPER TO HITCH  
LIMITED WARRANTY**

**2 YEAR STRUCTURAL &  
APPLIANCE LIMITED WARRANTY**

\*See owner's manual for complete warranty details.

### TUNDRA

2164 Caragana Court ■ Goshen, IN 46526  
(574) 534-1224 ■ Fax: (574) 975-0556

**www.tundra-rv.com**

*Your Local Dealer:*

## Decor Choices



**Ebony**



**Island Java**



**Mulberry**



**Tuscan Mist**