

1 9 9 3

CAMPING TRAILERS

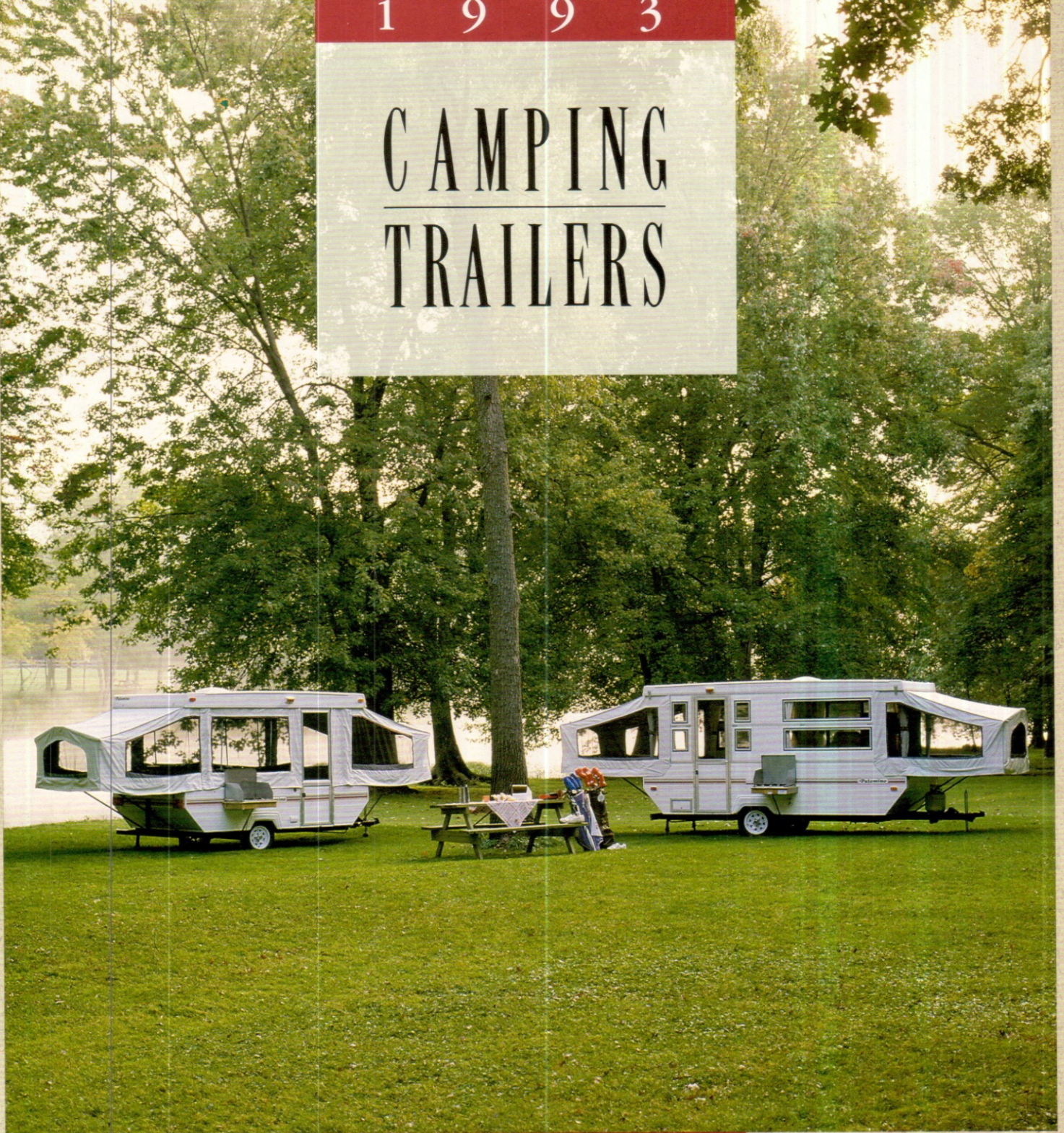

P A L O M I N O

COMFORT IN TXL AND MXL FOLD-A-WALLS

For over 18 years, Palomino has specialized in solid Fold-A-Wall construction. These handsome units combine the durability of solid sides with spacious sleeping areas protected by vinyl tent ends. This year, three different models offer affordable, comfortable camping with all the conveniences of home.

Ultra-comfortable TXL-SC models feature a standard refrigerator and a self-contained toilet with a shower. Included as standard equipment on all models are 13-inch tires, electric brakes, a mirrored screen door, four stabilizer jacks and independent suspension. An indoor/outdoor stove makes galley duty fun and a roomy wardrobe holds plenty of gear.



*TXL & MXL
Fold-A-Wall Series*



TXL-SC

MUSTANG OFFERS SPACIOUS COMFORT

More than 23 feet of interior length makes the Mustang Palomino's roomiest soft sided trailer. With a choice of three spacious, well-equipped floorplans, there's a model to suit every camping family—large or small.

Included on the long list of standard features are 13-inch tires with independent suspension, a handy indoor/outdoor three burner stove, four stabilizer jacks, lift-up port-a-potti storage, 4-inch deluxe cushions and a sturdy vinyl tent with tinted windows.



MUSTANG
Deluxe Series



MUSTANG D-D

LIGHT AND LOW PROFILE—SHETLAND AND PINTO

Even with a four-cylinder car, you can easily tow our lightweight Shetland (5-sleeper) and Pinto (6-sleeper) models. Both units weigh under 1,000 pounds and have a complete kitchen, top loading ice chest, vinyl tent, independent suspension, built-in jacks and many more camping conveniences.

These easy-towing units have a low profile, an economical price and are well equipped to make them ideal camping companions for veteran campers and first-timers, too.



**SHETLAND
& PINTO**
Light Weight Series

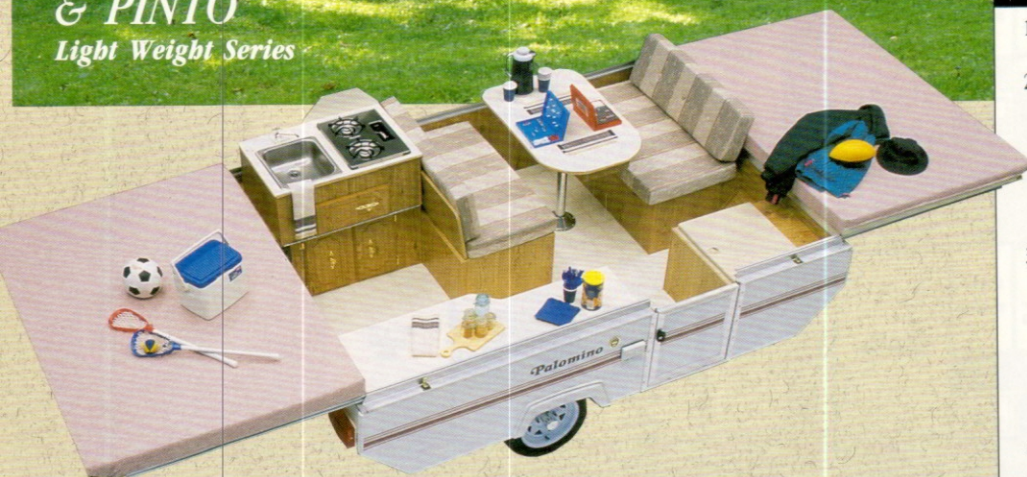

PINTO

Crank-up Lift System

1. The drive system is enclosed for protection from weather and road conditions.
2. The underneath location of the system allows for easy inspection and maintenance. Grease zerks are located top and bottom of the main tube to allow yearly maintenance.
3. A single cable capable of 3,200 lbs. tensile strength rotates around the rear cable pulley and pushes the four flexible steel push rods up the lifter posts.
4. Flexible steel push rods.
5. Three stage plated lift post.

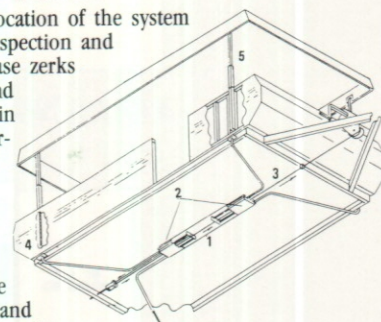

MID-SIZE FILLY AND YEARLING

Palomino's mid-sized camping trailers have four functional floorplans. Choose from Filly Long Bed or Rear Gaucho or the slightly smaller Yearling Long Bed or Front Gaucho.

Both Filly and Yearling models have a standard indoor/outdoor three burner range, independent suspension, port-a-potti storage, a top loading ice chest and a rugged vinyl tent with tinted windows. If you're looking for a lightweight, affordable tent trailer loaded with standard features, then check out these popular models for 1993.



*FILLY &
YEARLING
Deluxe Series*



FILLY RG

F L O O R P L A N S

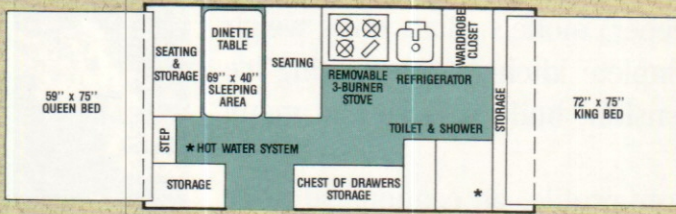

TXL-SC

Fold-A-Wall Series

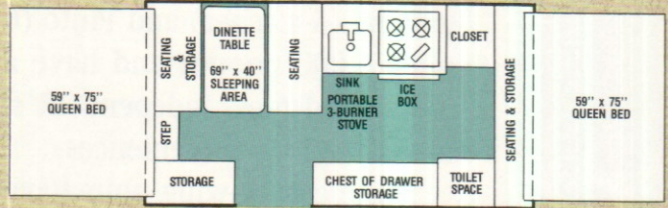

TXL-FG

Fold-A-Wall Series

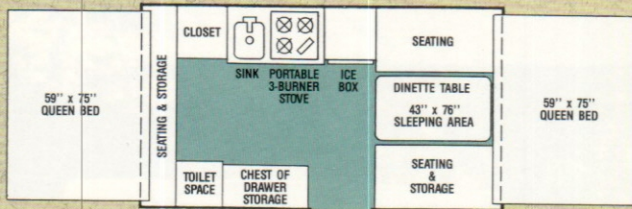

MXL

Fold-A-Wall Series

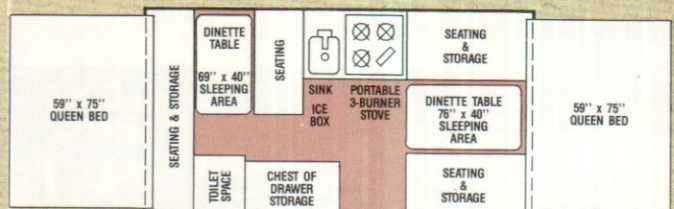

MUSTANG D-D

Deluxe Series

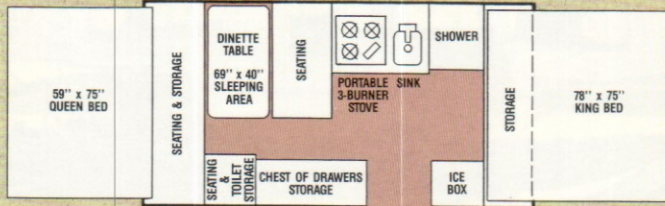

MUSTANG SH

Deluxe Series

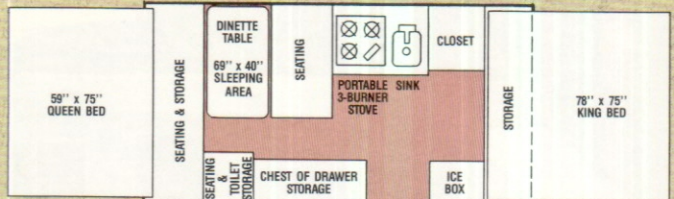

MUSTANG LB

Deluxe Series

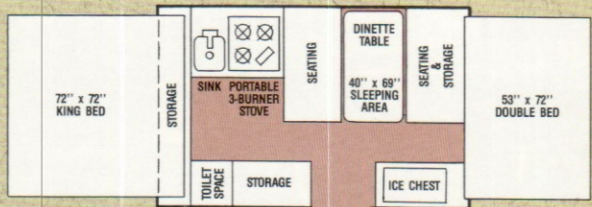

FILLY LB

Deluxe Series

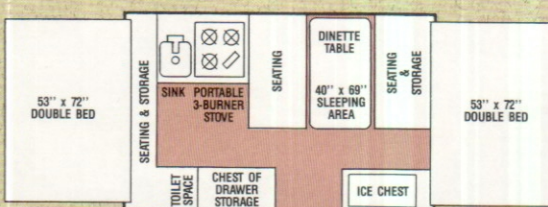

FILLY RG

Deluxe Series

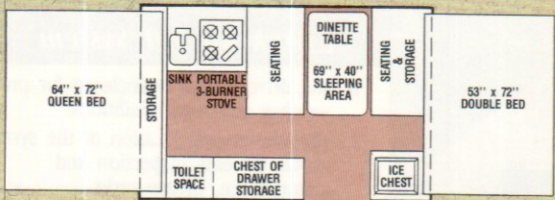

YEARLING LB

Deluxe Series

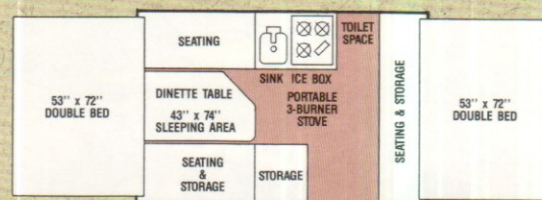

YEARLING FG

Deluxe Series

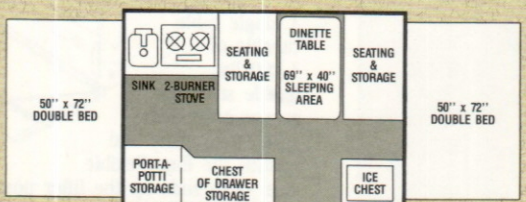

PINTO

Light Weight Series

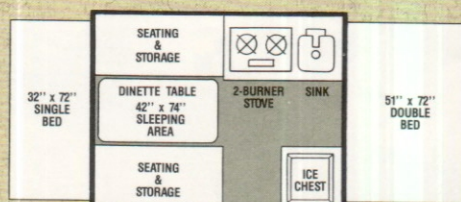

SHETLAND

Light Weight Series

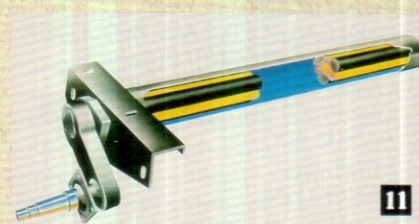

1 ATTACHABLE SCREEN ROOM - Palomino's own design and it attaches to your canopy in minutes.

2 CANOPY-IN-A-BAG - Free standing, sets up in minutes. Stores in its own vinyl bag.

3 ROOF MOUNTED AIR CONDITIONER - Available for all models except Shetland.

4 WHEELWELLS AND FLOORS - Open galvanized wheelwells allow for easy access to wheels when needed. Weyerhaeuser Structurwood® one-piece floor has limited lifetime warranty.

5 SHOWER - Includes hot water system. Standard in TXL-SC.

6 ROOF RACK - Available for all models. Includes mounting brackets. Ideal for canoes and other small boats.

7 MIRRORED SCREEN DOOR - Available for Fold-A-Wall trailers only.

8 ELECTRIC TOILET - Self-contained for your convenience and privacy. Standard in TXL-SC.

9 IN AND OUT STOVE - Have the convenience of inside or outside cooking. Available on most models.

10 REFRIGERATOR-Dometic - Two way system: LP Gas and 12-volt.

11 AL-KO Axle - Allows for independent suspension, smoother towing, 5 year limited warranty.

LIFETIME LIMITED WARRANTY - Vanguard Industries warrants a lifetime limited warranty to the original owner for: Lifter Systems, Beds, Frames and Floors. **TENT WARRANTY** - Vinyl Tents manufactured by Vanguard Industries are warranted for 5 years to original owner. Free from defects in materials and workmanship under normal use and service.

MODEL	Fold-A-Wall Series			Deluxe Series			Light Weight Series	
	TXL-SC	TXL	MXL	MUSTANG	FILLY	YEARLING	PINTO	SHETLAND
CLOSED BODY	6'9" X 13'5"	6'9" X 13'5"	6'9" X 12'5"	6'9" X 13'5"	6'6" X 11'8"	6'6" X 10'5"	6'6" X 9'	6'4" X 6'10"
CLOSED OVERALL	6'10" X 16'6"	6'10" X 16'6"	6'10" X 15'5"	6'10" X 16'6"	6'7" X 14'8"	6'7" X 13'5"	6'7" X 12'4"	6'7" X 10'4"
CLOSED HEIGHT	54½"	54½"	54½"	51"	48"	48"	43"	42"
OPEN LENGTH	23'6"	23'6"	22'9"	23'4"	20'6"	19'3"	17'7"	14'2"
OPEN HEIGHT	6'5"	6'5"	6'5"	6'3"	6'3"	6'3"	6'5"	6'3"
HITCH WEIGHT - POUNDS	180	175	195	160	145	130	120	105
AXLE WEIGHT - POUNDS	1,810	1,715	1,525	1,430	1,170	1,125	875	700
TIRE SIZE	13"	13"	13"	13"	10"	12" STD 10" OPT	8" STD 12" OPT	8" STD 12" OPT
SPARE TIRE	0	0	0	0	0	0	0	0
SPARE TIRE COVER	0	0	0	0	0	0	0	0
SPARE TIRE MOUNT AND BUMPER	S	S	S	S	S	S	0	0
ELECTRIC BRAKES	S	S	S	0	0	0	0	0
TORSION AXLE	S	S	S	S	S	S	S	S
OPEN WHEEL WELL	S	S	S	S	S	S	S	S
WATER TANK - GALLON CAPACITY	16	10	10	10	10	10	5	5
CITY WATER HOOKUP	S	S	S	S	S	S	S	S
HOT WATER SYSTEM	S	0	0	0	—	—	—	—
SHOWER AND TOILET	S	—	—	—	—	—	—	—
DOMES LIGHTS	S	S	S	S	S	S	S	S
9-AMP 12-VOLT POWER CONVERTER	25-AMP	S	S	S	S	S	S	S
110-VOLT OUTSIDE RECEPTACLE	S	S	S	S	S	S	S	—
LP/12-VOLT REFRIGERATOR	S	0	0	0	0	0	—	—
ICE CHEST	S	S	S	S	S	S	S	S
3-BURNER STOVE	S	S	S	S	S	S	(2)	(2)
IN/OUT STOVE	S	S	S	S	S	S	0	—
20-LB GAS BOTTLE AND REGULATOR	S	S	S	S	S	S	S	S
12,000 OR 16,000 BTU FURNACE	0	0	0	0	0	0	0	0
LAMINATED CONSTRUCTION	S	S	S	S	S	S	S	S
ONE-PIECE UNDERCOATED FLOOR	S	S	S	S	S	S	S	S
RADIUS ROOF	S	S	S	S	S	S	S	—
ROOF VENT	S	S	S	S	S	S	S	—
AWNING RAIL	S	S	S	S	S	S	S	—
FRONT BED AREAS	72"	FG-60"	60"	DD-59" LB 78"	53"	53"	50"	51"
REAR BED AREAS	60"	60"	60"	59"	LB 72" RG 53"	LB 64" FG 53"	50"	32"
DELUXE CUSHIONS AND MATTRESSES	S	S	S	S	S	S	S	S
WINDOW CURTAINS	S	S	S	S	0	0	0	0
BED END CURTAINS	0	0	0	0	0	0	0	0
VINYL TENT	S	S	S	S	S	S	S	S
SPRING LOADED LIFT ARMS	—	—	—	—	—	—	—	S
CRANK LIFT SYSTEM	S	S	S	S	S	S	S	—
ROOF READY FOR AIR CONDITIONING	0	0	0	0	0	0	0	—
SLIDING STEP OR DELUXE STEP	0	0	0	0	0	0	0	0
CLOTHES RACK & SILVERWARE DRAWER UNDER TABLE	S	S	S	S	S	S	S	S
MIRRORED SCREEN DOOR	S	S	S	—	—	—	—	—
PATIO LIGHT	S	S	S	S	S	S	S	S
STAINLESS STEEL SINK	S	S	S	S	S	S	S	S
FIRE EXTINGUISHER	S	S	S	S	S	S	S	S
CANOPY IN A BAG	0	0	0	0	0	0	0	—
DELUXE SCREEN ROOM	0	0	0	0	0	0	0	—
STONE SHIELD	S	S	S	S	S	S	S	—

S=STANDARD 0=OPTIONAL —=NOT AVAILABLE

ALL PALOMINOS BUILT TO COMPLY WITH RV CODES, AND AMERICAN NATIONAL STANDARDS INSTITUTE REGULATIONS. SPECIFICATIONS SUBJECT TO CHANGE WITHOUT NOTICE. SPECIFICATIONS IN THIS BROCHURE ARE BASED ON INFORMATION AT TIME OF PUBLICATION. VANGUARD INDUSTRIES OF MICHIGAN, INC., RESERVES THE RIGHT TO MAKE CHANGES IN MATERIALS, COMPONENTS AND SPECIFICATIONS AND TO DISCONTINUE MODELS AT ANY TIME WITHOUT NOTICE OR OBLIGATION. DEPENDING ON MATERIALS FROM TIME TO TIME, WEIGHTS MAY VARY PLUS OR MINUS FIVE PERCENT.



Palomino

Established in 1968
VANGUARD INDUSTRIES
OF MICHIGAN, INC.
Colon, Michigan 49040
Phone (616) 432-3271