

1973 model year brochure before '73½ revision

**MINNIE WINNIE...FLYING W QUALITY IN A MINI MOTOR HOME!**

**WINNEBAGO**  
**We give you more.**





# Here it is! The 1973 Minnie Winnie



A new addition to Winnebago's line of recreational vehicles. A mini motor home with Winnebago quality at a reasonable price. A solid, dependable value-packed motor home built and backed by the world's largest producer of recreational vehicles.

Check inside. Check the roomy self-contained features we've designed and built in this Winnebago newcomer. Not added on as options.

You'll find sleeping room for five with optional bunk plus a complete kitchen with 3-burner gas range, a 4 cubic foot gas/electric refrigerator, a power stove unit, and stainless steel sinks.

Two floor plans from which to choose. Take your pick of three interior color schemes . . . cactus, sunflower, or tangerine. All blend handsomely with the wormy pecan vinylface paneling and designer furnishings. The bath has a built-in lavatory, molded fiberglass tub and shower, marine type toilet, medicine cabinet and power roof vent. Plus, you'll find a number of thoughtfully designed features with the unmistakable stamp of Winnebago quality.

The Minnie Winnie offers a dependable Dodge chassis with dual rear wheels. Men will appreciate the rugged performance of the 360 cubic-inch engine. Women will like the automatic transmission, power steering, and power brakes that make driving easier wherever you travel. Every buyer will be glad to know these are standard features on the entire Winnie Minnie line-up.

Go ahead. Test drive the new Minnie Winnie. See for yourself why this newest member of the Winnebago fleet provides an ideal way for the budget-minded family to see America!



## CHOOSE FROM TWO MINNIE WINNIE FLOOR PLANS!

One good turn deserves another. We were so certain that the travel crowd would "go" for our new mini motor home that we decided to offer — not one — but two floor plans for the 1973 Minnie Winnie.

First came the MW-RB . . . a lot of living in a small package. It features a good-sized kitchen, galley, facing dinette that converts into sleeping space (with a bunk above), plus an even larger overhead bed up front, and plenty of cabinet storage. But the real eye-catcher in the MW-RB is a delightful, man-sized bath at the back of this unit. Built-in lavatory. Molded fiberglass bathtub. Flexible phone head shower. Marine type toilet. Power roof vent. Medicine cabinet. Who says you have to sacrifice convenience in a mini motor home?

Same thing with the MW-RG. This running mate to the MW-RB is an identical look-a-like from the outside, but it's what you see inside that makes all the difference. Our designers changed the configuration to include an inviting gaucho that stretches across the rear section of the MW-RG. A comfortable bed by night . . . a relaxing sofa by day. And, yet we still offer the dinette which converts into sleeping quarters plus the front overhead bunk. Great for the family who needs more space. The bath's up front. The galley includes a 3-burner range and sizeable 4 cubic-foot refrigerator.

The overall effect? An excitingly different application of Winnebago's more value conveniences . . . so pleasingly incorporated into these two new mini motor homes. Take a look before you buy. Remember the name . . . Minnie Winnie from Winnebago!

### GUIDE TO MINNIE WINNIE FLOOR PLANS

(1) Mini shag carpet (2) Bunk over drivers compartment (3) Dinette (4) Stainless steel sink (5) Stove and oven (6) Refrigerator (7) Shower or tub and shower combination (8) Lavatory (9) Toilet (10) Swivel Lounge

MINNIE WINNIE RB

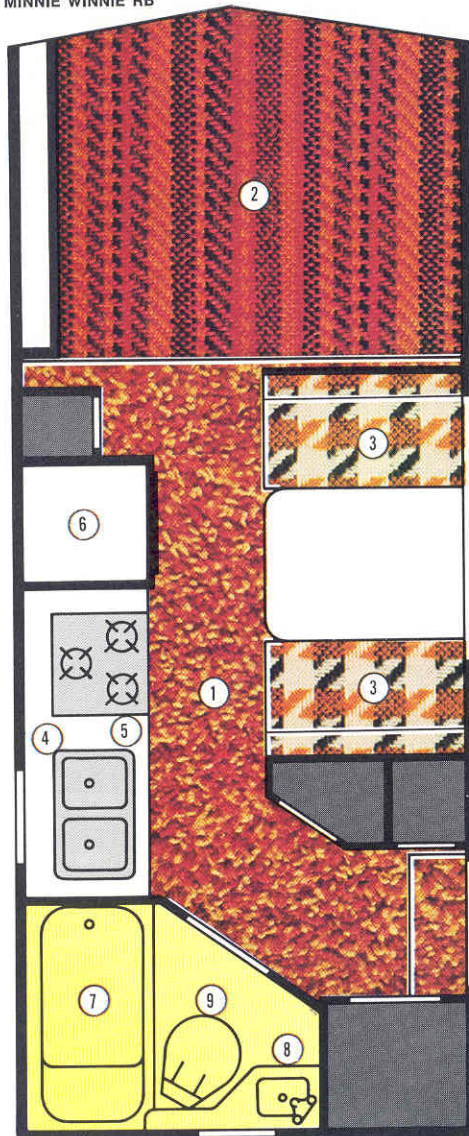

MINNIE WINNIE RG

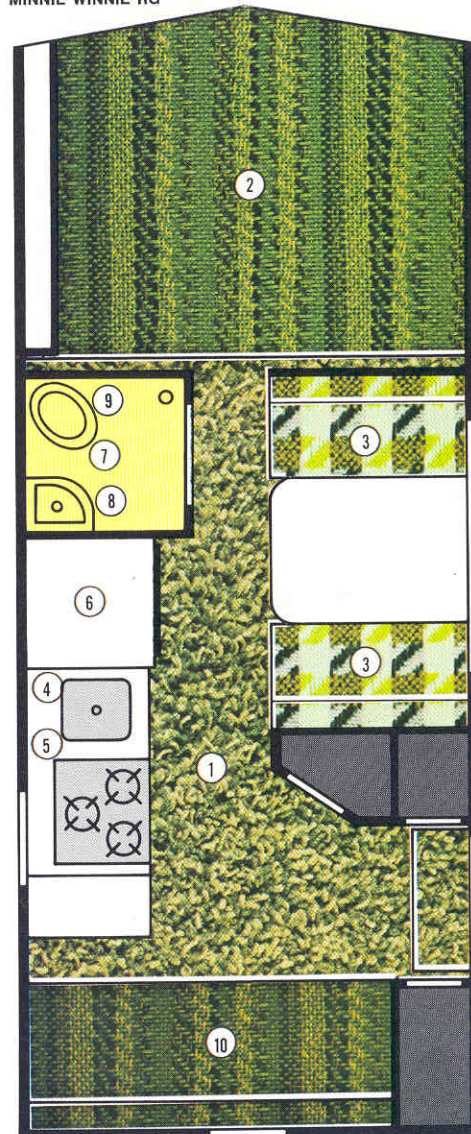

SPECIFICATION: MINNIE WINNIE RG & RB: 19' 9" Long / 7' 10" Wide / Height 9' 10" / Weight 6,460# / Dodge MBH 300 Chassis / 127" W.B. / 8.00 x 16.5 (6 ply) Front Tires / Dual Rear Tires / 60 Amp Alternator / 70 Amp-Hour Battery / 2nd 70 Amp-Hour Auxiliary Battery / 360 Cu. In V-8 Engine / 245 H.P. / Automatic Transmission / Power Steering / Power Brakes



# STANDARD EQUIPMENT FOR MINNIE WINNIE

## Automotive Features:

Dodge V-8, 360 cubic-inch engine / Automatic transmission / Power steering / Power brakes / 60 amp alternator / Twin 70-amp batteries / 25 gallon gasoline tank /

## Driver's Compartment:

Arm rests for driver and front passenger / Ash tray for driver's compartment / Glove box door and light / Sunvisors / Deluxe high-output automotive heater / Interior rear view mirror / Windshield washers and electric wipers / Tinted safety glass on all windows (including windshield) / Twin outside rear view mirrors /

## Kitchen Features:

Stainless steel galley sink (1) Deluxe 3-burner LP gas range with oven / Power stove vent (2) 4 cubic-foot gas/electric refrigerator /

## Livability Features:

16,000 BTU forced air furnace / Carpeting in the living area / 30 gallon demand water system / 6 gallon water heater / Built-in lavatory in the bath / Molded fiberglass bathtub / Flexible phone head shower / Marine type toilet / Shower curtain / Power roof vent in bathroom (in ceiling) / Medicine cabinet in bathroom / 21 gallon holding tank / 12 volt/110 volt converter / Seven 12-volt lights / Roomy wardrobe / Full length wardrobe mirror inside door / Overhead cabinets have magnetic door catches / Full-length vinyl, driver blackout curtain / Dinette makes into 74" x 39" bed / Overhead bed size, 84" x 58" / Twin 20 lb. LP gas bottles / Outside luggage compartment / 25' 110-volt power cord entrance / Fire extinguisher / Radius cornered windows /

Take your pick of three interior color schemes . . . tangerine, cactus or sunflower.

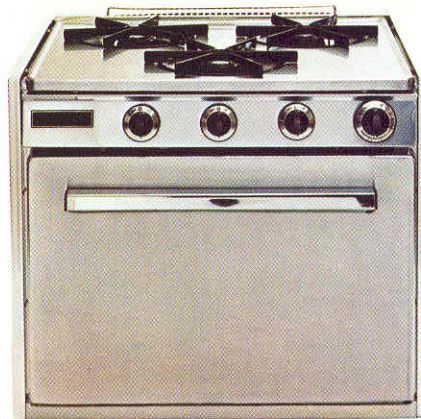



# OPTIONAL EQUIPMENT FOR MINNIE WINNIE

For your shopping convenience, we've added a quick-glance chart. It works like this. Suppose you've decided to buy the basic Minnie Winnie RB, and now you're thinking about what extras you might want to add. Look at the color chart under the M.W.-R.B. heading. You'll see six color categories (each with a different letter) representing six option packages available.

For example, read down the orange "B" column. If there's an orange color block "B" corresponding to the accessory item described on the left margin, it means that item is available and offered as part of the orange package (a white blank space means it's not available). Buy orange and you get all the options shown in orange, and you can buy more than one package.

Option package A — Option package B — Option package C — Option package D  
Option package E — Option package F

OPTIONAL EQUIPMENT	MINNIE WINNIE RB OPTION PACKAGE						MINNIE WINNIE RG OPTION PACKAGE					
	A	B	C	D	E	F	A	B	C	D	E	F
<b>INTERIOR</b>	A	B	C	D	E	F	A	B	C	D	E	F
Twin bunk - right side	A		C		E							
6 Cu. Ft. refrigerator	A	B	C	D			A	B	C	D		
10,000 BTU Roof Air (1 unit)	A	B					A	B				
AM Radio	A	B	C	D	E	F	A	B	C	D	E	F
<b>EXTERIOR</b>	A	B	C	D	E	F	A	B	C	D	E	F
Auto LP Regulator — Std. w/30# and 40# tanks	A	B	C	D			A	B	C	D		
Screen door	A	B	C	D	E	F	A	B	C	D	E	F

Optional equipment items listed are available for purchase individually or in combination with any of the option packages or convenience groups.

## Interior:

Bunk Ladder  
12,000 BTU Roof Air (1 unit) ③  
Water Conditioner  
Chemical Toilet  
Automotive Air

## Exterior:

Battery Charger  
w/voltage converter

## Spare Tire (1)

Snow Tires (4)

TV Antenna ④

Luggage Rack and Ladder ⑤

Undercoating

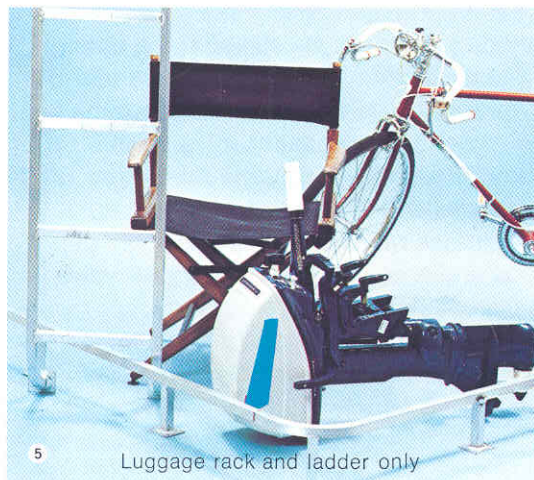
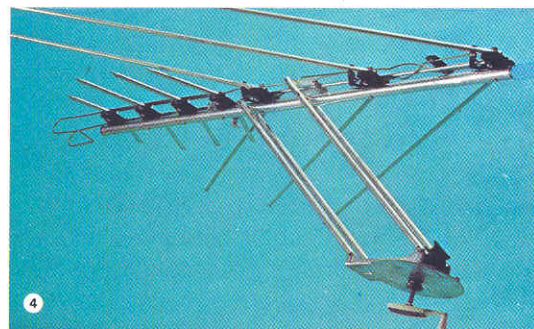
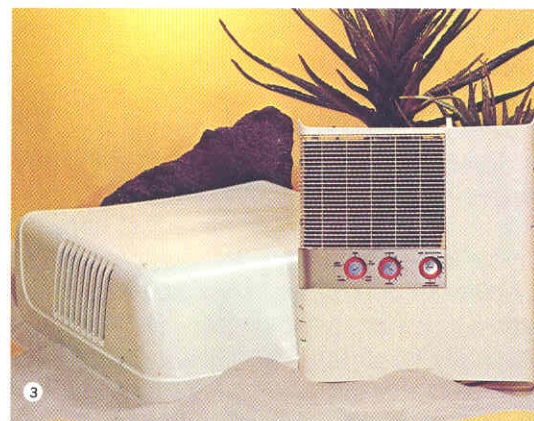

Luggage rack and ladder only



# WINNEBAGO WARRANTY

Winnebago Industries, Inc., warrants each new Winnebago Motor Home (excluding chassis, 110 volt power plant, and tires), Travel Trailer (excluding tires), or Camper Coach to the original purchaser as follows:

- For the lifetime of the unit—Winnebago Industries' exclusive "Thermo-Panel" Construction is warranted against defects in lamination for the lifetime of the Winnebago Motor Home Body, Travel Trailer, or Camper Coach.
- For the period of one year from the date of purchase — air compressor, air conditioner (auto), air conditioner (roof), antenna, axles (TT), auxiliary battery (MH), battery (TT), brake assembly (TT), converter, speed control, demand pump, furnace, hitch (TT), LP gas bottle(s), power range hood, pre-finished paneling, range, radio, refrigerator, sink, stereo, vacuum cleaner, gauges, water conditioner, toilet, and water heater.
- For the period of 90 days from the date of purchase — carpet, cushion foam, compartment doors, drainage hose, driver and passenger seats, electrical systems, cushion fabric, fire extinguisher, plastic refrigerator interior box, faucets, light fixtures, plumbing system, switches, shower door, shower head, vinyl, jack (MH), sealants, LP gas valves, and windows.

Any part of the Winnebago Motor Home, Travel Trailer or Camper Coach subject to this warranty, which is found to be defective in material or workmanship, will be repaired or replaced at Winnebago Industries' option, by the selling dealer without charge for parts or labor. If the selling dealer has ceased to do business as an authorized Winnebago dealer or the owner is traveling or has moved to a different locality and cannot return to the selling dealer, the owner may obtain warranty repairs or replacement at any authorized Winnebago Dealership.

Winnebago Industries, Inc., cannot, however, and does not accept any responsibility in connection with any of its Motor Homes, Travel Trailers, or Camper Coaches when they have been altered outside of its own factory. If the purchaser shall use or allow to be used in the Motor Home, Travel Trailer or Camper Coach, equipment and/or parts not made or supplied by Winnebago Industries, Inc., then this warranty shall become void, if failure is a result of improper installation or adaption.

Winnebago Industries, Inc., does not undertake responsibility to any purchaser of its products for any undertaking, representation or warranty made by dealers selling its products beyond those herein expressed.

This express warranty is the only warranty applicable to the Winnebago Motor Home, Travel Trailer, or Camper Coach and is expressly in lieu of any warranties otherwise implied by law (including but not limited to implied warranties of merchantability or fitness for any particular purpose). The remedies available under this express warranty shall be the only remedies available to the purchaser-user with respect to defects in materials or workmanship.

Without regard to the alleged defect, Winnebago Industries, Inc., under any circumstances, does not assume any responsibility for loss of time, inconvenience or other consequential damage including, but not limited to, expense for gasoline, telephone, travel, lodging, loss or damage to personal property or loss of revenue.

Winnebago Industries, Inc., reserves the right to make changes in design and changes or improvements upon its products without imposing any obligation upon itself to install the same upon its products theretofore manufactured.

It is the obligation of each Winnebago dealer to provide full service for owners of Winnebago Motor Homes, including Winnebago installed and/or approved components as to all aspects of said products. If the dealer is unable to provide said service at his place of business, the dealer will, at his own expense, secure said service for you from other firms authorized to service the various components in your Winnebago Motor Home.

Winnebago Industries, Inc., offers much, much more for your recreation vehicle investment. A complete line of outstanding products is offered through the nation's largest network of dealers. Winnebago commands an enviable reputation for product availability, quality workmanship, service, and value. You'll find authorized dealers from coast to coast.

Winnebago is a publicly owned company and in 1970 began trading its stock on the New York Stock Exchange, Pacific and Midwest Stock Exchanges. All products are backed by a financially strong and well-respected company that continues in its role as the industry leader.

*Due to continued product improvement, all descriptive and pictorial representations of the products in this brochure are believed to be current at the time of publication. However, due to changes in suppliers, design and production, accuracy cannot be guaranteed. Therefore, equipment, colors, material specifications, and model availability are subject to change without notice. Please contact your authorized Winnebago dealer for current model specifications.*

**WINNEBAGO**  
AUTHORIZED DEALER

Cover photo taken at Links Landing  
on Lake-of-the-Ozarks, Mo.

Winnebago Industries, Inc., Forest City, Iowa 50436

Printed in U.S.A.

Copyright 1972