

Sea Breeze

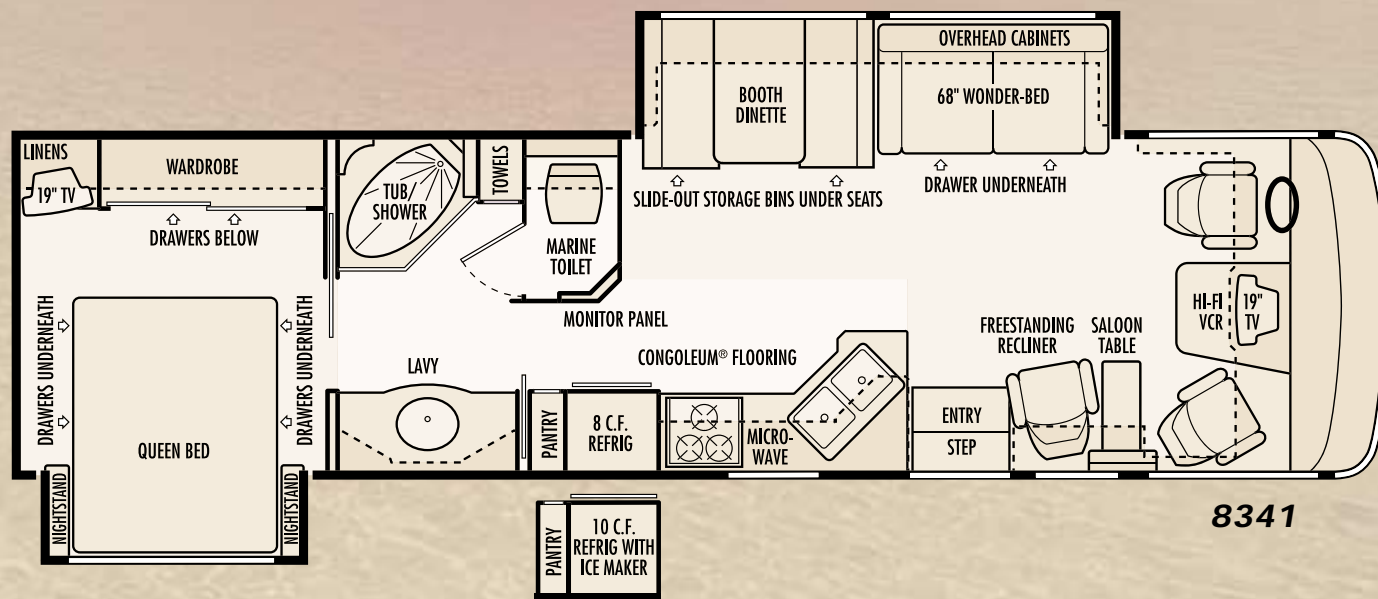
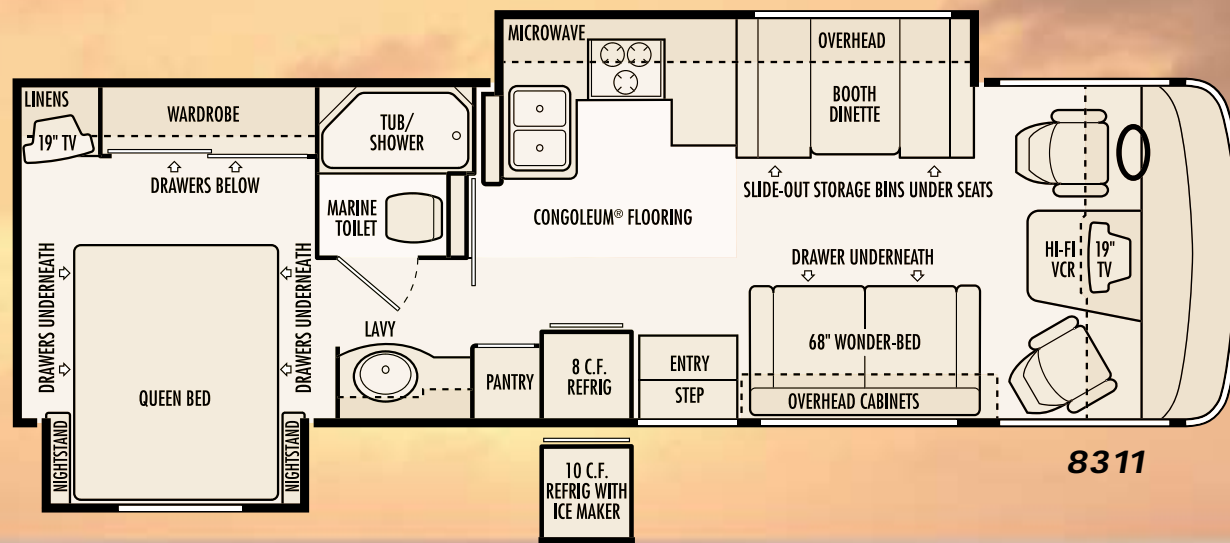

Due to continued product improvement, National R. V., Inc. reserves the right to change materials, colors, specifications and prices at any time without notification. Copyright © 2002 by National R. V., Inc. 07/02

SEA BREEZE LX FEATURES & SPECIFICATIONS

CHASSIS SPECIFICATIONS		FORD
Chassis	Ford® Super Duty (22,000 GVWR)	
Tires	Goodyear® RV 245/70R 19.5F	
Wheels	19.5X6, 8-Lug Steel, SS Liner	
Brakes	Hydro-Boost, 4-Wheel Disc ABS	
Drive Axle gear Ratio	5.38:1	
Alternator	115 Amp	
Chassis Batteries	(1) 750 CCA	
Shock Absorbers	Ford® Factory Installed Shock Absorbers	
Fuel Capacity	75 gallon	
Hitch Capacity	5,000 lbs. Class III	
Chassis Warranty	3 years/36,000 miles	
Engine	Ford® Triton V-10	
Displacement	6.8 Liters (415 cu. in.)	
Peak Horsepower	310 HP @ 4,250 RPM	
Peak Torque	425 ft./lbs. @ 3,250 RPM	
Engine Warranty	3 years/36,000 miles	
Transmission	Ford® 4R100	
Transmission Type	4-Speed Automatic Overdrive	
Transmission Warranty	3 years/36,000 miles	

BODY CONSTRUCTION

Duraframe® patented steel sub floor construction
Steel framed laminated floor
Steel framed crowned laminated fiberglass roof
Steel framed laminated fiberglass high gloss walls
Front and rear molded fiberglass caps
High impact Centrex® front and rear bumpers
Full panoramic tinted windshield
Soft fabric ceiling material
Electric slide-out room with overhead cabinets
High impact Centrex® exterior storage compartment doors with integrated latches and gas struts
One-piece rotocast polyethylene storage compartments
Lighted storage compartments and service area
Exterior assist handle
Aluminum rear ladder
Awning rail/rain gutter with drip spouts
Automotive undercoating as required
Steel insulated front bulkhead
Custom vinyl exterior graphics

COCKPIT FEATURES

JVC® AM/FM stereo and CD with four speakers
Driver and passenger gooseneck reading lights
Custom dash in gray matte diamond brush finish with full gauge package
Convenience tray
Audible turn signals
Pantographic windshield wipers
Power steering
Cruise control
Tilt steering wheel
Rear vision system with built-in microphone

Power heated rear view mirrors with double convex
Passenger work station with 12V/120V receptacle in console
Aviation style sun visors
Hydraulic leveling jacks with dash mounted controls
Generator hour meter and auxiliary start switch on dash
Wraparound privacy curtain with easy reach wand
CB radio ready

APPLIANCES & ACCESSORIES

Multi-speaker TV sound
8 cu. ft. double door refrigerator
High output three burner cook top with flush mount Corian® range cover
Over-the-counter mount microwave with built-in range hood, lights and fan
Systems monitor panel
Cable TV hook-up and multiple telephone jacks
TV antenna
RCA® 19" TV with front A/V jacks in cockpit
RCA® Hi-Fi VCR in cockpit
RCA® 19" TV with front A/V jacks in bedroom
Video control box with antenna booster

FURNITURE

Kustom Fit® fabric driver recliner seat with swivel base
Kustom Fit® fabric passenger recliner seat with swivel base
Kustom Fit® Wonder-Bed® fabric sleeper sofa with slide-in armrests and drawer underneath (74" for 8311; 68" for 8341)
Freestanding Kustom Fit® fabric swivel recliner chair with footrest (8341)

INTERIORS

Throughout Coach

Maple paneling and doors
Telestrut hardware on overhead doors and positive catches on others
Drawers with ball bearing roller guide design

Cockpit Area

Floormats

Living Area

Booth dinette with slide-out storage drawers
Day/night shades with designer valances
Solid raised panel overhead cabinet doors and flat panel base cabinet doors

Kitchen Area

Corian® kitchen countertop with Corian® flush mount stove cover (angled galley on 8341)
Porcelain sink with wood cutting block sink cover
Wastebasket
Armstrong® vinyl flooring
Venetian mini-blind with valance (8341)

Bath Area

Armstrong® vinyl flooring
Decorative shower glass etching

Flat panel doors
Laminate lavy top with woodgrain edge
Medicine cabinet
Towel bars
Residential doorknob for toilet room door

Bedroom Area

Deluxe nylon carpet and pad
Venetian mini-blinds with valances
Flat panel doors
Cedar lining in wardrobe
Wardrobe with mirrored sliding doors
Color coordinated bedspread, pillows and shams
Radius padded headboard
Slide-out queen bed with four pull out drawers and storage compartment
"Sandpiper Deluxe" residential-style pillow top mattress
Laminate top nightstands with woodgrain edge
Residential style closet rods

ELECTRICAL SYSTEMS & LIGHTS

50 Amp MagneTek® power converter and charger
50 Amp 120V distribution panel and cord
Onan® Marquis Gold™ 5.5 kW generator
Two 6V deep cycle house batteries
Battery disconnect switch for house batteries
Porch light with interior switch
110V patio receptacle
Recessed fluorescent lights in ceiling
Designer lights in living and bedroom areas
Cosmetic light in bathroom
Two water pump switches (kitchen and bath)
GFI protected electrical circuit
Courtesy light at entry-door switch panel

PLUMBING & LPG SYSTEMS

Coach Exterior

Heated systems compartment with easy access to hook-ups
On demand water system and water pump
Holding tank rinse system (black tank only)
Manual dump valves
Winterization antifreeze inlet to pump
Outside shower
Water heater by-pass valve
Pressurized water fill
Six gallon LPG water heater with electric ignition (DSI)

Kitchen Area

Delta® single lever chrome faucet with side sprayer

Bath Area

One-piece fiberglass tub/shower
Residential single lever pressure balancing shower faucet with fixed head
Single lever brass faucet with crystal handle

SAFETY FEATURES

Extra large double convex rear view mirrors

Driver and passenger three point lap and shoulder seatbelts
Deadbolt lock on entry door
Fire extinguisher
Smoke, carbon monoxide (CO) and LPG detectors
Egress window

WINDOWS, DOORS & AWNINGS

Radius tinted safety glass windows (sliding windows in living area and jalousie windows in kitchen and bedroom)
Radius entrance door with clear glass, shade and screen door
Power double entrance step with light and anti-skid
Ventilated windows on sides of slide-out rooms (lounge slides only)
Slide-out rooms topper awnings*
Tinted skylight in bathroom (8341)

VENTILATION

Thermostatically controlled dual 13,500 BTU ducted roof A/Cs
35,000 BTU electronic ignition furnace
Ducted heating system
12V roof exhaust fan in bathroom
Dash automotive heating and A/C system with defroster

OPTIONAL FEATURES

Coach Exterior

Dual pane windows
Manual patio awning with metal cover*

Cockpit Area

Pioneer® AM/FM stereo with CD player, XM receiver and remote control
RCA® DVD player
JVC® multi-disc CD changer (for use with JVC® receiver)
Pioneer® multi-disc CD changer (for use with Pioneer® receiver)
400 watt inverter
Kingdome® automatic stationary satellite dish

Living Area

Freestanding dinette table with four low-back wooden chairs (8341)

Kitchen Area

10 cu. ft. double door refrigerator with icemaker (with pantry)
21" high output three-burner range with oven (surface mounted)
Corian® countertop extension
Convection microwave oven with carousel, built-in light and fan
Variable speed 12V Fan-Tastic® Vent

WEIGHTS (POUNDS)	8311	8341
Ford Chassis		
Gross Vehicle Weight Rating	22,000 lbs.	22,000 lbs.
Gross Combined Weight Rating	26,000 lbs.	26,000 lbs.
Front Gross Axle Weight Rating	7,000 lbs.	7,000 lbs.
Rear Gross Axle Weight Rating	15,000 lbs.	15,000 lbs.
Unloaded Vehicle Weight	15,840 lbs.	16,820 lbs.
Maximum Carrying Capacity	6,160 lbs.	5,200 lbs.
Cargo Carrying Capacity	4,851 lbs.	3,700 lbs.
MEASUREMENTS		
Wheelbase	208"	228"
Overall Length	31' 8"	34' 11"
Exterior Height (Road Height)	11' 9"	11' 9"
Exterior Height (with Satellite)	11' 11"	11' 11"
Interior Height	79½"	79½"
Interior Width	98½"	98½"
Exterior Width	102"	102"
TANK CAPACITIES		
Water Heater (Gas/Electric)	6 gal.	6 gal.
Gray Tank	40 gal.	50 gal.
Black Tank	40 gal.	50 gal.
Fresh Water Tank(s)	67 gal.	90 gal.
LPG Tank (Volume W.C.)	24.2 gal.	24.2 gal.

*Not available on CSA units

Due to continued product improvement. National R. V., Inc. reserves the right to change materials, colors, specifications and prices at any time without notification. Copyright © 2002 by National R. V., Inc. 10/02