

# 2012 REGENCY GT24



Freedom Awaits.



The image shows the interior of a motorhome with a warm, wood-paneled design. On the left, a large flat-screen TV is mounted on a wooden cabinet, displaying a scenic mountain landscape. Below the TV, a small magazine rack holds several publications. The floor is covered in large, square, light-colored tiles. In the center, a round, dark-colored table is supported by a black pedestal. On the table, there is a white pitcher, a yellow mug, a glass of orange juice, and a bowl of food. To the right of the table is a curved, cream-colored leather sofa with a brown textured throw blanket. The walls are finished with light-colored wood paneling and feature two framed pictures of trees. The ceiling has several recessed lights and a central air vent. In the background, a kitchen area with wooden cabinets and a sink is visible.

## FREEDOM AWAITS

They say that good things come in small packages, and at 24', this motorhome proves it's true! From front to back, you'll find that every available space has been carefully designed to ensure you maintain all the luxuries of a larger RV, while offering exceptional maneuverability on the highway or in the city. Treat yourself to the gift of freedom today!

ALL PHOTOS: 2012 Regency GT24MB shown in Natural Clay Décor.





**www.tripleerv.com**  
For more photos, videos, virtual tours & more.



At night, convert the living area to this beautiful sleeping space by lowering the Murphy Bed onto the base created by folding down the dinette. You're sure to enjoy a great night's rest on the comfortable 60" x 80" queen bed.



Throughout the GT24 you will find many features that would normally only be found in much larger coaches. The large 26" LED TV, 7 Cu. Ft. Fridge/Freezer and spacious wardrobe are just a few examples of this.



Savour the offerings of this fully equipped galley, complete with 3 burner glass top cooktop and convection microwave.



You are sure to feel right at home in the GT24's lavatory which features a large shower with skylight, offering the comforts and size of a residential shower.

## FLOORPLAN

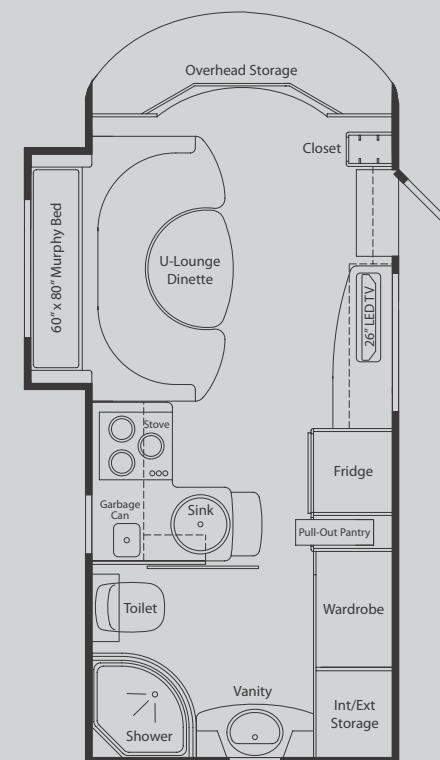

**GT24MB**

## 2012 REGENCY GT24 STANDARD AND OPTIONAL EQUIPMENT

### SPECIFICATIONS

GT24MB	
GVWR - lbs. (kg)	14500 (6579)
Wheelbase - in. (mm)	167" (4242)
* Length Not Incl. Spare - ft. (mm)	24' 6" (7467)
Width - ft. (mm)	7' 11" (2420)
Exterior Height Inc. A/C - ft. (mm)	10' 6.5" (3213)
Interior Height	6' 5" (1958)
** Fresh Water Cap. - Gal. (L)	36 (137)
Black Holding Tank Cap. - Gal. (L)	32 (122)
Grey Holding Tank Cap. - Gal. (L)	38 (145)
Fuel Cap. - Gal. (L)	55 (209)
Propane Cap. - Gal. (L)	17.5 (66)
Exterior Storage Capacity	30 CU.FT.

All Capacities in U.S. Gallons \* Add 7" for Spare Tire \*\* Includes 6 gal. Water Heater

### CHASSIS & SUSPENSION

Block Heater	S
Chassis - Ford E-450, 6.8L EFI V-10 Triton w / Gas Generator Ready	S
Concealed Locking Fuel Filler	S
Hitch - Trailer Hitch Receiver w/ Wiring - 500/5000 lb	S
Rear Airbag Assist Suspension	S
Spare Tire w/Carrier and Continental Cover	S
Transmission - Automatic 5 Speed c/w Overdrive and Tow Haul Mode	S

### DRIVERS AREA CONVENIENCES

Air Conditioning - Chassis	S
Cruise Control and Tilt Steering Wheel	S
Decorative Dash Trim	S
Mirrors - Heated Remote Mirrors	S
Power Windows and Door Locks	S
Radio - In-Dash AM/FM/CD/DVD Player/Navigation/Blue Tooth/Rear View Camera	S
Satellite Radio Prewire - Including Antenna	S
Seat - Ultraleather Driver's and Passenger's Chairs (Power Driver's)	S

### VEHICULAR

Battery Boost	S
Undercoating - Chassis	S

### CONSTRUCTION

Floor - Steel Framed Vacuum Bonded Insulated Construction	S
Roof - Domed Vacuum Bonded Aluminum Framed Insulated Kemplite FRP Flexroof	S
Sidewalls - Vacuum Bonded Aluminum Framed Insulated with Thermal Break Gel Coat Fiberglass	S
Windows - Frameless Thermal Tinted All Glass Awning Style	S

### EXTERIOR

Assist Handle - Lit	S
Doors - Flush Radiused Style Baggage Doors	S
Ladder	S
Large Rear Storage Compartment	S
Paint - Full Body w/ Clear Coat	S
Patio Light - w/ Interior Wall Switch	S
Running Boards and Flares - Fiberglass	S

### INTERIOR

Cabinetry - Cherry Finished with Euro Style Pillow Framed Doors and Solid Wood Cabinet Ends	S
Ceiling - Flat Padded Vinyl Headliner	S
Detectors - Electronic Smoke, LP and CO	S
Drawers - Full Extension Ball Bearing Tracks	S
Fire Extinguisher - Dry Chemical	S
Flooring - Easy Clean Vinyl Throughout	S
Lighting - LED Aisle with LED Accent	S
Privacy Drape - Cab	S
Shades - Pleated Day/Night (Bedroom Black Out)	S
Skylight - Living Area	S

### FURNITURE

Murphy Bed with Residential Queen Mattress w/ Cover - 60" x 80"	S
U-Lounge Dinette	S

### GALLEY

Blind - Venetian Blind in Galley	S
Convection Microwave - OTR c/w Light & Vent Fan	S
Cooktop 2 Burner Glass Top	S
Countertop - Contoured Solid Surface	S
Decorative Backsplash around Cook-top	S
Faucet - Brushed Nickel Galley Faucet with Pull-out Sprayer	S
Garbage Can - Recessed in Counter Top w/ Flush Lid	S
Range Hood	S
Refrigerator - Dometic Double Door LP/Electric 7 Cu. Ft. w/ Raised Panel Inserts	S
Sink - Large Round Stainless Steel Deep Bowl	S

### LAVATORY

Medicine Cabinets with Swing-out Double Mirrored Doors	S
Shower - c/w Glass Door	S
Sink - in Vanity	S
Skylight - in Shower	S
Toilet - China - Foot Flush w/ Sprayer	S

### ENTERTAINMENT

Satellite Dish - Pre-Wire	S
Stereo - AM/FM/DVD/CD/Tuner Home Theater	S
TV - 26" LED with TV Lift	S
TV Antenna - Roof Top Retractable Antenna c/w Booster	S

### HEATING, VENTILATING & AC

Air Conditioner - Low Profile 13,500 BTU Ducted c/w Heat Pump	S
Fan - Non Reversible Thermal Controlled Create A Breeze Fan in Galley	S
Furnace - 35,000 BTU	S
Vent - 12 Volt Power Roof Exhaust in Lavatory	S

### ELECTRICAL

Bi-Directional Isolator Relay Delay (BIRD) Battery Charging	S
Cable TV Hook-up	S
Converter - Power Converter c/w Battery Charger (55 Amp)	S
Generator - 4.0 KW Onan MicroQuiet® w/ Auto Changeover Switch	S
GFI Receptacle - 110 V - Patio, Galley, Lavatory	S
Switch - 12 Volt Battery Disconnect - Manual	S

### PLUMBING & LP SYSTEMS

Black Tank Flush	S
Exterior Shower w/ Shut Off Valves for Winterizing	S
Monitor Panel - Grey, Black, Fresh Water, LP Level and Battery Charge	S
Pick Up Kit - Antifreeze Pick Up Kit	S
Valve - Water Heater By-Pass Valve	S
Water Heater - Electronic Ignition LP/ Electric/ Motoraid	S

### AWNING PACKAGES

Patio Awning with Aluminum Weather Shield	S
---	---

### CERTIFICATION

Canadian Certification - Mandatory for Canada	O
RVIA Certification	S

### OPTIONAL EQUIPMENT

Air Compressor w/ Individual Gauges (Wireless)	O
Battery - Second RV Coach (1 Standard)	O
Factory PDI	O
Inverter - 600 watt for Entertainment	O
Jacks - Stabilizer Electric (2 only)	O
Macerator - RV Sanicon System	O
Rust Protection	O
Satellite Dish - Winegard with Electronic Elevation Sensor	O
Side Turn Cameras	O
Slide Topper Awning	O

\* Please visit [tripleerv.com](http://tripleerv.com) for a comprehensive list of standard & optional equipment.

**Triple E Recreational Vehicles** 301 Roblin Boulevard, Winkler, MB, Canada R6W 4C4 Telephone: 204-325-4361 Toll-Free: 877-992-9906 Fax: 204-325-5241

\*Product improvement is a continuing process at Triple E RV. Thus we reserve the right to change the specifications on any and all products without prior notice; errors and omissions excepted. Triple E RV is under no obligation to undertake modifications to units manufactured prior to changes in specifications. Units may be shown with optional equipment. Photo accessories are not included. Brochure printed in Canada. 09/2011.



**www.tripleerv.com**  
For web-exclusive content you can't fit in a brochure.