

BEAVER®

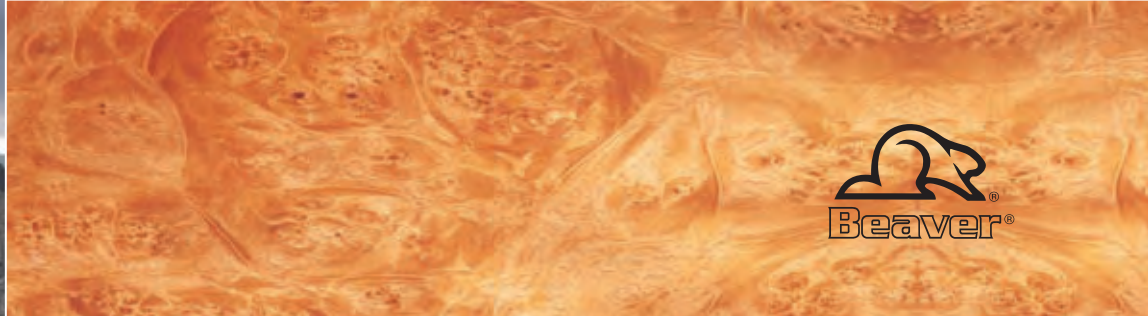

# MARQUIS® BEAVER® 2006

*One coach at a time. Yours.™*

MARQUIS® 2006

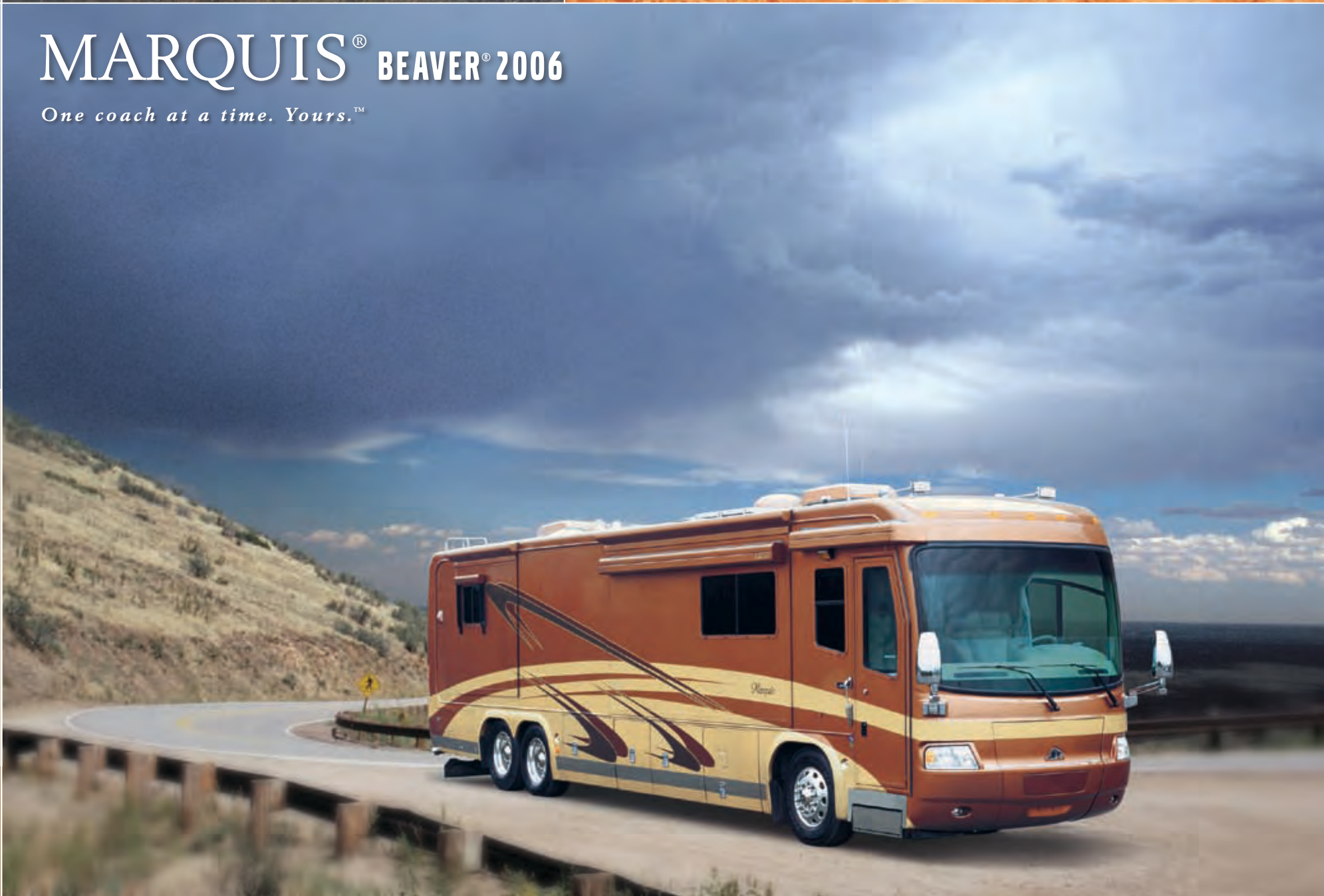

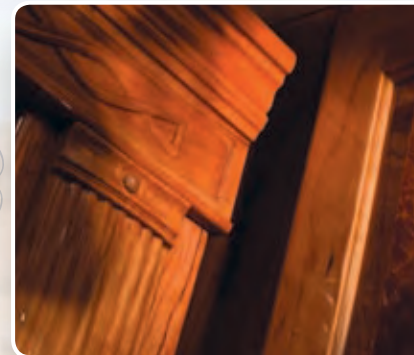
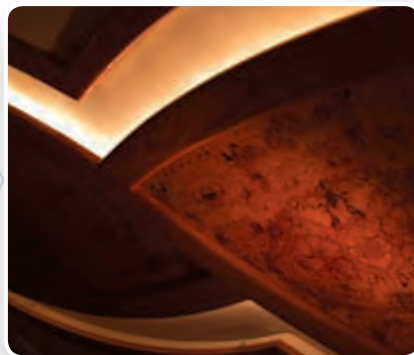

## *Beau. Bello. Bonito. Beautiful.*

Any way you translate it, one thing's for sure — it's love at first sight of a new 2006 Beaver Marquis motorcoach. That's because around here, we speak the language of Old World craftsmanship. For the cabinetry, we travel the globe to hand select the very best hardwoods and the one-of-a-kind exotic burl inlays. Giving the entire coach a remarkable

consistency of color and grain that's highlighted with a stunning gloss finish. Yes, from your first glimpse of the lustrous, full-body paint, to your first experience at the wheel of the state-of-the-art Roadmaster chassis, a Beaver Marquis will steal your heart away. We hope you'll enjoy your walk through the pages of the most beautiful motorcoach on the road.



*One coach at a time. Yours.™*

# *Marquis*



## YOUR SEARCH IS OVER.

You've found it. The ultimate luxury diesel motorcoach. The 2006 Marquis. Our flagship is the absolute culmination of everything you're looking for. Breathtaking power. Precision engineered performance. The newest technologies. And an awe-inspiring interior with versatile floorplans, exquisite decors and the world's most stunning woodwork. The new, contemporary styling of the front cap and the rich beauty of our unique full-body paint assure you of head-turning admiration. Yes, this is the coach for the most discriminating tastes. This is the coach for you.







42 Topaz IV shown in Cast Bronze decor with Cherry cabinetry and Maple Burl inlays.



## BECAUSE YOU'RE NOT THE TYPE TO SETTLE FOR LESS...

...and at Beaver Motorcoaches, neither are we. Whether it's stunningly beautiful interiors, state-of-the-art power and performance, or legendary customer support — you'll immediately see that we specialize in doing things better than anyone else. Yes, in a 2006 Marquis, you'll be settling into the very best.

### TAKING LUXURY TO NEW LEVELS.

The Marquis greets you with a spacious 81" of interior height, which is beautifully accented by the tiered wood ceiling design. Also tucked overhead is the flush-mount 37" LCD TV and recessed surround sound speakers. Look around you, and you'll see the plush, stylish furnishings, including the OptimaLeather™ Euro-recliner with ottoman and the optional wraparound computer table. Power Roman window shades offer instant privacy at the touch of a button.



40 Ruby IV shown in Birds of Paradise decor with Cherry cabinetry and Maple Burl inlays.



### MULTIPLEX SYSTEM

An exciting new feature this year is the Multiplex wiring system. Lighted switch panels like the ones shown here are located throughout the coach, giving you multiple convenient access points for the controls to the slide-outs, the lighting — including the dimmers, and more. Each switch illuminates to indicate which function is on or off. Multiplexing also reduces the amount of wiring in the coach, reducing the overall weight and making servicing easier.





40 Ruby IV shown in Birds of Paradise decor with Cherry cabinetry and Maple Burl inlays.



## CRAFTED BY HAND. DESIGNED WITH HEART.

Step inside the Marquis, and you get a feeling unlike any other. Maybe that's because every square inch reflects our pride in knowing this is the ultimate craftsmanship. High-gloss cabinetry. Scored granite backsplash. Sculpted glass splash guard. Solid surface countertop with integrated sink. These are not only stylish features that make the Marquis easy to care for, they make it a home.

### DINETTE

The dinette features a large picture window, as well as a wood table with 12" leaf and a wall cabinet with Corian® top. Recessed halogen lighting helps create the perfect ambiance.



### DISHWASHER DRAWER

This optional dishwashing drawer is concealed in the beautiful base cabinets and allows you to enjoy the same timesaving convenience you'd have at home.

### RESIDENTIAL REFRIGERATOR

With the optional residential refrigerator with ice maker, you truly take with you all the amenities of home. Perfect for longer trips or for the gourmet cook in your life.



### WINE GLASS CABINET

This elegant wine glass cabinet is an excellent option for safely storing and displaying your glassware.





42 Topaz IV shown in Cast Bronze decor with Cherry cabinetry and Maple Burl inlays.



## PLUSH BEYOND YOUR WILDEST DREAMS.

The Marquis' private quarters are roomy and elegant. A queen bed is standard on most models (a king is standard on the 45 Jade II, III, IV), or you may choose an optional king bed. Whichever you choose, you may personalize your comfort with an optional air mattress with dual remote control — allowing you to easily adjust the firmness of your bed. Other highlights include the beautifully coordinated bedspread and pillows, decorative hardwood slide-out fascia and nightstand(s) with Corian® tops.

### BEDROOM TV

You'll enjoy a fully equipped entertainment center in the bedroom, including a 20" LCD TV with remote and a combination VCR/DVD player or the optional Bose® 3-2-1 entertainment system. In addition, the optional In-Motion digital satellite system includes a second receiver for the bedroom.



### SECURITY SAFE

While you're away from your coach, your valuables may be securely locked in this discreetly located security safe.

### HIDE-A-BED

The versatility of your floorplan is enhanced with this optional hide-a-bed, giving you more sleeping room for family and guests. Its air mattress allows you to customize the firmness of the bed, for optimum comfort.



### AQUA-HOT®

The remarkable Aqua-Hot® system provides a continuous, unlimited on-demand supply of hot water and also serves as the zoned interior hot-water heating system, for cozy radiant heat. It even features an engine preheat function.



## A PERFECT MATCH FOR EVERY PERSONALITY.

Whether your tastes run from the traditional to the adventurous, our expert designers have assembled a color scheme that's right for you. No matter which one you choose, you'll enjoy a distinctive decor with plush fabrics, carpet and upholstery, as well as a uniquely durable exterior finish, featuring the rich luster of our deluxe full-body paint.

1. DINETTE
2. CARPET
3. SOFA
4. BEDSPREAD

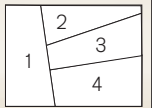

DESIGNER SERIES

*BIRDS OF PARADISE by Paloma Picasso*



CAST BRONZE







COPPER MARSH



TARTAN RED

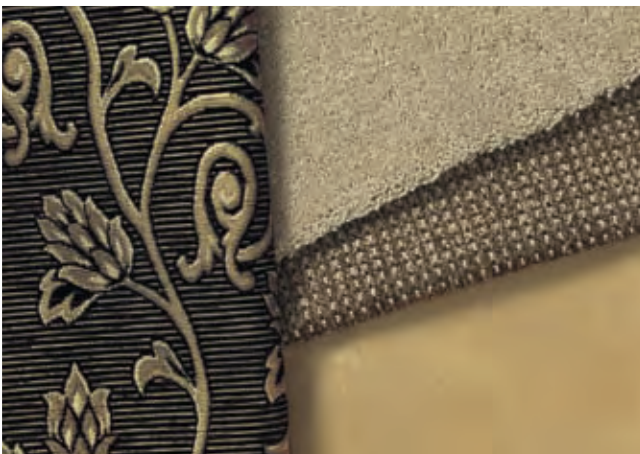

ZEN II





## THIS IS WHERE WE DO THINGS THE OLD-FASHIONED WAY.

The 2006 Marquis is a marvel of innovation, with a long list of new state-of-the-art features, including the convenient Multiplex wiring system, a spike-free 2,800 watt pure sine wave inverter, Active Control Dampening (ACD) adjustable shock absorbers and the Eaton® VORAD®

collision avoidance system — to name just a few. But here, in the Marquis' cabinet shop, it's all about Old World craftsmanship.

The hardwoods for our cabinets and the exotic burls used in our one-of-a-kind inlays come from all over the world — from South America to Northern Africa to Central Europe. Not only do we travel the globe in search of the best wood sources, we hand select our choice of trees to achieve greater consistency in grain, texture and

color. A single coach may typically include an astounding 45 cabinets, 60 doors, three pocket doors, 40 drawer faces and literally hundreds of other pieces of wood.

Naturally, we wouldn't entrust these valuable resources to just anyone. In fact, our cabinet shop is comprised of highly skilled craftspeople with a combined total of more than 350 years of cabinetmaking and woodworking experience.



*Cherry*



*Mahogany*



*Maple*

### FROM START TO FINISH.

The Marquis' woodwork features a unique high-gloss finish. Stain is never used — what you see is the natural grain and tones of the wood. To achieve this remarkable gloss, multiple layers of base coat and top coat are applied — each followed by painstaking sanding and buffing. And as you can see here, nothing leaves the cabinet shop until it's been thoroughly inspected.



*Select Lumber*



*Design and Layout*



*Craftsmanship and Construction*



*Hidden Details*



*Hand Finishing*



*Intricate Workmanship*



*Multi-Layer Finish*

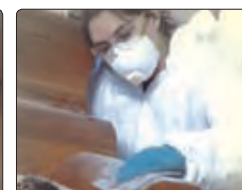

*Hand Sanded*



*Hand Wax and Power Buffing*



*Thorough Inspections*



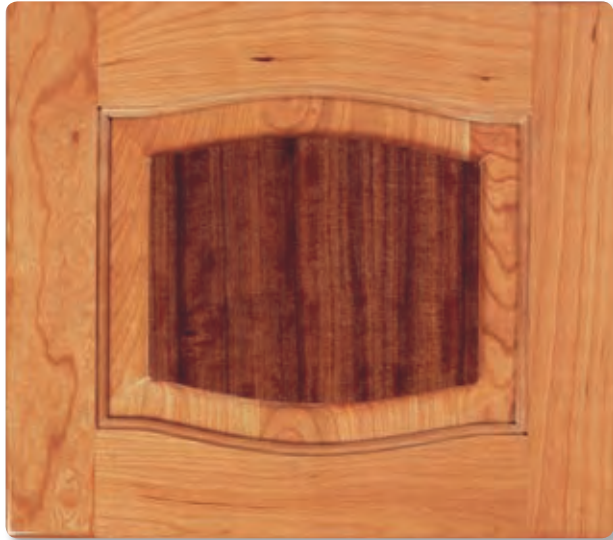

*Cherry with Makori Inlay*

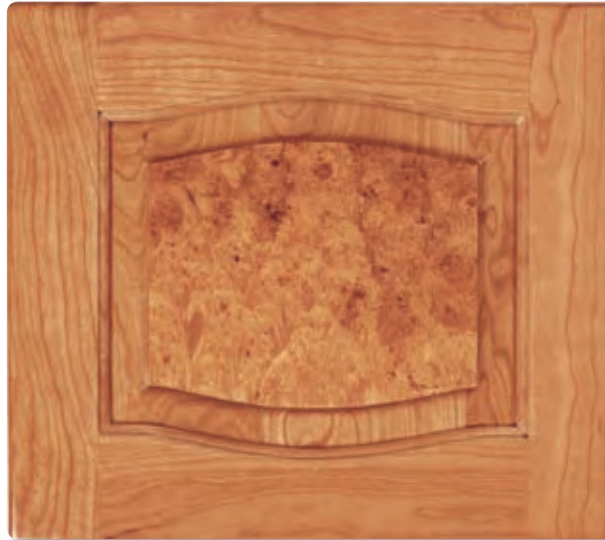

*Cherry with Maple Burl Inlay*

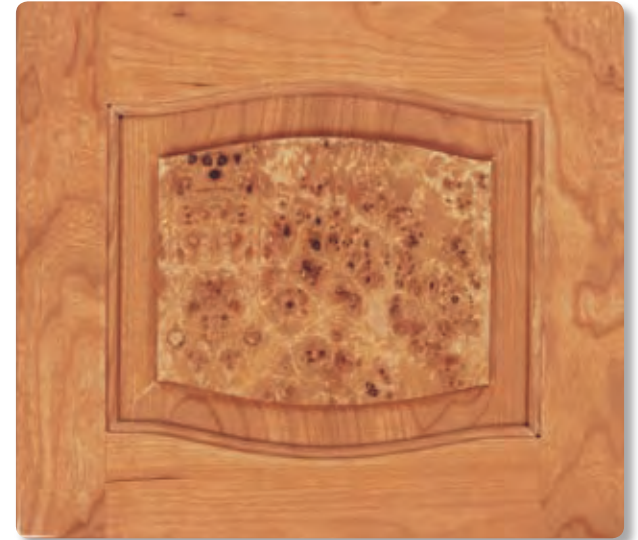

*Cherry with Mappa Burl Inlay*



*Maple with Bird's-Eye Maple Inlay*

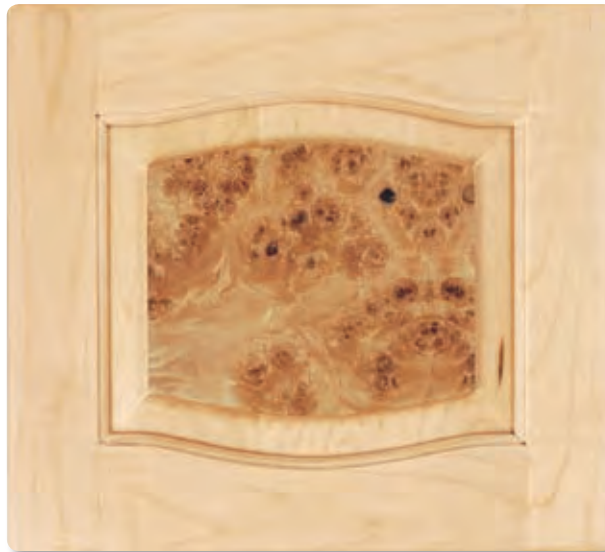

*Maple with Mappa Burl Inlay*

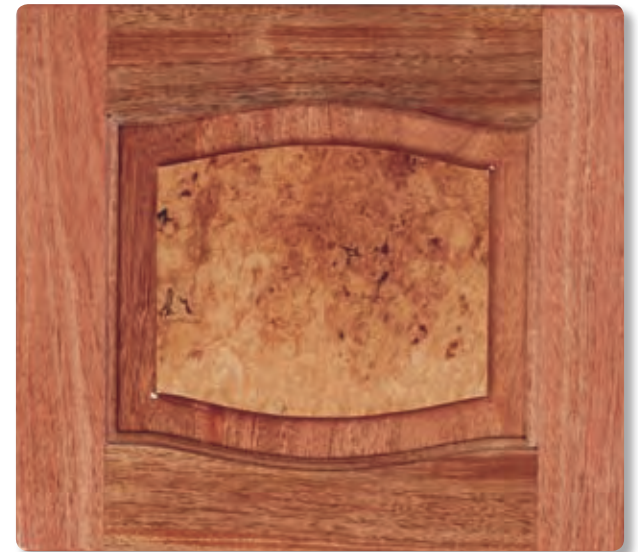

*Mahogany with Maple Burl Inlay*



## IT'S ALL RIDING ON A ROADMASTER.

Ask any Beaver owner, and they'll tell you — it's the Roadmaster chassis that makes the difference. That's because the Roadmaster is custom-built to the exact specifications of each Beaver model and floorplan. You see, Roadmaster has a 100% commitment to only producing luxury motorhome chassis — and that's something no other manufacturer can say. We invite you to take a closer look at the highlights of the Marquis' incomparable S-Series Semi-Monocoque chassis. You'll find that it leads the way in safety, performance, convenience and reliability.

 **Roadmaster**  
Chassis

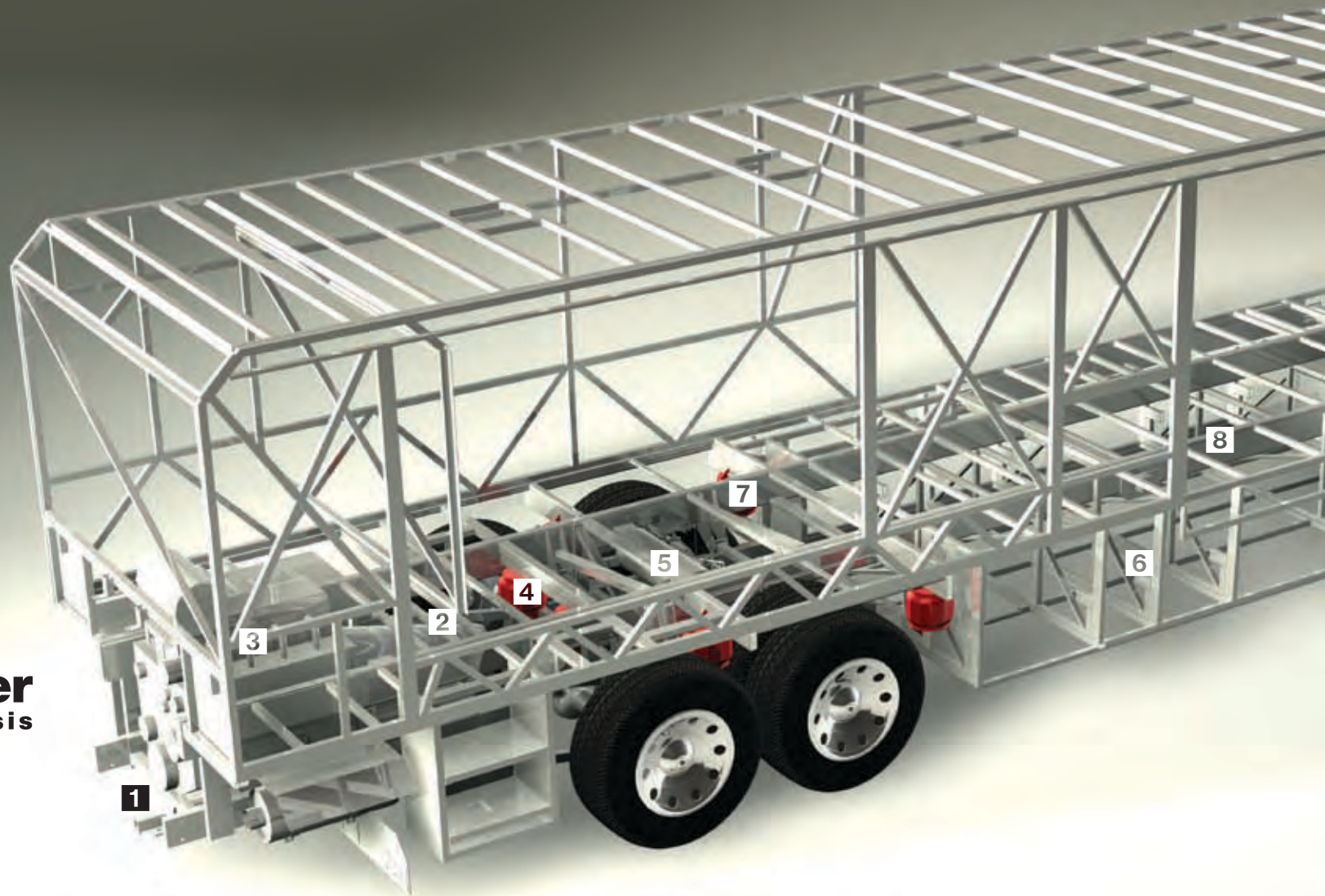

**1** 10,000 lb. hitch receiver offers powerful towing capacity with 7/4-way trailer plug. The coach also has a new prewire for a supplemental braking system.

**2** The three-point engine mounting system lowers the coach's center of gravity and reduces the amount of vibration that reaches the coach. The mounting also makes the engine easier to service by allowing the engine to be easily lowered through the bottom of the coach.

**3** Caterpillar® 525 HP ACERT C-13 Engine.

**4** Allison® 4000 MH 6-speed transmission for smooth shifting;

our exclusive use of synthetic transmission fluid allows for up to three-year maintenance intervals.

**5** Cushion Air-Glide suspension system positions ten Bilstein® shocks and ten air bags, eight of which are outboard mounted with auto-leveling for greater stability, a smoother ride and the best handling in its class.

• Unique three-degree rear axle tilt aligns the engine, transmission and differential, minimizing stress on the drive-train and reducing noise and vibration in the coach.

• Automatic Traction Control (ATC) eliminates wheel slippage in slick conditions and heightens control.

• Tag axle lifts for added maneuverability in tight spots.

**6** Basement structure rust inhibitor: To prevent corrosion, the basement storage area is constructed with pre-primed steel with rust-inhibiting paint.

**7** Full-length frame rails fabricated from 3" by 8" by 1/4" 60,000 PSI structural steel; rails are spaced 46" on center for a wider stance and unmatched strength.



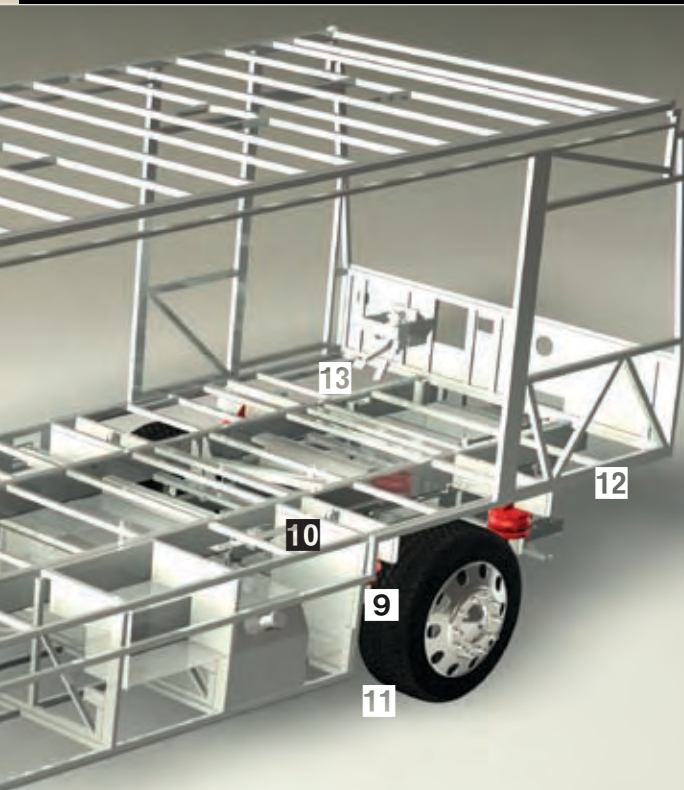

### OUTBOARD AIR BAG SUSPENSION

The outboard-mounted air bags are protected by two steel plates and are placed approximately 7-1/2 feet apart, providing a wider, more stable platform for the coach. The active suspension automatically adjusts the pressure of the air bags as you drive and virtually eliminates nose-diving and the side-to-side body sway associated with high wind conditions, curvy roads and emergency maneuvers.



- 8** The semi-monocoque design, with trussed superstructure, distributes stress evenly throughout the entire chassis and adds strength to sidewalls and bays.
- 9** Cat® compression two-stage engine brake system assures you of safely traveling steep grades while 6-wheel anti-lock brakes with disc brakes in front help you maintain control in severe road conditions.
- 10** Dual ping air tanks with 3/4" air lines for quicker response and improved ride and handling.



### POWERED BY CATERPILLAR® Caterpillar® 525 HP C-13

Beaver is proud to offer Caterpillar® engines with ACERT® technology. Road tested for millions of miles, Cat engines offer unbeatable reliability and durability. Plus, a Cat with ACERT technology gives you high performance with the lowest operating costs in the industry. In fact, its maintenance intervals are 30,000 miles, compared with 25,000 for other engines. The C-13 outperforms the competition in horsepower and torque and features the tremendous responsiveness of series turbocharging. The Cat is also backed by an industry-leading 5-year/200,000 mile warranty with no deductible. And finally, ACERT technology gives you the cleanest-running engine available — and is fully compliant with EPA mandated standards.

### ACTIVE CONTROL DAMPENING (ACD)

This state-of-the-art system monitors suspension and chassis movement thousands of times per second and adapts the suspension to the input. The result: superior control and unbeatable ride quality.

- 11** P295/80R Goodyear steel belted all-season tires ensure a safe and quiet ride (G670 RV tire).
- 12** The truss power steering box allows for a 50-degree front wheel turn angle in both directions for better maneuverability and returns the steering wheel back to its center position to eliminate driver fatigue.
- 13** All chassis are equipped with steel cage construction, steel firewall and steel stepwell for added safety.



### ROOF CONSTRUCTION

(top to bottom)

- One-piece 1/4" thick fiberglass roof, crowned for water runoff and seamlessly joined with front and rear end caps
- Vapor barrier
- 3 1/2" tapered bead foam supports the crowned roof; the center tunnel houses wiring and air conditioner ducts
- 1/4" marine grade plywood sheeting
- Tubular steel framework
- R 7.5 closed cel foam seals every nook and crevice
- Luaun and vinyl paneling are Vac-U-Bonded
- Sound-absorbing, easy-to-clean padded vinyl interior headliner

### WALL CONSTRUCTION

(left to right)

- Gel coat fiberglass outer wall
- Luaun paneling
- Heavy-gauge tubular steel and 4" steel plate backers
- R 7.5 closed cel foam seals every nook and crevice
- Luaun paneling; walls are Vac-U-Bonded together
- Decorative wall coverings

### FLOOR CONSTRUCTION

(top to bottom)

- Tile, or 1/2" carpet pad and carpeting
- Dyna-Span flooring
- Decibel layer
- Dyna-Span flooring
- Waterproof fiberglass underbelly



With the GPS option, you're free to explore the middle of nowhere and always know exactly where you are.



Aladdin™ makes it easy to keep track of many important functions, including tank levels, temperatures, mileage and much more.



This optional collision avoidance system utilizes a combination of sensors, software and radar to warn you of potential hazards on the road ahead and alongside your coach, which may be outside your view.



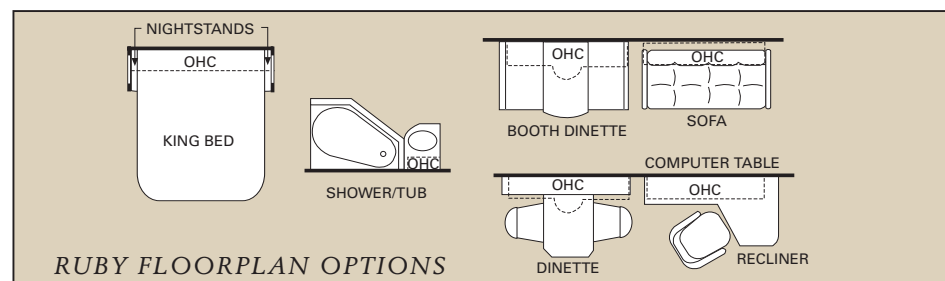
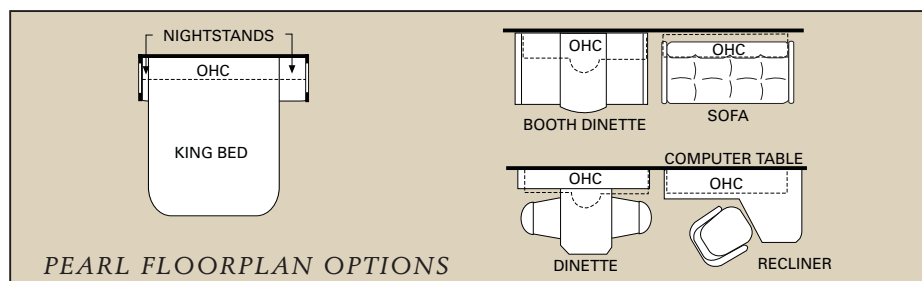
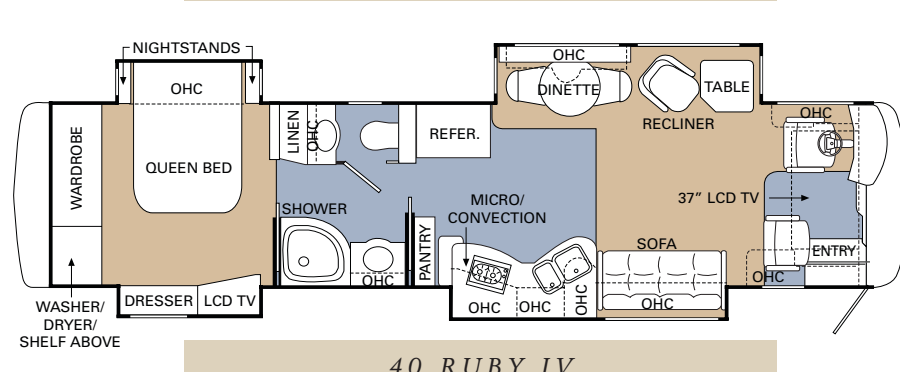
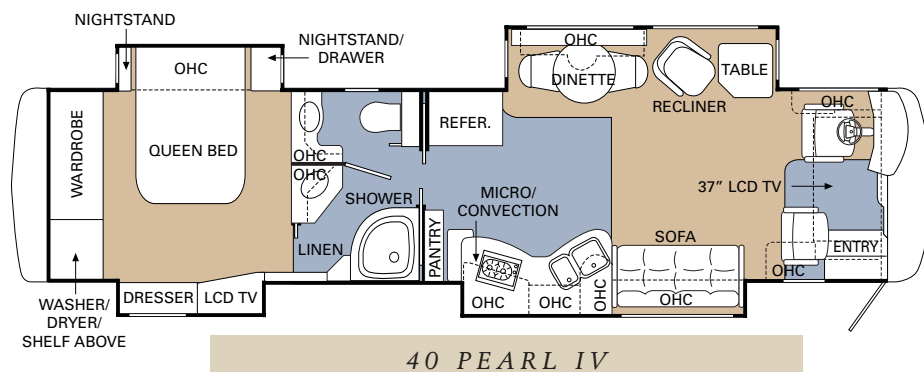
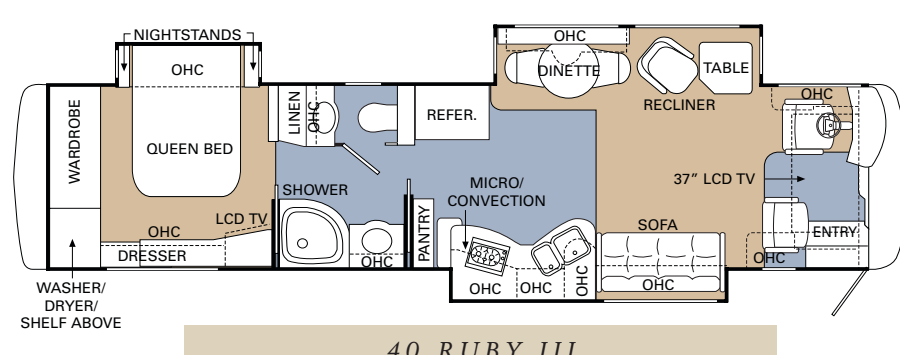
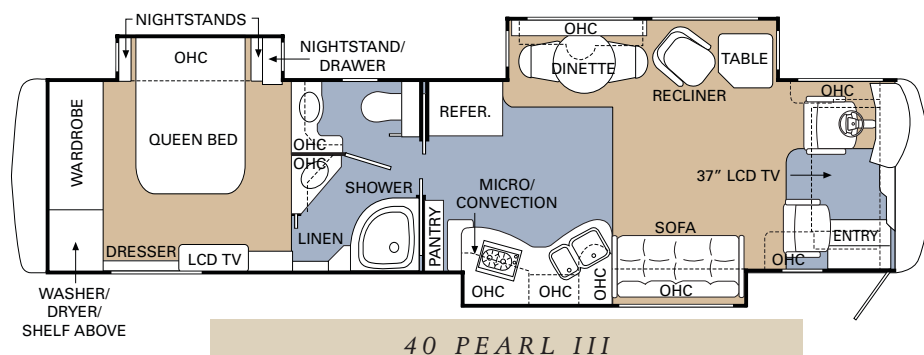
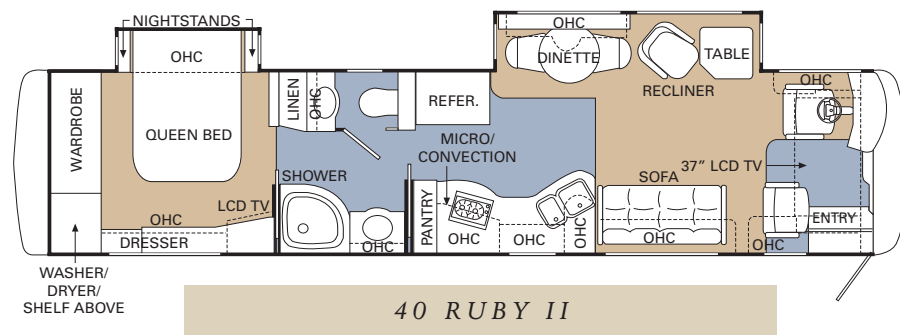
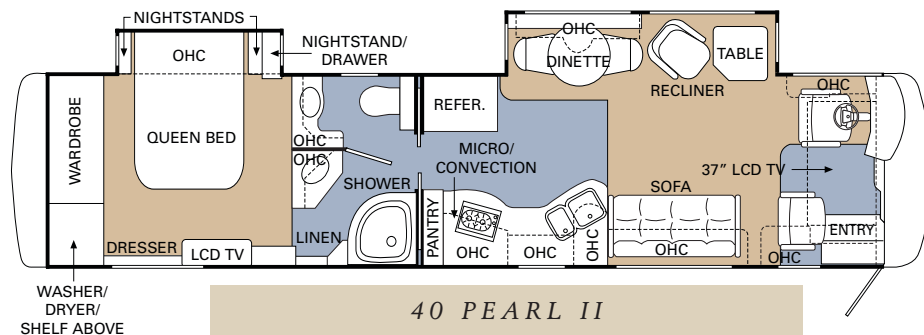



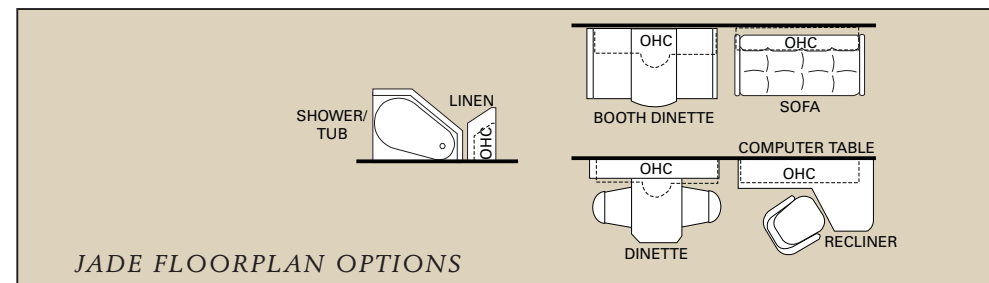
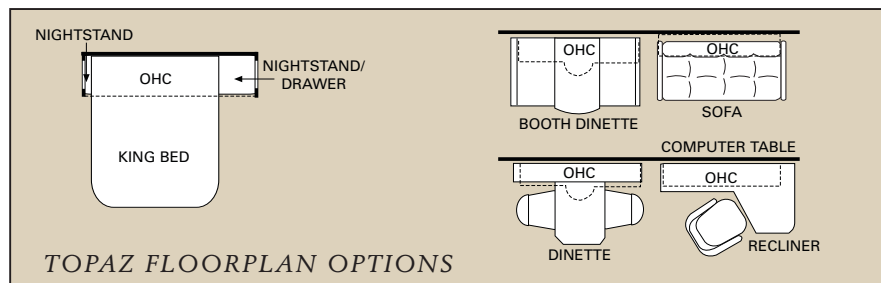
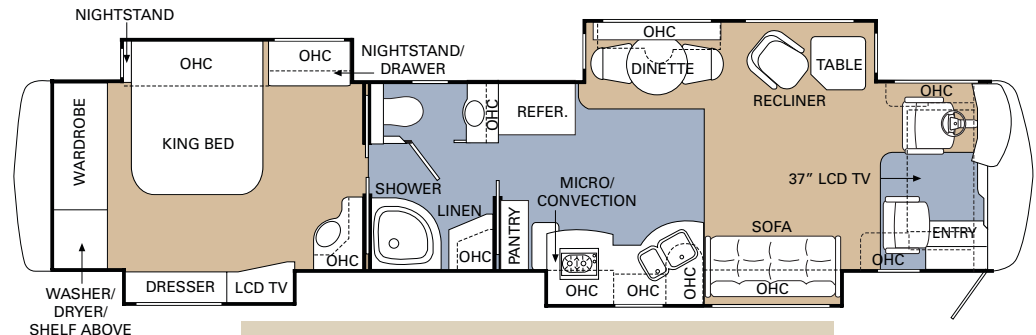
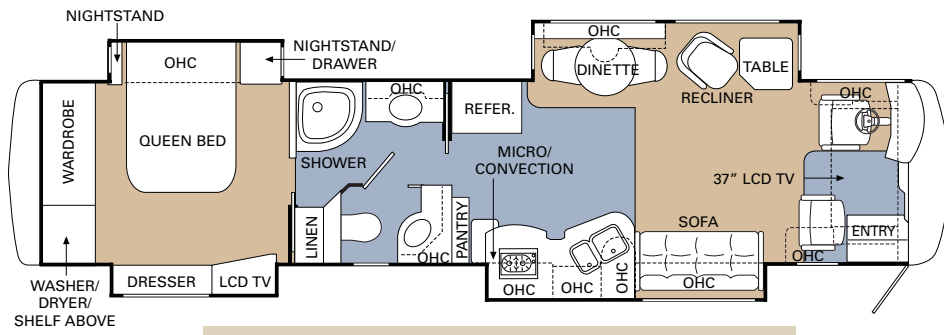
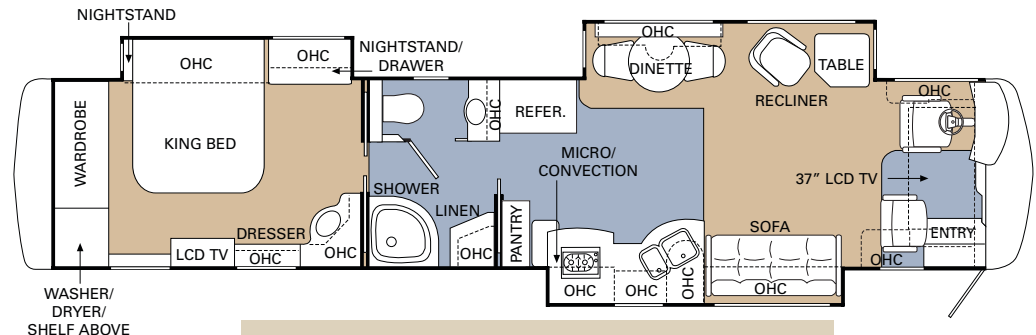
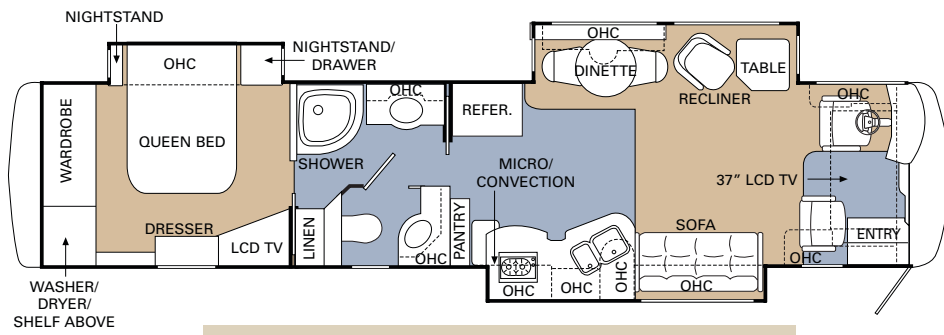
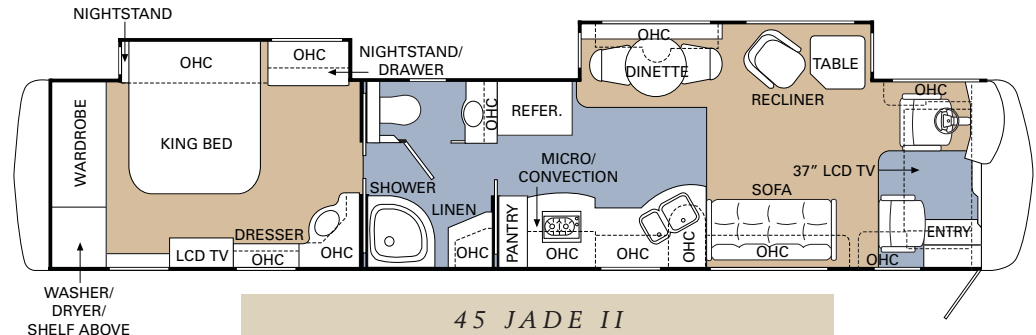
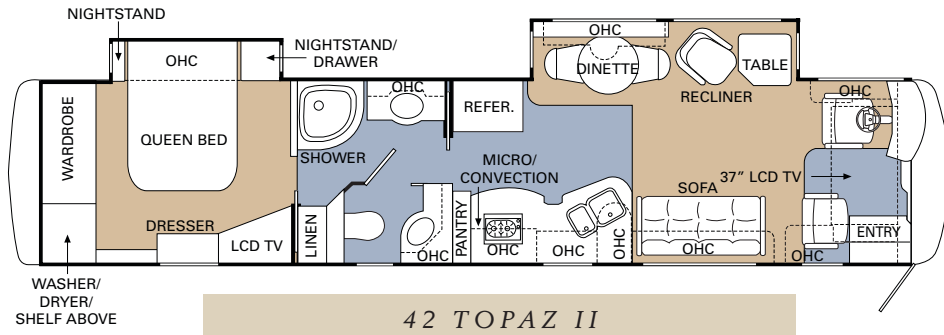



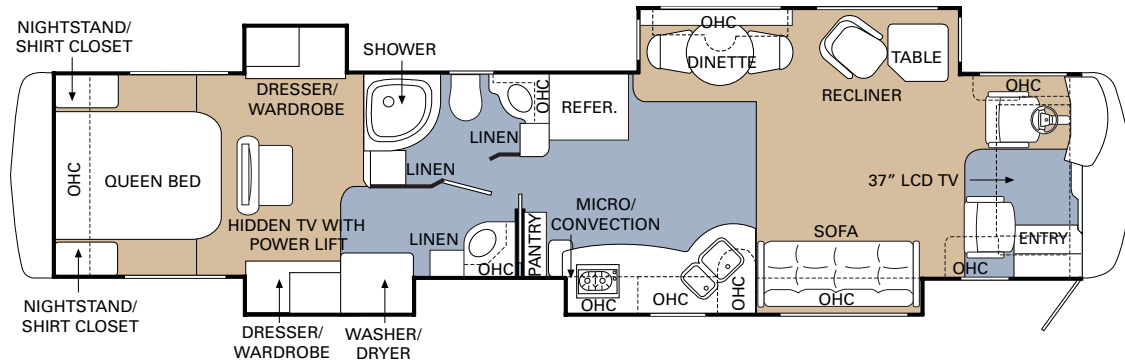

45 ONYX IV

ONYX FLOORPLAN OPTIONS

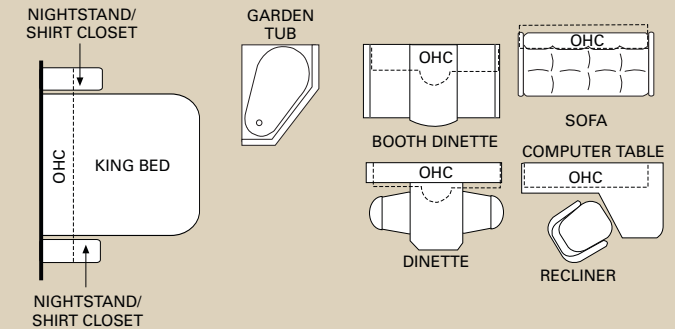

WANT A CLOSER  
LOOK? BE OUR GUEST  
AND STAY AS LONG AS  
YOU LIKE.

VIRTUAL SHOWROOM

[www.beavermotorcoaches.com](http://www.beavermotorcoaches.com)

Be sure to visit our website for all the latest product news and updates. It's also a great place to get information on club events and a great way to contact us directly. And yes, while you're there, don't miss our virtual tour with panoramic views of the entire coach, close-ups of many exciting details and much more.





## HERE ARE SOME THINGS YOU CAN COUNT ON.

Talk to Beaver owners, and they'll tell you the day you drive away in your new coach is the beginning of a lasting relationship. That's because personalized owner care is something we stake our reputation on, year after year. Wherever your travels lead, you can count on us to be only a phone call away. Our staff is available 24/7/365 to help you with virtually any situation that may arise — with troubleshooting, operational instruction or facilitating repairs at the nearest of our 350 nationwide service centers. In addition, you'll be enrolled in our Owner Advantage Roadside Assistance Program free of charge for your first year of ownership — providing additional emergency assistance, including towing, tire repairs and many more services around the clock. In short, when you purchase an RV from Monaco Coach Corporation, you get a wider array of benefits than any other manufacturer can offer. From our industry-leading Roadmaster chassis to the remarkable White Glove factory inspection program. Want to see it all for yourself? Simply call 1-800-634-0855 or 1-800-650-7337 to arrange a tour of one of our state-of-the-art production facilities in Oregon or Indiana.



## WARRANTIES

### 12 month/24,000 mile

basic limited warranty

### 5 Year/50,000 mile

limited warranty on aluminum or steel frame structure of sidewall, roof, front and rear cap

### 3 Year/36,000 mile

limited warranty on Roadmaster chassis

Applies to certain models. See owner's manual for complete details.

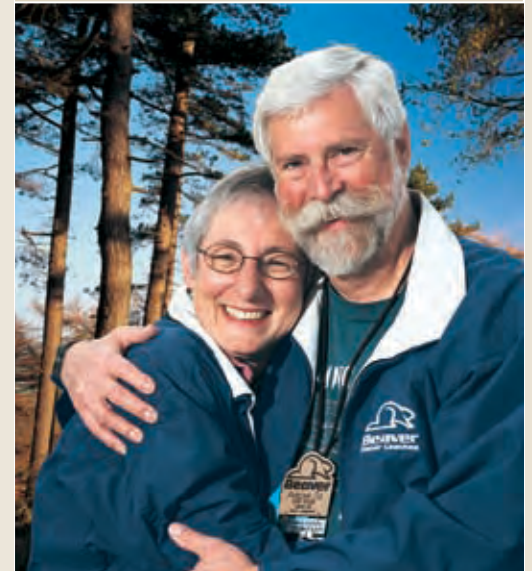

## OWNER ADVANTAGE ROADSIDE ASSISTANCE PROGRAM

At no charge to you in your first year of ownership, we offer an extensive support program that provides complete roadside assistance and special motor club benefits that follow you wherever your travels take you. This coverage also includes one additional family vehicle at no extra charge! Highlights include towing, tire repairs, fuel delivery, lock-out service, service appointment assistance, trip interruption coverage and much more.



	BODY CONSTRUCTION			OPTIONS
FEATURES	<ul style="list-style-type: none"><li>› Heavy-Duty Steel Superstructure with Steel Cage Cockpit Construction</li><li>› Seamless One-Piece Molded Crowned Fiberglass Roof</li><li>› All-Season Foam Insulated Roof</li><li>› Laminated Gel Coat Fiberglass Sidewalls</li><li>› Five-Layer Flooring with Two Layers of OSB Flooring</li><li>› Deluxe Full-Body Paint</li></ul>	<ul style="list-style-type: none"><li>› One-Piece Windshield</li><li>› Triple Head Power Controlled Heated Chrome Exterior Mirrors with Turn Indicator Lights</li><li>› Daytime Running Lights</li><li>› Halogen Driving Lights</li><li>› Recessed Side Docking Lights</li><li>› Roof-Mounted Dual Trumpet Air Horns</li><li>› Insulated Aluminum Baggage Doors with Power Locks</li></ul>	<ul style="list-style-type: none"><li>› Lined Storage Compartments</li><li>› Interlocking Aluminum Framed Slide-Out Houses</li><li>› Interior Paneling with 1 1/2" Insulation</li><li>› Storage Bay Slide-Out Tray (Full Pass-Through)</li><li>› Rear Ladder</li><li>› Full-Length "Beaver" Mud Flap</li></ul>	<ul style="list-style-type: none"><li>› 3M Film Front Mask</li><li>› Additional Manual Storage Bay Slide-Out Storage Tray (One-Side)</li><li>› Additional Manual Storage Bay Slide-Out Storage Tray (Full Pass-Through)</li><li>› Electric Slide-Out Storage Tray (Full Pass-Through)</li><li>› Exterior Sunscreens</li></ul>
	CHASSIS/ENGINE/SUSPENSION			OPTIONS
FEATURES	<ul style="list-style-type: none"><li>› Roadmaster S-Series: Semi-Monocoque Chassis</li><li>› CAT® 525 HP C-13 Engine with Allison® 4000 MH 6-Speed World Transmission and Electronic Shifter</li><li>› Torque [ @ 1,200 RPMs ]: 1,650 lbs./ft. Max</li><li>› Engine Displacement: 763 Cu. In. /12.5L</li><li>› Engine Block Heater</li></ul>	<ul style="list-style-type: none"><li>› Dual Fuel Fill</li><li>› 200 Amp Alternator</li><li>› Rear Axle Ratio: 4.33:1</li><li>› Tires: 295/80R/22.5</li><li>› Polished Aluminum Wheels</li><li>› Full-Cushion Air Glide Suspension with Ten Outboard Mounted Air Bags and Ten Shock Absorbers</li><li>› Automatic Traction Control</li></ul>	<ul style="list-style-type: none"><li>› Air Disc Brake System with ABS</li><li>› Tag Axle with Anti-Lock Braking System</li><li>› Auto Slack Adjusters on Brakes</li><li>› Cat® Compression Two-Stage Engine Brake</li><li>› Hydraulic Leveling System</li><li>› 10,000 Lb. Hitch Receiver and 7/4-Way Trailer Plug</li></ul>	<ul style="list-style-type: none"><li>› Electronic Adjustable Suspension System</li><li>› Dual Leveling System (Air/Hydraulic)</li><li>› Air Leveling</li></ul>
	COCKPIT			OPTIONS
FEATURES	<ul style="list-style-type: none"><li>› Fiberglass Automotive Dash with Roman Bronze Instrumentation Panel, Black Gauges with Gray Lettering and Gun Metal Bezels</li><li>› In-Dash AM/FM Stereo with Multi-Disc CD Changer</li><li>› Color Rear Vision System</li><li>› Aladdin™ Video Coach System SEE-Vision Security Cameras with Integrated Compass and Temperature Gauge</li><li>› CB Radio Prep</li></ul>	<ul style="list-style-type: none"><li>› Power Privacy Cab Drapes</li><li>› Power Sunvisors with Driver and Passenger Switch</li><li>› Pilot-Side Window Manual Sunscreens</li><li>› Adjustable Accelerator and Brake Pedals</li><li>› Two-Tone Leather VIP Lighted Smartwheel® with Controls for Windshield Wipers, ICC and Cruise Control</li><li>› Cruise Control Light on Dash</li><li>› Audible Turn Signals</li></ul>	<ul style="list-style-type: none"><li>› Power OptimaLeather™ 6-Way Pilot and Co-Pilot Seats with Electric Lumbar and Heat; Electric Sliding Seat Cushion and Memory Capabilities on Pilot Seat and Adjustable Headrest on Both; Footrest on Passenger Seat</li><li>› Carpet, Pilot and Co-Pilot Floor Mats</li></ul>	<ul style="list-style-type: none"><li>› Extra-Wide Co-Pilot Seat with Power Footrest</li><li>› CB Radio with Antenna</li><li>› GPS Navigation System with Touch Screen</li><li>› Sirius Satellite Stereo (Requires Subscription)</li><li>› VORAD® Collision Avoidance System</li></ul>
	APPLIANCES AND ACCESSORIES		OPTIONS	
FEATURES	<ul style="list-style-type: none"><li>› Four-Door Refrigerator with Ice Maker and Raised Panel Doors</li><li>› Recessed High-Output 2-Burner Cooktop</li><li>› Spacesaver Convection Microwave with Touch Control</li><li>› Manual TV Antenna</li><li>› Fully Automatic Digital Satellite System with Receiver in Living Area and Bedroom</li></ul>	<ul style="list-style-type: none"><li>› 37" LCD TV in Living Area Ceiling</li><li>› 20" LCD TV with Remote Control in Bedroom</li><li>› Home Theater System: AM/FM Stereo, Accoustimass Bass Module, Surround Sound Speakers</li><li>› Bedroom VCR/DVD Combo</li><li>› Universal Remote System</li><li>› Combination Washer/Dryer</li></ul>	<ul style="list-style-type: none"><li>› Residential Refrigerator</li><li>› Dishwashing Drawer</li><li>› Fully Automatic In-Motion Digital Satellite System with Receiver in Living Area and Bedroom</li></ul>	<ul style="list-style-type: none"><li>› Exterior Entertainment Center: 20" LCD TV, AM/FM/CD/DVD/MP3 Player, Two 4" Speakers</li><li>› Bose® 3-2-1 II Entertainment System in Bedroom (Replaces VCR/DVD Combo)</li></ul>

## SPECIFICATIONS: STANDARD FEATURES/OPTIONS

	INTERIOR		OPTIONS	
FEATURES	<ul style="list-style-type: none"><li>› High-Gloss Euro-Finish Cabinetry with Exotic Wood Inlays</li><li>› Lined Cabinet Shelves</li><li>› Dinette Wall Cabinet with Corian® Top</li><li>› Built-In Storage Area for Kitchen Sink and Cooktop Covers</li><li>› Bedroom Dresser</li><li>› Low-Friction Roller Drawer Guides</li><li>› Vinyl Ceiling with Tiered Wood Design</li><li>› Corian® Countertops Throughout</li><li>› Integrated Corian® Sinks in Vanity and Galley</li><li>› Scored Granite Galley Backsplash Design</li><li>› Scored Granite and Mirror Vanity Backsplash Design</li><li>› Sculpted Glass Splash Guard at Edge of Galley</li><li>› Power Roman Shades with Pleated Shades in Living Area and Bedroom</li></ul>	<ul style="list-style-type: none"><li>› Day/Night Shades in Kitchen and Bathroom Windows</li><li>› Vinyl Wallpaper</li><li>› Cutting Boards in Kitchen</li><li>› Plush Carpet in Living Room and Bedroom</li><li>› Sculptured Carpet Design in Living Area</li><li>› Ceramic Tile Flooring in Kitchen, Bath Area and Entry</li><li>› Bedspread with Pillows</li><li>› Nightstands with Corian® Countertops</li><li>› Corian® Windowsills in Living Area</li><li>› Recessed Living Area Surround Sound Speakers</li><li>› Decorative Hardware Throughout</li><li>› Large Pot and Pan Drawer in Kitchen Area</li><li>› Decorative Hardwood Slide-Out Fascia Trim</li></ul>	<ul style="list-style-type: none"><li>› Interior Decors: Tartan Red, Copper Marsh, Cast Bronze, Zen II</li><li>› Paloma Picasso Decor: Birds of Paradise with Tile Aisle from Entry to Kitchen</li><li>› Gloss Finish Cabinetry Choices:<ul style="list-style-type: none"><li>– Cherry, Mahogany, Maple</li><li>– Mahogany Cabinetry with Maple Burl Accent Cabinet Door Inserts</li><li>– Maple Cabinetry with Bird's-Eye Maple Accent Cabinet Door Inserts</li></ul></li></ul>	<ul style="list-style-type: none"><li>– Maple Cabinetry with Mappa Burl Accent Cabinet Door Inserts</li><li>– Cherry Cabinetry with Makori Accent Cabinet Door Inserts</li><li>– Cherry Cabinetry with Mappa Burl Accent Cabinet Door Inserts</li><li>– Cherry Cabinetry with Maple Burl Accent Cabinet Door Inserts</li><li>› Wine Glass Cabinet</li></ul>
	FURNITURE		OPTIONS	
FEATURES	<ul style="list-style-type: none"><li>› Queen Bed (N/A: Jade Floorplans)</li><li>› King Bed (45 Jade II, III and IV)</li><li>› Curbside: Sleeper Sofa with Drawer</li><li>› Roadside: OptimaLeather™ Euro-Recliner with Ottoman</li></ul>	<ul style="list-style-type: none"><li>› TV Module at Foot of Bed (45 Onyx IV)</li><li>› Corian® Fixed Living Area Table</li><li>› Dinette Table, Wood Round with 12" Leaf with Two Freestanding Dinette Chairs and Two Folding Chairs</li></ul>	<ul style="list-style-type: none"><li>› King Bed (45 Jade II, III and IV)</li><li>› Queen Air Mattress with Remote (N/A: 45 Jade II, III and IV)</li><li>› King Air Mattress with Remote</li><li>› Roadside: OptimaLeather™ Recliner</li><li>› OptimaLeather™ L-Sofa with Drawer</li><li>› OptimaLeather™ Sofa with Drawer</li><li>› OptimaLeather™ Hide-a-Bed with Air Mattress</li></ul>	<ul style="list-style-type: none"><li>› Fabric Hide-a-Bed with Air Mattress</li><li>› Roadside: Wraparound Computer Table (Requires Recliner)</li><li>› Side-Slide, Corian® Fixed Dining Table with Dinette Cabinet</li><li>› Booth Dinette</li></ul>
	ELECTRICAL SYSTEMS AND LIGHTS		OPTIONS	
FEATURES	<ul style="list-style-type: none"><li>› 50 Amp 120/240V Distribution Panel and Power Cord with Quick Disconnect</li><li>› Power Cord Reel</li><li>› Onan® 12.5 kW Quiet Diesel Generator on Power Slide-Out Tray with Auxiliary Start Switch and Automatic Temperature Start</li><li>› 2,800 Watt Pure Sine Wave Inverter with Auto Gen Start and Auto Temp Start</li><li>› Computer Hook-Up with Phone Jack at Dinette Area and Dash</li><li>› Decorative Lighting in Living Area and Bedroom</li><li>› Pilot/Co-Pilot Reading Lights</li></ul>	<ul style="list-style-type: none"><li>› Cosmetic Vanity Light in Bathroom</li><li>› Adjustable Bedroom Overhead Lights with Switches above Bed</li><li>› Recessed Halogen Lighting under Living Room and Dinette Overhead</li><li>› Halogen Lighting in Ceiling Throughout</li><li>› 120V Outlet in Private Lavatory</li><li>› 120V Outlet in Bed Base</li><li>› 120V Receptacle in Outside Storage Compartment</li><li>› Porch Light</li><li>› Doorbell</li></ul>	<ul style="list-style-type: none"><li>› Lighted Exterior Storage Compartments</li><li>› Four 6V Deep Cycle Coach Batteries</li><li>› Two 12V Deep Cycle Chassis Batteries</li><li>› Surge Protector for Automatic Transfer Switch</li><li>› Multiplex 12V Wiring Throughout Interior</li><li>› Locking Battery Disconnect Switch inside Coach</li><li>› Battery Disconnect Switch in Battery Compartment</li><li>› Two Solar Panels with Regulator (100 Watt)</li></ul>	<ul style="list-style-type: none"><li>› All Electric Coach: 5 Glass Matt Batteries, 270 Amp Alternator, Residential Refrigerator and Princess Two-Burner Cooktop (N/A: 45 Jade II, III and IV; 45 Onyx IV)</li><li>› Glass Matt Batteries</li></ul>



	PLUMBING AND LP SYSTEMS			OPTIONS
FEATURES	<div><div><div>› Central Water Filtration System in Service Bay</div><div>› Manifold Water Control System</div><div>› Insulated Systems Compartment with Easy Access to Hook-Ups</div><div>› Water Pump Switches in Galley, Bathroom and Service Bay</div></div><div><div>› China Toilet</div><div>› Super Service Center</div><div>› Corian® Shower with Accent Corian® Inlay Design and Corian® Shower Caddy</div><div>› Waste Master Drain System</div><div>› Black and Gray Tank Flush</div></div><div><div>› Water Sprayer in Outside Bay</div><div>› Power Water Hose Reel</div><div>› One Touch Pullout Faucet</div><div>› Insta-Hot® Water System in Kitchen</div><div>› Fresh Water Tank with “Auto Fill”</div></div></div>			<div><div>› Garden Tub with Clear Surround (N/A: 40 Pearl II, III, IV and 42 Topaz II, III, IV )</div><div>› Electric Automatic Winterization</div></div>
	HEATING, VENTS AND AIR CONDITIONING			OPTIONS
FEATURES	<div><div><div>› Aqua-Hot® Heating System</div><div>› Two Low-Profile Ducted 15,000 BTU Roof Air Conditioners with Heat Pumps (40 Pearl II, III, IV; 40 Ruby II, III, IV)</div></div><div><div>› Three Low-Profile Ducted 15,000 BTU Roof Air Conditioners with Heat Pumps (N/A: 40 Topaz II, III, IV; 45 Jade II, III, IV; 45 Onyx IV)</div><div>› Electronic AC/Heat Climate Control System</div></div><div><div>› Dual Climate Controls</div><div>› Dash Heating and Air Conditioner System with Defroster</div><div>› 12V Attic Fan with Sensor and Wall Switch in Kitchen, Bath and Vanity Area</div></div></div>			<div><div>› Two Low-Profile Baseboard Heaters</div></div>
	WINDOWS, DOORS AND AWNINGS			OPTIONS
FEATURES	<div><div><div>› Flush-Mount Radius Dual Pane Safety Glass Dark Tinted Windows</div><div>› Front Entry Door with Air Seal and Removable Top Screen</div><div>› Automatic Front Door Awning</div></div><div><div>› Keyless Remote Entry System with Pocket Remote</div><div>› Tinted Skylight in Bathroom</div><div>› Topper Slide-Out Awnings</div></div><div><div>› Window Awnings with Color-Coordinated Hardware (N/A with Passenger Side Front Slide-Out Windows)</div><div>› Girard® Automatic Patio Awning with Wind Sensor</div></div></div>			<div><div>› Girard® Awning Package Includes: Patio Awning, Entry Door Awning, Window Awnings (Where Applicable) and Slide-Out Topper Awnings</div></div>
	SAFETY			OPTIONS
FEATURES	<div><div><div>› Back-Up Alarm</div><div>› Fire Extinguisher</div><div>› Deadbolt Lock on Entrance Door</div><div>› Lighted Interior and Exterior Grab Handles</div><div>› 120V GFI Protected Circuit</div></div><div><div>› LP Gas Detector</div><div>› Smoke Detector</div><div>› Carbon Monoxide Detector</div><div>› Integrated Pilot and Co-Pilot Three-Point Seat Belts</div></div><div><div>› Third Brake Safety Light</div><div>› Egress Window</div><div>› Security Safe</div></div></div>			<div><div>› Deluxe Security System</div><div>› Collision Avoidance System</div></div>

## SPECIFICATIONS: WEIGHTS & MEASUREMENTS

WEIGHTS	40 Pearl II	40 Pearl III	40 Pearl IV	40 Ruby II	40 Ruby III	40 Ruby IV	42 Topaz II	42 Topaz III	42 Topaz IV	45 Jade II	45 Jade III	45 Jade IV	45 Onyx IV
Gross Vehicle Weight Rating (Lbs.)	48,160	48,160	48,160	48,160	48,160	48,160	48,160	48,160	48,160	48,160	48,160	48,160	48,160
Gross Combined Weight Rating <sup>1</sup> (Lbs.)	58,160	58,160	58,160	58,160	58,160	58,160	58,160	58,160	58,160	58,160	58,160	58,160	58,160
Front Gross Axle Weight Rating (Lbs.)	15,160	15,160	15,160	15,160	15,160	15,160	15,160	15,160	15,160	15,160	15,160	15,160	15,160
Rear Gross Axle Weight Rating (Lbs.)	23,000	23,000	23,000	23,000	23,000	23,000	23,000	23,000	23,000	23,000	23,000	23,000	23,000
Tag Gross Axle Weight Rating (Lbs.)	10,000	10,000	10,000	10,000	10,000	10,000	10,000	10,000	10,000	10,000	10,000	10,000	10,000
MEASUREMENTS	40 Pearl II	40 Pearl III	40 Pearl IV	40 Ruby II	40 Ruby III	40 Ruby IV	42 Topaz II	42 Topaz III	42 Topaz IV	45 Jade II	45 Jade III	45 Jade IV	45 Onyx IV
Wheelbase	250 3/4"	250 3/4"	250 3/4"	250 3/4"	250 3/4"	250 3/4"	271"	271"	271"	280"	280"	280"	280"
Overall Length	41' 7"	41' 7"	41' 7"	41' 7"	41' 7"	41' 7"	43' 11"	43' 11"	43' 11"	44'	44'	44'	44'
Overall Height <sup>2</sup> (to Top of Satellite) (11' 3" to Top of Roof; 12' 2" to Top of A/C)	12' 4"	12' 4"	12' 4"	12' 4"	12' 4"	12' 4"	12' 4"	12' 4"	12' 4"	12' 4"	12' 4"	12' 4"	12' 4"
Exterior Width	100.5"	100.5"	100.5"	100.5"	100.5"	100.5"	100.5"	100.5"	100.5"	100.5"	100.5"	100.5"	100.5"
Interior Height	81"	81"	81"	81"	81"	81"	81"	81"	81"	81"	81"	81"	81"
TANK CAPACITIES	40 Pearl II	40 Pearl III	40 Pearl IV	40 Ruby II	40 Ruby III	40 Ruby IV	42 Topaz II	42 Topaz III	42 Topaz IV	45 Jade II	45 Jade III	45 Jade IV	45 Onyx IV
Gray Tank (Gal.)	56	56	56	56	56	56	56	56	56	56	56	56	56
Black Tank (Gal.)	56	56	56	56	56	56	56	56	56	56	56	56	56
Fresh Tank (Gal.)	100	100	100	100	100	100	100	100	100	100	100	100	100
Fuel Tank (Gal.)	150	150	150	150	150	150	150	150	150	150	150	150	150
LP Tank <sup>3</sup> (Gal.)	25	25	25	25	25	25	25	25	25	25	25	25	25

<sup>1</sup> Towing capacity is limited by GCWR; your vehicle's towing capacity is the difference between the GCWR and the actual vehicle weight, including all water, fuel, passengers and cargo. Your towed vehicle should be equipped with auxiliary brakes if the weight of the towed vehicle exceeds 1,000 lbs. Consult your Owner's Manual for further towing information.

<sup>2</sup> Height measurements include roof satellite.

<sup>3</sup> Actual filled LP capacity is 80% of listing due to safety shut-off required on tank.

All tank capacities are estimated based upon calculations provided by the tank manufacturers and represent approximate capacities. The actual "usable capacity" may be greater or less than the estimated capacities based upon fabrication and installation of the tanks.

The actual overall length of the recreational vehicle may differ from that indicated in the brochure due to variances in the manufacturing process and/or installed components. The actual length may be greater or less than that indicated.

Due to the large variety of options and floorplan arrangements available to our customers, actual weights for each unit may differ. Beaver Motor Coaches provides a weight sticker on each unit we produce, which includes that unit's tank capacities and approximate weight. Consult your local Beaver Motor Coaches dealer for unit availability and further information. The information printed in this brochure reflects product design, fabrication, and component parts at the date of printing. The manufacturer reserves the right, at any time, to make changes in product design, material or component specifications as its sole option, without notice. This includes the substitution of components of a different brand or trade name, which will result in comparable performance.

Component part and appliance manufacturers issue limited warranties covering those portions of the recreational vehicle not covered by the Limited Warranties issued by Monaco Coach Corporation. To learn which specific component parts and appliances are excluded from the Limited Warranties issued by Monaco Coach Corporation, please contact your selling dealership or Monaco Coach Corporation directly, or review the warranty packet inside the recreational vehicle. All information printed in this brochure is subject to change after the date of printing. Some features shown or mentioned in this brochure are optional and may only be available in selected floorplans. Photographs may show props or decorations that are not standard equipment on Beaver Motor Coach models. Beaver Motor Coaches, the Beaver logo and its design, are registered trademarks. All other products and company names are trademarks and/or registered trademarks of their respective holders.





## BEAVER 2006 MARQUIS®

THE BEAVER LINE OF MOTOR COACHES:  
MONTEREY • PATRIOT® • MARQUIS®



*One coach at a time. Yours.™*

### BEAVER MOTOR COACH

91320 Coburg Industrial Way, Coburg, OR 97408

[www.beavermotorcoaches.com](http://www.beavermotorcoaches.com)

Daily factory tours.

(800) 634-0855

### WHEN A COMPANY TREATS YOU THIS WELL, YOU CAN'T HELP BEING LOYAL.

Just ask Melvin and Patricia Engelke. They're on their fourth Beaver coach, a 42 Marquis Amethyst. Yes, they'll tell you all the things they like about it – the roomy floorplan, elegant woodwork, powerful engine and excellent handling. And they'll tell you about the great friends they've made all over North America. But then, they'll tell you what made them Beaver owners for life.

You see, six years ago, the Engelkes were traveling in California when Melvin became ill and flew home to Florida. "A day later, I was diagnosed with Hodgkin's disease and my Marquis was 3,000 miles away," says Melvin. "What did Beaver do? They picked it up, took it to Oregon for maintenance, and then drove it across the country and parked it in front of my house.

"These are good people," he concludes. "They've always stood by me and helped me out."

We're happy to report that Melvin is feeling great now and traveling out west – from New Mexico to California to Washington – and every great golf course along the way.



MONACO COACH CORPORATION

Monaco is traded on the New York Stock Exchange under the listing MNC.

© 2005, Monaco Coach Corporation Litho in USA

0605 NPN:BROBMARQ

