

**AEROLITE** Travel Trailers & Expandables

**AEROLITE**

**AEROLITE**

[www.Dutchmen.com](http://www.Dutchmen.com)



Model 294RKSS, shown in Sienna



Model 294RKSS, Bath



Model 294RKSS, Tri-Fold Sofa



Model 294RKSS,  
shown in Sienna

**AEROLITES** offer well-planned, comfortable seating areas, generous kitchens and practical baths and bedrooms. Families appreciate the time our engineers and interior designers spend to make their vacation experiences the best ever!

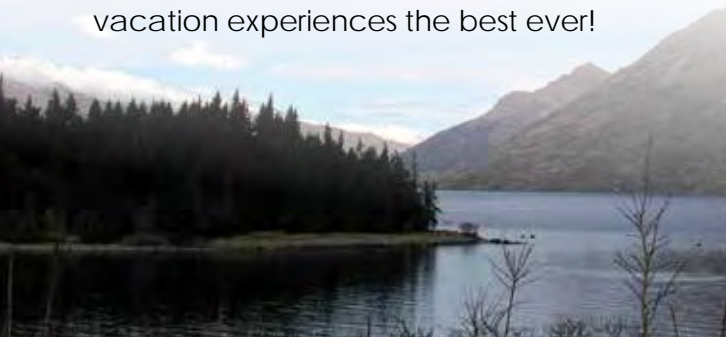





Model 319BHSS, Bunkhouse  
Bed & Wardrobe



Model 319BHSS, Bunkhouse Beds

# AEROLITE

travel trailers offer tons of living and storage space for the money. They utilize every square inch to guarantee your family will have everything packed and ready for the perfect camping experience.

Interiors are offered in three decor packages; Sienna, Sandstone & Entourage



Model 294RKSS,  
Kitchen



Model 294RKSS,  
Entertainment Center



Model 294RKSS,  
Central Control Station



**EVERY** Aerolite comes with a crowned interior roof, giving you the most living space and interior height possible. With its 6-foot 10-inch interior height, Aerolite offers the most headroom.

Families appreciate the residential feel of our interiors, as well as our unique floorplans and fuel-saving aluminum lightweight construction.



Model 282DBHS,  
shown in Sandstone



Model 282DBHS, Dinette & Sofa  
Slide-room shown in Sandstone

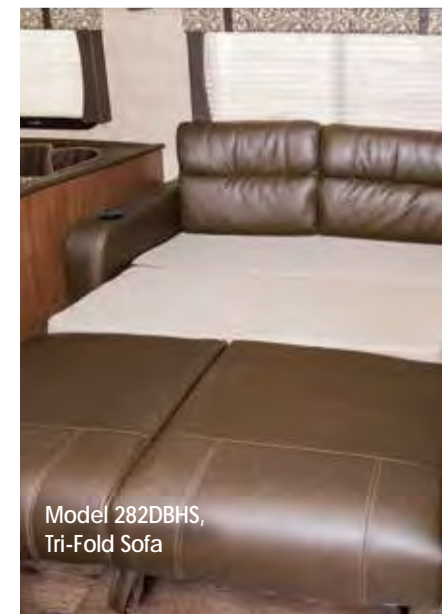

Model 282DBHS,  
Tri-Fold Sofa





Model 282DBHS,  
Bunk Beds in Down Position



Model 282DBHS,  
shown in Sandstone



Model 282DBHS,  
Bunk Beds in Up Position

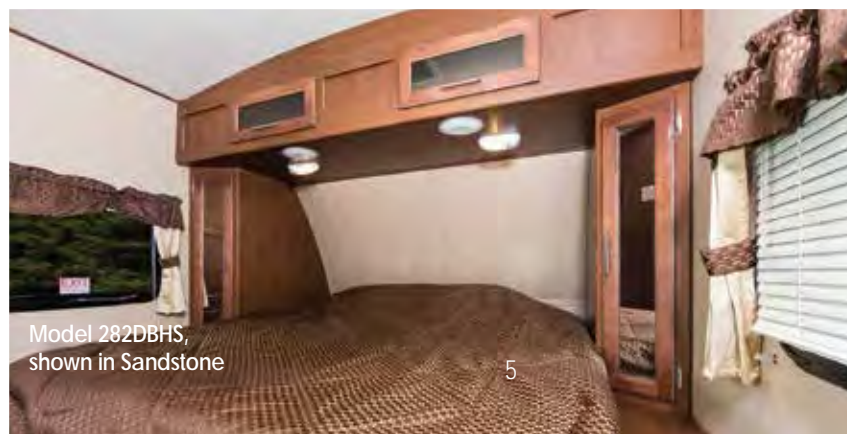

Model 282DBHS,  
shown in Sandstone

For the most current information on any  
of our floorplans, photo images, 360s,  
specifications and standards/options,  
please visit us online at  
[www.dutchmen.com](http://www.dutchmen.com).



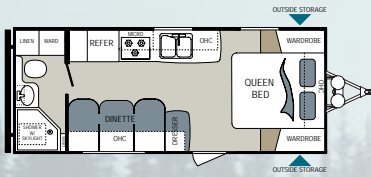

### 205KB

Unloaded Weight . . . . . TBD Length . . . . . TBD  
Hitch Weight . . . . . TBD Fresh Water Capacity TBD  
Cargo Capacity . . . . . TBD Black Water Capacity TBD  
Height . . . . . TBD Grey Water Capacity TBD

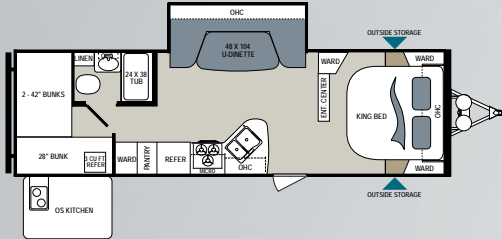

### 250KBHS

Unloaded Weight . . 6,053 Length . . . . . 32' 1"  
Hitch Weight . . . . . 787 Fresh Water Capacity \*52  
Cargo Capacity . . 1,547 Black Water Capacity .28  
Height . . . . . 11' 2" Grey Water Capacity .39

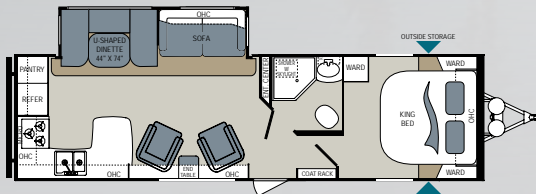

### 294RKSS

Unloaded Weight . . 6,374 Length . . . . . 34' 2"  
Hitch Weight . . . . . 758 Fresh Water Capacity \*52  
Cargo Capacity . . 1,226 Black Water Capacity .28  
Height . . . . . 11' Grey Water Capacity .78

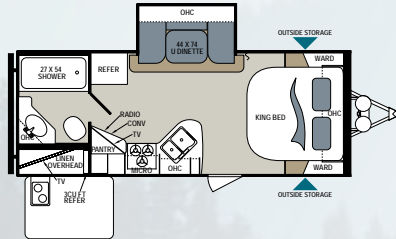

### 213RBSL

Unloaded Weight . . 4,973 Length . . . . . 25' 8"  
Hitch Weight . . . . . 547 Fresh Water Capacity \*52  
Cargo Capacity . . 1,627 Black Water Capacity .28  
Height . . . . . 11' 1" Grey Water Capacity .39

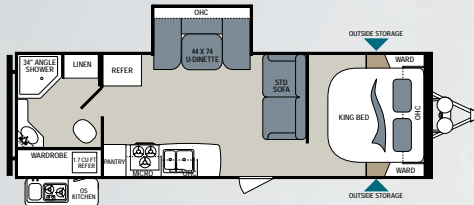

### 254RBSL

Unloaded Weight . . . TBD Length . . . . . TBD  
Hitch Weight . . . . . TBD Fresh Water Capacity TBD  
Cargo Capacity . . . TBD Black Water Capacity TBD  
Height . . . . . TBD Grey Water Capacity TBD

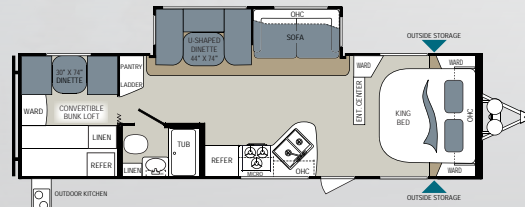

### 315BHSS

Unloaded Weight . . 6,460 Length . . . . . 34'  
Hitch Weight . . . . . 840 Fresh Water Capacity \*52  
Cargo Capacity . . 1,140 Black Water Capacity .28  
Height . . . . . 11' Grey Water Capacity .39

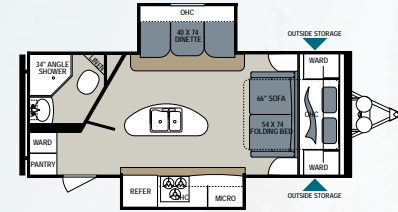

### 218RBSL

Unloaded Weight . . 5,204 Length . . . . . 25' 2"  
Hitch Weight . . . . . 520 Fresh Water Capacity \*52  
Cargo Capacity . . 2,396 Black Water Capacity .28  
Height . . . . . 10' 10" Grey Water Capacity .39

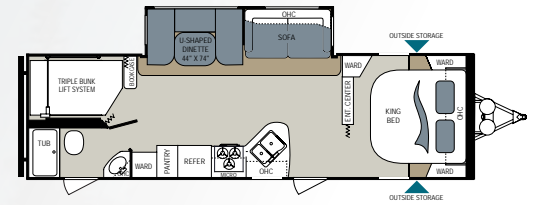

### 282DBHS

Unloaded Weight . . 6,125 Length . . . . . 33'  
Hitch Weight . . . . . 857 Fresh Water Capacity \*52  
Cargo Capacity . . 1,475 Black Water Capacity .28  
Height . . . . . 11' 1" Grey Water Capacity .39

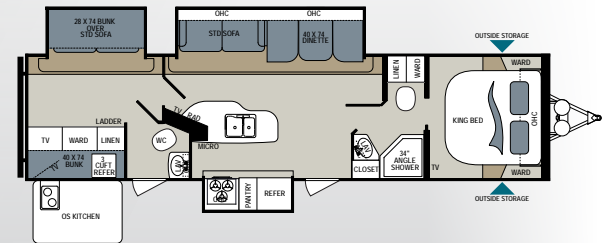

### 319BHSS

Unloaded Weight . . 8,280 Length . . . . . 37' 7"  
Hitch Weight . . . . . 1,159 Fresh Water Capacity \*52  
Cargo Capacity . . 1,400 Black Water Capacity .56  
Height . . . . . 11' 5" Grey Water Capacity .56

Disclaimer: Features, floorplans and specifications are subject to change without notice. Our weights represent how most units are built, inclusive of many commonly-ordered options.

\*Fresh water capacity includes water heater



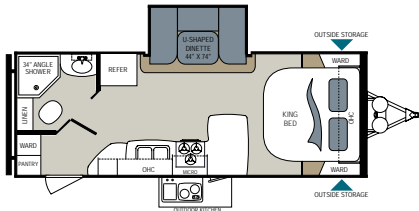

### 225RBSL

Unloaded Weight . . 5,074    Length . . . . . 26' 11"  
Hitch Weight . . . . . 609    Fresh Water Capacity \*52  
Cargo Capacity . . . 1,526    Black Water Capacity .28  
Height . . . . . 10' 11"    Grey Water Capacity .39

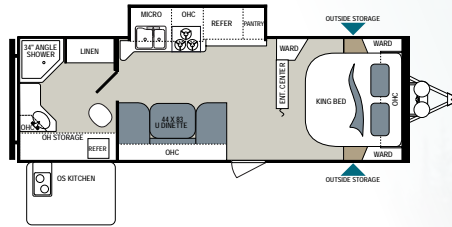

### 248RBSL

Unloaded Weight . . 5,402    Length . . . . . 29' 4"  
Hitch Weight . . . . . 648    Fresh Water Capacity \*52  
Cargo Capacity . . . 1,198    Black Water Capacity .28  
Height . . . . . 11'    Grey Water Capacity .39

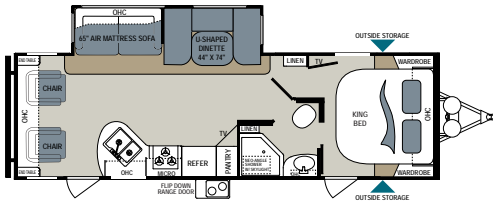

### 288RLSS

Unloaded Weight . . 6,045    Length . . . . . 31' 4"  
Hitch Weight . . . . . 786    Fresh Water Capacity \*52  
Cargo Capacity . . . 1,555    Black Water Capacity .28  
Height . . . . . 11'    Grey Water Capacity .39

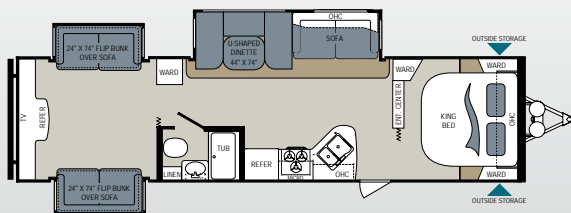

### 326BHSI

Unloaded Weight . . 7,408    Length . . . . . 36' 11"  
Hitch Weight . . . . . 1,037    Fresh Water Capacity \*52  
Cargo Capacity . . . 2,272    Black Water Capacity .28  
Height . . . . . 11' 3"    Grey Water Capacity .39

## Expandables

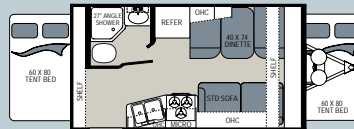

### 174E

Unloaded Weight . . 3,191    Length . . . . . 18' 6"  
Hitch Weight . . . . . 287    Fresh Water Capacity \*52  
Cargo Capacity . . . 659    Black Water Capacity .28  
Height . . . . . 10'    Grey Water Capacity .39

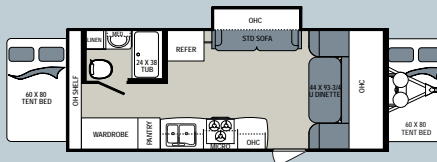

### 204ES

Unloaded Weight . . . TBD    Length . . . . . TBD  
Hitch Weight . . . . . TBD    Fresh Water Capacity TBD  
Cargo Capacity . . . . TBD    Black Water Capacity TBD  
Height . . . . . TBD    Grey Water Capacity TBD

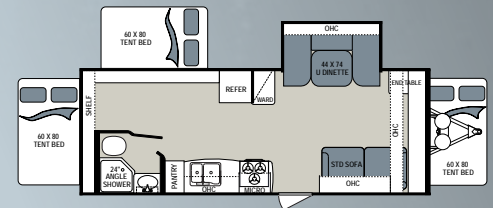

### 224ES

Unloaded Weight . . 4,536    Length . . . . . 25' 11"  
Hitch Weight . . . . . 608    Fresh Water Capacity \*52  
Cargo Capacity . . . 2,064    Black Water Capacity .28  
Height . . . . . 9' 11"    Grey Water Capacity .39



Model 319BHSS,  
shown in Entourage



Model 174E,  
shown in Entourage

# AEROLITE Standards & Options

## EXTERIOR FEATURES

Full Painted Fiberglass Front Cap  
Easy Lube Axles  
Spare Tire/Carrier  
Diamond Plate  
Enclosed Underbelly  
Dark Tinted Safety Glass Windows  
Frameless Windows  
Outside Speakers  
Battery Disconnect (Diamond PKG)  
Hitch Light  
Patio Light  
Stab Jacks  
LED Power Awning (Diamond PKG)  
Black Tank Flush  
LP Cover  
30 LB Bottles (Diamond PKG)  
Exterior Spray Port  
LP Quick Disconnect  
Exterior Pull Out 2 Burner Cooktop  
(where applicable)  
Extended Down Spouts  
TV Antenna  
Deluxe Folding Entry Assist Handle  
Double or Triple Entry Step  
Satellite Hookup

## INTERIOR FEATURES

Wood Grain Beauflor® Flooring  
Night Shades in Living Area  
Mini Blinds - Bunk Area, Bedroom, Bathroom  
Tri-Fold Deluxe Sofa (where applicable)  
Flip Sofa (where applicable)  
Bath Skylight  
Tub Surround  
Medicine Cabinet w/Mirror  
12V Bath Exhaust Fan  
Valance Legs  
Under Bed Storage  
3 Burner Range w/Oven  
Rangehood w/12V Fan/Light  
6 GAL Gas/Electric/DSI Water Heater  
Bluetooth AM/FM/CD/DVD Player (Diamond PKG)  
Cable TV Hookup w/Booster  
Bedroom TV Hookup w/LCD Backer  
Microwave  
13,500 BTU Ducted A/C  
6 CU FT Double-Door Refer  
Black Refer Insert  
Porcelain Foot Flush Toilet (Diamond PKG)



Check us  
out on  
Facebook!

## MANDATORY OPTIONS

Premium PKG  
Aero PKG  
Radial Tires  
Power Tongue Jack  
Heated Enclosed Underbelly  
Deluxe Tri-Fold Sofa  
15,000 BTU A/C IPO 13,500 BTU

## OPTIONS

2nd 13,500 BTU A/C (319BHSS, 326BHSL)  
Tri-Fold IPO U-Shaped Dinette (213RBSL, 225RBSL)  
29" Flat Screen TV (288RLSS only)  
32" Flat Screen TV

## AEROLITE PREMIUM PACKAGE

Aluminum Wheels  
Frameless Windows  
Aztec Grey Gelcoat Fiberglass  
Power Awning w/Adjustable legs  
Crowned 6' 10" Interior Roof  
80" X 72" King Bed  
Black Tank Flush



Scan our quick  
response code to  
open our website,  
and explore the  
many products  
we have to offer!

## DECOR CHOICES



Entourage



Sandstone



Sienna



www.Dutchmen.com



**Dutchmen**

Disclaimer: Product information is as accurate as possible as of the date of publication of this brochure. Features, floorplans and specifications are subject to change without notice. Please also consult our website for more current product information and specifications.

Tow Vehicle Disclaimer CAUTION: Owners of Dutchmen Manufacturing, Inc., recreational vehicles are solely responsible for the selection and proper use of tow vehicles. All customers should consult with a motor vehicle manufacturer or their dealer concerning the purchase and use of suitable tow vehicles for Dutchmen products. Dutchmen disclaims any liability or damages suffered as a result of the selection, operation, use or misuse of a tow vehicle. Dutchmen's limited warranty does not cover damage to the recreational vehicle or the tow vehicle as a result of the selection, operation, use or misuse of the tow vehicle.

P.O. BOX 2164 • 2164 Caragana Court Goshen, Indiana 46526 • Sales: 574.537.0600 Fax: 574.975.0626

Your Local Dealer