

*Sunny Brook RV*

2006  
TITAN SURV



A silhouette of a person in a wetsuit, seen from the back, holding a golf club horizontally across their shoulders. The person is looking out over a body of water towards a distant shoreline under a dramatic sky with scattered clouds and a bright sun low on the horizon, creating a shimmering reflection on the water.

# 2006 TITAN SURV

It's grand! Yet behind all that finery is an adventurous spirit ready to take you to a place where dreams come true. Introducing the TITAN SURV. A highly refined, luxurious home with a practical side. This is living.





A built-in, portable garage

Bathroom with full, surround shower

Optional loft adds a bunk room

Long Weekend



# 2006 TITAN SURV DETAILING, FLOORPLANS AND SPECIFICATIONS

Hand chosen by our experienced interior designers, these fabrics afford the texture and colors to please even our most discriminating customer. Higher quality materials and plush, contemporary styling let everyone know you have good taste.



Copper Mountain

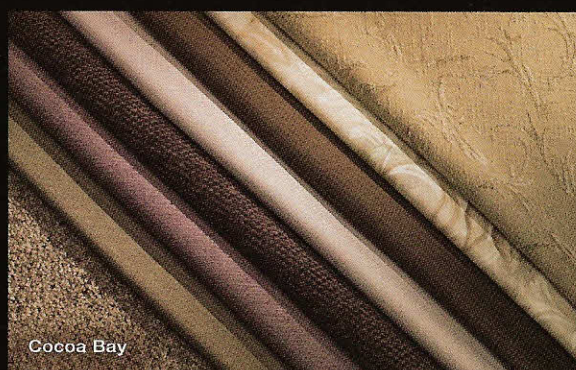

Cocoa Bay



Plum Creek



Blue Ridge



Our ceramic-look vinyl flooring will give your TITAN the look of a fine home with this popular standard.

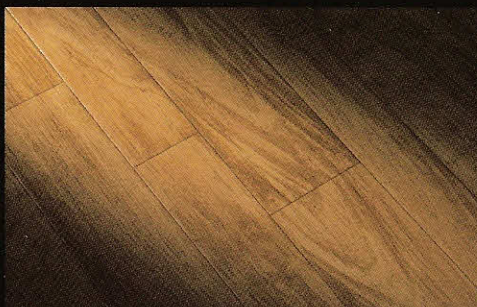

The optional, upgraded wood-look flooring is made from a heavy vinyl. It looks just like wood, but it's ultra-durable.

## 319SURV † 349SURV † 391SURV

Exterior Length*	32'-1"	35'-1"	39'-7"
Exterior Height**	12'-6"	12'-6"	12'-6"
Exterior Width	8'-2.5"	8'-2.5"	8'-2.5"
Interior Height	7'-5"	7'-5"	7'-5"
Dry Hitch Weight***	2,290	2,336	2,794
Dry Gross Weight***	10,730	11,925	13,192
GVWR	15,000	18,000	18,000
Triple 6,000 lbs	Str. Axles <sup>(dual)</sup>	Str. Axles	Str. Axles
Tire Size	ST235/80 R16E	ST235/80 R16E	ST235/80 R16E
Hitch Height	46"	46"	46"
Awning Size	16'	19'	19'
Furnace Size	31M BTU	35M BTU	35M BTU
Domestic Gas ††	Dbl. Door	Dbl. Door	Dbl. Door
Fresh Water Cap.	60	60	100
Black Water Cap.	50	50	50
Gray Water Cap.	90	90	90
Sleeping Capacity	4 (Opt. 8)	4 (Opt. 8)	4 (Opt. 8)

## 391KSURV 412SURV 434SURV

Exterior Length*	39'-7"	41'-7"	43'-7"
Exterior Height**	12'-6"	12'-10.25"	12'-6"
Exterior Width	8'-2.5"	8'-2.5"	8'-2.5"
Interior Height	7'-5"	7'-5"	7'-5"
Dry Hitch Weight***	2,808	2,985	2,790
Dry Gross Weight***	13,772	13,532	13,192
GVWR	18,000	18,000	18,000
Triple 6,000 lbs	Str. Axles	Str. Axles	Str. Axles
Tire Size	ST235/80 R16E	ST235/80 R16E	ST235/80 R16E
Hitch Height	46"	46"	46"
Awning Size	19'	19'	19'
Furnace Size	35M BTU	35M BTU	35M BTU
Domestic Gas ††	Dbl. Door	Dbl. Door	Dbl. Door
Fresh Water Cap.	60	100	100
Black Water Cap.	50	50	50
Gray Water Cap.	90	90	90
Sleeping Capacity	4 (Opt. 8)	4 (Opt. 8)	4 (Opt. 8)

\* Measured from center of king pin to rear bumper

\*\* Includes air conditioner on roof

\*\*\* Does not include optional equipment

† Extended Pin. Box unavailable

†† With electric refrigerator



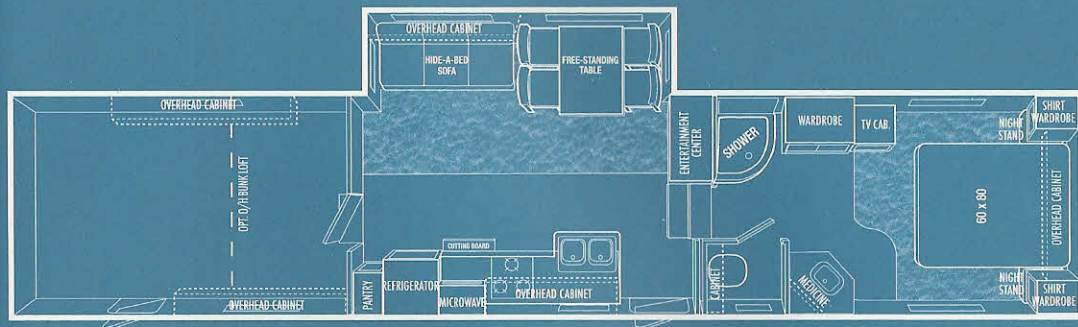

**434SURV** | Available in options: BD, D, RT and Bunk

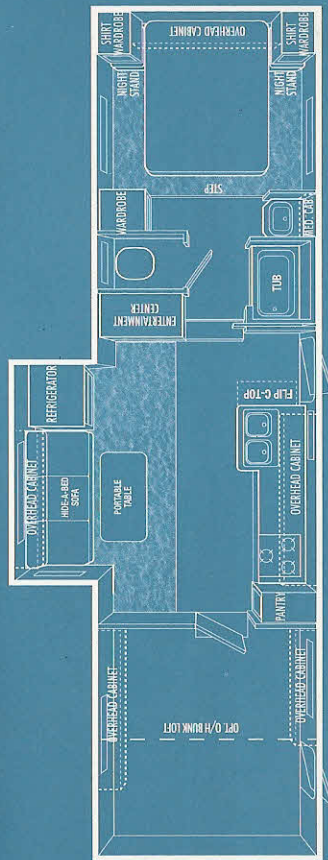

**319SURV** | Available in options: BD, D, F and Bunk

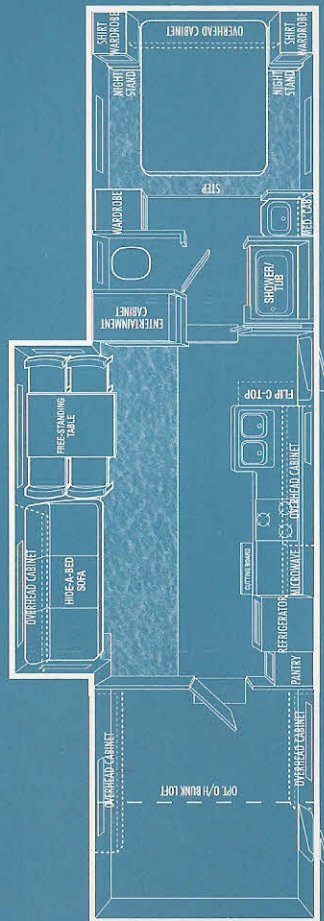

**349SURV** | Available in options: BD, D and Bunk

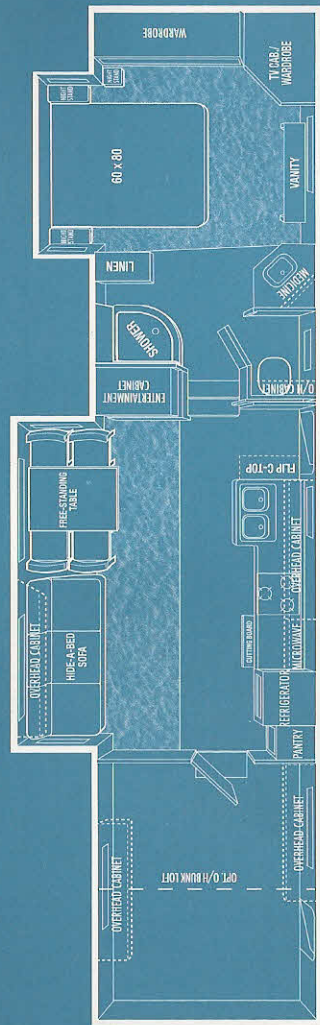

**391SURV** | Available in options: BD, D, IB, RT and Bunk

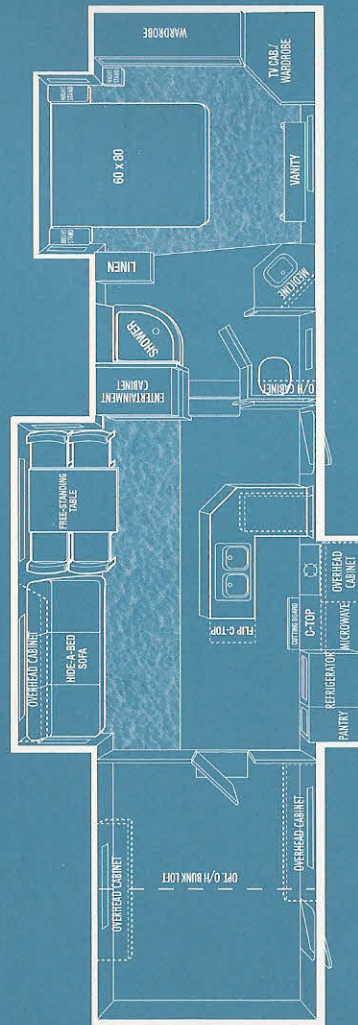

**391KSURV** | Available in options: BD, D, IB, RT and Bunk

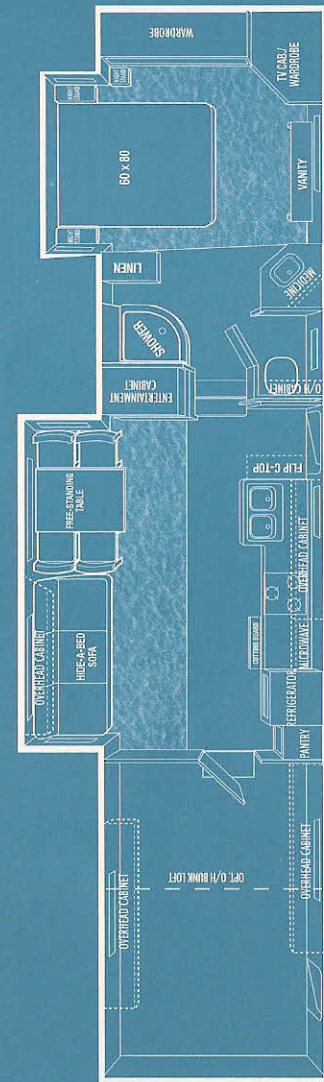

**412SURV** | Available in options: BD, D, IB, RT and Bunk

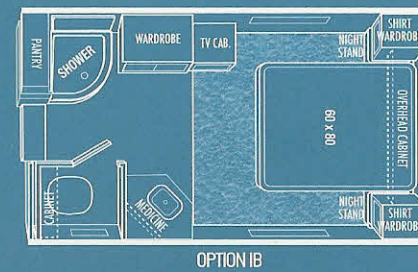
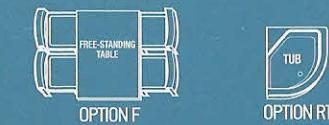
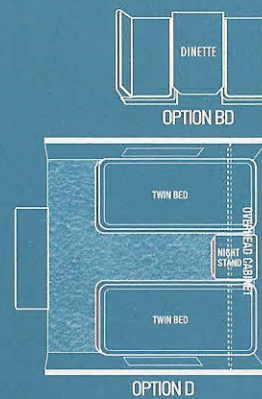



# CONSTRUCTION FEATURES

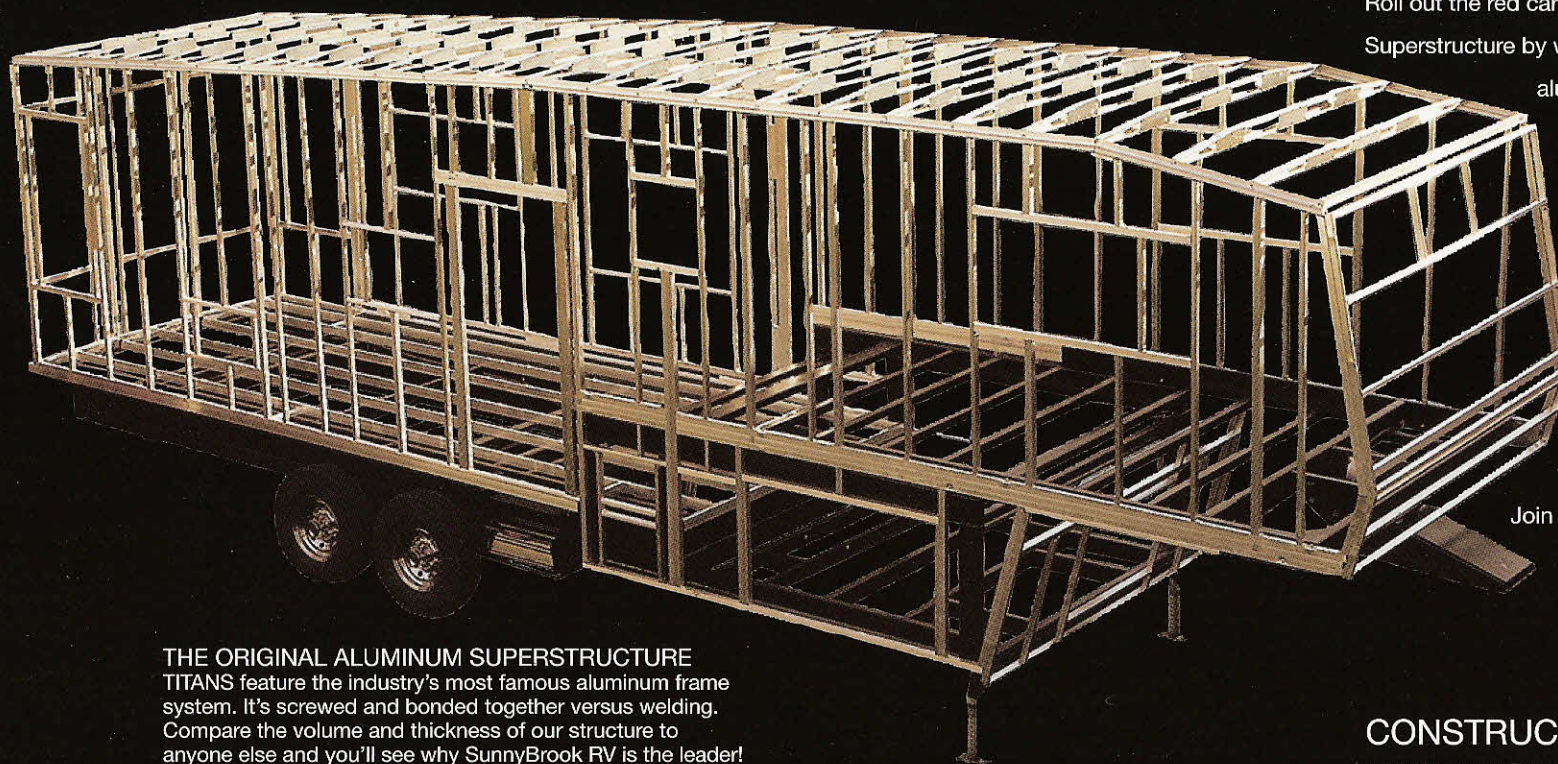

**THE ORIGINAL ALUMINUM SUPERSTRUCTURE**  
TITANS feature the industry's most famous aluminum frame system. It's screwed and bonded together versus welding. Compare the volume and thickness of our structure to anyone else and you'll see why SunnyBrook RV is the leader!

Roll out the red carpet. This is the original Superstructure by which all the other so-called aluminum-framed fifth-wheel and travel trailer brands are measured. Does anyone build to SunnyBrook's high standards? See for yourself. Our aluminum Superstructure is stronger, tows easier and will look better longer—giving you a higher return on your investment than any of the want-to-be's flooding the market today. Join the elite club.

## CONSTRUCTION HIGHLIGHTS

- All Aluminum Superstructure
- Thick Box/Tube Steel Frame Chassis for Strength
- Fifth-wheels Feature 16" Triple Stacked Steel Central Frames
- 5/8" Tongue and Groove Exterior Grade Plywood Floors
- Congoleum Ultima Residential Vinyl Floor Covering
- Nylon Carpeting (FHA Approved) with Rebond Carpet Pad
- 4" Crowned Aluminum Roof Rafters (16" On Center)
- 1/2" Exterior Grade Plywood Roofs with Ladder
- L.E.D. Clearance and Tail Lights
- Lighted Main Entry with 4 Steps
- Extra Large Basement Storage in Fifth-Wheels
- Corian Edged Countertops
- Endura Cabinet Door and Drawer Fronts (10 year Warranty)
- 60 x 80 Pillow Top Queen Mattress (Most Models)
- One Piece Fiberglass Shower with Glass Shower Door
- Enclosed, Insulated and Heated Holding Tanks (Fresh, Gray, Black)
- Deep Tinted Safety Glass Windows

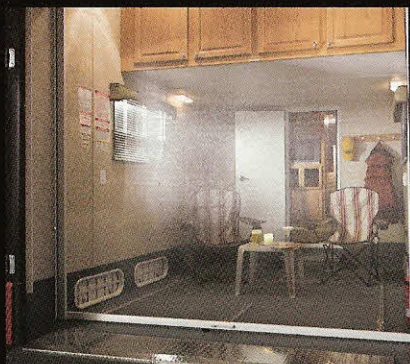

Large cargo bay features floor liner, tie-downs, overhead cabinetry and this optional pull-down screen.



A 28 gallon fuel reservoir with fill nozzle is a great option if you're hauling motorcycles or ATVs.



This standard 30 AMP marine-style power cord is removable and stores out of the way.



# STANDARDS | OPTIONS

## CONSTRUCTION

All Aluminum Bonded Superstructure  
16" Double Stacked Tube Steel Chassis  
5/8" Tongue and Groove Exterior Grade Plywood Floors  
Floor is Bonded and Screwed to Aluminum Floor Joists on 16" Centers  
Tapered Aluminum Truss-Type Roof Rafters on 16" Centers  
½" Exterior-Grade Plywood Roof Decking  
R-7 Fiberglass Insulation in Side Walls  
R-7 Fiberglass Insulation in Floor  
R-11 Fiberglass Insulation in Roof  
Fome-Cor Insulation Board (Roof, Front & Rear Walls)

## INTERIOR

Autumn Maple Cabinetry with Black Glaze  
Congoleum Ultima Deluxe Ceramic Tile  
Look Vinyl Flooring  
Congoleum Ultima Wood Look Vinyl Flooring  
Nylon Filament Carpeting with Rebond Padding (FHA Approved)  
Corian Edged Counter and Cabinet Tops  
Corian Countertop Upgrade for Kitchen and Bathroom  
Color Coordinated Day/Night Shades (N/A Kitchen and Bath)  
Mini Blinds in Kitchen and Bathroom  
Solid Oak Framed Cabinet Door and Drawer Fronts  
Pocket Screwed Construction on all Cabinet Faces  
Fifth Wheel Slide Rooms are 6'3" Interior Height  
Heated Below Floor Water Tanks for More Inside Storage  
Deluxe Lighting Upgrade Package (Flourescent Lights Down Center of Unit and Stool Room, 4 ½" Recessed Halogen Lights in Kitchen)

## KITCHEN

Large Stainless Steel Look Acrylic Double Sink with Covers  
Single-lever Faucet with Pull Out Sprayer on Kitchen Sink  
Dometic Large Double Door Refrigerator\*\*  
Dometic 12 cu/ft. Side by Side Refrigerator  
Ice Maker (N/A in Units with Kitchen Slide)  
Raised Oak Refrigerator Door Panels  
Microwave Oven  
Convection Microwave  
Kitchen Countertop Extension (Select Models)  
Three Burner Range and Oven with Piezo Ignition  
Water Filter at Kitchen Sink with Separate Faucet  
Waste Basket (Pull Out on Most Models)

S Oak Table and 4 Chairs with Hidden  
S Storage Compartments  
S Roof Vent  
S Fantastic Fan with Rain Sensor  
S Create-a-Breeze Roof Vent (Kitchen or Bedroom)  
S Booth Dinette

## LIVING ROOM

S Hide-a-Bed  
S End Table  
S Ceiling Fan  
S Window Draperies with Wrought Iron Tie Backs  
S Wallpaper Border  
S Sofa Pillows  
S Recessed Halogen Lights with Wall Switch in Slide Room

## BATHROOM

S Acrylic Bathroom Lavatory Sink  
O Brushed Nickel Single-Lever Faucet on Lavatory Sink  
S Sealand Porcelain Toilet with Sprayer Upgrade  
O Create-a-Breeze in Hallway and Stool Room  
S Skylight in Shower  
S One-piece Fiberglass Shower  
S Tub Option  
S Glass Shower Door  
S 32" x 34" Shower on 391, 391K, & 412 FW with Queen Bedroom Slide and Washer & Dryer  
S Congoleum Ultima Ceramic Tile Look Flooring

## BEDROOM

S Bedroom Slide-out (60 x 80 Queen Bed with Night Stands - N/A on 319, 349, & 434 SURV)  
S California King Width Bed (72 x 80) (Not Available on 319, 349, & 434 SURV)  
O Bunk Loft  
S Deluxe Pillow Top Mattress  
S Deluxe Curtains and Bedspread  
S Pillow Shams and Decorative Accent Pillow  
S Deluxe Headboard  
S Wall Sconces at Head of Bed  
O Bedroom Slide-out Delete (Bed Off Front Wall - Select Models)  
S Gas Piston Assist Beds with Finished Storage  
S Edge Trimmed Bed Board  
S Lighted Under Bed Storage Compartment (FW only)  
S Safe  
S Lighted Wardrobe (Select Models)  
S Shirt Wardrobes (Select Models)  
S Wall Switched Overhead Light  
O Fantastic Fan with Rain Sensor and Wall Switch  
S Create-a-Breeze Vent

## ENTERTAINMENT

S TV Antenna with Power Booster  
S Surround Sound AM/FM Stereo with CD & DVD  
S Cable TV Hook-up and Telephone Jack  
O TV Outlets in Bedroom  
O TV Outlet in Basement  
O Pre-wired For Satellite to Off Door Side of Unit  
O Satellite Dish  
O 27" Flat Screen Color Television

## SYSTEMS

S AC/DC Power Converter With Charger  
S Floor-Ducted, Forced Air Furnace  
S Dual 30 lb. Liquid Propane Tanks with Auto Change Over Regulator  
S Dual 40 lb. Liquid Propane Tanks Upgrade  
S LP Quick Disconnect  
S Enclosed, Insulated and Heated Holding Tanks  
S Enclosed, Insulated and Heated Fresh Water Tanks  
S Atwood 10 Gallon DSI Hot Water Heater  
S Water Heater By-Pass System  
S Central Vacuum  
S Dometic 15,000 BTU Ducted Air Conditioner \*\*  
S Pre-Wire for 2nd AC in Bedroom or Garage (Requires 50 amp Electrical Service)  
O 13.5 AC for Bedroom or Garage (Requires 50 amp Electrical Service)  
O 15.0 AC for Bedroom or Garage (Requires 50 amp Electrical Service)  
O Heat Strip For Air Conditioner  
S Cool Air Diverter with all Air Conditioners  
S Washer / Dryer Prep or Installed (N/A on 319 & 349) (Includes 50 Amp Electrical Service)  
S No-Fuss Flush for Black Tank  
S Generator Prep or Installed with Carbon Monoxide Detector (FW only)  
O Electric Fireplace - Requires 50 Amp  
O 30 amp Electrical Service with Detachable Power Cord  
S 50 amp Electrical Service with Detachable Power Cord  
S Fuel Storage Tank  
S Fuel Pump, Hose and Nozzle

## EXTERIOR

S Gel-Coat Fiberglass Sidewalls and End Caps  
S Dead Bolt Locks on Entry Doors  
S Door Side Patio Light, and Front and Roadside Setup Lights  
S Security Lights with Wall Switches (4 Corners)  
S 30" Main Entry Door (Wheelchair Accessible)  
S Lights in Exterior Storage Compartments  
O Storage Slide Tray  
O Black Framed Radius Windows

S White Framed Radius Doors  
S Entry and Baggage)  
S 12 Volt Power Front Jacks  
S A&E 8500 Series Awning \*\*  
S A&E 9000 Series Awning with Metal Wrap  
S A&E One Step Awning  
O Slide Room Awnings  
O Leveling Jacks  
O 12 Volt Power Rear Stabilizer Jacks  
S Outside Shower  
S Reinforced Rubber Roof  
S Detachable Ladder with ½" Plywood Roof Decking  
S Thermopane Windows  
S Safety Glass Windows  
S Deep Tint Windows  
S Aluminum Wheels Upgrade  
S Spare Tire and Carrier  
S Folding Assist Grab Handle  
S Extended Pin Box (319 & 349 SURV Only)  
O MOR/ryde Rubberized Medium Pin Box Upgrade  
O MOR/ryde Rubberized Extended Pin Box Upgrade (319 & 349 SURV only)  
O King Combo Gooseneck  
O Hitch Upgrade  
O L.E.D. Taillights and Clearance Lights  
S Enclosed Underbellies  
O Lighted Main Entry Steps  
S Lower Skirt Paint Upgrade

## GARAGE

S Custom Paint Package Upgrade  
O Diamond Plate Entry Step  
O Solid Wall Between Garage and Main Living Area  
O Spray-on Bed Liner on Floors, Sidewalls and Ramp  
S Mini Blinds on Windows  
S Overhead Cabinet Storage  
O Rear Roll-Up Screen Door  
O Cargo Tie Down Rails

## SAFETY

S 16" Name Brand Radial Tires \*\*  
S All Wheel Electric Brakes  
S Break-Away Switch  
S Smoke Detector  
S L.P. Leak Detector  
S GFI Electrical Circuit Protection  
S Dexter Nev-R Lube Axles with Sealed Bearings \*\*  
O Shock Absorbers  
S MOR/ryde RE Suspension

\*\* Mandatory Option-Included in TITAN Consumer Package





www.sunnybrookrv.com  
(574) 825-5250  
201 14th Street  
Middlebury, IN 46540  
Printed in the USA  
© 2005 SunnyBrook RV, Inc

*SunnyBrook®*  
*Mobile Scout®*

All illustrations and specifications contained in this literature are based on the latest product information available at the time of printing. SunnyBrook RV, Inc. reserves the right to make changes to colors, materials, specifications and pricing without notice or obligation. Photography may show optional equipment available at an additional cost. Items used as props in photography are not part of the packages. All liquid capacities and weights are approximate and dimensions are nominal. SunnyBrook RV reserves the right to make changes and improvements without incorporating these changes into similar models produced at an earlier date. Consult your local, authorized SunnyBrook or Mobile Scout dealer for the latest information and/or changes. SunnyBrook RV is a member in good standing of the RVIA.