

Pioneer Spirit and Pioneer



**SO MUCH FUN OUT THERE, YOU CAN
ALMOST HEAR YOUR MOM CALLING
YOU IN FOR SUPPER.**



TRAVEL TRAILERS

Built-in Value | Quality | Functional Floor Plans | Appealing Décors | Enclosed & Heated Chassis Available



Spacious Pantry and TV Shelf
so you can enjoy the Fishing Channel and chips at the same time. (TV not included.)



The AM/FM Radio with CD Player
(available) provides instant relief from the relentless chorus of "99 Bottles of Beer on the Wall."



The Overhead Storage
is located right over the sink, so it's handy to put clean dishes away. And the cabinets are deep enough for full-size plates.



The Double-Bowl Acrylic Sink
makes doing the dishes easier with one side for washing and one for rinsing. The high-rise faucet leaves room for big pots.



The Microwave
(available) heats dinner fast so you can get to the best part: campfire and s'mores.

A LOT OF KUMBAYAH FOR THE BUCK. Exceptionally well priced, Pioneer™ and Pioneer Spirit™ are high-quality, feature-packed travel trailers designed for family fun in the great outdoors. At the same price you'd expect to pay for a used, second-hand trailer, you can camp in comfort in a brand-new model.

Pioneer 27FQS shown in Blue Topaz interior décor with Clear Oak wood finish.



^ **The Appealing Décor** makes camping more comfy with nice window treatments, warm cabinetry and Flexsteel® furniture that carries a limited lifetime warranty. (Select models.)



^ **The Galley** boasts the finest brand names, with a Dometic® refrigerator, Magic Chef® range and HydroFlame furnace.



The Convertible Sofa Bed

does double duty. By day, three people can lounge there. At night, two people can sleep. Hopefully, nobody snores.



The Wardrobe

is the perfect place for his shirts, reserving the closet for her more extensive wardrobe.



The Shower/Tub Combo

is perfect for cleaning kids who always seem to soak up a mountain's worth of dirt in a day.

One tour through a Pioneer and you'll see the innovation in our floor plans. For example, our bedrooms are situated east to west, which gives you more space to walk around and make the bed. Try to find that in somebody else's floor plan – bet you won't.



<The Master Bedroom features a comfortable innerspring mattress that's sure to beckon after a day of hiking. Hidden below, you'll find a lift-up platform with tons of storage.

> Under Bed Storage is the perfect place to stow extra down comforters.





Drawing is for illustrative purposes only to highlight aspects of Pioneer construction. Actual RV design depends on model and is subject to change.

TESTED TO EXTREMES. PROVEN DURABILITY.

You're going to entrust your vacation days to Pioneer, so we've tested the day-lights out of the prototypes. They're exposed to miles of durability testing, and those components that don't survive are redesigned until they do. The end result is a tough trailer you can count on for years to come.

1. **ENGINEERED RADIUSED CEILING TRUSS** - Helps to ensure strength and water runoff.
2. **ARCTIC WHITE SEAMLESS, ONE-PIECE RUBBER ROOF** - Provides the ideal weather seal.
3. **INTERIOR WALL PANEL** - Features a durable, easy-to-clean, decorative vinyl.
4. **STEEL CHASSIS** - Provides optimal strength, durability and performance.
5. **WOOD DECKING** - Provides a solid backbone for the roof construction.
6. **2" X 2" WOOD FRAMED SIDEWALL** - Provides a solid foundation for the sidewall construction.
7. **R-7 FIBERGLASS INSULATION** - Helps to ensure interior comfort in every season.
8. **.024" ALUMINUM SIDING** - Complete with a baked-on enamel paint, this aluminum siding offers rigidity while still being affordable.
9. **5/8" TONGUE AND GROOVE DECKING** - Provides structural strength floor construction.
10. **2" X 2" STUDS 16" ON CENTER** - Utilizing residential framing methods, this is the structural component of our front section.
11. **2" X 3" FLOOR JOISTS** - Provides the foundation for the enclosed chassis.
12. **ENCLOSED CHASSIS** - Is a lightweight, seamless, durable weather barrier (available).

PIONEER INTERIOR DÉCOR CHOICES

- A** Sofa
 B Dinette Cushions & Throw Pillow
 C Bedspread & Headboard
 D Window Treatments



CLEAR OAK



BLUE TOPAZ



BASIL

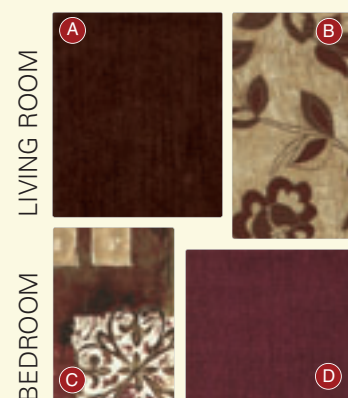

MULBERRY

CHOOSE YOUR PIONEER.

Take your pick from two different trim levels, each packed with value. There's the Pioneer Spirit, the ultimate affordable trailer, or the Pioneer with even more bells and whistles. It includes things like an upgraded stereo with DVD, air conditioner and stabilizer jacks. But whichever way you go, Pioneer lets your family camp in comfort and stay within your budget.



Abundant Cargo Storage
gives you more room for your equipment, toys, and the ton of stuff families need to camp. And it makes loading and unloading a breeze.



Exterior Shower
(available) is unbelievably handy to rinse off dirty dog paws, smelly waders and the occasional kid who fell (or jumped) in the mud hole.



The Enclosed Chassis
is available on Pioneer models 26' and over. No need to migrate to warmer climates. The enclosed chassis allows heating the holding tanks to help prevent freezing in colder weather.

PIONEER SPIRIT FLOOR PLANS

18CK Sleeps 6*

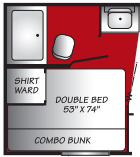

OPT. B71 COMBO O'HD BUNK W/PADS

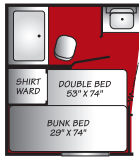

OPT. B46 DOUBLE BED W/BUNK

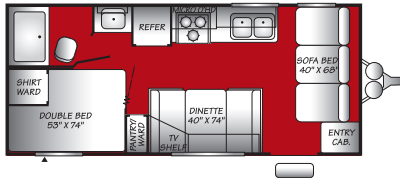

24BH Sleeps 6*

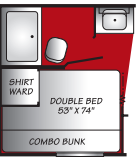

OPT. B71 COMBO O'HD BUNK W/PADS
OPT. B46 DOUBLE BED W/BUNK
OPT. O64 GARAGE STORAGE
OPT. O66 GARAGE STORAGE

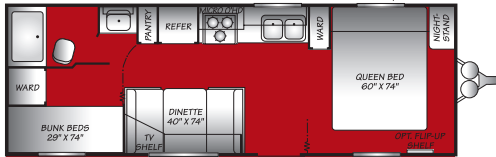
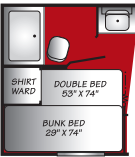

28BH Sleeps 8*

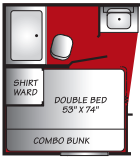

OPT. B71 COMBO O'HD BUNK W/PADS

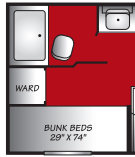

OPT. O64 GARAGE STORAGE
OPT. O66 GARAGE STORAGE

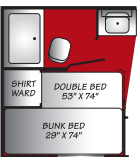
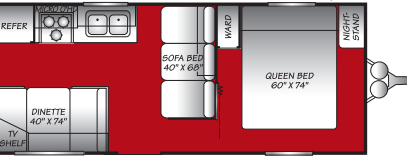

OPT. B46 DOUBLE BED W/BUNK

▲ = Exterior Storage

* Sleeping capacity is a variable number and is affected by items such as size of occupants, options and floor plan. Some models are not available in all areas of the country. Please see your local dealer for model availability.

PIONEER FLOOR PLANS

21CKS Sleeps 6*, Single Slide-Out

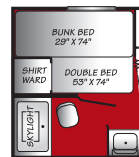

OPT. B46 DOUBLE BED W/BUNK

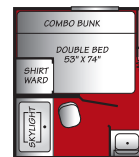
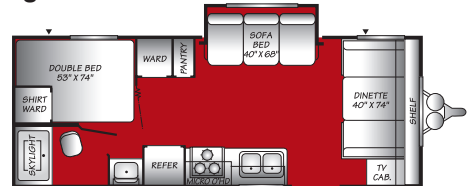

OPT. B71 COMBO O'HD BUNK W/PADS

24RKS Sleeps 6*, Single Slide-Out

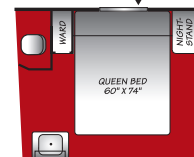
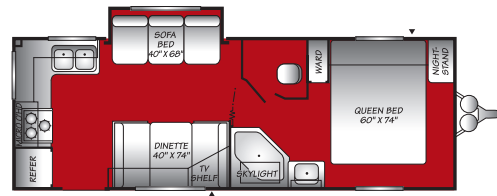

OPT. B44 FRONT ENTRY DOOR

PIONEER FLOOR PLANS

25FQ
Sleeps 6*

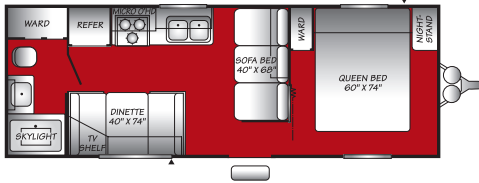

26BHS
Sleeps 7*, Single Slide-Out

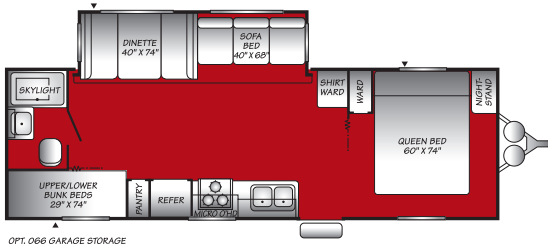

27FQS
Sleeps 6*, Single Slide-Out

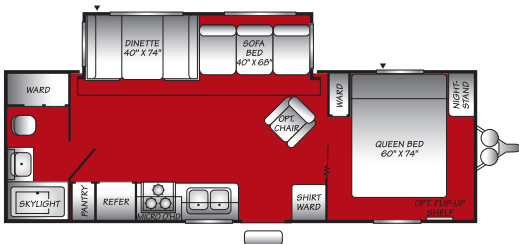

31BD2S
Sleeps 8*, Double Slide-Out

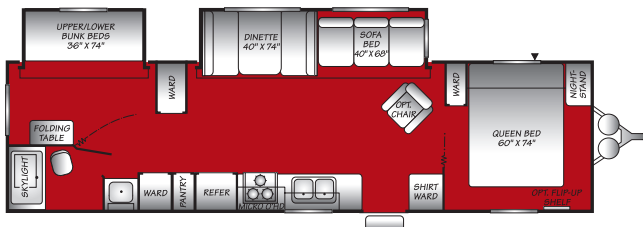

39BD2S
Sleeps 8*, Double Slide-Out

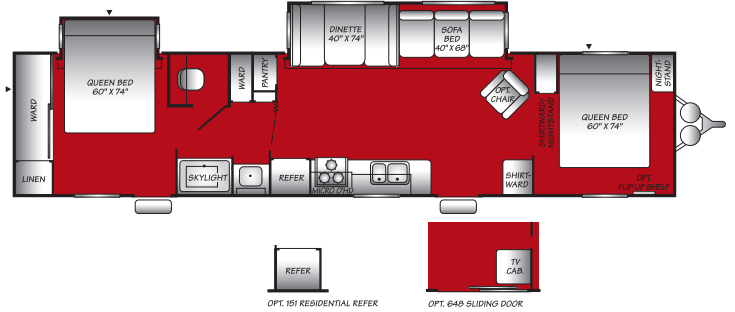

39BDDS
Sleeps 6*, Double Slide-Out

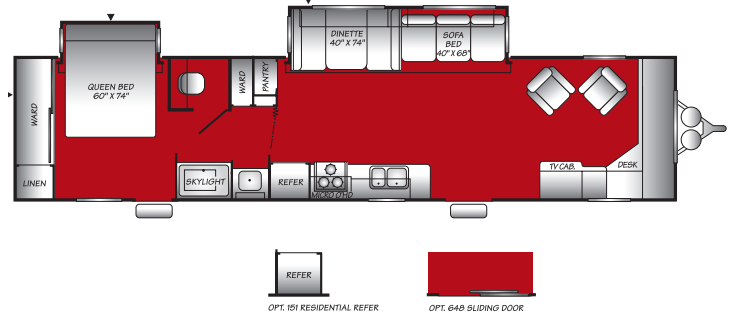

39BHDS
Sleeps 9-10*, Double Slide-Out

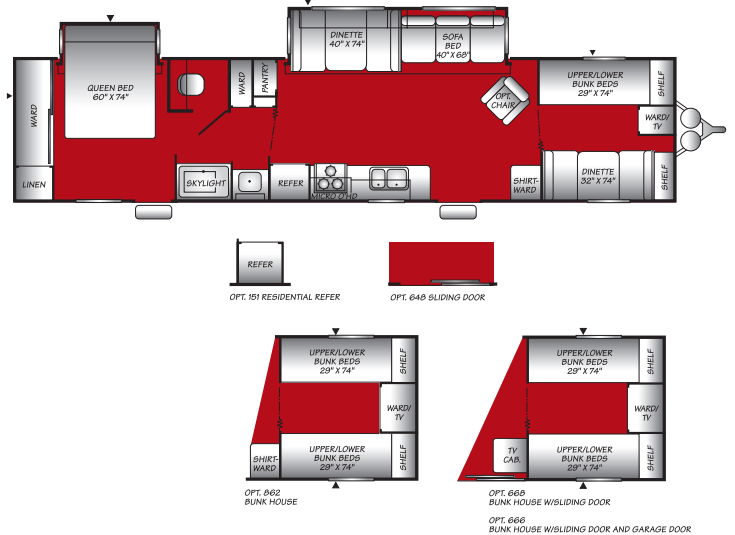

WEIGHTS AND MEASUREMENTS

	PIONEER SPIRIT				PIONEER							
WEIGHTS	18CK	24BH	28BH	21CKS	24RKS	25FQ	26BHS	27FQS	31BD2S	39BD2S	39BDDS	39BHDS
GVWR (lbs) ¹	5,600	5,800	7,500	6,400	7,000	6,400	8,000	7,500	9,500	N/A	N/A	N/A
Gross Dry Weight (lbs) ^{2, 6}	3,465	4,005	4,226	4,199	4,461	4,016	5,368	5,114	6,548	N/A	N/A	N/A
Cargo Carrying Capacity (lbs) ^{3, 6}	2,135	1,795	3,274	2,201	2,539	2,384	2,632	2,386	2,952	N/A	N/A	N/A
Hitch Dry Weight (lbs) ^{2, 6, 9}	419	454	602	636	474	595	687	708	765	N/A	N/A	N/A

DIMENSIONS & CAPACITIES

Length (Feet & Inches) ^{4, 6}	22' 2"	26' 8"	29' 7"	24' 8"	26' 4"	26' 1"	29' 2"	27' 11"	34' 0"	39' 7"	39' 7"	39' 7"
Height (Feet & Inches) ^{5, 6}	9' 3"	9' 3"	9' 3"	9' 10"	9' 10"	9' 10"	10' 4"	10' 2"	10' 4"	10' 4"	10' 4"	10' 4"
Fresh Water Holding Tank (gal) ^{6, 7}	40	40	40	50	50	50	50	50	50	50	50	50
Grey Water Holding Tank (gal) ^{6, 7}	40	40	40	40	40	40	40	40	40	40	40	40
Black Water Holding Tank (gal) ^{6, 7}	40	40	40	40	40	40	40	40	40	40	40	40
Propane Capacity (lbs) ^{6, 7}	60	60	60	60	60	60	60	60	60	60	60	60
Tire Size (Load Range)	ST205/75R 14C	ST205/75R 14C	ST205/75R 14C	ST205/75R 14C	ST205/75R 14C	ST205/75R 14C	ST225/75R 15C	ST205/75R 15C	ST225/75R 15C	ST225/75R 15C	ST225/75R 15C	ST225/75R 15C

FEATURES

INTERIOR

- 120-Volt GFI Circuit Protection (Galley/Bath/Patio)
- 120V Central Electrical Panel
- 92 5/8" Interior Width
- Double-Light Fixtures (Most Areas)
- Dual 7-Gallon Propane Cylinders w/Regulator & Auto-Changeover
- HydroFlame Forced Air, Direct Spark Ignition Furnace w/Thermostat
- In-Ceiling Air Conditioner Ducting (Most Models)
- In-Floor Furnace Ducting (Most Models)
- Light Colored Interior Wall Coverings
- Mini-blinds Throughout (Except Bunk Windows)
- Prewired for Roof Air Conditioner
- Prewired for Stereo & Speakers
- Solid State Converter w/Built-In Battery Charger
- Wall-Mounted Systems Monitor Panel
- Wall-Switched Interior Lights
- 13,500 BTU Air Conditioner
- 15,000 BTU Air Conditioner
- 6-Gallon Propane/12V DSI (Direct Spark Ignition) Water Heater (N/A w/Option 958)
- Bedroom Carpet (Most Models)
- Living Room Carpet (Most Models)
- Stereo AM/FM CD Player (N/A w/Option 958)
- Stereo AM/FM/CD/DVD/MP3 Player
- Large TV Location (Most Models)

GALLEY

- 19" Drop in Range w/Oven
- Dometic® Double Door Propane/Electric Refrigerator
- Double Bowl Sink
- Double Handle High Rise Faucet
- Large Cabinet Doors
- Overhead Storage Cabinet Above Sink
- Pantry w/Adjustable Shelves (Most Models)
- Range Hood w/12V Light & Exhaust Fan
- Wood Grain Refrigerator Insert
- Deluxe Wood Grain Refrigerator Insert
- Mortise and Tenon Cabinets Doors
- Microwave w/Electronic Touch Pad
- Range Cover
- Sink Covers/Cutting Board

Spirit
Pioneer

BEDROOM

- Bedroom Headboard (Most Models)
- Bedside Nightstand (Most Models)
- Décor-Coordinated Bedspread
- Innerspring Mattress
- Lift-Up Bed Platform w/Below Bed Storage (Most Models)
- Wardrobes Accommodate Residential Size Clothes Hangers

BATHROOM

- ABS Bath Tub Wall Surround
- Skylight
- 12V Power Exhaust Roof Vent
- Medicine Cabinet w/Mirrored Door & Adjustable Shelves
- Thetford® Fresh Water Flush Toilet
- Towel Bar, Towel Ring, Toilet Paper Holder
- Wall-Switched Ceiling Light

SAFETY/CONVENIENCE

- Carbon Monoxide Detector/Alarm
- Fire Extinguisher
- Propane Detector/Alarm
- Smoke Detector/Alarm

EXTERIOR

- 120V Patio Receptacle
- Arctic White Gloss Exterior Metal Finish
- Fiberglass Insulation
- Full Color Decorative Exterior Graphics
- Molded Wheel Well Skirts (Most Models)
- Quick Drain Valve Fresh Water Tank
- Radius Aluminum Sidewall Skirting (Most Models)
- Radius Corner Entry Door
- Radius Corner Safety Glass Windows
- Radius Corner Luggage Doors
- Truss Roof Rafters
- Rear Bumper w/Sewer Hose Carrier
- Reinforced Screen Door w/Kick Panel
- Seamless, One-Piece Rubber Roof
- Slide-Out Endwall Window
- Structural I-Beam Cambered Chassis
- Sub-Floor Fresh Water Holding Tank
- Welded, Dual Battery Rack
- Exterior Shower
- Garage Storage
- Patio Awning (N/A w/Option 958)
- Spare Tire and Carrier
- TV Antenna
- Enclosed Chassis

Spirit
Pioneer

SAFETY/CONVENIENCE

- 26" Wide Main Entry Door w/Window (Most Models)
- 4-Wheel Electric Brakes
- Break-Away Emergency Disconnect Brake
- Flush Mount Entry Door Latch w/Deadbolt Lock
- Patio Light-Interior Switch
- Retractable Entry Step w/Non-Skid Strip

STORAGE

- Locking, Insulated Luggage Doors

INTERIOR VALUE PACKAGE

- Microwave
- 6-Gallon Propane/12V DSI (Direct Spark Ignition) Water Heater (N/A w/Option 958)
- Water Heater By-Pass
- Sink Lids
- Stereo AM/FM/CD Player (N/A w/Option 958)
- Throw Pillow
- Skylight
- Ranger Cover
- Deluxe Refer Insert Panel

EXTERIOR VALUE PACKAGE

- TV Antenna
- Awning (N/A w/Option 958)
- LPG Cover (N/A w/Option 958)
- Front Gravel Cover (N/A w/Option 958)
- Stab Jacks
- 13,500 BTU Air Conditioner

Spirit
Pioneer

- GVWR (Gross Vehicle Weight Rating) is the maximum permissible weight of this trailer when fully loaded. It includes all weight at the trailer axle(s) and tongue or pin.
- All dry weights are based on the standard model and do not include optional features or equipment.
- Carrying Capacity is determined by subtracting Gross Dry Weight from GVWR. Cargo Carrying Capacity includes all fluids, optional features, equipment, and personal cargo.
- Length taken from hitch or pin box to rear bumper (excludes accessories). Trailer length includes 3' 6" for hitch; fifth wheel includes standard pin box.
- Actual height may be lower, based on option offerings. Consult with your dealer to obtain actual height for the unit you are interested in.
- Approximate.
- Water weight equals 8.3 lbs. per gallon. Propane weight equals 4.2 lbs per gal.
- Add 10" if equipped with optional spare tire and carrier.
- Hitch weights are dependent upon how the trailer is equipped with options, on-board cargo and tank fluid levels. Actual hitch weights may be higher or lower than shown. It is recommended that the tow vehicle and hitch for your trailer have sufficient capacity to accommodate actual usage.

* = Estimated weights.

N/A = Not available at time of printing.

IMPORTANT— PLEASE READ

Product information, photography and illustrations included in this publication were as accurate as possible at the time of printing. For further product information and changes, please visit our website at www.fleetwoodrv.com or contact your local Fleetwood dealer. Prices, materials, design and specifications are subject to change without notice. All weights, fuel, liquid capacities and dimensions are approximate. Fleetwood has designed its recreational vehicles to provide a variety of uses for customers. Each vehicle features optimal seating, sleeping, storage and fluid capacities. The user is responsible for selecting the proper combination of loads (i.e.: equipment, fluids, cargo, etc.) to ensure that the vehicle's capacities are not exceeded.



S = STANDARD O = OPTIONAL

WHY PIONEER?



PASSION

We're truly passionate about the RV lifestyle. Fleetwood was founded by RV enthusiasts, and that tradition continues today.



QUALITY

There's no cutting corners. Skilled craftsmen build every Fleetwood RV for maximum durability and longevity.



SERVICE

Help is nearby. When you need an upgrade or repair, you'll find facilities all across North America and more than 1,100 dealers ready to assist you.



WARRANTY

Exclusive RV Ownercare warranty. See your Fleetwood dealer for details.



TRUST

More people trust Fleetwood. After all, we've spent over 50 years perfecting RVs, earning the loyalty of generations of RVers.

CONTACT US

To locate a dealer near you, visit our website at www.fleetwoodrv.com or call 1-800-444-4905. We can also be contacted at Fleetwood Customer Relations, P.O. Box 1007, Decatur, IN 46733.

FLEETWOOD TRAVELCADE CLUB

As a Fleetwood owner, you're eligible to become a member of the Fleetwood Travelcade Club. It's a perfect way to meet other Fleetwood owners who love to travel across America and share in the RV lifestyle. Call (877) 577-2560 or visit our website at www.fleetwoodrv.com/owners_clubs to learn more and join the fun!

RV OWNERCARE*

See your local dealer for complete details.

IMPORTANT—PLEASE READ

Product information, photography and illustrations included in this publication were as accurate as possible at the time of printing. For further product information and changes, please visit our website at www.fleetwoodrv.com or contact your local Fleetwood dealer. Prices, materials, design and specifications are subject to change without notice. All weights, fuel, liquid capacities and dimensions are approximate. Fleetwood has designed its recreational vehicles to provide a variety of uses for customers. Each vehicle features optimal seating, sleeping, storage and fluid capacities. The user is responsible for selecting the proper combination of loads (i.e.: equipment, fluids, cargo, etc.) to ensure that the vehicle's capacities are not exceeded.

TO OUR CUSTOMERS...

To make sure that you get the maximum satisfaction out of your recreational vehicle purchase, there are several things you should know:

1. Learn all you can about the travel trailer or fifth wheel you're planning to buy. Don't rely on word of mouth. Get the facts about the actual trailer length, width, unloaded weight with options, Gross Vehicle Weight Rating, and cargo carrying capacity. These are usually available in the manufacturer's sales literature or from the Cargo Carrying Capacity Label located in each trailer. Be sure to check this information **before** you decide which unit to buy.
2. Verify the towing capacity of your tow vehicle. If you don't know, or aren't sure, you can ask at your automotive dealership. Be sure to match its tow rating to the loaded (not dry) weight of your trailer. Include the weight of water, additional accessories, clothing, food, and gear. To help Fleetwood travel trailer customers estimate this total weight, our Gross Vehicle Weight Ratings reflect the maximum weight of the trailer when fully loaded for camping. Be sure the weight of the tow vehicle plus the weight of your trailer do not exceed the Gross Combined Weight Rating of the tow vehicle.

Taking these simple steps before you buy will help ensure that your trailer and tow vehicle combination is just what you wanted.

See you on the trail!

Your Local Fleetwood Dealer Is:

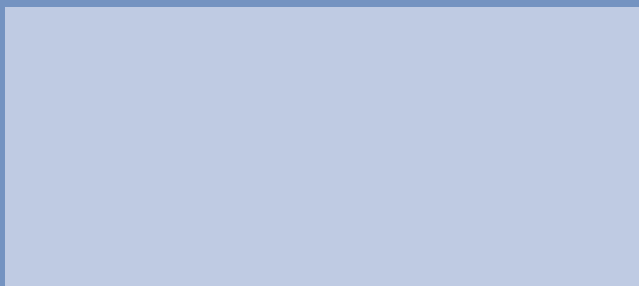

tread lightly!
LEAVING A GOOD IMPRESSION



FLEETWOOD

Driven to Explore

*For complete info see your Fleetwood dealer.
©2006. Fleetwood Enterprises, Inc. Printed in the U.S.A.
Model Year 2007, 1st Edition PI07B1, 8/06.